

A Plan and Survey of a piece of
 Situate Land in the Parish of Ralbed
 the property of Mr. Thomas Radcliffe
 By James Kelly Feb. 26th 1739

Contents

1	2	0	14
2	0	3	35
3	2	1	12
4	1	2	33
5	0	3	34
6	1	2	24
7	4	0	16
8	2	0	14
9	1	3	29
10	2	2	0
11	2	3	35
12	3	1	28
13	2	1	21
14	2	0	14
15	0	3	35
House	0	3	5
Total			32.3.29

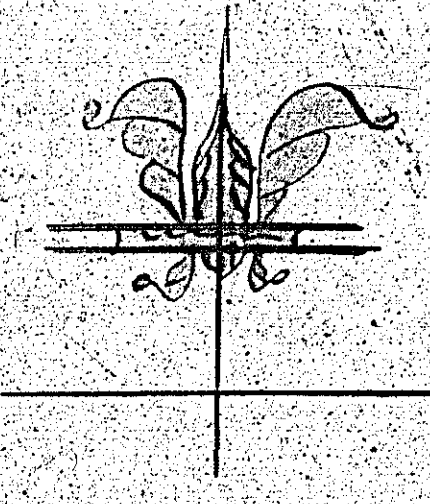

Scale 3 Chains to an inch

Content
 Roads 15.0.15
 7.5.13

Scale 3 chains to an inch
 Surveyed May 1840 by J. J. J. & J. J. J.

William Thomas & Robert J. J.

[Faint, mostly illegible text on the top page of the manuscript, possibly bleed-through from the reverse side.]

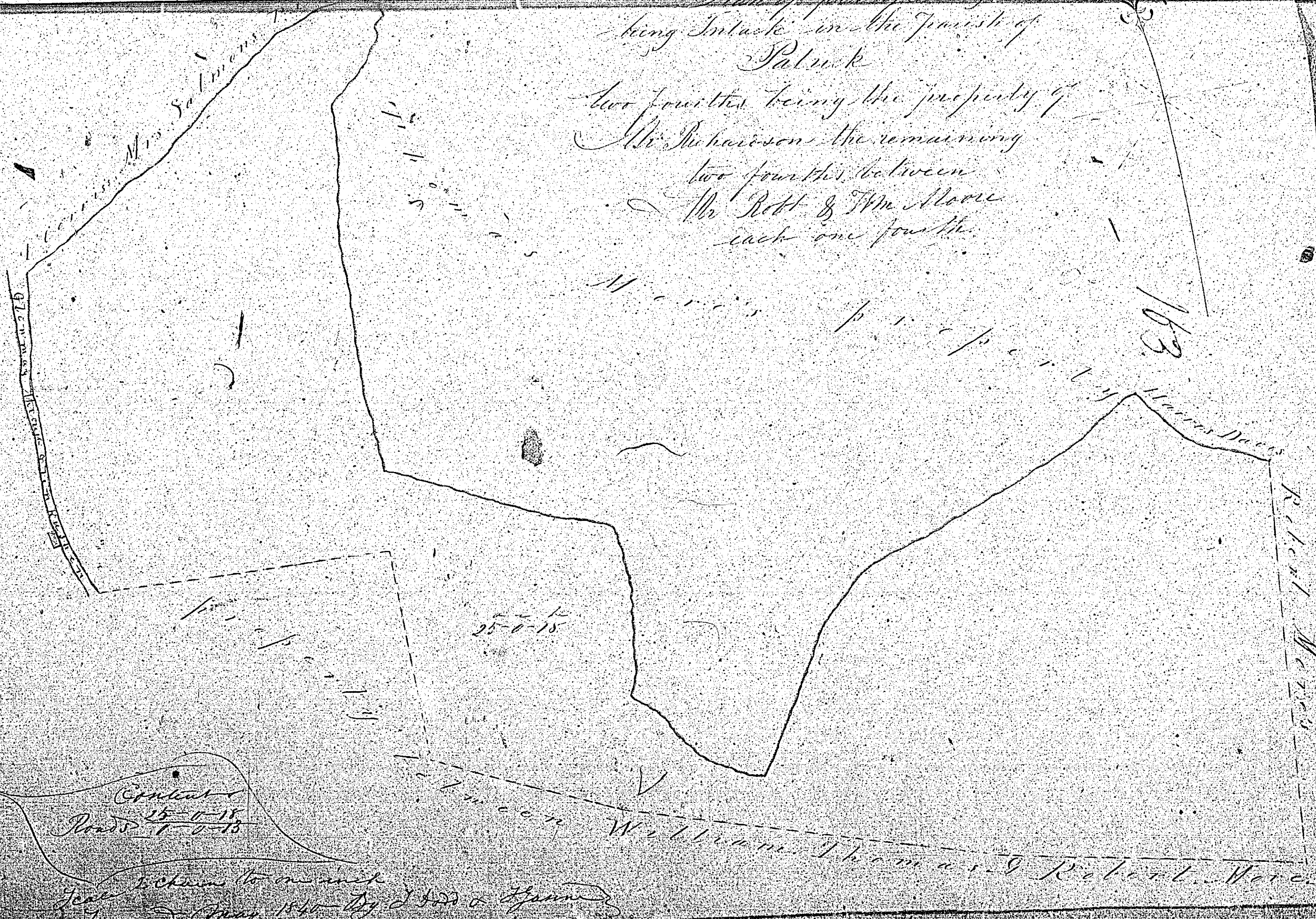

*being Inducted in the Parish of
Palwick
two fourths being the property of
Mr. Harrison the remaining
two fourths between
Mr. Holt & Mr. Moore
each one fourth.*

*Central
Road 25-1-18*

*John Thomas to me and
George Henry 1840 by J. D. & J. H.*

between William Thomas & Robert Moore

part of
Kerron-hill 165

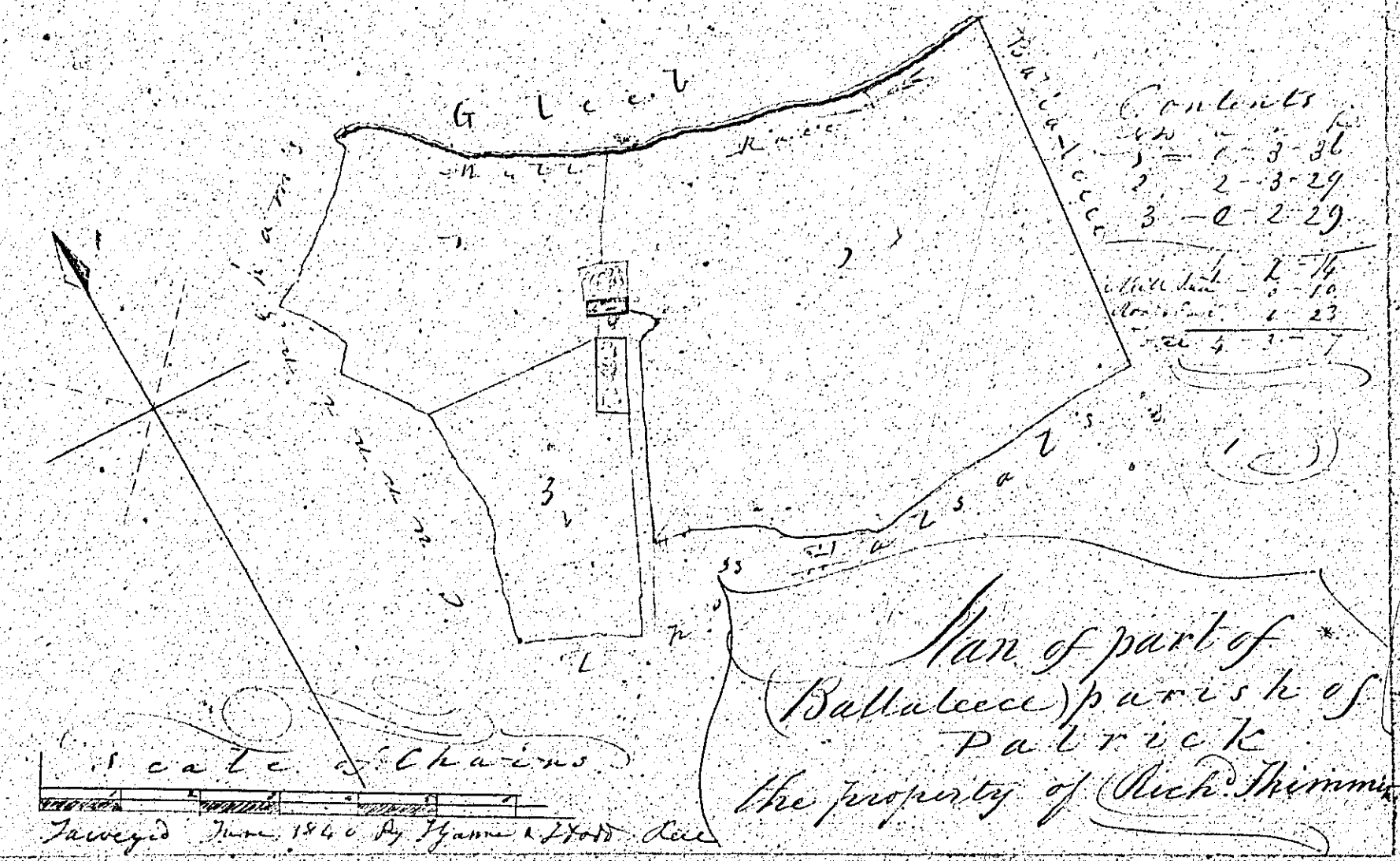

Contents

1	1	29
2	1	29
3	1	29
4	1	29
5	1	29
6	1	29
7	1	29
8	1	29
9	1	29
10	1	29
11	1	29
12	1	29
13	1	29
14	1	29
15	1	29
16	1	29
17	1	29
18	1	29
19	1	29
20	1	29
21	1	29
22	1	29
23	1	29
24	1	29
25	1	29
26	1	29
27	1	29
28	1	29
29	1	29
30	1	29
31	1	29
32	1	29
33	1	29
34	1	29
35	1	29
36	1	29
37	1	29
38	1	29
39	1	29
40	1	29
41	1	29
42	1	29
43	1	29
44	1	29
45	1	29
46	1	29
47	1	29
48	1	29
49	1	29
50	1	29
51	1	29
52	1	29
53	1	29
54	1	29
55	1	29
56	1	29
57	1	29
58	1	29
59	1	29
60	1	29
61	1	29
62	1	29
63	1	29
64	1	29
65	1	29
66	1	29
67	1	29
68	1	29
69	1	29
70	1	29
71	1	29
72	1	29
73	1	29
74	1	29
75	1	29
76	1	29
77	1	29
78	1	29
79	1	29
80	1	29
81	1	29
82	1	29
83	1	29
84	1	29
85	1	29
86	1	29
87	1	29
88	1	29
89	1	29
90	1	29
91	1	29
92	1	29
93	1	29
94	1	29
95	1	29
96	1	29
97	1	29
98	1	29
99	1	29
100	1	29

Plan of part of
(Ballalece) parish of
Patrick
the property of John Thimmin

Plan of
The John Thimmin's
part of Lhiggymear
being Patrick
Parish of Patrick

Contents

1	1	29
2	1	29
3	1	29
4	1	29
5	1	29
6	1	29
7	1	29
8	1	29
9	1	29
10	1	29
11	1	29
12	1	29
13	1	29
14	1	29
15	1	29
16	1	29
17	1	29
18	1	29
19	1	29
20	1	29
21	1	29
22	1	29
23	1	29
24	1	29
25	1	29
26	1	29
27	1	29
28	1	29
29	1	29
30	1	29
31	1	29
32	1	29
33	1	29
34	1	29
35	1	29
36	1	29
37	1	29
38	1	29
39	1	29
40	1	29
41	1	29
42	1	29
43	1	29
44	1	29
45	1	29
46	1	29
47	1	29
48	1	29
49	1	29
50	1	29
51	1	29
52	1	29
53	1	29
54	1	29
55	1	29
56	1	29
57	1	29
58	1	29
59	1	29
60	1	29
61	1	29
62	1	29
63	1	29
64	1	29
65	1	29
66	1	29
67	1	29
68	1	29
69	1	29
70	1	29
71	1	29
72	1	29
73	1	29
74	1	29
75	1	29
76	1	29
77	1	29
78	1	29
79	1	29
80	1	29
81	1	29
82	1	29
83	1	29
84	1	29
85	1	29
86	1	29
87	1	29
88	1	29
89	1	29
90	1	29
91	1	29
92	1	29
93	1	29
94	1	29
95	1	29
96	1	29
97	1	29
98	1	29
99	1	29
100	1	29

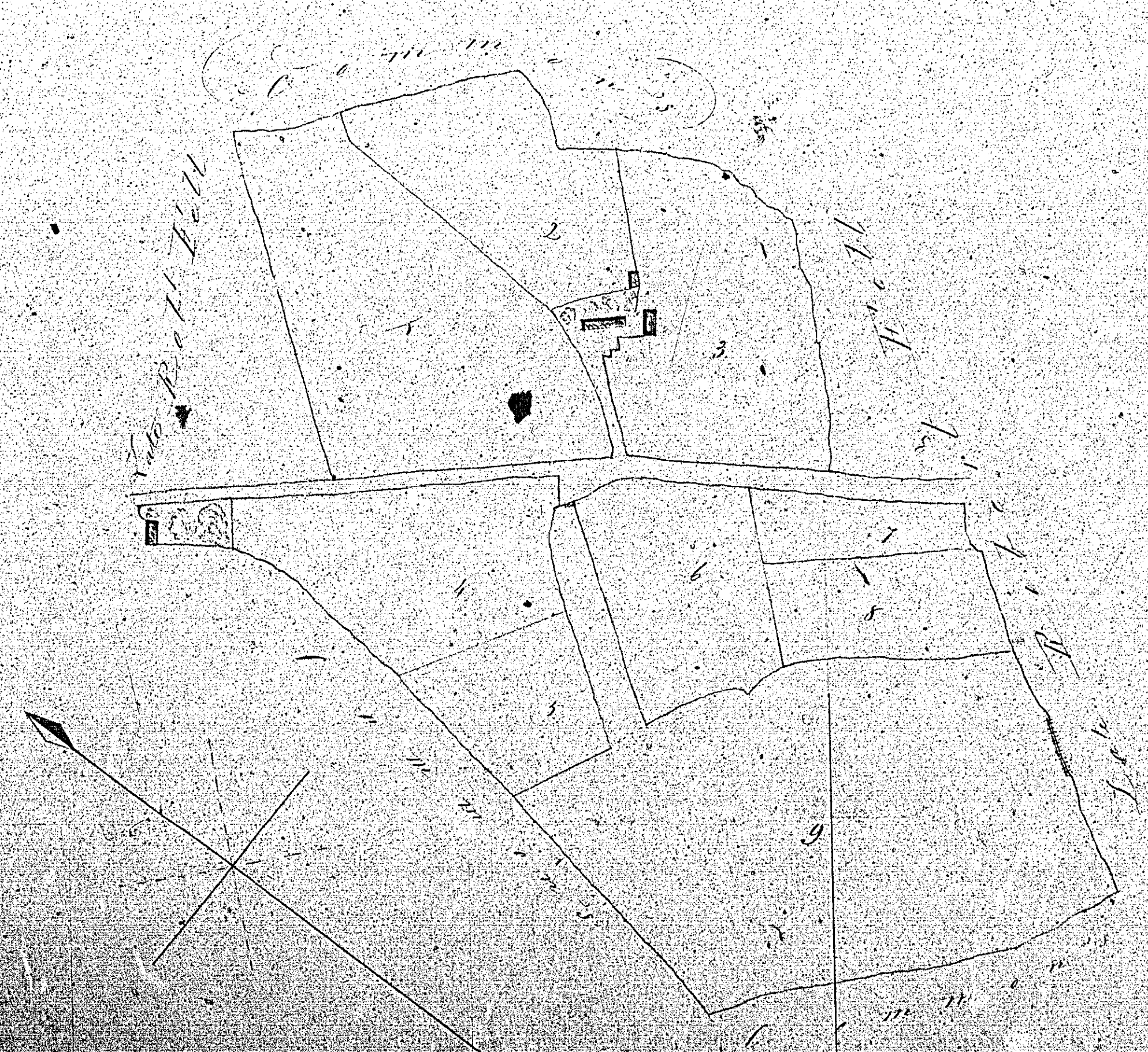

Scale of Chains
Surveyed June 1860 by James & John Hill

F. Plan & Survey of a piece
of Indian land on the Peninsula of
Pulaski, the property of St. John's College
by P. J.
1840

167

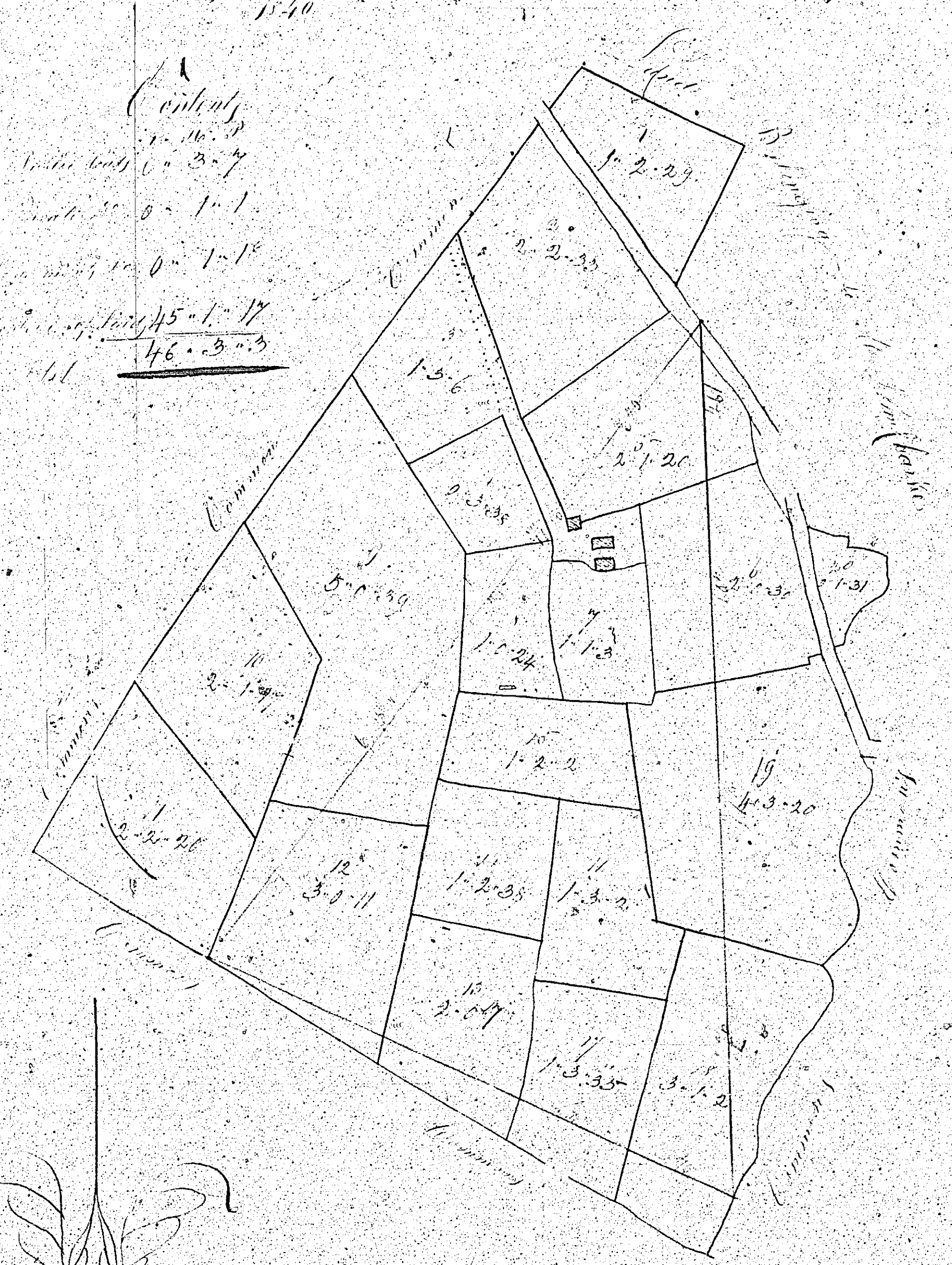

Contents
1-2-29
2-2-35
1-3-6
2-1-20
5-0-199
2-1-24
1-1-3
1-2-2
4-3-20
1-2-35
1-3-20
2-0-9
1-3-35
3-1-2

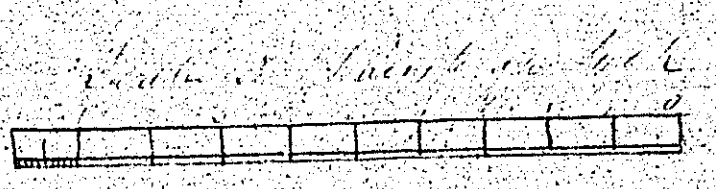
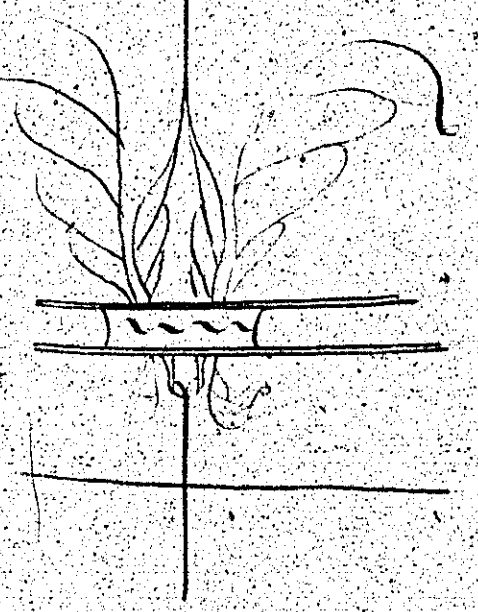

68

160

Plan of
Ballagunna
Quartermen
in the
Parish of Slieve
the property of
Messrs. Salmon



Ballagunna
the property of
Messrs. Salmon

Plot No.	Area	Remarks
1	1.0	
2	1.0	
3	1.0	
4	1.0	
5	1.0	
6	1.0	
7	1.0	
8	1.0	
9	1.0	
10	1.0	
11	1.0	
12	1.0	
13	1.0	
14	1.0	
15	1.0	
16	1.0	
17	1.0	
18	1.0	
19	1.0	
20	1.0	
21	1.0	
22	1.0	
23	1.0	
24	1.0	
25	1.0	
26	1.0	
27	1.0	
28	1.0	
29	1.0	
30	1.0	
31	1.0	
32	1.0	
33	1.0	
34	1.0	
35	1.0	
36	1.0	
37	1.0	
38	1.0	
39	1.0	
40	1.0	
41	1.0	
42	1.0	
43	1.0	
44	1.0	
45	1.0	
46	1.0	
47	1.0	
48	1.0	
49	1.0	
50	1.0	
51	1.0	
52	1.0	
53	1.0	
54	1.0	
55	1.0	
56	1.0	
57	1.0	
58	1.0	
59	1.0	
60	1.0	
61	1.0	
62	1.0	
63	1.0	
64	1.0	
65	1.0	
66	1.0	
67	1.0	
68	1.0	
69	1.0	
70	1.0	
71	1.0	
72	1.0	
73	1.0	
74	1.0	
75	1.0	
76	1.0	
77	1.0	
78	1.0	
79	1.0	
80	1.0	
81	1.0	
82	1.0	
83	1.0	
84	1.0	
85	1.0	
86	1.0	
87	1.0	
88	1.0	
89	1.0	
90	1.0	
91	1.0	
92	1.0	
93	1.0	
94	1.0	
95	1.0	
96	1.0	
97	1.0	
98	1.0	
99	1.0	
100	1.0	

Scale 2 chains to an inch
Surveyed by J. Salmon
August 1839

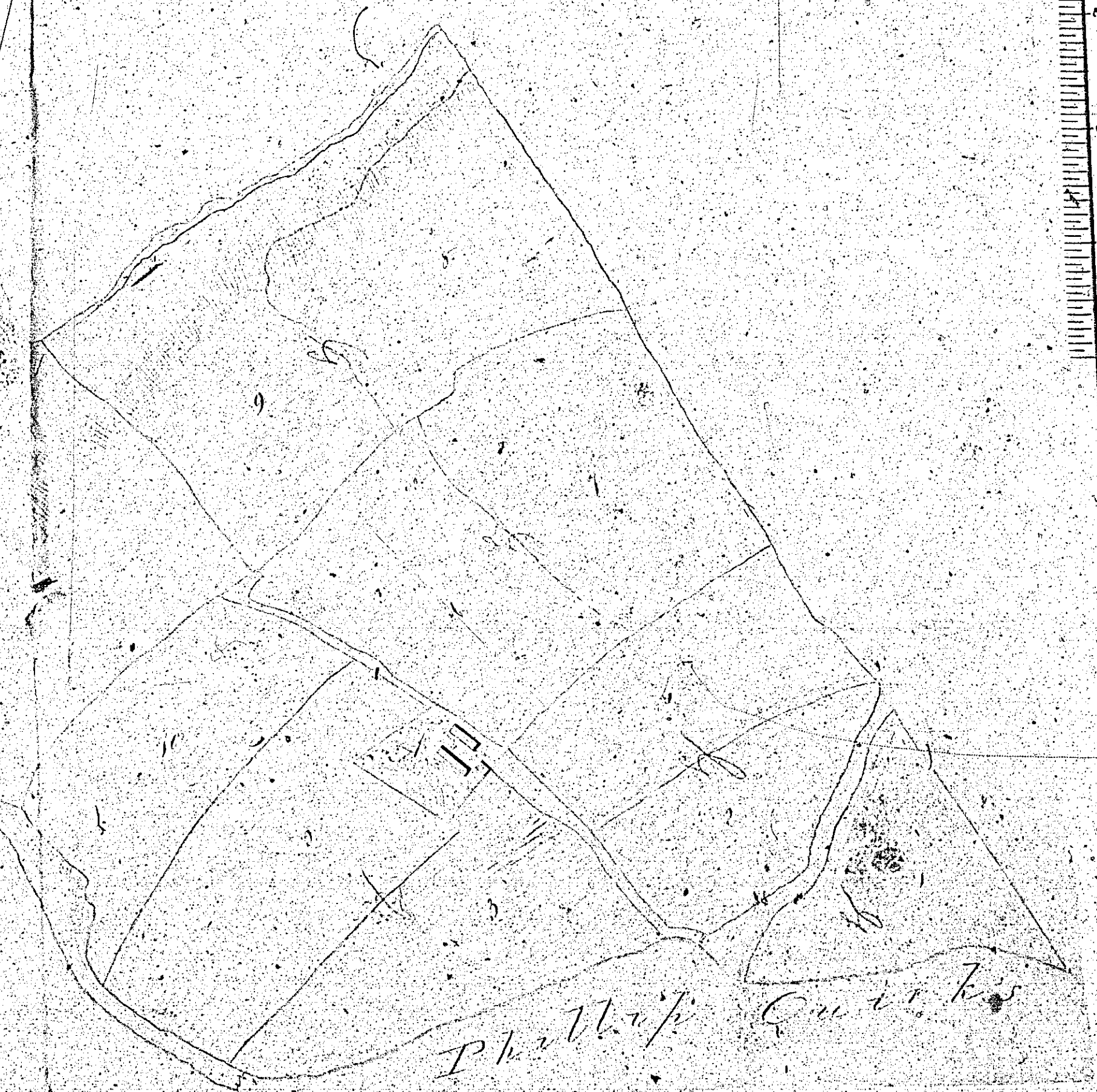

Phillip's