

1000 1/2 Survey of part of 3000

in the Parish of Redbrook the property of

Mr Wm Deacon  
by P. Kelly his solicitor

146.

Contents of 146  
 Public Roads 0.0.34  
 Rivers 1.0.39  
 Houses & Buildings 1.2.5  
 Content of Sites 17.0.42  
 Total 18.0.31  
 Mr Kelly's share by a 1/2  
 Mr Deacon's share 9.0.29

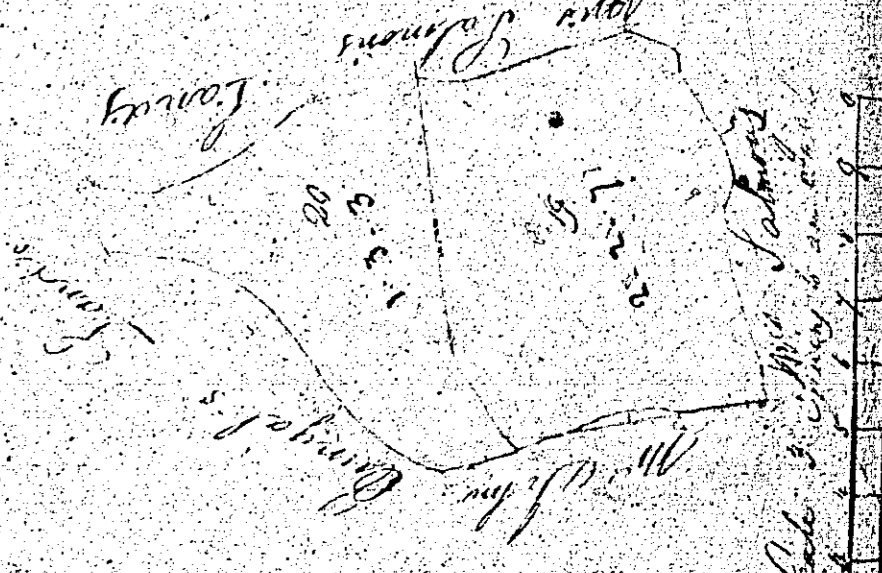
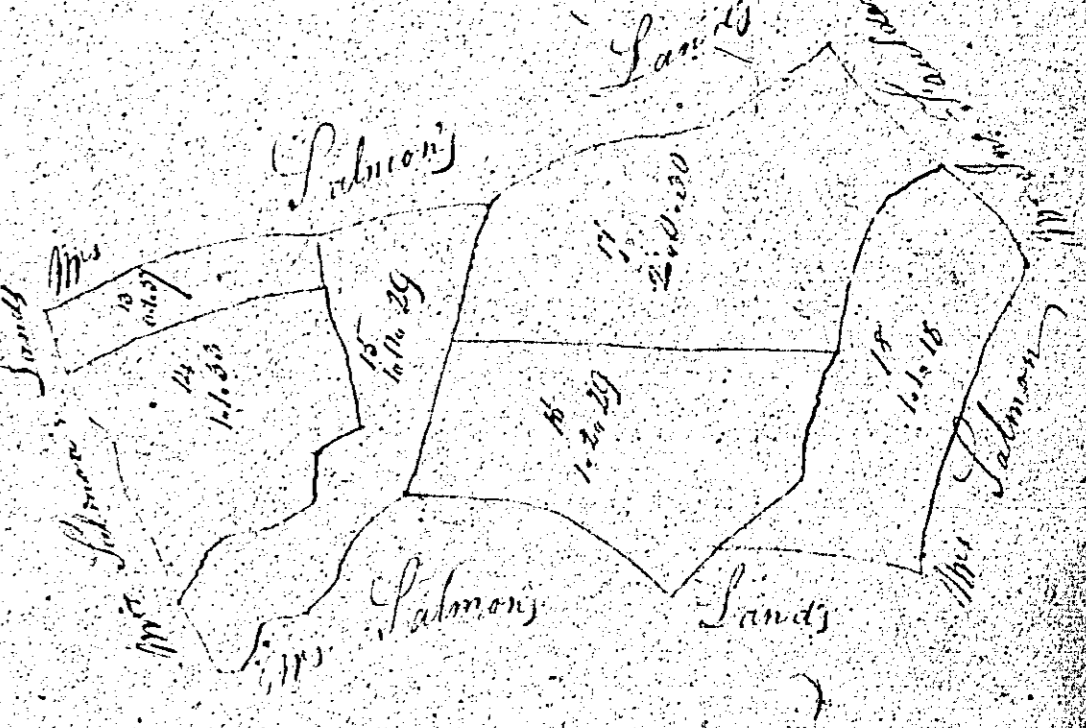
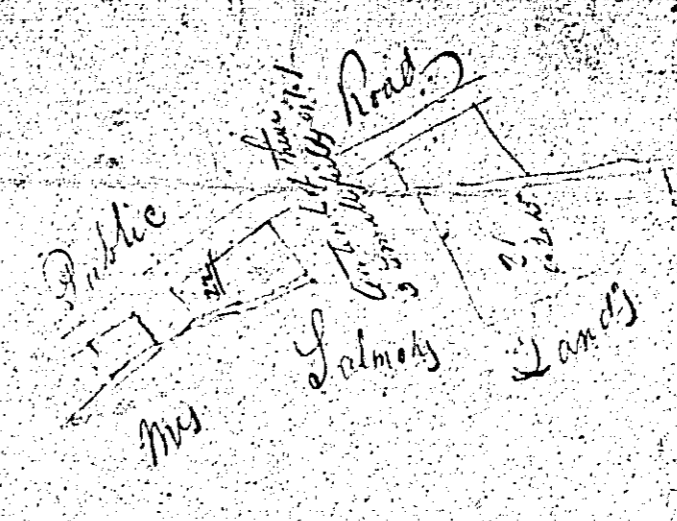
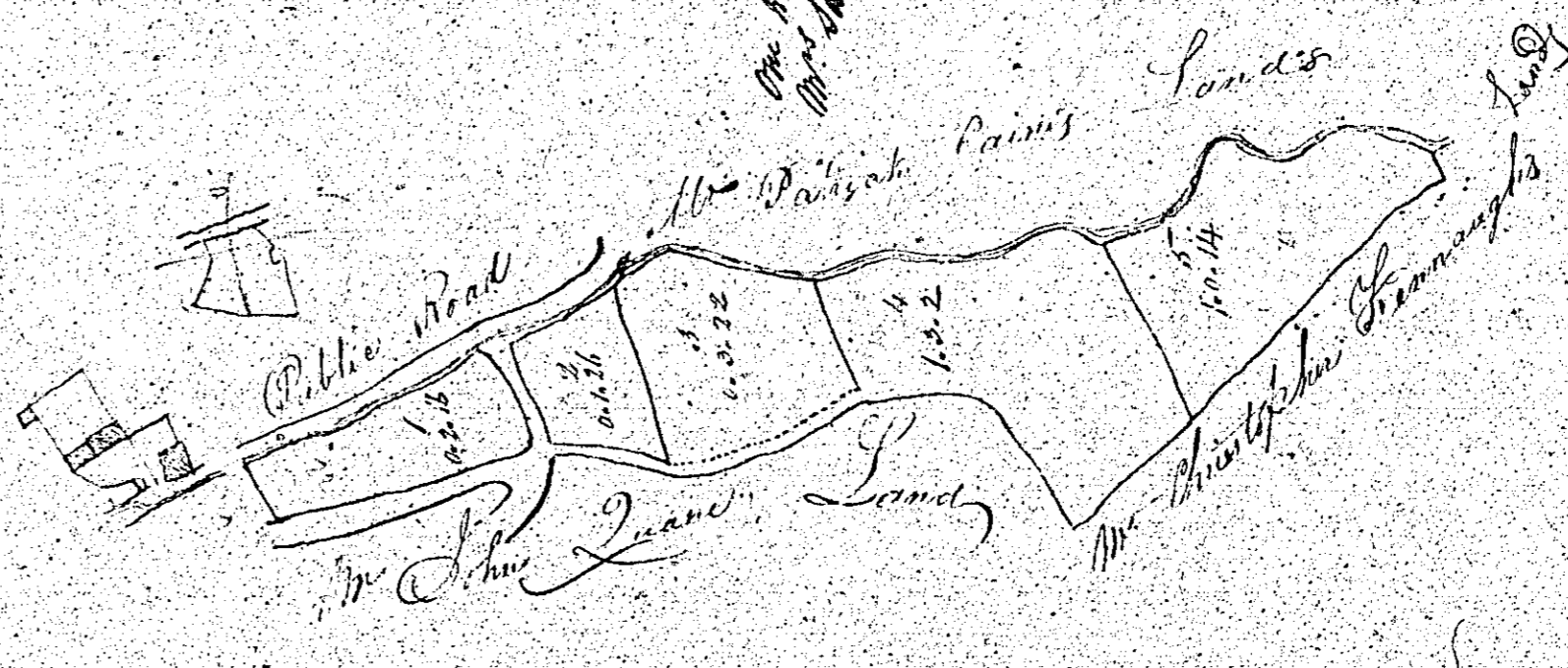

145.

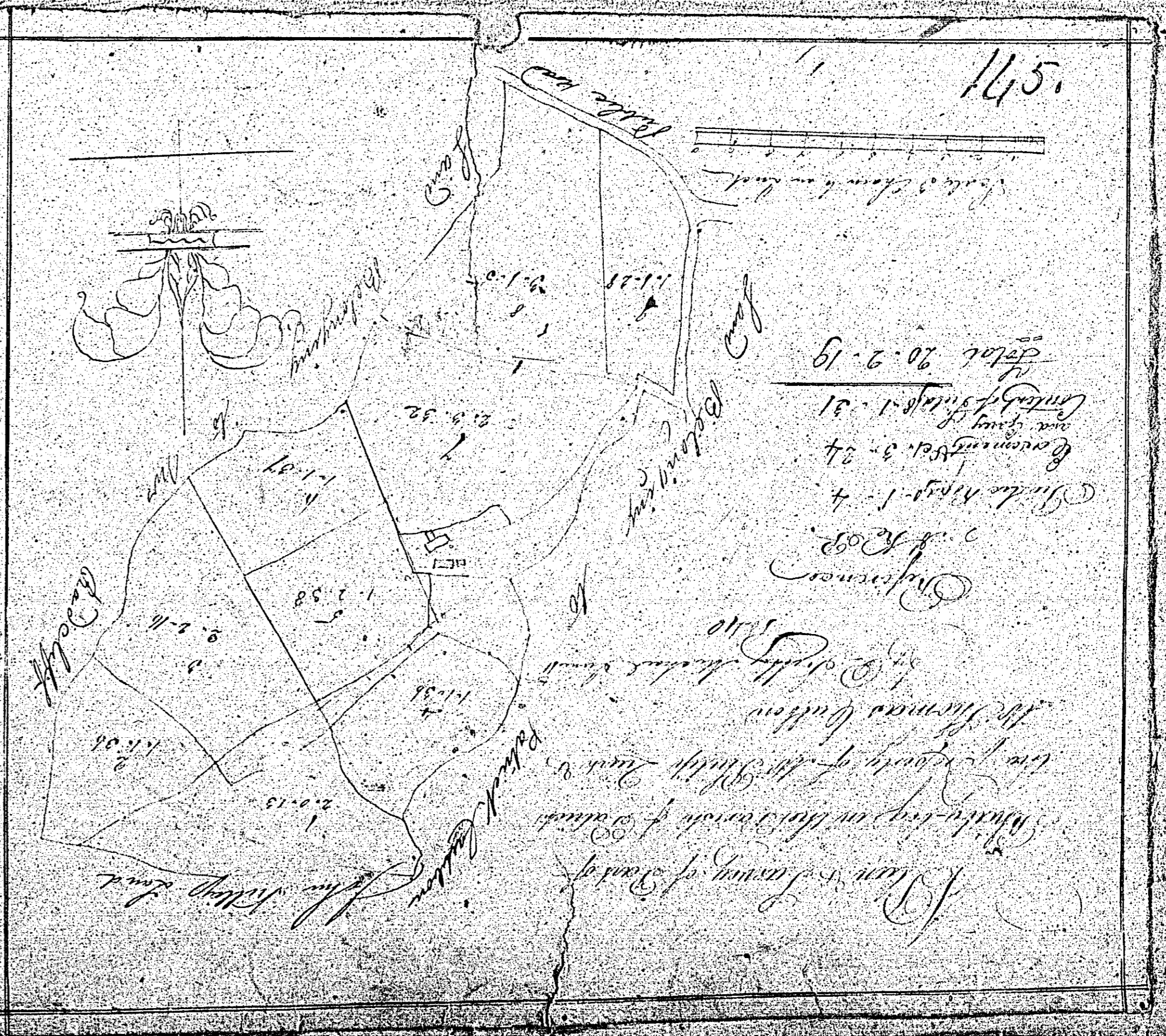

Contents of 145  
 Public Roads 20.2.19  
 Rivers 1.0.31  
 Houses & Buildings 3.24  
 Content of Sites 1.4  
 Total 25.0.24

Mr Kelly's share by a 1/2  
 Mr Deacon's share 12.5.12

PLAN  
 OF  
 THE TITHES OF RHEAVY MOAR & RHEAVY BING  
 in the Parish of  
 PATRICK  
 the property of  
 M<sup>r</sup> RICHARD QUIRK  
 1840.

REFERENCE TO THE FARMS

RHEAVY, D & P		RHEAVY, B & C	
No.	Acres	No.	Acres
1	2.1.20	1	1.1.20
2	6.1.20	2	1.1.20
3	6.1.20	3	1.1.20
4	1.2.20	4	1.1.20
5	4.1.20	5	1.1.20
6	5.2.20	6	1.1.20
7	2.1.20	7	1.1.20
8	2.1.20	8	1.1.20
9	3.1.20	9	1.1.20
10	3.1.20	10	1.1.20
11	1.3.20	11	1.1.20
12	1.3.20	12	1.1.20
13	2.2.20	13	1.1.20
14	1.1.20	14	1.1.20
15	1.3.20	15	1.1.20
16	1.1.20	16	1.1.20
17	1.1.20	17	1.1.20
18	1.1.20	18	1.1.20
19	1.1.20	19	1.1.20
20	1.1.20	20	1.1.20
21	1.1.20	21	1.1.20
22	1.1.20	22	1.1.20
23	1.1.20	23	1.1.20
24	1.1.20	24	1.1.20
25	1.1.20	25	1.1.20
26	1.1.20	26	1.1.20
27	1.1.20	27	1.1.20
28	1.1.20	28	1.1.20
29	1.1.20	29	1.1.20
30	1.1.20	30	1.1.20
31	1.1.20	31	1.1.20
32	1.1.20	32	1.1.20
33	1.1.20	33	1.1.20
34	1.1.20	34	1.1.20
35	1.1.20	35	1.1.20
36	1.1.20	36	1.1.20
37	1.1.20	37	1.1.20
38	1.1.20	38	1.1.20
39	1.1.20	39	1.1.20
40	1.1.20	40	1.1.20
41	1.1.20	41	1.1.20
42	1.1.20	42	1.1.20
43	1.1.20	43	1.1.20
44	1.1.20	44	1.1.20
45	1.1.20	45	1.1.20
46	1.1.20	46	1.1.20
47	1.1.20	47	1.1.20
48	1.1.20	48	1.1.20
49	1.1.20	49	1.1.20
50	1.1.20	50	1.1.20
51	1.1.20	51	1.1.20
52	1.1.20	52	1.1.20
53	1.1.20	53	1.1.20
54	1.1.20	54	1.1.20
55	1.1.20	55	1.1.20
56	1.1.20	56	1.1.20
57	1.1.20	57	1.1.20
58	1.1.20	58	1.1.20
59	1.1.20	59	1.1.20
60	1.1.20	60	1.1.20
61	1.1.20	61	1.1.20
62	1.1.20	62	1.1.20
63	1.1.20	63	1.1.20
64	1.1.20	64	1.1.20
65	1.1.20	65	1.1.20
66	1.1.20	66	1.1.20
67	1.1.20	67	1.1.20
68	1.1.20	68	1.1.20
69	1.1.20	69	1.1.20
70	1.1.20	70	1.1.20
71	1.1.20	71	1.1.20
72	1.1.20	72	1.1.20
73	1.1.20	73	1.1.20
74	1.1.20	74	1.1.20
75	1.1.20	75	1.1.20
76	1.1.20	76	1.1.20
77	1.1.20	77	1.1.20
78	1.1.20	78	1.1.20
79	1.1.20	79	1.1.20
80	1.1.20	80	1.1.20
81	1.1.20	81	1.1.20
82	1.1.20	82	1.1.20
83	1.1.20	83	1.1.20
84	1.1.20	84	1.1.20
85	1.1.20	85	1.1.20
86	1.1.20	86	1.1.20
87	1.1.20	87	1.1.20
88	1.1.20	88	1.1.20
89	1.1.20	89	1.1.20
90	1.1.20	90	1.1.20
91	1.1.20	91	1.1.20
92	1.1.20	92	1.1.20
93	1.1.20	93	1.1.20
94	1.1.20	94	1.1.20
95	1.1.20	95	1.1.20
96	1.1.20	96	1.1.20
97	1.1.20	97	1.1.20
98	1.1.20	98	1.1.20
99	1.1.20	99	1.1.20
100	1.1.20	100	1.1.20



ISLE OF MAN GOVERNMENT: GENERAL REGISTRY  
 TITHE PLANS: PARISH OF PATRICK  
 Original coloured 1:30

7

148

West

West

160.

A Plan Survey of a piece  
of Suback Land in the Parish  
of St. Andrew, the property of  
Mr. ~~John~~ <sup>James</sup> ~~Smith~~  
by Order, and Survey of 1748

1748

Perch  
No 1 0.2.12  
No 2 0.1.2  
No 3 0.2.2  
Road 0.0.9  
Total 1.0.5

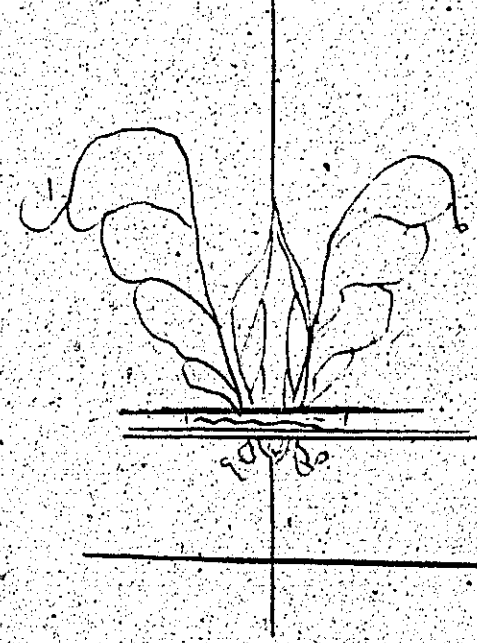
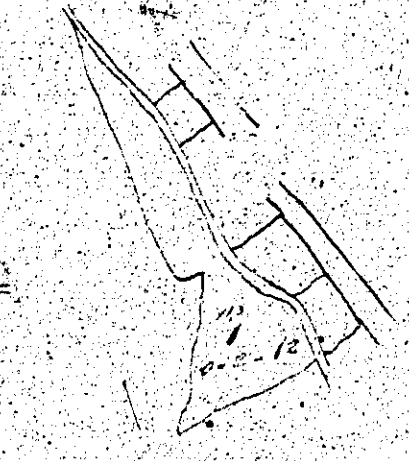

of ~~St. Andrew's~~ Church, & ~~the~~ <sup>the</sup> ~~same~~ <sup>same</sup> ~~land~~ <sup>land</sup>

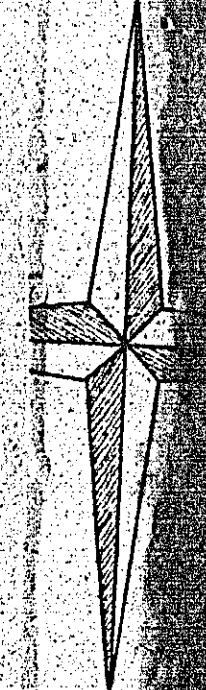
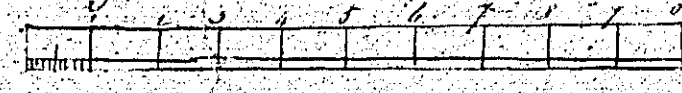

DI  
NO  
VI  
©

**PLAN and Survey**  
 of the part of the Quarterland of Ballahic  
 In the parish of St. Patrick  
 The property of  
 Mr. Henry Quilliam

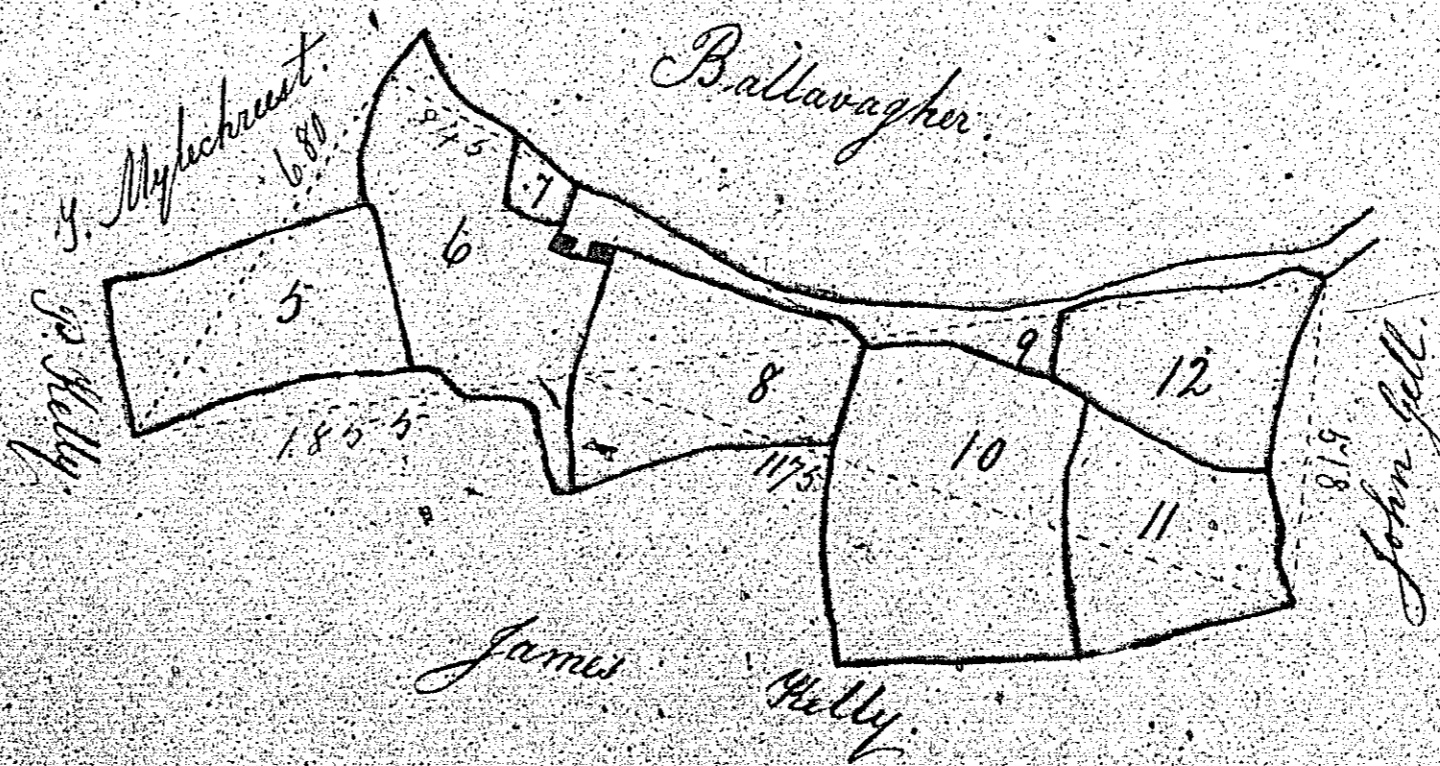
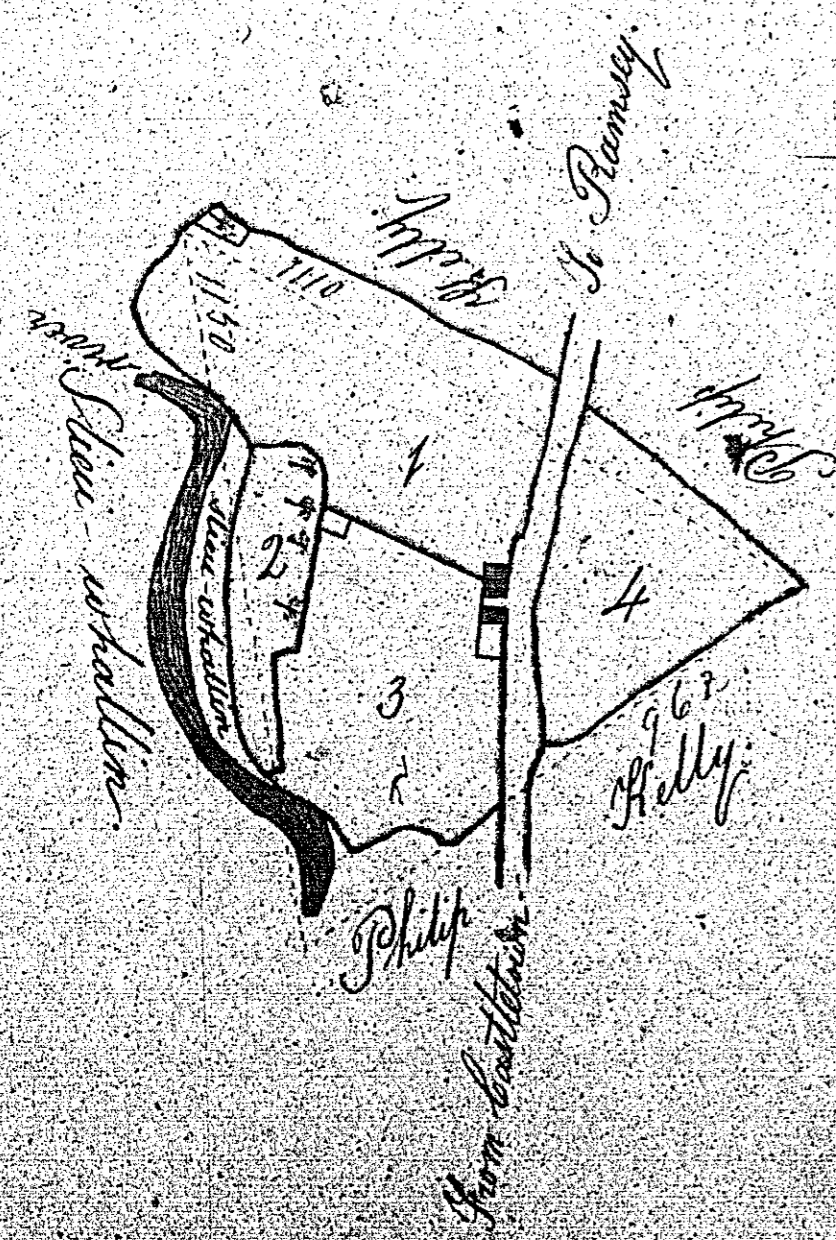

Reference.			
No.	Ac.	R.	P.
1	2	0	5
2	0	2	6
3	1	2	0
4	1	0	26
5	1	0	10
6	1	1	3
7	0	0	14
8	1	0	21
9	0	2	26
10	1	3	10
11	0	3	31
12	0	3	17
Total.	13	0	8

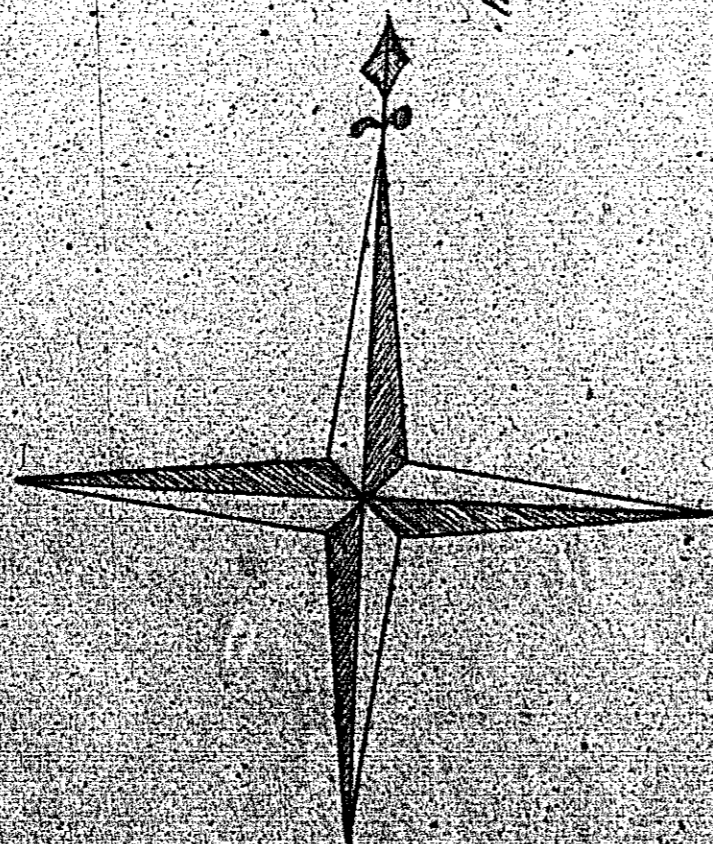

0 1 2 3 4 5 6 7 8 9 10 Chains.

Surveyed May 1840  
 by William Keighan  
 R.H. Gorman

1840

EXTRA  
 LONDON  
 CAMBRIDGE

Plan

BALLIQUAYLE

in the Parish of  
 Cabrick  
 the property of  
 Mr. John Donnelly

Scale of 1/2 inches to one inch

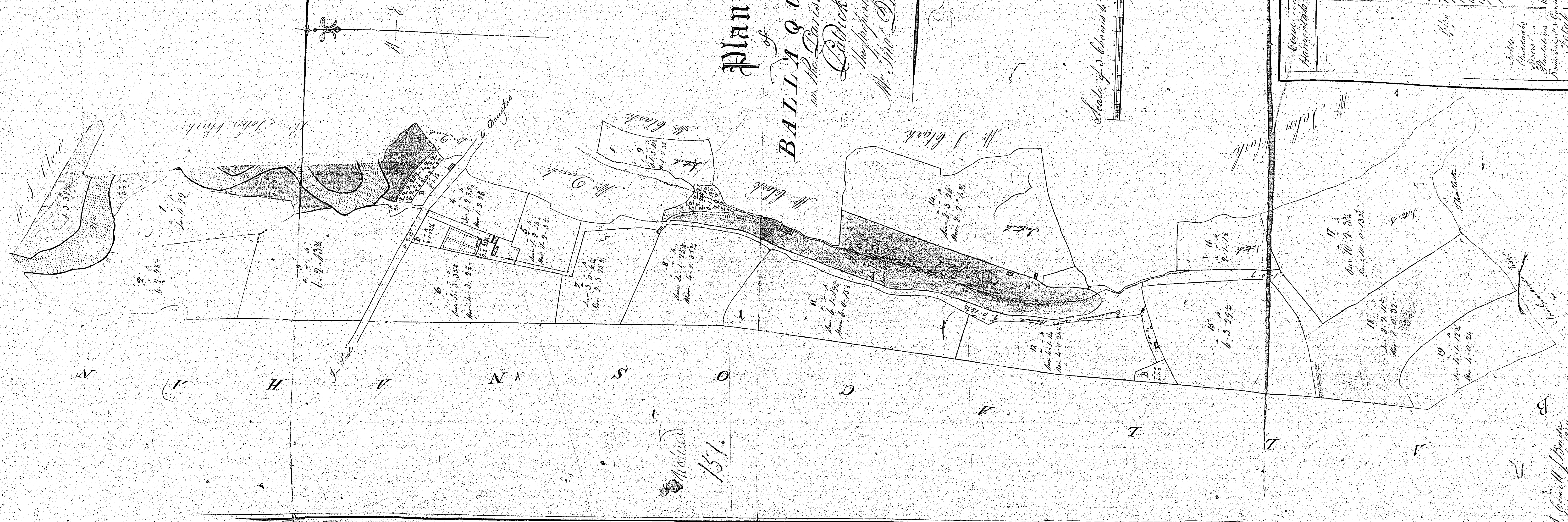

Table of Contents

1	2	3	4	5	6	7	8	9	10	11	12	13	14	15	16	17	18	19	20	21	22	23	24	25	26	27	28	29	30	31	32	33	34	35	36	37	38	39	40	41	42	43	44	45	46	47	48	49	50	51	52	53	54	55	56	57	58	59	60	61	62	63	64	65	66	67	68	69	70	71	72	73	74	75	76	77	78	79	80	81	82	83	84	85	86	87	88	89	90	91	92	93	94	95	96	97	98	99	100
---	---	---	---	---	---	---	---	---	----	----	----	----	----	----	----	----	----	----	----	----	----	----	----	----	----	----	----	----	----	----	----	----	----	----	----	----	----	----	----	----	----	----	----	----	----	----	----	----	----	----	----	----	----	----	----	----	----	----	----	----	----	----	----	----	----	----	----	----	----	----	----	----	----	----	----	----	----	----	----	----	----	----	----	----	----	----	----	----	----	----	----	----	----	----	----	----	----	----	-----

J. Conwell & Sons  
 Surveyors Dublin 1851

