

not used

Plan of Field
part of land of
Walla Church
Parish of Enchan
No. John Milligan
175.



A.R.D.
1. 2. 12

Three chains to a furlong

Joseph Blake Surveyor

Ground plan of House
 and Front Court 176.
 Situate in the
 Village of Cuckon
 The property of
 Mr. John Willmott
 Jan 4th 1844

Chapel 12 Capt. Willmott
 From Bangalore to Ranvij

J. R. W. D.
 1844

One Chain to an Inch
 Joseph Blake Survey

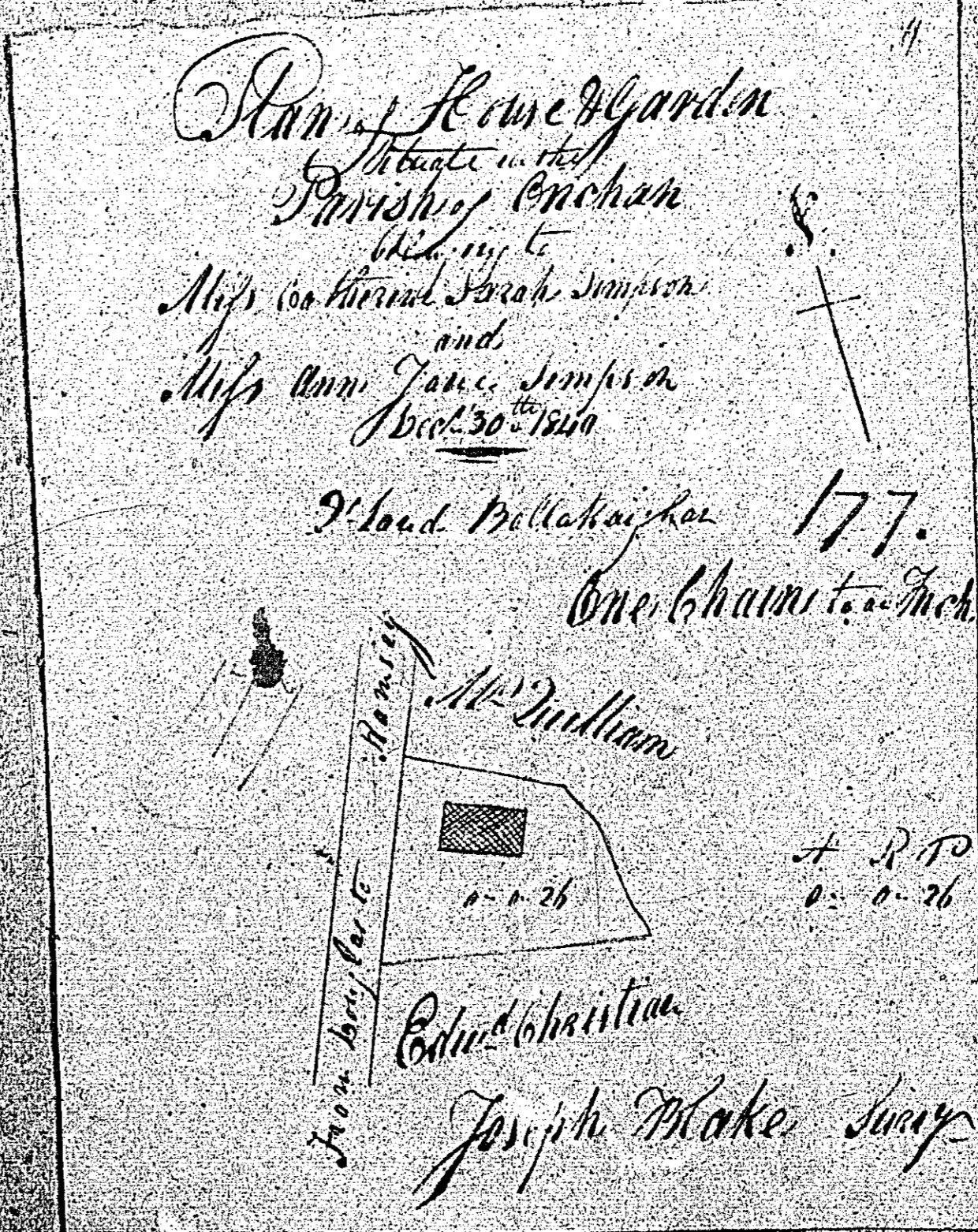

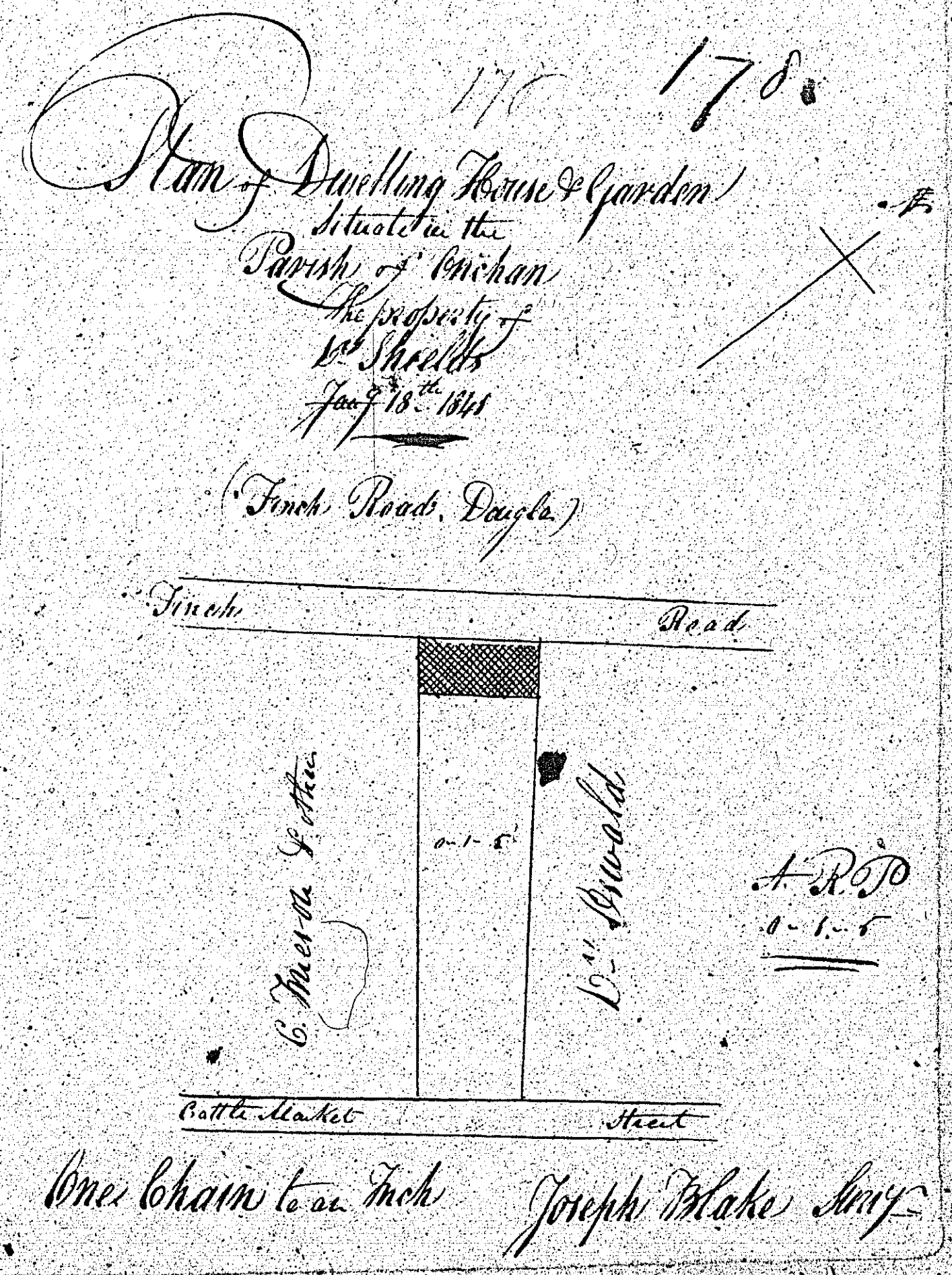

in town

Property in Finch Road
Orchard
belonging to M. J. Stephen
April 1840

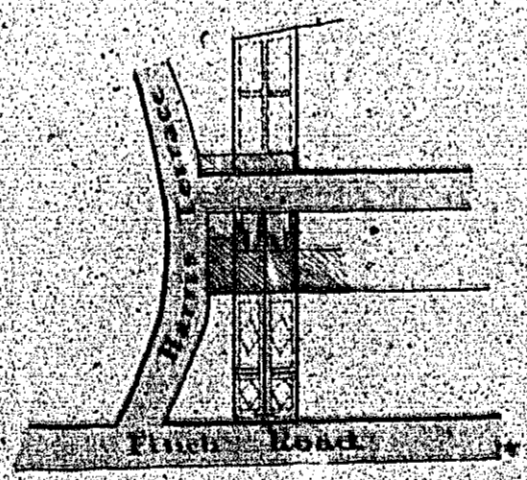

Contents of 30

Chains
By John C. Hard, Surveyor

179

W. H. H. S.

Home of Industry
Back of Harris Terrace



180
GROUND PLAN
OF
DWELLING HOUSE & OFFICES
ON
HARRIS TERRACE
THE PROPERTY
OF
THE REV. H. J. STEVENSON, M.A.
In the Parish of
ONCHAM.

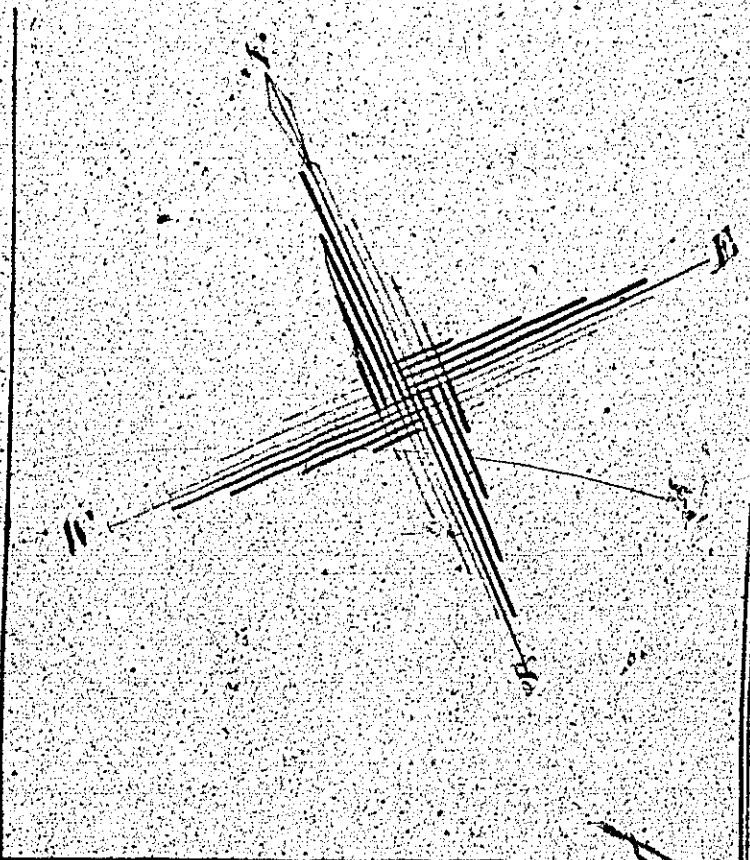
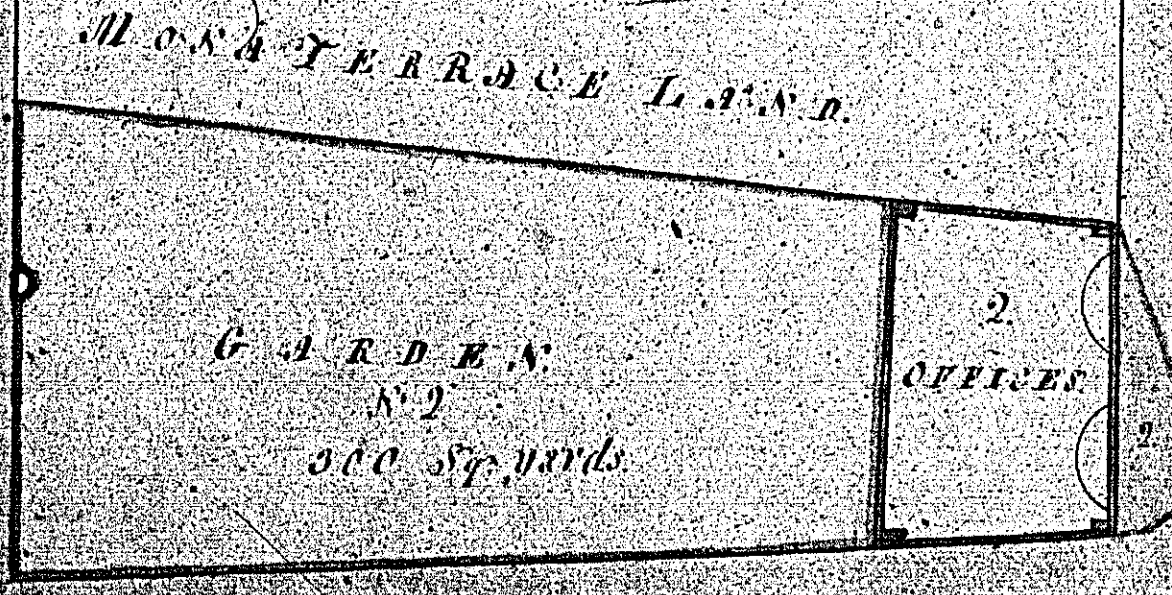

MEASURES in Yards
St. Front of Plot 210 yds
2. Back of Offices 100
Total 310

Scale of 5 Yards to an Inch

Drawn in 1840
G. H. Rogers