

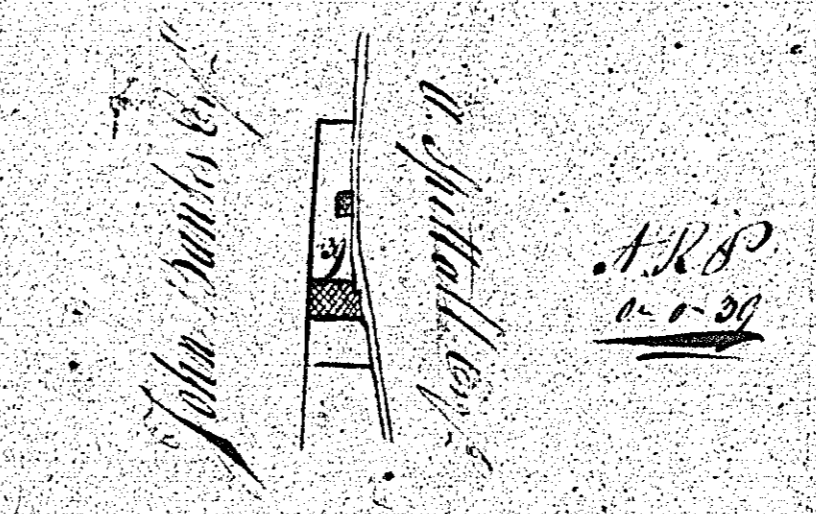

Plan of House & Garden  
in the Parish of Enchan  
158.



Three Chains to the Well  
Joseph Blake Surveyor

in Town

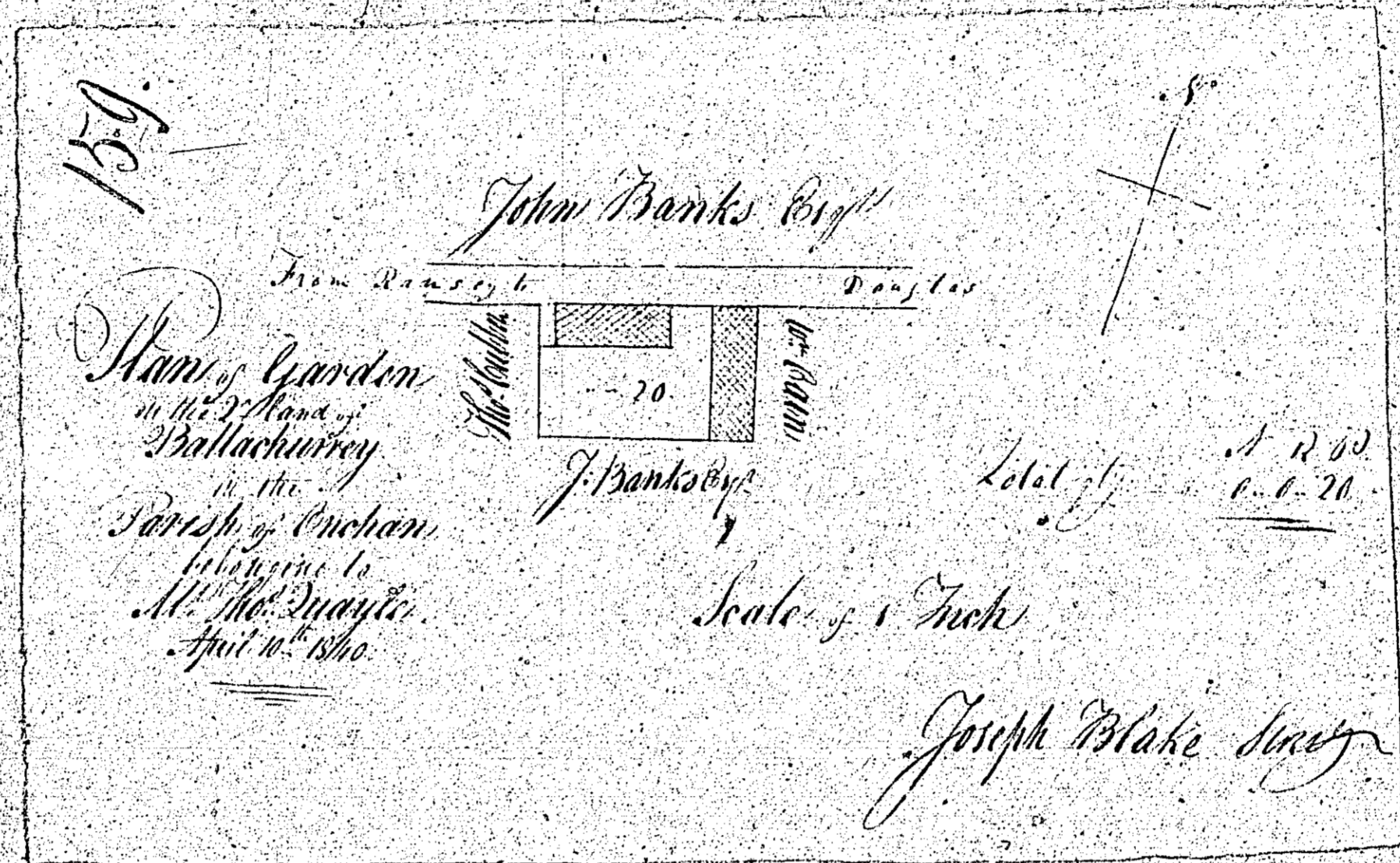

ISLE OF MAN GOVERNMENT: GENERAL REGISTRY

TITHE PLANS: PARISH OF ONCHAN

Original monotone

1:30

162

PLAN

160.

PLAN  
 of a Plot of Ground adjoining  
 FINCH ROAD, DOUGLAS  
 Parish of Onchan  
 the Property of  
 WILLIAM QUIGGIN  
 and  
 ROBERT QUIGGIN.  
 1840

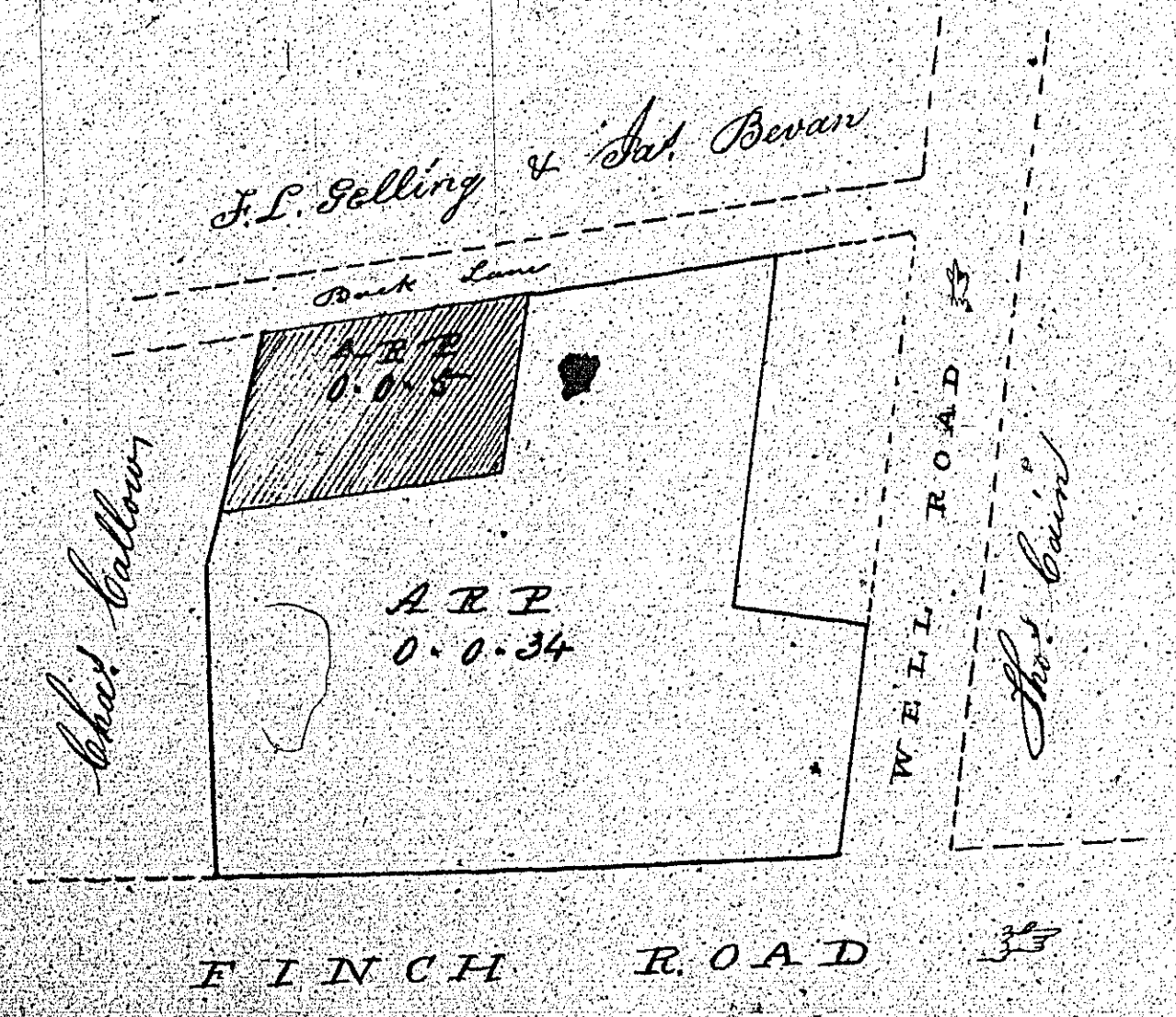

Scale 2 Inches to 1 Chain

Total 39 Perches

John Goldsmith  
Surveyor

A.P.P.  
0.0.28

A.P.P.  
0.0.29

to Ramsey

A.P.P.  
0.0.32

P.  
20

P.  
20

P.  
20

P.  
20

P.  
32

From Douglas

Scale 2 Inches to 1 Chain

John Goldsmith  
Surveyor

161

PLAN

162

PLAN  
 of a Plot of Ground adjoining  
 FINCH ROAD, DOUGLAS  
 Parish of Onchan  
 the property of  
 WILLIAM QUIGGIN and ROBERT QUIGGIN.  
 1840.

Philip Selley

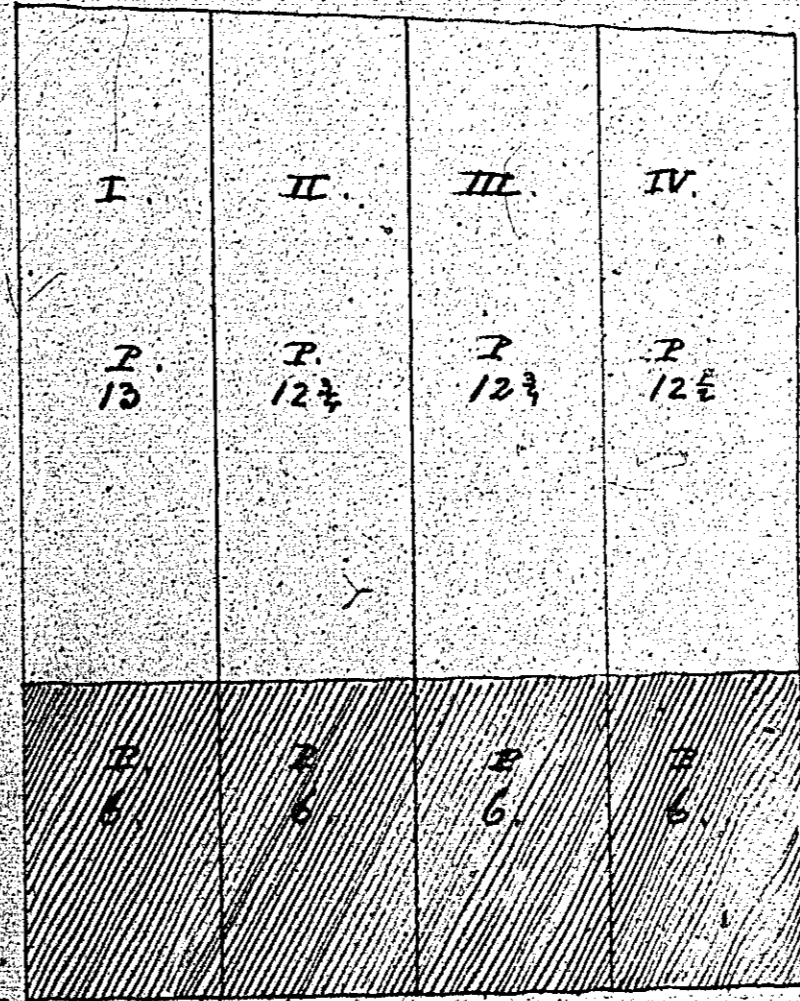

Serge ballin

Late Mr Chambers

FINCH ROAD

A. R. P.  
0.0.28

A. R. P.  
0.0.29

R. P.  
0.32

R. P.  
0.20

R. P.  
0.20

R. P.  
0.20

R. P.  
0.32

To Ramsey

From Douglas

REFERENCE

No	Contains	A. R.	P.
I		1	19
II		18	1/2
III		18	1/2
IV		18	1/2
Total		1	55

Scale 2 in. to 1 chain

John Goldsmith  
Surveyor

Scale 2 in. to 1 chain

John Goldsmith  
Surveyor

1840

PLAN

Seven Lots of Ground, on  
Castle Mona Lawn  
Parish of Onchan  
The names of the Proprietors  
Marked on their respective  
Lots from No. I. to VII.

182.

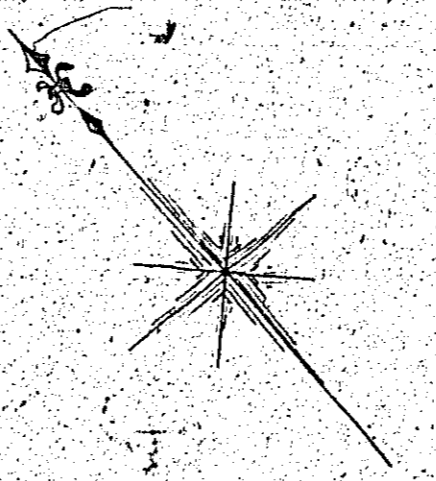

1840

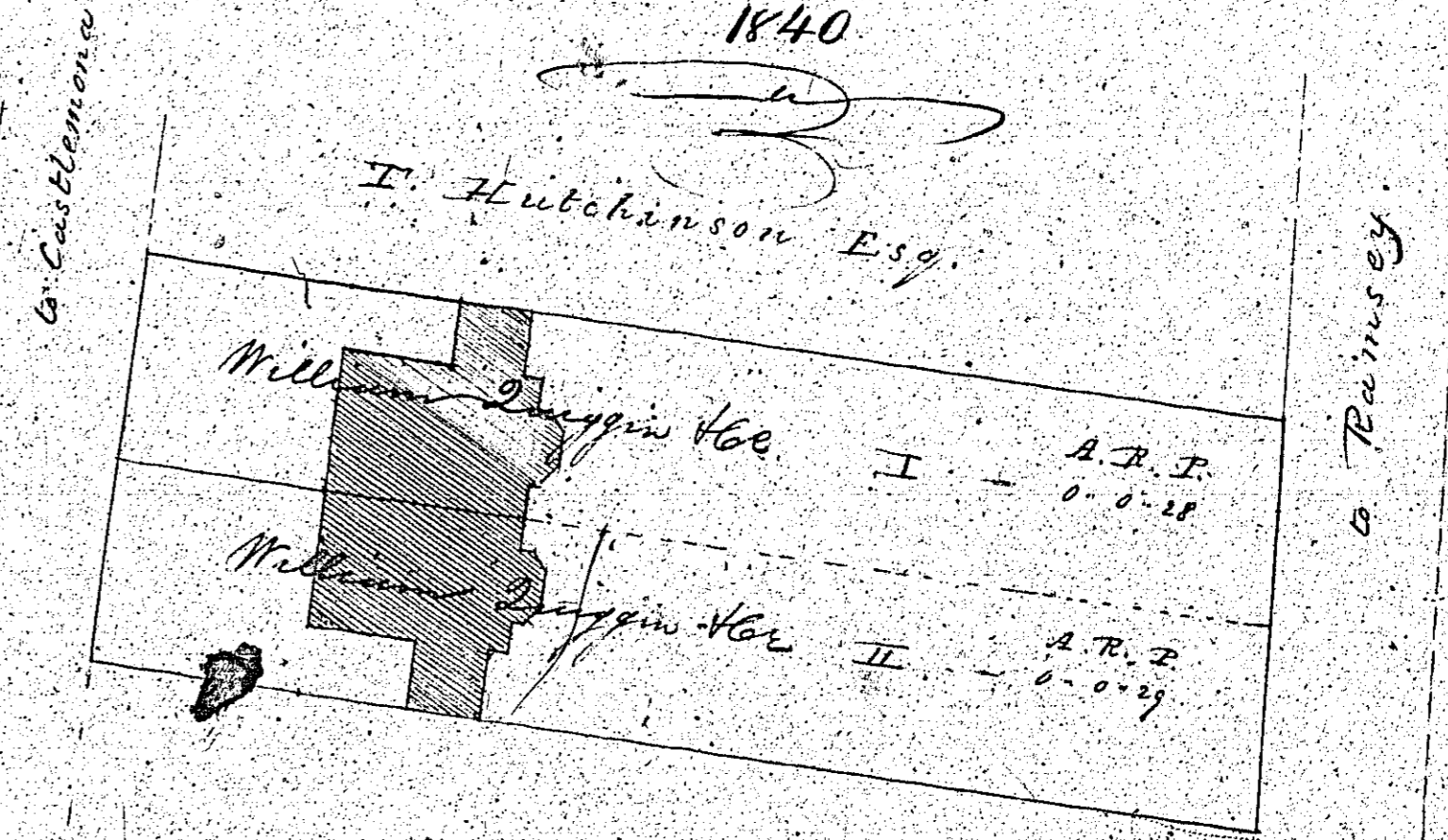

P. C. Wood Esq.

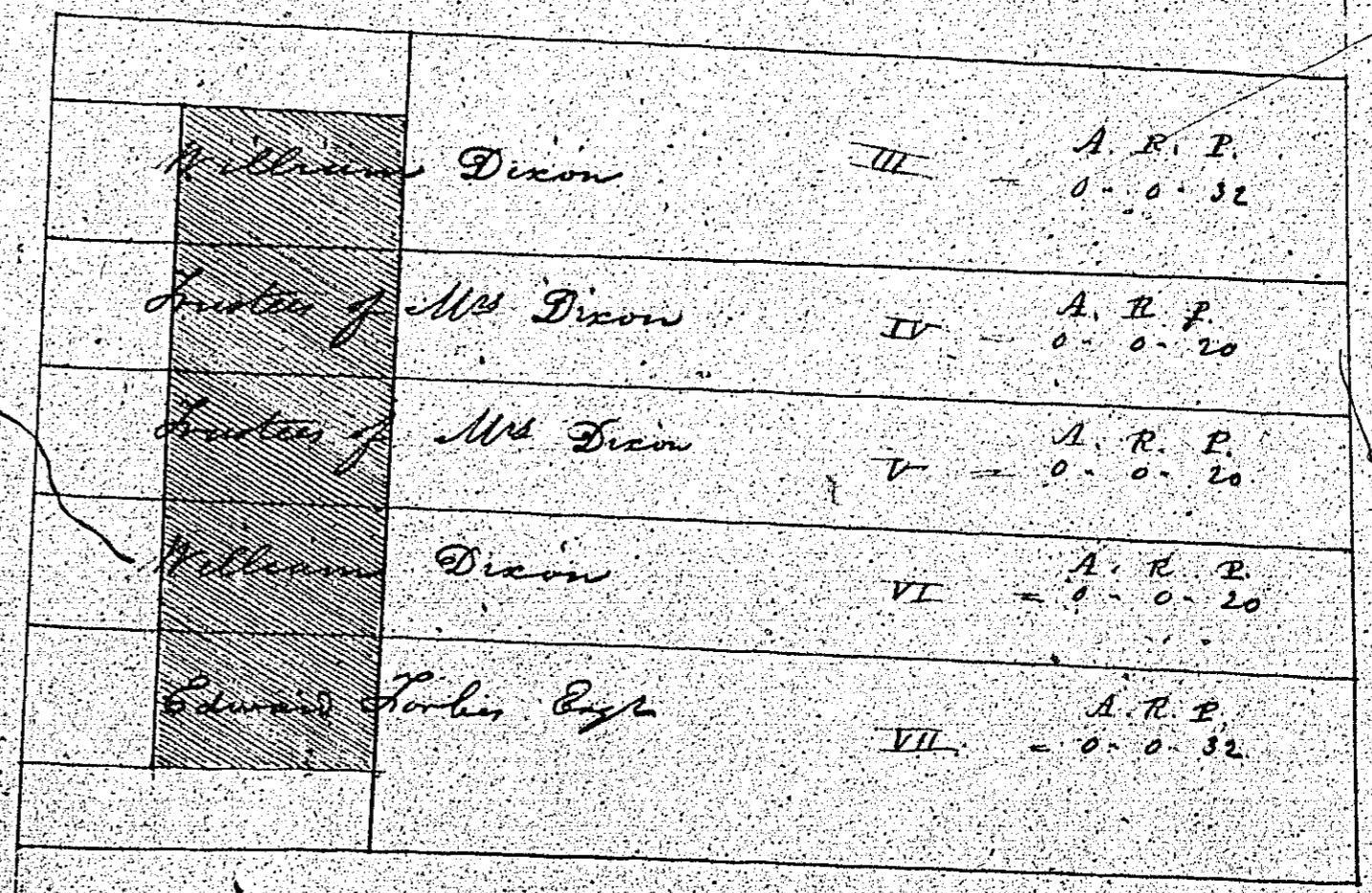

Scale 2 inches to 1 Chain

John Goldsmith  
Surveyor