

Handwritten text, possibly a name or title, located in the upper right quadrant of the left page.

Notice

*Ground plan of House, garden &c
situate in the
Parish of Pincheon Gt.
belonging to
John White, Dec: 27th 1700
John Gillis & John Christian
John White, Dec: 27th 1700
John Gillis & John Christian*

Track Road (longer)

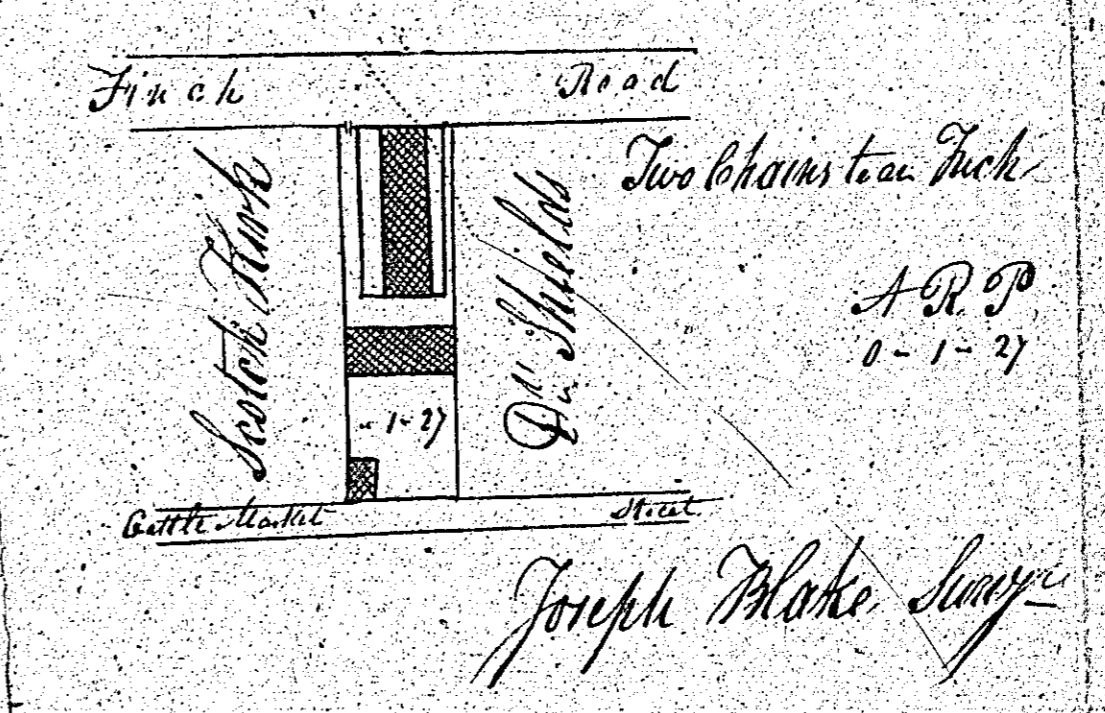

in witness

Mr. Kelly's Property

20 feet
Gallons
June 15

Mr. Lewis's Property

20 feet
Gallons
June 15

not used
95.

Mr. Andrews Property
20 feet 29 1/2

20 feet
Gallons
June 15

20 feet
Gallons
June 15

20 feet
Gallons
June 15

20 feet
Gallons
June 15

20 feet
Gallons
June 15

Grand in front

Mr. Kelly's Property

in house

Mr. Kelly Property

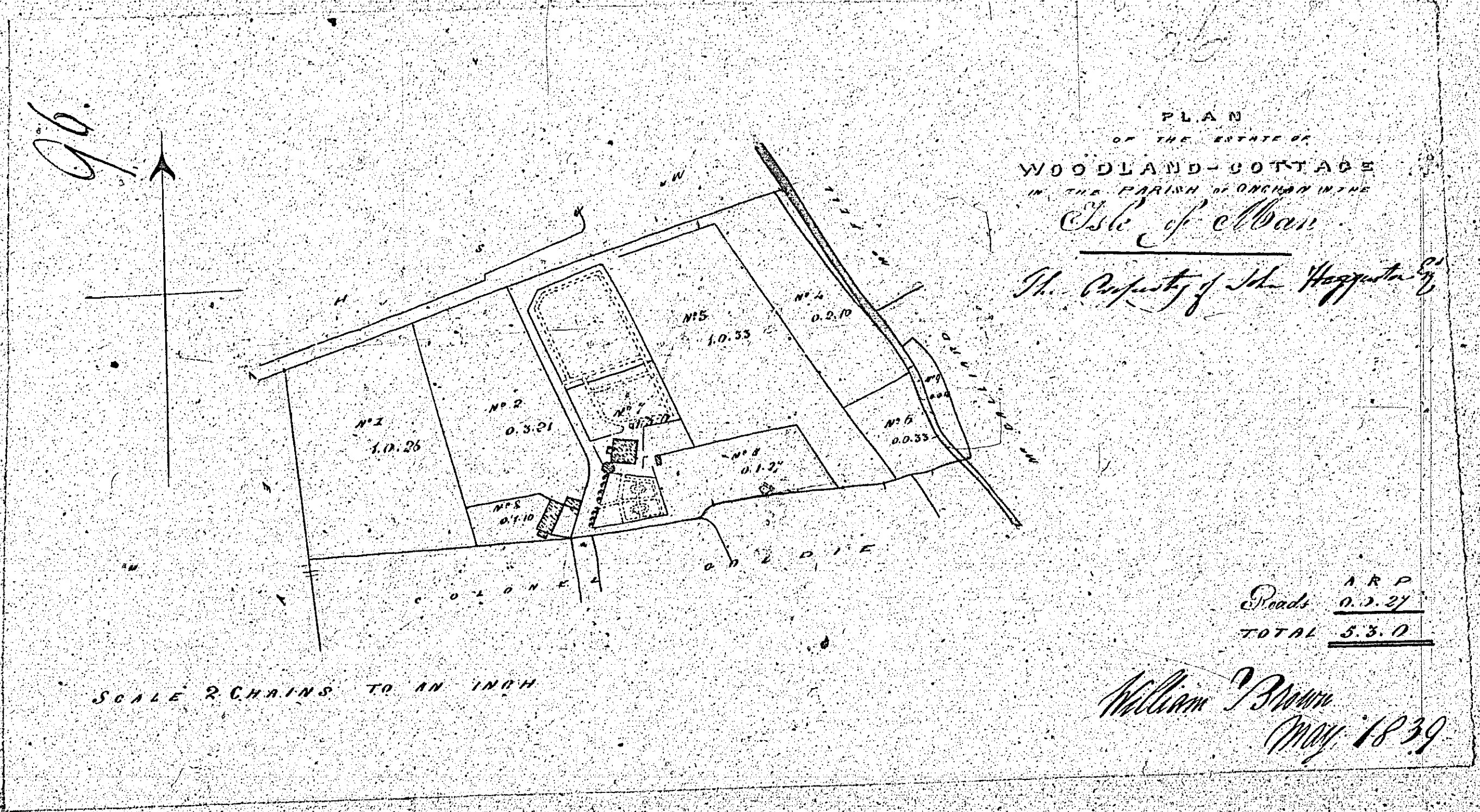

ISLE OF MAN GOVERNMENT: GENERAL REGISTRY

TITHE PLANS: PARISH OF ONCHAN

Original coloured

1:30



Plan

The Estate of
Bennahane

in the Parish of Onchan Isle of Man

the property of

Mrs Honor

John Joseph Heywood

Deemster

Total contents 139. 3. 42

Scale 2 Chains to an Inch

*Note: The Part colored blue formerly Part of
 Gammaghney Land & tithes*

Plan

of the Estate of Demahogue

in the Parish of Onchan Isle of Man

the property of

Mrs Honor

John Joseph Keywood

Deemster

Total Contents 139. 2. 1/2

(Scale 2 Chains to an Inch)

N.B. The Part colored Red formerly Part of
Generalship & not allotted



Copied from a Plan & Survey
made and taken by me in 1834
By A. W. Coakley
Deemster 1840

W. M. D. [unclear]

W. M. D. [unclear]

98

98

PLAN
of
LAND
The property of
JAMES HOLMES ESQ
situate in the Parish of
O'NECHAN
1810

CONTENTS

1	4.2.10
2	2.1.2
3	5.0.0
Total	12.3.12

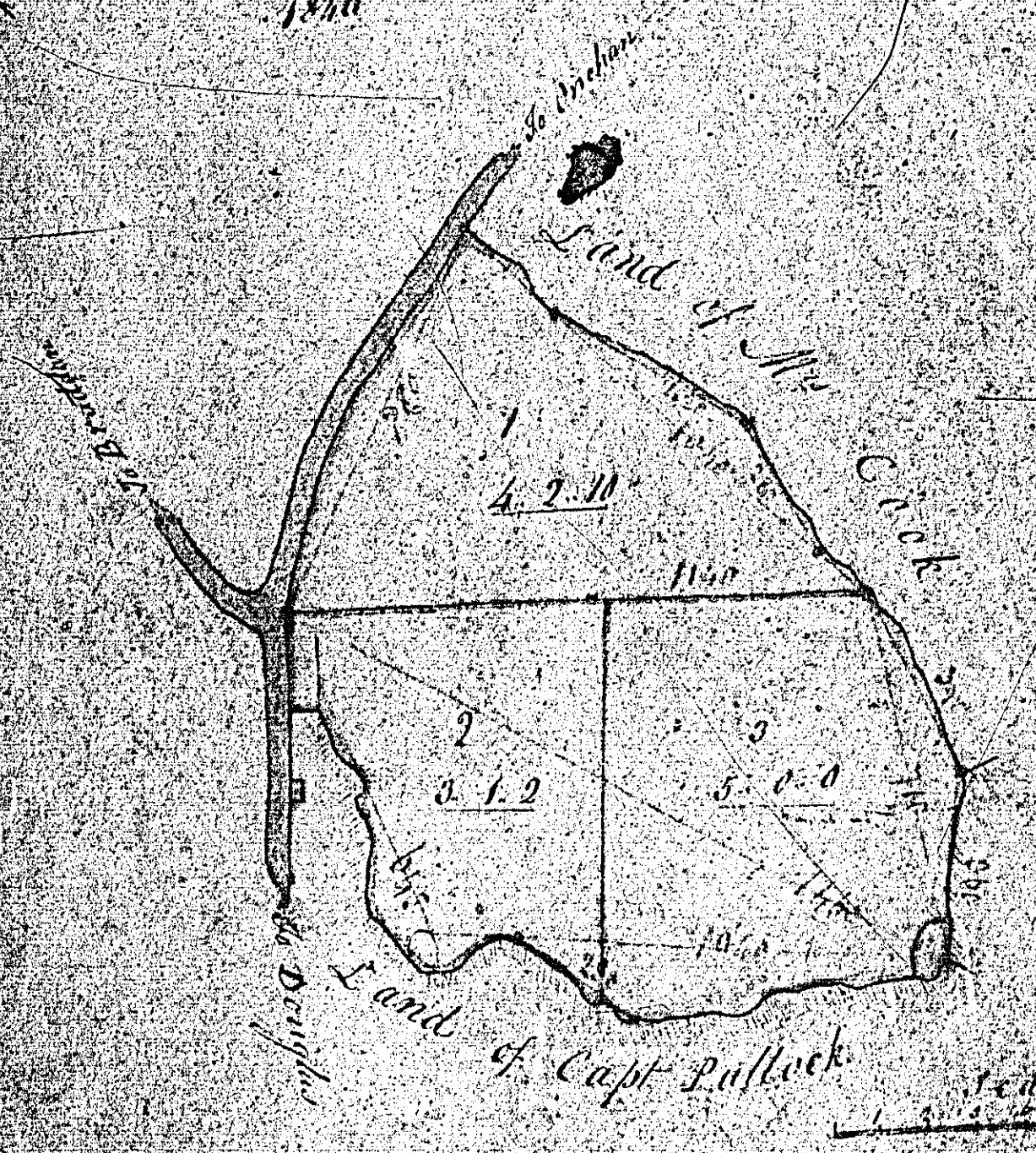

W. M. D. [unclear]