

159

A  
 PLAN OF  
 SUCHLANDS  
 THE PROPERTY OF  
 M<sup>r</sup> P. QUIGG  
 J. K. MICHAEL  
 by Robert Kelly  
 1838

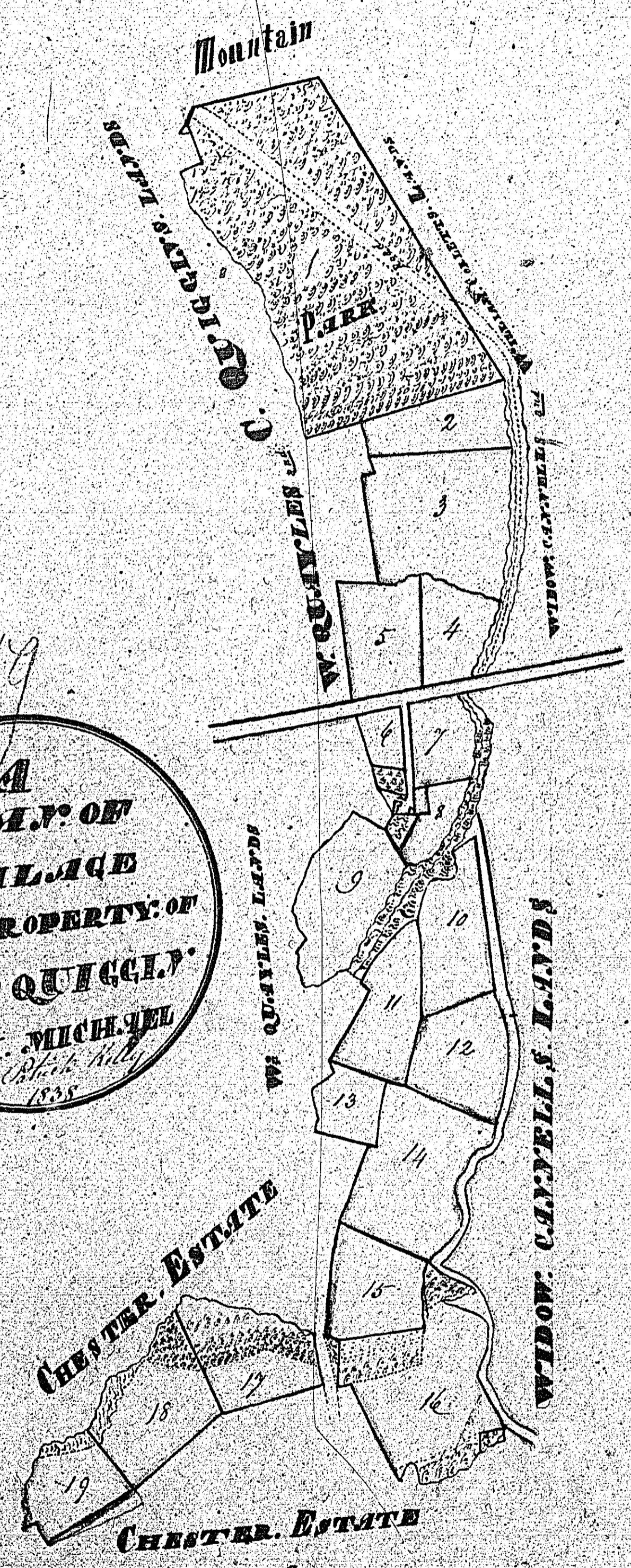

REFERENCE

No.	A	R	P
1	15	3	11
2	2	0	10
3	4	3	38
4	1	3	25
5	2	1	36
6	0	2	16
7	1	0	32
8	0	3	17
9	3	0	24
10	2	2	8
11	2	1	8
12	2	1	33
13	1	1	6
14	4	2	12
15	2	1	31
16	4	0	1
17	0	3	28
18	2	1	6
19	1	3	5
<hr/>			
Waste Lands	15	1	33
Waste Lands	0	2	20
Waste	2	3	16
Waste	16	0	0

160

A Plan and Survey of  
 Intack Land in the parish  
 of Michael the property of  
 Mr. Charles Quinn  
 By P. Kelly 160.  
 1839

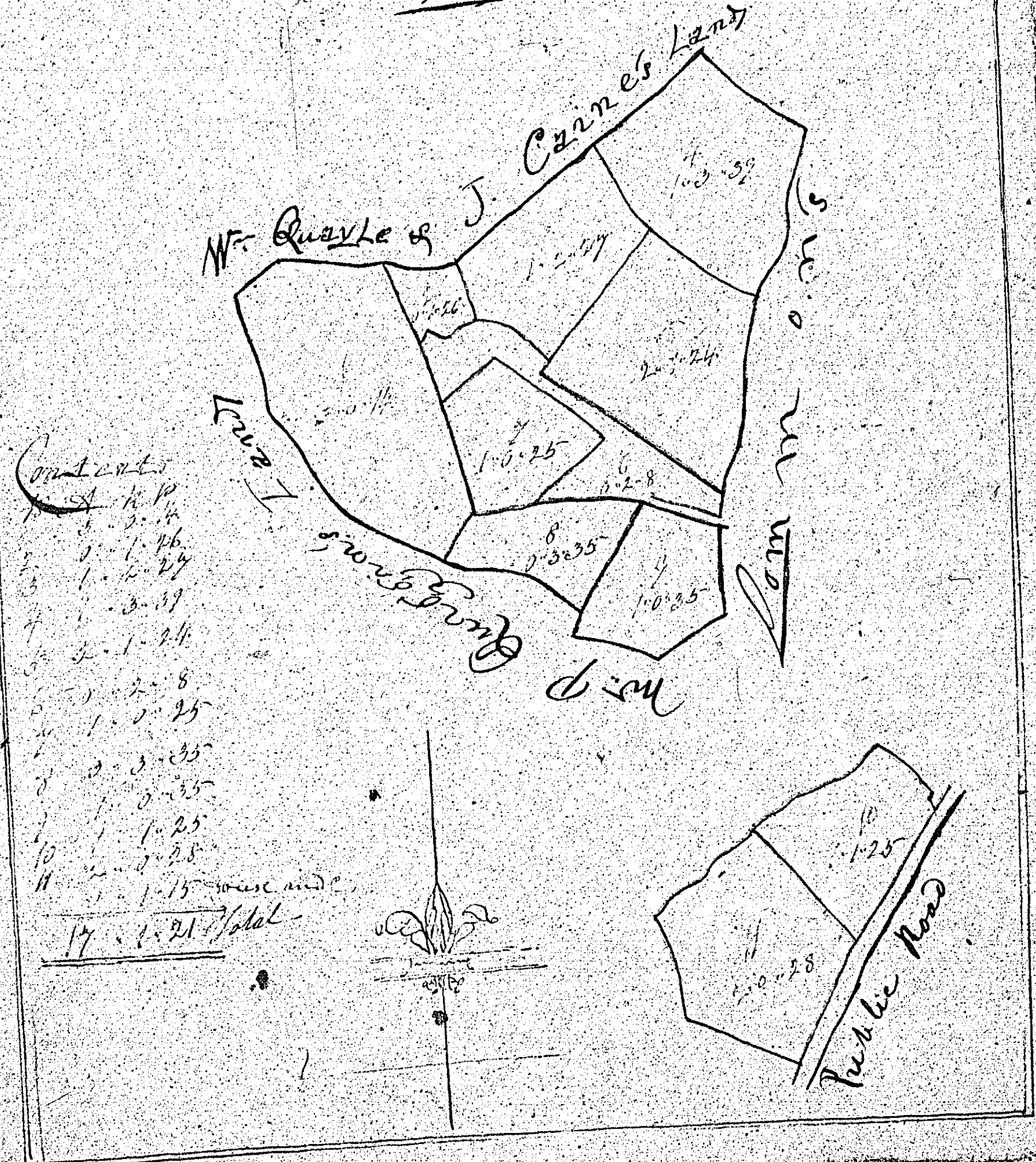

Referance	No.	Acres	Perches
1	0	30	
2	1	13	
3	1	20	
4	1	22	
5	1	24	
6	1	7	
7	3	7	
8	2	12	
9	2	25	
10	4	26	
11	3	8	
12	3	11	
13	3	29	
14	4	11	
15	2	35	
16	5	6	
17	1	25	
Wings 80	1	22	
Wings 80	0	38	
River	0	5	
Total Cont 451	1	29	

A Plan of Survey of Part of  
 the Quarter of Balla-meanagh  
 in the Parish of ~~the~~ Michael the Property of  
 the Earl of Drogheda by Deeds of Sir John Michael  
 October 17<sup>th</sup> 1727

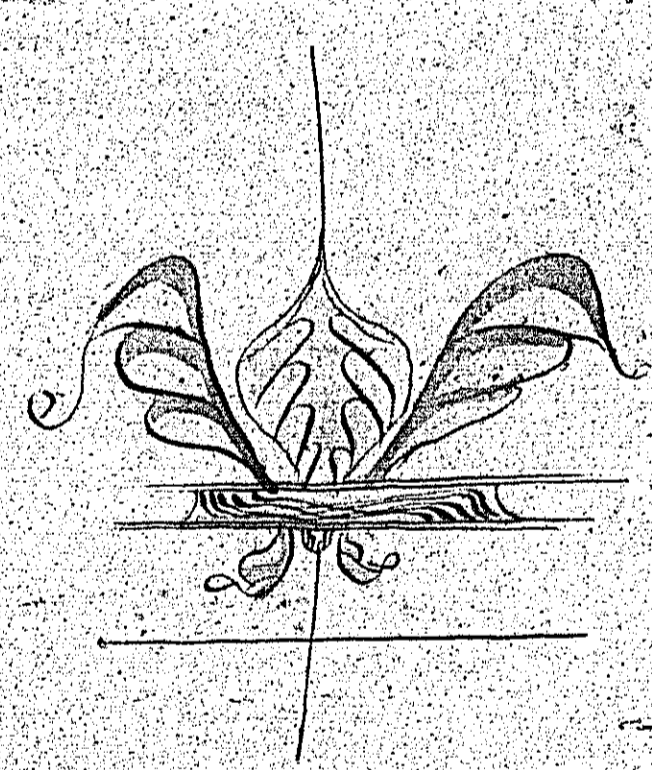

Scale Chain to an inch

Lands Belonging to Mr. Wm. Jones

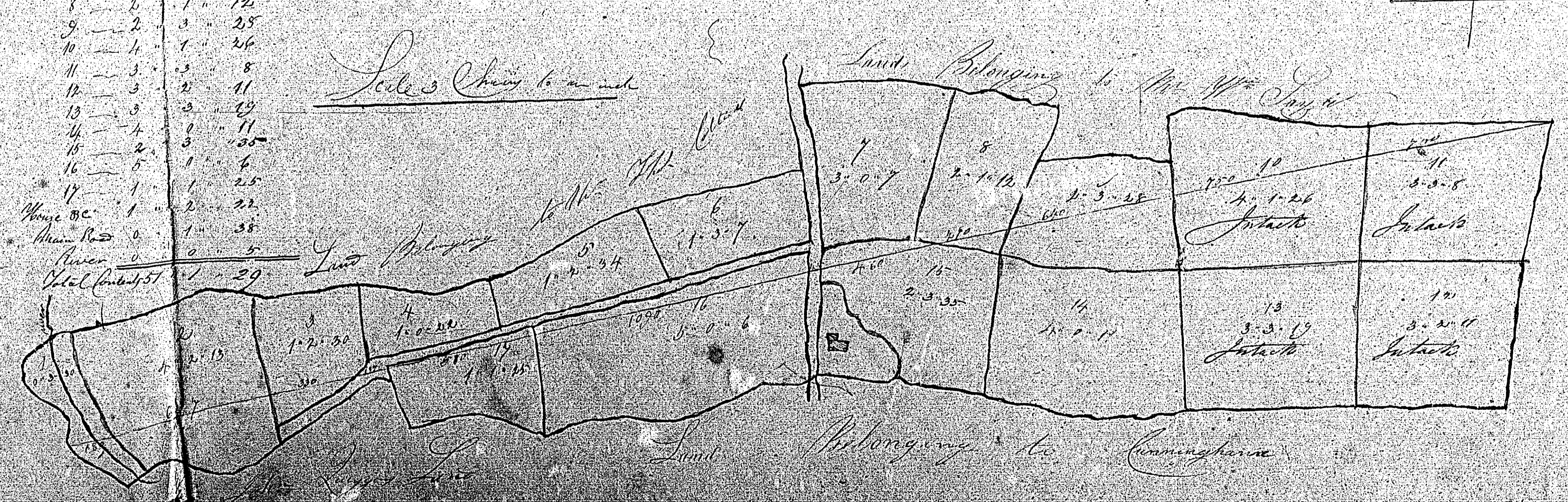

107

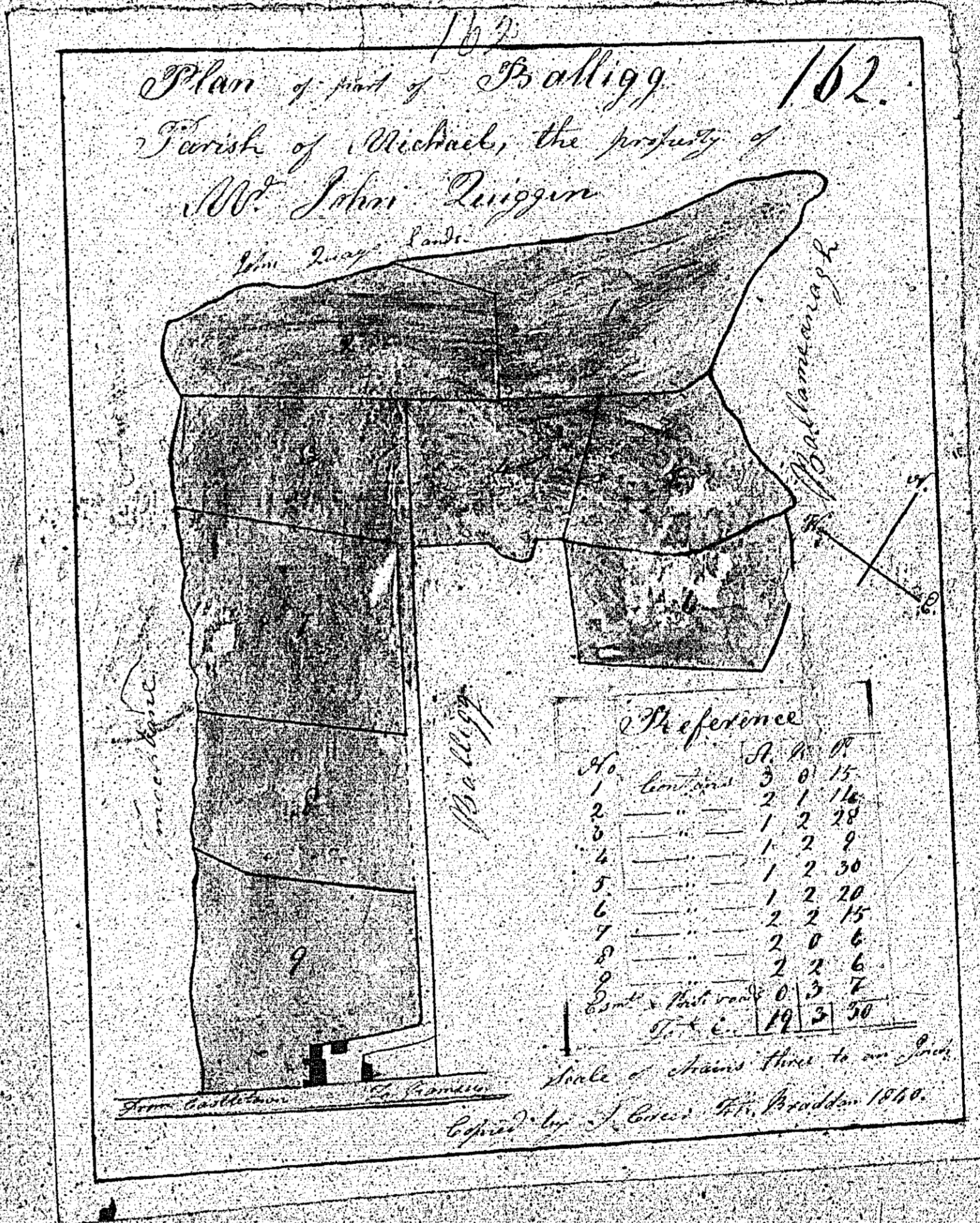

ISLE OF MAN GOVERNMENT: GENERAL REGISTRY  
TITHE PLANS: PARISH OF MICHAEL

163 Original monotone

164 Original coloured (decorative)

1.30

*Used as Saturday*

*163*

*A Plan and Survey of a Piece  
and Garden part of the Rectory  
at Bherrow in the Parish of  
Michael the Property of Mr John  
Suggin by Robert Kelly  
August 24<sup>th</sup> 1840*



*Count of Books  
Publ. No. 4  
Part II Books*

*Chart 2 Chain to an Inch*

*163*

*164*

*Not a plan*

*164*

*See the Survey of Part of the Rectory in the Parish of Michael  
and part of the Rectory of the same Parish  
by Robert Kelly, 1840*

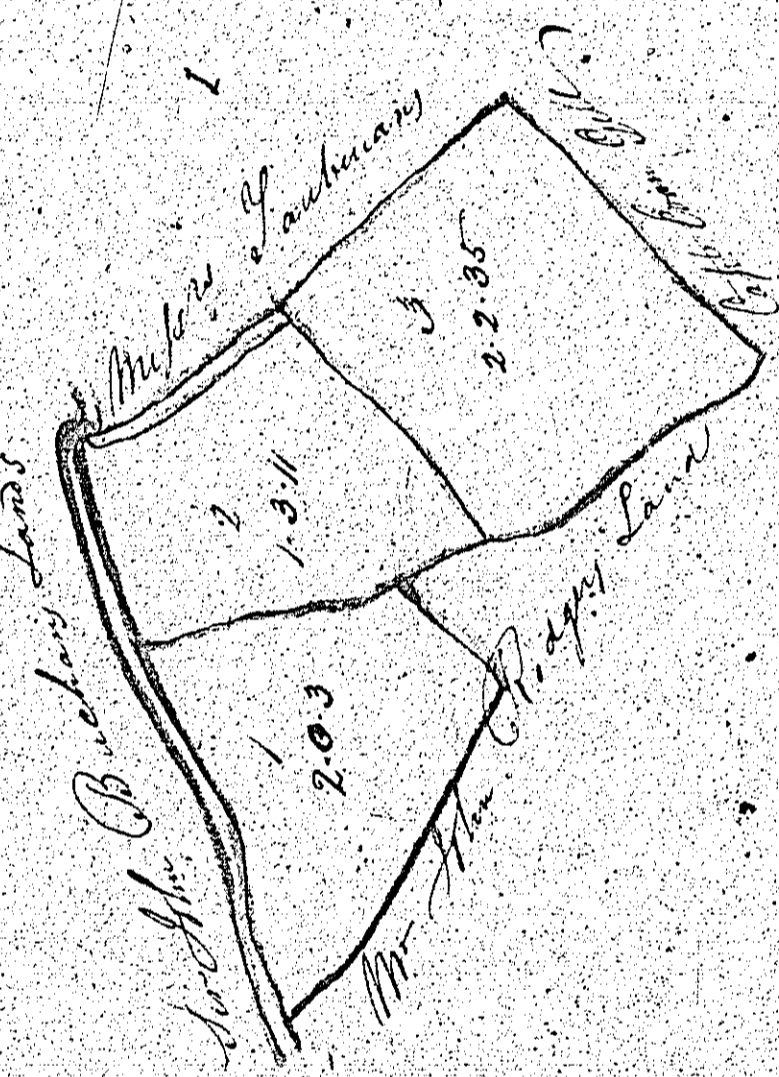

Conty	No	ACR
1	2	0.3
2	1	3.11
3	2	2.35
4	4	0.25
5	5	0.15
Total Area		9.30

*Scale 3 Chains to an Inch*

165-165  
A Plan of a House &c in  
Gardens in the Parish of St. Michael the  
property of Mr. James Ray by Peter  
Hely 1740  
VP  
Constantine Hely