

57.

*A Plan & Survey of Part of
 Scroggs in the Parish of Washel
 the Property of Mrs Anne Cabnet
 by P. Kelly & Michael
 August 17
 1850*

Content
AR 6
July 2-0-37
Nov 12 0-0-32
Feb 2-1-29

Scale is chains to a link

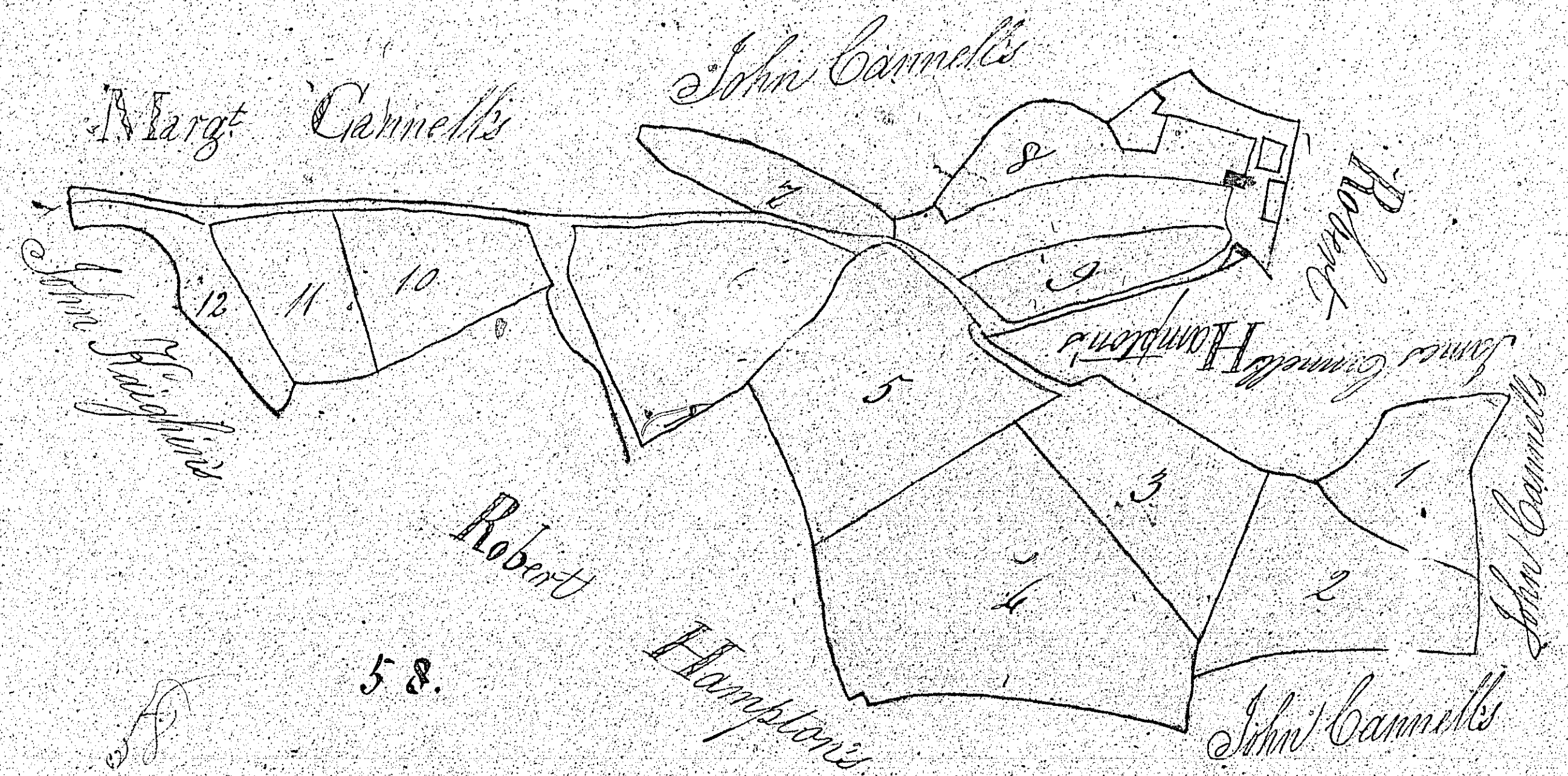
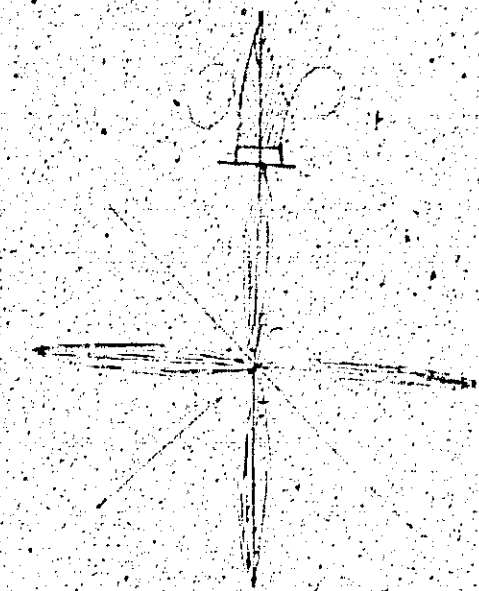

Contents

No	A.	R.	P.
1	1	2	25
2	2	1	34
3	2	0	7
4	4	0	24
5	3	1	22
6	2	3	25
7	1	2	34
8	1	1	15
9	5	3	32
10	1	2	0
11	1	1	7
12	1	2	25
13	0	0	0
	28	3	3
Half	1	1	30 Carnell's
	1	1	16 Brady's

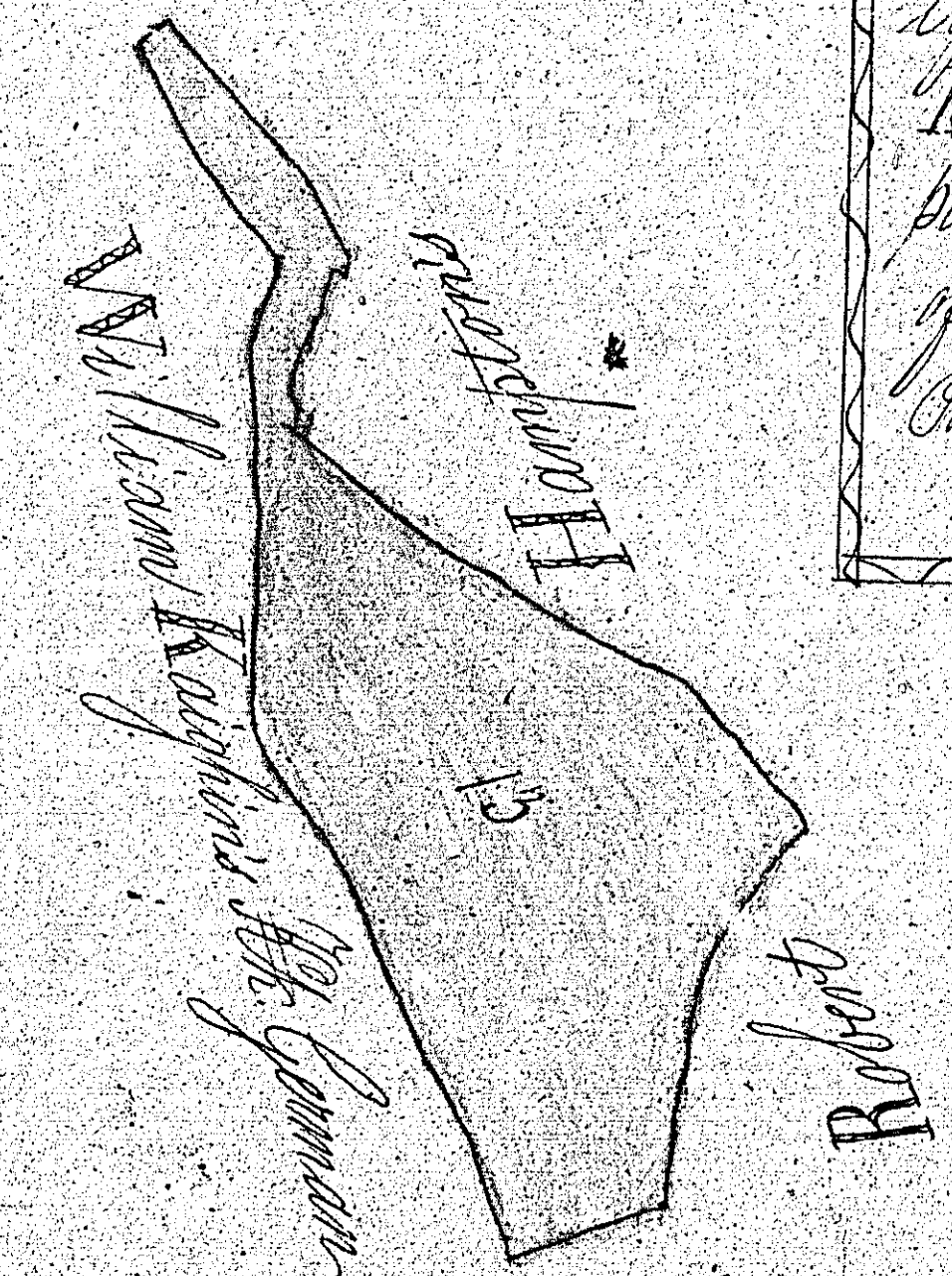

Plan of a small Estate
lying in the parish of
St Michael being
part of the quarter of
of Kilmaglass the
Property of Mrs
Carnell (Widow)

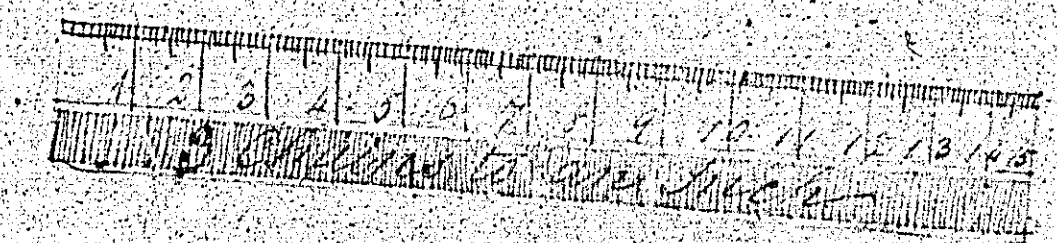

1837
Surveyed and drawn
by Robert Carnell
John's Master of
St John's Green

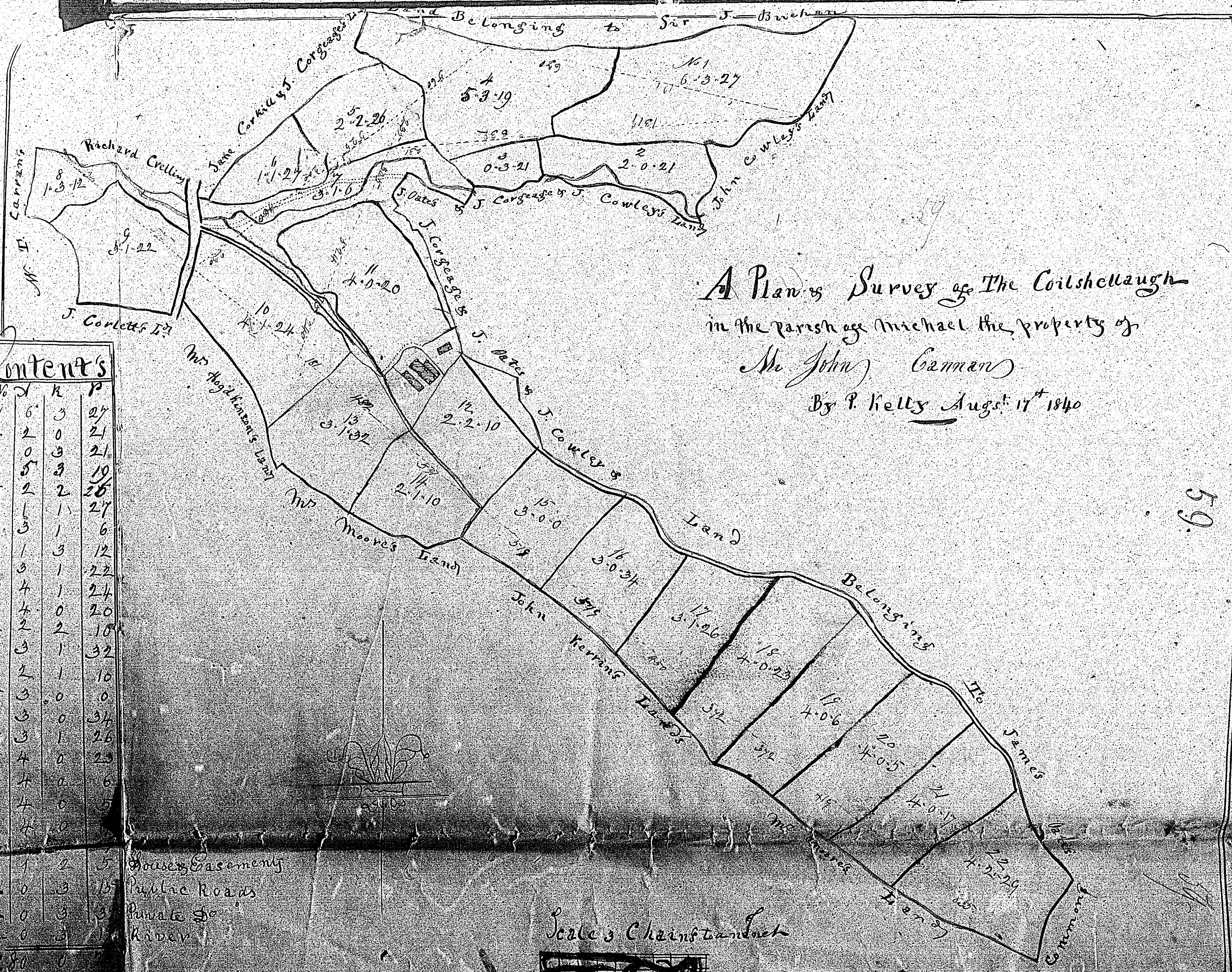

A Plan of Survey of The Coilshellaugh
 in the parish of Michael the property of
 Mr John Cannon
 By P. Kelly Aug: 17 1840

Contents

No	Ac	R	P
1	6	3	24
2	2	0	21
3	2	0	21
4	5	3	19
5	2	2	25
6	1	1	27
7	3	1	6
8	1	3	12
9	3	1	22
10	4	1	24
11	4	0	20
12	2	2	10
13	3	1	32
14	2	1	10
15	3	0	0
16	3	0	34
17	3	1	26
18	4	0	23
19	4	0	6
20	4	0	5
21	4	0	
22	1	2	5
23	0	3	15
24	0	3	3
25	0	3	1
Total	80		

Houses & Easements
 Public Roads
 Rivers &c
 River

Scale of Chain to an Inch

ISLE OF MAN GOVERNMENT: GENERAL REGISTRY
 TITHE PLANS: PARISH OF MICHAEL

- 60 Original coloured
- 61 Original monotone
- 62 Original coloured (decorative)

1.30

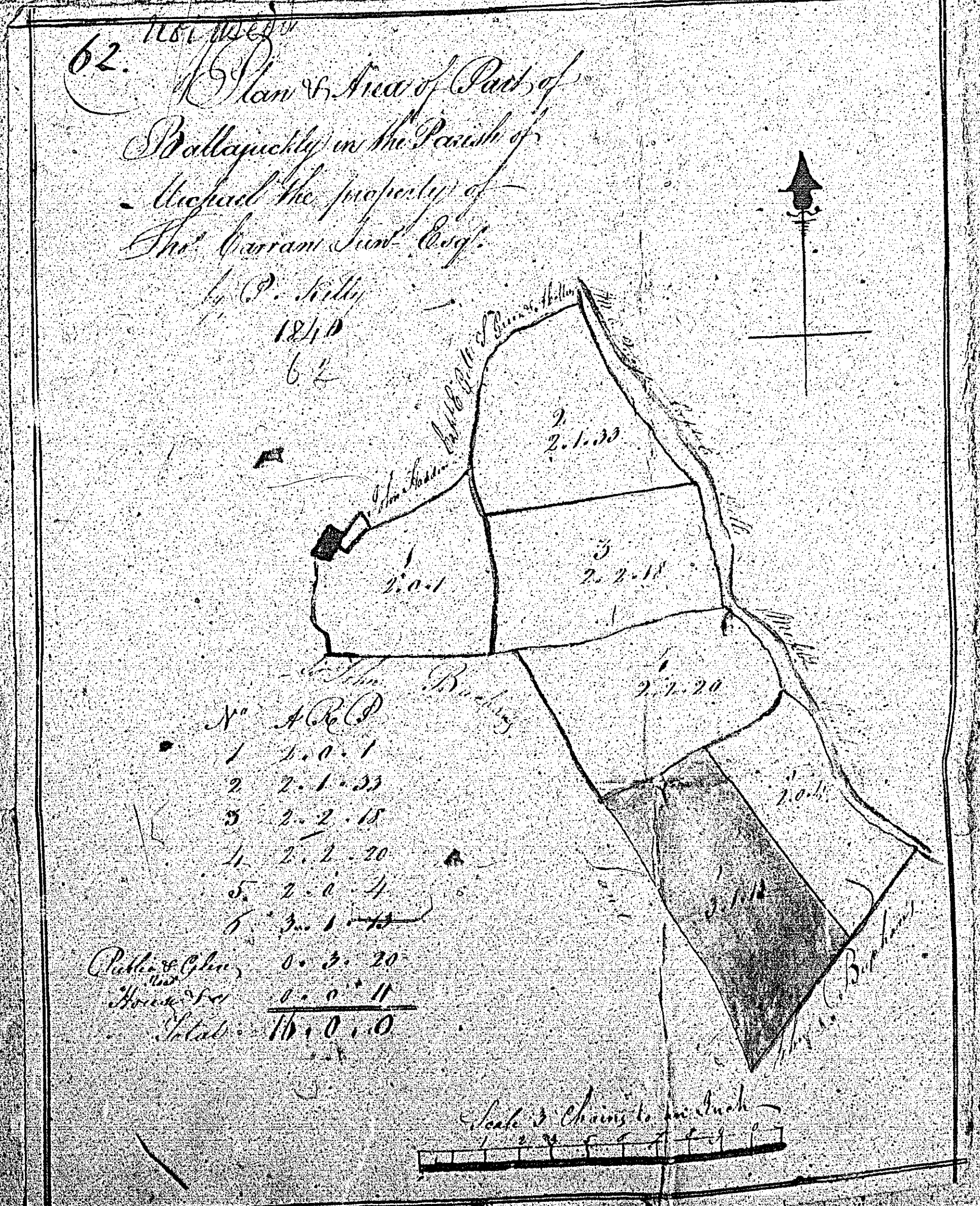
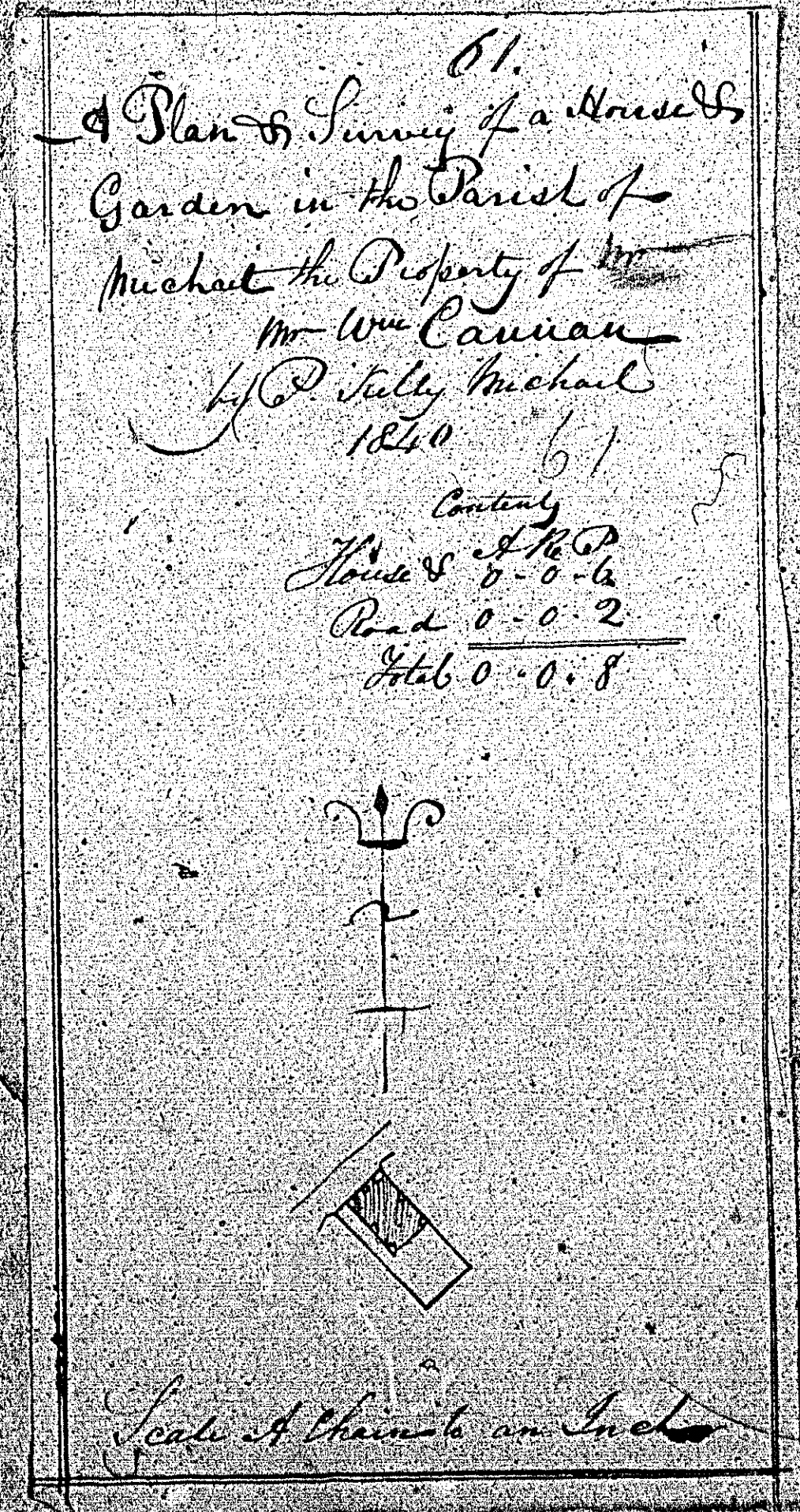
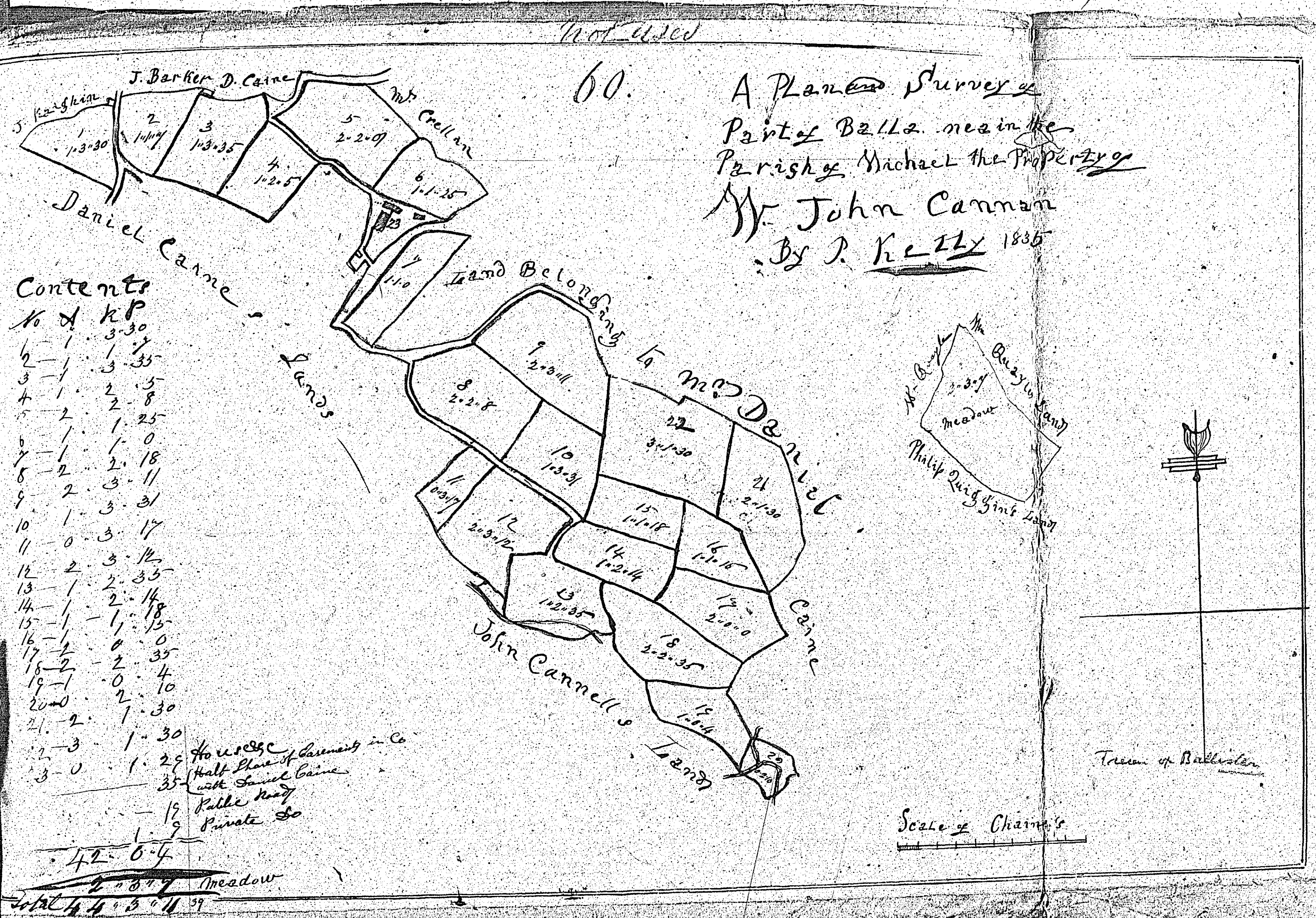

ISLE OF MAN GOVERNMENT: GENERAL REGISTRY
 TITHE PLANS: PARISH OF MICHAEL

- 63 Original coloured (decorative) 1.30
- 64 Original coloured (has the number 65 crossed out in pencil)
- [65] Original monotone (number in pencil only)
- 66 Original coloured (decorative)

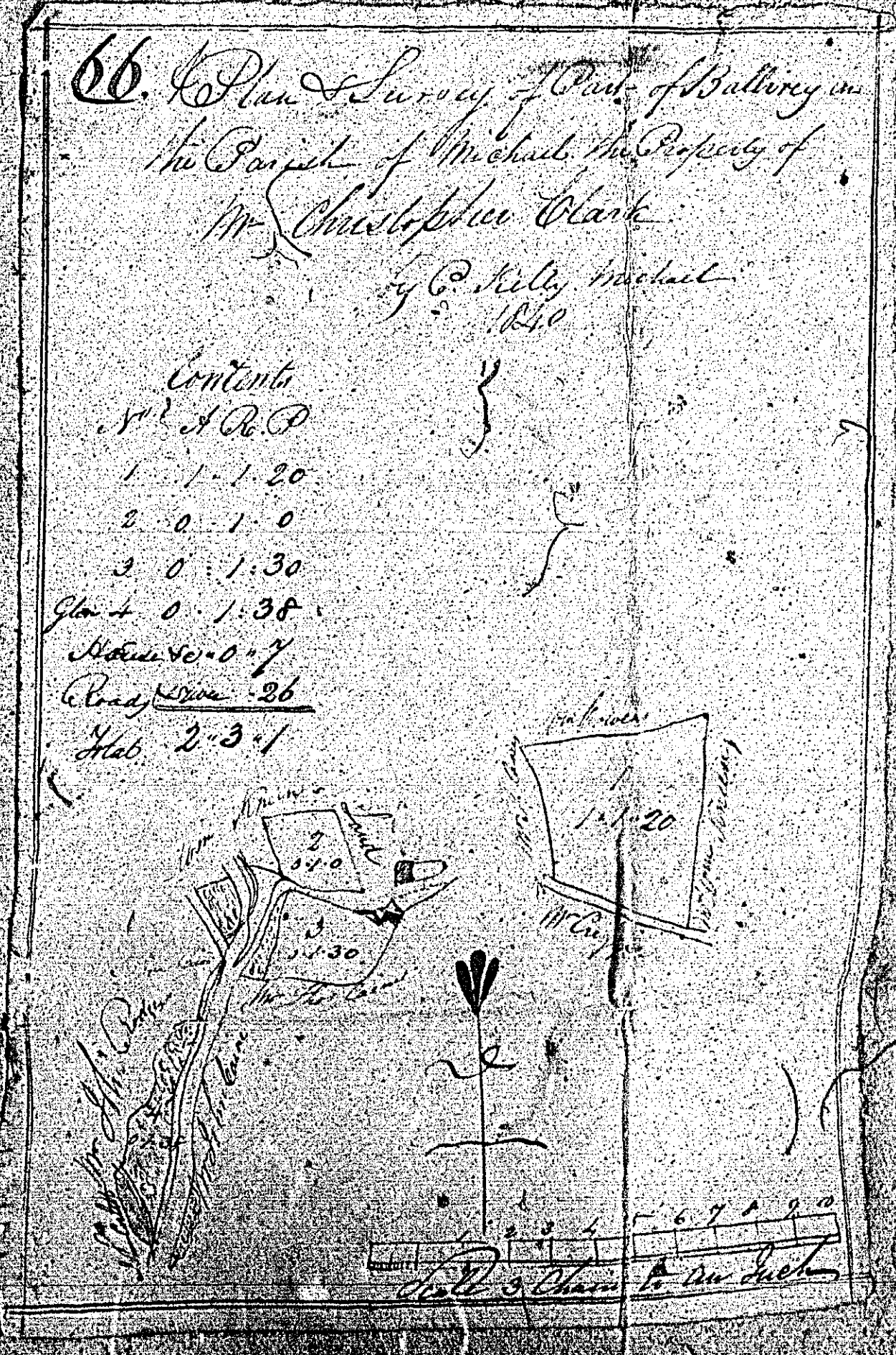
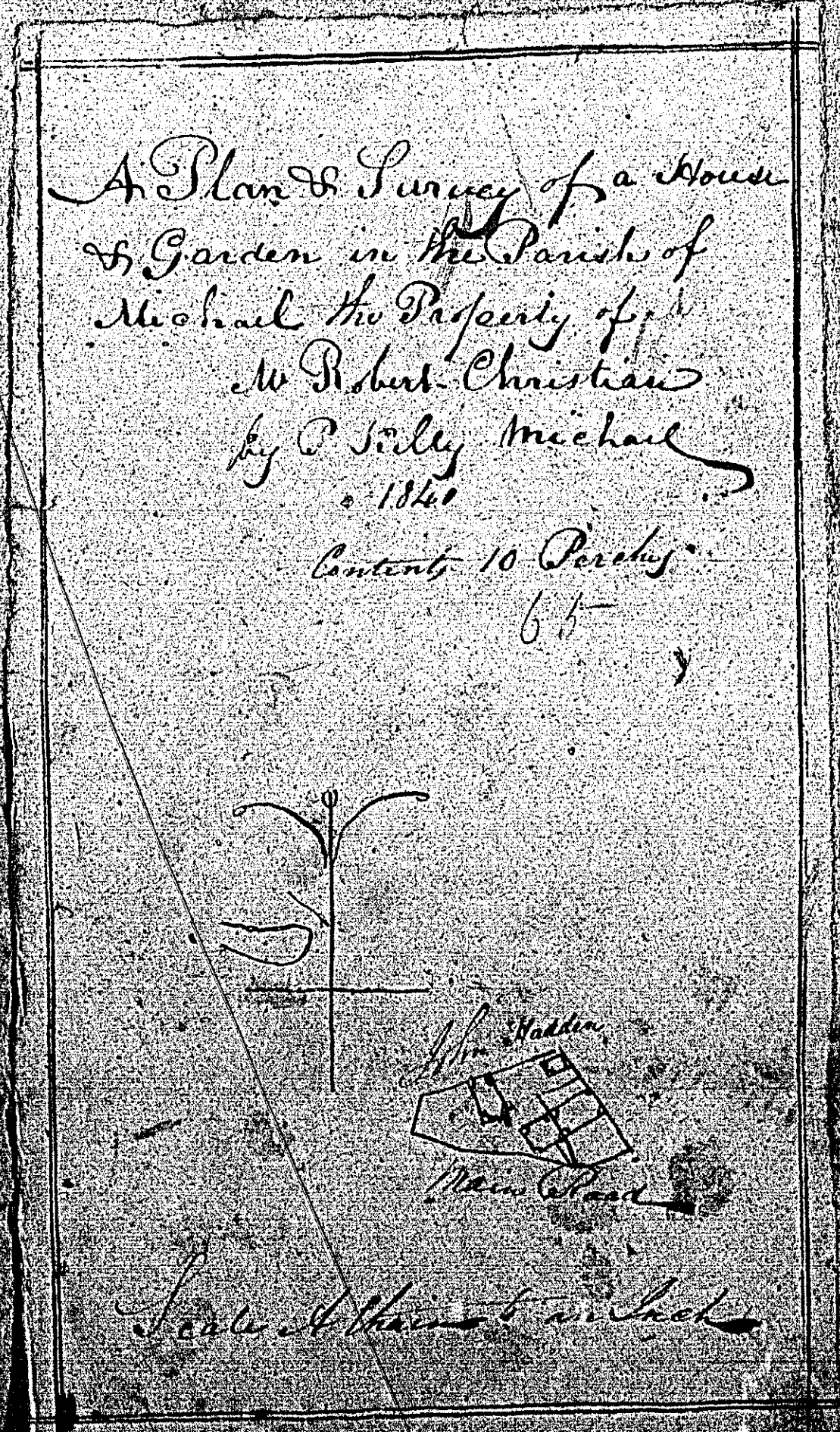
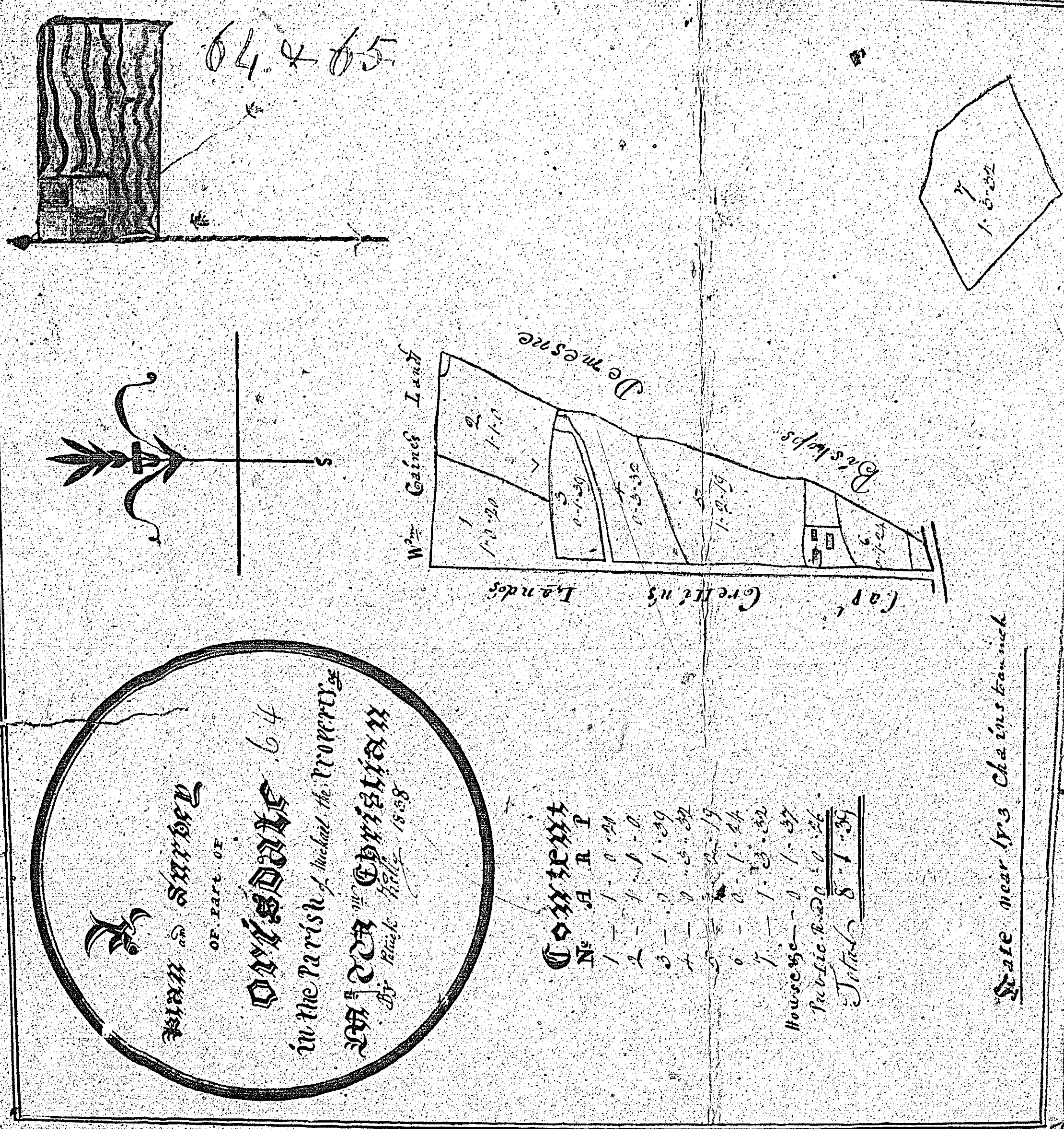
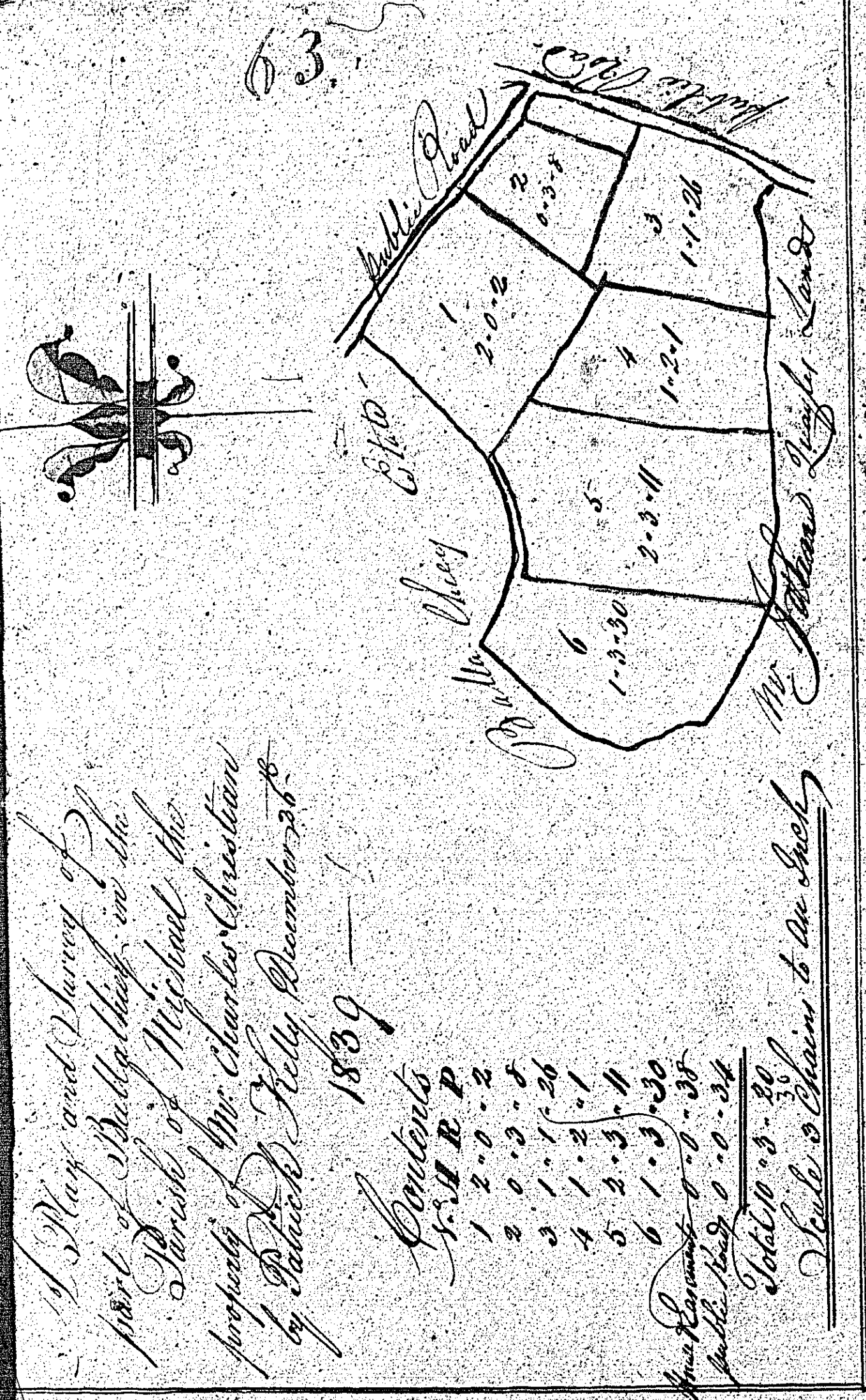

ISLE OF MAN GOVERNMENT: GENERAL REGISTRY.

TITHE PLANS: PARISH OF MICHAEL

1.30

- 67 Original coloured (decorative)
- 68 Original monotone
- 69 Original coloured (decorative)

67.

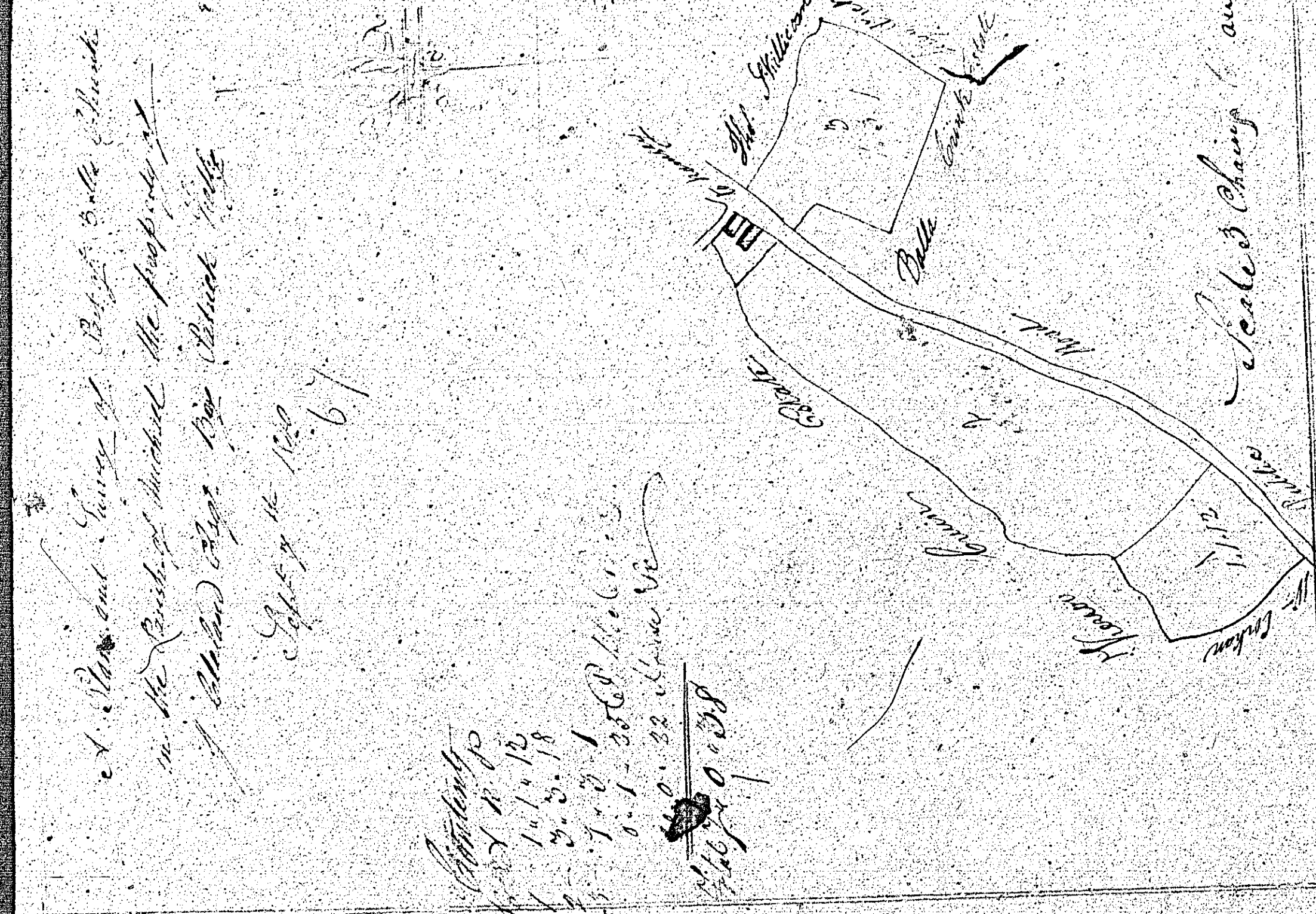

A Plan & Survey of a House & Garden in the Parish of Michael the Property of Mr. John Colette by P. Wally Michael Aug 17 1840

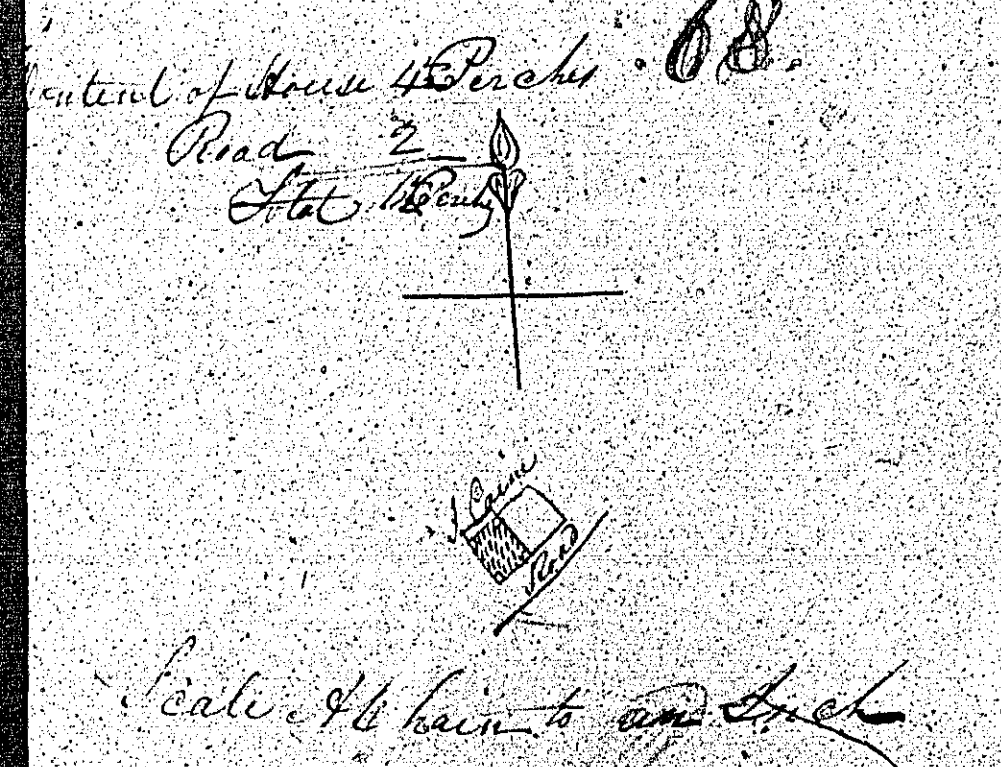

A Plan & Survey of a Piece of Land in the Parish of Michael the Property of Mr. John Colette by Patrick Wally July 12 1839

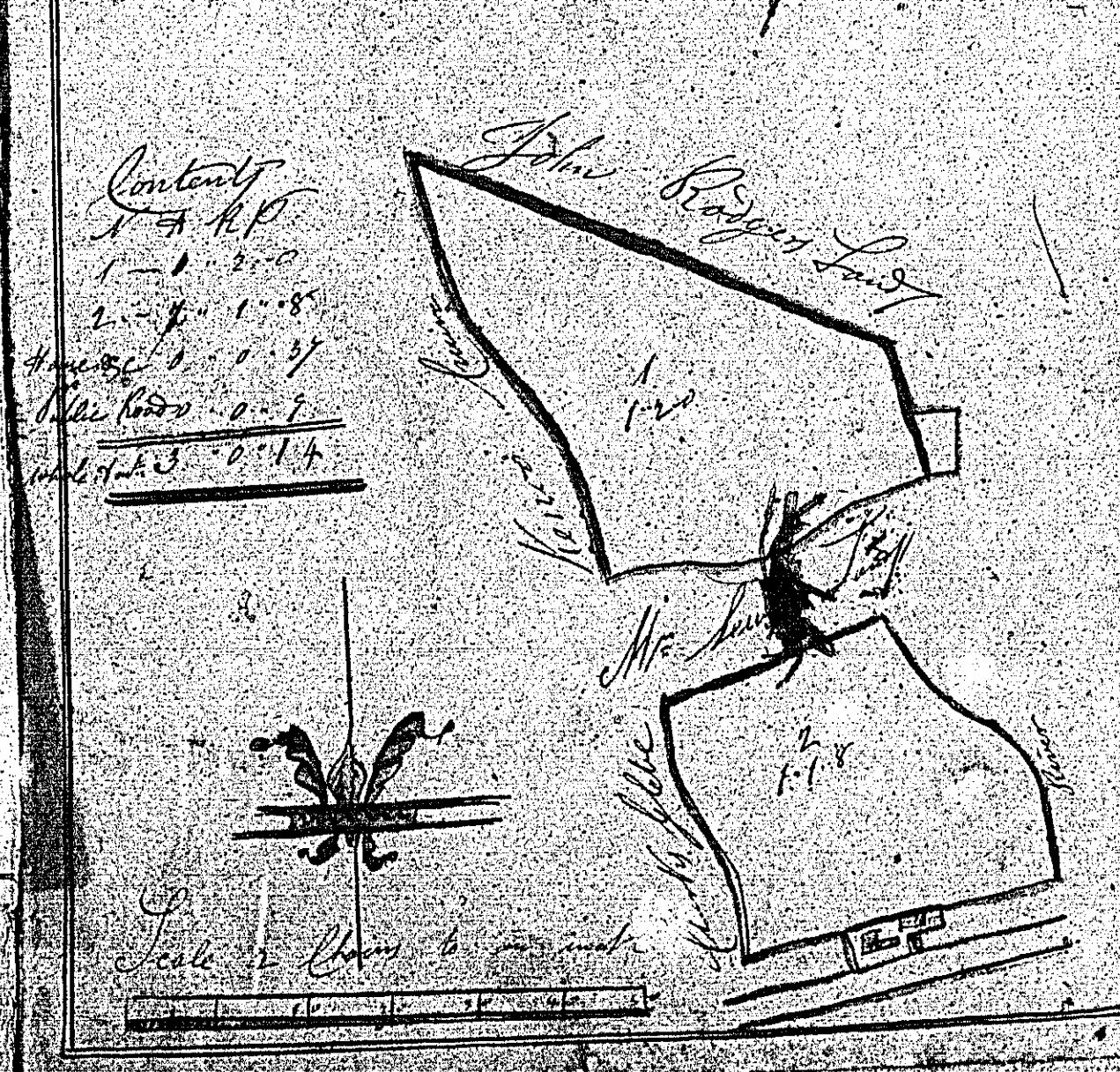

List to London