

Plan of
 Ballafageen in the
 Parish of Michael
 the
 property of Mr. John Carnall
 by Patrick Kelly 1838

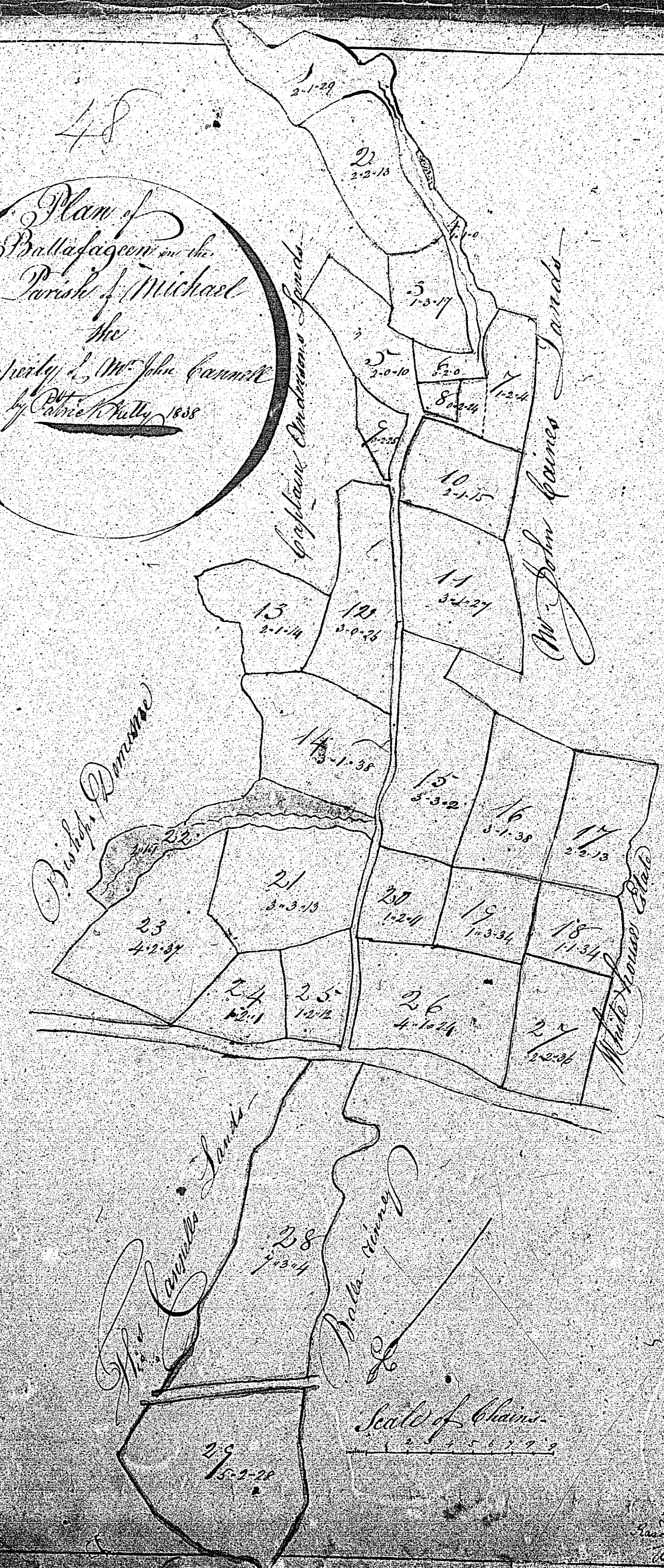

Reference

No.	Ac.	R.	sq
1	2	1	23
2	2	2	23
3	1	3	17
4	1	1	10
5	2	0	0
6	1	2	7
7	1	2	24
8	0	3	25
9	0	3	15
10	2	1	27
11	3	1	26
12	3	0	14
13	2	1	38
14	3	1	2
15	3	3	38
16	3	1	38
17	2	2	13
18	1	1	34
19	1	3	34
20	1	3	11
21	3	3	13
22	3	1	1
23	4	2	37
24	1	2	1
25	1	2	10
26	4	1	24
27	2	2	36
28	2	3	4
29	3	2	25
30	1	1	2
31	1	1	2
32	1	1	2
33	1	1	2
34	1	1	2
35	1	1	2
36	1	1	2
37	1	1	2
38	1	1	2
39	1	1	2
40	1	1	2

ISLE OF MAN GOVERNMENT: GENERAL REGISTRY
 TITHE PLANS: PARISH OF MICHAEL
 Original coloured 1:30

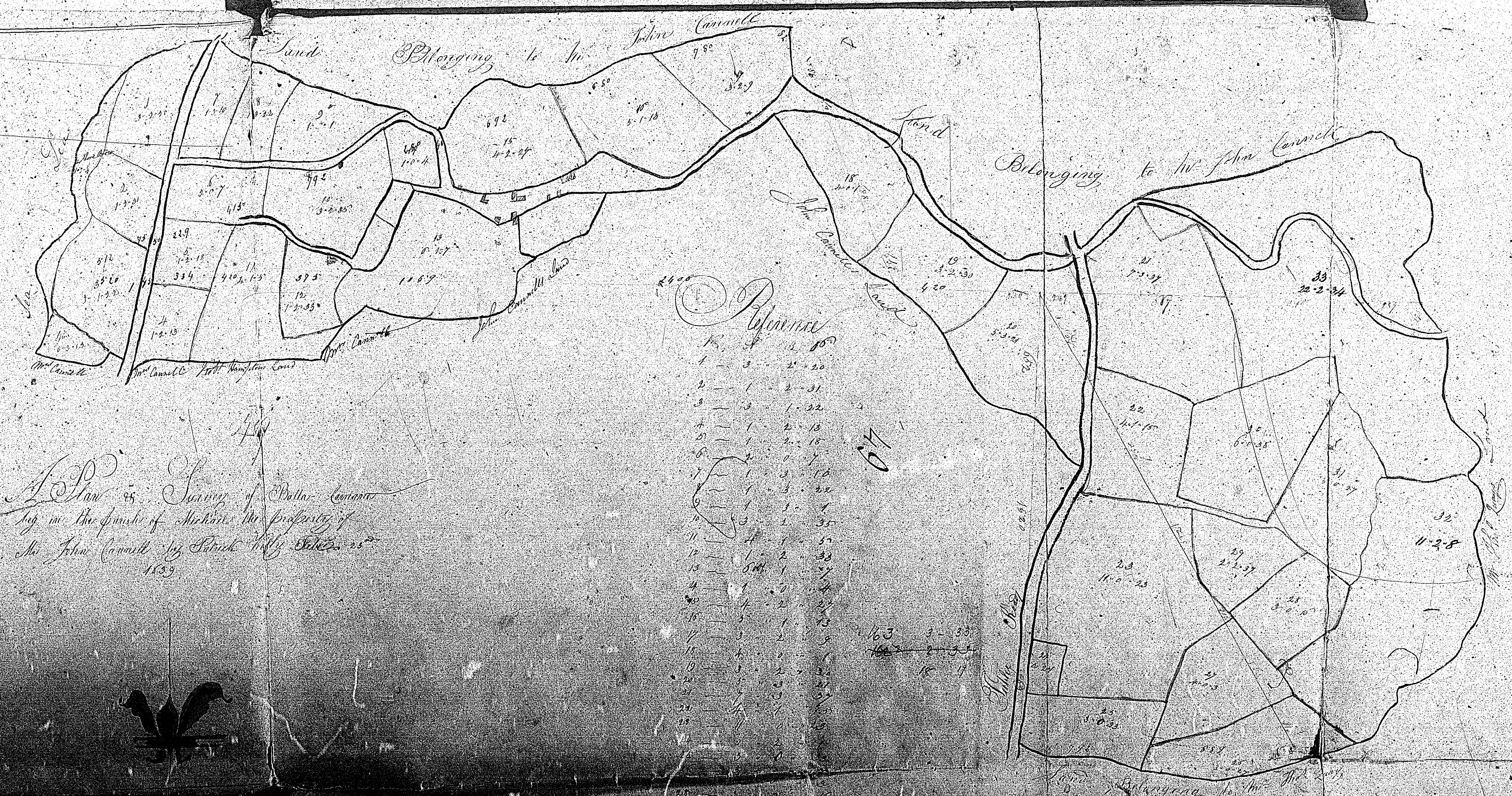

A.P. Survey of Michael, Isle of Man
 by Mr. John Carruth, Surveyor
 for the Parish of Michael, the Property of
 Mr. John Carruth, by Patrick Kelly, Esq.
 1839

ISLE OF MAN GOVERNMENT: GENERAL REGISTRY

TITHE PLANS: PARISH OF MICHAEL

- 50 Original coloured (decorative), faint 1.30
- 51 Original monotone
- 52 Original monotone

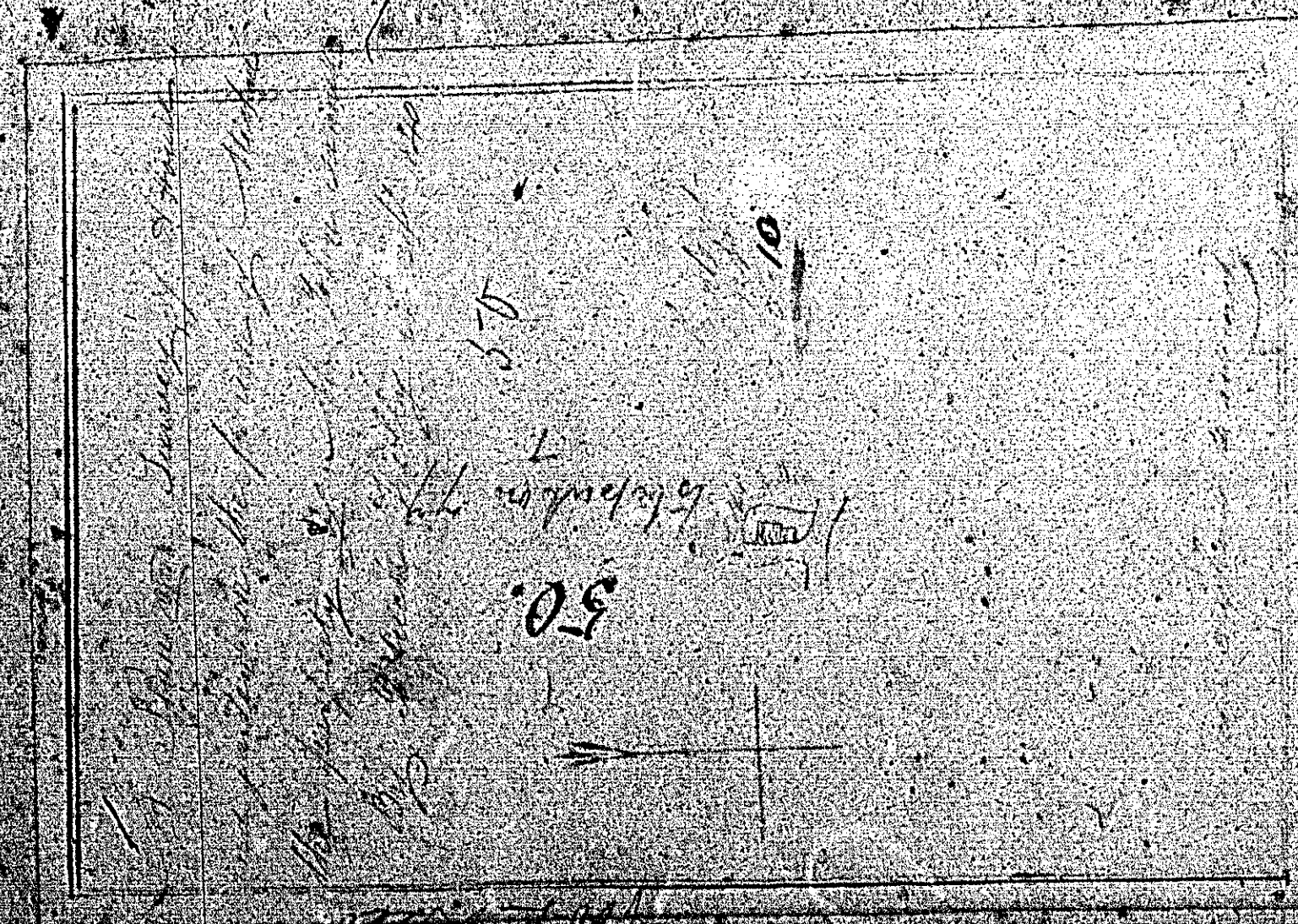
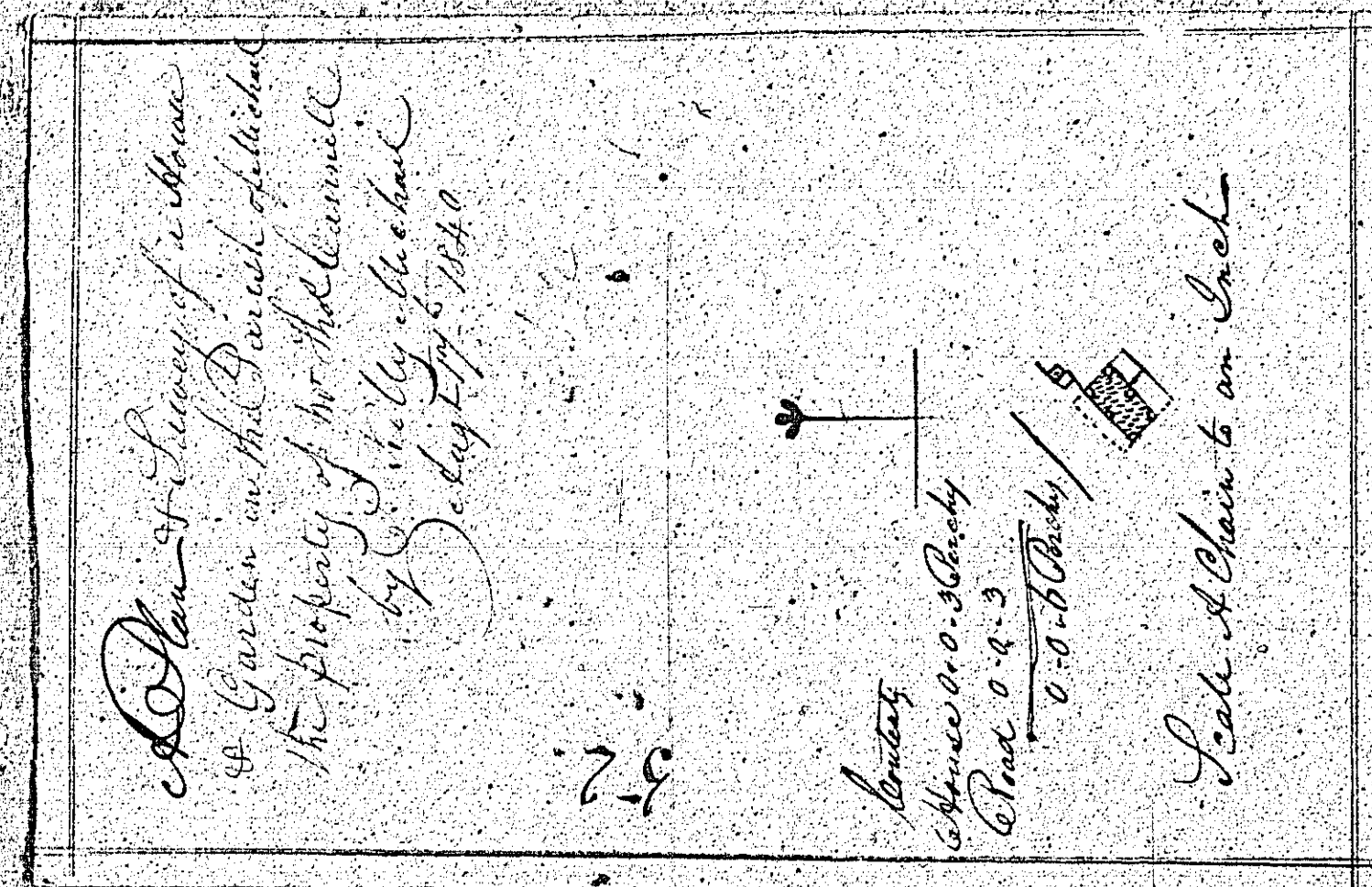

ISLE OF MAN GOVERNMENT: GENERAL REGISTRY

TITHE PLANS: PARISH OF MICHAEL

- 53 Original monotone
- 54 Original monotone
- 55 Original monotone, faint

1.30

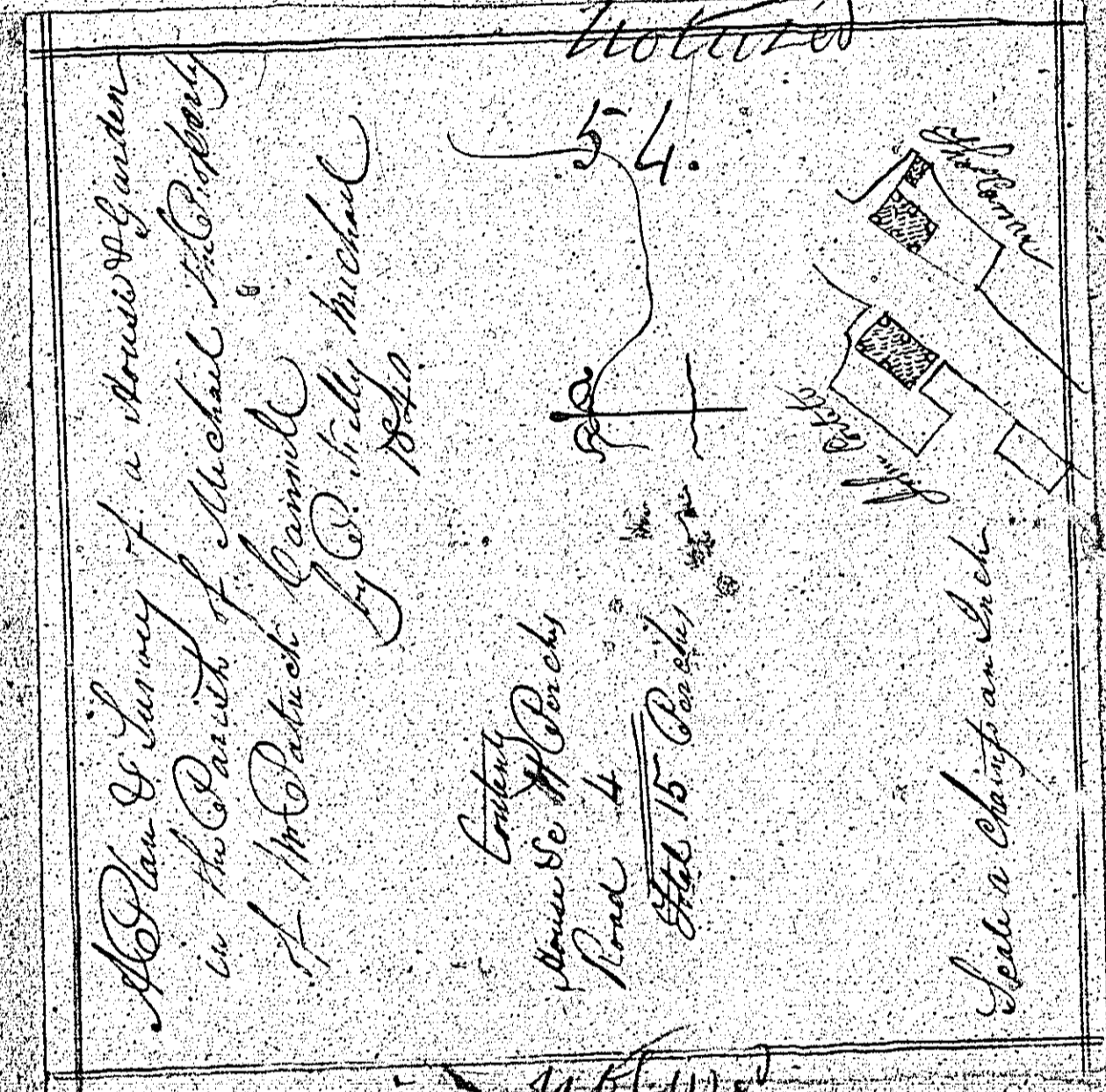
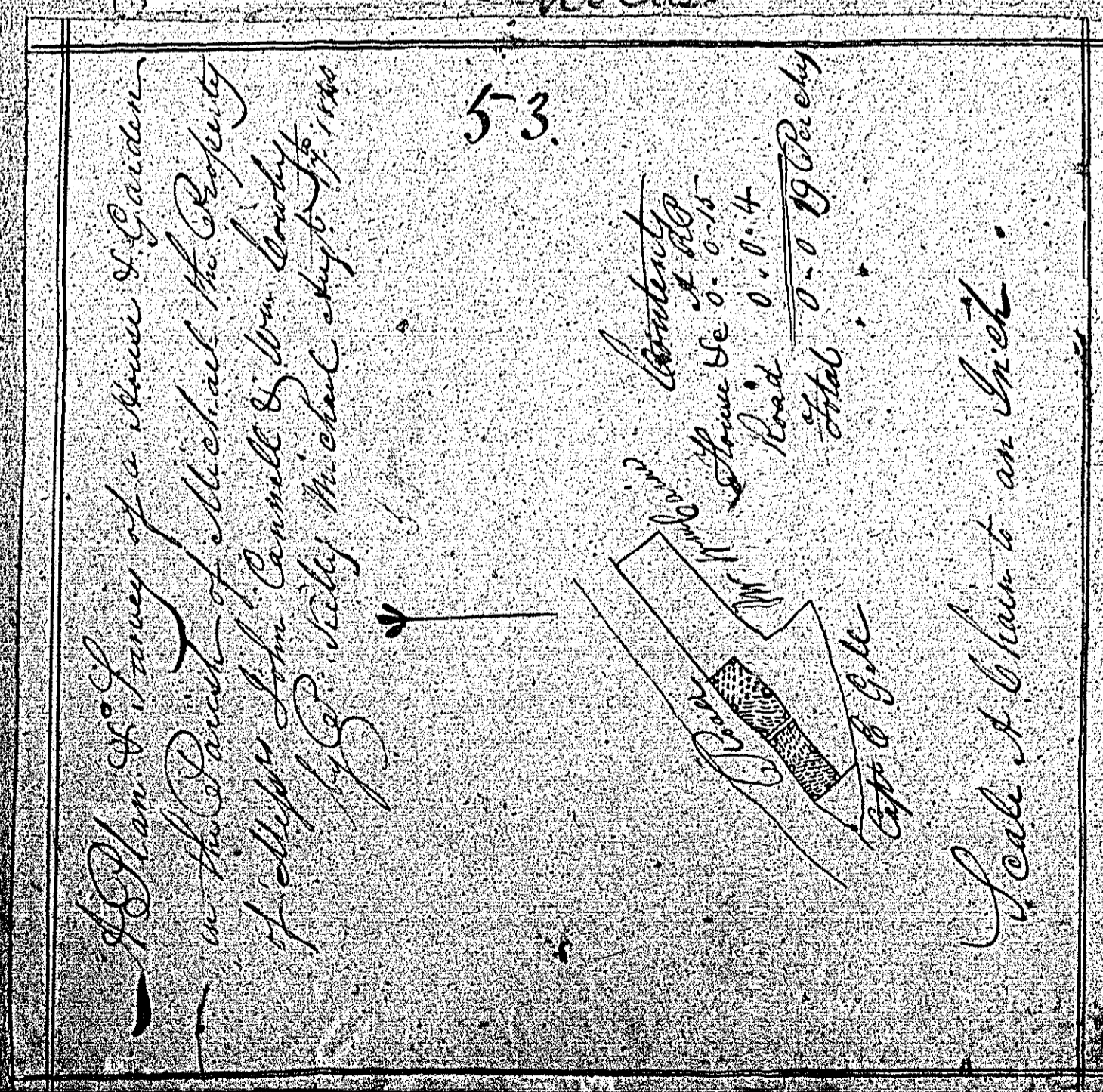

There is no plan
numbered 56