

Noted

A Plan of Survey of a piece of
Land in the Parish of St. John
the Evangelist in the County of
Dublin Properly called No. 34. Donegal By
Patrick Kelly 1840

Containing
No. 34
1-1-35
Area 10-0-24
Subdivided 1-3
1841-2-22

Scale 1/2 inch

35.

PLAN and Survey of part of the QUARTERLAND of SHUGHLA GUE-
 EY-CAIN and of the INTACK adjoining. in the parish of KK. MICHAEL
 the property of
 M^{RS} CATHERINE CANNELL.

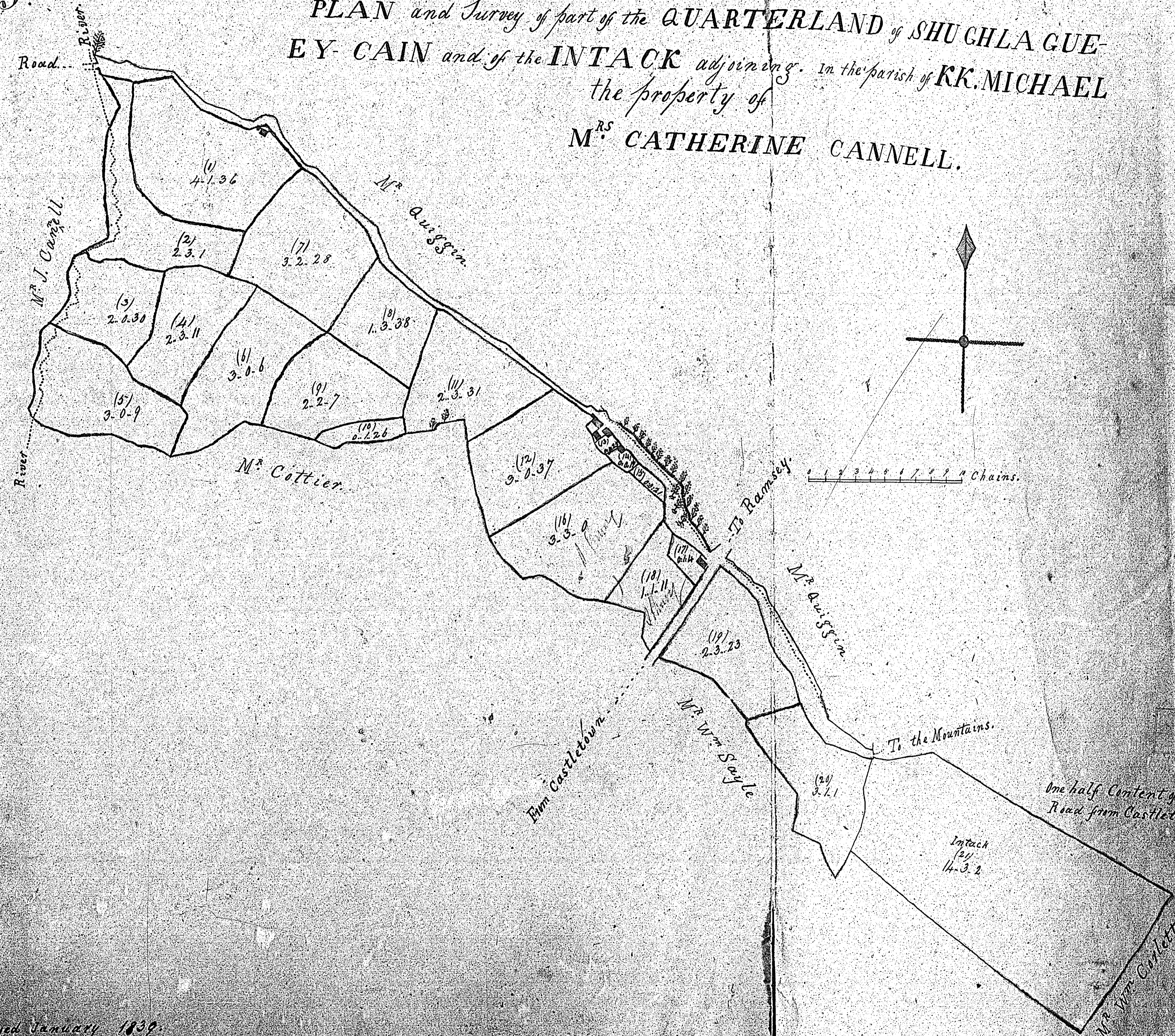

Collected			
N ^o	a.	r.	p.
1	4	1	36
2	2	3	1
3	2	0	30
4	2	3	11
5	3	0	9
6	3	0	6
7	3	2	28
8	1	3	38
9	2	2	7
10	1	1	26
11	2	3	31
12	3	0	37
13	0	0	25
14	0	1	17
15	0	0	21
16	3	3	0
17	0	1	4
18	1	1	11
19	2	3	23
20	3	1	1
21	14	3	2
Total			59 3 4

One half Content of mountain Road... 2-0-8
 Road from Castletown to Ramsey... 0-1-8
 Total... 2-1-16

Surveyed January 1839.
 By William Keogh
 Rev. K.K. German.

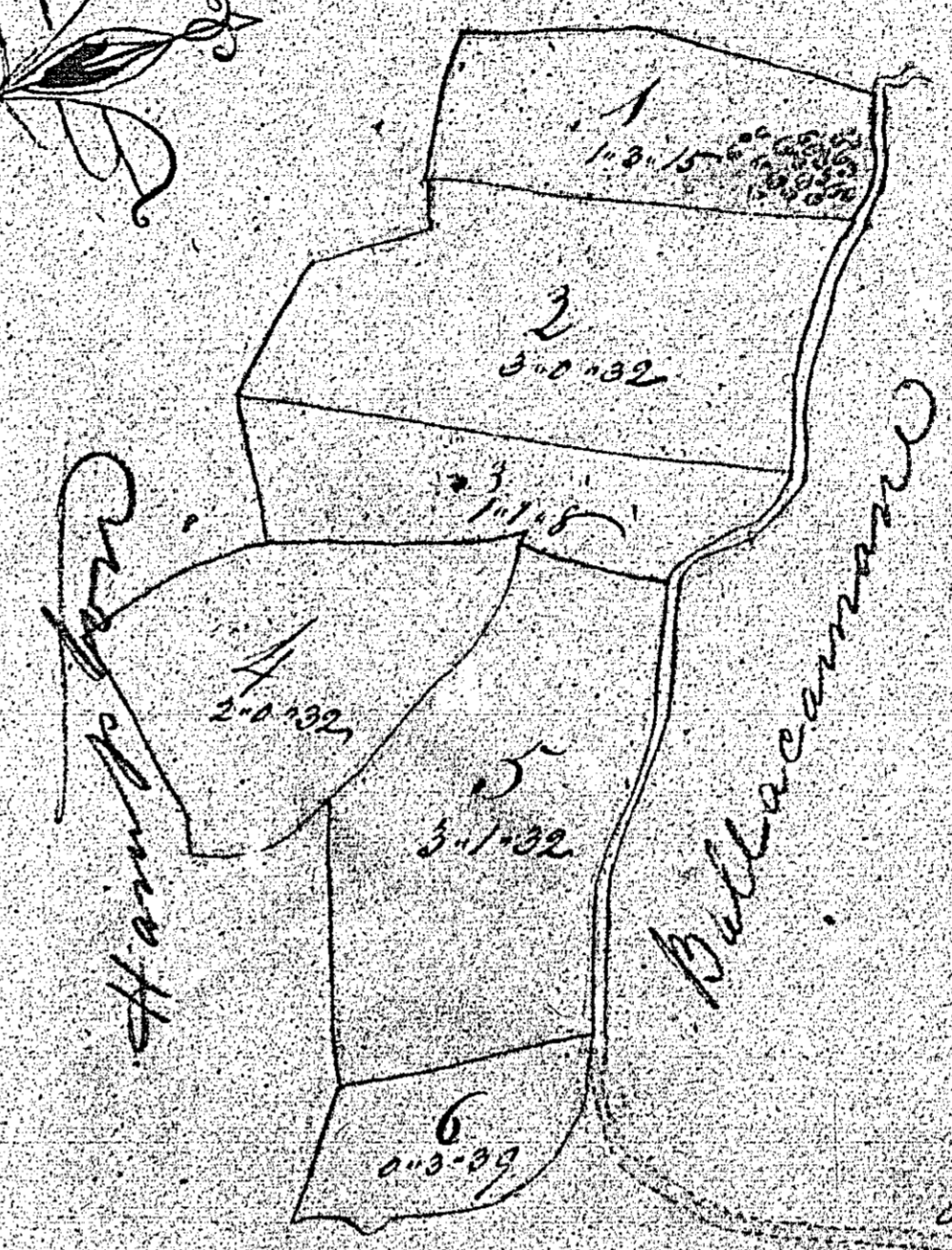
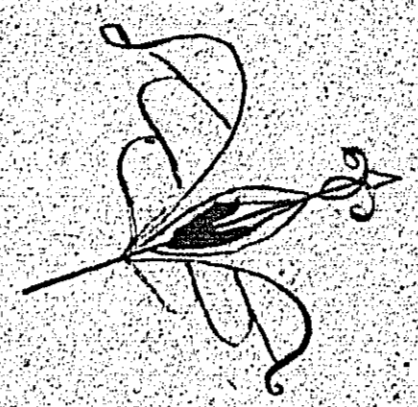

REFERENCE

F	A	R	P
1	1	5	15
2	3	0	32
3	1	1	8
4	2	1	32
5	3	1	32
6	0	3	37
7	0	3	15
8	0	2	34
9	1	3	37
10	1	2	39
11	2	1	36
12	2	1	37
13	2	1	37
14	1	1	12
15	2	0	12
16	1	3	11
Bullacanna			2
Total			53

A. PLANT OF
John
Mr. John Cannell's
LAND
Michael

Surveyed by C. Kelly March 1839

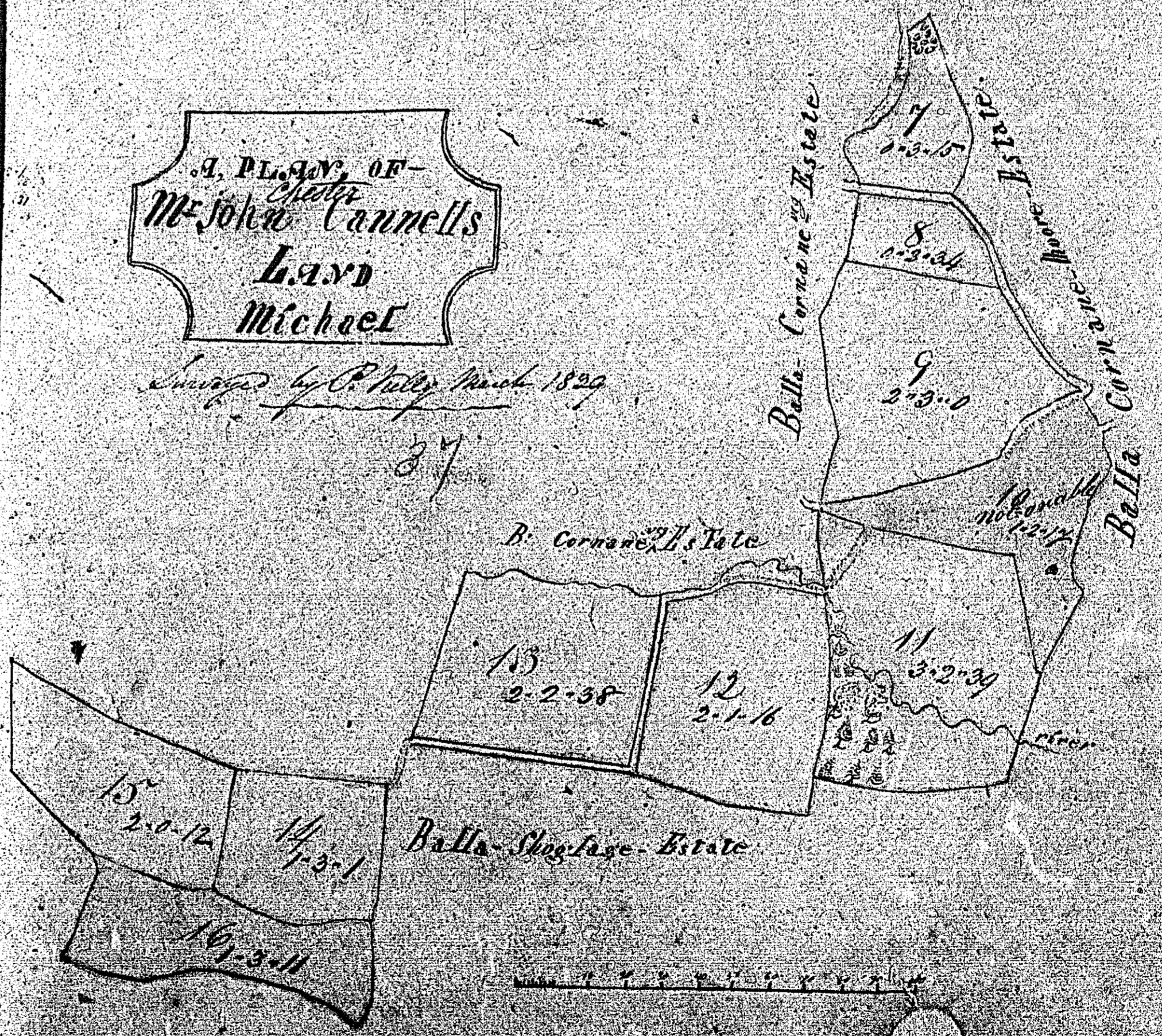

PLAN

Of part of the Quarterland of the Humberglaf
In the parish of St. Michael
The property of
Mrs Margaret Cannell.

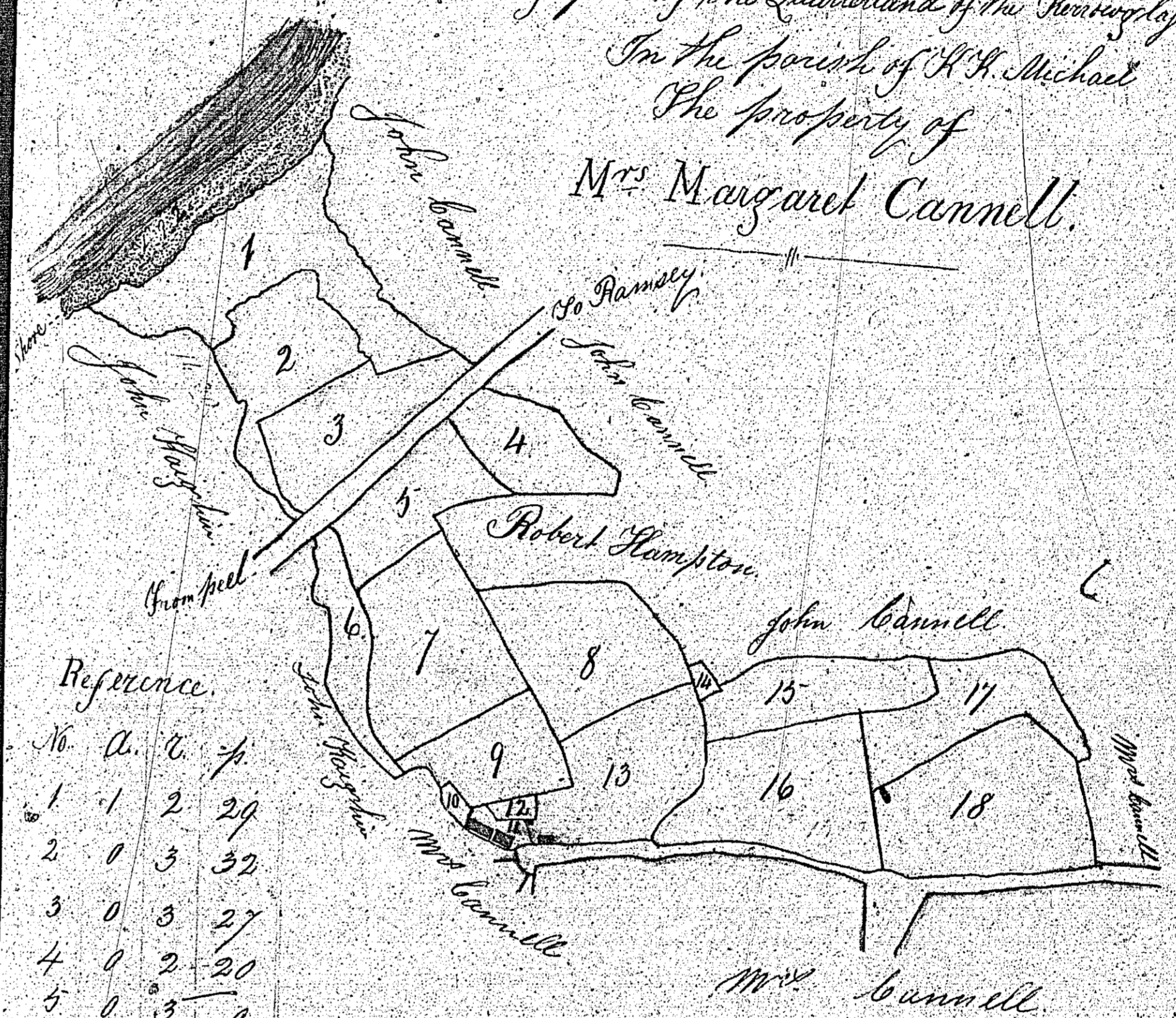

Reference.

No.	A.	B.	P.
1	1	2	29
2	0	3	32
3	0	3	27
4	0	2	20
5	0	3	0
6	0	1	34
7	1	1	17
8	1	0	32
9	0	2	26
10	0	0	7
11	0	0	32
12	0	0	8
13	1	0	17
14	0	0	6
15	0	3	2
16	1	1	23
17	0	3	23
18	1	2	16
Total	14	2	31

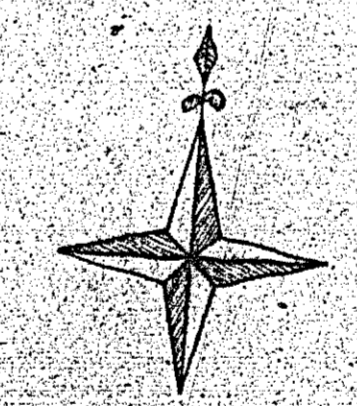

0 1 2 3 4 5 6 7 8 9 10 chains

Surveyed July 1844
By William Hughes
1844

A Plan of ^M ~~Surrey~~ ³⁰

a meadow of the Quarterland
of Bark in the Parish of

Michael The property of
^{Cannell}
Mr. John W. Carne By P. Kelly

July 1838

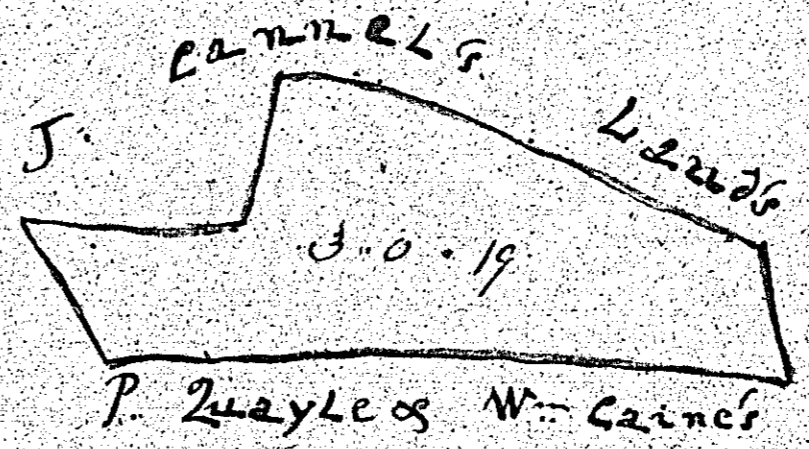

Scale nearly 3 Chains to an inch