

ISLE OF MAN GOVERNMENT: GENERAL REGISTRY
 TITHE PLANS: PARISH OF MAUGHOLD
 Original coloured (decorative) 1:30

Card Corkhill

Featured

John Corkhill Ballajera of
Moughold's titheable land by
James Faragher schoolmaster
August 2nd 1809

23

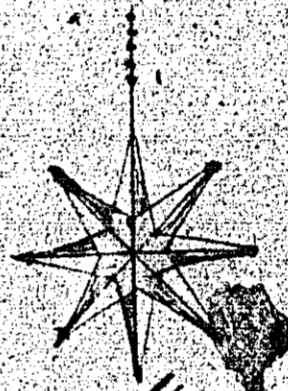

William Hampton

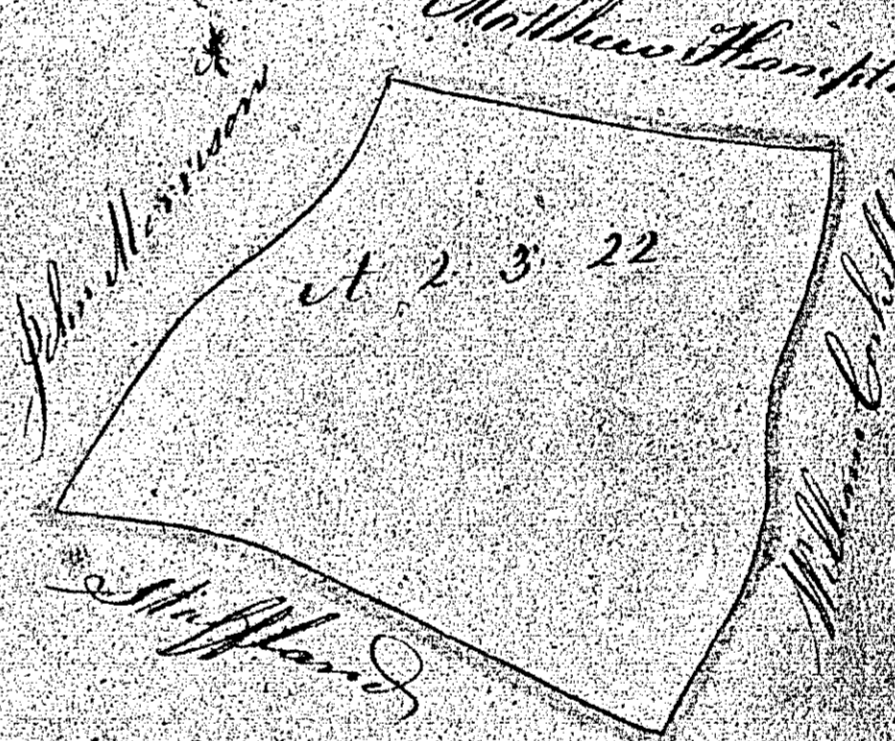

25

Intack

Property in Maughold
belonging to the late Edward Crow
July 1839.

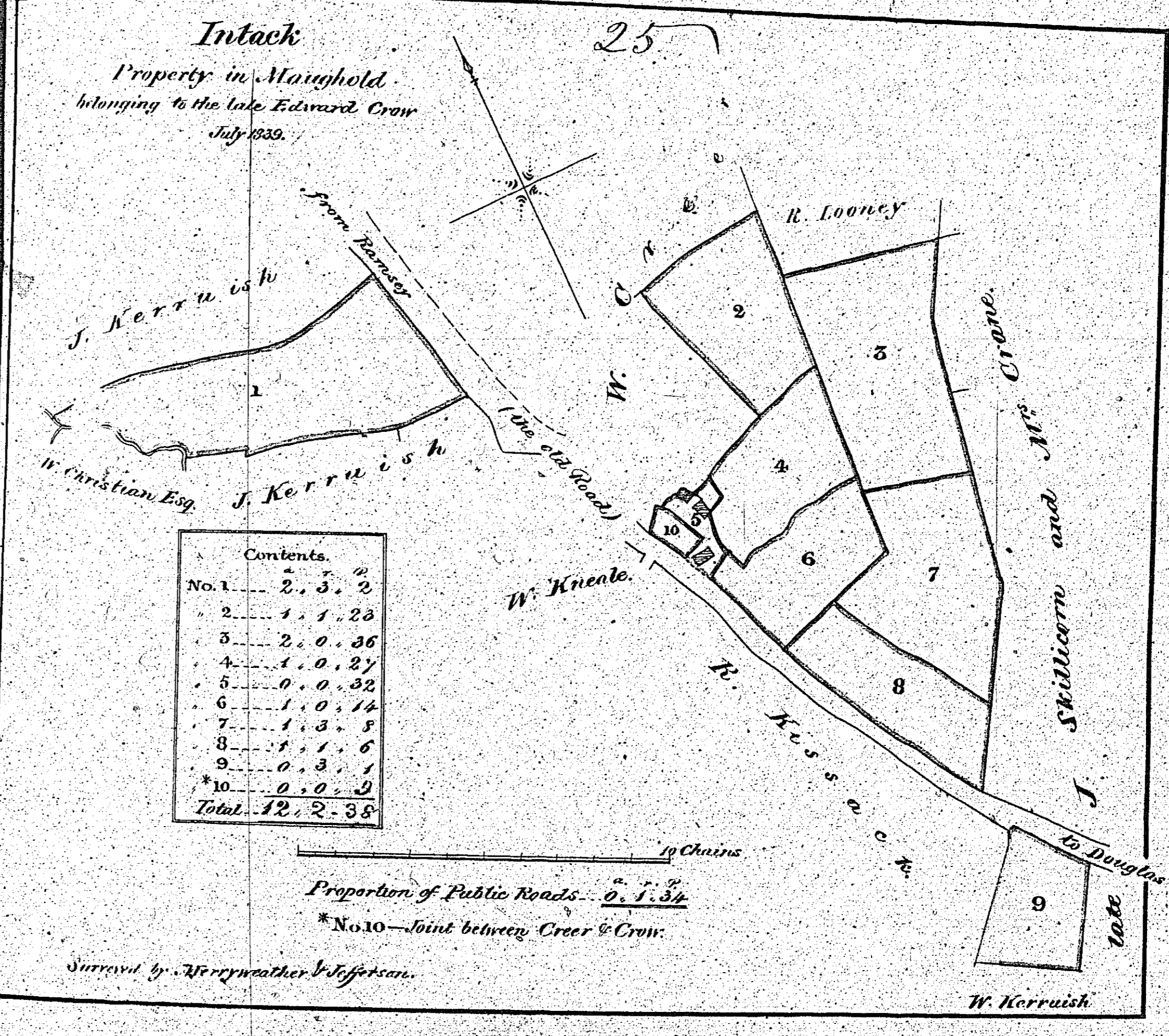

No.	Contents.
1	2. 5. 2
2	1. 1. 23
3	2. 0. 36
4	1. 0. 27
5	0. 0. 32
6	1. 0. 14
7	1. 3. 5
8	1. 1. 6
9	0. 3. 1
*10	0. 0. 2
Total	12. 2. 35

Proportion of Public Roads $\frac{0. 1. 34}{12. 2. 35}$

*No. 10—Joint between Crear & Crow.

Surveyed by W. Frymather & J. G. G. G.

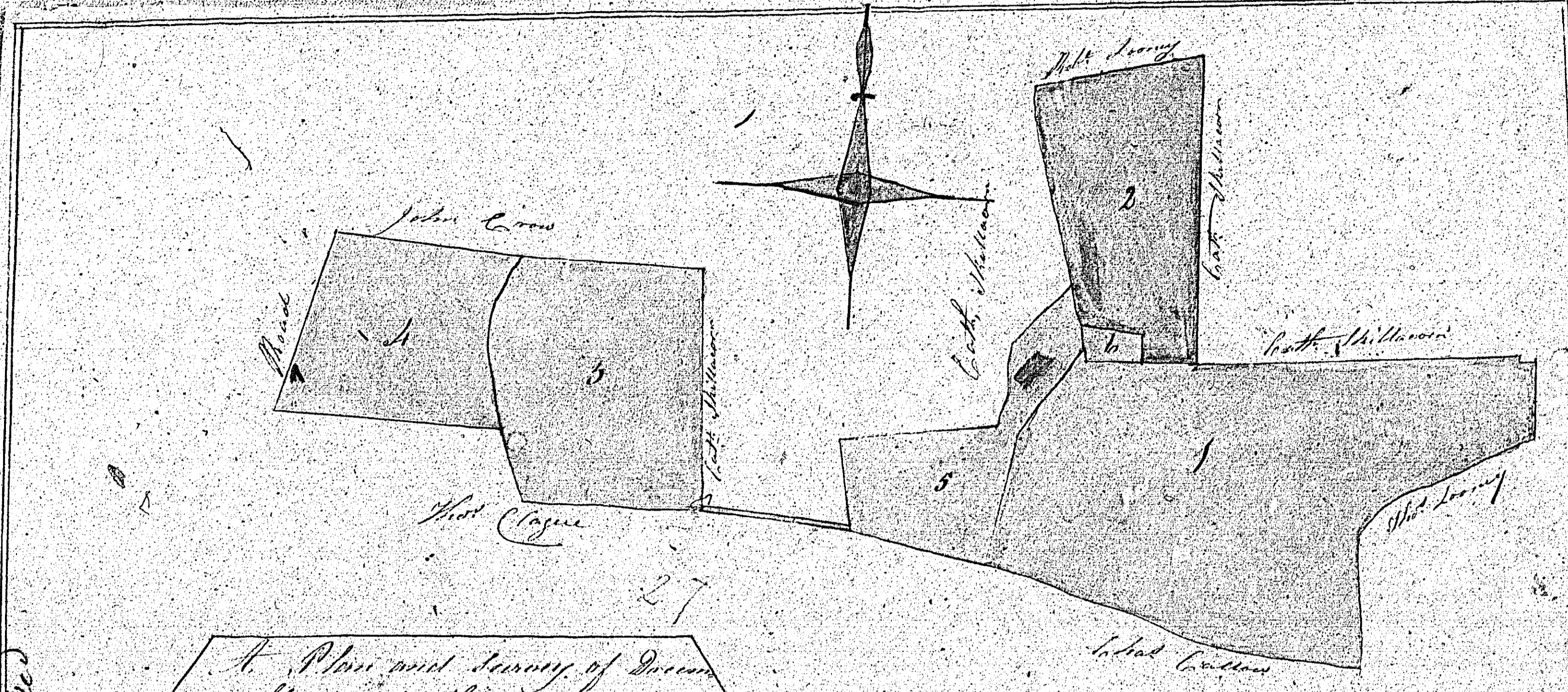

27

A Plan and Survey of Divers
 Holdings in the Parish of Maughold
 situated the property of Thomas
 Linnam
 by Thomas Linnam Surveyor
 July 1839

1st	3	1	10
2	2	1	1
3	2	1	10
4	1	2	31
5	8	5	21
2 1/2	50	one half of which is	15
6	1	one half of which is	5
	9	1	59

28

Bridle = 24. 2. 35.
 Roads & Lanes = 0. 3. 39.
 Total = 25. 0. 33

J. Linnam
 Surveyor 1839

Plan

27 Notuled

ISLE OF MAN GOVERNMENT: GENERAL REGISTRY

TITHE PLANS: PARISH OF MAUGHOLD

Original coloured

1:30