

William Paggart's New Plan

115

Plan of part of Reagy  
in the Parish of Malin  
being Intack Land  
the property of Mr. William Paggart.

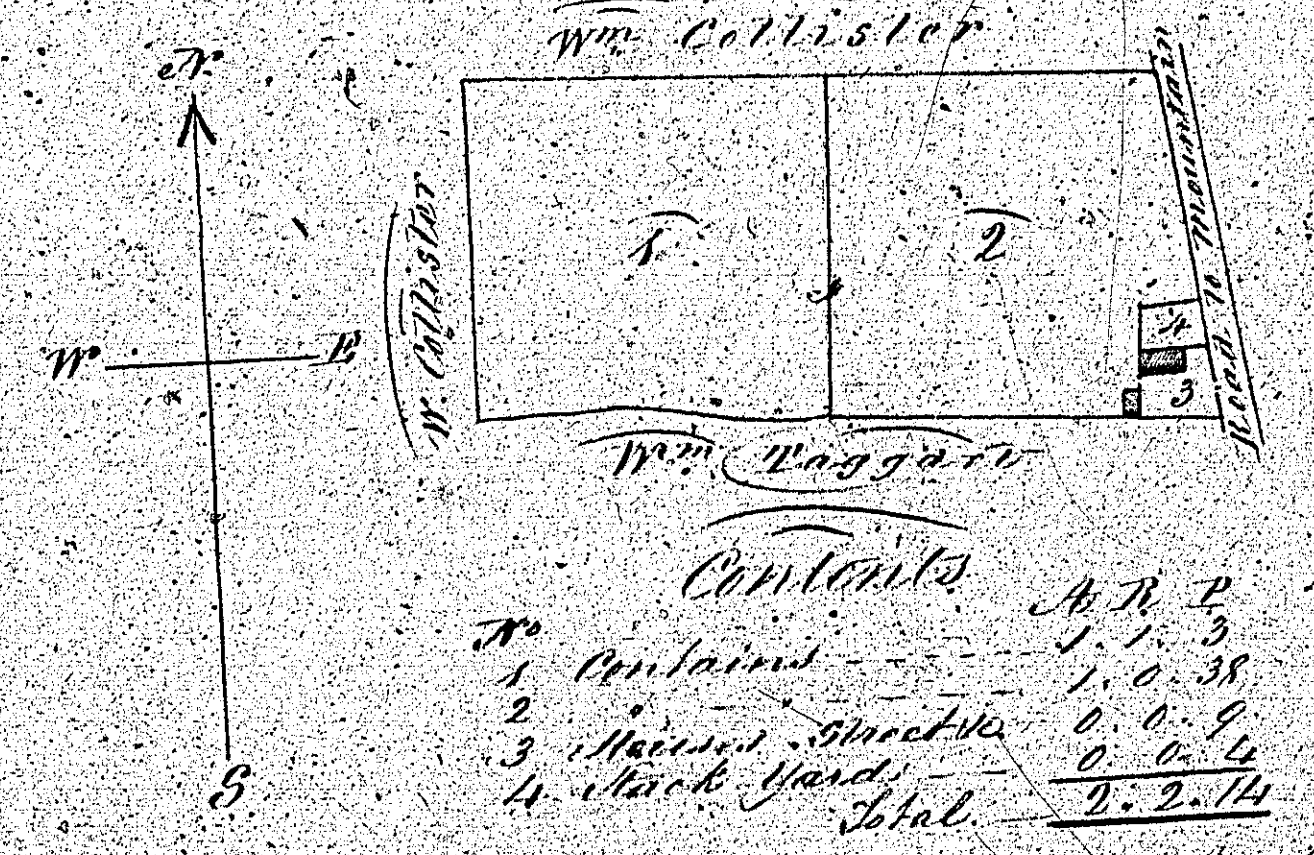

Contents

	A.	R.	P.
1. Containd	1.	0.	38.
2. Meadow Ground	0.	0.	4.
3. Stack Yard	0.	0.	4.
Total	1.	0.	46.

Scale 2 Chains to an Inch

The Clerk  
Barrington 1841

Noticed by  
Mr. Leggart near Meaw

119  
Plan of part of Meagy  
Antack Land in the Parish of Meaw  
the property of Mr. John Daggart 1815.

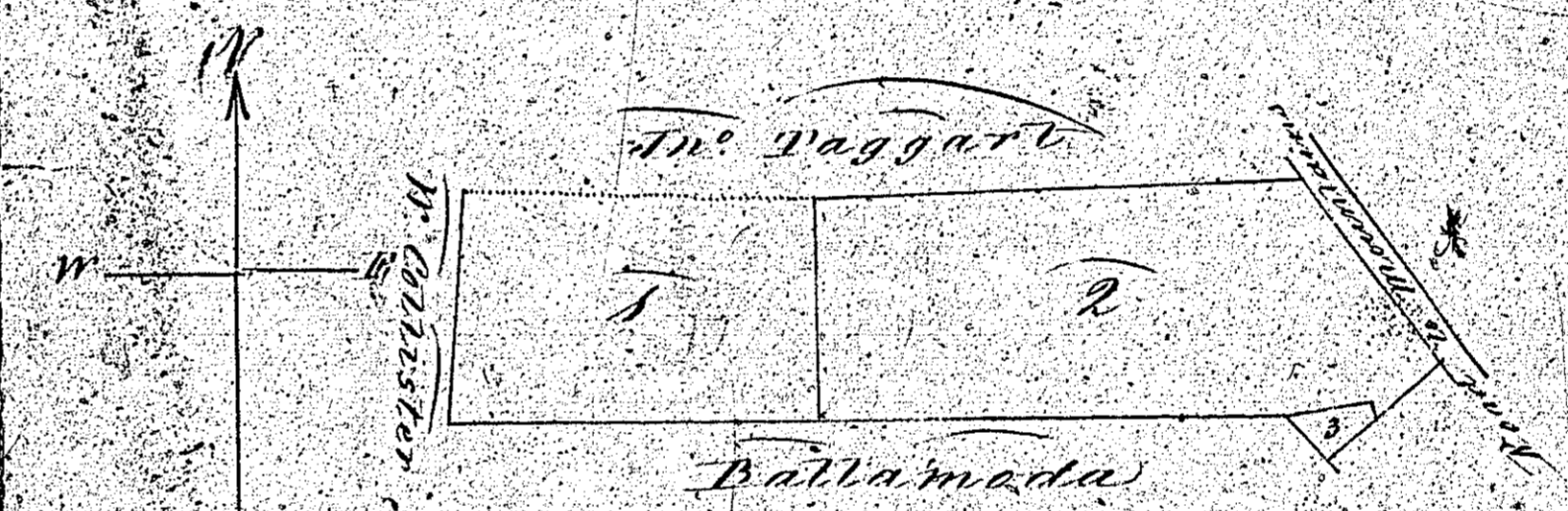

Contents

No	Contains	A	R	P
1	Contains	0	3	29
2		1	1	28
3	Garden	0	0	6
Total		2	4	23

Scale 2 Chains to an Inch

J. G. G. G.  
Surveyor  
1815

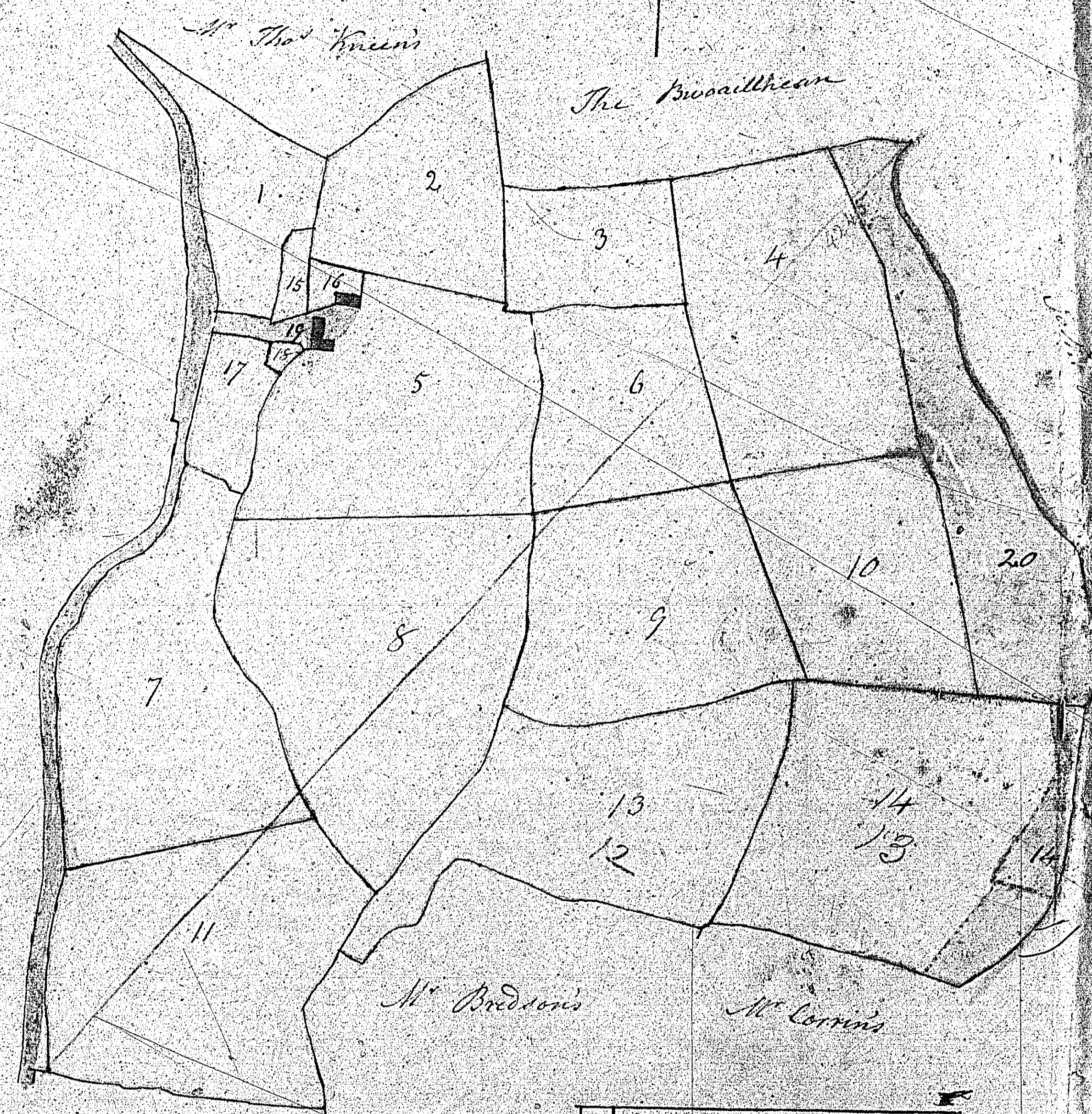
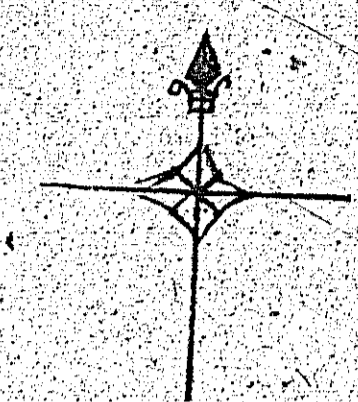

Mr. Fisher's

Mr. Bredson's

Mr. Corrin's

Mr. Fisher's

The Estate of  
Balla Charree  
In the parish of Malin  
The property of  
Mr. Henry Watterson  
of Collyer in the parish  
of Arbury surveyed  
from 15th of April 1840  
by A. Cooper

Contents	
No	A R P & A R B
1	2 2 15
2	3 2 25
3	2 1 29
4	6 3 8
5	6 1 33
6	3 2 24
7	6 3 34
8	5 2 18
9	5 3 37
10	4 2 17
11	7 3 31
12	4 3 31
13	7 1 7
14	1 1 30
15	1 1 0
16	4 6 0
17	1 2 16
18	1 2 0 2
19	1 1 6
20	5 7 15
<hr/>	
Total	90 12
	83 3 1

**END OF VOLUME**

T

P

E

**END**