

W. H. W.

*A Plan of the Survey of a House
and garden in the Parish of
St. Andrew, the Rectory of the
Dean of York, by
James Wyke Esq
Published by J. G. 1789*



Scale of 100 paces

Survey
 of part of the estate of
 Ballinacorney
 West Lonsay 1/8
 the property of
 Mr Robert Murray

| No | A | B | C |
|---------------|---|---|----|
| 1 | 2 | 3 | 4 |
| 2 | 1 | 2 | 36 |
| 3 | 1 | 3 | 12 |
| 4 | 2 | 3 | 5 |
| 5 | 1 | 1 | 7 |
| All the same | 7 | 1 | 7 |
| Value of same | 1 | 8 | |

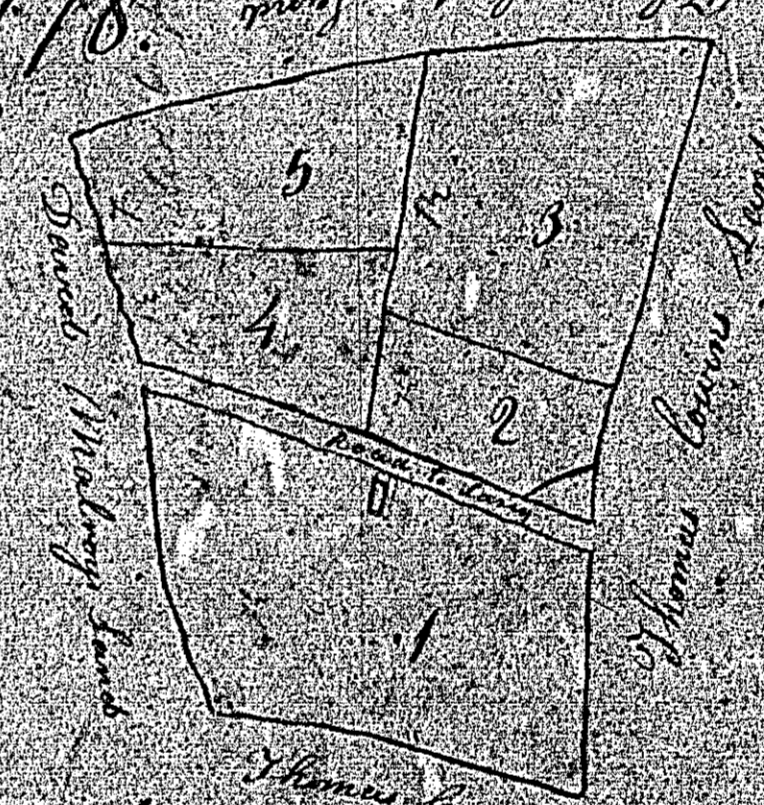

Scale
 Three inches to an inch

20th July 1859
 Surveyed by me
 James Gray
 West Lonsay

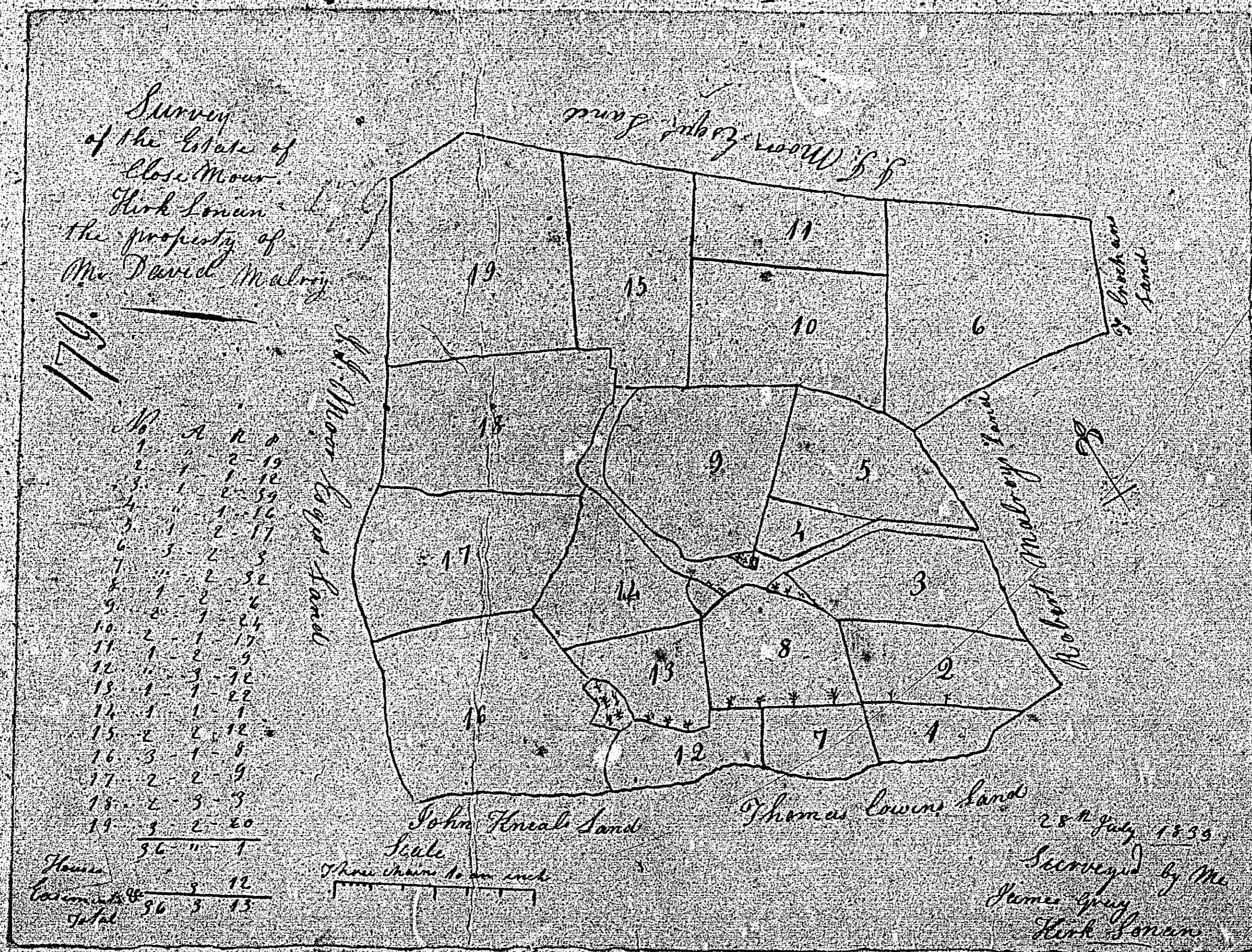

ISLE OF MAN GOVERNMENT: GENERAL REGISTRY

TITHE PLANS: PARISH OF LONAN

Original monotone

1:30

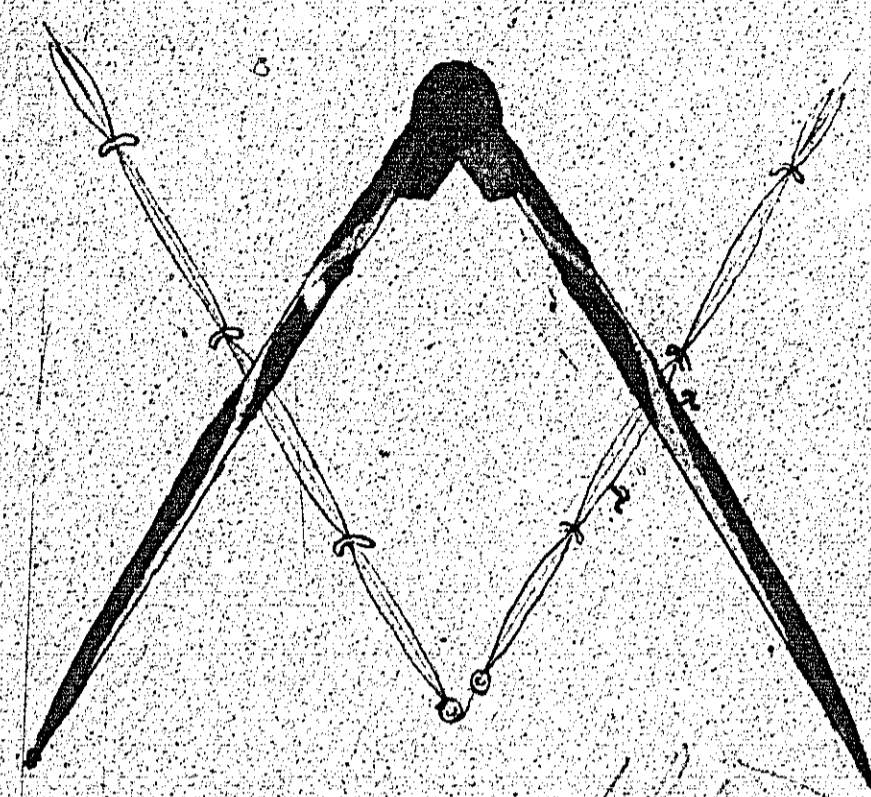

Lend. Belmings, To J. Skitticorn

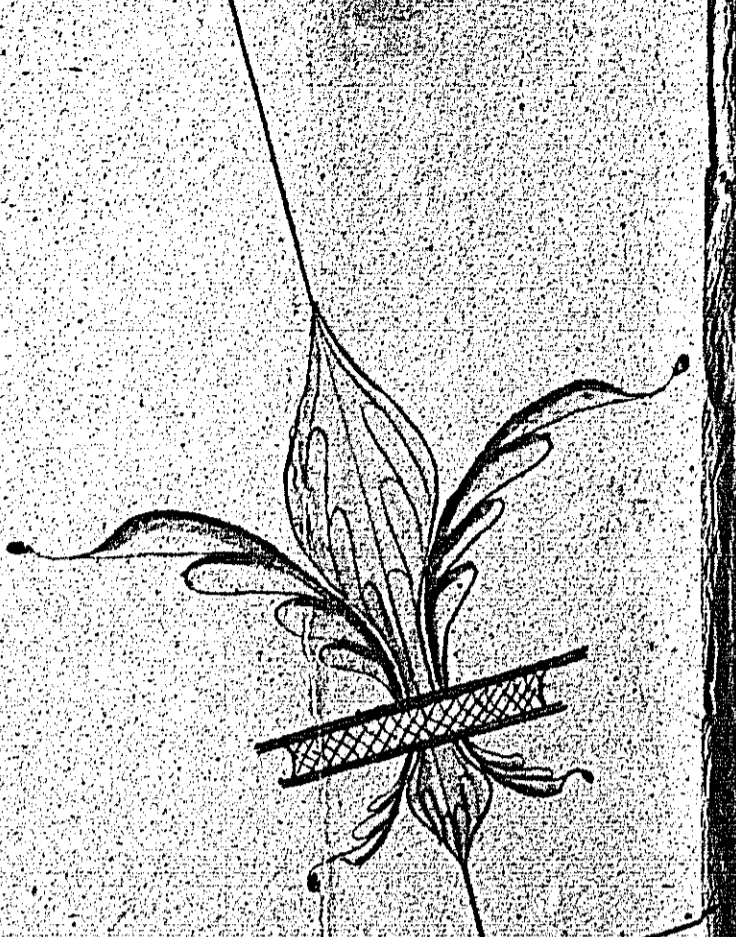

Plan and Survey

OF
GREYCH. VANE, BELONGING
M^r. DA^s. M^r. KNEALE

In the Parish of Loran. By Patrick Kelly

June 14th 1839

Scale of 1000 to an inch



Summary

| No. | Ac. | R. | P. |
|-------|-----|----|--------|
| 1 | 10 | 0 | 23 |
| 2 | 3 | 0 | 11 |
| 3 | 3 | 2 | 30 |
| 4 | 3 | 1 | 18 |
| 5 | 3 | 3 | 11 |
| 6 | 3 | 1 | 0 |
| 7 | 2 | 3 | 34 |
| 8 | 3 | 2 | 21 |
| 9 | 3 | 3 | 8 |
| 10 | 2 | 3 | 24 |
| 11 | 3 | 3 | 5 |
| 12 | 3 | 0 | 11 |
| 13 | 1 | 0 | 36 |
| Total | | | 48 1 7 |

Public Road 1 2 0
 House Enclosure 1 2 0
 Total Content 50 1 7

187
187
187

187

187

187

600 m. yds.

*In Extract Licensed to the Governor the property of Mr. James Moore
not yet enclosed*

Mr James Moore

*L. R. P.
1870*

200 m. yds.

James

ISLE OF MAN GOVERNMENT: GENERAL REGISTRY

TITHE PLANS: PARISH OF LONAN

Original monotone

1:30

James

