

8

160

160  
Survey  
of a house and garden  
in the parish of  
Lismore  
the property of  
Mr Thomas Keruish

Content is poles



Scale  
whose chain is used

17th Feb 1861  
Surveyed by me  
John Gray  
Lismore

Survey  
of a house and garden  
in the village of Long  
London  
the property of  
Mr. John Kernele

1614

Content 54 poles



Scale  
Three inches to an inch

In the year 1614  
Surveyed by me  
James Gray  
Surveyor

*Corrected and amended*

*Wolfe*

*Survey* 162.  
*of a house and garden*  
*in Ballinacree*

*Admiral*  
*the property of*  
*Mr William Kelly*

*Corrected and amended*

*1720*  
*Surveyed by me*  
*James Kelly*  
*Admiral*

*W. Case*

*Survey 163*  
*of a house and garden*  
*in the parish of*  
*St. Dunstons*  
*the property of*  
*Mr. William Kerne*  
*Contents of plan*

*Scale*  
*Three chains to an inch*  
*11<sup>th</sup> Feb 1841*  
*Surveyed by me*  
*James Gray*  
*London*

Survey  
of a parcel of uninclosed  
land, in the parish of  
Loran 164.  
the property of  
Mrs Kennish and Hubby

Content  $\overset{r}{5} \overset{r}{5} \overset{r}{26}$

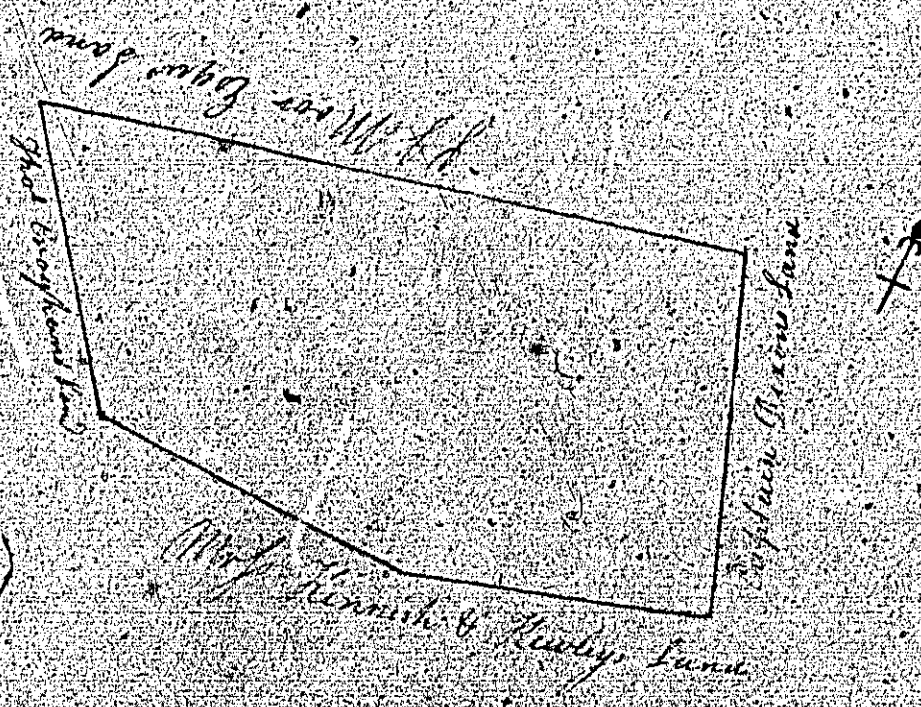

Scale  
Three chains to an inch

1841  
Surveyed by me  
James Pugh  
Loran

