

ISLE OF MAN GOVERNMENT: GENERAL REGISTRY

TITHE PLANS: PARISH OF LONAN

Original coloured (decorative)

1:30

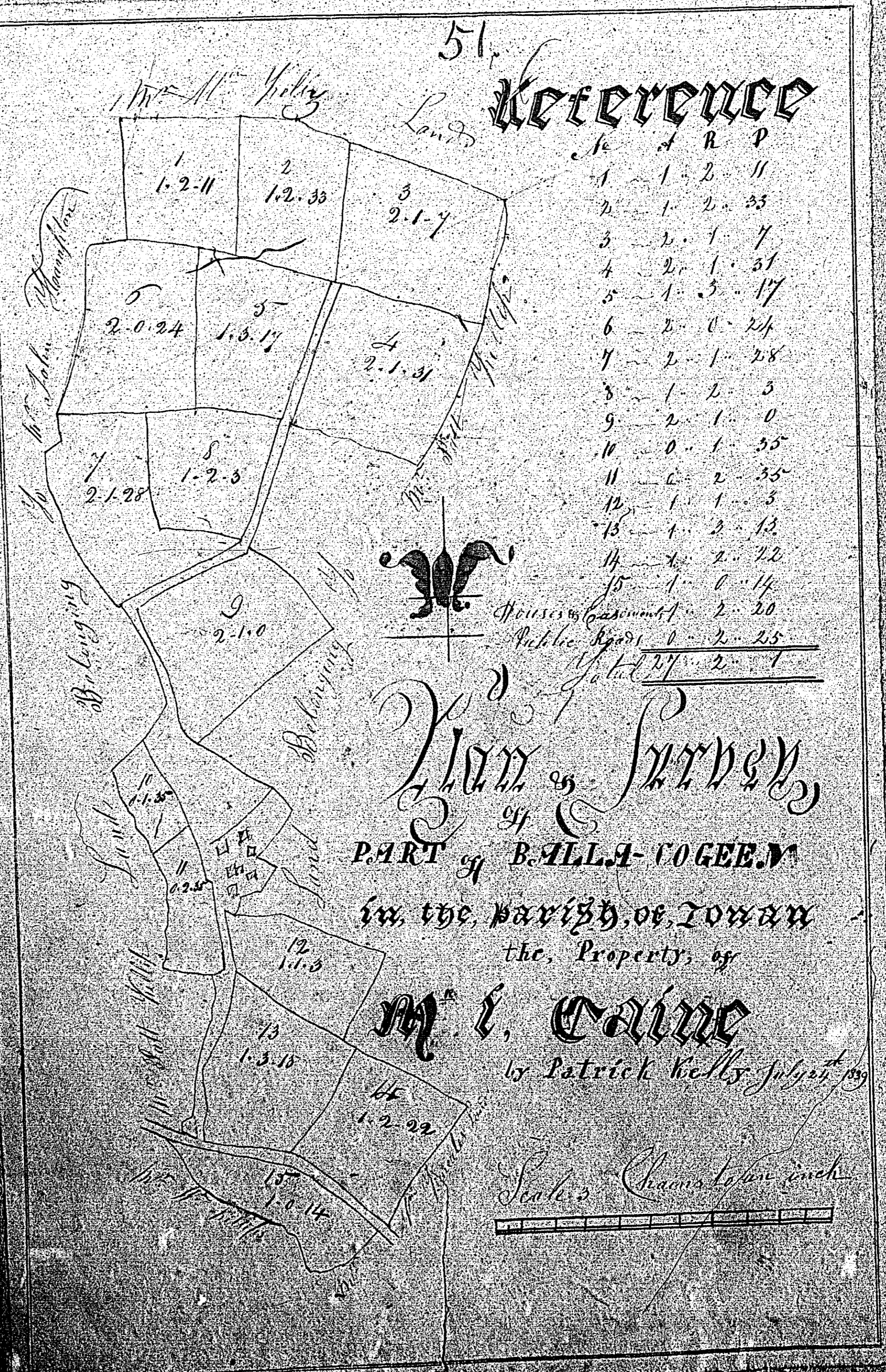

Reference

No.	A.	R.	P.
1	1	2	11
2	1	2	33
3	2	1	7
4	2	1	31
5	1	5	17
6	2	0	24
7	2	1	38
8	1	2	3
9	2	1	0
10	0	1	35
11	0	2	35
12	1	1	3
13	1	2	13
14	2	2	22
15	1	0	14
Houses & Grassmatt	2	2	20
Public Road	0	2	25
<u>Total</u>	<u>2</u>	<u>1</u>	<u>1</u>

Plan of Survey

of PART of BALLACORNEY

in the Parish of TOWAN

the Property of

M. L. CAINE

by Patrick Kelly Surveyor

Scale's Chain to an Inch



Noticed

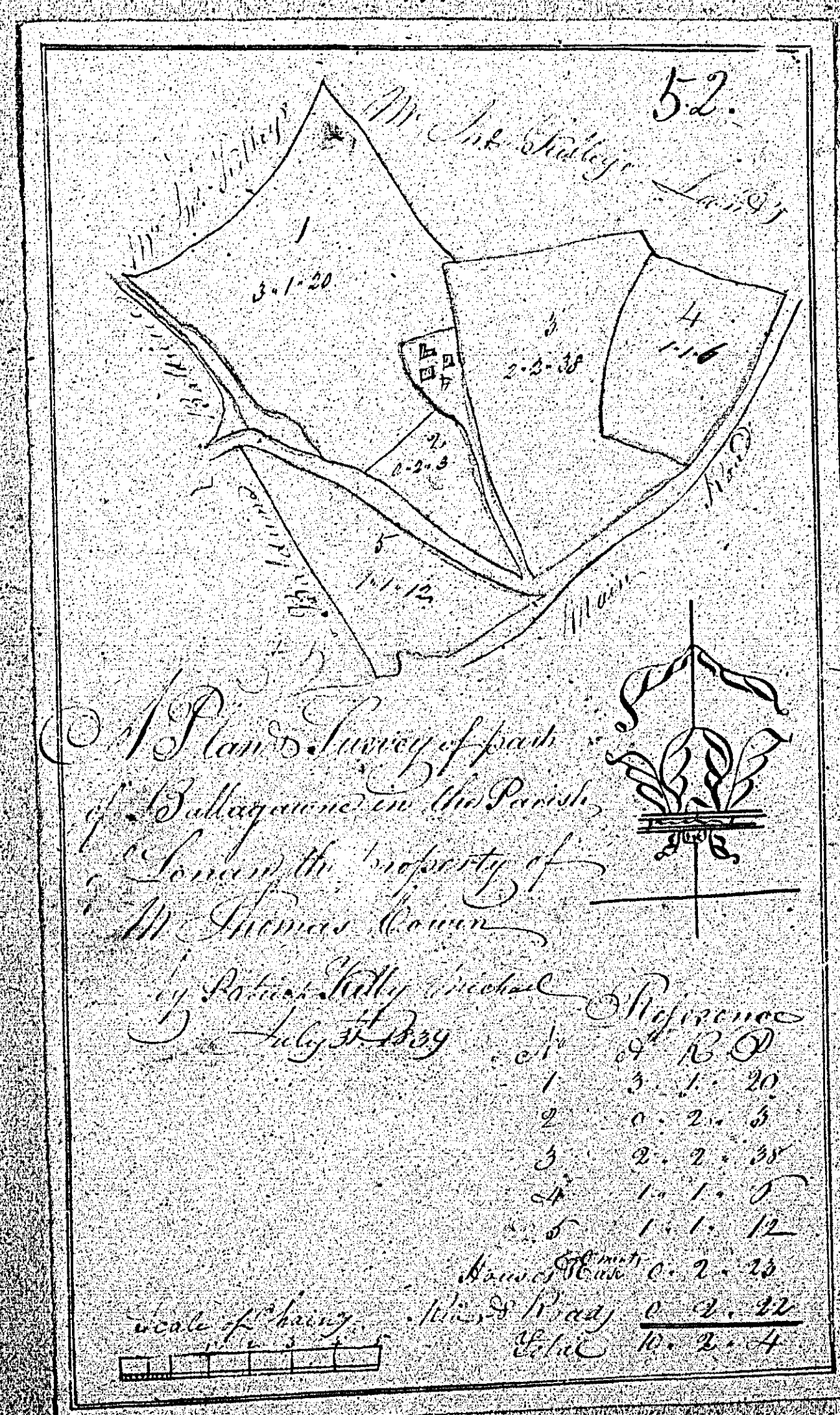

A Plan & Survey of part
of Ballyquinn in the Parish
of Louisa the property of
Mr Thomas Conner

by Robert Kelly Michael
July 20 1839

1839

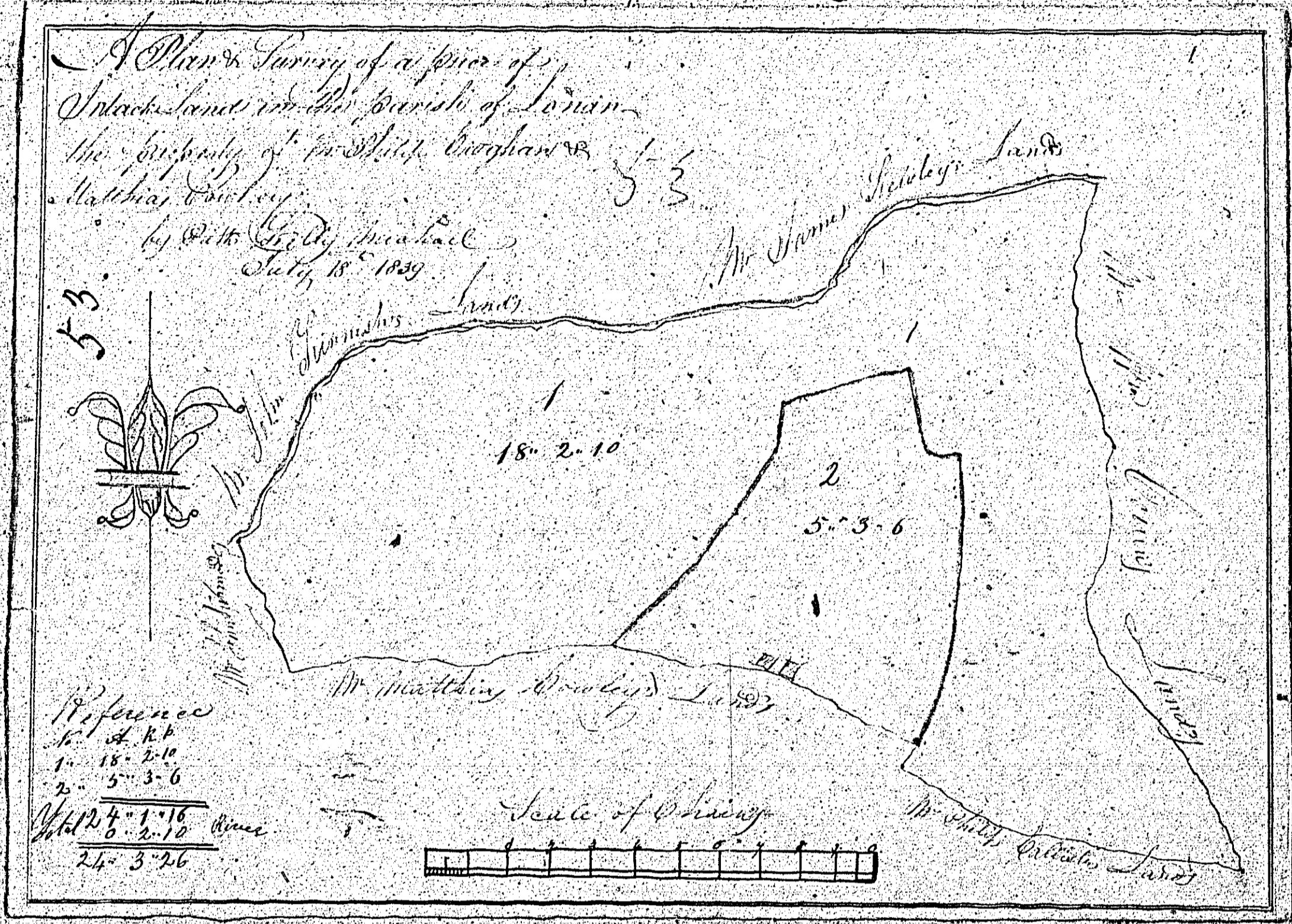

ISLE OF MAN GOVERNMENT: GENERAL REGISTRY

TITHE PLANS: PARISH OF LONAN

Original coloured

1:30

54.

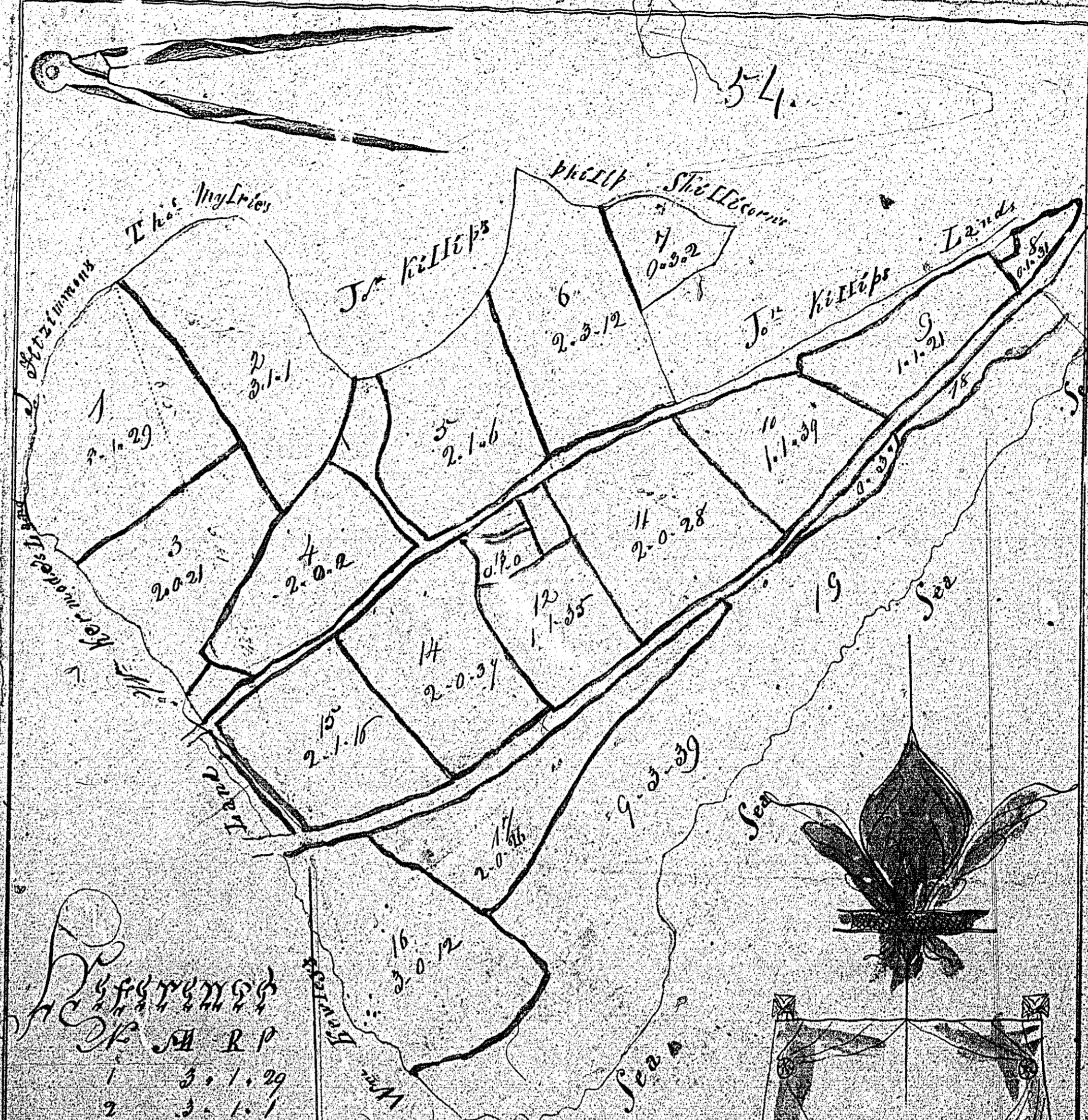

1 3.1.29
 2 3.1.1
 3 2.0.2
 4 2.0.2
 5 2.1.6
 6 2.3.12
 7 0.3.2
 8 0.1.1
 9 1.1.2
 10 1.1.29
 11 2.0.28
 12 1.1.29
 13 2.0.28
 14 1.1.29
 15 2.0.28
 16 1.1.29
 17 2.0.28
 18 1.1.29
 19 2.0.28

No 54
 John Killip
 Esq. & The Rev. Mr. John Killip
 Vicar of the Parish of Loman
 The Rectory, St. John's Church
 1st March 1839

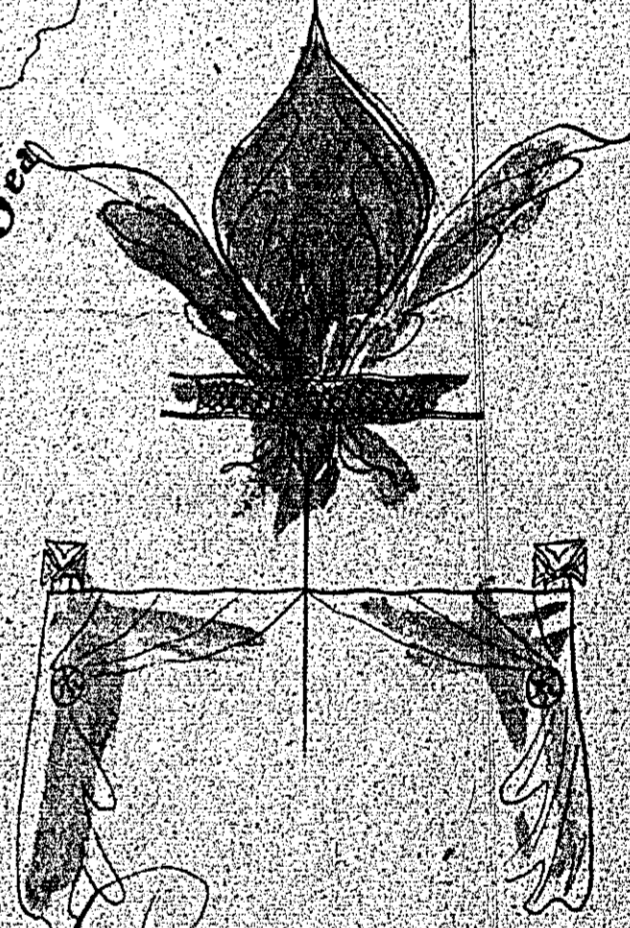

October
55

Mr. Philip Grayham's Survey
of part of
Watercourse & Substrate Lands in
the parish of Lissan the property
of Mr. William Cowley
by James Sully Marshal
July 10 1839

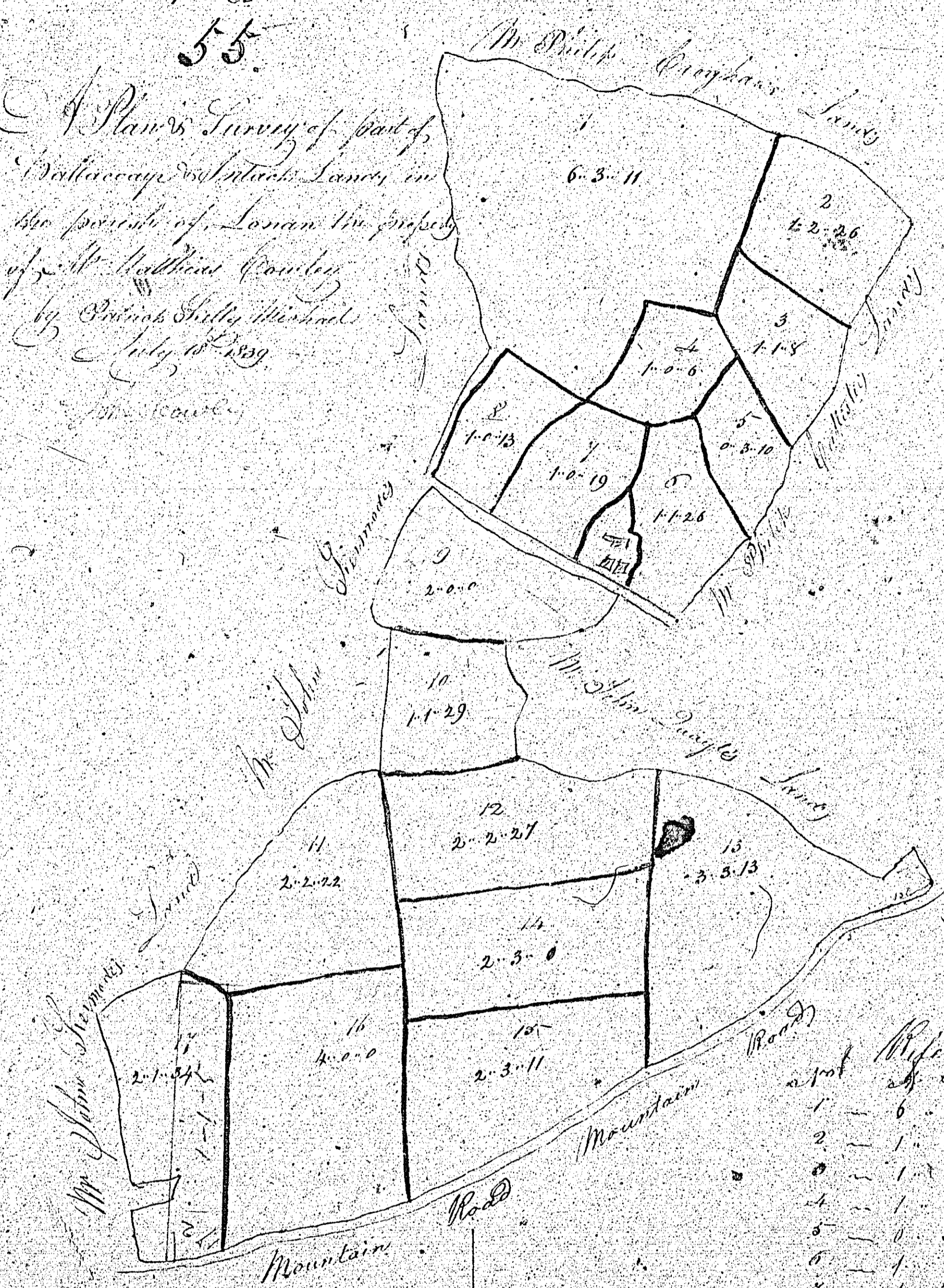

Plot	Reference
1	6.3.11
2	2.2.26
3	1.1.8
4	1.0.6
5	0.3.10
6	1.1.26
7	1.0.19
8	1.0.13
9	2.0.0
10	1.1.29
11	2.2.22
12	2.2.27
13	2.3.13
14	2.3.0
15	2.3.11
16	2.1.24
House & Enclosure	0.1.20
of the Road	0.5.30
Total	41.0.25

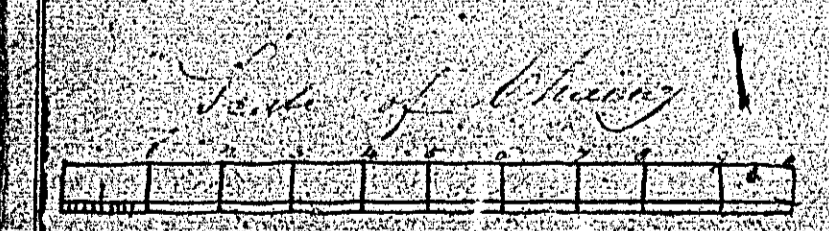

1839