

*Notes*

*P. 4.*  
*Plan of Survey of part*  
*of the land of the*  
*Province of Louisiana*  
*the West Indies*  
*the Indian Islands*  
*August 1769*

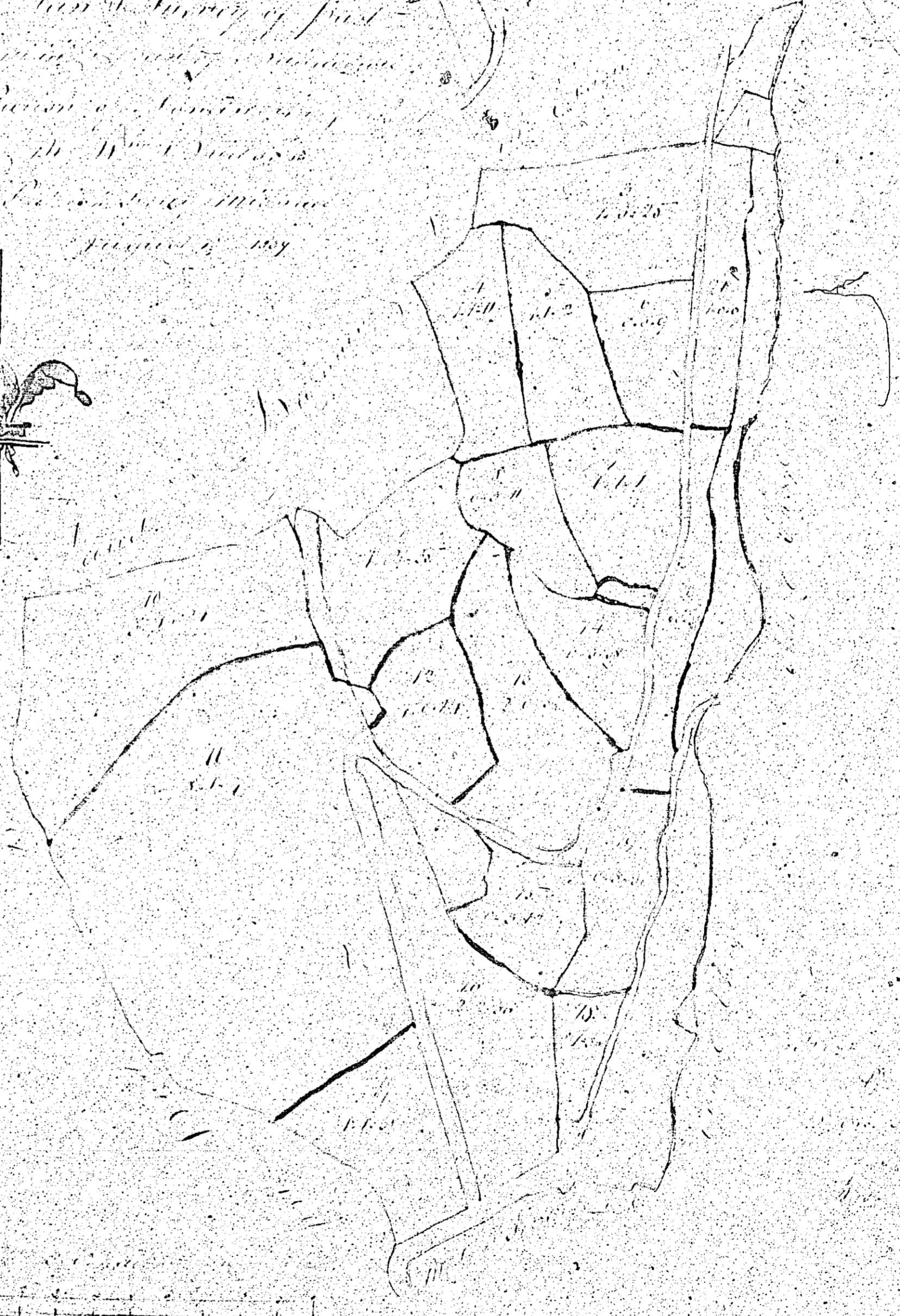
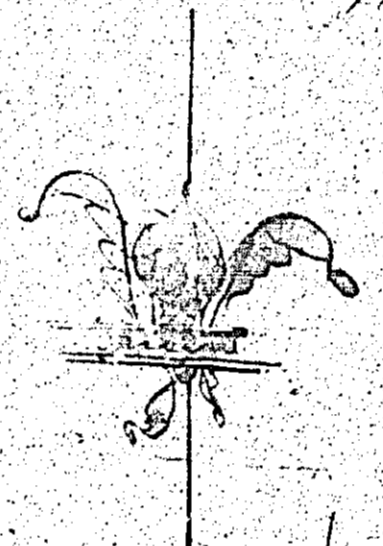
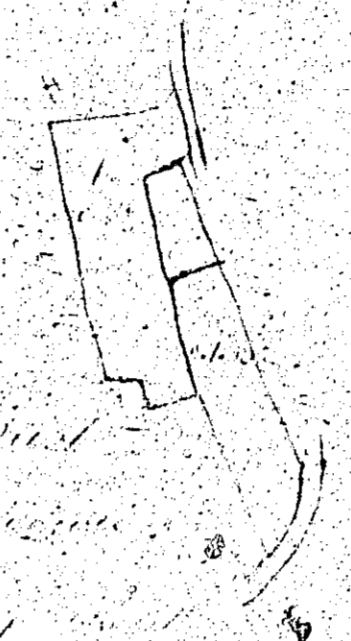

*Part of the*  
*Province of Louisiana*  
*the West Indies*  
*the Indian Islands*  
*August 1769*

*Contents*

1	1
2	2
3	3
4	4
5	5
6	6
7	7
8	8
9	9
10	10
11	11
12	12
13	13
14	14
15	15
16	16
17	17
18	18
19	19
20	20
21	21
22	22
23	23
24	24
25	25
26	26
27	27

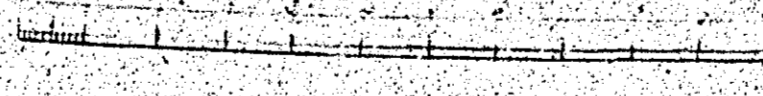



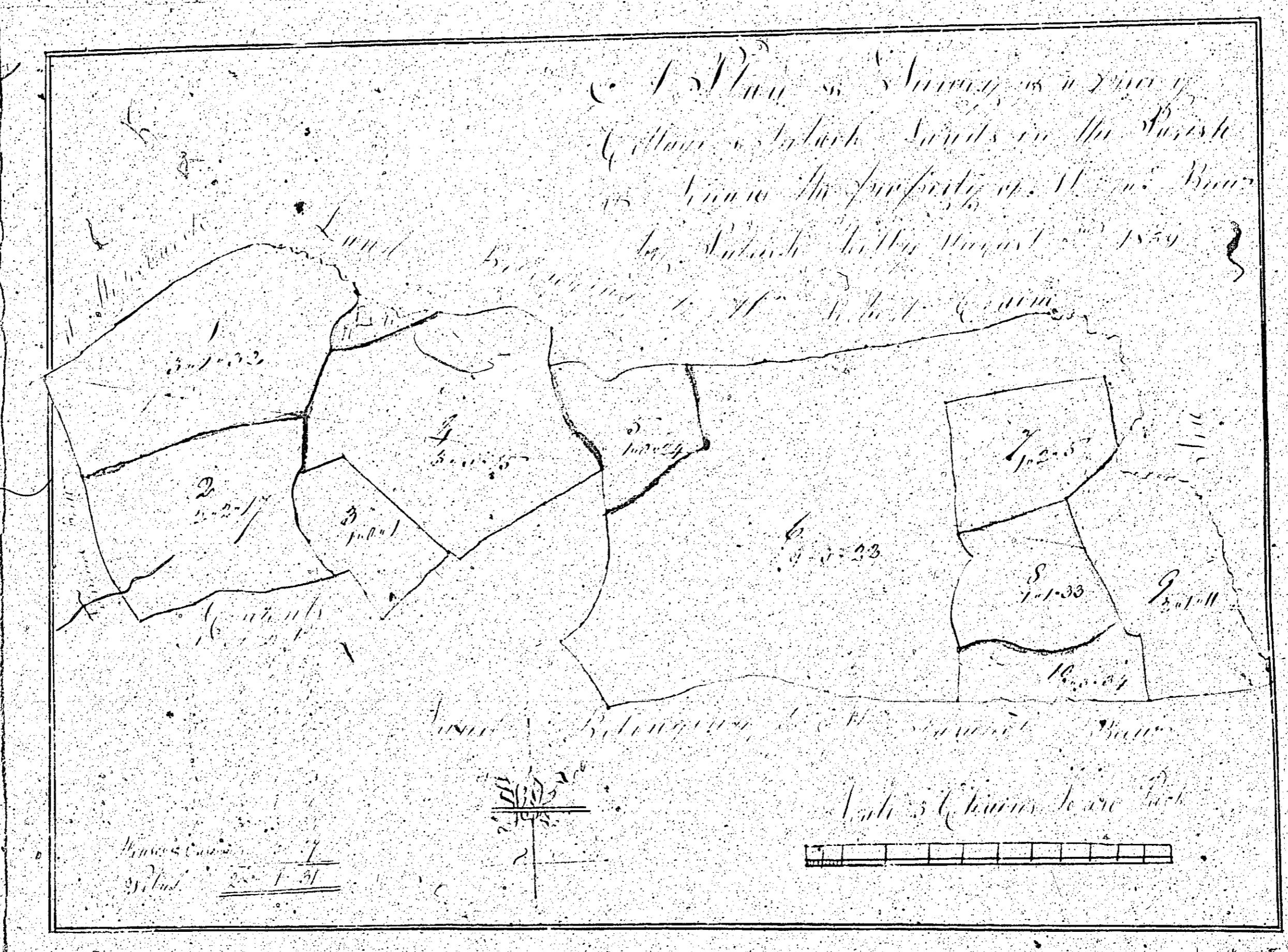



*Delin.*

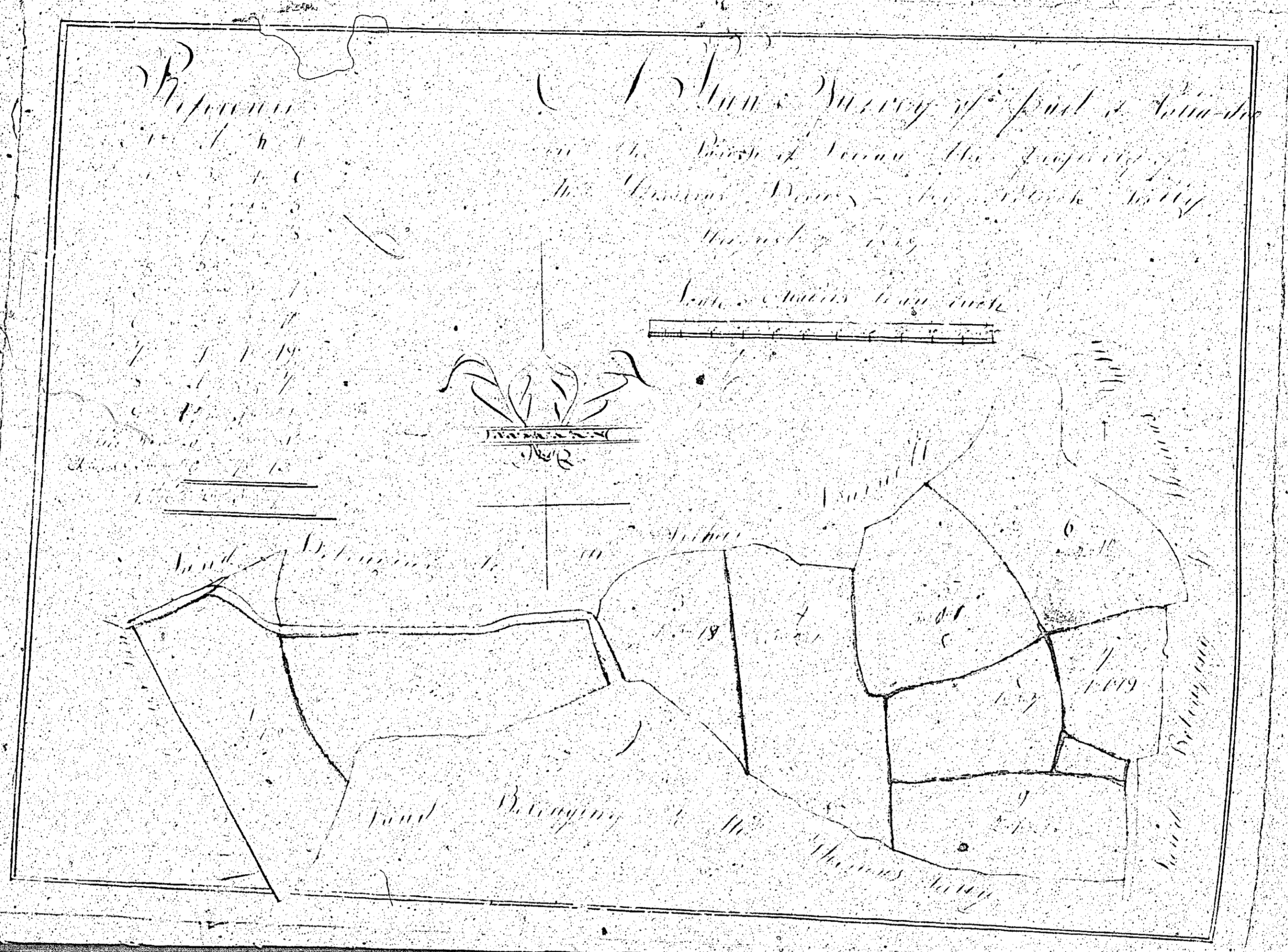



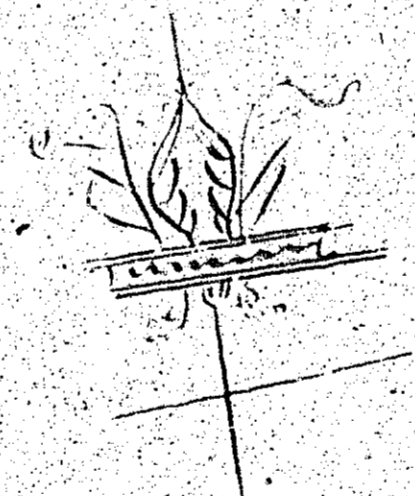
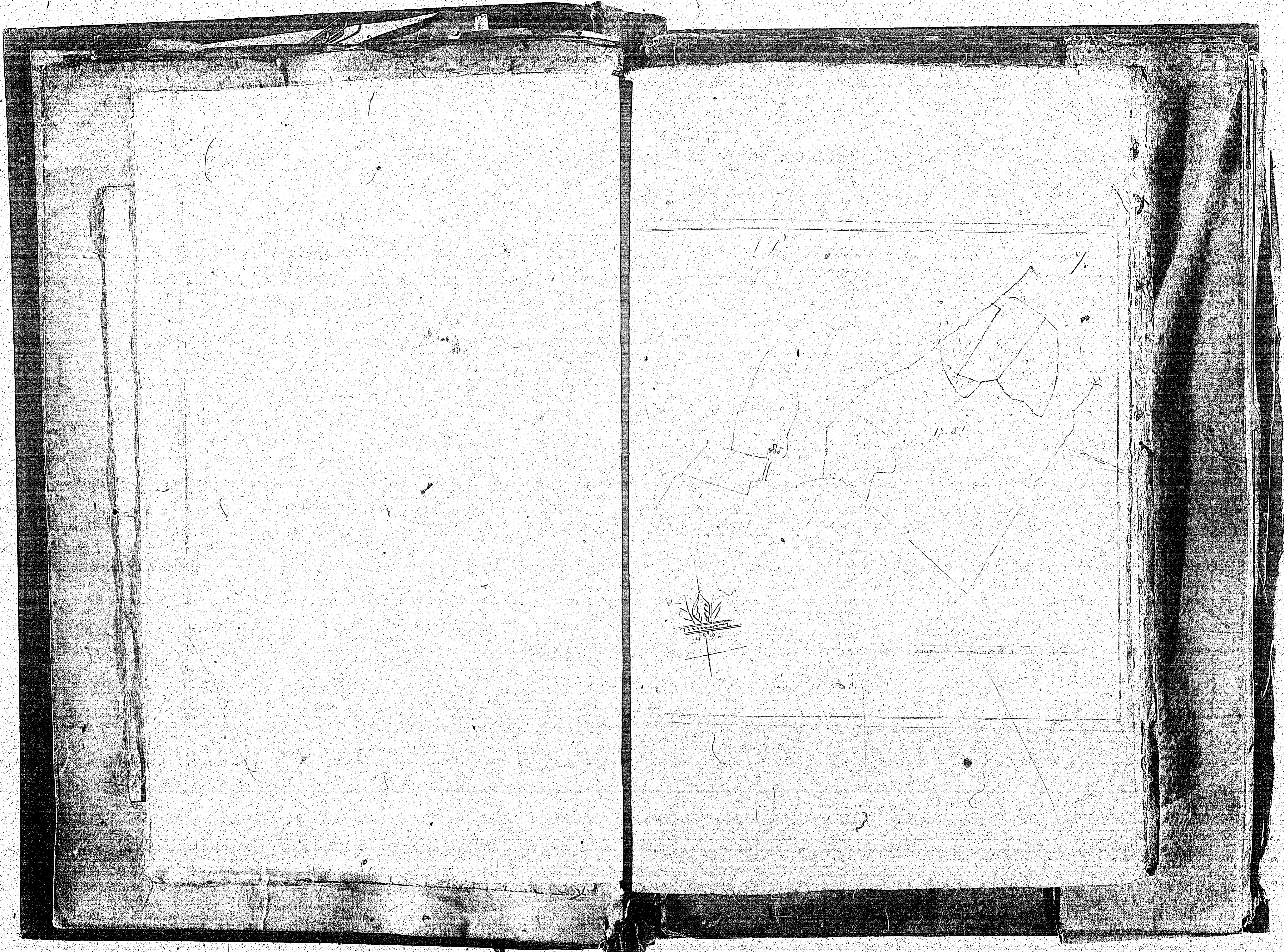



2 8

*Plan*  
of part of the  
Costale of *Darrisc*  
in the  
Parish of *Sonnan*  
surveyed by  
*W. James Breen*  
July 27<sup>th</sup> 1820

*W. Mc Kelly*

*W. J. Clague*

Two Chains & a half

*Spencer Blake Esq.*

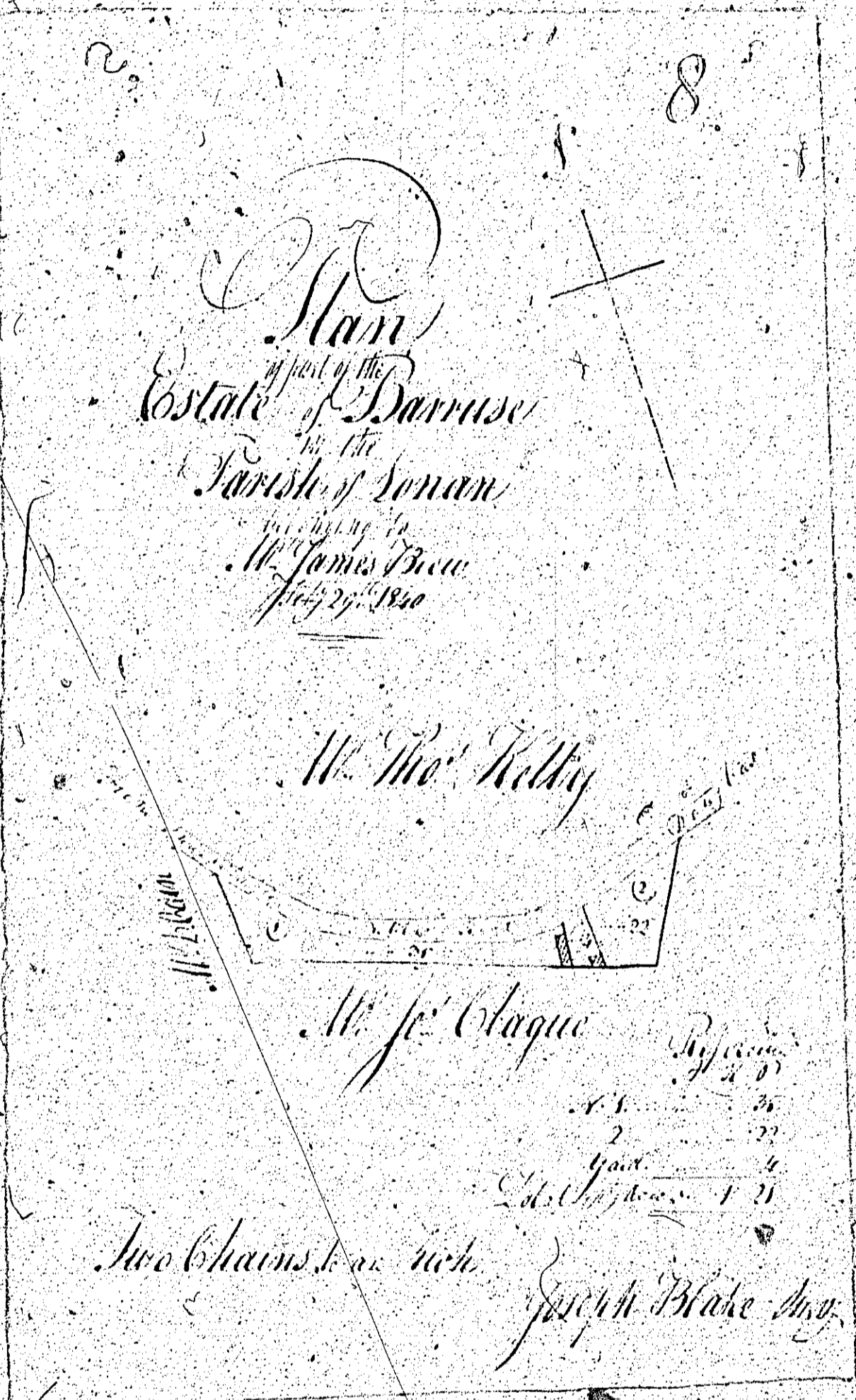



Survey  
of a house and garden  
in the village of Lacey  
Towan  
The property of  
M<sup>rs</sup> Elizabeth Banks

Content 27 pels

Scale  
Three inches to an inch

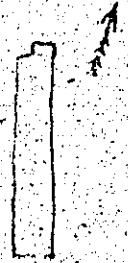

Done 1741  
Surveyed by me  
James Smith  
Towan