

147.

MAP and SURVEY of Balladromma

Signate in
L. E. L. A. R. E.
The PROPERTY of
Mr. William Surphes
and Farmed by
Nicholas Boscom.

Taken June 14. 1830.
by Samuel Fox
Surveyor.

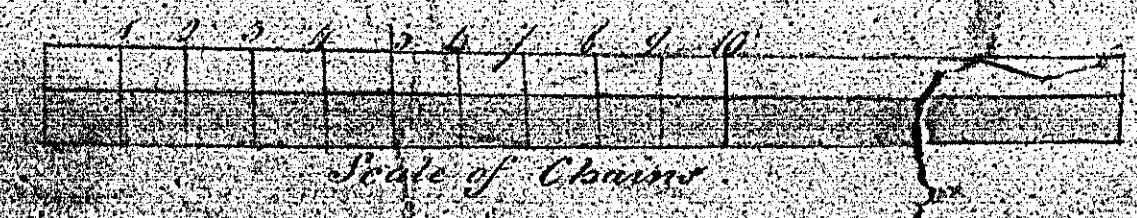
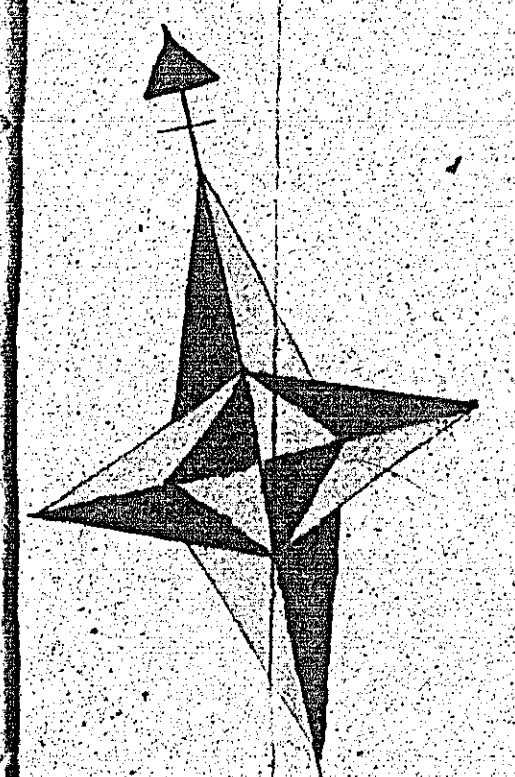
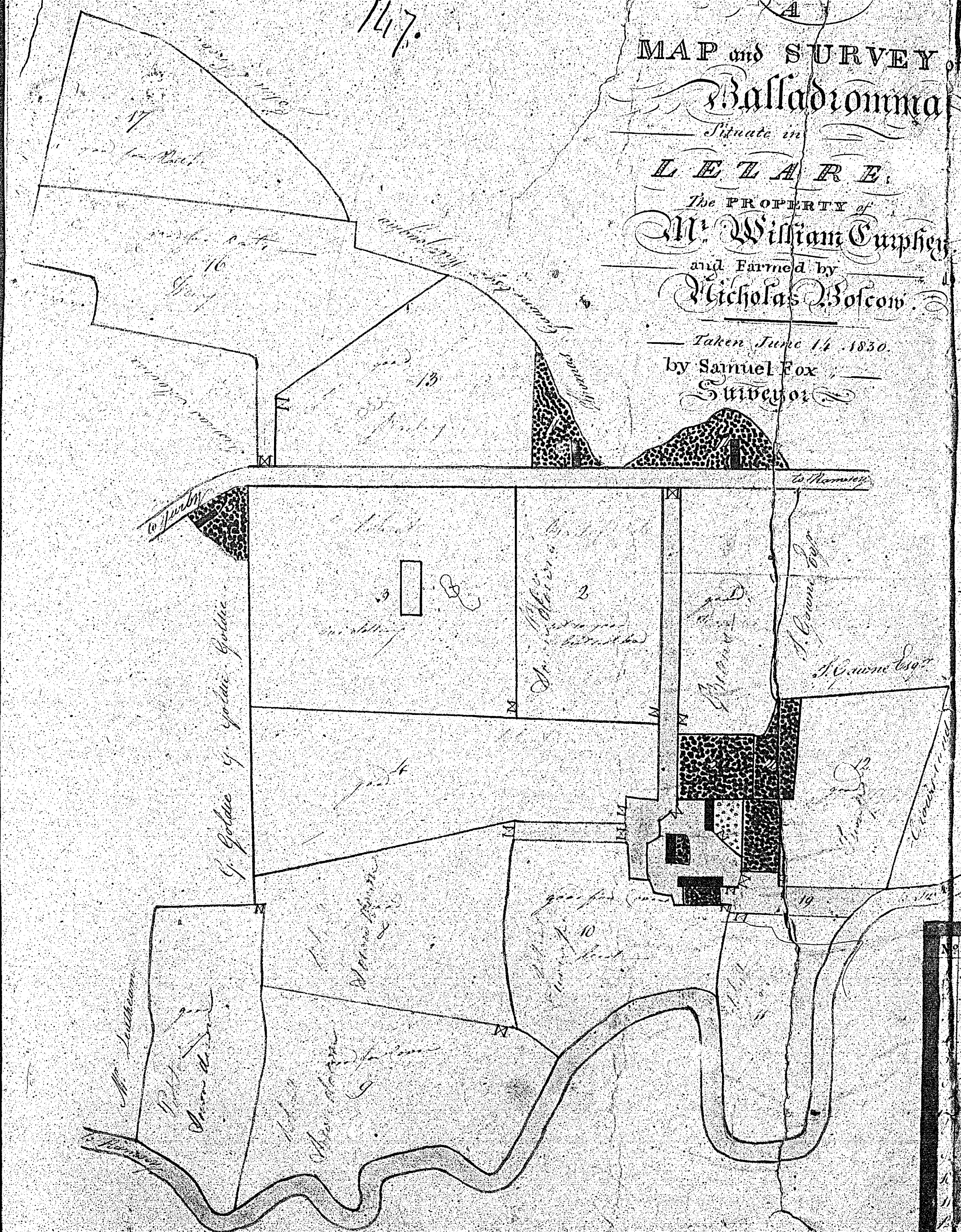

No.	A. R. P.
1	2 1/2
2	3 1/2
3	3 3/4
4	3 1/2
5	3 1/2
6	3 1/2
7	3 1/2
8	3 1/2
9	3 1/2
10	3 1/2
11	3 1/2
12	3 1/2
13	3 1/2
14	3 1/2
15	3 1/2
16	3 1/2
17	3 1/2
18	3 1/2
19	3 1/2
20	3 1/2
21	3 1/2
22	3 1/2
23	3 1/2
24	3 1/2
25	3 1/2
26	3 1/2
27	3 1/2
28	3 1/2
29	3 1/2
30	3 1/2
31	3 1/2
32	3 1/2
33	3 1/2
34	3 1/2
35	3 1/2
36	3 1/2
37	3 1/2
38	3 1/2
39	3 1/2
40	3 1/2
41	3 1/2
42	3 1/2
43	3 1/2
44	3 1/2
45	3 1/2
46	3 1/2
47	3 1/2
48	3 1/2
49	3 1/2
50	3 1/2

Bull.

J. D. Green

Not used

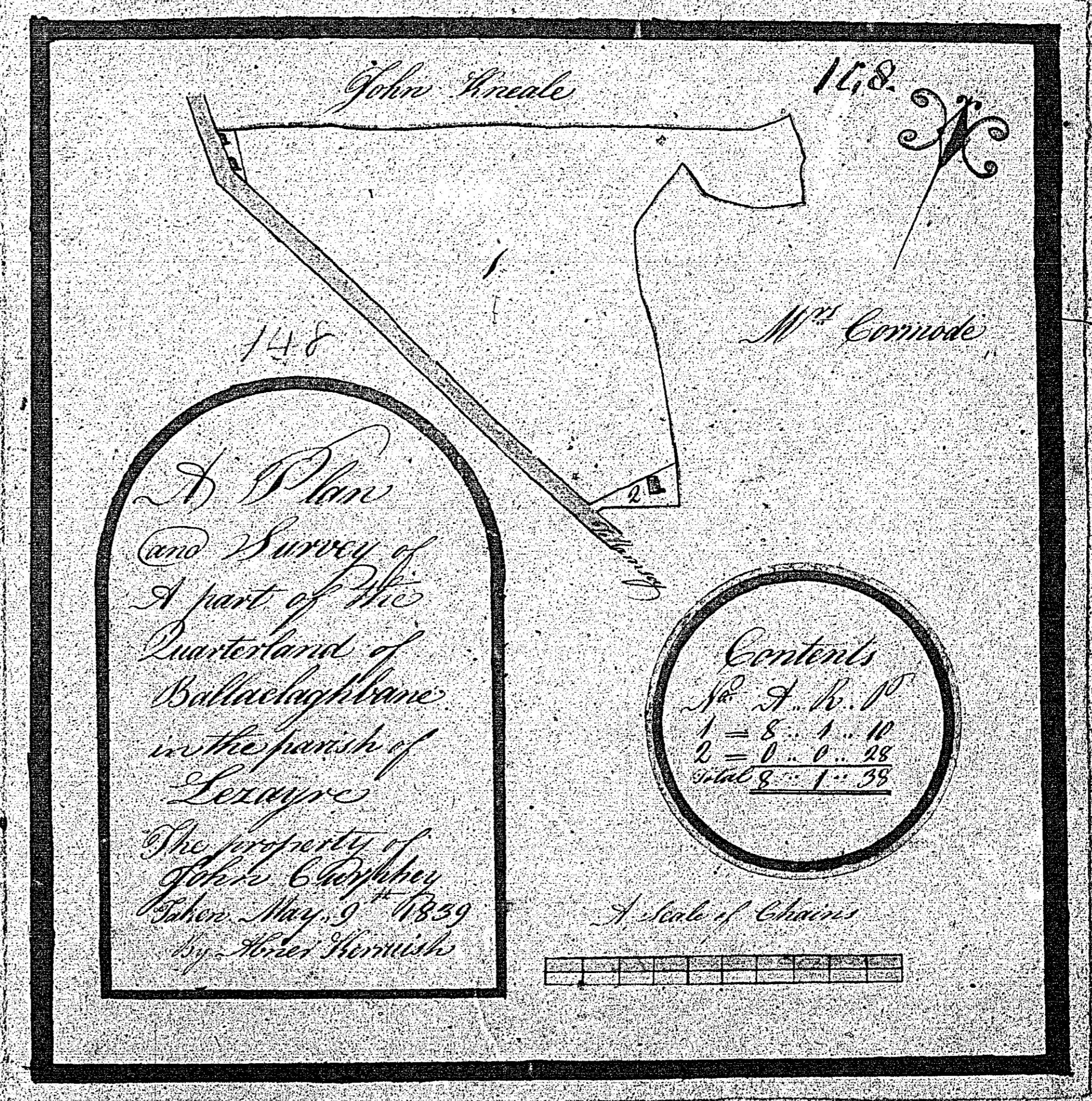

Ternycaath
Sturneyo

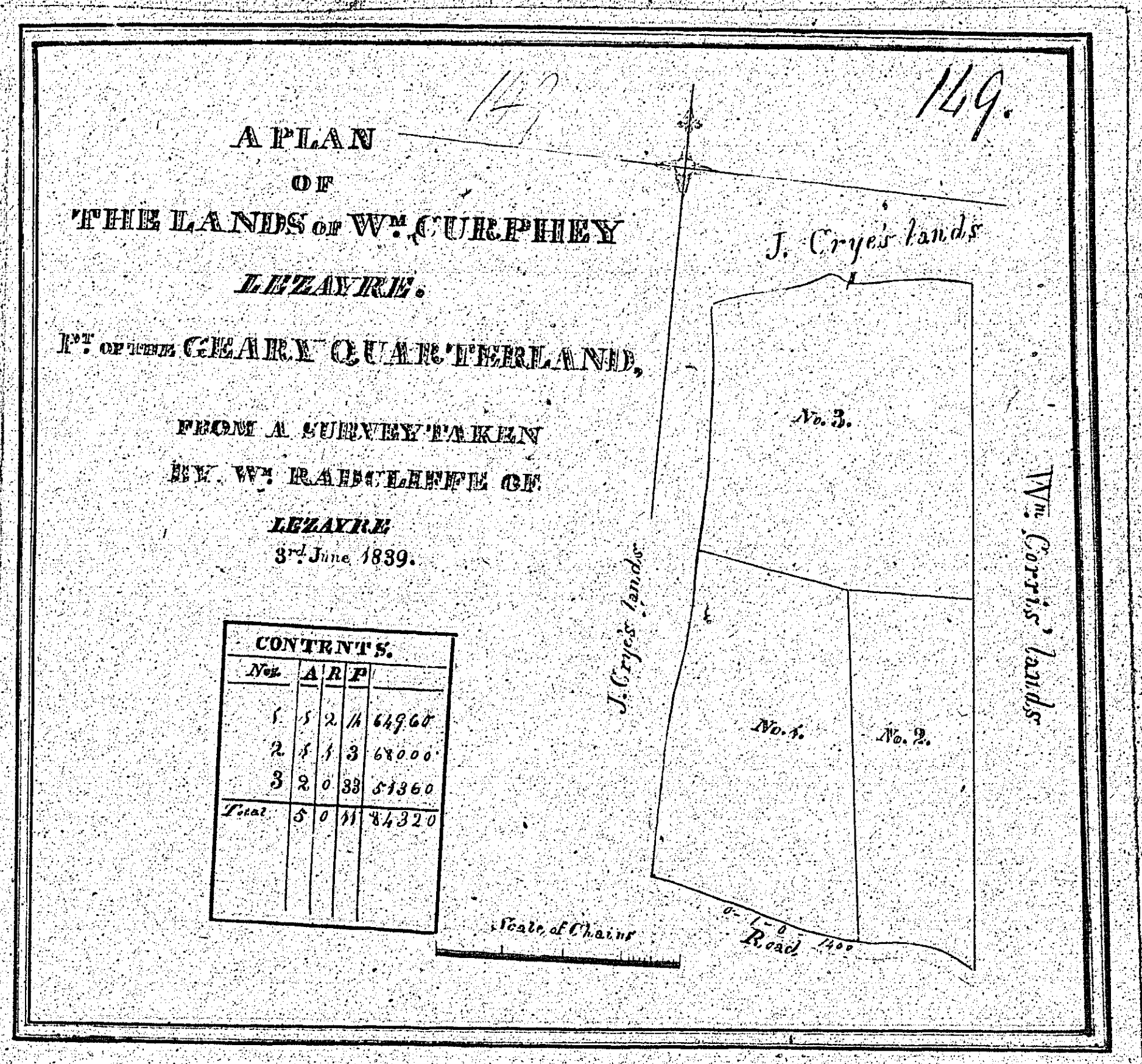

in C
Terry road
Stimney

126
0-0-9

150. ———→

W.D. Kelly

A Plan of House and Garden
belonging to — Curphy (alias)
in Ballacaley Liberties
Lepre
by John Brown
June 22. 1829

126
Terryvaath
Sturmoys

151
A Plan and survey of a
part of Chisney manor in
the parish of Loxley the
property of Edward Curphy
taken May 1st 1829
by Henry Hemmick
A scale of 2 Chains to an Inch
Wm. Stone
1829
John Heddiffe

20 Ch
Terrywall
Sturveys

ISLE OF MAN GOVERNMENT: GENERAL REGISTRY

TITHE PLANS: PARISH OF LEZAYRE

Original coloured (decorative)

1:30

Fold sewn into volume obscuring headings of
reference table

0-1-14
1-1-11
1-1-34
3-0-17

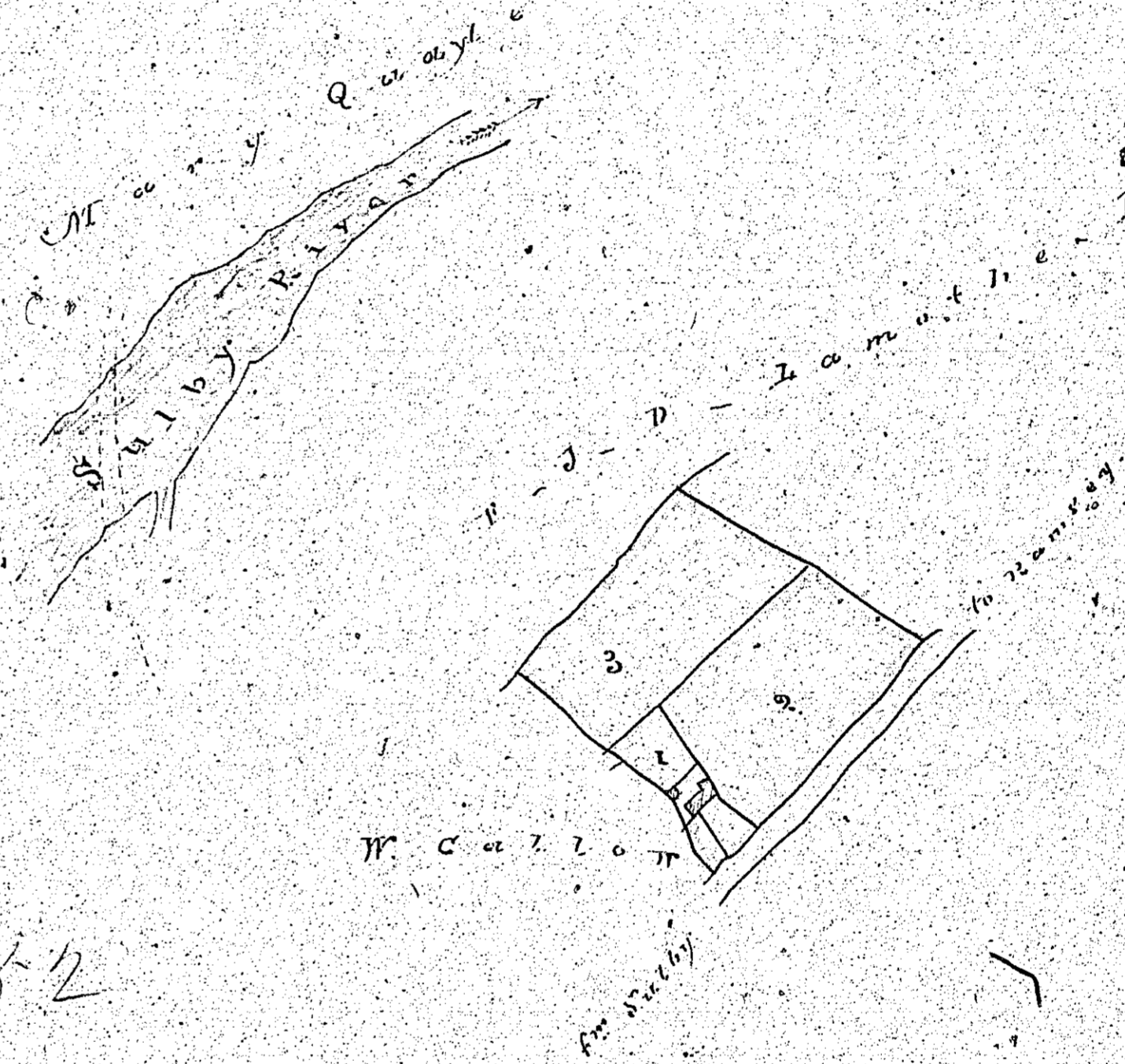

152
Rope Cottage
in
Lezayre
Vobing Stn
J. Donnellson Esq.
June 1839

Scale
H. Merryweather
Surveyor

Proprietor of Public Road 20. 28.