

142

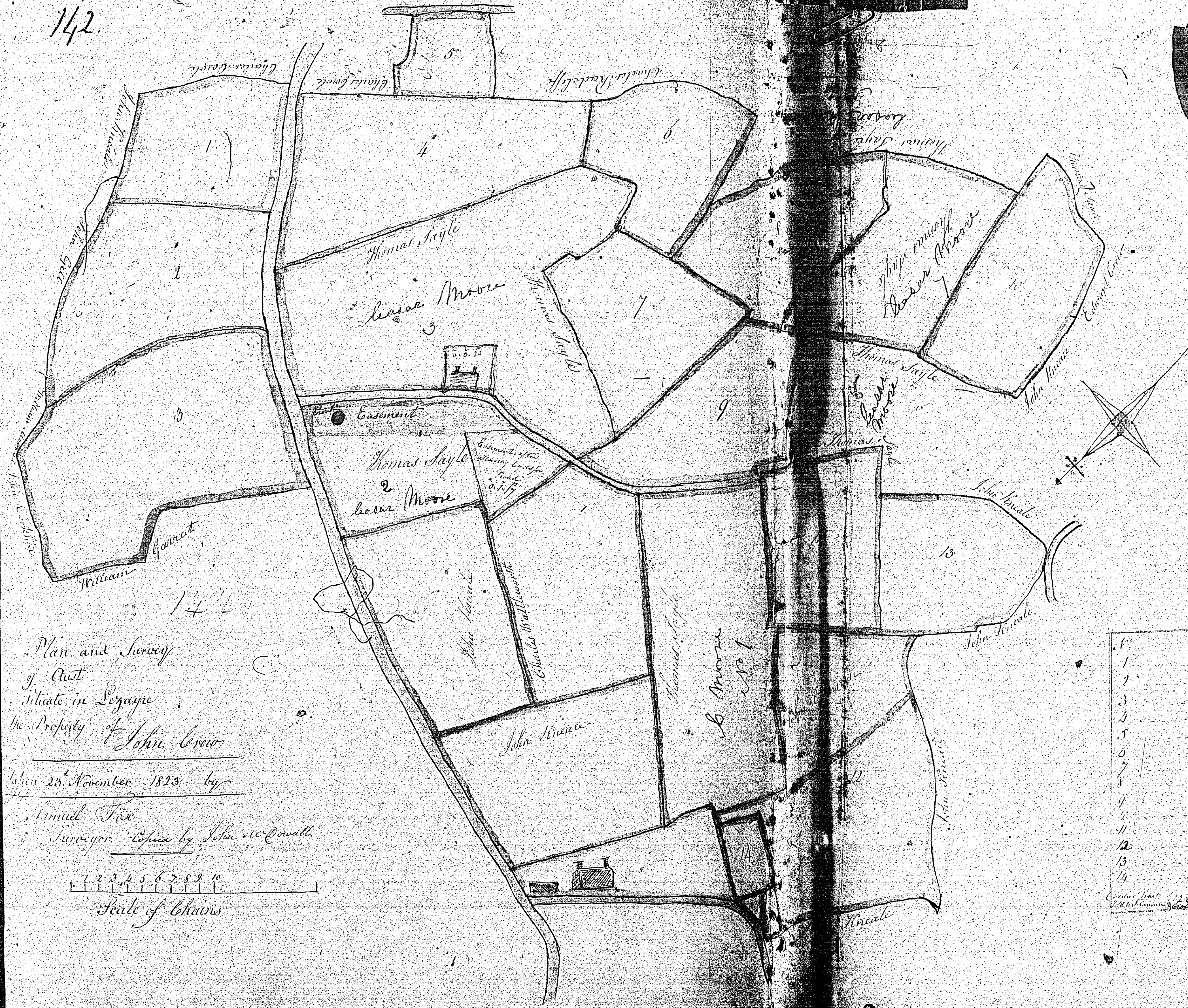

Plan and Survey
of Part
of the Estate in Lezayre
the Property of John Crow

taken 28th November 1823 by

Samuel Fox
Surveyor: Witnessed by John W. Corwall

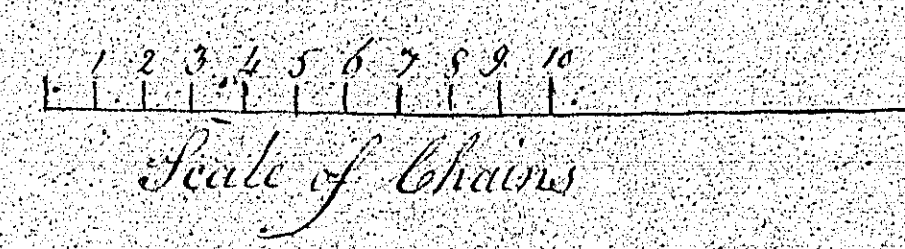

| | | |
|-------|----|---|
| 1 | 2 | 0 |
| 2 | 3 | 0 |
| 3 | 6 | 2 |
| 4 | 3 | 3 |
| 5 | 5 | 3 |
| 6 | 2 | 5 |
| 7 | 2 | 3 |
| 8 | 1 | 0 |
| 9 | 3 | 0 |
| 10 | 3 | 2 |
| 11 | 2 | 2 |
| 12 | 5 | 0 |
| 13 | 2 | 3 |
| 14 | 0 | 7 |
| Total | 44 | 2 |

WEST AUST

in
LEZAYRE

belonging to

Edmund Crow

June 1839.

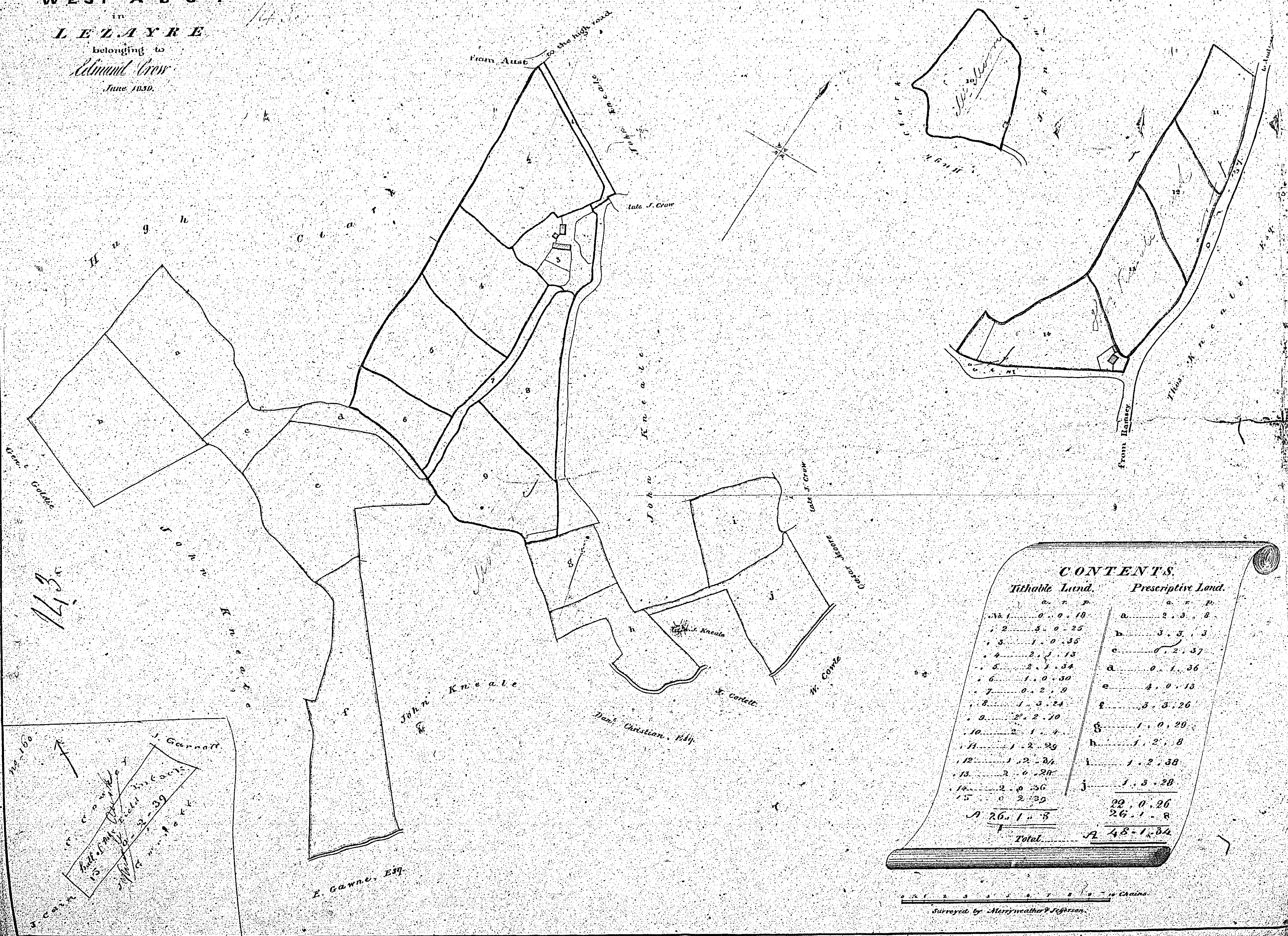

CONTENTS.

Tithable Land.

Prescriptive Land.

| | | | |
|--------------|---------------|---|----------------|
| 1 | 0.0.18 | a | 2.3.8 |
| 2 | 5.0.25 | b | 3.5.3 |
| 3 | 1.0.35 | c | 6.2.57 |
| 4 | 2.1.13 | d | 0.1.36 |
| 5 | 2.1.34 | e | 4.0.13 |
| 6 | 1.0.30 | f | 3.3.26 |
| 7 | 0.2.9 | g | 1.0.29 |
| 8 | 1.2.24 | h | 1.2.8 |
| 9 | 2.2.10 | i | 1.2.38 |
| 10 | 2.1.4 | j | 1.3.58 |
| 11 | 1.2.29 | | 22.0.26 |
| 12 | 1.2.24 | | 26.1.8 |
| 13 | 2.0.20 | | |
| 14 | 2.0.36 | | |
| 15 | 0.2.39 | | |
| Total | 26.1.8 | | 48.1.34 |

Surveyed by *Maryweather & Johnson.*

ISLE OF MAN GOVERNMENT: GENERAL REGISTRY

TITHE PLANS: PARISH OF LEZAYRE

Original coloured

1:30



ISLE OF MAN GOVERNMENT: GENERAL REGISTRY
 TITHE PLANS: PARISH OF LEZAYRE

Original coloured

1:30

J
1853

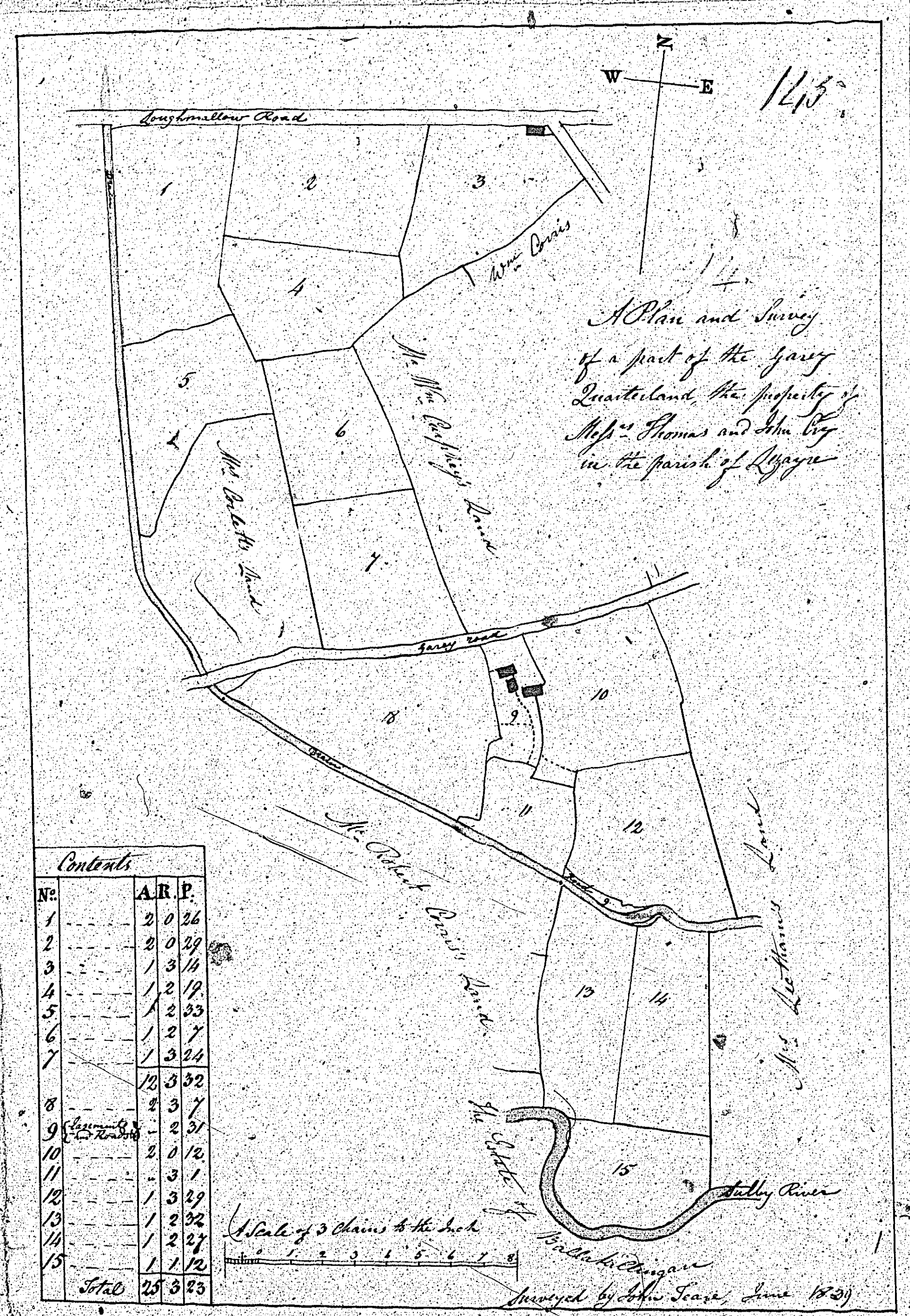

146
 Plan of Bwockemou
 in the Parish of Sexoupe
 the Property of
 W. J. Cunningham Esq
 and others

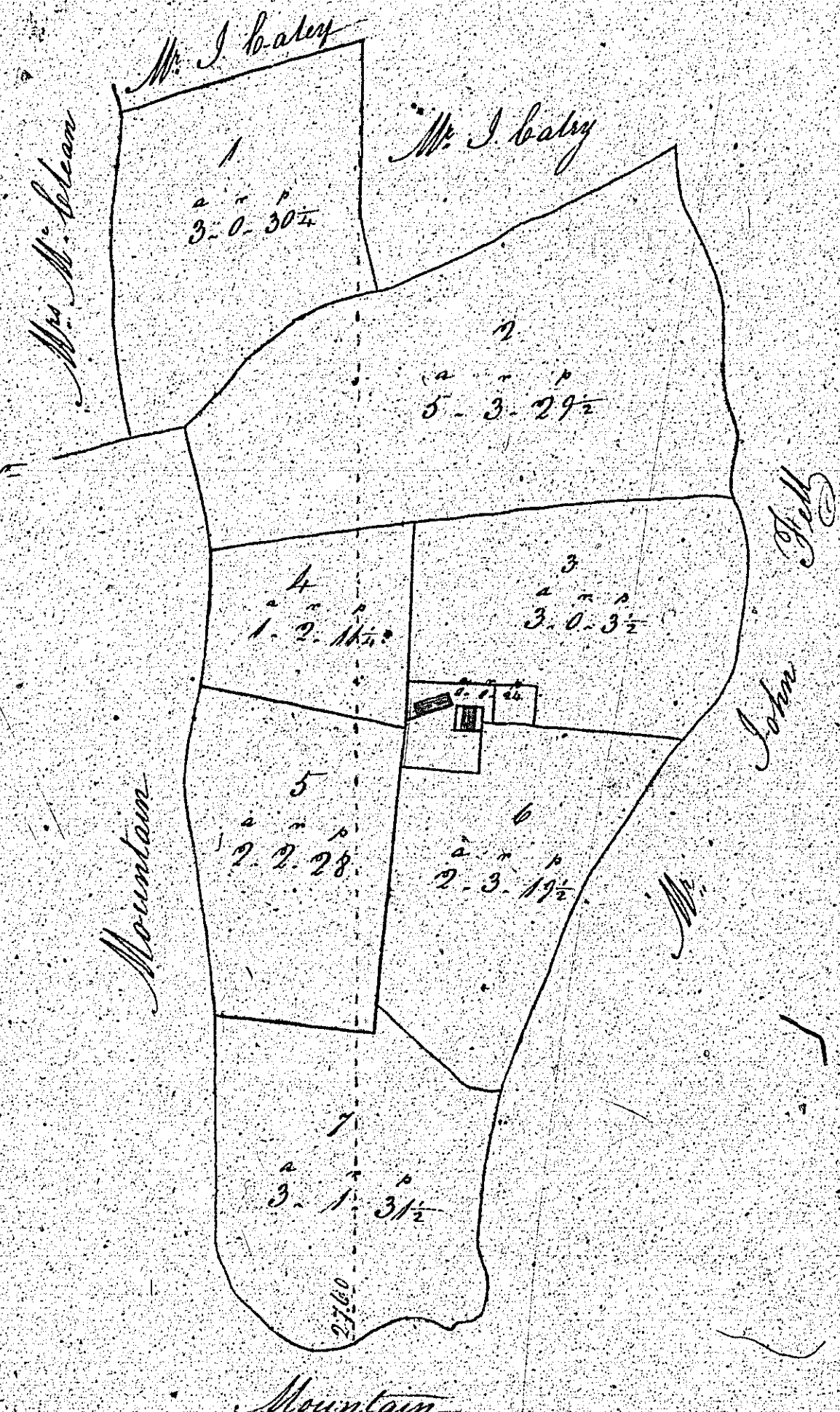

Scale of 3 Chains
 to One Inch

Consents
 23-0-17 $\frac{1}{2}$

J. Howell Surveyor
 July 1839

