

Not used

Not used

109.

Plan of a parts of Dabachunk
in the parish of Sejour
the property of
Mr. James Bourne

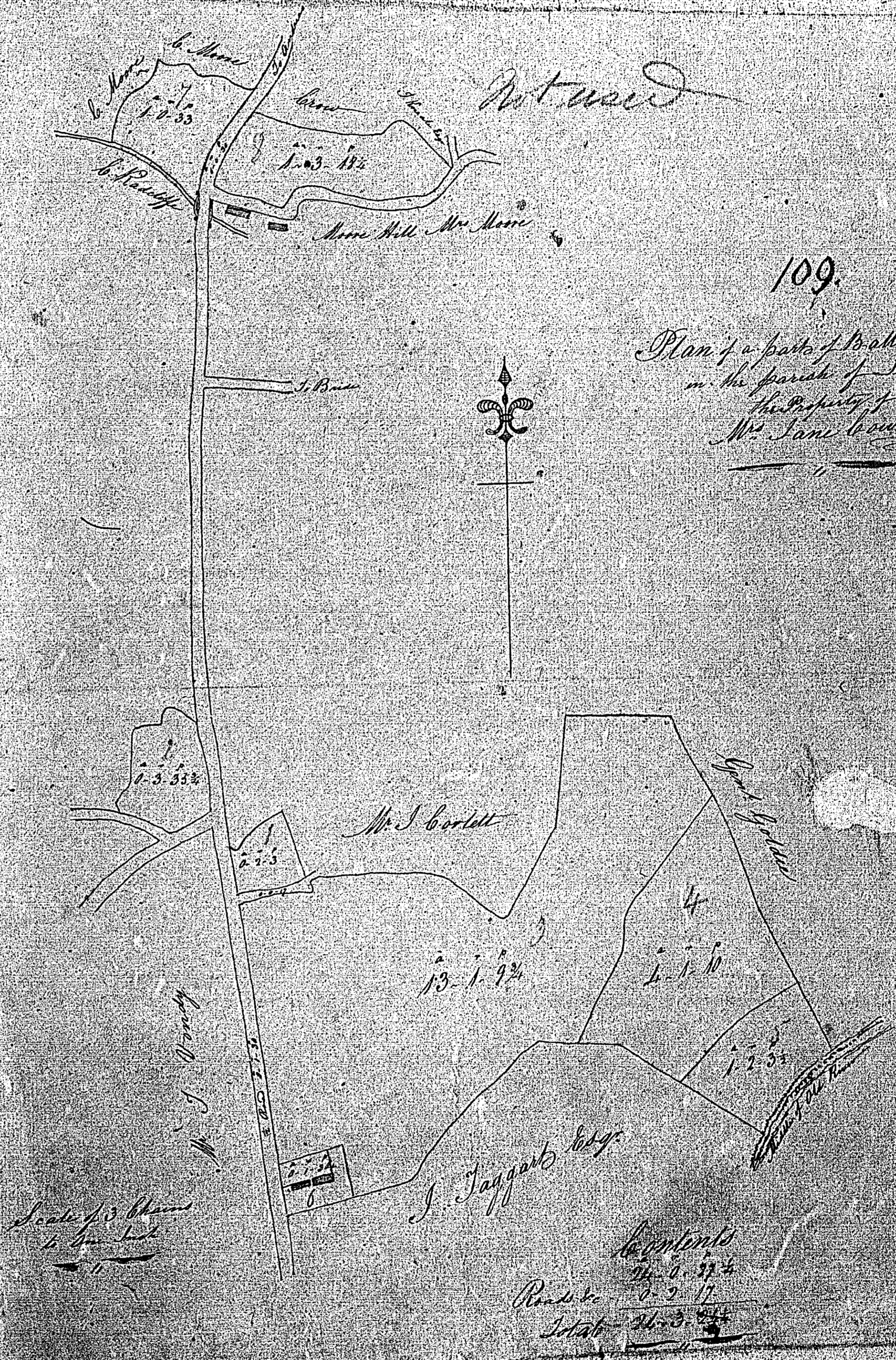

Scale of 1/2 mile

Contents
Page 1
1753
1756

Watered

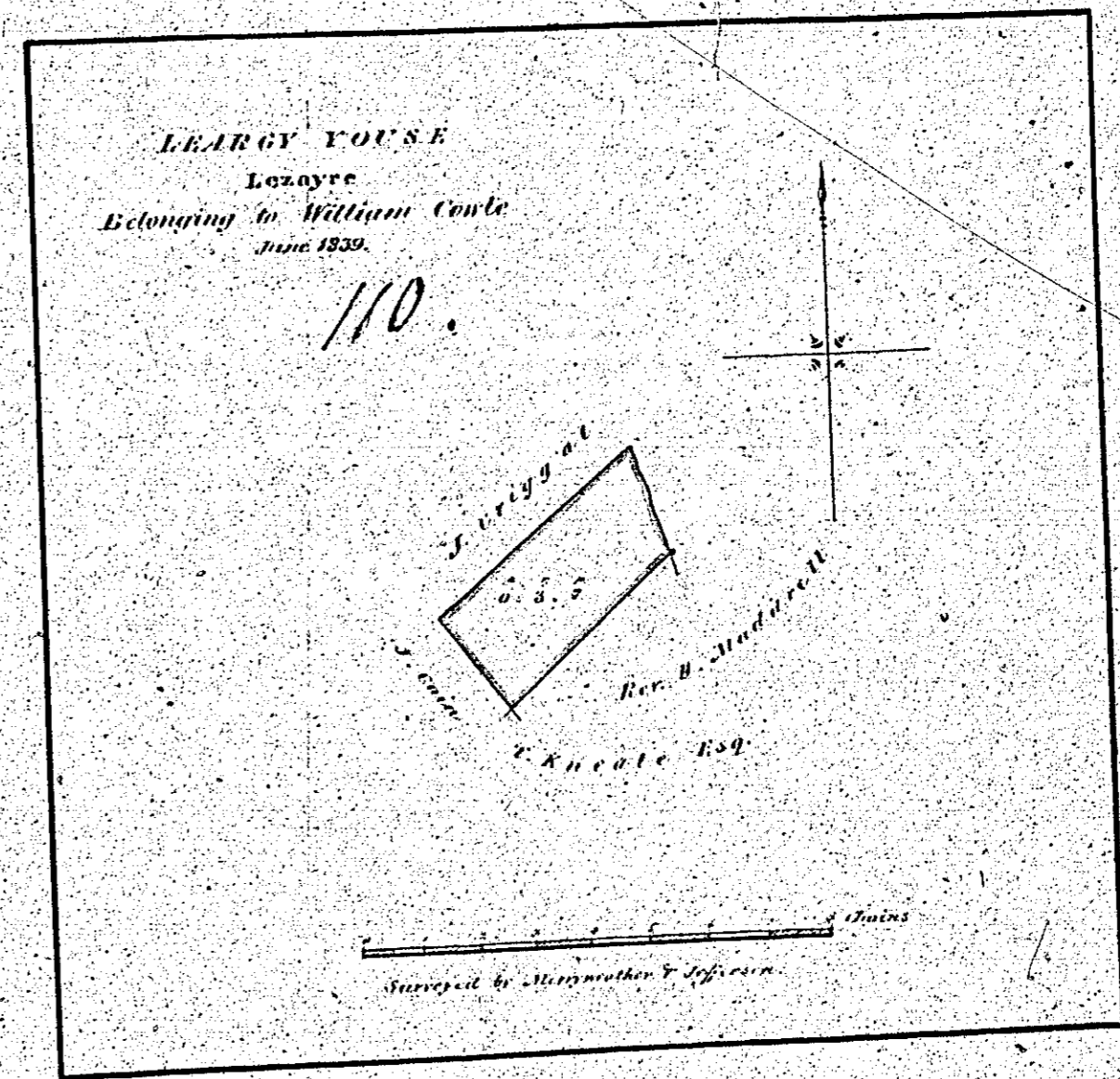

Noticed

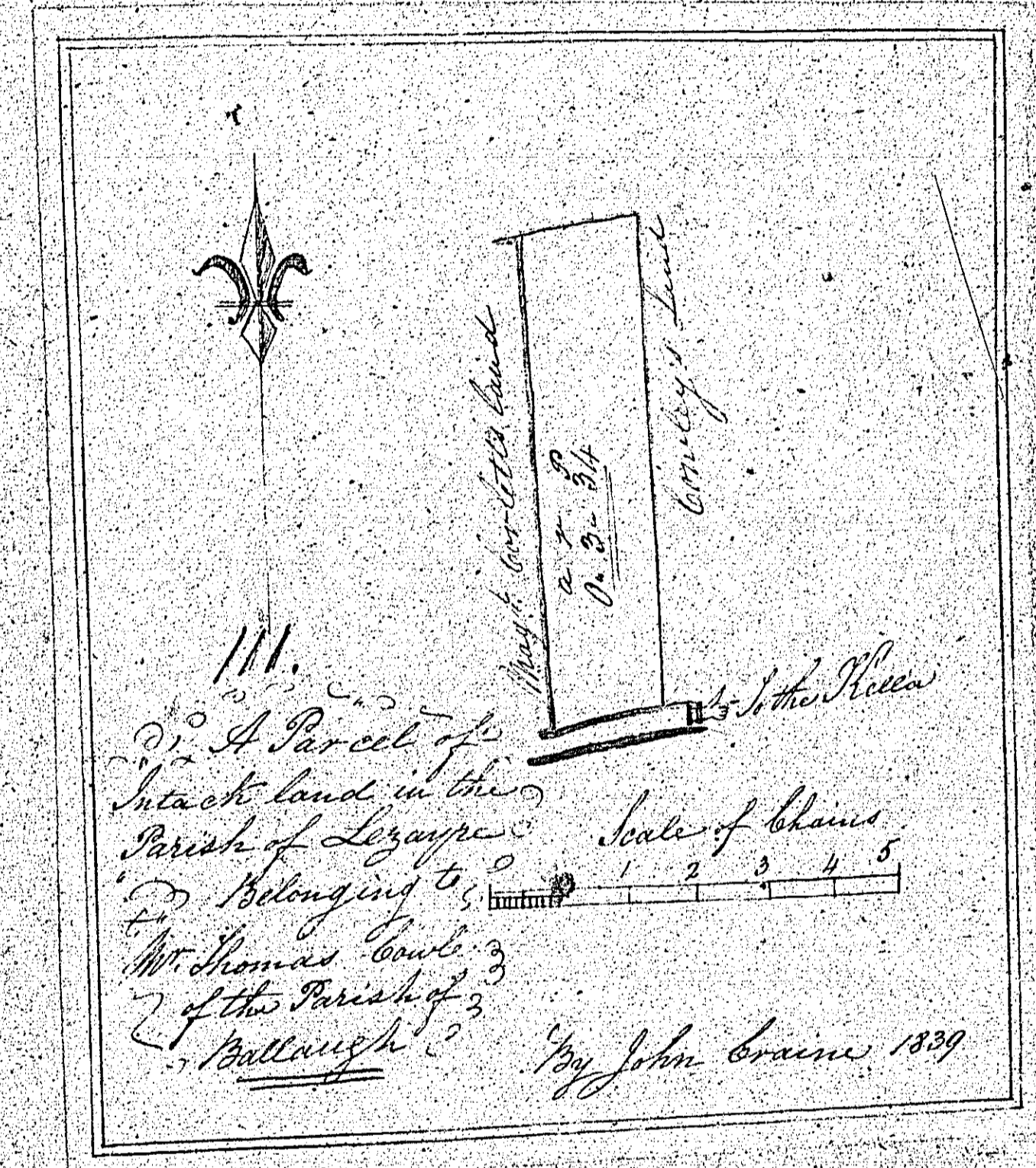

III.
 A Parcel of
 detached land in the
 Parish of Lezaype
 Belonging to
 Mr. Thomas Coulter
 of the Parish of
 Bullaugh
 Scale of chains
 0 1 2 3 4 5
 By John Crane 1839

Vol. 112

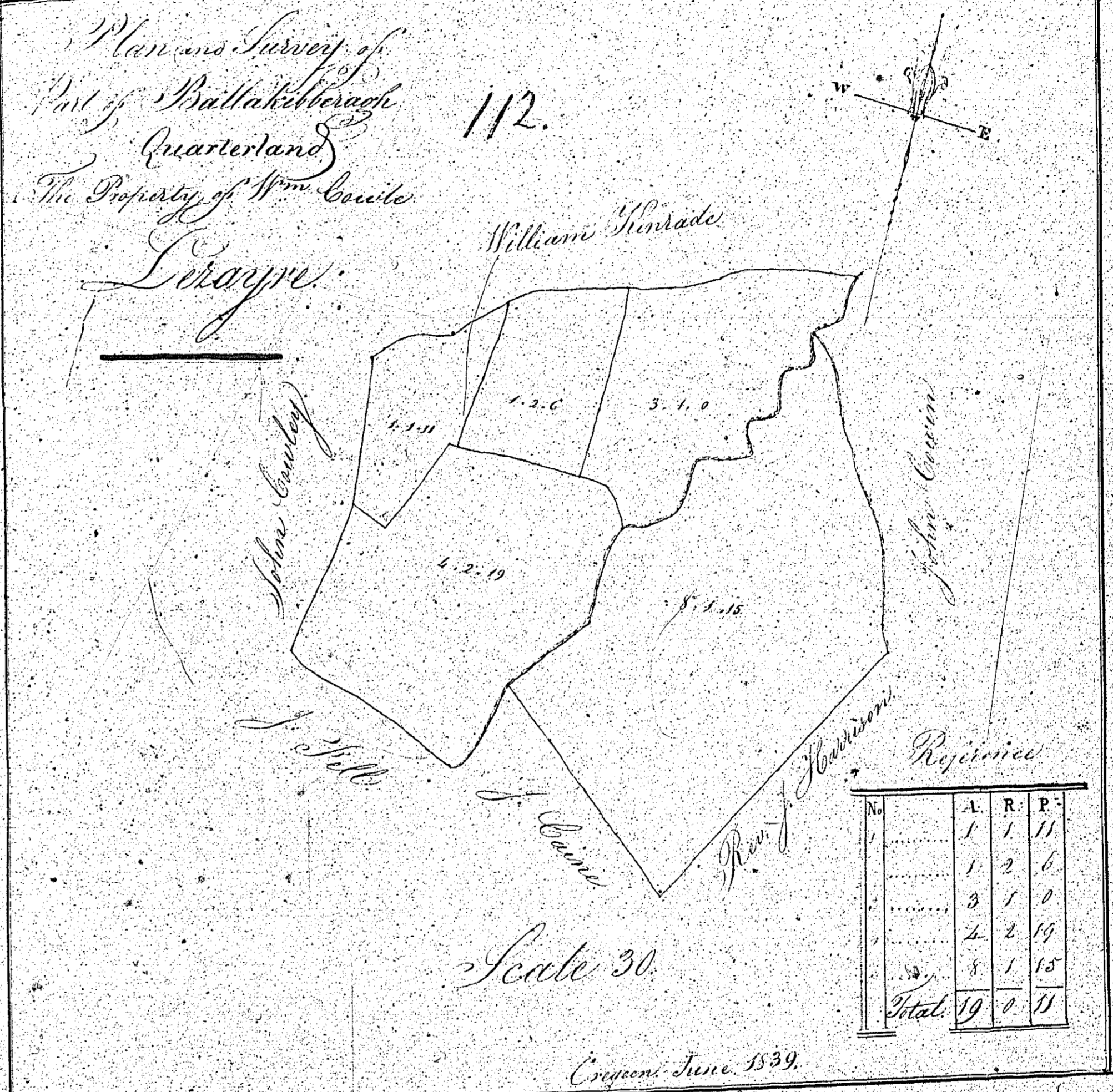

Not used

Not used

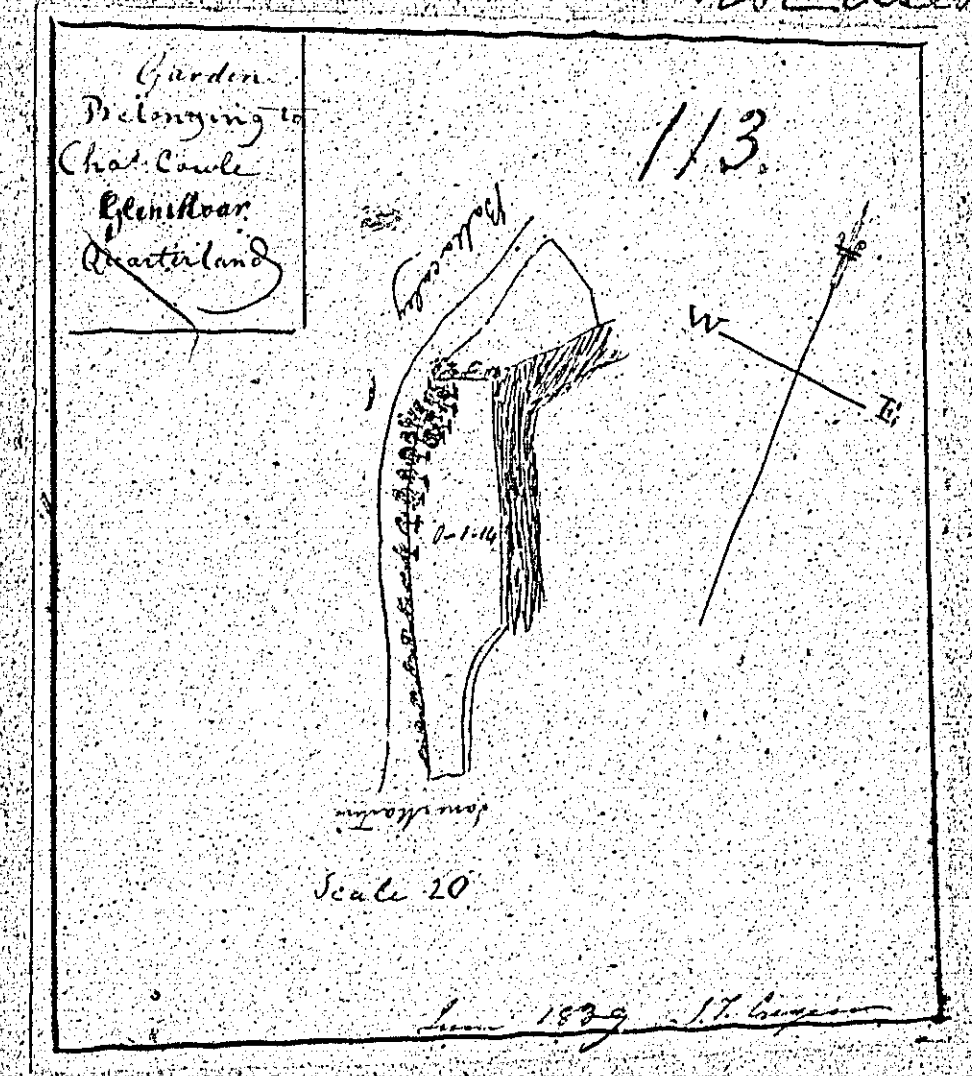

114.
 Plan and Survey
 of part of Karadal
 situated and situated
 in the parish of Laggan
 property of
 James Cowley

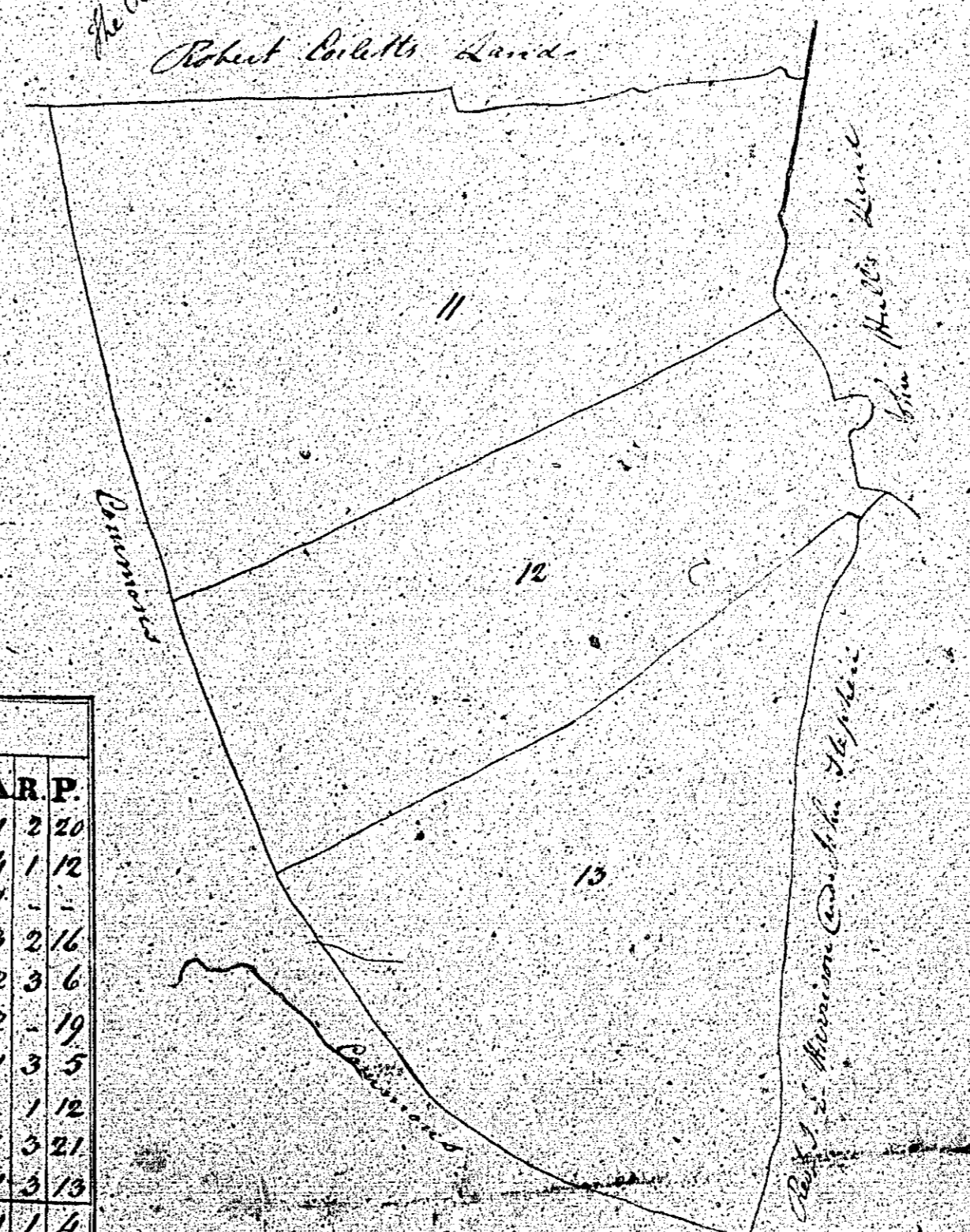
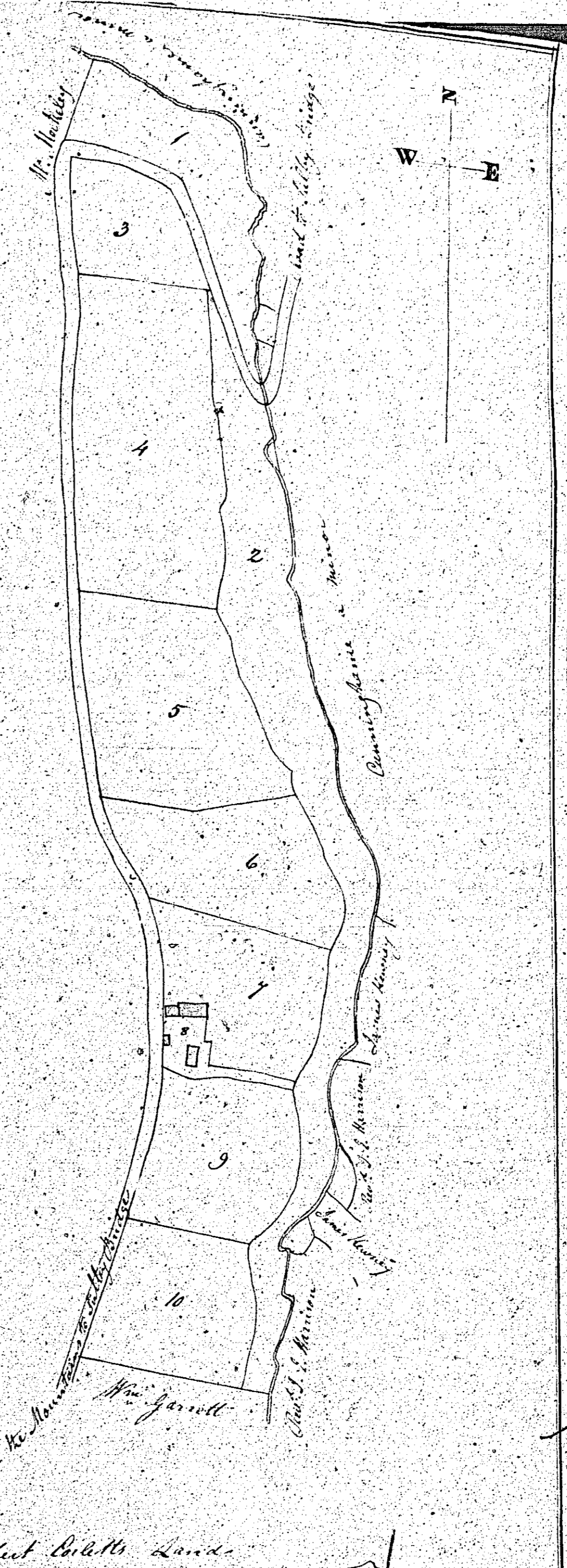

arp.

arp.	arp.
1	20
1	12
1	-
3	24
2	36
2	19
1	35
1	12
1	21
1	13
2	14
9	15
7	39
8	10
16	28

Scale of 3 Chains 8 an Inch
 By John Lane June 1839