

ISLE OF MAN GOVERNMENT: GENERAL REGISTRY

TITHE PLANS: PARISH OF LEZAYRE

Original coloured (decorative)

1:30

70.

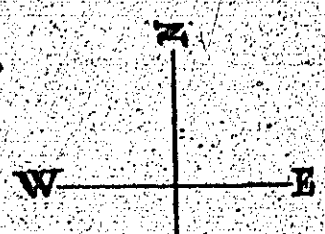

A Plan and Survey of
Mr. Collett's Land
being a part of the Grey
Quart. & lying in the
parish of Ligonier

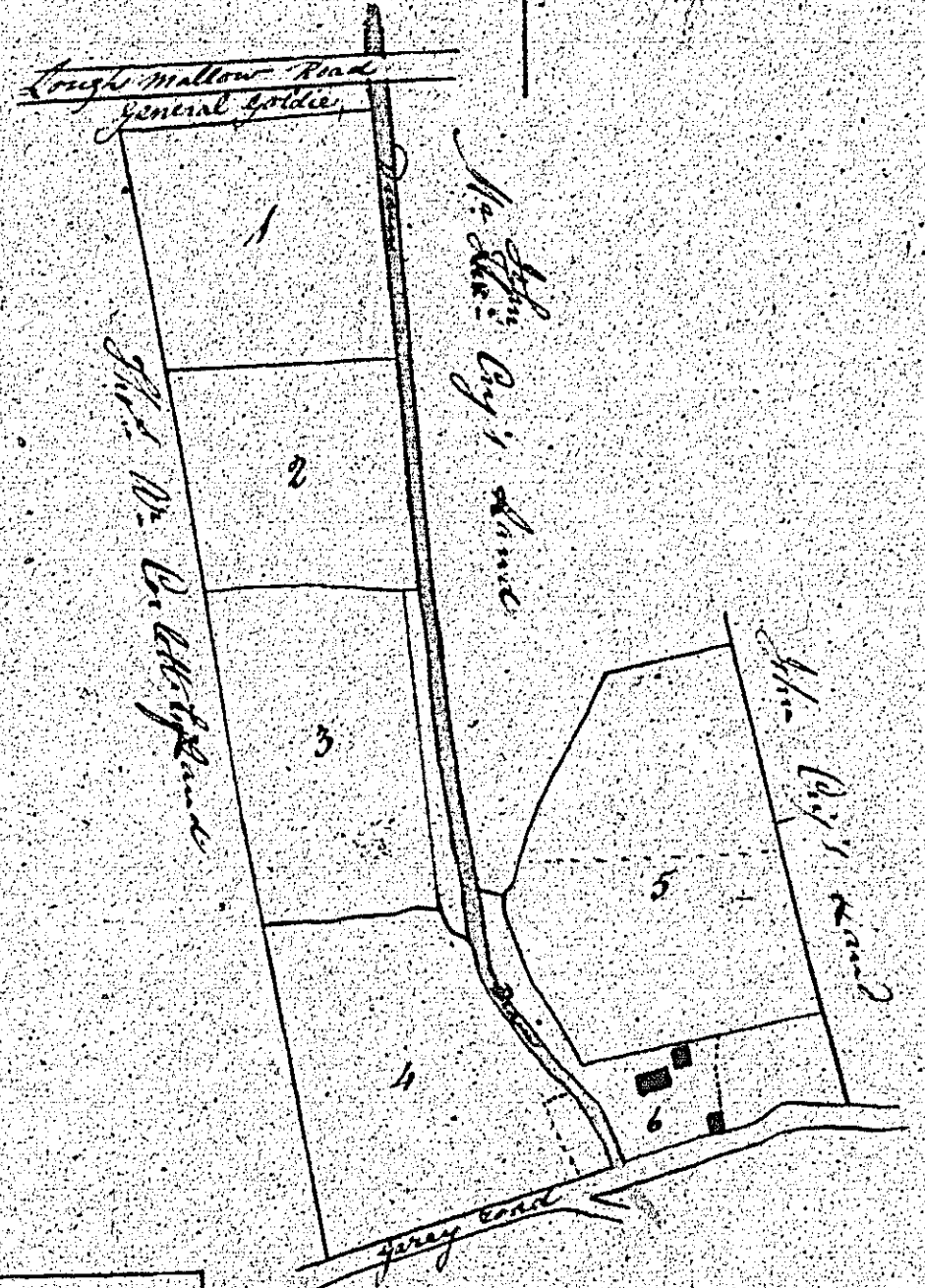

Contents		
No.	A.	R. P.
1	1	1 3/4
2	1	1 0
3	1	2 6
4	1	3 4
5	2	1 7
6	0	3 20
Total	9	0 36

A Scale of 3 Chains to the Inch

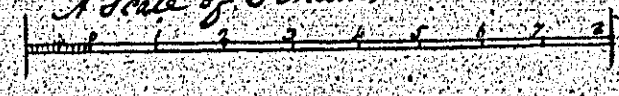

By John Jones June 1809

PLAN
 of
 71. THALLOO CURRY.
 The Property of
 THOMAS ARTHUR CORLETT ESQUIRE.
 Situate in the Parish of
 LEZAYRE.

Copied from a former survey, by J. PARVIS.

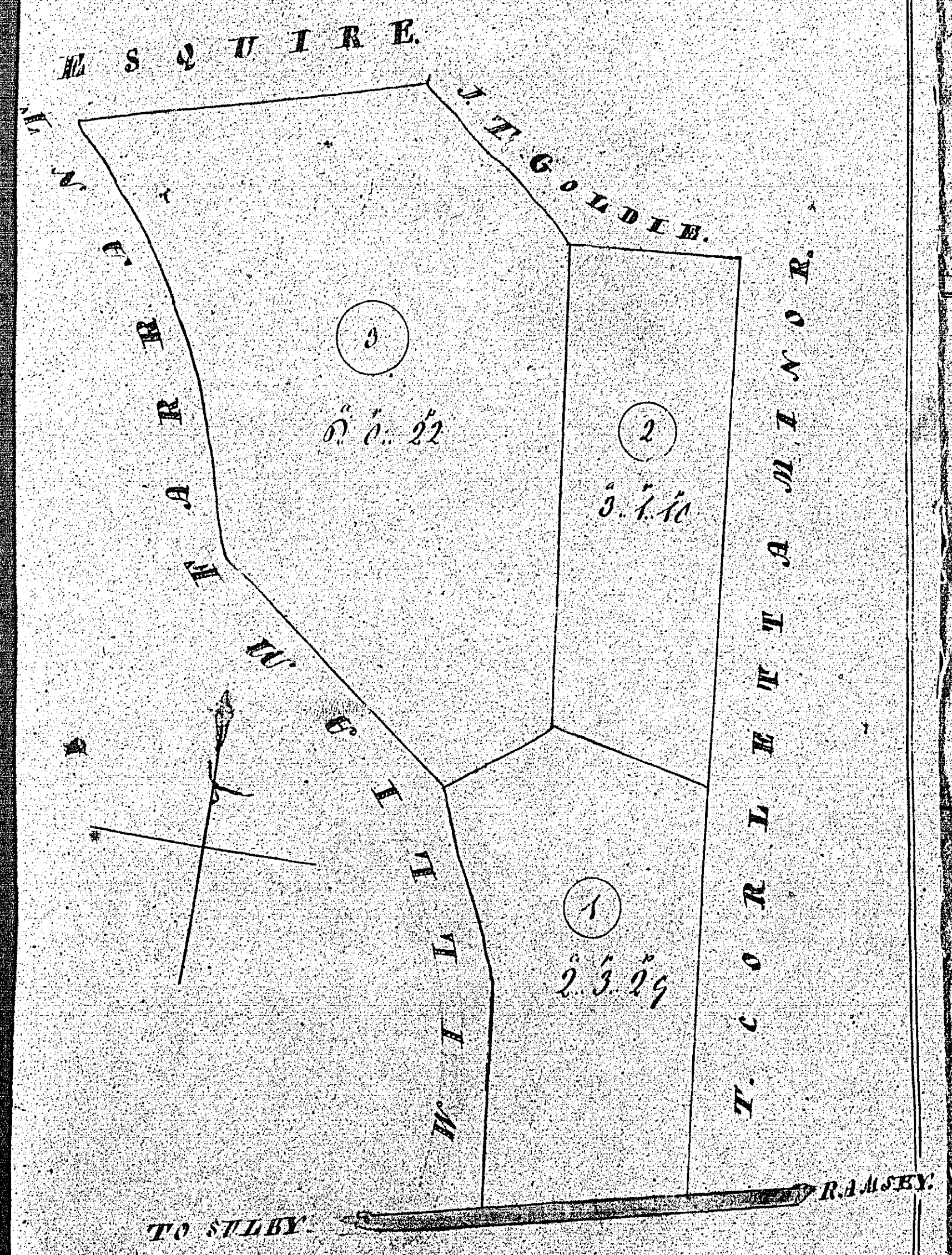

TOTAL $12.1.11$

SCALE OF CHAINS

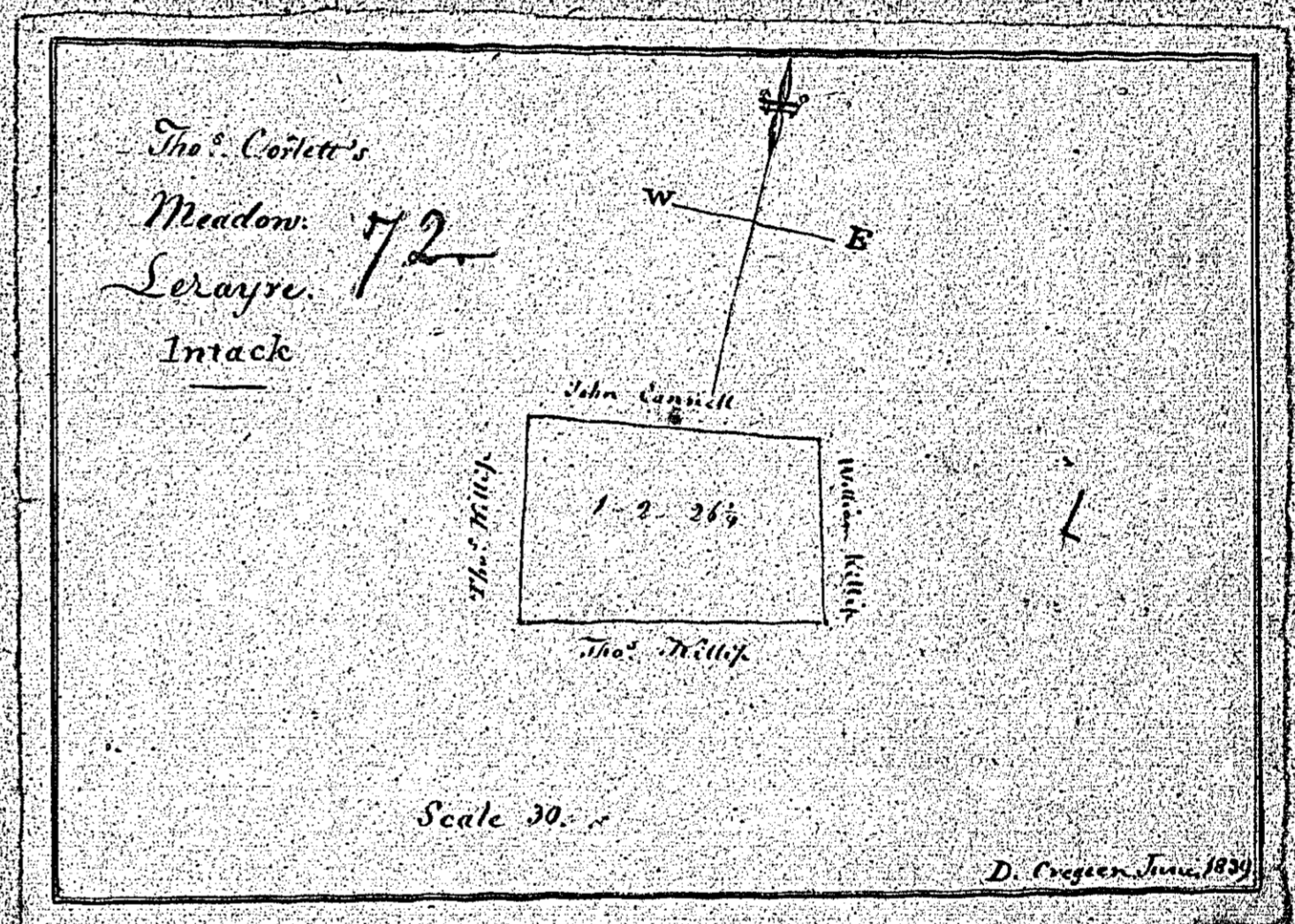

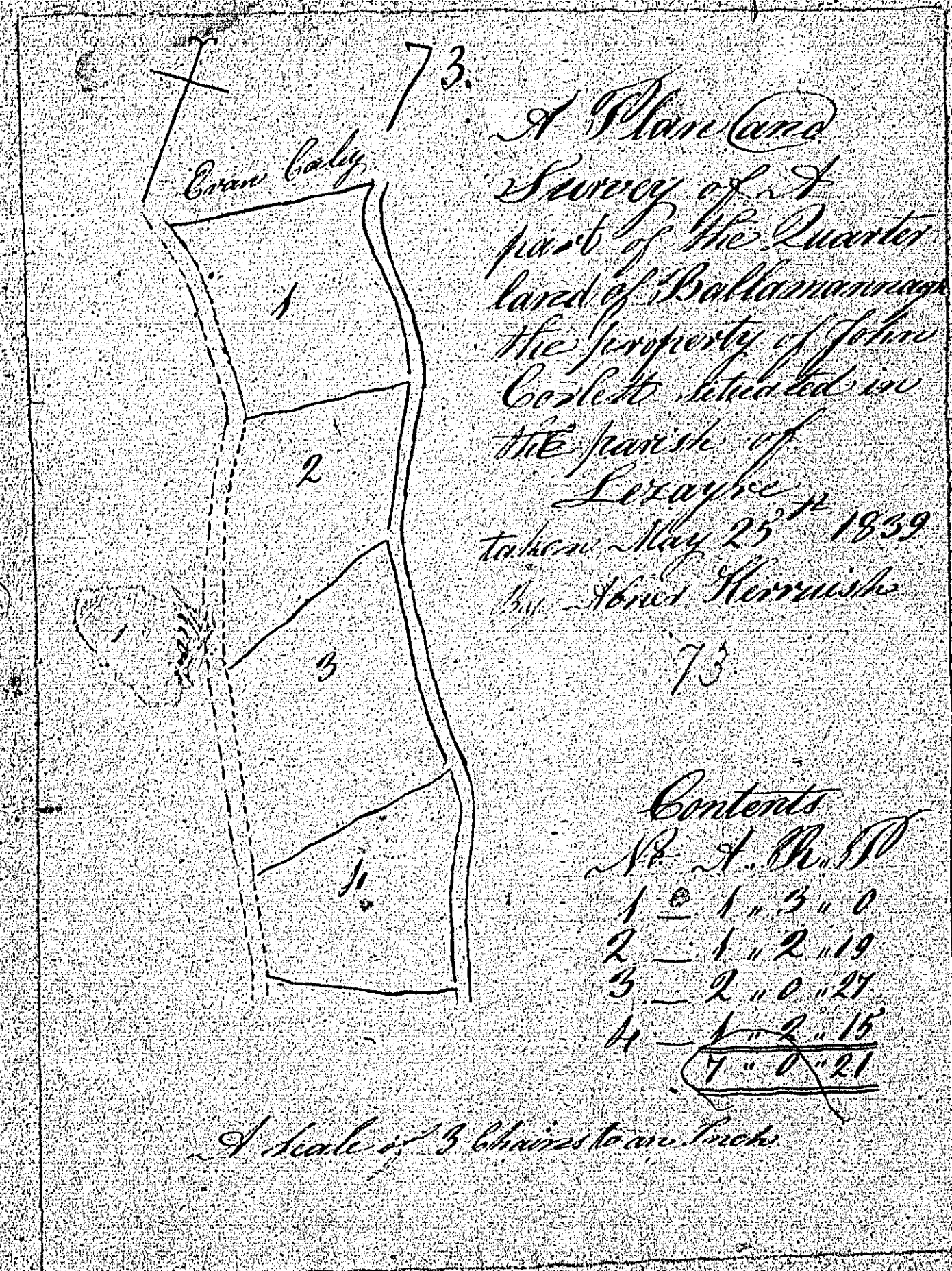

74

PLAN
OF
TOWNSHIP
OF BALLYGARRA TOWNSHIP

1837

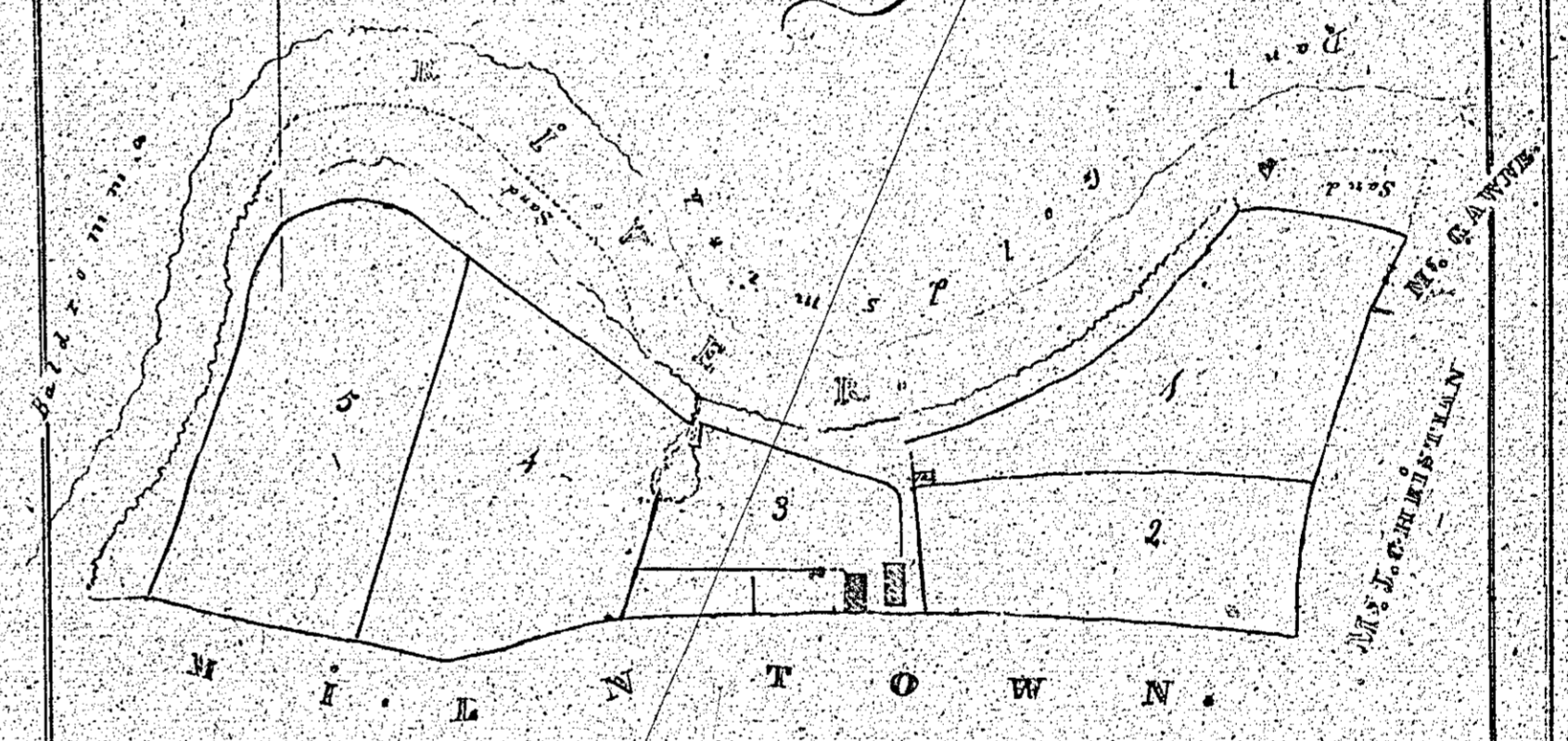

Plot	A.	R.	P.	D. per
1	0	3	37	12000
2	0	3	24	10000
3	0	1	12	4000
4	10	3	21	12000
5	0	3	37	6400
Total	10	13	71	79200
Garden	0	0	19	20000

Scale
Six of the above Roads become in
A. R. P.

From a Survey taken 21. June 1839 by W. Rodd & Co. Surveyors