

Shard



A Plan and Survey of a part of
 Ballagarybeg in the parish of
 Jurby the property of Phillip Black
 taken March 27. 1810 by Wm. Marshall

Contents

No.	A.	R.	P.
1	4	1	31
2	5	1	15
3	6	1	68
4	4	4	24
5	5	4	36
6	5	1	19
7	4	2	15
8	2	2	37
9	2	0	21
10	3	2	36
11	1	2	22
12	2	2	35
13	1	3	23
Gardens	0	2	3
14	1	2	32
15	1	0	38
16	1	0	28
17	4	1	33
18	6	2	14
19	2	3	23
Total	76	0	24

Scale of Chains to an Inch

ISLE OF MAN GOVERNMENT: GENERAL REGISTRY

THE PLANS: PARISH OF JURBY

Original coloured

1:30

PLAN

OF

THE ESTATE
OF
JURBY

17

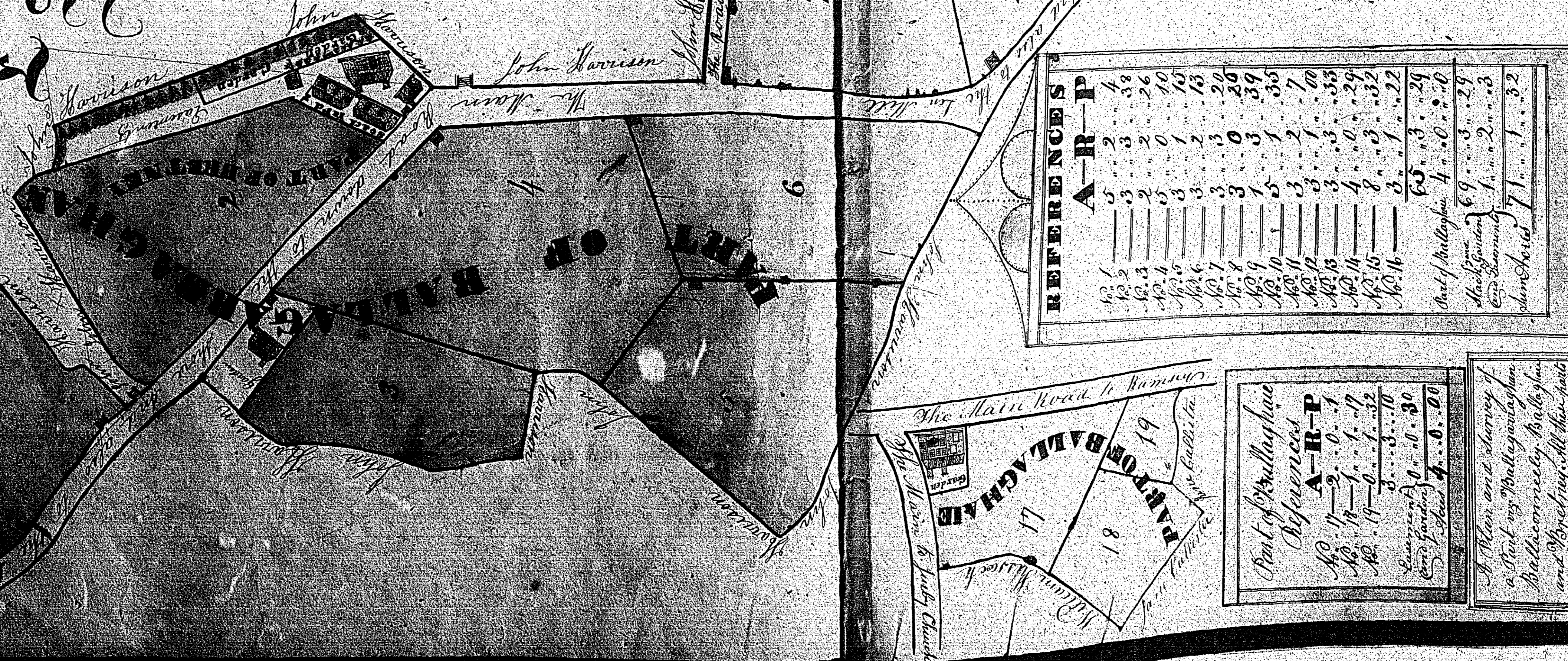
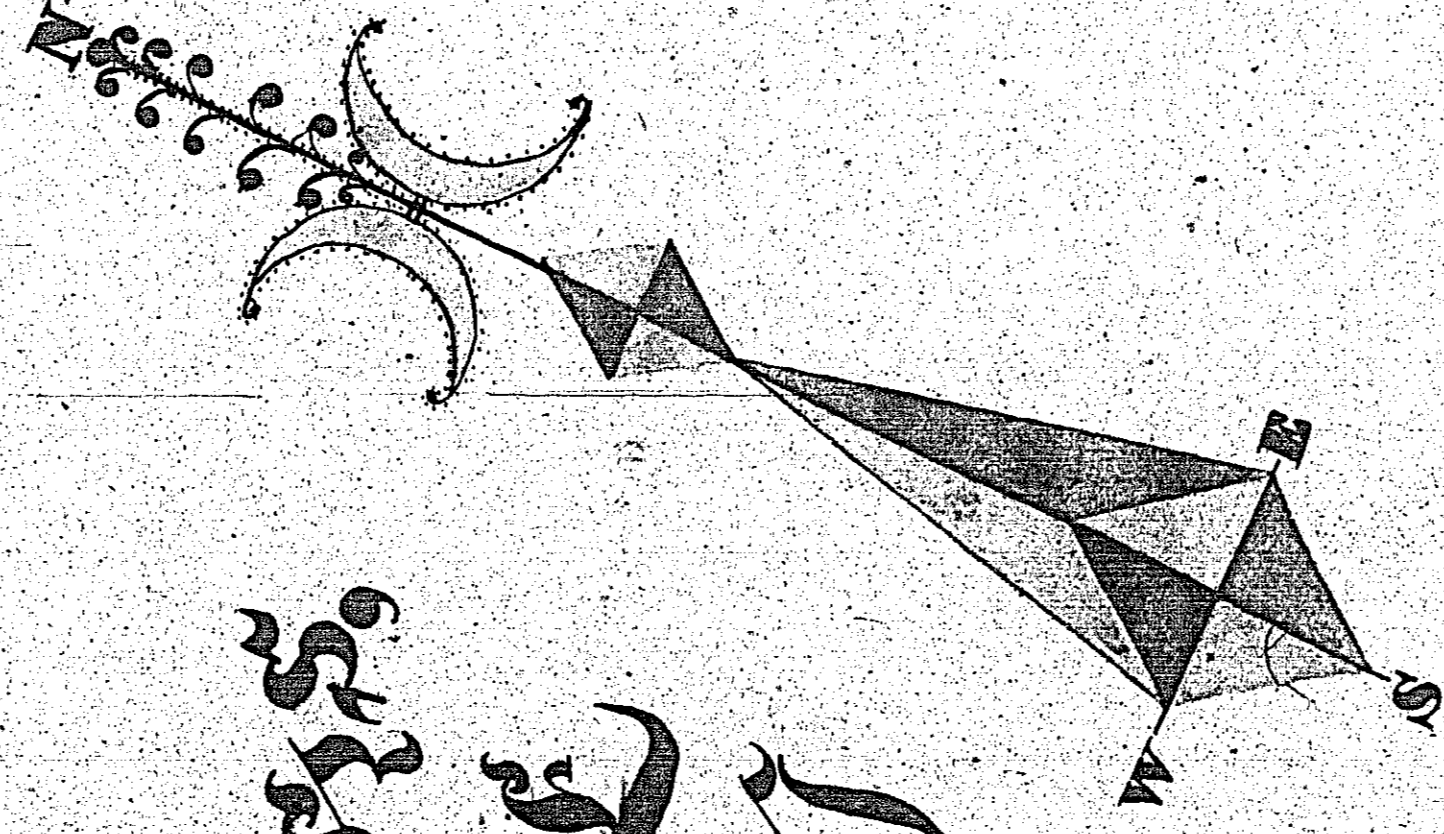

REFERENCES	
A	R-P
Ap. 1	5
Ap. 2	2
Ap. 3	3
Ap. 4	2
Ap. 5	3
Ap. 6	3
Ap. 7	3
Ap. 8	3
Ap. 9	1
Ap. 10	5
Ap. 11	3
Ap. 12	3
Ap. 13	3
Ap. 14	4
Ap. 15	3
Ap. 16	3
Total of Ballaghch. 40.0.0	
The Glebe 69.3.29	
The Glebe 1.2.29	
The Glebe 1.2.29	
The Glebe 1.1.32	

Part of Balraghch References	
A	R-P
Ap. 1	2
Ap. 2	0
Ap. 3	1
Ap. 4	1
Ap. 5	1
Ap. 6	1
Ap. 7	1
Ap. 8	1
Ap. 9	1
Ap. 10	1
Ap. 11	1
Ap. 12	1
Ap. 13	1
Ap. 14	1
Ap. 15	1
Ap. 16	1
Total of Balraghch. 16.0.0	
The Glebe 4.0.0	

All the parts of Balraghch are surveyed twice and that part of it three times to save the work more correct. And the calculations thereof is made up by Robertson by Daniel Caley Junr. Last September July 30. 1840

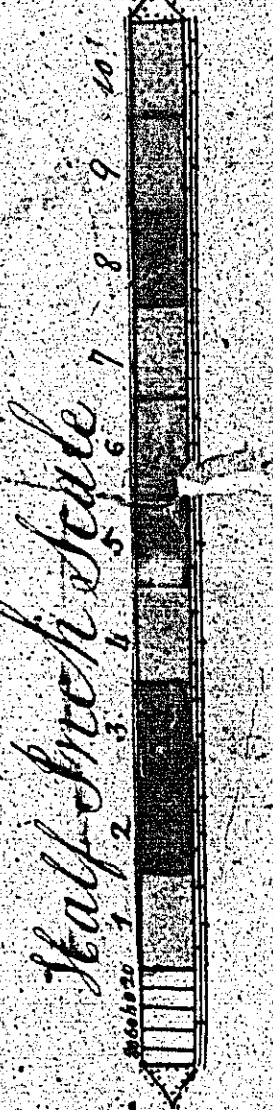

When one survey of a Plot is made in Balraghch the other is made in the Parish of Jurby. All the parts of Balraghch are surveyed twice and that part of it three times to save the work more correct. And the calculations thereof is made up by Robertson by Daniel Caley Junr. Last September July 30. 1840

A Plan and Survey of a part
of Ellan Rackabiddy in the
parishes of Skullaugh and Jasby
the property of William Cleator
taken April 22nd 1840
by James Hervey

Contents	
A. B. & C. D.	
1	1.. 2.. 31
2	0.. 3.. 39
3	1.. 1.. 21
	<u>4.. 0.. 11</u>

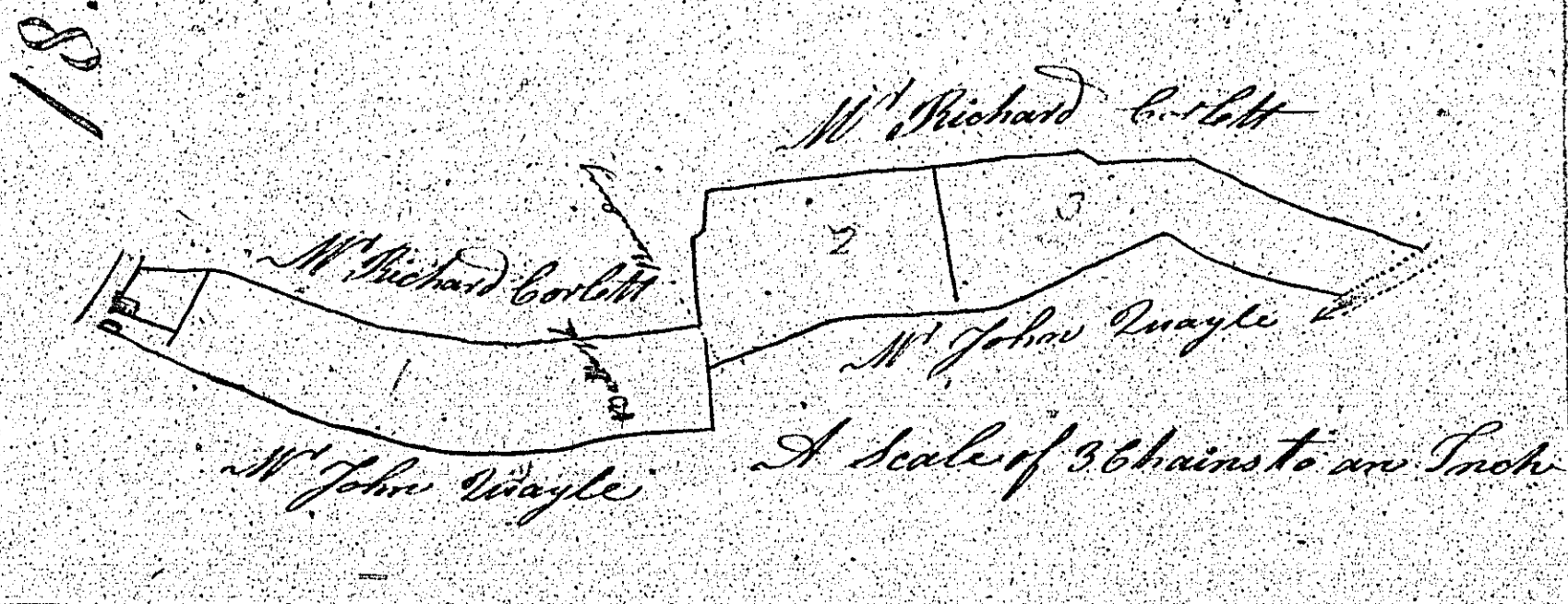

M^r W. W. W.

*Unsurveyed
No. 1126*

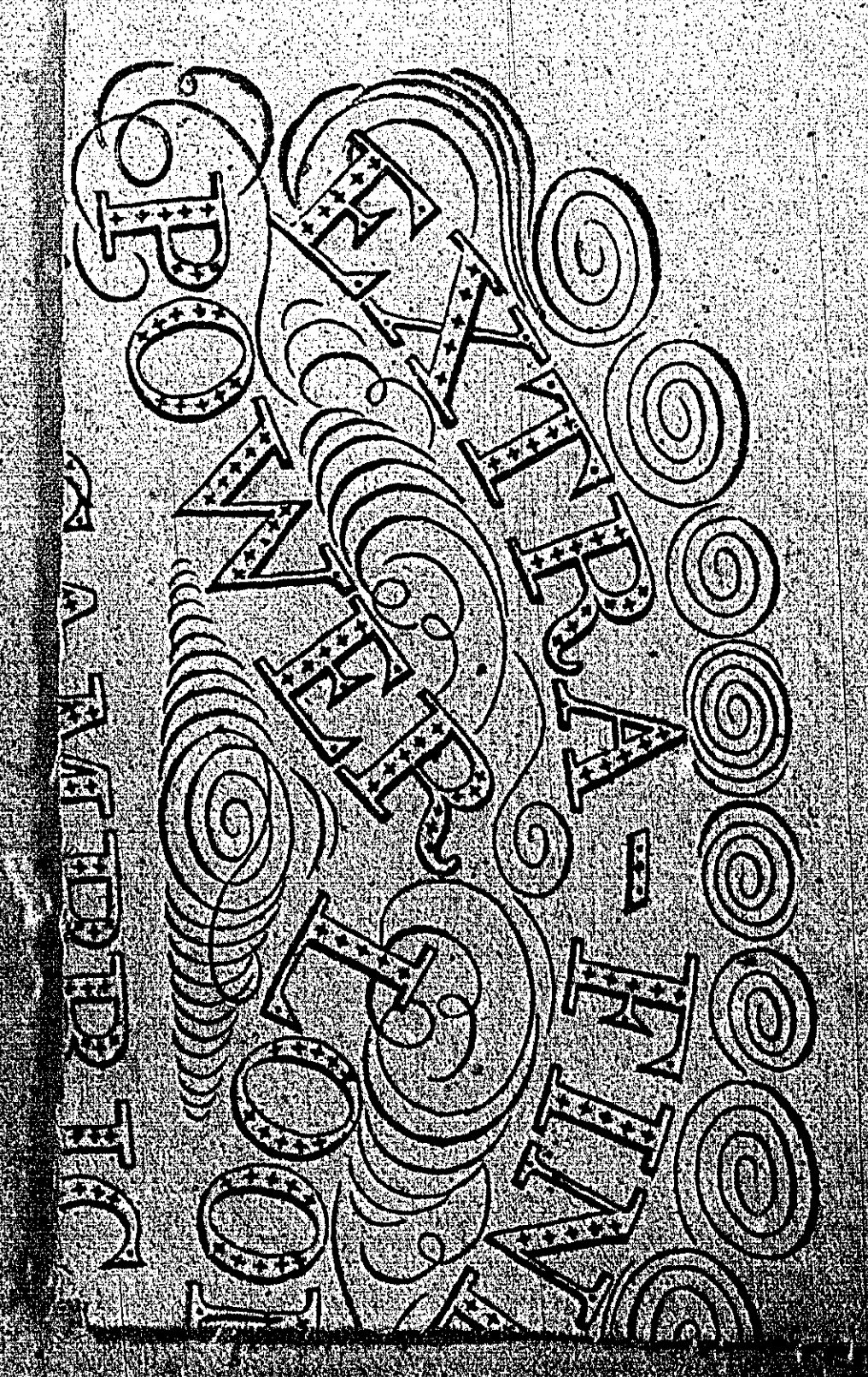

19



*A Plan and survey of a
part of Serfield in the parish
of Jurby, the property of
John Cleator senior and
John Cleator junior
taken March 4th 1840
by James Thomas*

No.	Contents	Acres	Roods	Poles
1		0	0	0
2		0	0	0
3		0	0	0
4		0	0	0
5		0	0	0
6		0	0	0
7		0	0	0
8		0	0	0
9		0	0	0
10		0	0	0
11		0	0	0
12		0	0	0
13		0	0	0
14		0	0	0
15		0	0	0
16		0	0	0
17		0	0	0
18		0	0	0
19		0	0	0
20		0	0	0
Total		0	0	0

A scale of 4 chains to an Inch

ISLE OF MAN GOVERNMENT: GENERAL REGISTRY

TITHE PLANS: PARISH OF JURBY

Original coloured (decorative)

1:30

OF THE PARISH OF JURBY

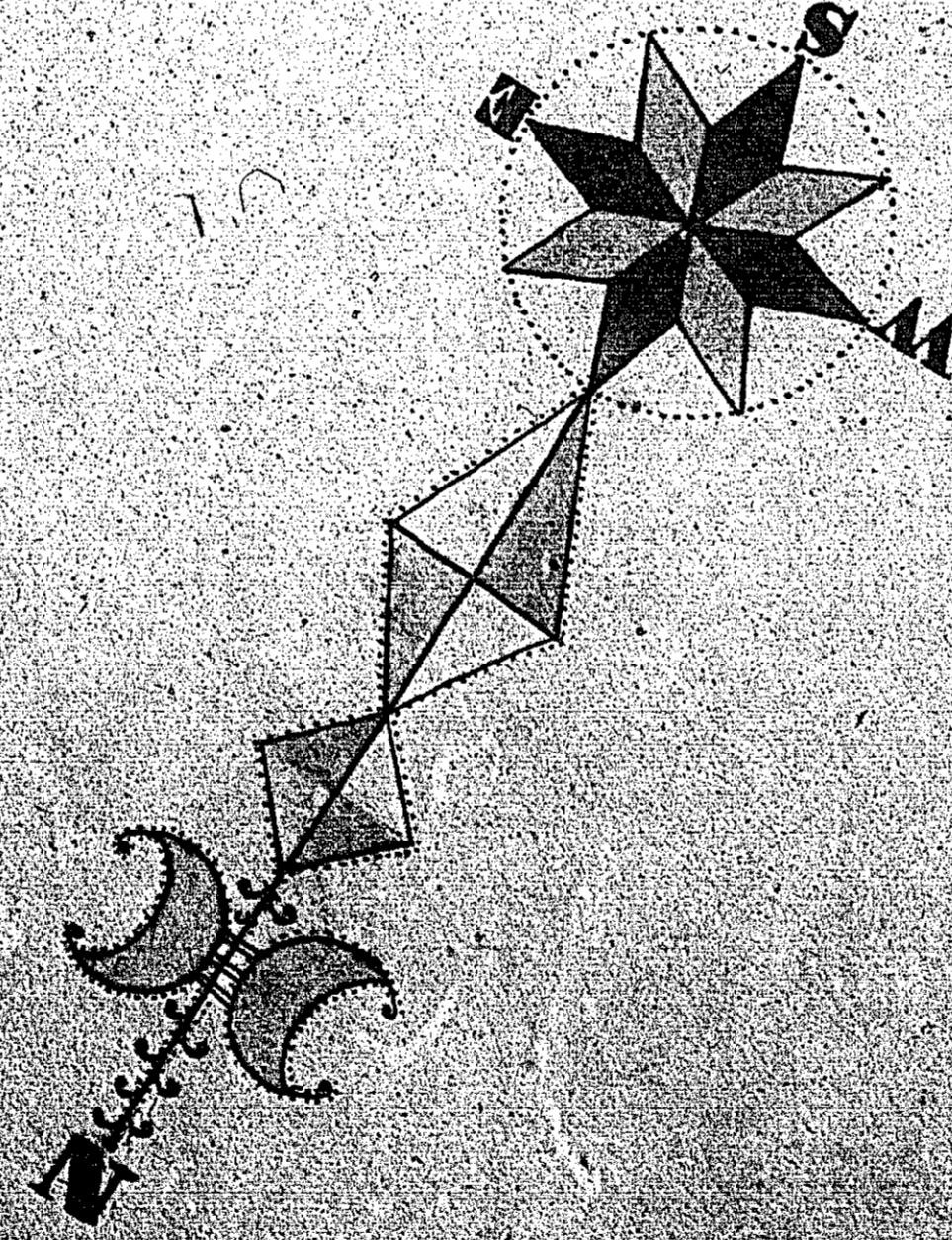

REFERENCES

	A	B	P
Ap. 1	3	0	14
Ap. 2	3	1	14
Ap. 3	4	2	25
Ap. 4	4	0	30
Ap. 5	2	2	2
Ap. 6	2	3	11
Ap. 7	2	3	39
Ap. 8	3	2	17
Ap. 9	3	0	20
Ap. 10	1	3	16
Ap. 11	0	3	38
Ap. 12	0	0	34
Summ's Acre	33	0	5
Good and Garden	1	2	25
Total Sum Acres	33	3	30

The Man and tithery of the Quill-stew
and part of Ballacorney in the parish of Jurby
the property of Thomas Walker, who on the 1st day of
the property of Thomas Walker, from the
of the Man.

This property is charged with tithes
from the year 1830 and tithes on the year 1830
but from the 1st day of the year 1830
the property of Thomas Walker, from the
of the Man, Jurby, 1st day of the year 1830.

Half Inch Scale

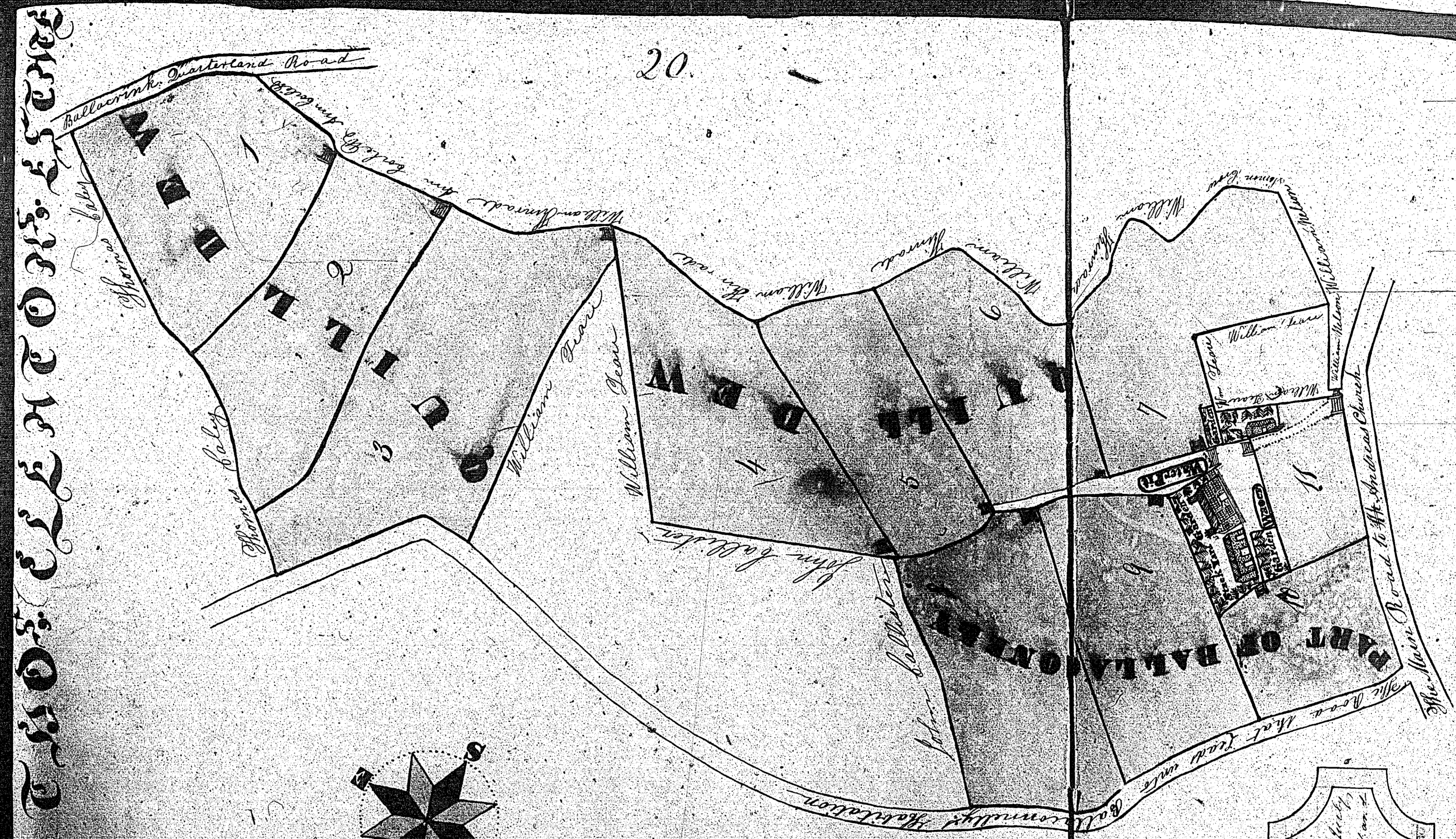

Plan of Daniel Cleator's Property Survey

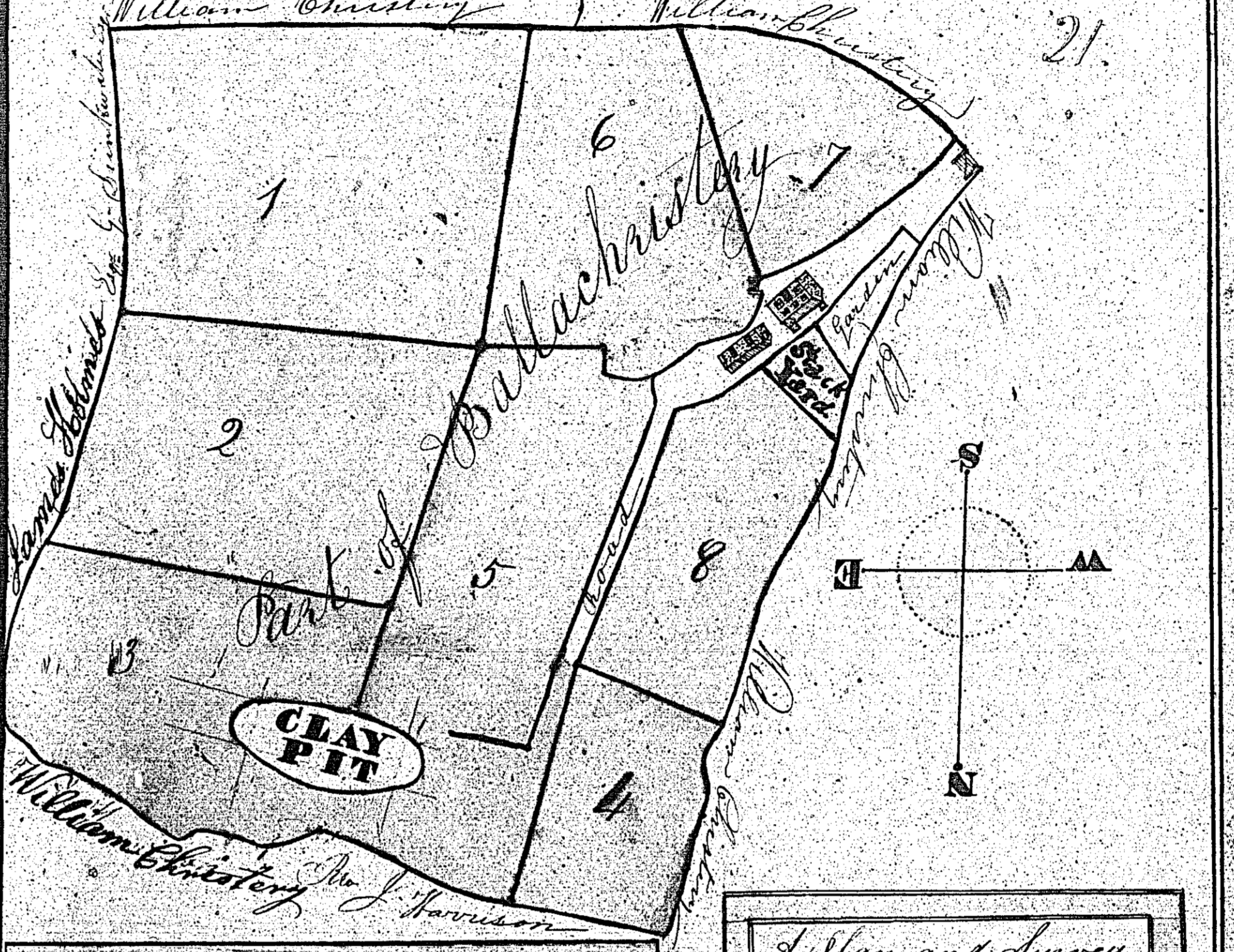

References

	A	R	P
No 1	2	3	35
No 2	2	1	12
No 3	1	3	17
No 4	0	3	23
No 5	2	1	20
No 6	1	3	4
No 7	0	3	25
No 8	1	0	20
Mount Road	14	0	36
Back Garden	0	3	12
Doors	15	0	8

*A Plan and Survey
Part of a Diateland
Called Ballechristy
in the Parish of Perth,
the Property of
Daniel Cleator*

*Surveyed by Daniel Caley
October 16-1860*

Half Inch Scale

