

165

PLAN

Of part of the Quarterlands of Ballahwin and Ballaligg  
In the parish of St. John's  
The property of  
M<sup>r</sup> Henry Kelly.

B. Crane  
Ballahwin  
From P.L. ...  
C. Wattworth

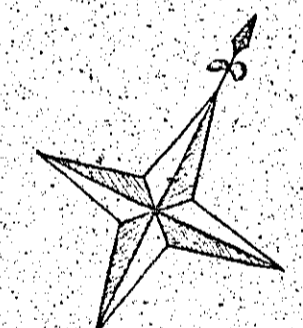

Reference.

No.	Ac.	R.	P.
1	0	0	3 $\frac{1}{2}$
2	0	0	6
Total Content 0 0 9 $\frac{1}{2}$			

0 1 2 3 4 5 6 7 8 9 10 Chains.

Surveyed July 1811  
By William Haigh  
St. John's

166.



Scale of 3 chains  
to One Inch

Contents  
 Fields - 4.7.28 1/2  
 Casements - 0.1.7  
 Total = 4.8.35 3/4

J. Cowell  
Surveyor  
1840

166  
 A Plan & Survey of parts  
 of Bullacourt in the Parish of  
 Gorman the property of Mr Wm Kelly  
 by Patrick, Esq. Surveyor Michael  
 July 27 1840

Contents

1	0.1.6
2	2.2.5
3	0.3.7
4	1.2.14
5	1.0.22
6	1.0.24
7	0.3.3
8	1.2.9
	0.1.7 (Caveing & etc)
	0.2.10 (Public Road)
	0.0.12 (Rise)
Total	0.0.3.32

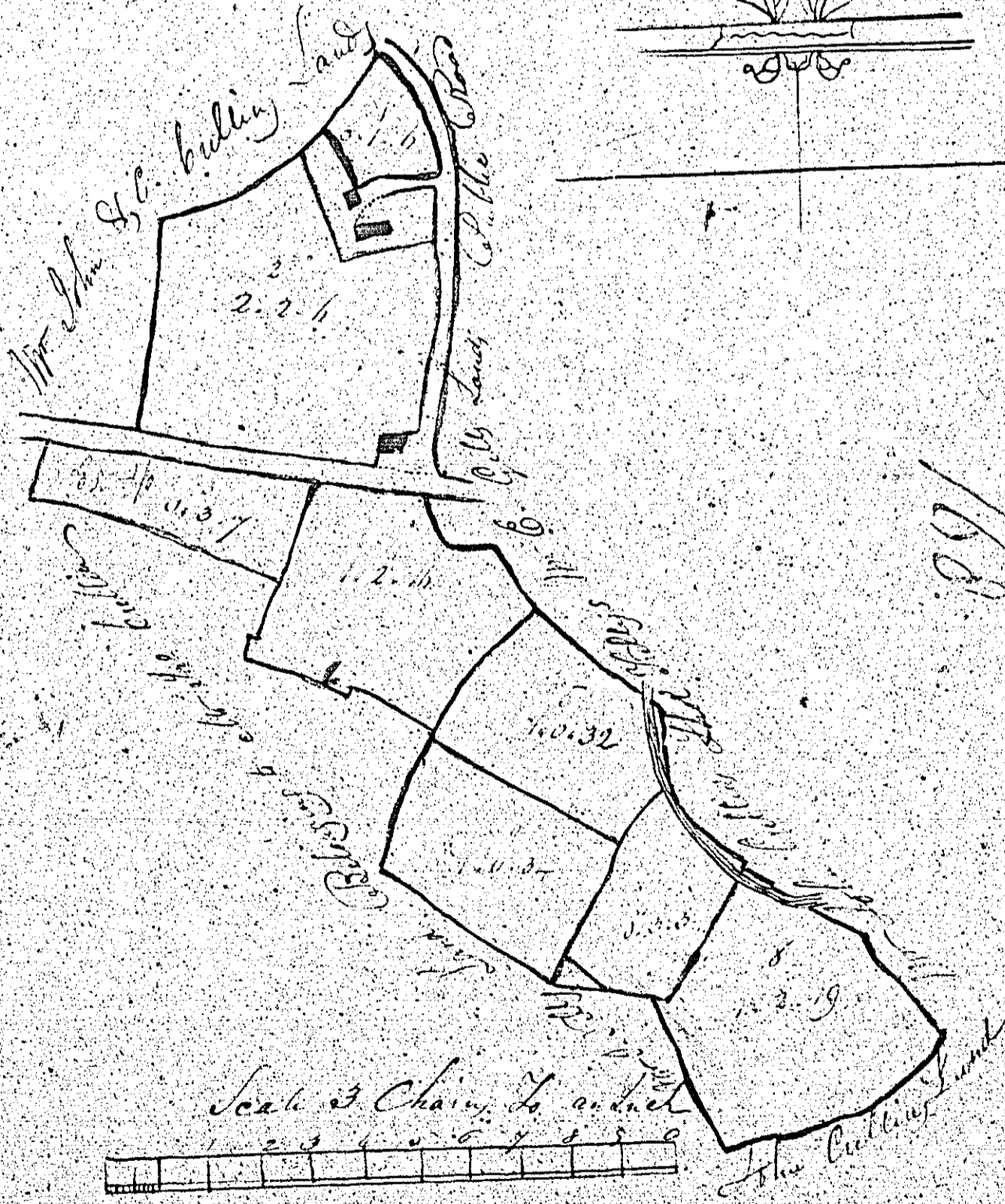

167  
 Plan of a part of the  
 Kermoglass  
 in the Parish of Gorman  
 the property of  
 Mr W. Kelly

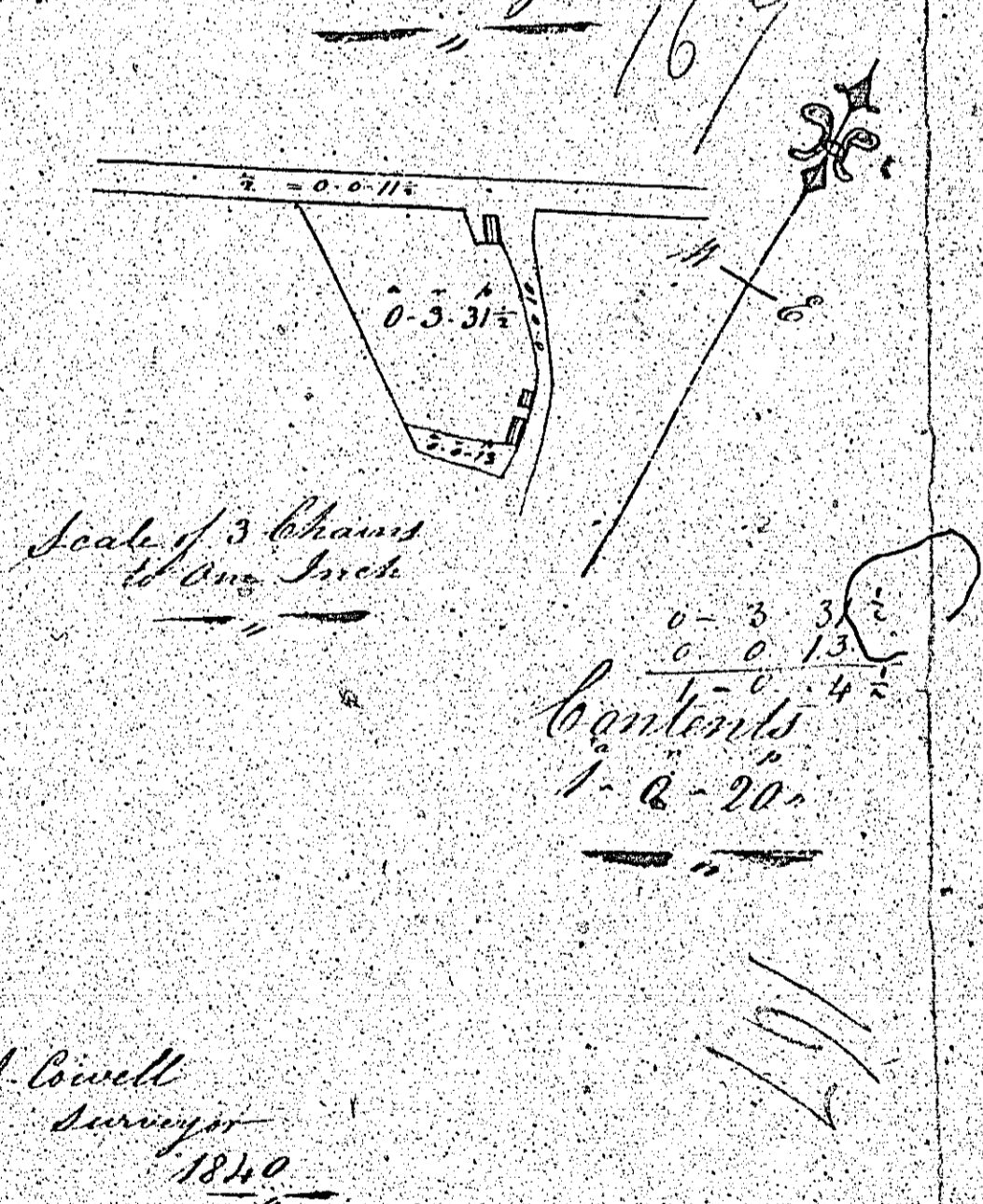

169.

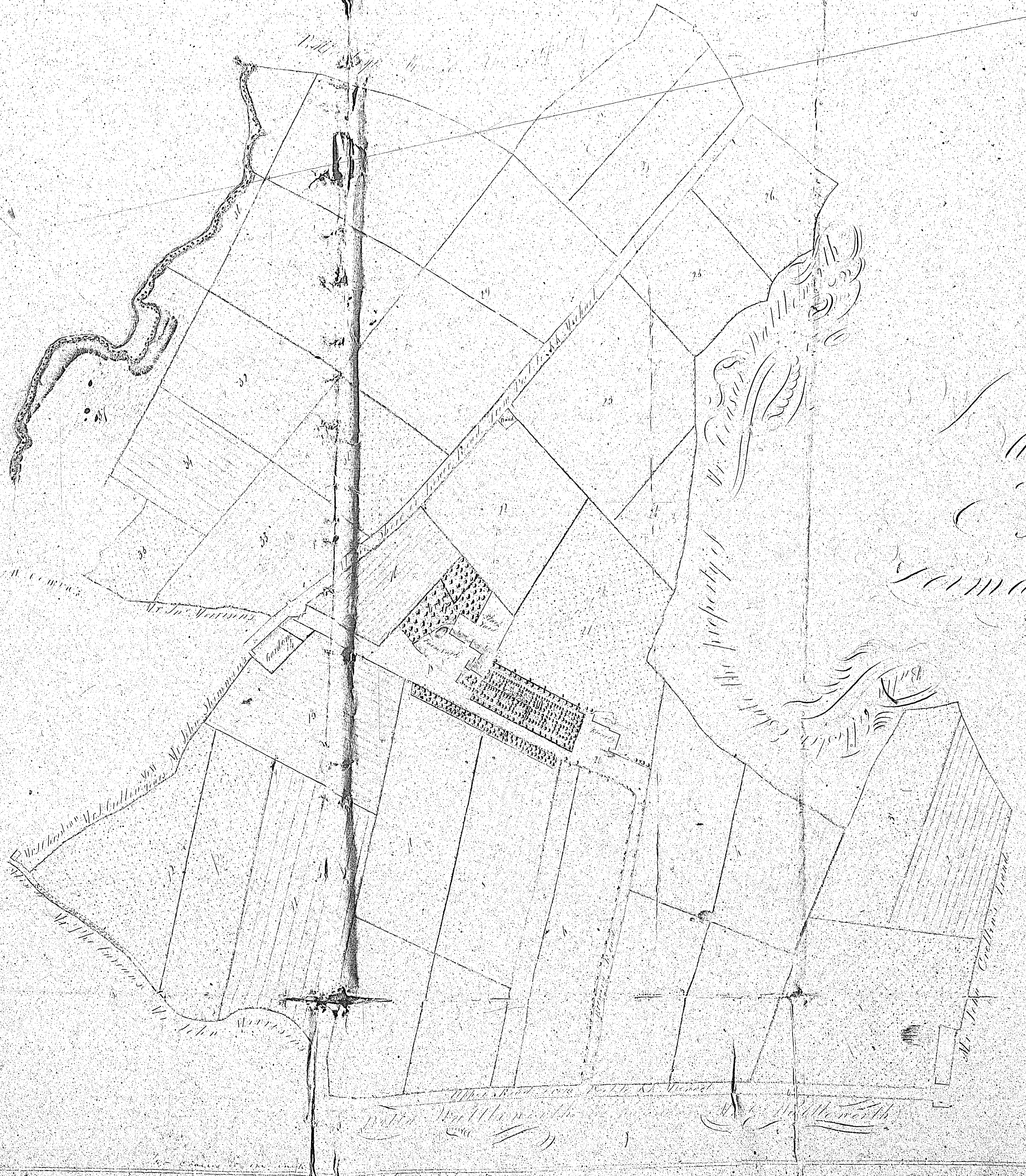
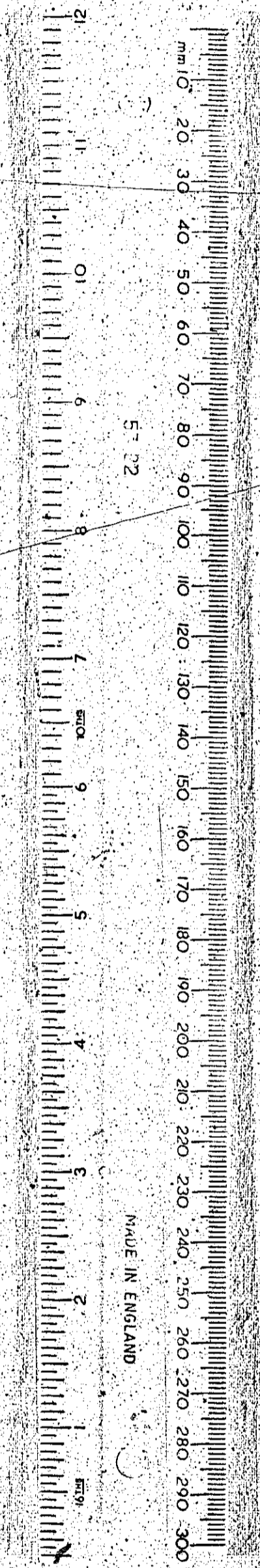
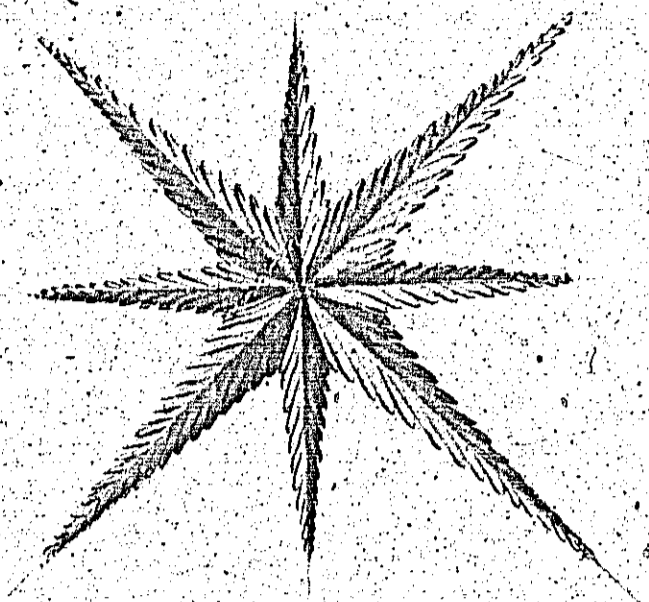

Handwritten text, possibly a title or description, including the words 'The Duke of Devonshire' and 'The Duke of Devonshire'.

Handwritten notes or a list of measurements, possibly a survey log, with columns of numbers and text.

169.

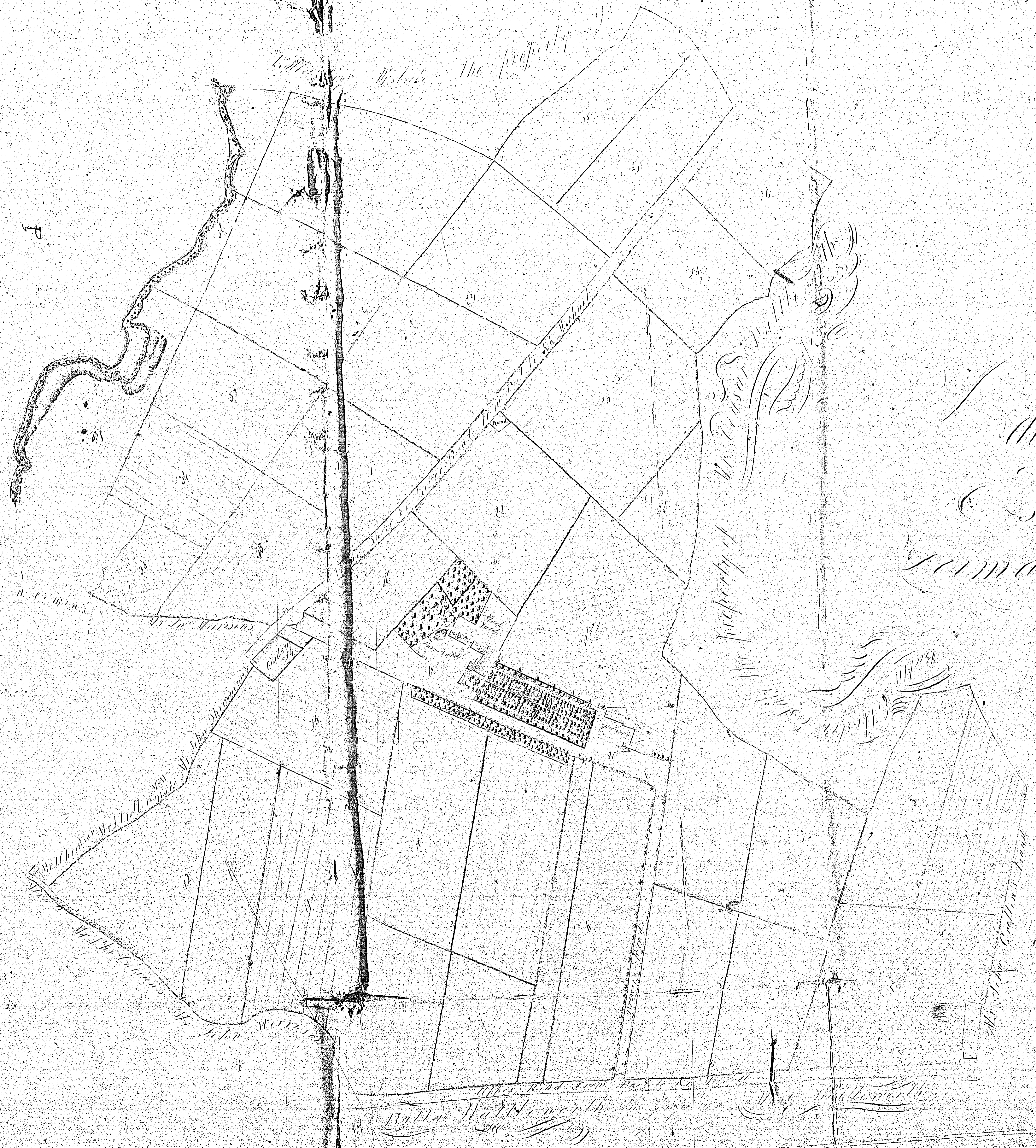
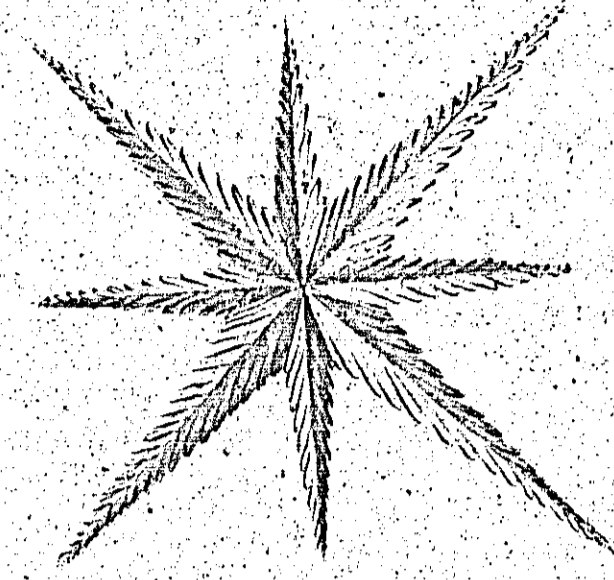

Albany  
State  
Survey

acres

1	1/2
2	1/2
3	1/2
4	1/2
5	1/2
6	1/2
7	1/2
8	1/2
9	1/2
10	1/2
11	1/2
12	1/2
13	1/2
14	1/2
15	1/2
16	1/2
17	1/2
18	1/2
19	1/2
20	1/2
21	1/2
22	1/2
23	1/2
24	1/2
25	1/2
26	1/2
27	1/2
28	1/2
29	1/2
30	1/2
31	1/2
32	1/2
33	1/2
34	1/2
35	1/2
36	1/2
37	1/2
38	1/2
39	1/2
40	1/2
41	1/2
42	1/2
43	1/2
44	1/2
45	1/2
46	1/2
47	1/2
48	1/2
49	1/2
50	1/2
51	1/2
52	1/2
53	1/2
54	1/2
55	1/2
56	1/2
57	1/2
58	1/2
59	1/2
60	1/2
61	1/2
62	1/2
63	1/2
64	1/2
65	1/2
66	1/2
67	1/2
68	1/2
69	1/2
70	1/2
71	1/2
72	1/2
73	1/2
74	1/2
75	1/2
76	1/2
77	1/2
78	1/2
79	1/2
80	1/2
81	1/2
82	1/2
83	1/2
84	1/2
85	1/2
86	1/2
87	1/2
88	1/2
89	1/2
90	1/2
91	1/2
92	1/2
93	1/2
94	1/2
95	1/2
96	1/2
97	1/2
98	1/2
99	1/2
100	1/2

Water Road from Park to the Canal  
Water Road from the property of Mr. John Watson

