

A 87
 Plan of
 a part of
BALLAQUINE
 in the Parish of
 Braddan
 the property of
 Mr. John Betty

Contents			
No.	Ac.	R.	P.
1	5	1	3 1/2
2	2	0	1 1/2
3	5	0	1 1/2
4	4	3	1 1/2
5	3	2	1 1/2
6	6	0	3 1/2
7	1	1	7 1/2
8	2	3	7 1/2
9	6	3	4 1/2
10	4	1	3 1/2
11	7	1	5 1/2
12	2	2	5 1/2
13	4	0	0 1/2
14	4	0	0 1/2
15	2	3	2
16	2	3	3 1/2
17	2	2	3
18	2	2	2 1/2
19	3	2	3 1/2
20	2	2	3 1/2
21	3	0	3 1/2
22	3	0	1 1/2
23	2	0	2 1/2
24	2	0	2 1/2
25	2	0	2 1/2
26	2	0	2 1/2
27	2	0	2 1/2
28	2	0	2 1/2
29	2	0	2 1/2
30	2	0	2 1/2
31	2	0	2 1/2
32	2	0	2 1/2
33	2	0	2 1/2
34	2	0	2 1/2
35	2	0	2 1/2
36	2	0	2 1/2
37	2	0	2 1/2
38	2	0	2 1/2
39	2	0	2 1/2
40	2	0	2 1/2
41	2	0	2 1/2
42	2	0	2 1/2
43	2	0	2 1/2
44	2	0	2 1/2
45	2	0	2 1/2
46	2	0	2 1/2
47	2	0	2 1/2
48	2	0	2 1/2
49	2	0	2 1/2
50	2	0	2 1/2
51	2	0	2 1/2
52	2	0	2 1/2
53	2	0	2 1/2
54	2	0	2 1/2
55	2	0	2 1/2
56	2	0	2 1/2
57	2	0	2 1/2
58	2	0	2 1/2
59	2	0	2 1/2
60	2	0	2 1/2
61	2	0	2 1/2
62	2	0	2 1/2
63	2	0	2 1/2
64	2	0	2 1/2
65	2	0	2 1/2
66	2	0	2 1/2
67	2	0	2 1/2
68	2	0	2 1/2
69	2	0	2 1/2
70	2	0	2 1/2
71	2	0	2 1/2
72	2	0	2 1/2
73	2	0	2 1/2
74	2	0	2 1/2
75	2	0	2 1/2
76	2	0	2 1/2
77	2	0	2 1/2
78	2	0	2 1/2
79	2	0	2 1/2
80	2	0	2 1/2
81	2	0	2 1/2
82	2	0	2 1/2
83	2	0	2 1/2
84	2	0	2 1/2
85	2	0	2 1/2
86	2	0	2 1/2
87	2	0	2 1/2
88	2	0	2 1/2
89	2	0	2 1/2
90	2	0	2 1/2
91	2	0	2 1/2
92	2	0	2 1/2
93	2	0	2 1/2
94	2	0	2 1/2
95	2	0	2 1/2
96	2	0	2 1/2
97	2	0	2 1/2
98	2	0	2 1/2
99	2	0	2 1/2
100	2	0	2 1/2

2 1/2 = Fields
 3 2/3 = Roads, Easements &
 2 1/2 = Totals

Scale of 3 Chains to One Inch

S. Powell
March 1840

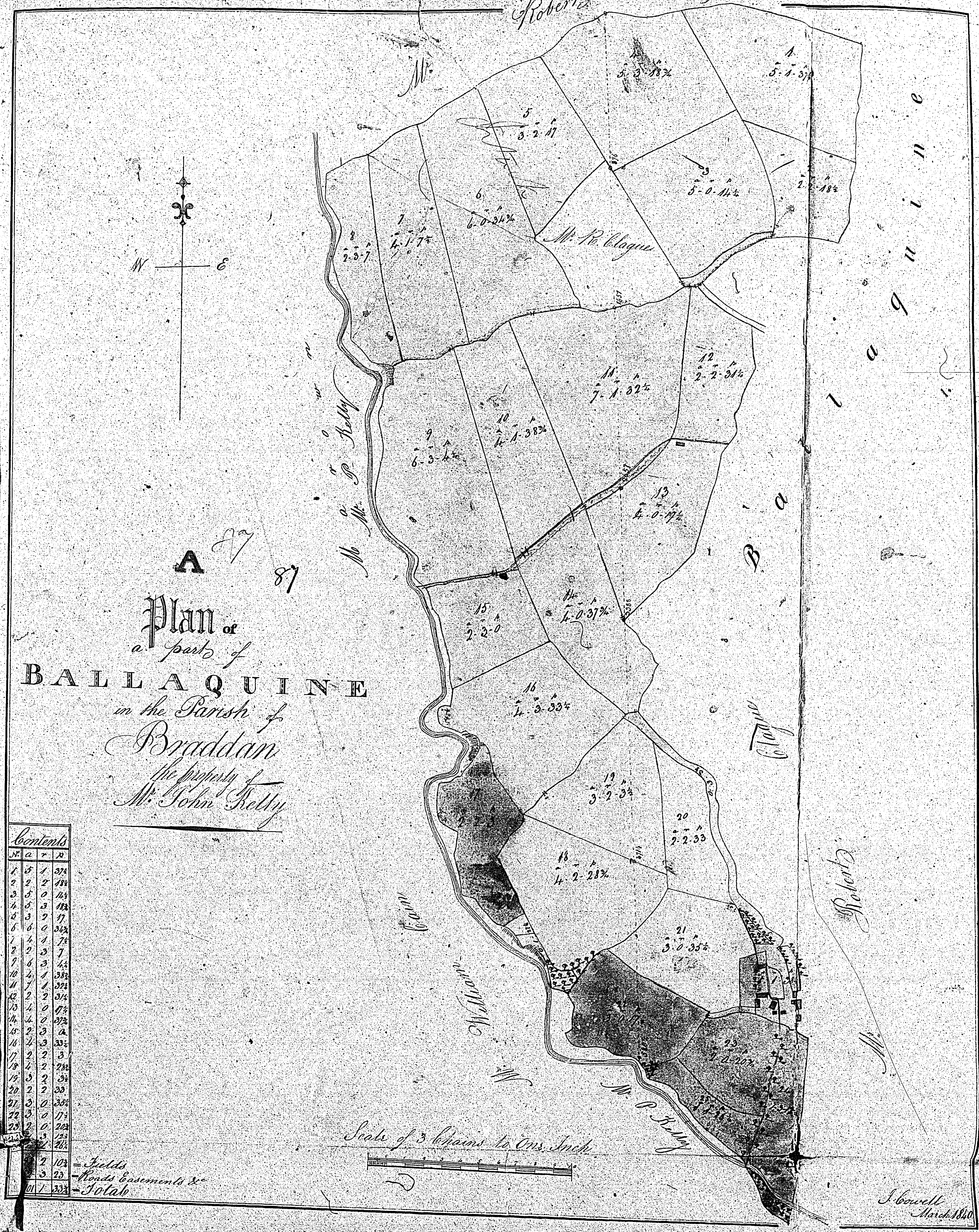

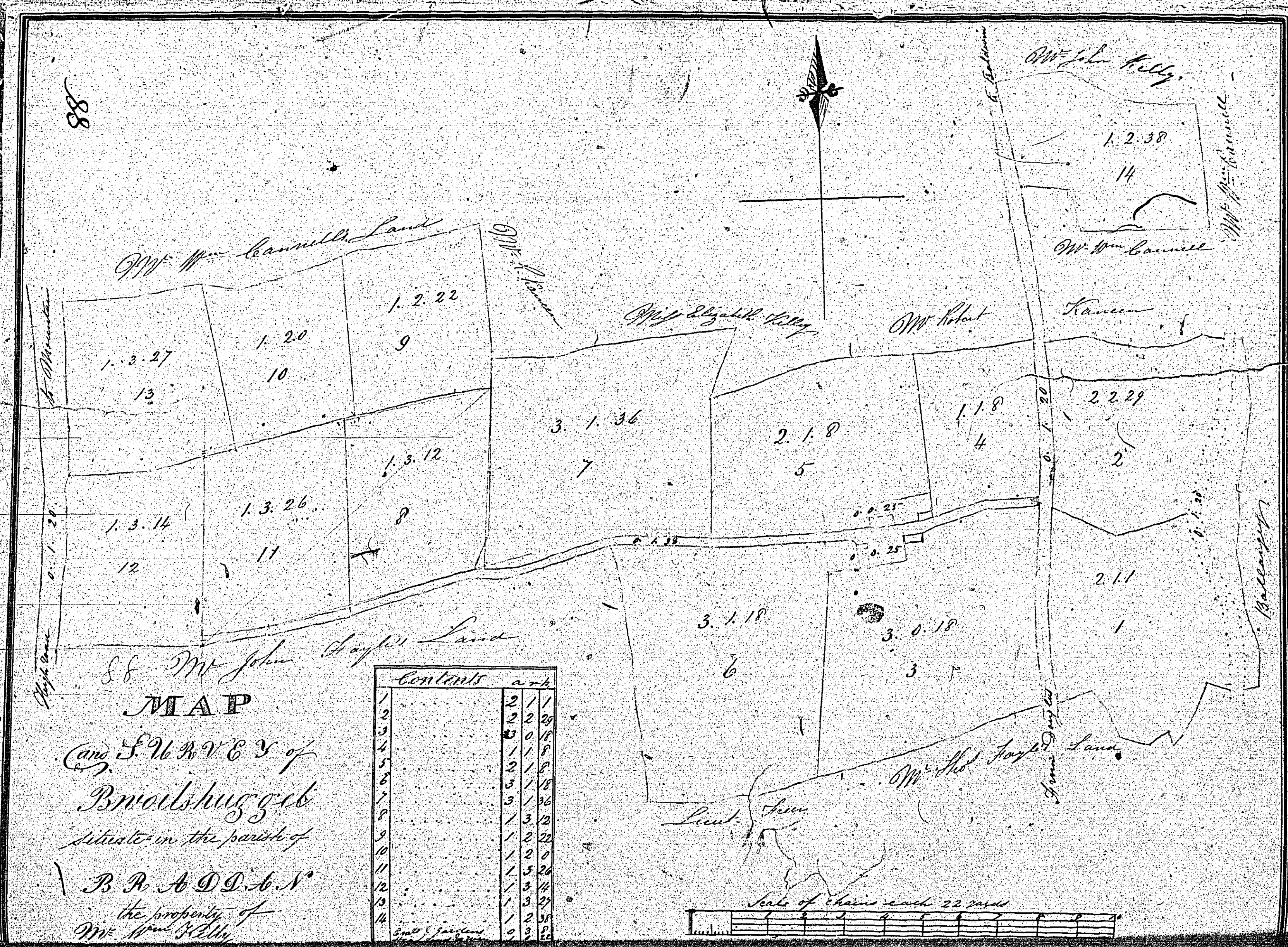

ISLE OF MAN GOVERNMENT: GENERAL REGISTRY

TITHE PLANS: PARISH OF BRADDAN

Original coloured

1:30

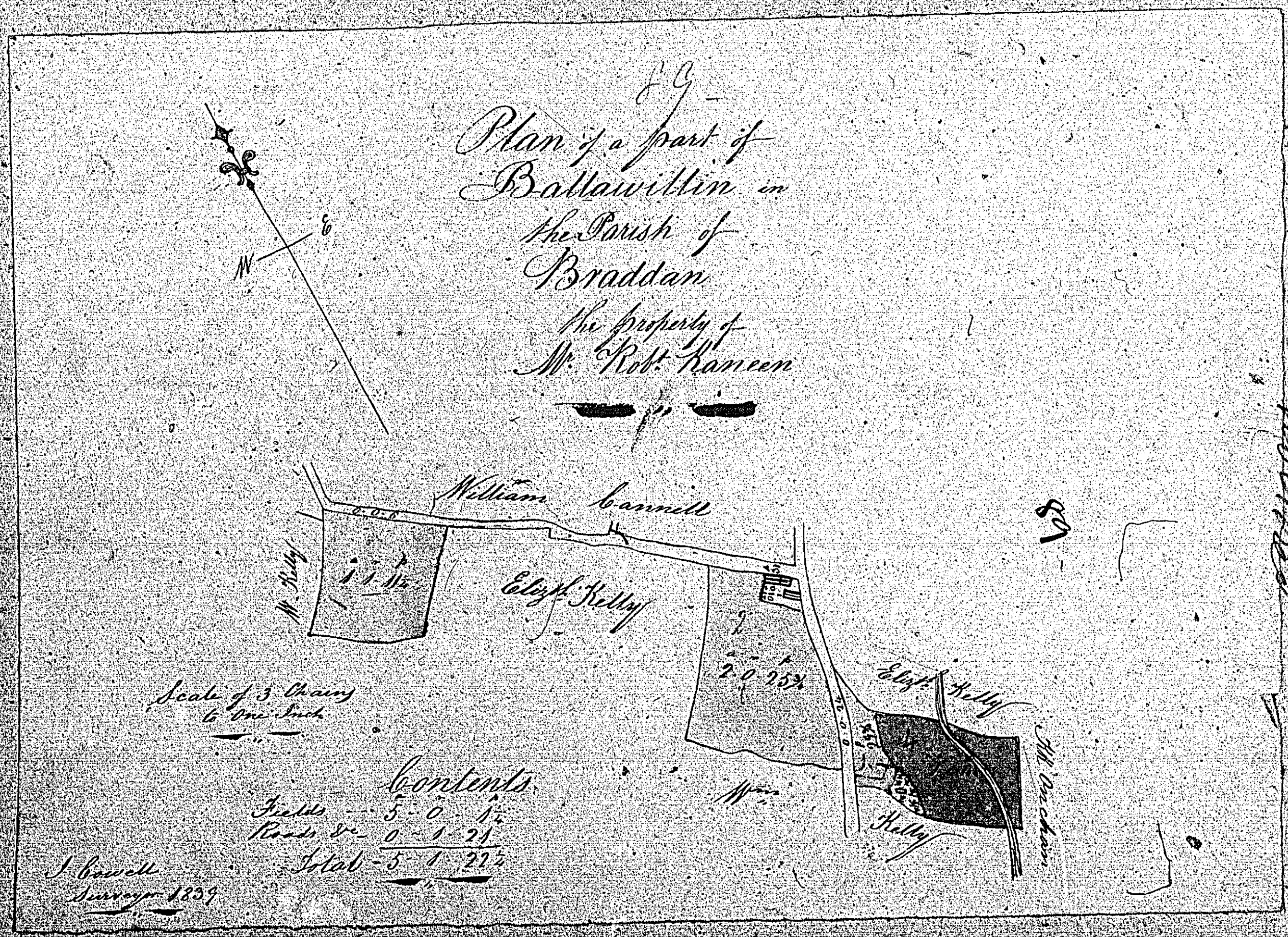

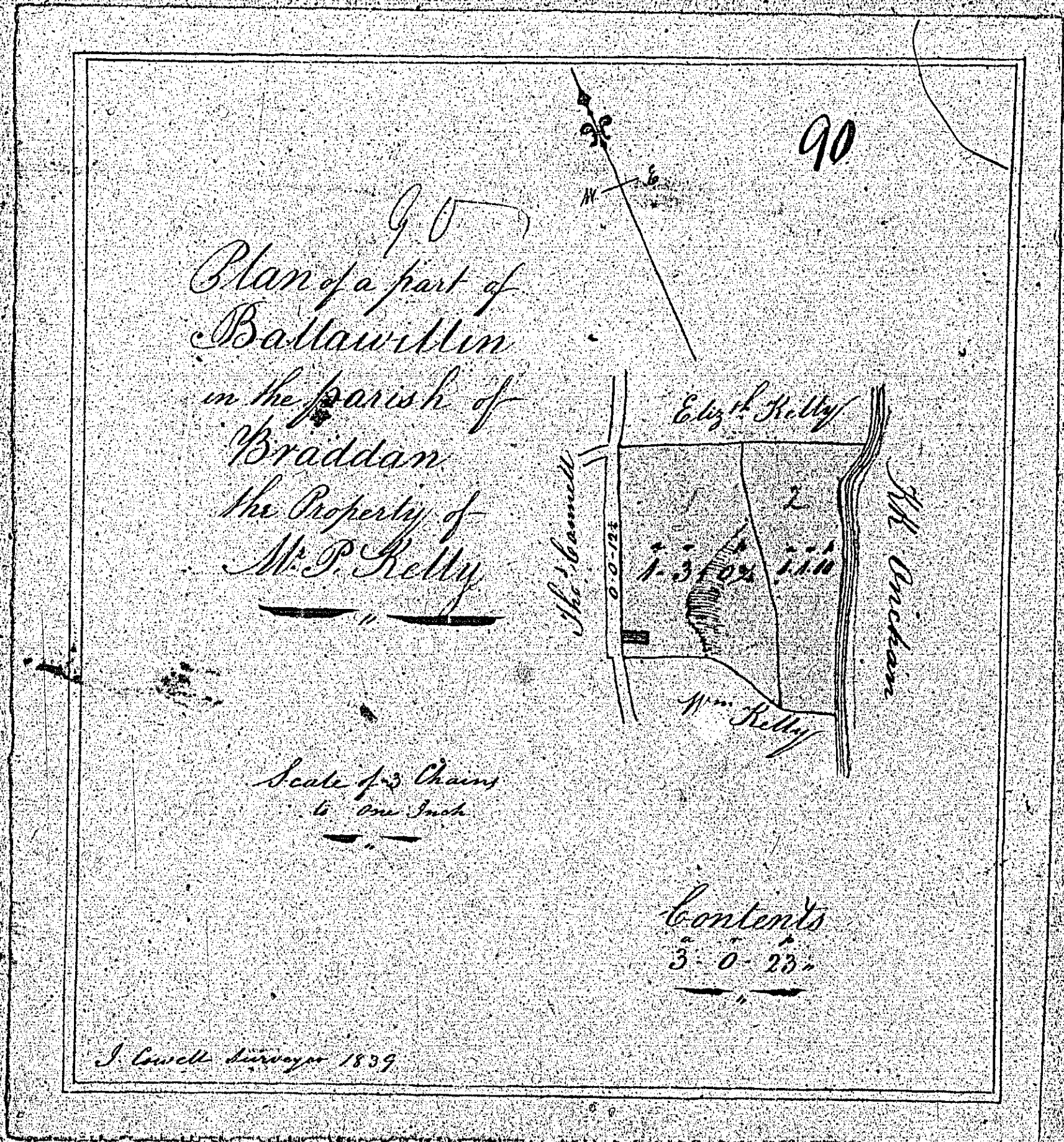

95

41
 A Plan of
 the
 D O O N
 in the parish of
 BRADDAN
 the property of
 Mr. Dan. Hanrahan

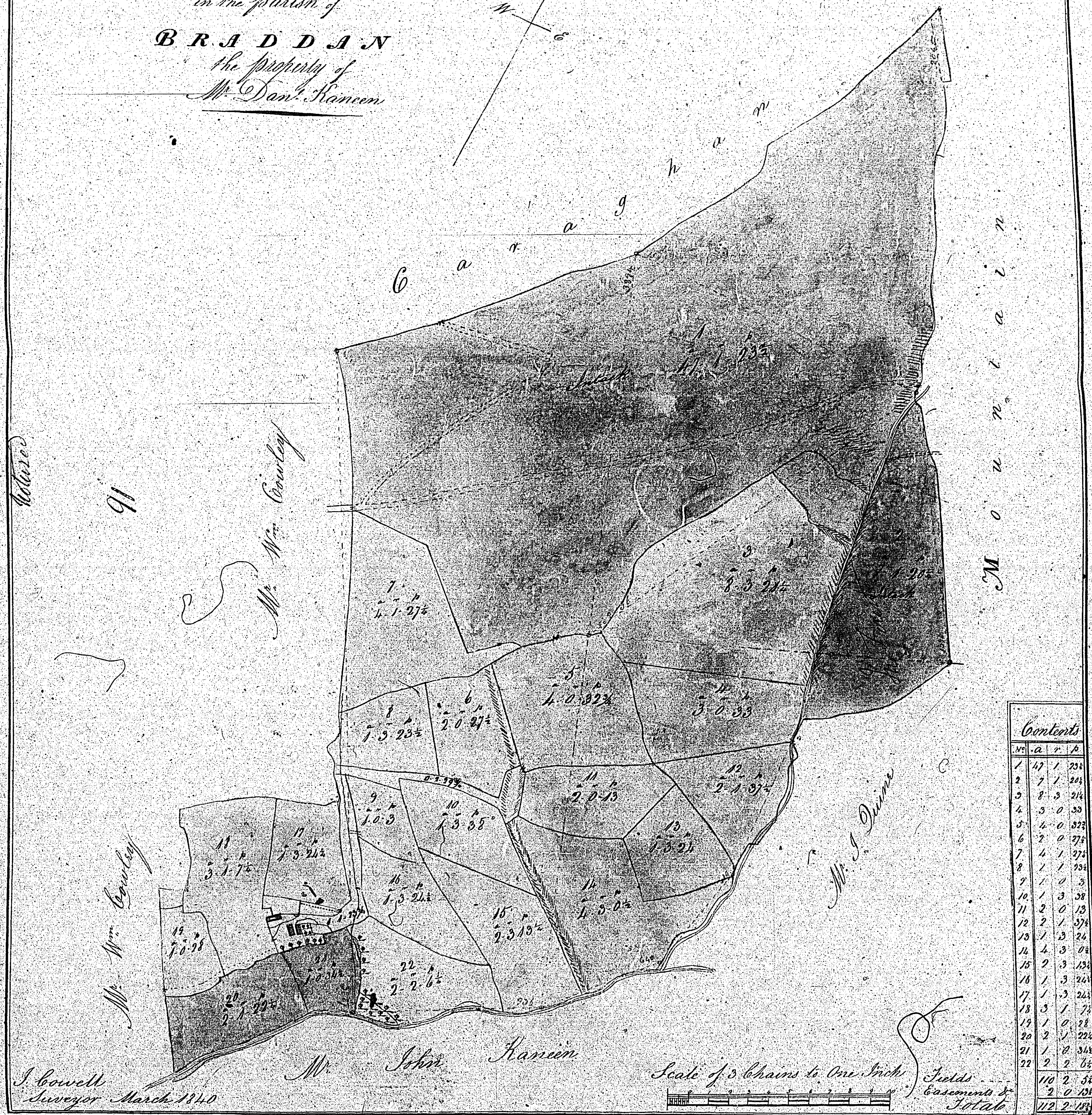

Return

41

M o u n t a i n

J. Cowell
 Surveyor March 1840

Mr. John Hanrahan

Scale of 3 chains to One Inch

Fields
 Easements &
 Totals

Contents			
No.	a	r	A
1	47	1	254
2	7	1	244
3	8	3	244
4	3	0	55
5	4	0	822
6	2	0	278
7	4	1	278
8	1	1	254
9	1	0	3
10	1	3	58
11	2	0	13
12	2	1	578
13	1	3	24
14	4	3	74
15	2	3	134
16	1	3	244
17	1	3	244
18	3	1	74
19	1	0	28
20	2	1	224
21	1	8	344
22	2	2	64
	110	2	54
	2	0	104
	112	2	158

ISLE OF MAN GOVERNMENT: GENERAL REGISTRY
 TITHE PLANS: PARISH OF BRADDAN

Original coloured

1:30

The two following plans are
both numbered 92