

76
Plan

76
Warcroft
in the Parish of Braddan,
the Property of
R. Haworth Esq.

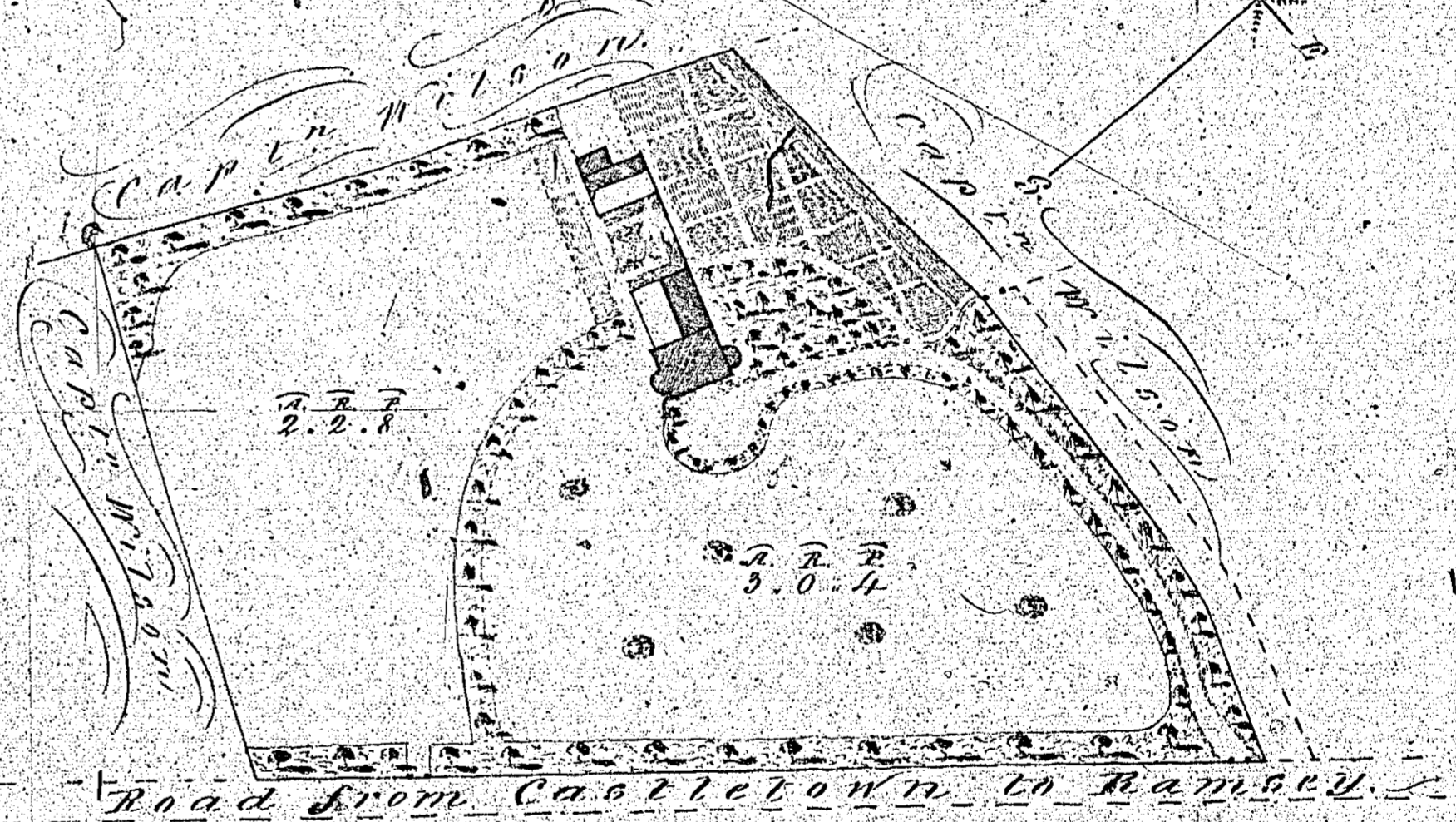

Road from Castle town to Ramsey

Contents.	
Houses, Warranties, Gardens &c.	4 7 25
Pasture, Pleasure Grounds &c.	3 0 11
Waste Land	2 2 5
Total	8 1 37

Scale 2 Chains to an Inch.
W. J. Corbett
Surveyor 1840.

The Union Mills
 In Braddon
 The Report of Mr. Harrison
 April 1840 (77) 77

not used

Two Meadows
 In Braddon
 The Report of Mr. Harrison
 Copied from a Survey by J. Sargent in 1820
 Drawn by W. H. Collins

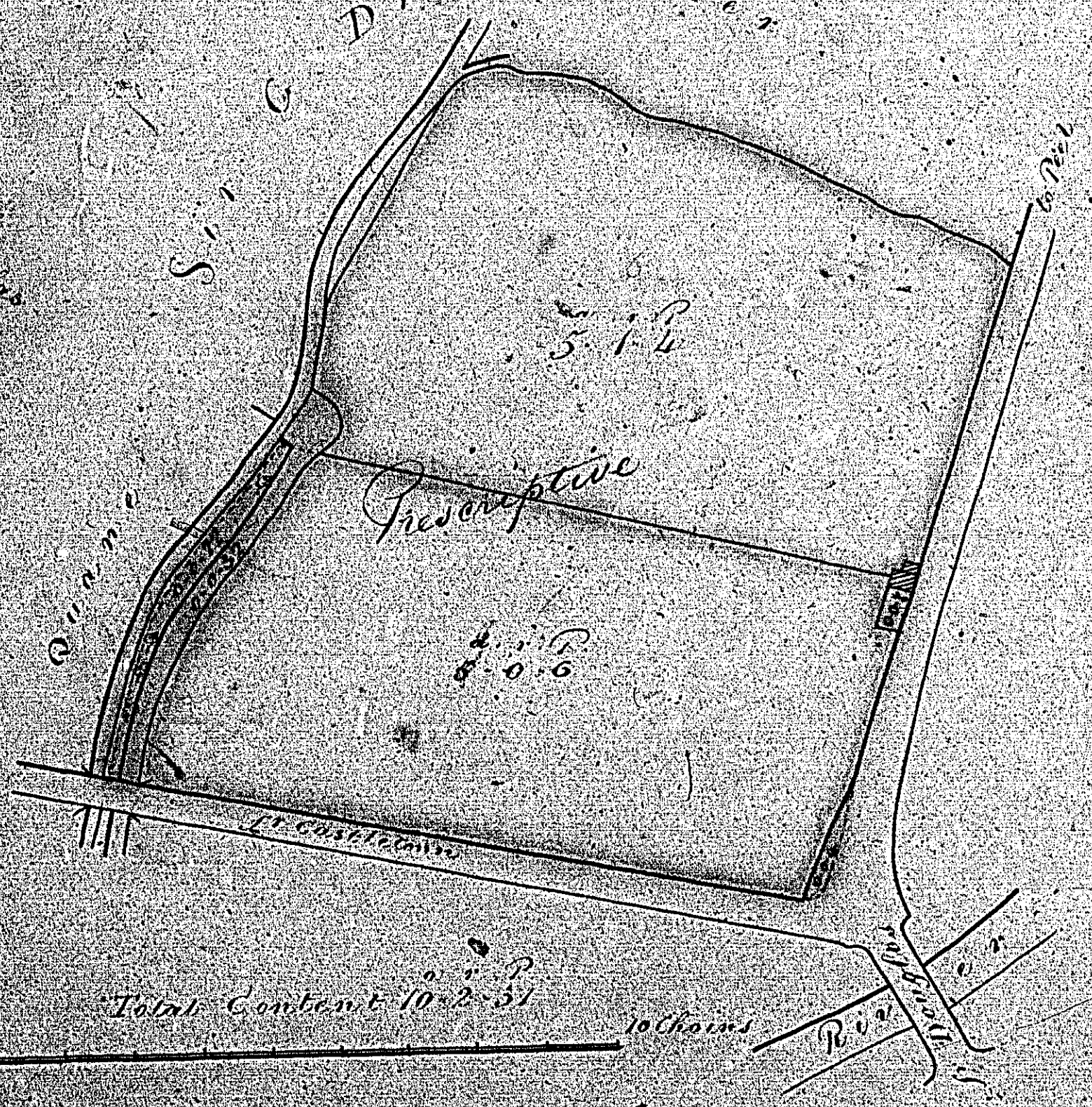
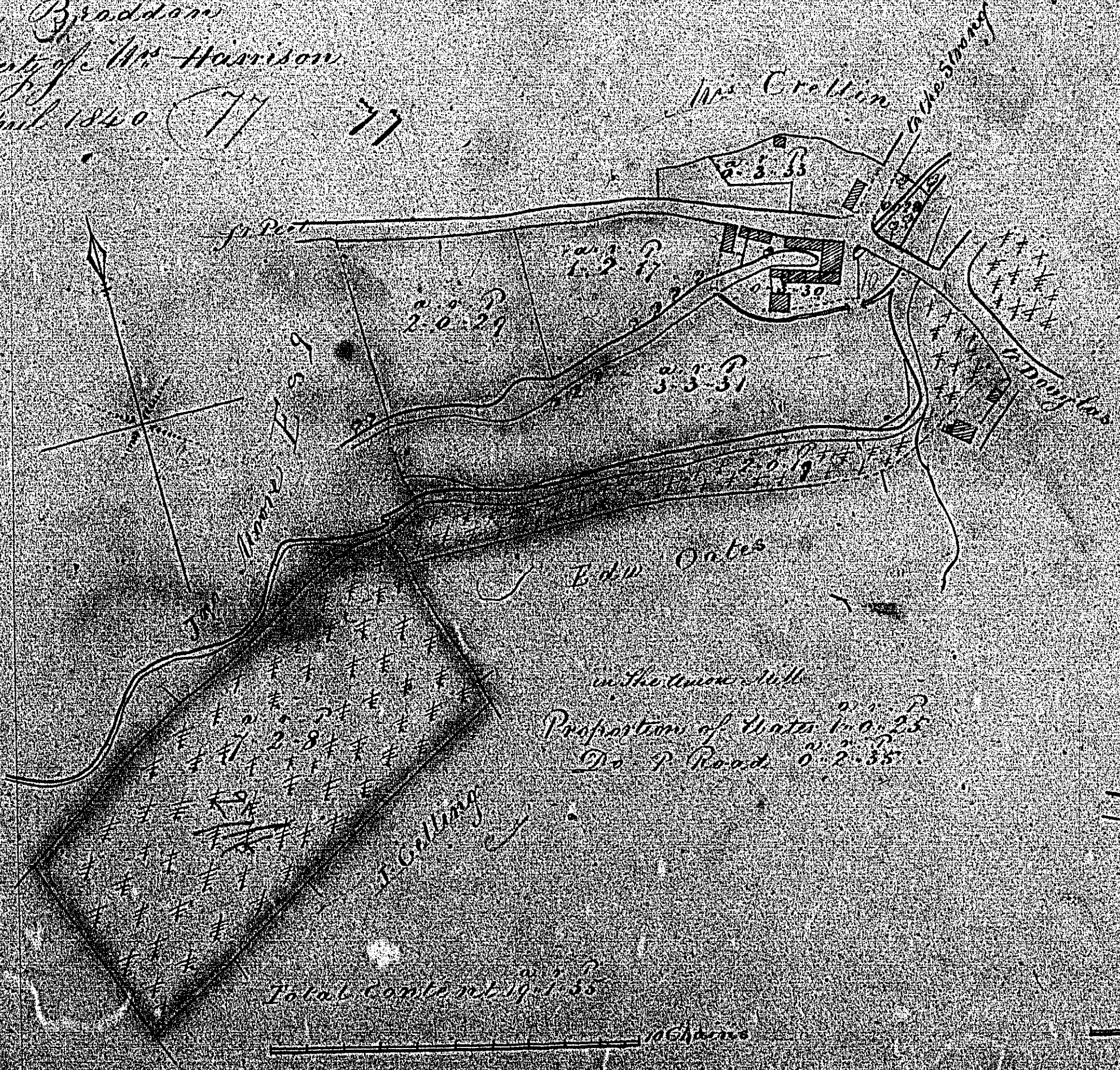

W. H. Collins

W. H. Collins

Plan
of 78
Ballabunt
Parish of Braddan
The property of
Messrs Tho^t and W^m Hampton,

Preference

No	Contains	A.	R.	P.
1	Contains	5	0	17
2	"	3	2	1
3	"	3	1	12
4	"	2	2	28
5	"	3	1	25
6	"	2	1	33
7	"	1	0	10
8	"	1	3	19
9	"	1	1	12
10	"	1	2	36
11	"	2	0	19
12	"	2	1	17
13	"	0	3	4
14	"	2	0	1
15	"	3	2	1
16	"	2	1	8
17	"	2	2	10
18	"	5	0	27
19	"	1	3	5
20	"	2	0	28
21	"	3	3	22
Easements & private roads		3	8	4
Total		61	7	19

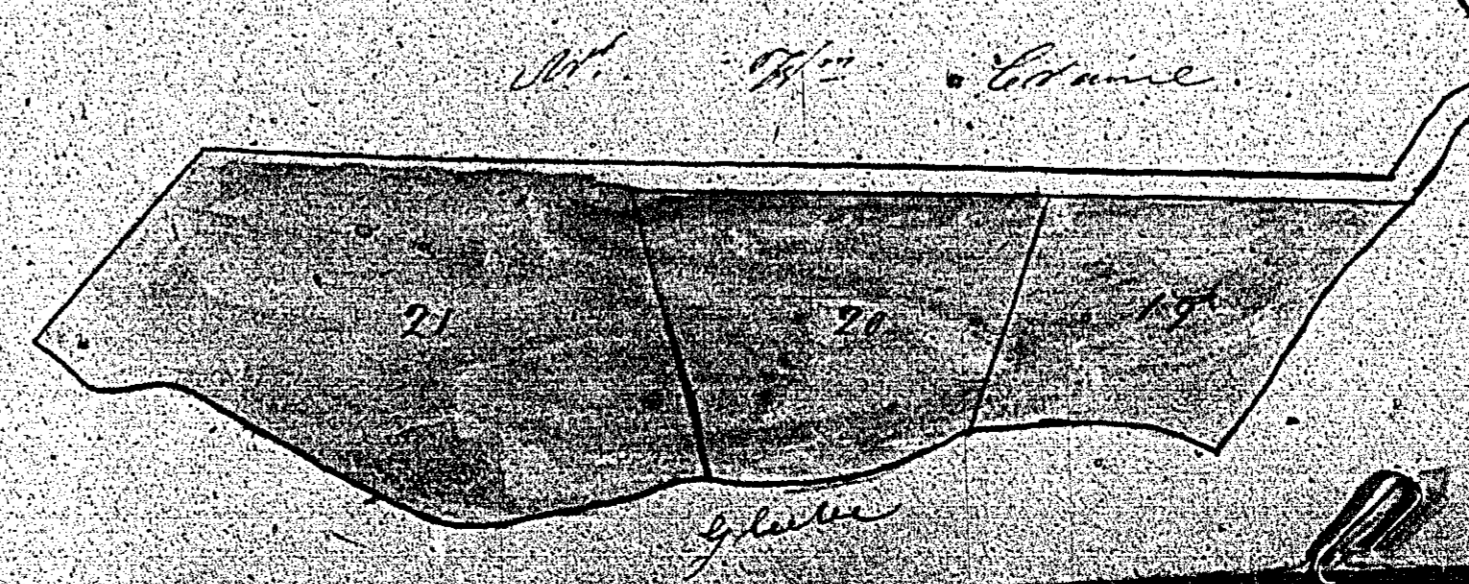

Scale of chains three to an inch
J. Currier F.R.S. Braddan 1840

near Mr. Green

88	1	02	70
7	0	2	33

1840

PLAN

of
Ballacubbin
Parish of Braddoo
The Property of

M. HAMPTON Esq.

79
79
The Line East

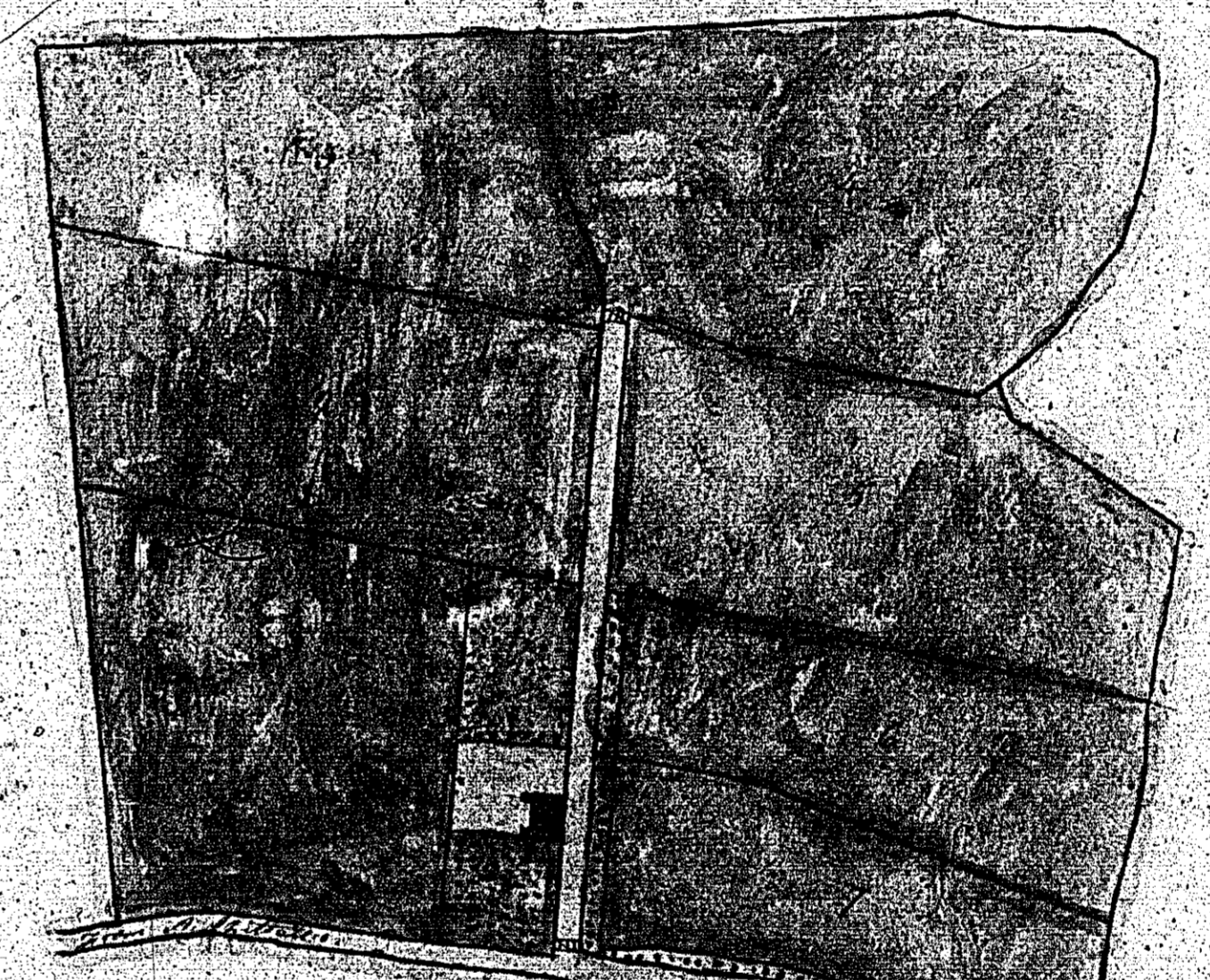

East
of
the
line

with
the
line

Reference

1	contains	4	0	23
2	"	3	3	16
3	"	3	2	20
4	"	5	1	17
5	"	4	0	27
6	"	2	3	16
7	"	2	2	33
8	"	2	0	23
Total		28	3	30

Scale of chains three to an Inch.

John Green Surveyor 1840

with the line
of the
line

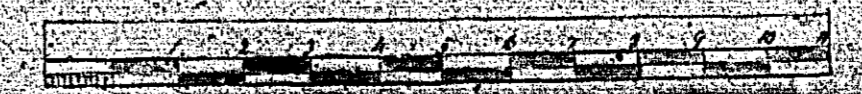

1840



PLAN
 of
 Ballachrenik
 Parish of Braddan
 The Property of
 G. HIGHTON Esq.

80

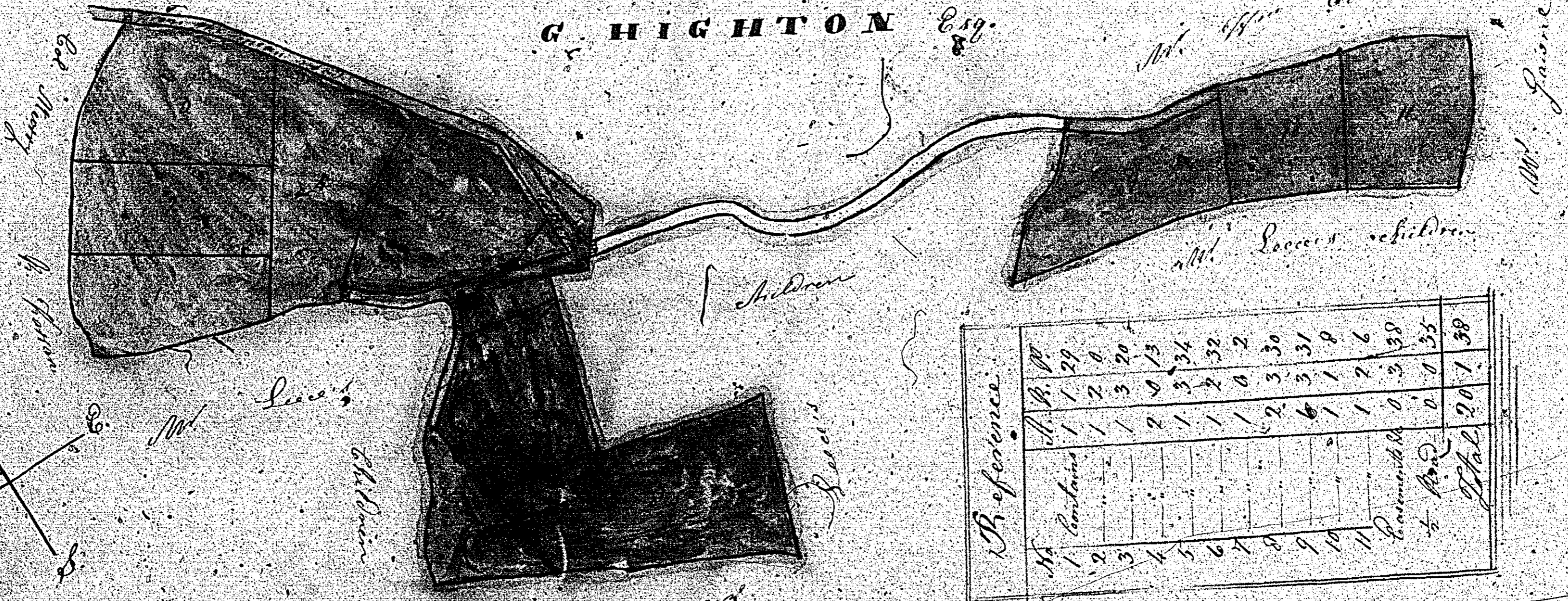

Reference.

1	1	29
2	1	30
3	1	31
4	1	32
5	1	33
6	1	34
7	1	35
8	1	36
9	1	37
10	1	38
11	1	39
12	1	40
13	1	41
14	1	42
15	1	43
16	1	44
17	1	45
18	1	46
19	1	47
20	1	48
21	1	49
22	1	50
23	1	51
24	1	52
25	1	53
26	1	54
27	1	55
28	1	56
29	1	57
30	1	58
31	1	59
32	1	60
33	1	61
34	1	62
35	1	63
36	1	64
37	1	65
38	1	66
39	1	67
40	1	68
41	1	69
42	1	70
43	1	71
44	1	72
45	1	73
46	1	74
47	1	75
48	1	76
49	1	77
50	1	78
51	1	79
52	1	80
53	1	81
54	1	82
55	1	83
56	1	84
57	1	85
58	1	86
59	1	87
60	1	88
61	1	89
62	1	90
63	1	91
64	1	92
65	1	93
66	1	94
67	1	95
68	1	96
69	1	97
70	1	98
71	1	99
72	1	100

Scale of chains three to an Inch.

John Grant Surveyor - Ballachrenik 1840.

1840
 John Grant Surveyor
 Ballachrenik