

Map of a Small Meadow

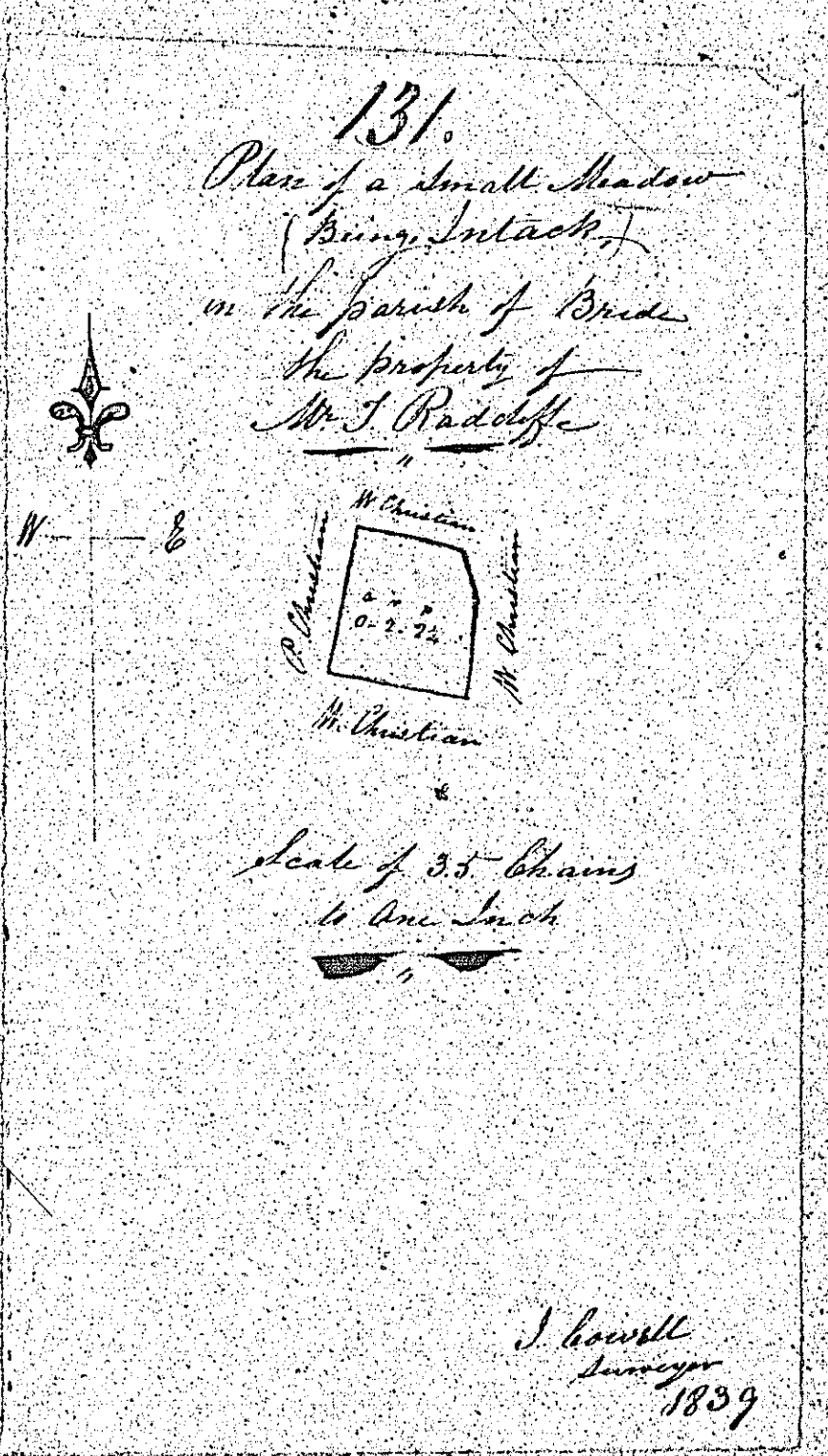

Bude Plan

Map and Survey of the Estate of Ballinacorney in the Parish of St. Bride, made by William Sayle & John Joyce 1839.

132.

The Highway from Lismore to St. Bride Church

Contents of the South part

	S	R	P
.....	3	1	3
.....	2	1	11
.....	0	3	2
.....	3	3	30
.....	5	1	33
.....	6	3	11
.....	5	1	1
.....	2	3	34
.....	4	1	4
.....	5	2	7
.....	6	3	11
.....	47	1	37
St. Bride Highway	1	2	16
	49	0	7

Contents of the North part

	S	R	P
.....	5	1	33
.....	2	3	11
.....	14	2	3
.....	1	1	11
.....	5	1	2
.....	6	2	6
.....	2	1	6
.....	13	2	33
.....	51	3	24
Garden	1	0	16
Wagon	0	2	11
House & Outbuildings	0	2	25
The Highway	1	1	24
	53	2	20

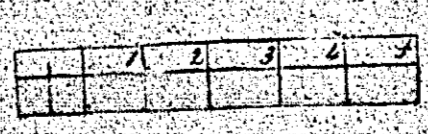
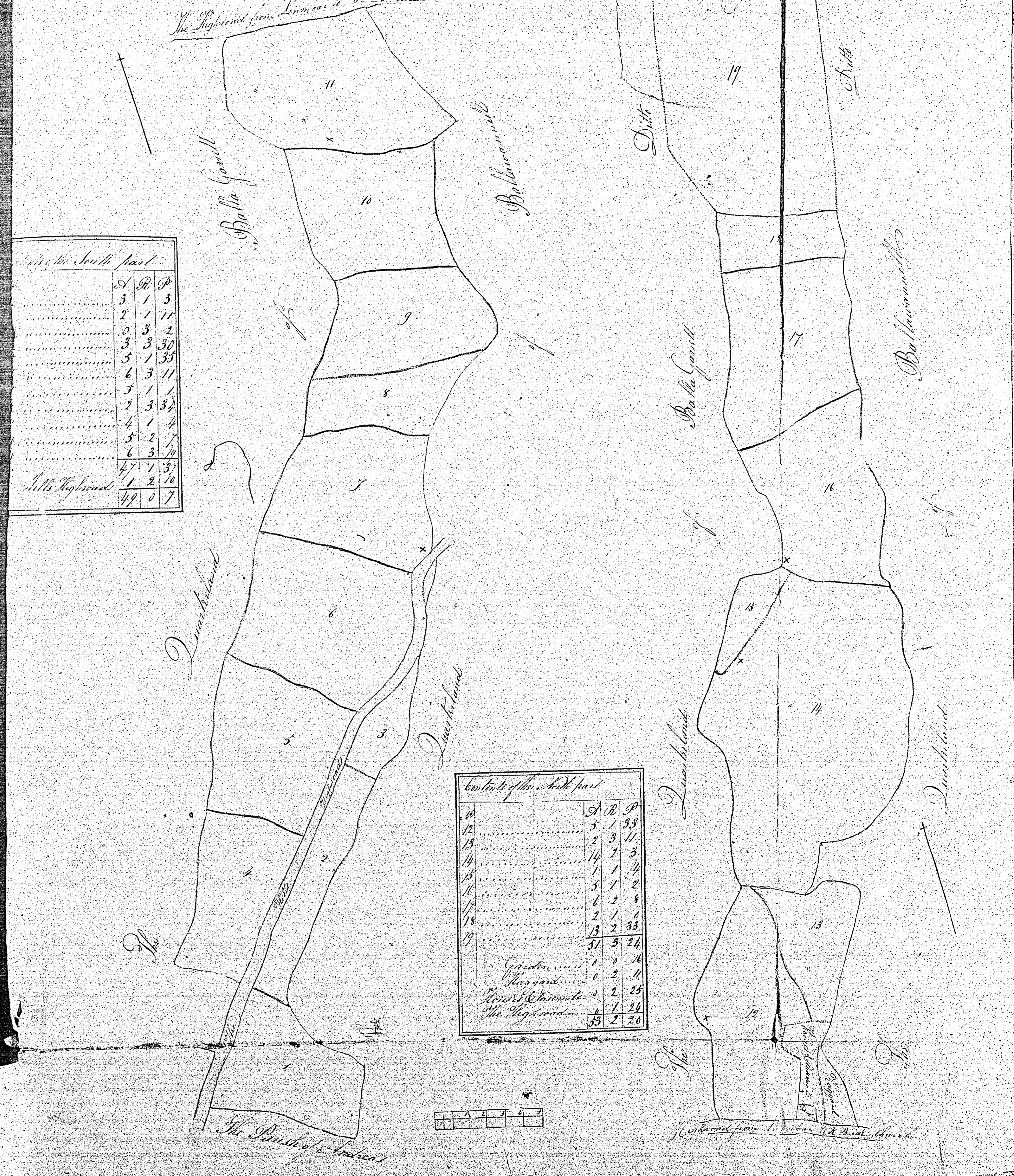

133. Plan of part of  
Ballaskally in  
the Parish of Breda  
the property of  
Mr. D. Skinner  
Mr. G. Hewitt



Scale of 3 Chains  
to One Inch

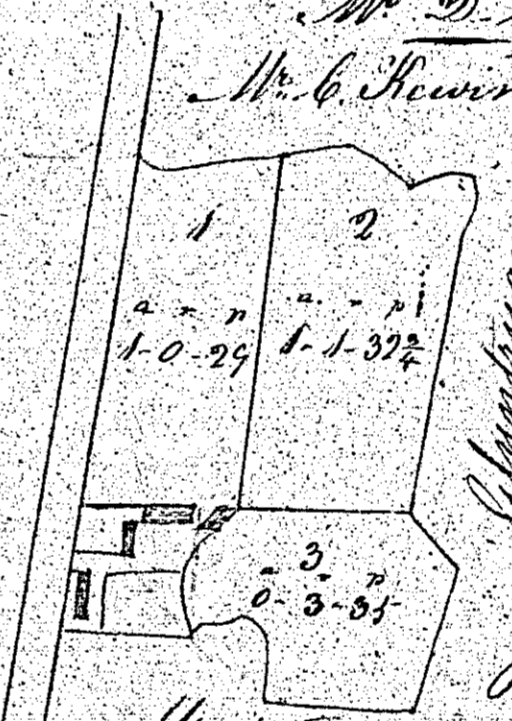

133



1	10.29
2	11.32
3	0.35
4	0.25
5	0.7
	3.3.8
	1.37
	4.1.5

Contents

3-2-16 1/2

Roofs & 2-0-1-37

Mr. Wm. Joughin Total 4-0-18 1/2

Contents of 1/2

By John Cowell  
Surveyor 1859

136.

134.



134  
A Plan and Survey  
of the Land of the  
Island of  
St. John of the River

Wm. G. G. G.  
Baltimore

1838

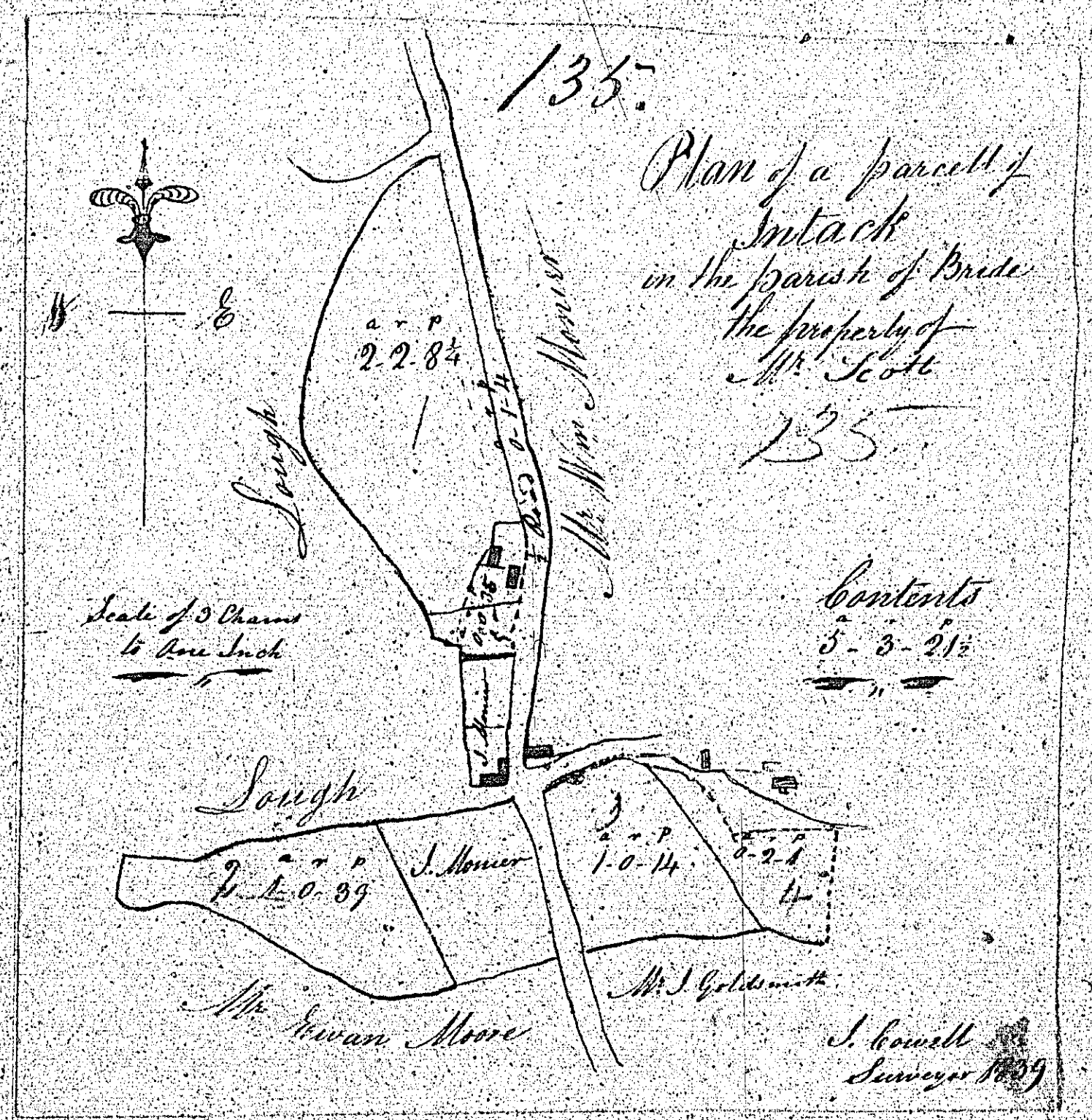

*Map and Survey of  
 Balla-vannell and Balli-vereage  
 in the Parish of Bride  
 the Property of  
 Mr. Wm. Deane  
 Surveyed by me John Funnell, Schoolmaster  
 This the 5<sup>th</sup> of May 1839*

*Ann of Commission*

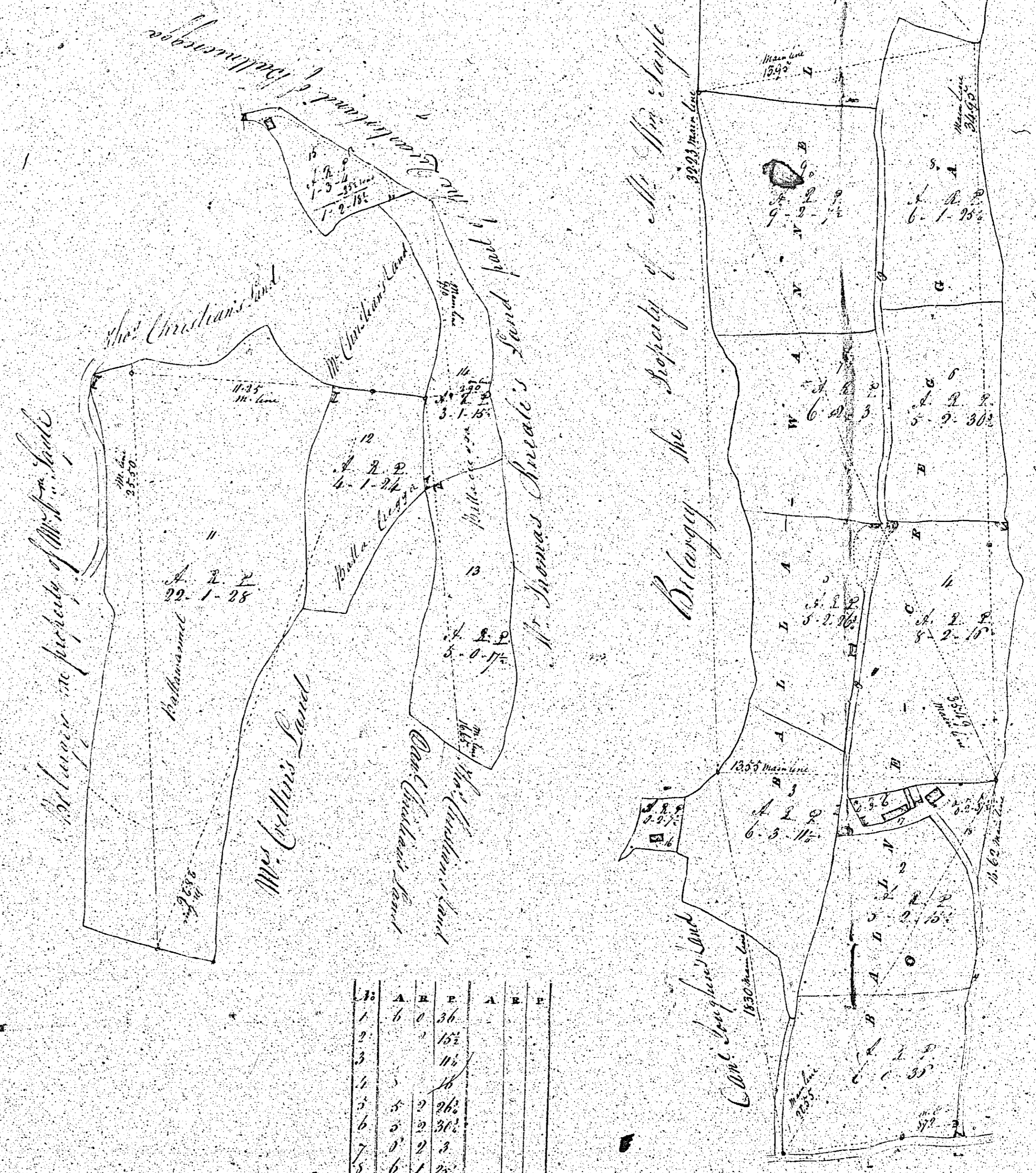

No.	A	R	P	A	R	P
1	1	0	36			
2	1	1	105			
3	1	1	11			
4	1	1	10			
5	1	1	102			
6	1	1	102			
7	1	1	10			
8	1	1	20			
9	1	1	7			
10	1	1	58			
11	1	1	1			
12	1	1	36			
13	1	1	3			
14	1	1	3			
15	1	1	2			
16	1	1	2			
17	1	1	1			
18	1	1	1			
19	1	1	1			
				59	1	59
20	1	1	25			
21	1	1	20			
22	1	1	18			
23	1	1	18			
24	1	1	18			
25	1	1	18			
26	1	1	18			
27	1	1	18			
28	1	1	18			
29	1	1	18			
30	1	1	18			
31	1	1	18			
32	1	1	18			
33	1	1	18			
34	1	1	18			
35	1	1	18			
36	1	1	18			
37	1	1	18			
38	1	1	18			
39	1	1	18			
40	1	1	18			
41	1	1	18			
42	1	1	18			
43	1	1	18			
44	1	1	18			
45	1	1	18			
46	1	1	18			
47	1	1	18			
48	1	1	18			
49	1	1	18			
50	1	1	18			
51	1	1	18			
52	1	1	18			
53	1	1	18			
54	1	1	18			
55	1	1	18			
56	1	1	18			
57	1	1	18			
58	1	1	18			
59	1	1	18			
60	1	1	18			
61	1	1	18			
62	1	1	18			
63	1	1	18			
64	1	1	18			
65	1	1	18			
66	1	1	18			
67	1	1	18			
68	1	1	18			
69	1	1	18			
70	1	1	18			
71	1	1	18			
72	1	1	18			
73	1	1	18			
74	1	1	18			
75	1	1	18			
76	1	1	18			
77	1	1	18			
78	1	1	18			
79	1	1	18			
80	1	1	18			
81	1	1	18			
82	1	1	18			
83	1	1	18			
84	1	1	18			
85	1	1	18			
86	1	1	18			
87	1	1	18			
88	1	1	18			
89	1	1	18			
90	1	1	18			
91	1	1	18			
92	1	1	18			
93	1	1	18			
94	1	1	18			
95	1	1	18			
96	1	1	18			
97	1	1	18			
98	1	1	18			
99	1	1	18			
100	1	1	18			

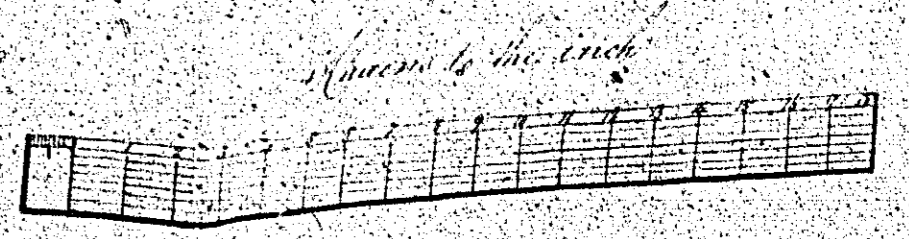

*Note all steep slopes are reduced to the horizontal Plane*