

No 5

View
side
D

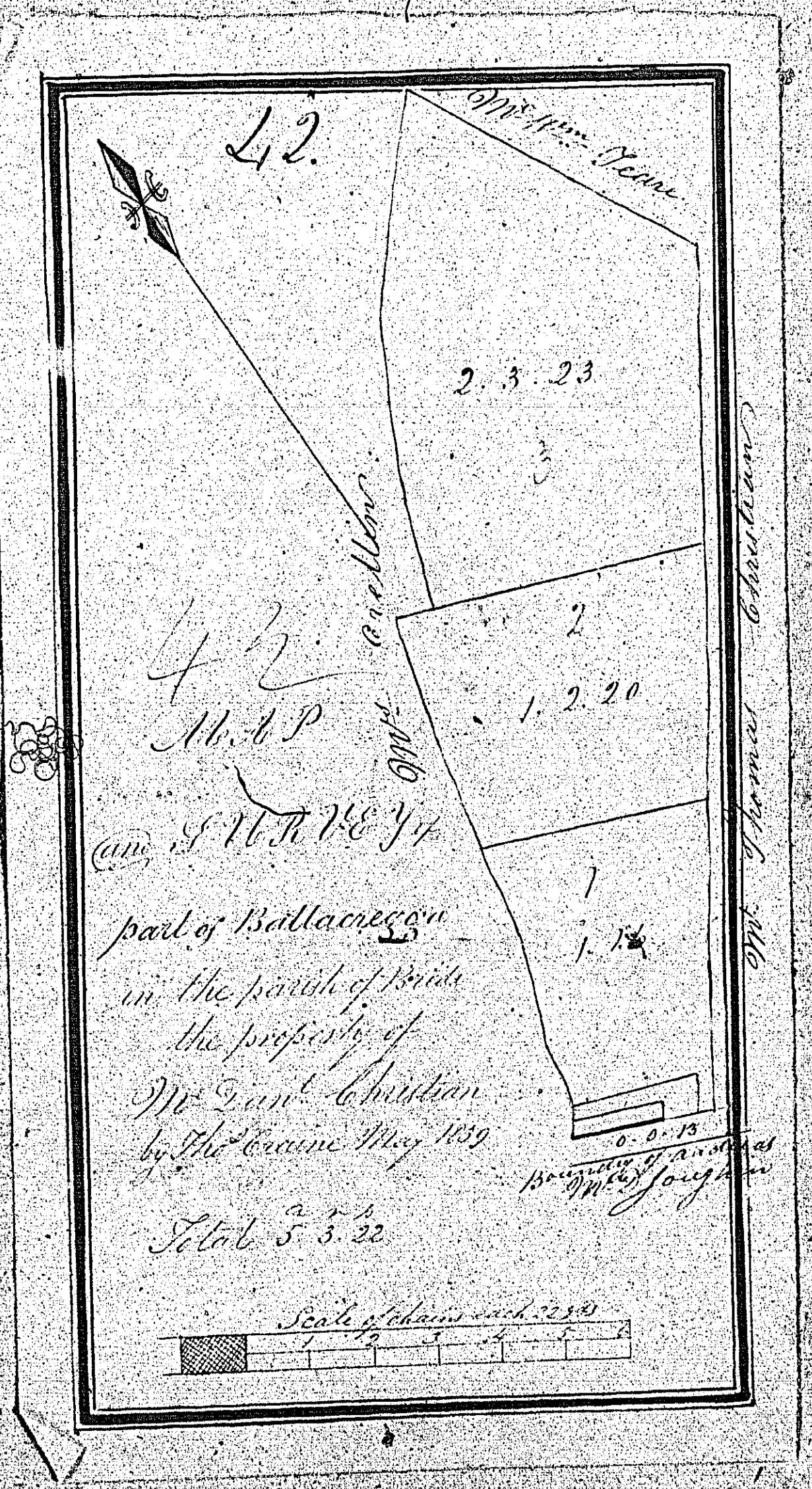

cents
 36
 6
 11
 10
 11
 12
 13
 14
 15
 16

Corr	mes
	1
	2
	3
	4
	5
	6
	7
	8
	9
	10
	11
	12
	13
	14
	15
	16

Proportion of roads

I
 S
 100

125

Side
of

Com

- 1
- 2
- 3
- 4
- 5
- 6
- 7
- 8
- 9
- 10
- 11
- 12
- 13
- 14
- 15
- 16

tents
0-56
0-6
0-14
1-16
0-27 1/2
0-3
0-6 1/2

Proportion of
Travels

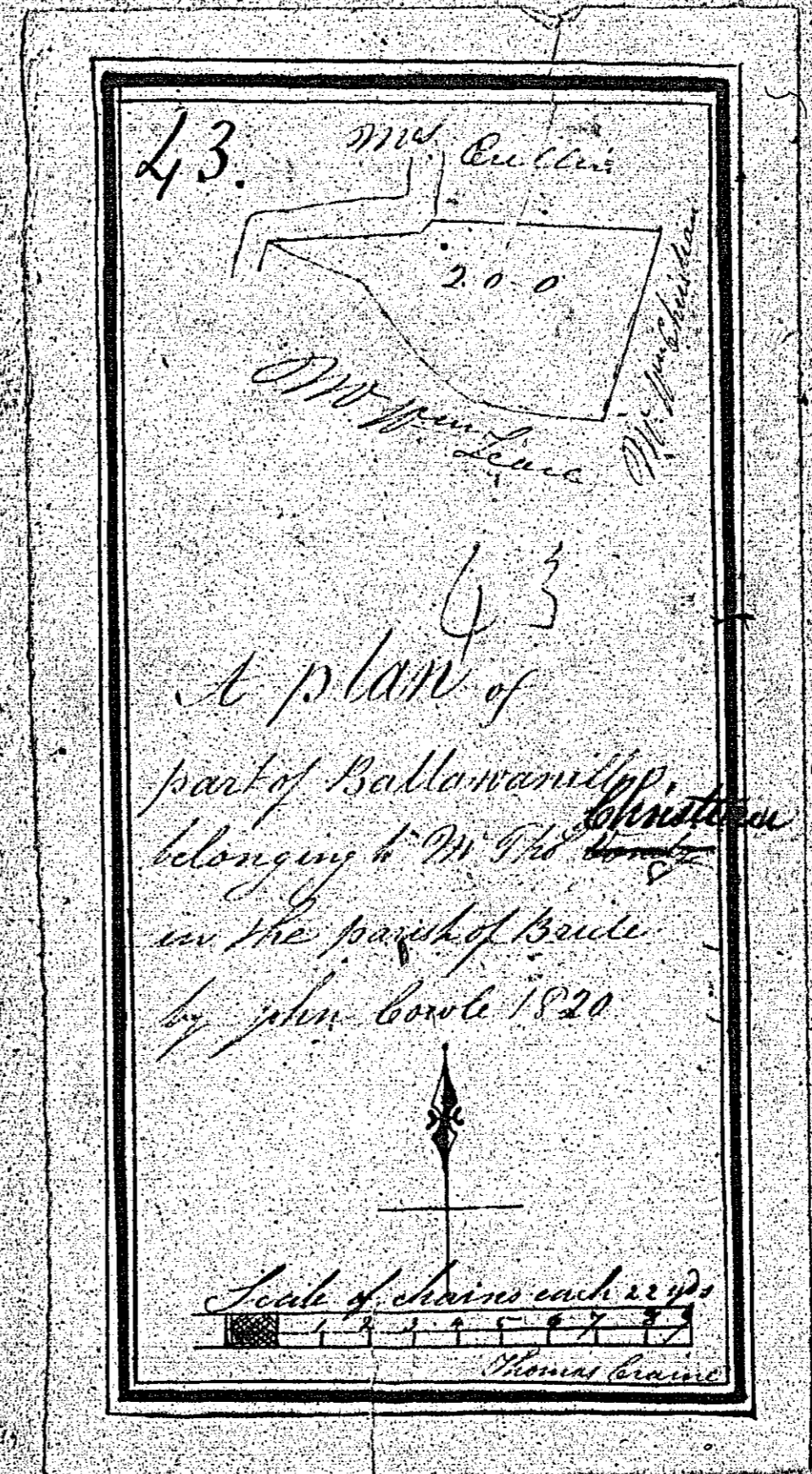

1

700

Wed

acolliers
of Bride
why of
attest

Con

1	
2	
3	
4	
5	
6	
7	
8	
9	
10	
11	
12	
13	
14	
15	
16	

Contents
 10-0-36
 1-2-6
 5-0-2 1/4
 12-1-10
 -5-0-2 1/4
 -3-2-3
 51-0-6 1/4

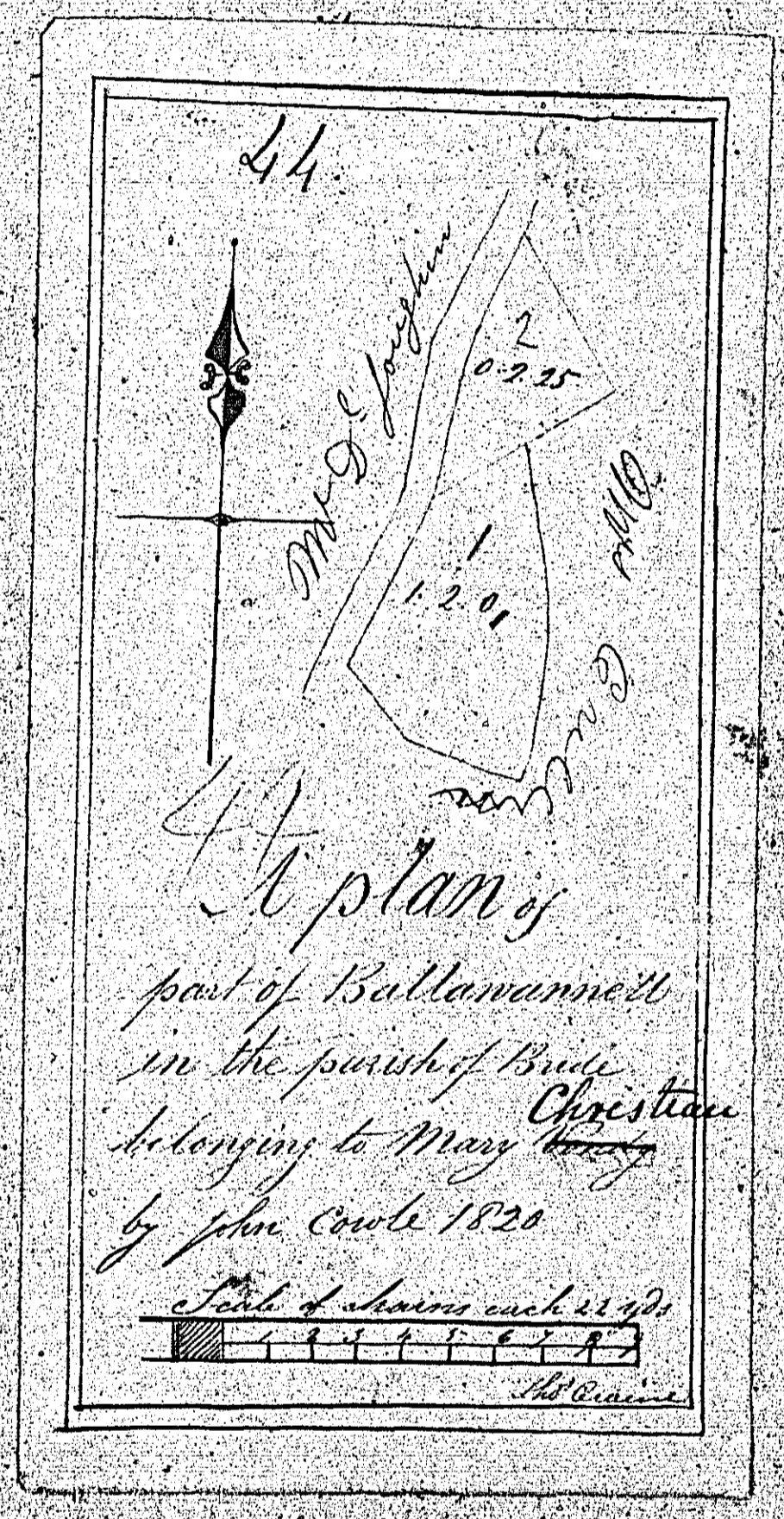

44
 A plan of
 part of Ballinameth
 in the parish of Bride
 belonging to Mary ^{Christina}
 by John Cooke 1820

Proportion of
Feet

I

100

45
 Plan of Ballacottier
 in the Parish of Bride
 the property of
 Mr. J. Cottrell

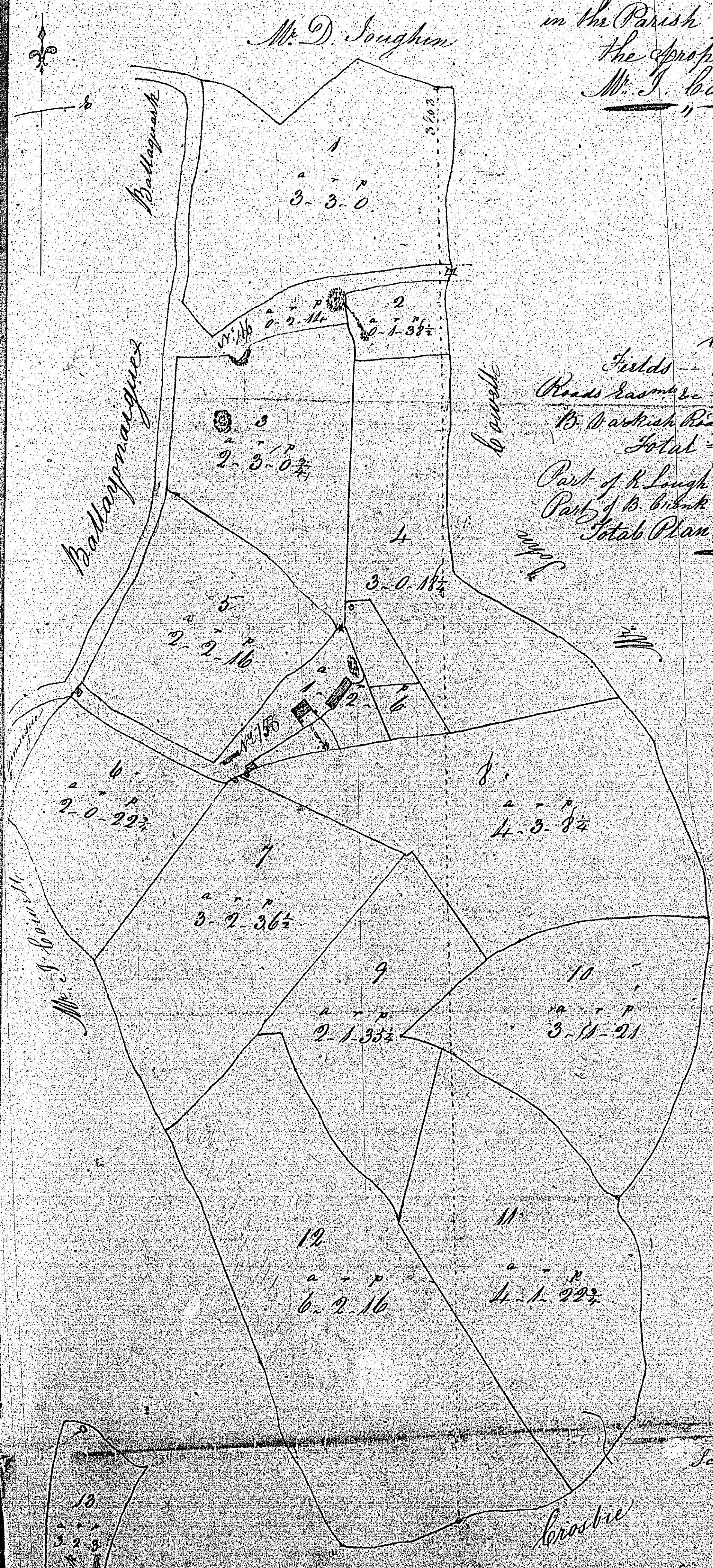

Contents

Fields	100 0 56
Roads	1 2 6
W. Parkish Road	2 1 1/2
Total	103 1 16
Part of B. Lough	5 0 2 1/2
Part of B. Brook	5 2 3
Total Plan	110 0 1 1/2

Contents

1
2
3
4
5
6
7
8
9
10
11
12
13
14
15
16

Proportions of
 Roads

ISLE OF MAN GOVERNMENT: GENERAL REGISTRY
 TITHE PLANS: PARISH OF BRIDE
 Original coloured (decorative), marked 1:30

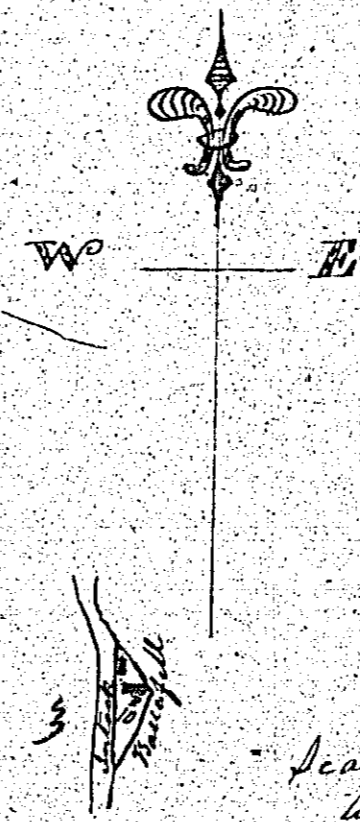

L. 6.

Plan of parcels
of Lands
in the parish of Bride
the property of
Mr. John Gallow

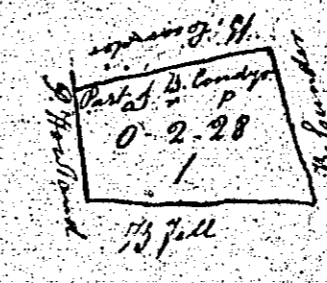

Scale of 3 Chains
to one Inch

Contents
4-2-13 3/4

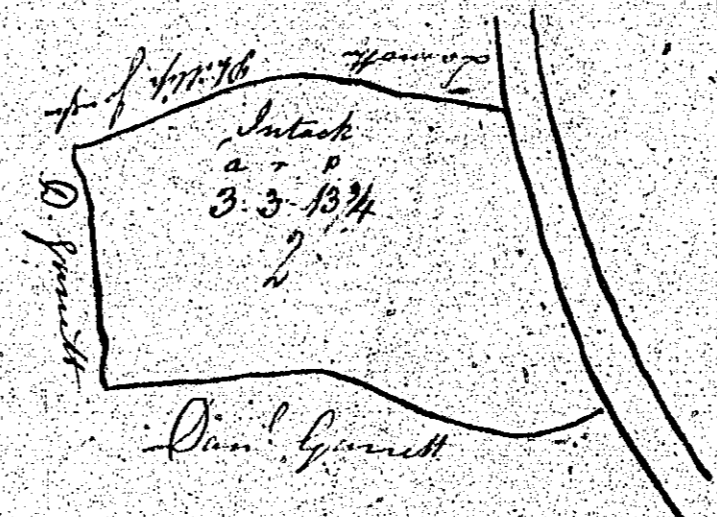

Danl. Gurnell

Scale of 3.5 Chains
to one Inch

J. Howell Surveyor
1839

Contents

1	
2	
3	
4	
5	
6	
7	
8	
9	
10	
11	
12	
13	
14	
15	
16	

Proportion of
acres

R. I. S.

Martin

ride

long 5 to

see plan

by 1839

Jacob Surveyor
Ramsey

17

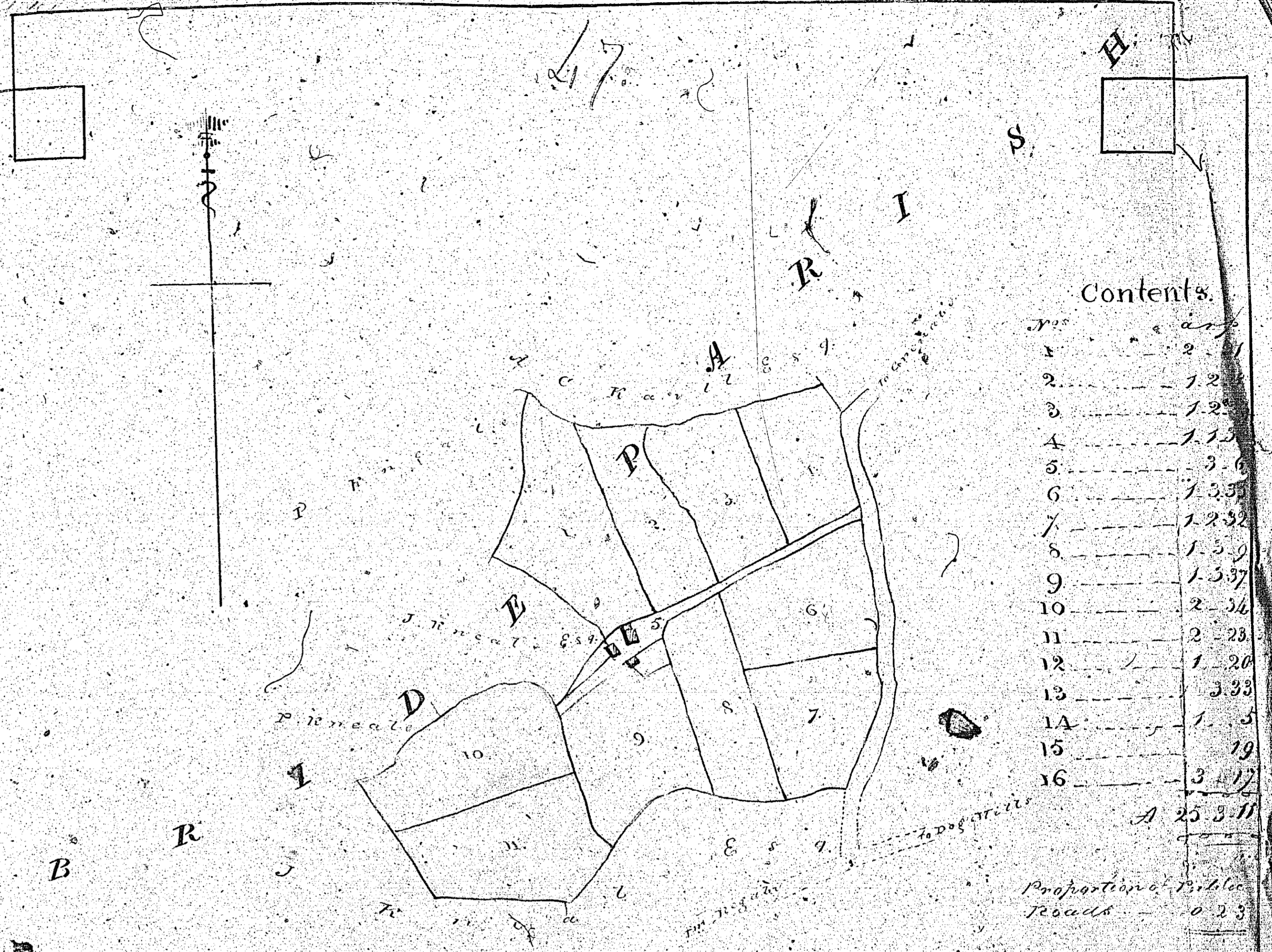

Contents.

1	1.21
2	1.22
3	1.23
4	1.24
5	3.6
6	1.35
7	1.32
8	1.59
9	1.37
10	2.54
11	2.23
12	1.20
13	3.33
14	1.5
15	19
16	3.17
A 25.311	

Proportion of Public
Roads 0.23

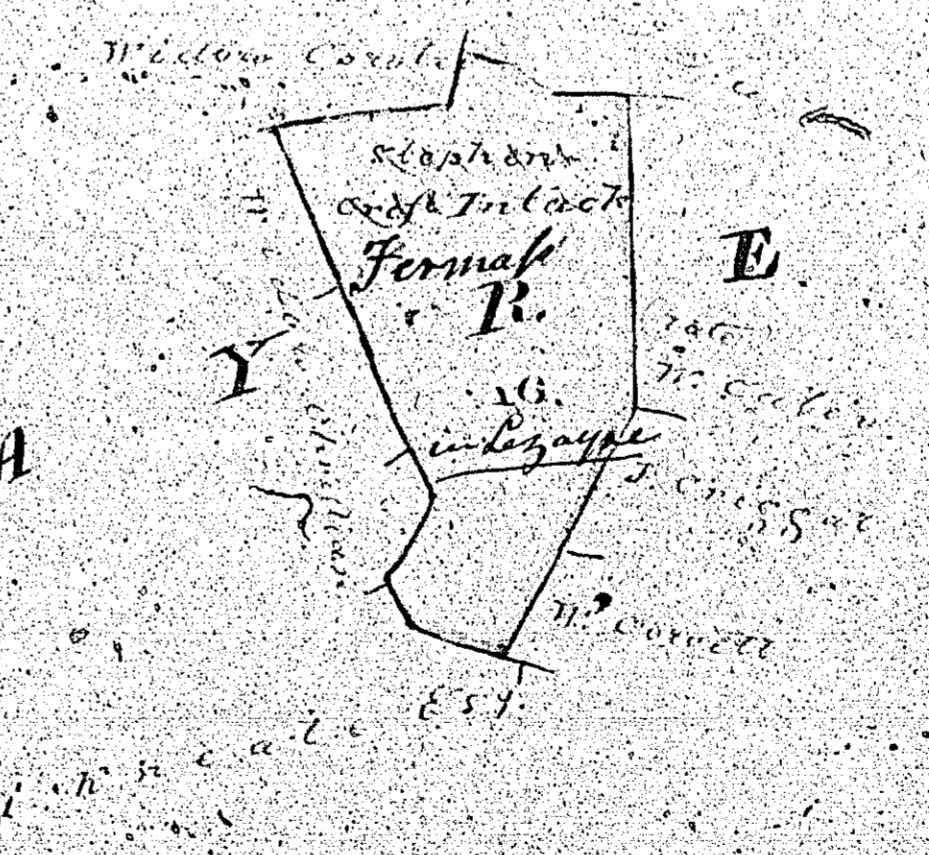

Balla Mar
in
Evide
John
Mr John Gann
July 1839

Scale 10 Chains
Royal Ordnance
Sand Surveyor
Ramsey