

Not used
5

Not used
4

Plan of the Estate of **Dak Hill**
in the Parish of Braddan, Isle of Man.
the Property of Mrs Anne Bell.

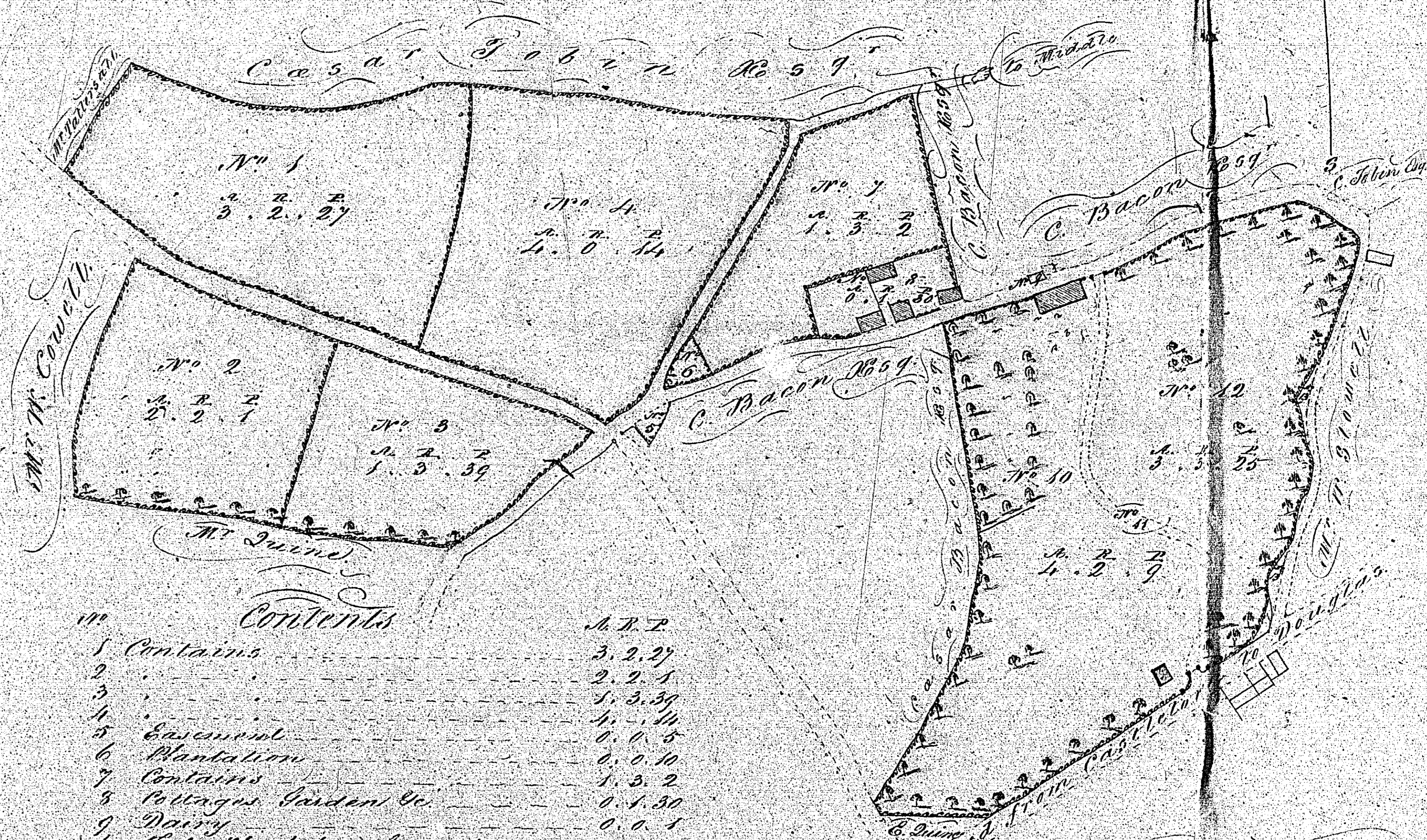

Contents

No	Description	A. R. P.
1	Contains	3. 2. 27
2		2. 2. 5
3		1. 3. 39
4		4. 0. 14
5	Enclosure	0. 0. 5
6	Mantations	0. 0. 10
7	Contains	1. 3. 2
8	Pollage Garden &c	0. 1. 30
9	Dairy	0. 0. 1
10	Fields, Mantations, Gardens & Mansions	1. 2. 9
11	Carriage Drive or Approach	0. 0. 26
12	Meadow & Mantations	3. 5. 25
13	Commons in Road	0. 0. 10
	Total	<u>23. 1. 2</u>

Scale 2 Chains to an Inch.

Robt. Carruth Surveyor
1840



Plan
or
Detached premises
in the Parish of Braddan
the Property of
Cesar Bacon Esq.

ISLE OF MAN GOVERNMENT: GENERAL REGISTRY
TITHE PLANS: PARISH OF BRADDAN
 Original monotone 1:30

6

C A M L U I R G
 in the Parish of Bradlan
 The Property of *M^{rs} CRELLIN*
 October, 1859

Contents.			
No.	a.	r.	p.
1	11	3	31
2	10	1	33
2a	0	0	13
3	7	0	19
4	16	0	11
5	11	1	11
6	0	2	21
7	8	2	9
8	6	1	36
9	4	1	19
10	0	2	7
11	0	2	29
12	7	0	19
13	0	3	20
14	5	1	12
15	0	2	20
16	8	2	6
17	6	0	32
Came up 107			2 - 36
No.	a.	r.	p.
18	0	5	7
19	0	1	29
20	9	0	3
21	7	2	32
22	13	3	21
23	0	0	26
24	4	2	23
25	12	0	9
26	19	3	30
27	9	0	36
28	1	0	27
29	0	0	9
30	1	1	39
31	1	1	36
32	2	1	28
33	0	0	7
Total			202 - 1 - 1

Proportion of Public Roads 2 - 5 - 25
 Do. Rivers 0 - 3 - 9



Survey
of the lands

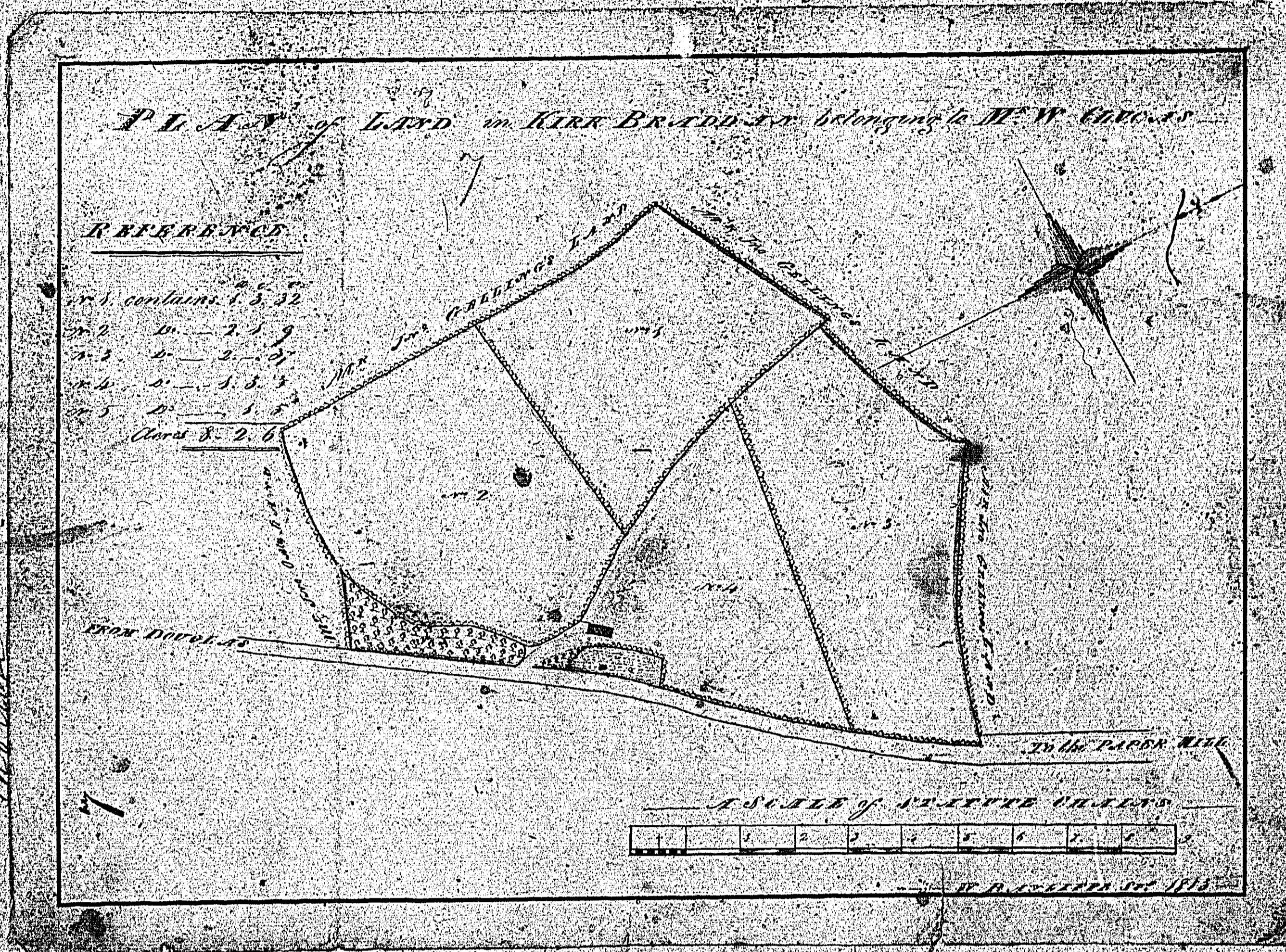

ISLE OF MAN GOVERNMENT: GENERAL REGISTRY
TITHE PLANS: PARISH OF BRADDAN
Original coloured, marked

1:30

The two following plans are
both numbered 8

