

*Buttack Meadows*

*Situated in Ballynagh*

*The Property of*

*Mr. Wm. Stephens 1891.*

*By Danl. Crockett Aug. 1888*

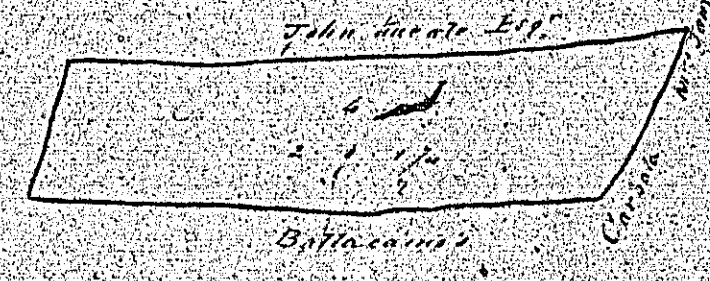
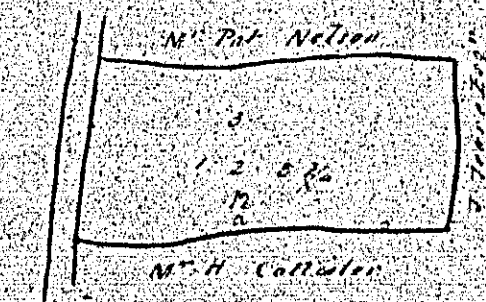
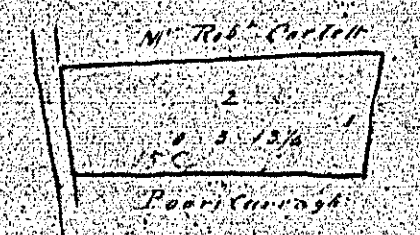
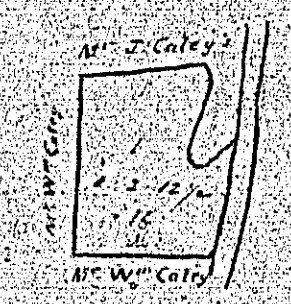
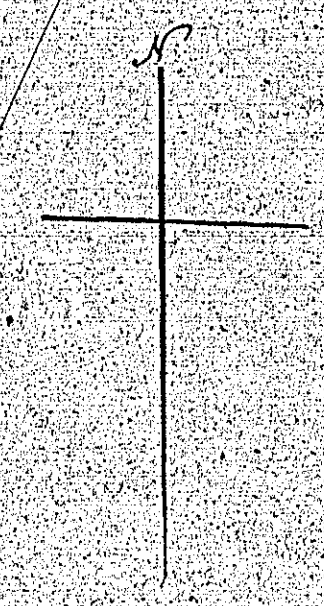

*Contents*

No.	Acres	R.	P.
1	1	2	11 1/2
2	1	2	11 1/2
3	1	2	11 1/2
4	1	2	11 1/2
Total		4	45 1/2

*Scale of 1/2 chain to the inch*

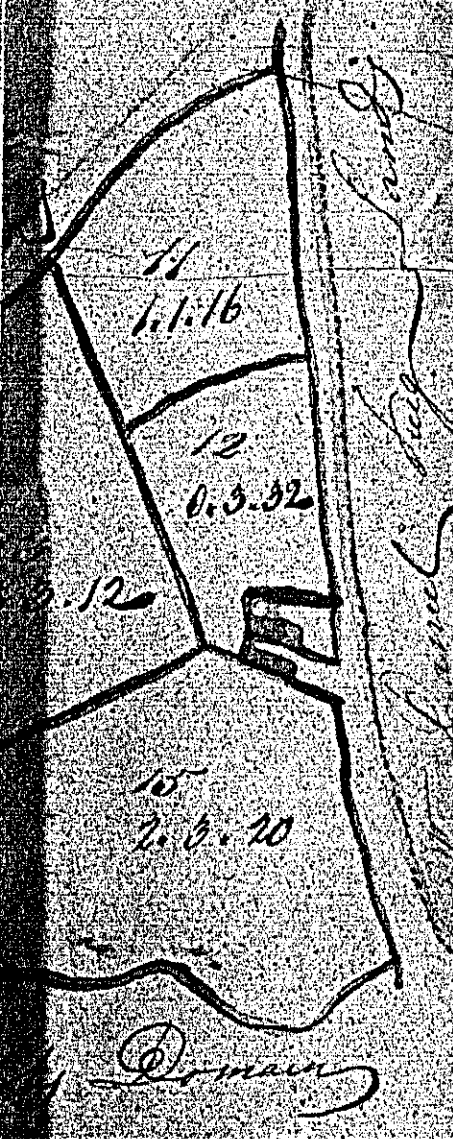
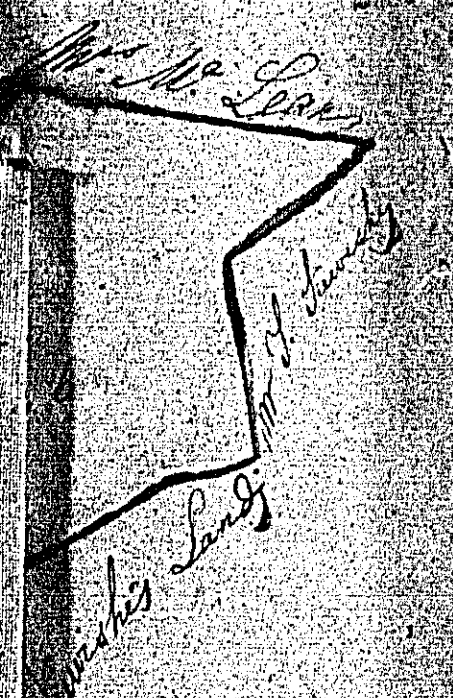



192.

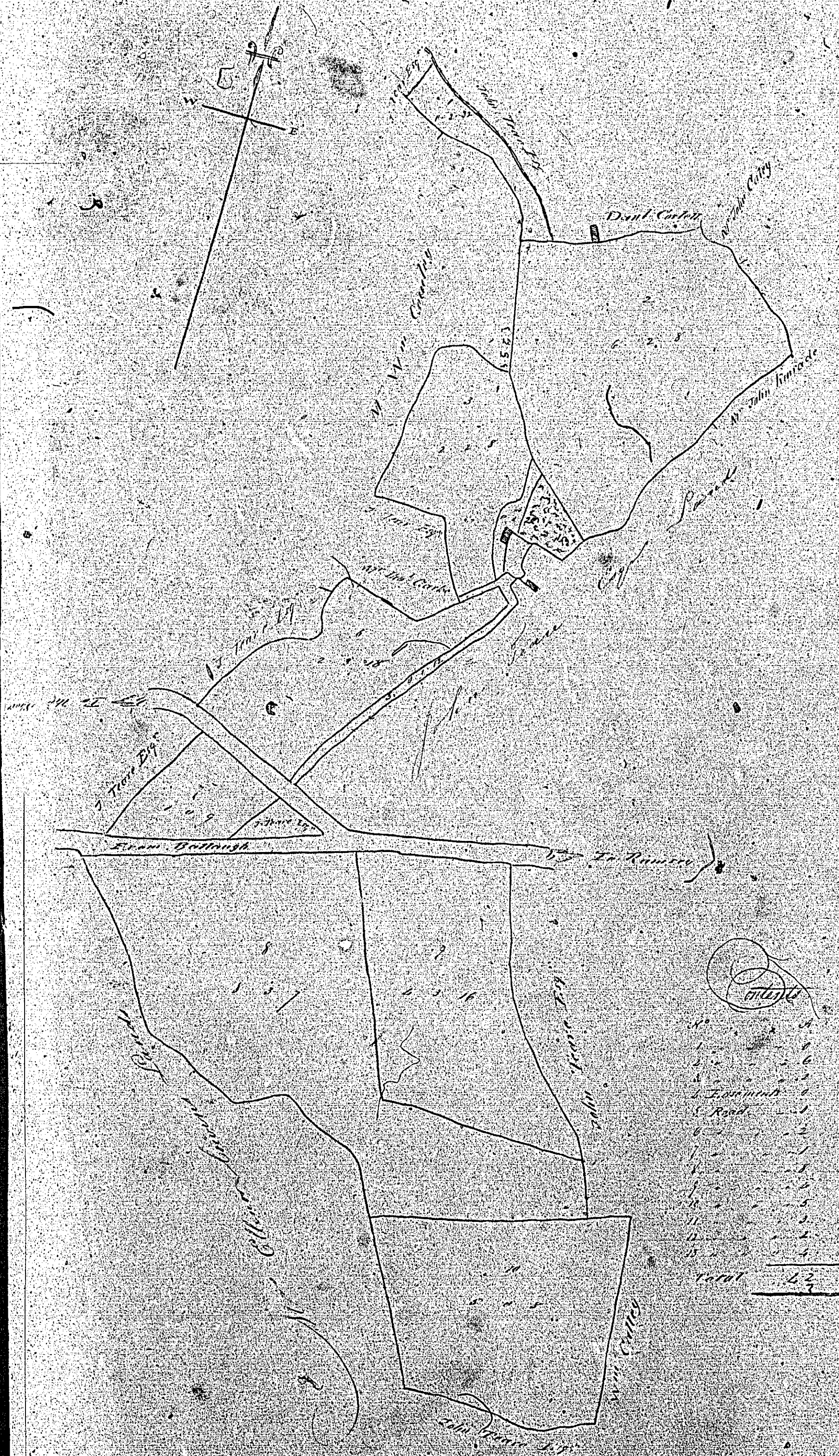

Part of  
 Ballasally Quarterland  
 and Subdiv. Ballinagh  
 In Right of  
 The Late Miss Cath. Stephen  
 By J. D. Cogan Esq. 1850  
 192.



Acreage	
1	1/2
2	1/2
3	1/2
4	1/2
5	1/2
6	1/2
7	1/2
8	1/2
9	1/2
10	1/2
11	1/2
12	1/2
13	1/2
14	1/2
15	1/2
16	1/2
17	1/2
18	1/2
19	1/2
20	1/2
21	1/2
22	1/2
23	1/2
24	1/2
25	1/2
26	1/2
27	1/2
28	1/2
29	1/2
30	1/2
31	1/2
32	1/2
33	1/2
34	1/2
35	1/2
36	1/2
37	1/2
38	1/2
39	1/2
40	1/2
41	1/2
42	1/2
43	1/2
44	1/2
45	1/2
46	1/2
47	1/2
48	1/2
49	1/2
50	1/2
51	1/2
52	1/2
53	1/2
54	1/2
55	1/2
56	1/2
57	1/2
58	1/2
59	1/2
60	1/2
61	1/2
62	1/2
63	1/2
64	1/2
65	1/2
66	1/2
67	1/2
68	1/2
69	1/2
70	1/2
71	1/2
72	1/2
73	1/2
74	1/2
75	1/2
76	1/2
77	1/2
78	1/2
79	1/2
80	1/2
81	1/2
82	1/2
83	1/2
84	1/2
85	1/2
86	1/2
87	1/2
88	1/2
89	1/2
90	1/2
91	1/2
92	1/2
93	1/2
94	1/2
95	1/2
96	1/2
97	1/2
98	1/2
99	1/2
100	1/2

Scale of 5 chains to the inch



*Westwood*

*Atlan's ...*  
*...*  
*...*  
*193*

*Reference*

<i>1</i>	<i>no 3. 24</i>
<i>2</i>	<i>0. 1. 22</i>
<i>3</i>	<i>2. 0. 35</i>
	<i>1. 1. 5 ...</i>
	<i>0. 0. 12 ...</i>
	<i>4. 0. 4 ...</i>
<i>Total</i>	<i>5. 0. 35</i>

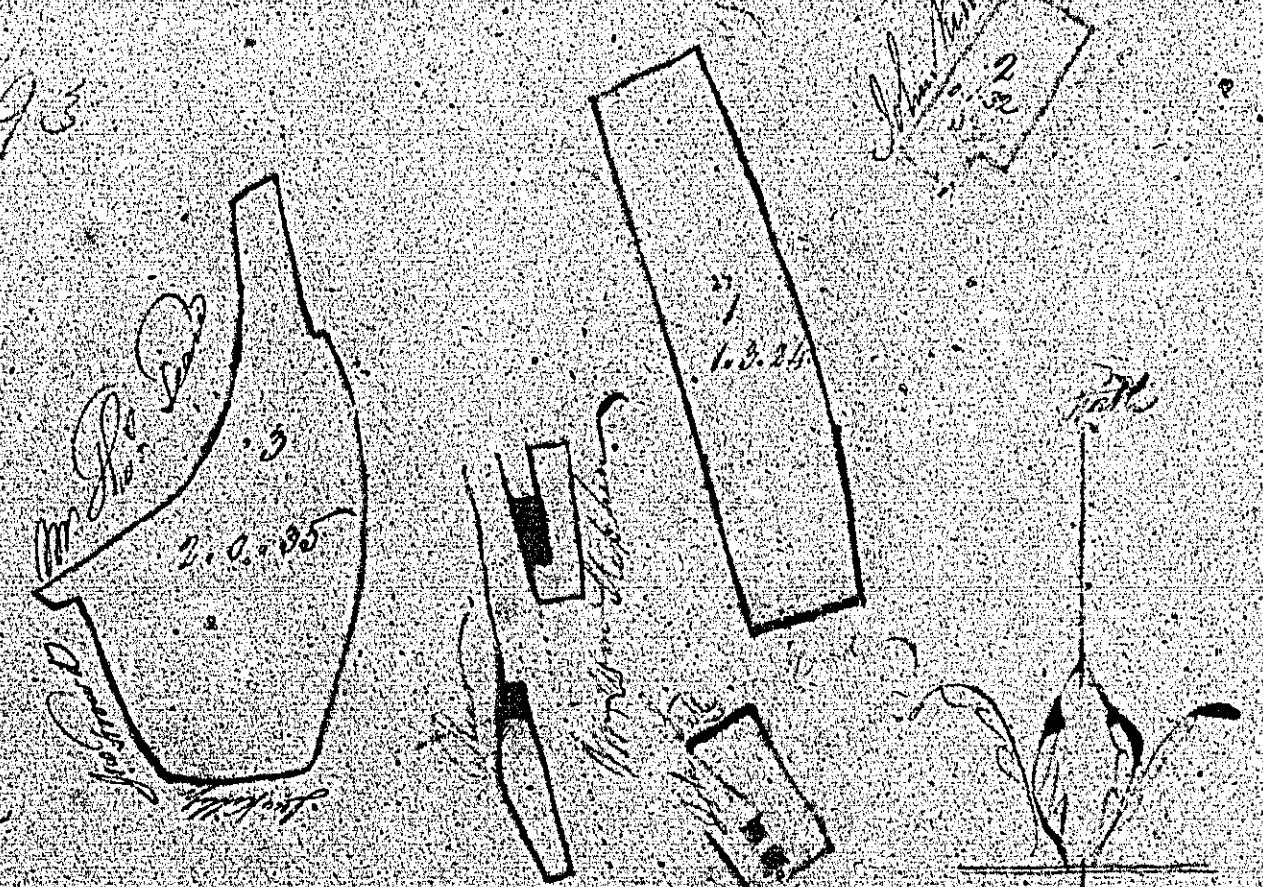

*Scale 3 inches on each*

*103.*

*Westwood*



194.

A Plan & Survey of Part of Ballyvaughan  
 & other Lands in the Parish of Ballyvaughan  
 the Property of Mr James Lambman

by P. Kelly, Surveyor  
 1840  
 194

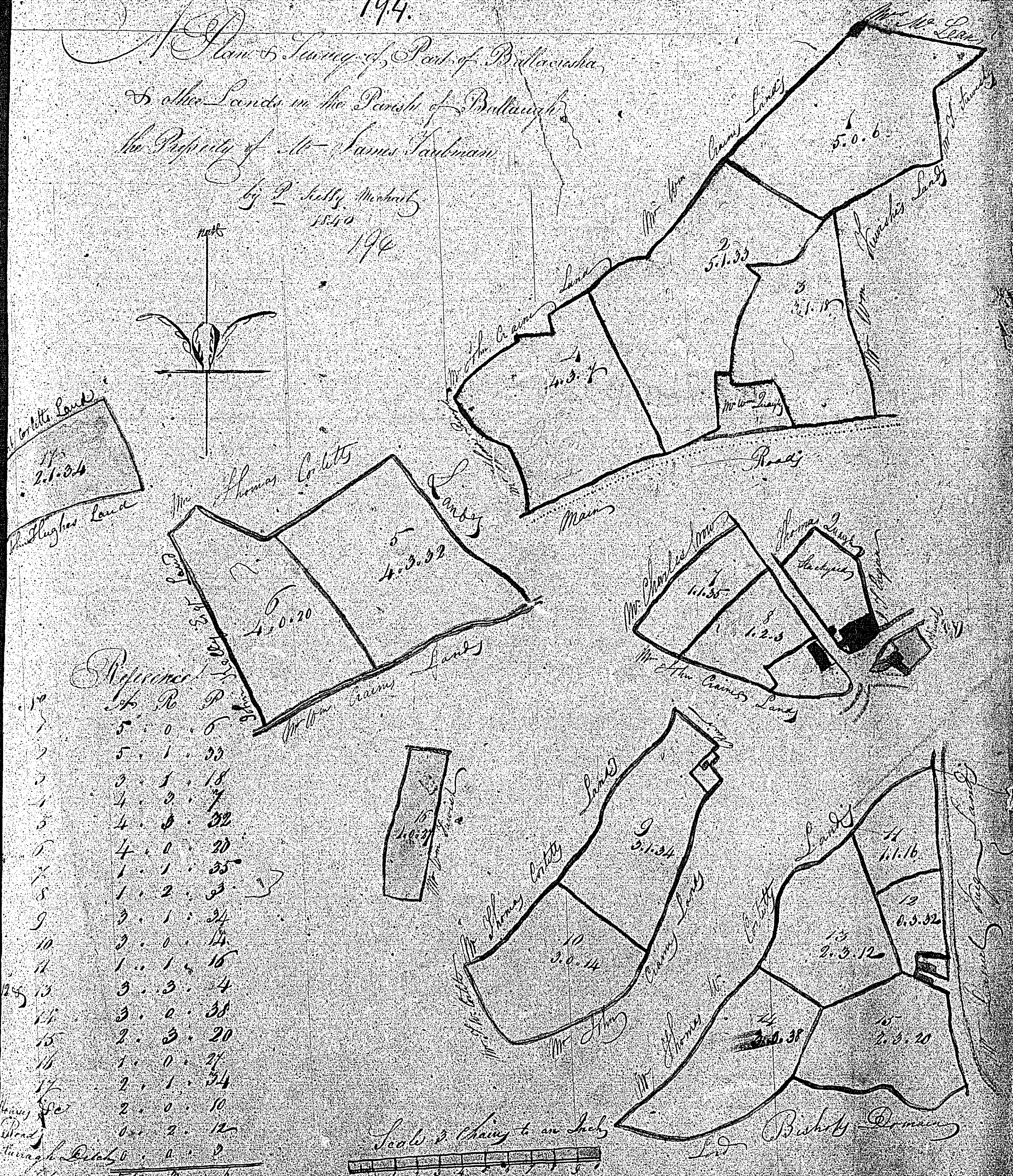
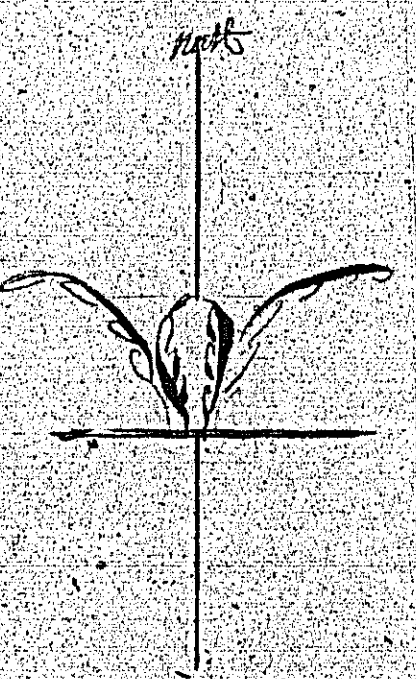

Reference

No	Ac	R	P
1	5	0	6
2	5	1	33
3	3	5	18
4	4	0	7
5	4	0	32
6	4	0	20
7	1	1	35
8	1	2	3
9	3	1	24
10	2	0	14
11	1	1	16
12	3	3	4
13	3	0	38
14	2	3	20
15	1	0	24
16	2	1	34
17	2	0	10
18	0	2	12
19	0	0	0
20	5	4	5

Scale of Chain to an Inch

Lord Bishop's Demesne



*Not used*

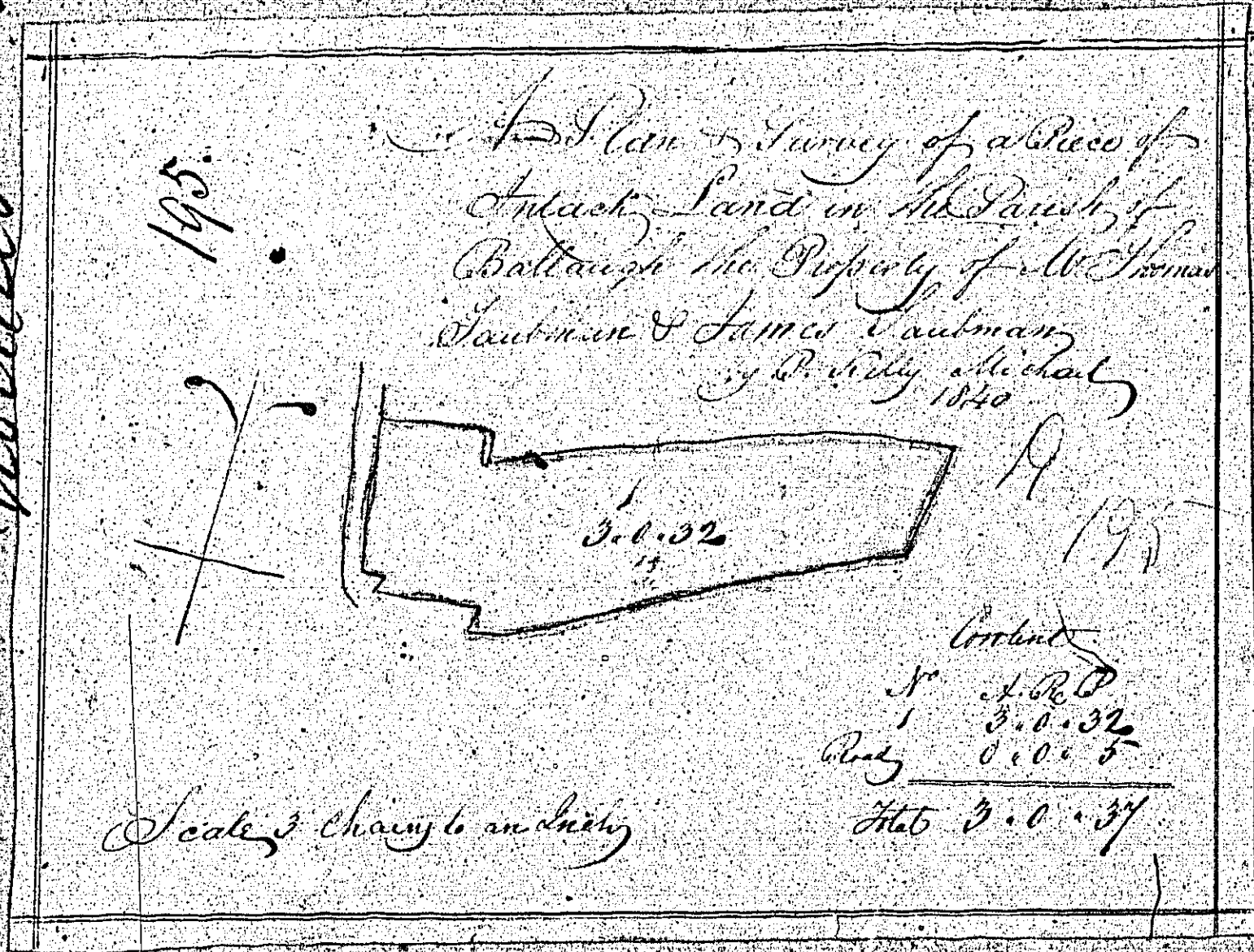

*Not used*

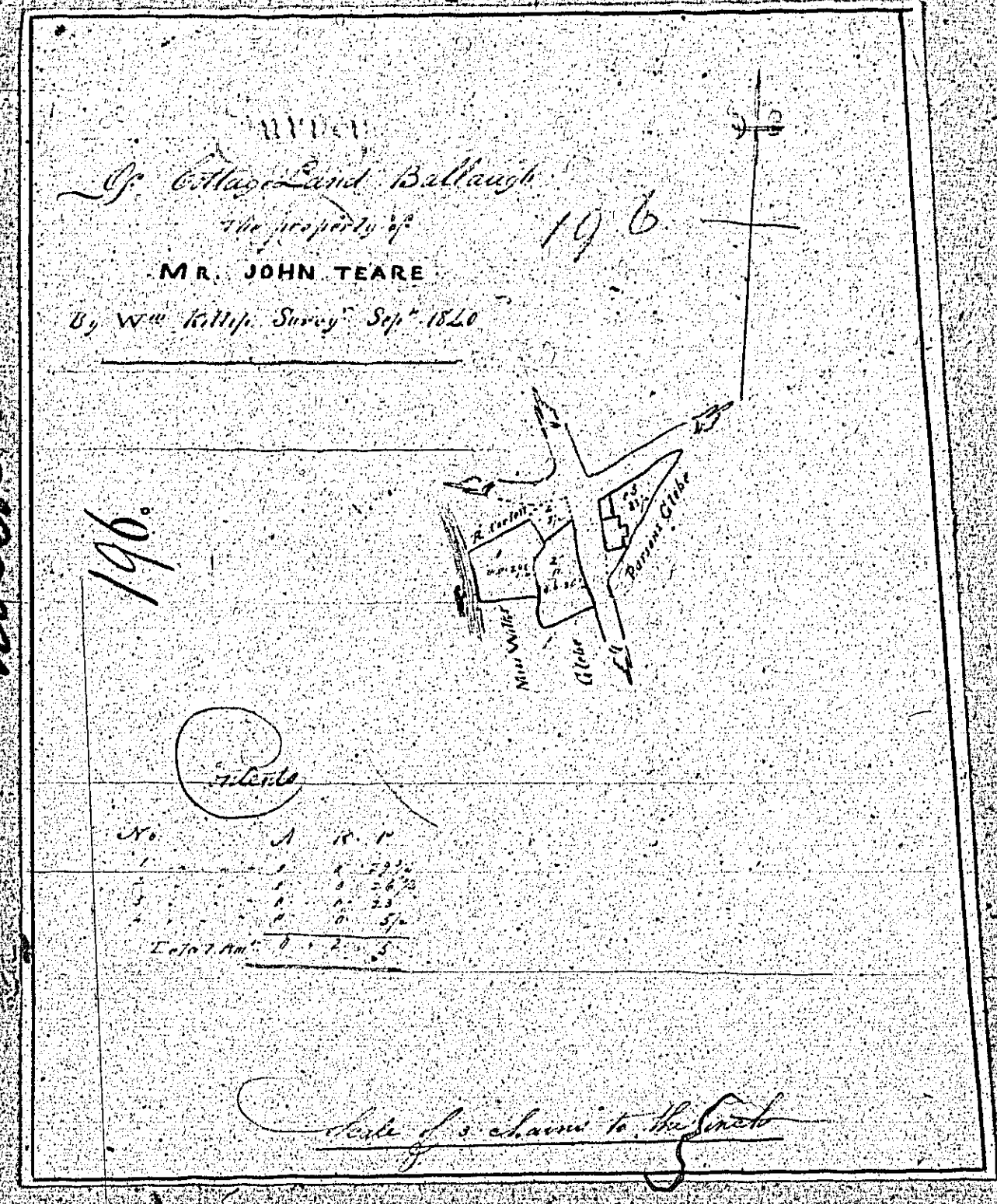

*Not used*

**ISLE OF MAN GOVERNMENT: GENERAL REGISTRY**

**TITHE PLANS: PARISH OF BALLAUGH**

Originals coloured (decorative) 1:30



