

There is no plan
numbered 178

ISLE OF MAN GOVERNMENT: GENERAL REGISTRY
TITHE PLANS: PARISH OF BALLAUGH

1.30

179 Original monotone

180 Original coloured

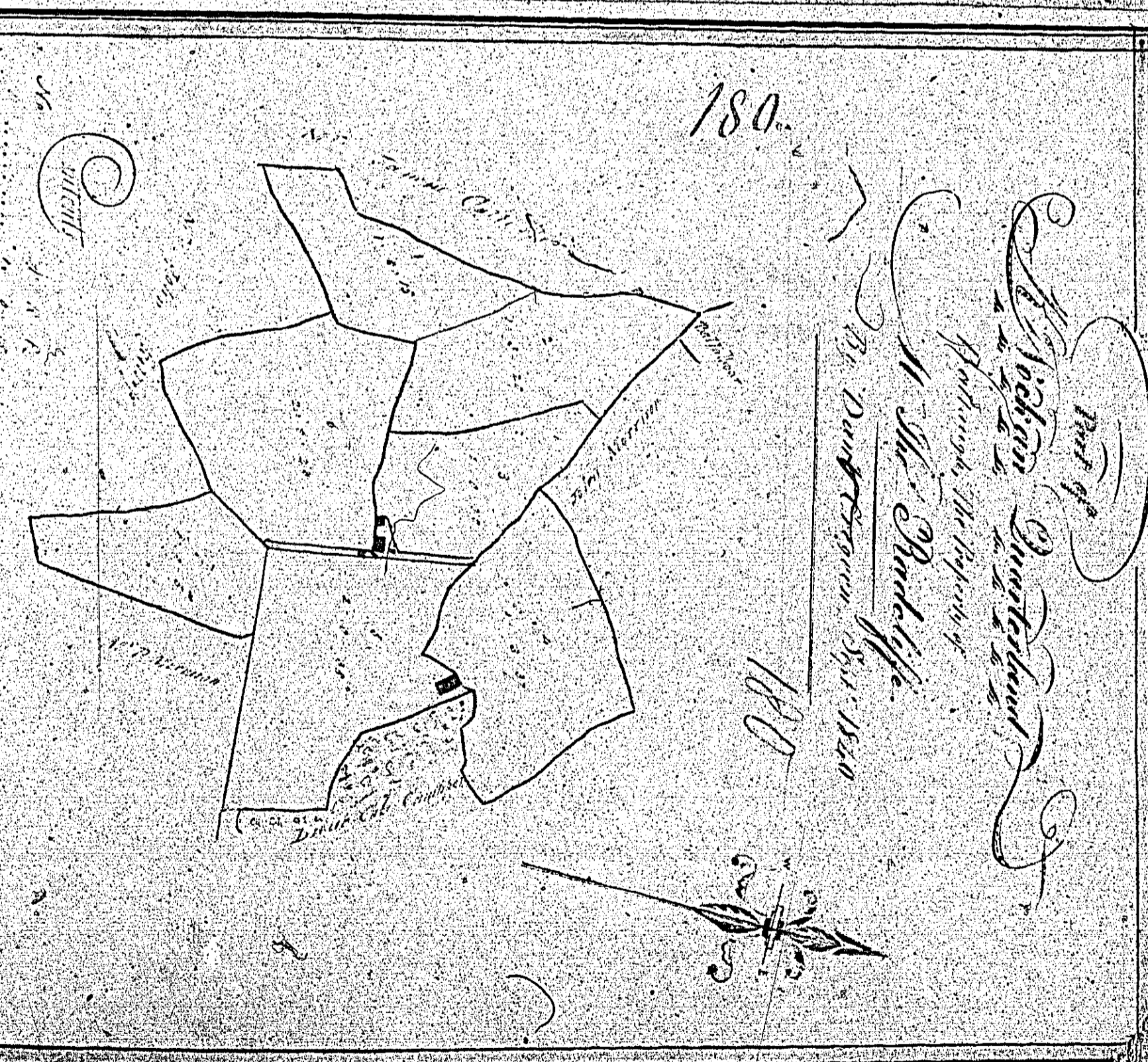
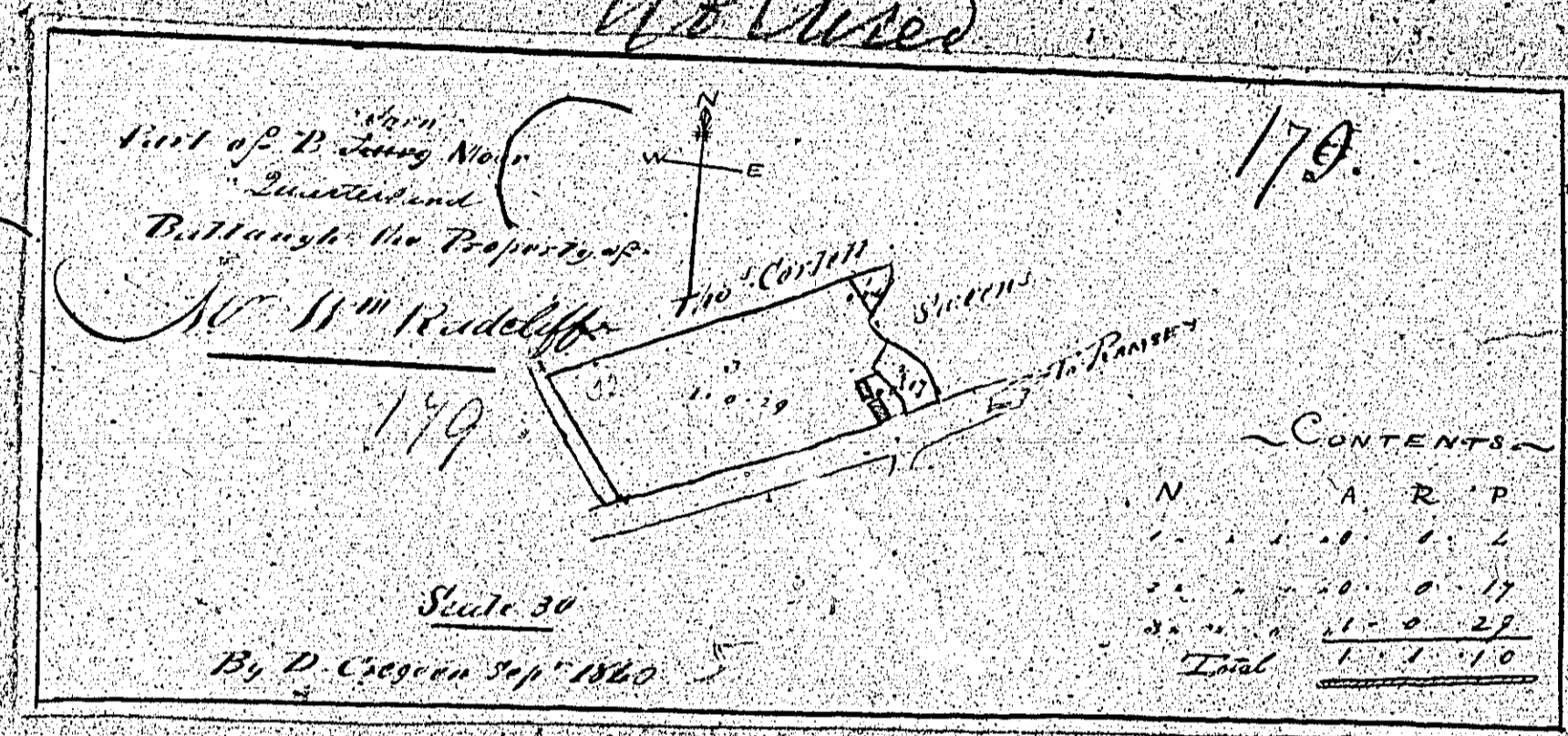

183.

A Plan & Area of Part of Glendoo
in the Parish of Ballaugh the Property
of Mr Charles Shimmer,
by R. Kelly & Co. Surveyors
1828

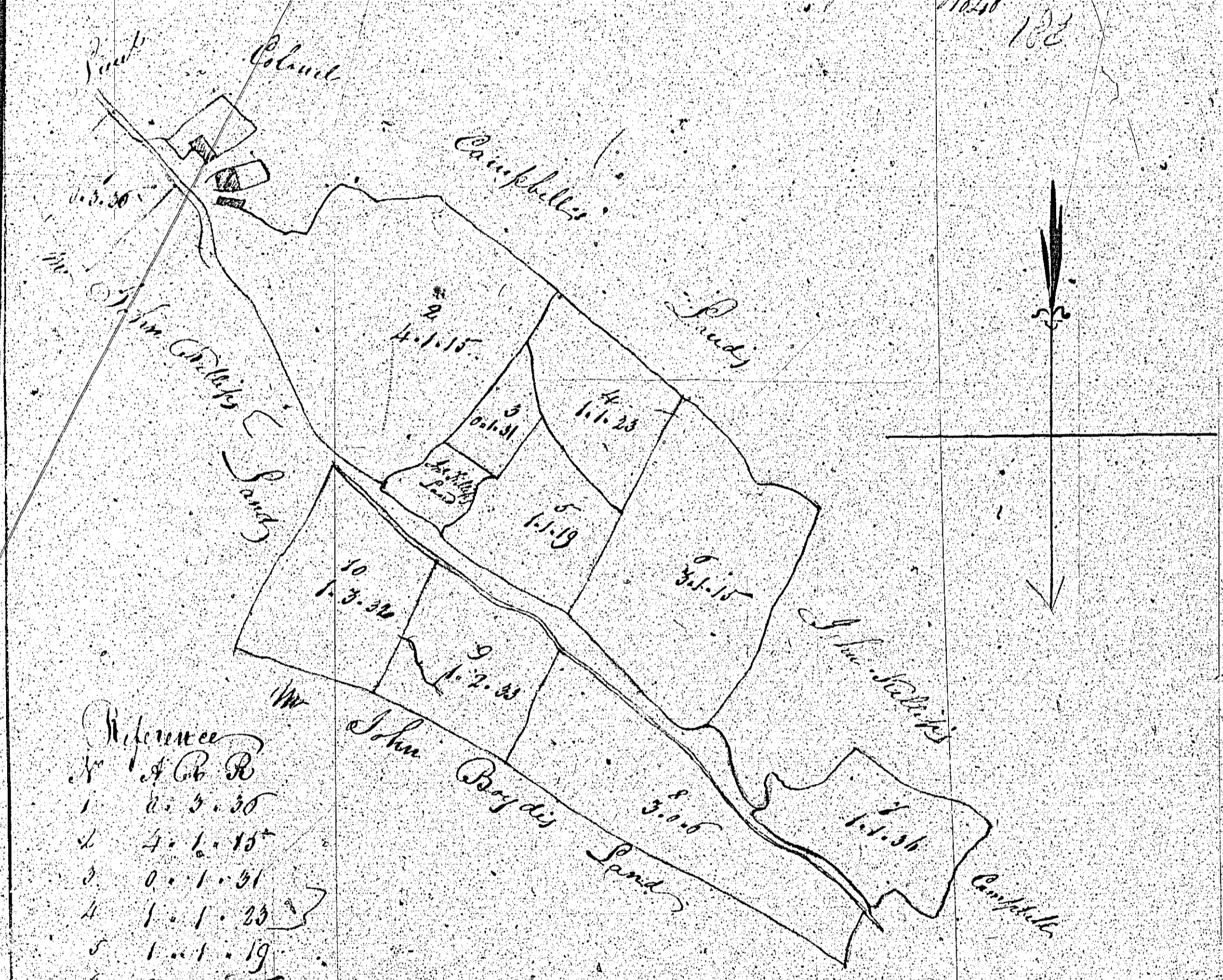

Reference

1	0. 5. 30
2	4. 6. 15
3	0. 1. 31
4	1. 1. 23
5	1. 1. 19
6	3. 1. 15
7	1. 1. 38
8	3. 0. 0
9	1. 2. 23
10	1. 3. 30
Colony	0. 1. 14
John Kelly	0. 2. 11
Mr. Kelly & Co.	0. 1. 28
Shimmer	
Total	27. 0. 22

Scale 3 Chains to an Inch

W ——— E

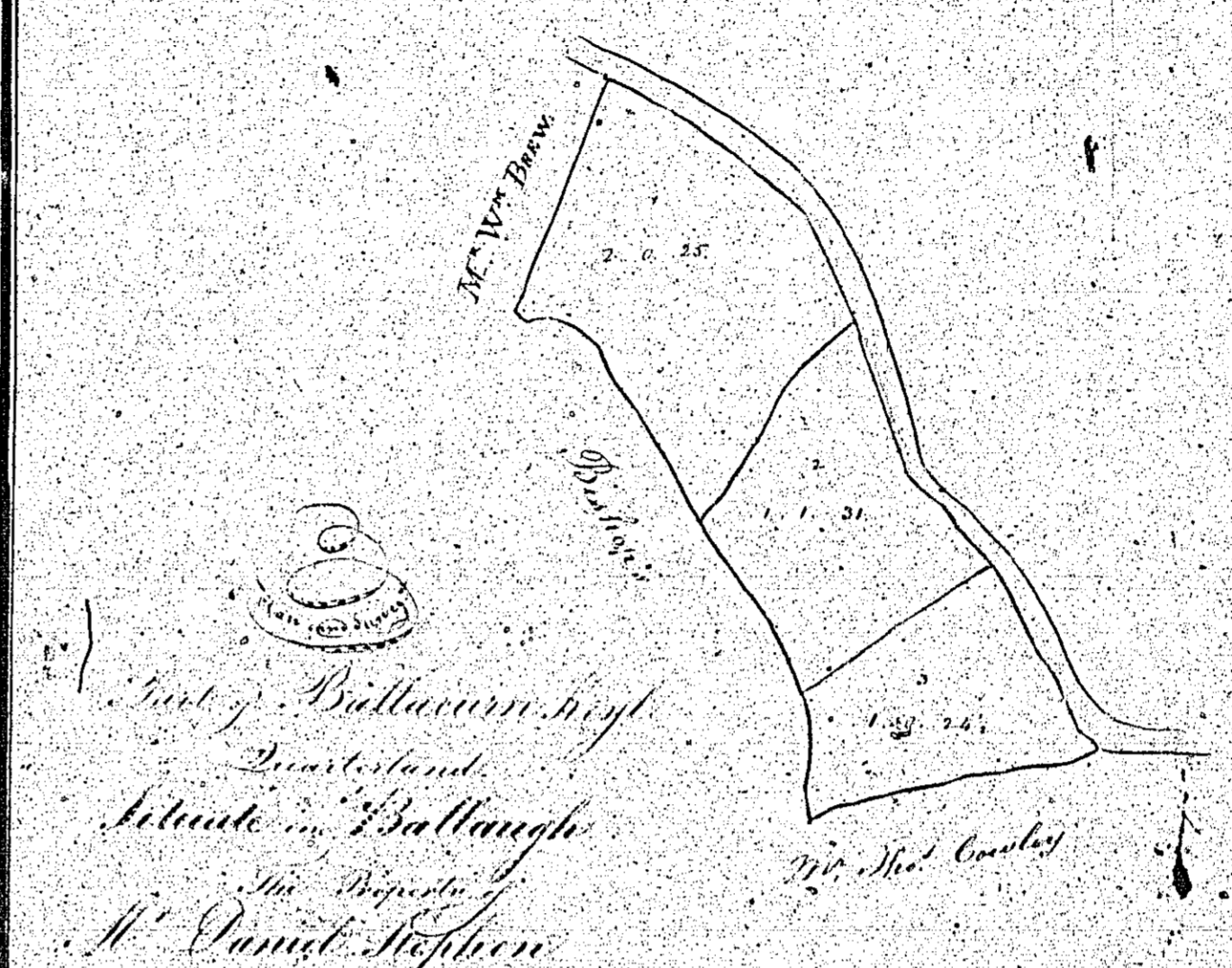

Part of Ballymore high
 Quarterland
 Situate in Ballymore
 The Property of
 Mr. Daniel Stephenson

Surveyed by D. Cregeen
 29th Aug. 1840.

184

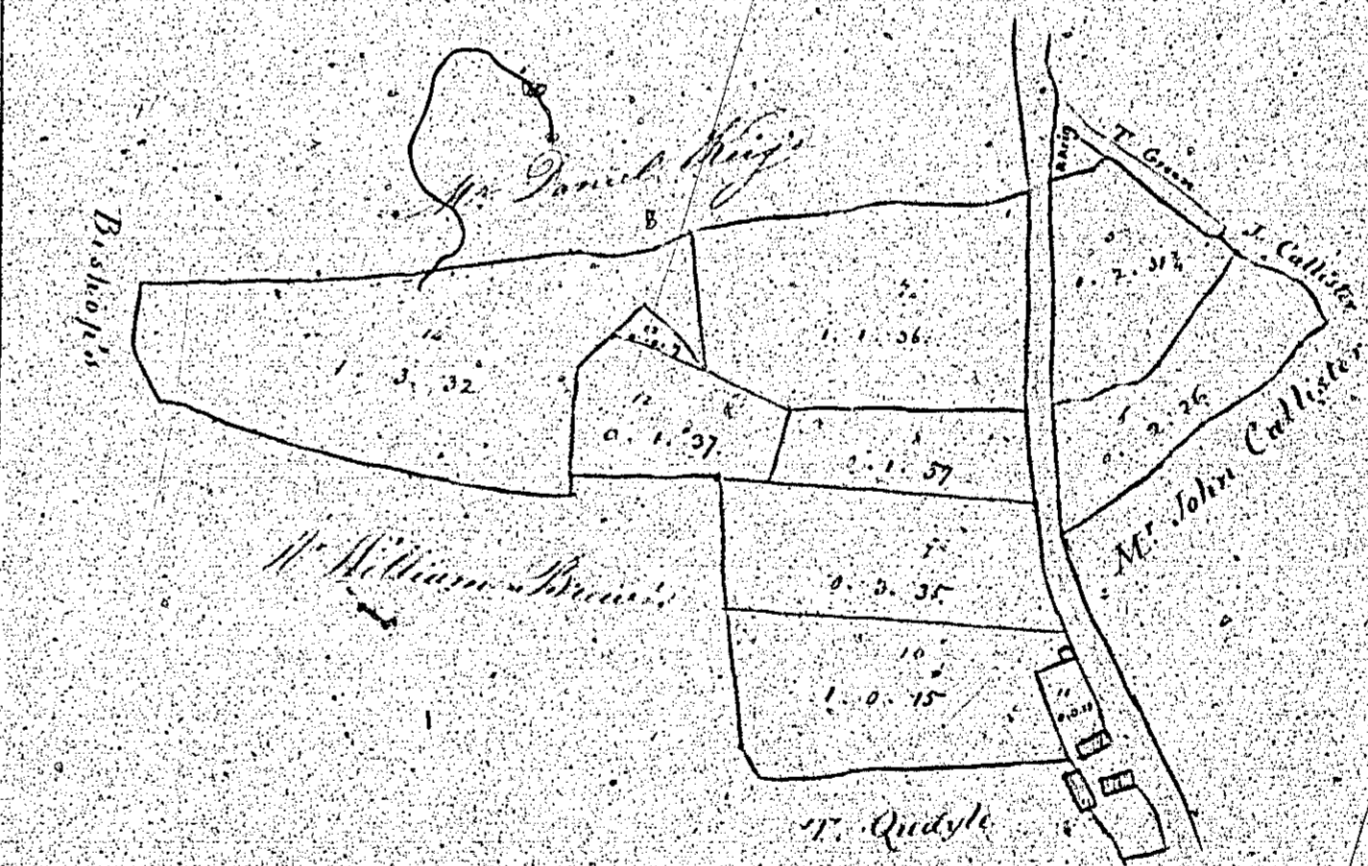

Contents

1	1	0	25
2	1	0	25
3	1	0	25
4	1	0	25
5	1	0	25
6	1	0	25
7	1	0	25
8	1	0	25
9	1	0	25
10	1	0	25
11	1	0	25
12	1	0	25
13	1	0	25
14	1	0	25
15	1	0	25

Scale of 3 chains to an Inch

Not used

185.

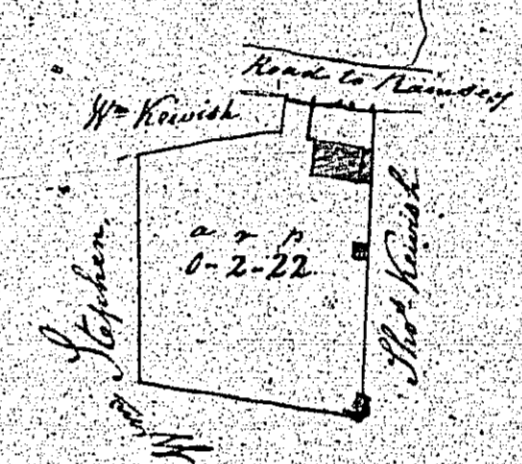

Plan of a Part of
 the Ballamoor
 in the Parish of
 Ballinagh
 belonging to
 Mr. John Stephen
 Scale 2 chains to the Inch
 By John Craine 1850