

Not used

*A Part of Crown
Quarrel and Ballough
The property of
Mr. J. M. Corby
By Des. Co. 1850*

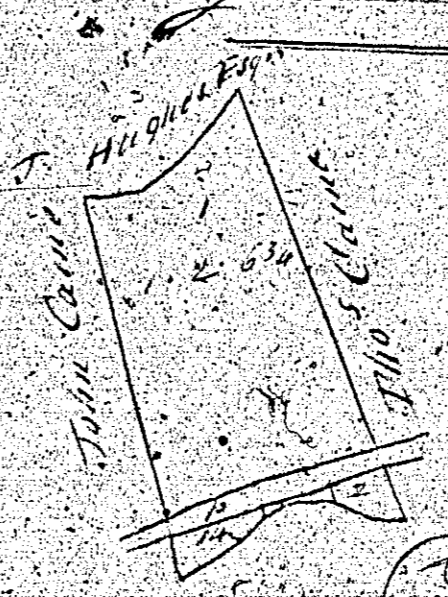

127.

Contents:

1.	1 2 4
2.	1 2 6
3.	1 2 11
4.	1 2 20

Scale 50

1	2	4
2	6	11
3	11	20
4	20	35

A Plan and Survey of
 Part of Ballakenny
 Parish, situated
 in Ballagh The
 Property of
 John Kellip

By Daniel Cresson
 1839
 129

129

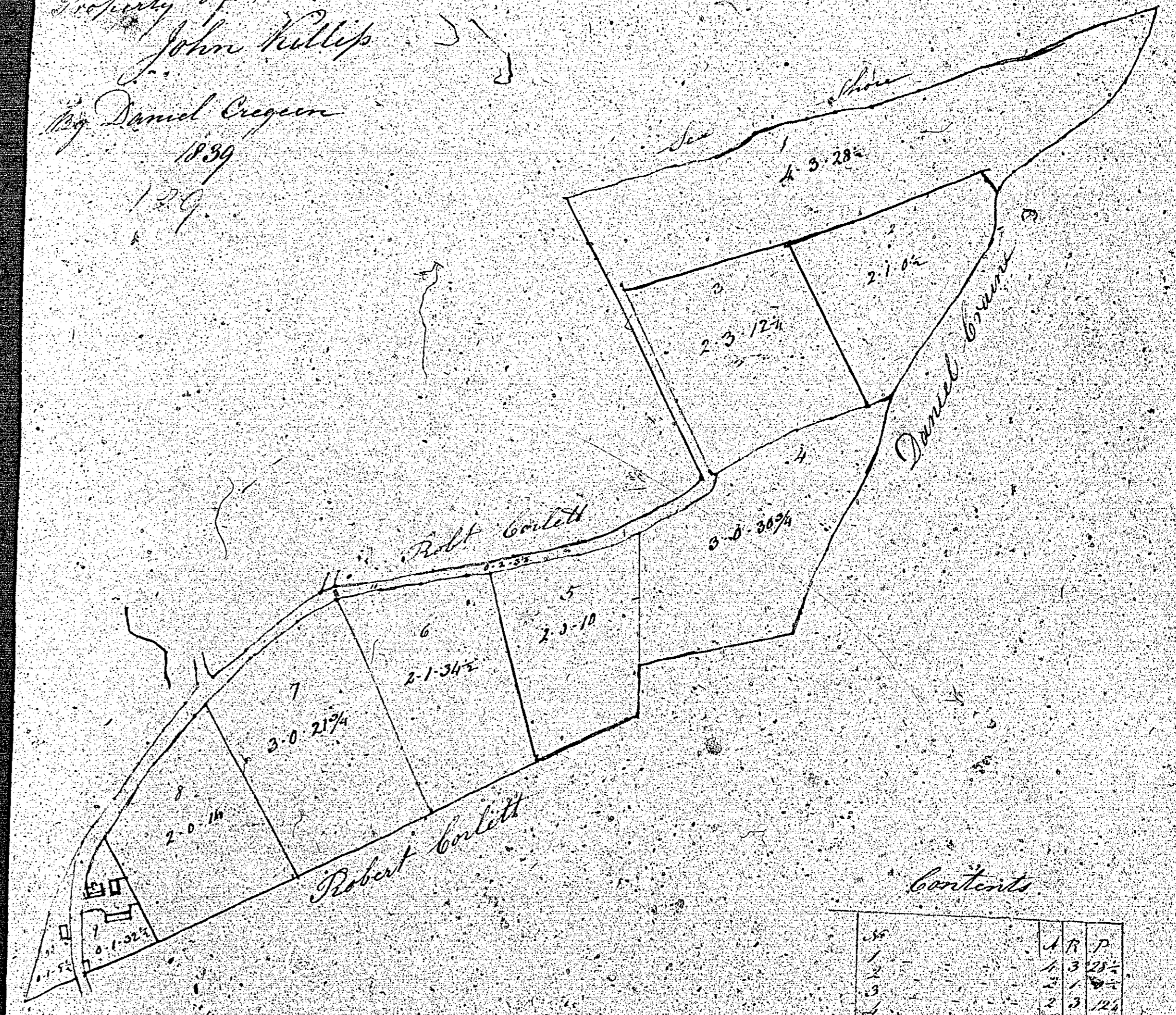

Contents

1	7	7
2	13	20 1/2
3	17	37 1/2
4	20	57 1/2
5	23	80 1/2
6	25	105 1/2
7	28	133 1/2
Total	143	500 1/2

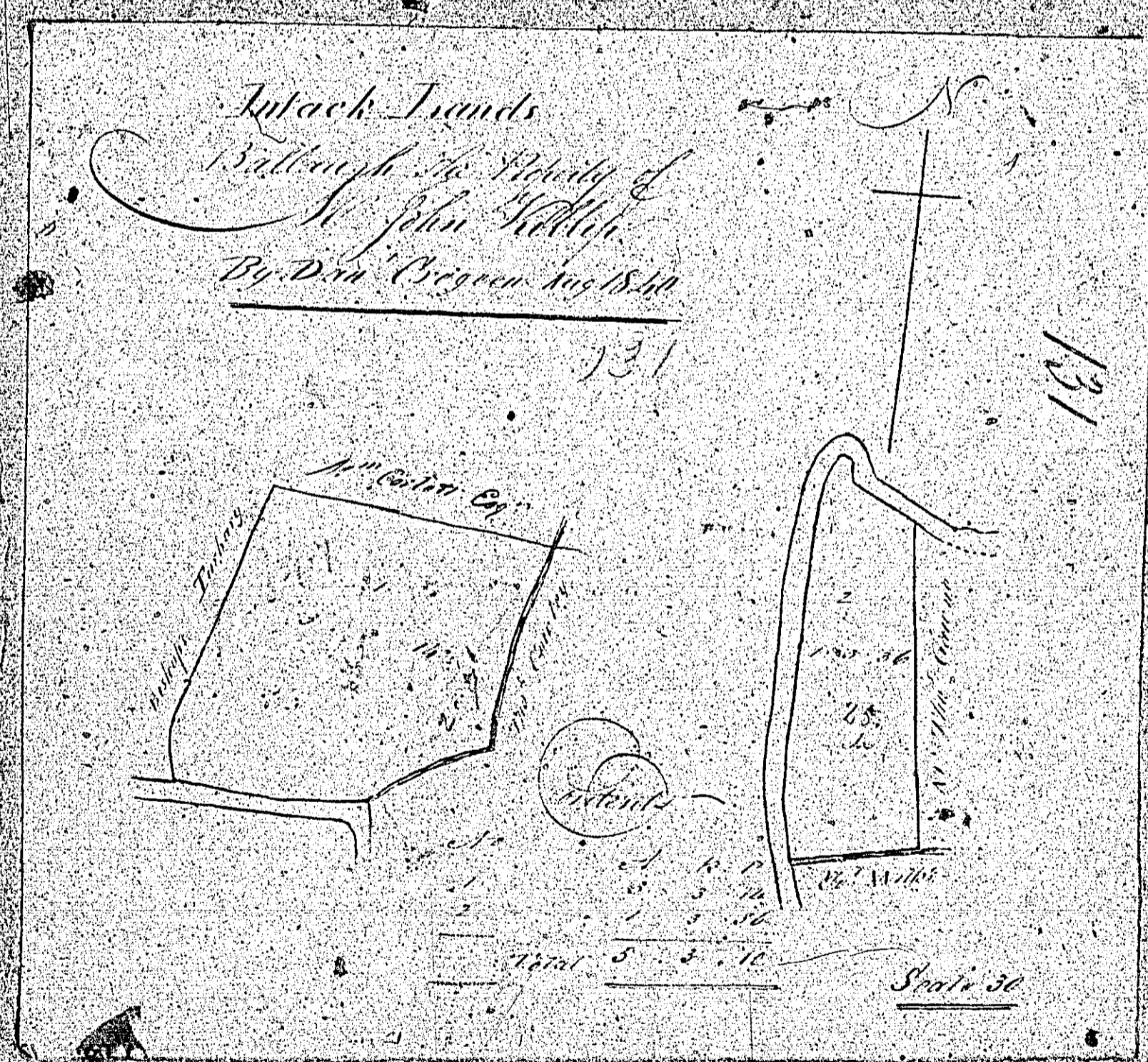
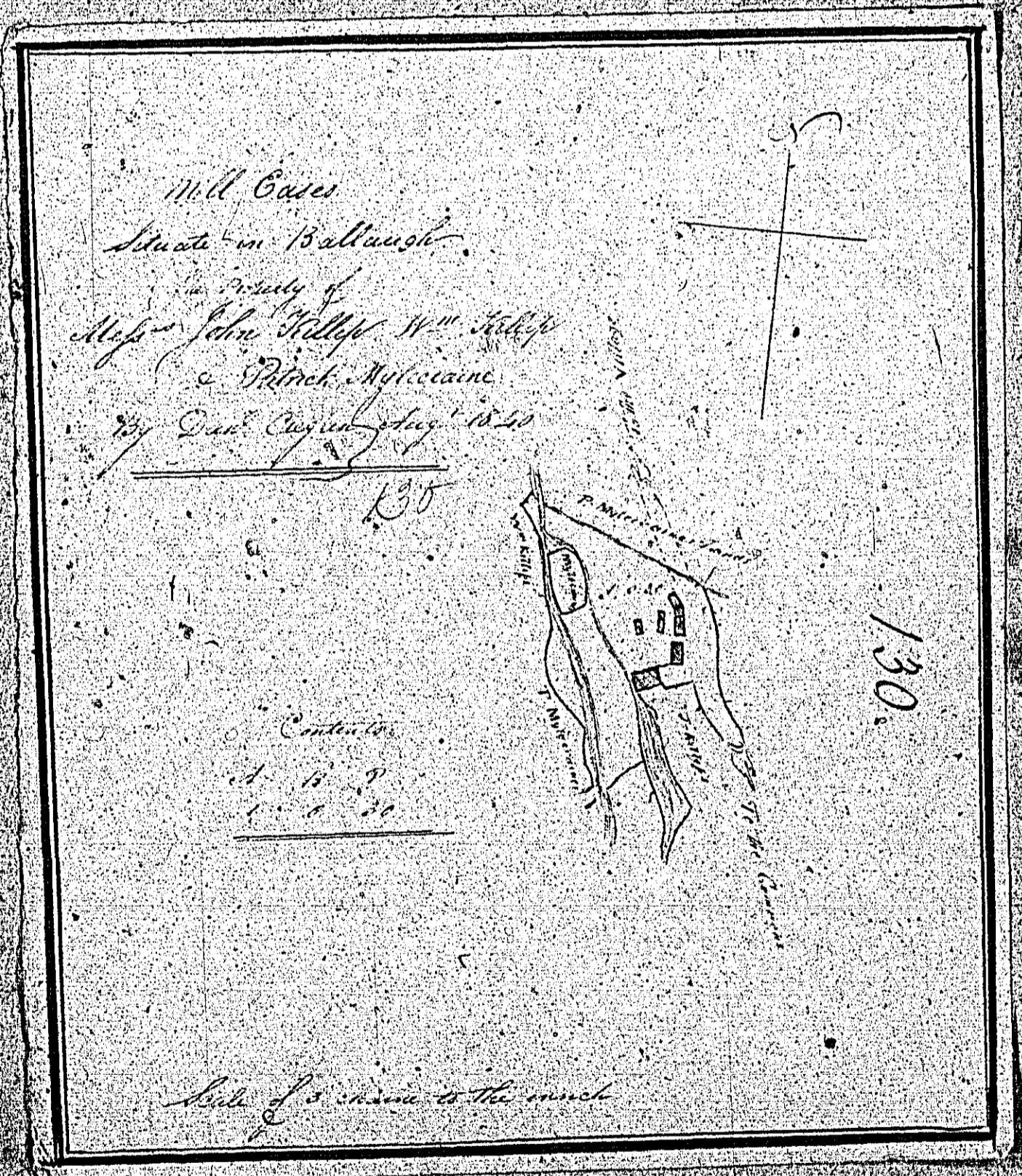

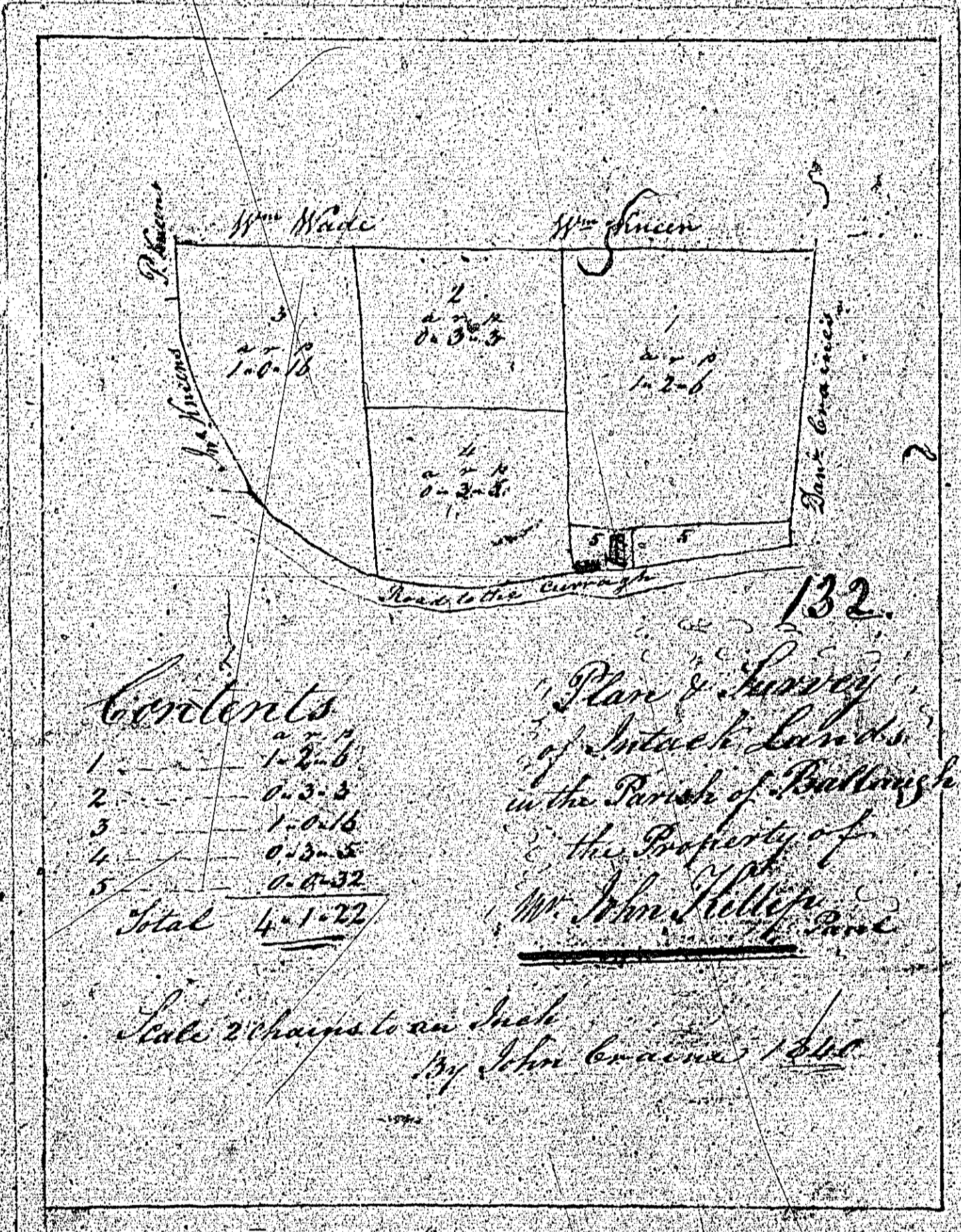

133.

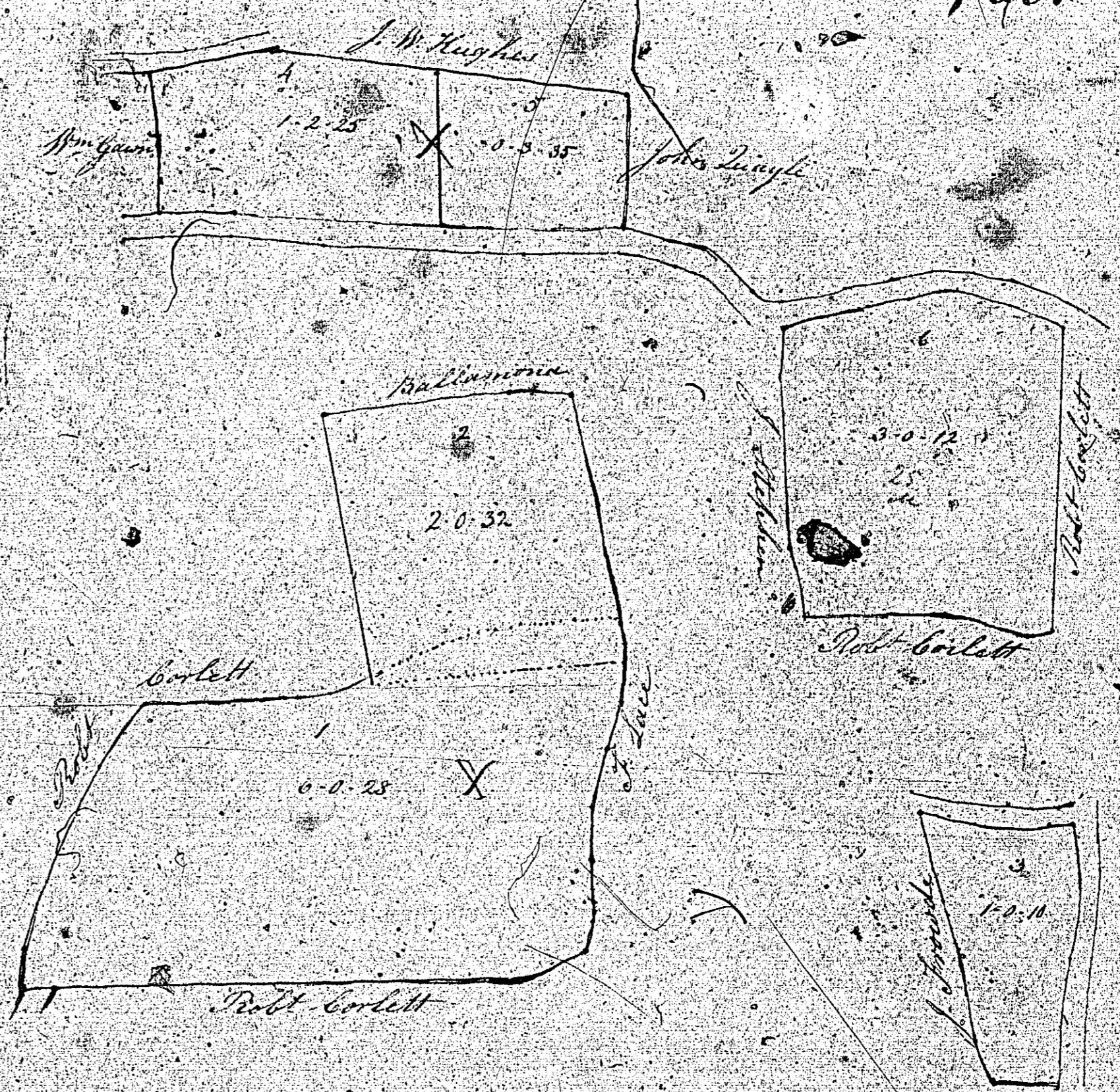

133
 In tack Lands
 Ballinacorney
 The Property of
 John Phillips
 By Thomas Irvine Surveyor
 1834

1	2	25
2	0	32
3	0	10
4	2	25
5	3	35
6	0	12
7	0	22