



MAP AND SURVEY
 OF PART OF *Carmodil Beg* QUARTERLAND AND INTACK

SITUATE IN BALLAUGH BELONGING TO

M^r T. W. CORLETT

By Dant. Croggen July 1856

56

Contents

1	2	3	4	5	6	7	8	9	10
11	12	13	14	15	16	17	18	19	20
21	22	23	24	25	26	27	28	29	30
31	32	33	34	35	36	37	38	39	40
41	42	43	44	45	46	47	48	49	50
51	52	53	54	55	56	57	58	59	60
61	62	63	64	65	66	67	68	69	70
71	72	73	74	75	76	77	78	79	80
81	82	83	84	85	86	87	88	89	90
91	92	93	94	95	96	97	98	99	100

Handwritten signature or note at the bottom of the page.

not used

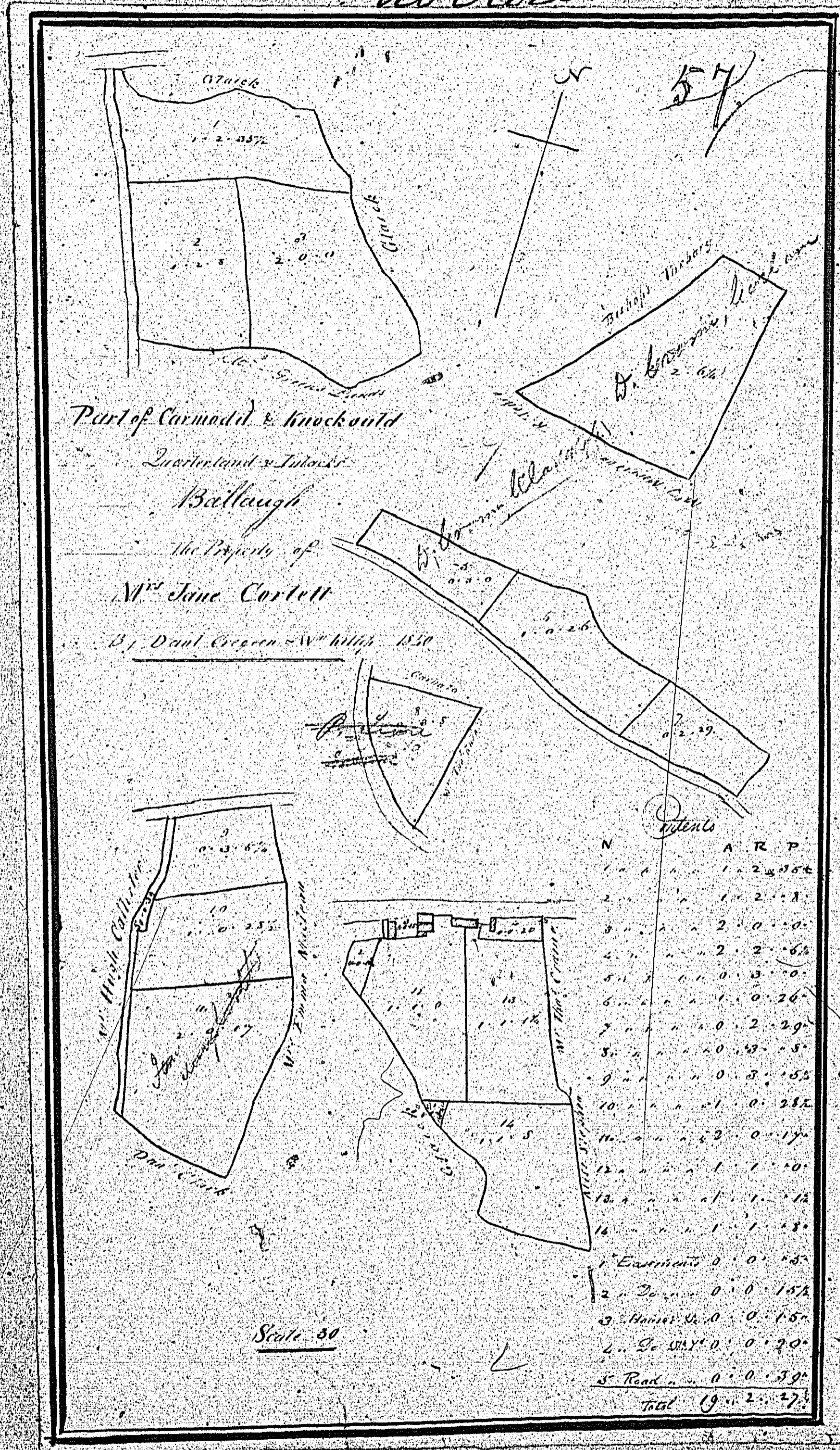

58.

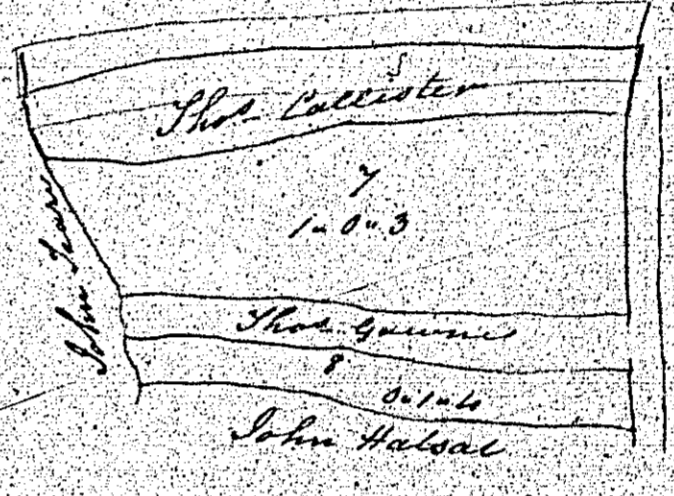
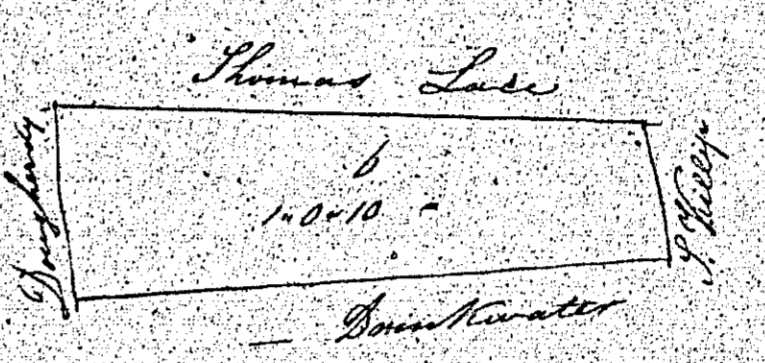

CONTENTS		
1	1	1 37
2	1	1 5
3	2	0 36
4	1	2 0
5	1	0 25
6	1	0 10
7	1	0 3
8	0	1 4
Total	9	0 0

Plan & Survey
of Intack Lands
in the Parish of Ballaugh
belonging to
Mr. Wm. Corlett

Scale 2 chains to an inch
By John Graine 1846

ISLE OF MAN GOVERNMENT: GENERAL REGISTRY

TITHE PLANS: PARISH OF BALLAUGH

Original monotone

1:30

No. 100

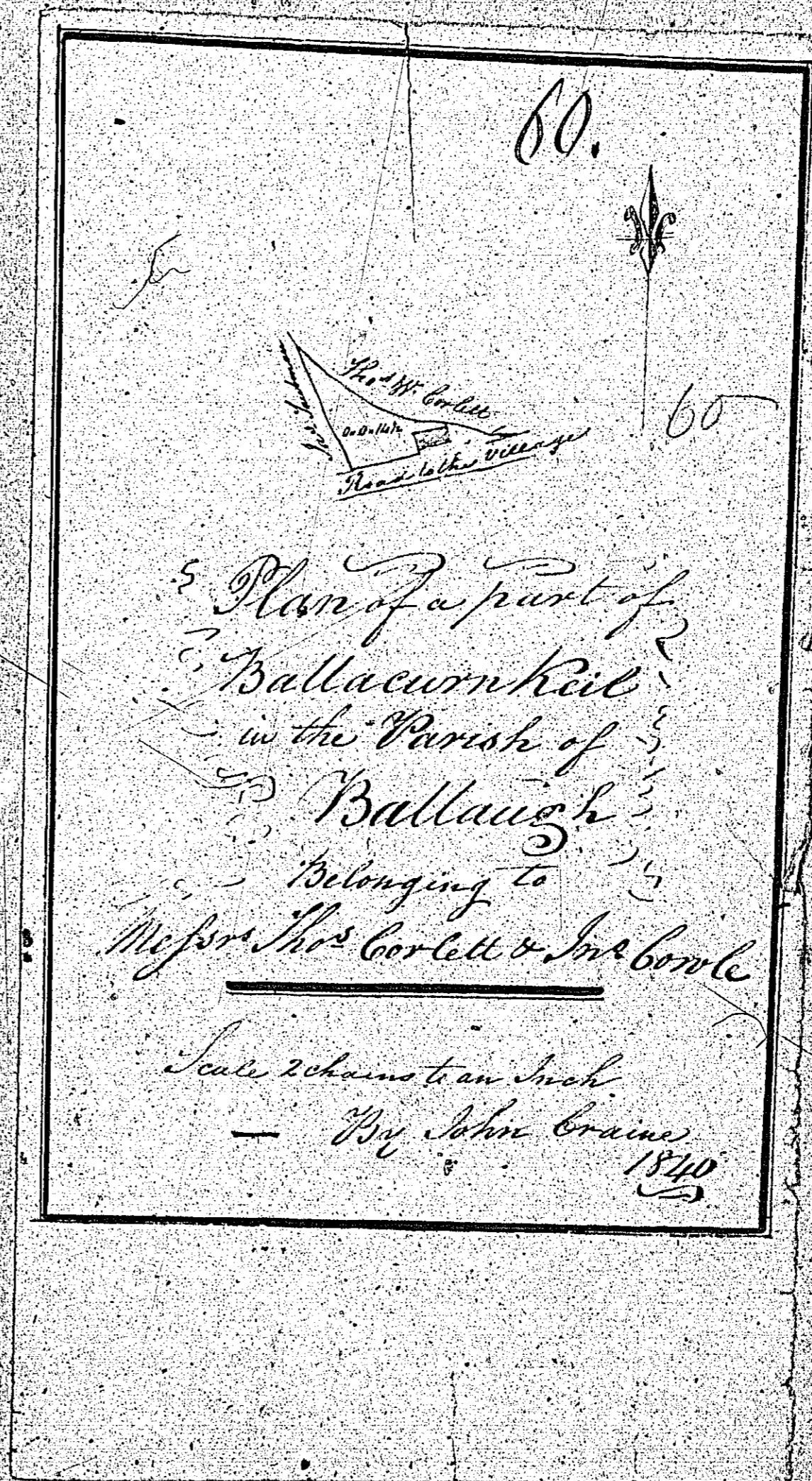

Mr. John Corlett & Sons

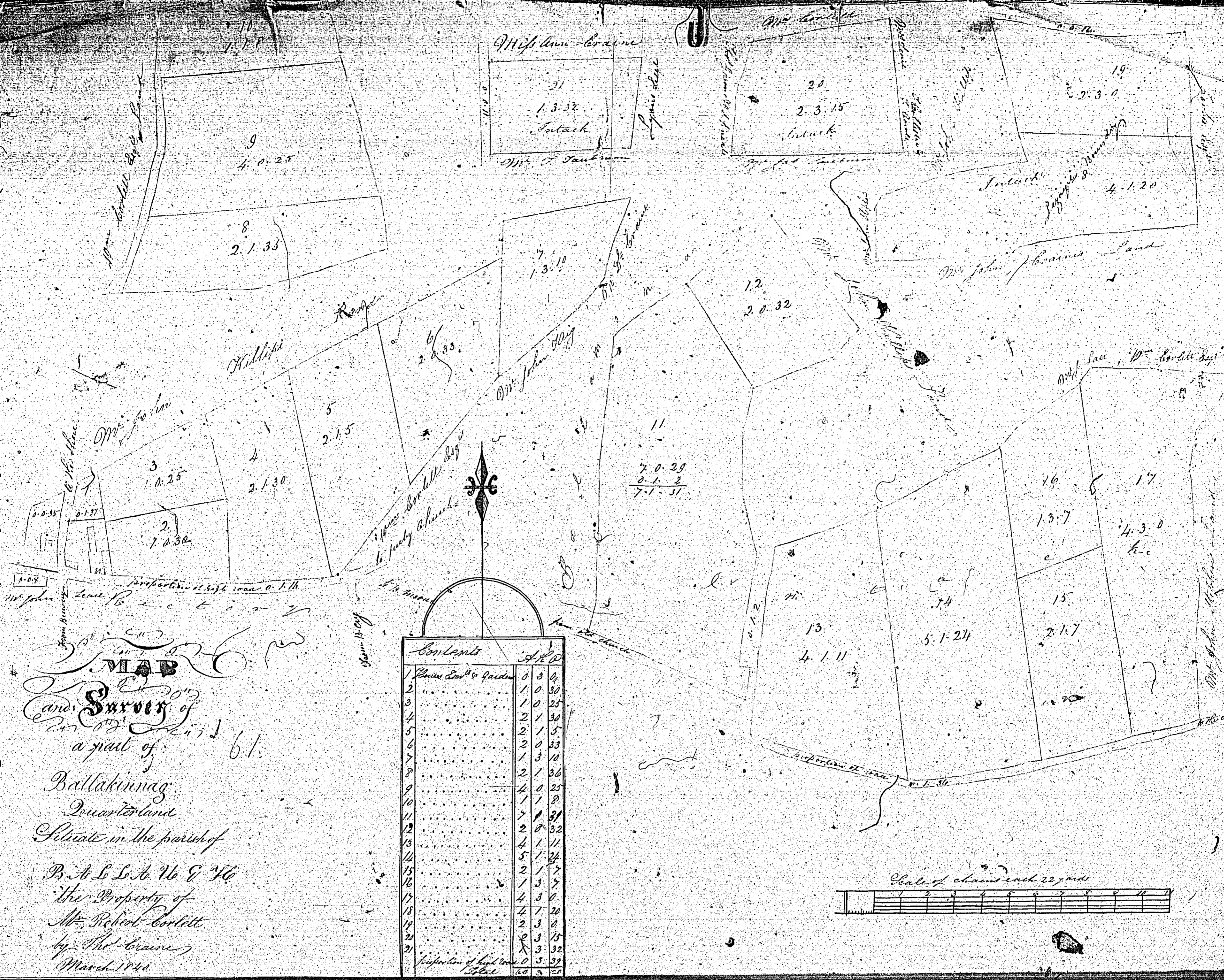

MAP
 and **Survey** of
 a part of
 Ballakinnag
 Quarterland
 Situate in the parish of
 B. A. L. S. N. E. & V. G.
 the Property of
 Mr. Robert Corlett
 by Thos. Craane
 March 1844

Contents	Area
1. House Land & Garden	0 3 0
2	1 0 30
3	1 0 25
4	2 1 30
5	2 1 5
6	2 0 33
7	1 3 10
8	2 1 30
9	4 0 25
10	1 1 0
11	7 1 31
12	2 0 32
13	4 1 11
14	5 1 24
15	2 1 7
16	1 3 7
17	4 3 0
18	1 3 0
19	4 7 20
20	2 3 0
21	2 3 15
22	3 3 32
23	3 3 32
24	6 0 3
25	3 3 32

ISLE OF MAN GOVERNMENT: GENERAL REGISTRY
 TITHE PLANS: PARISH OF BALLAUGH
 Original coloured (decorative) 1:30