

Plan  
 of part of the  
 Estate of Ballalanna  
 called  
 Close Moor  
 in the  
 Parish of Abury  
 the property of  
 Mr. R. H. Fagant  
 May 16<sup>th</sup> 1830

Acres

|                        |        |
|------------------------|--------|
| 1                      | 2-3-18 |
| 2                      | 1-0-25 |
| 3                      | 1-3-33 |
| 4                      | 1-1-27 |
| 5                      | 1-0-24 |
| 6                      | 1-5-22 |
| 7                      | 1-0-22 |
| 8                      | 2-0-16 |
| Total 15 Acres 12-2-14 |        |

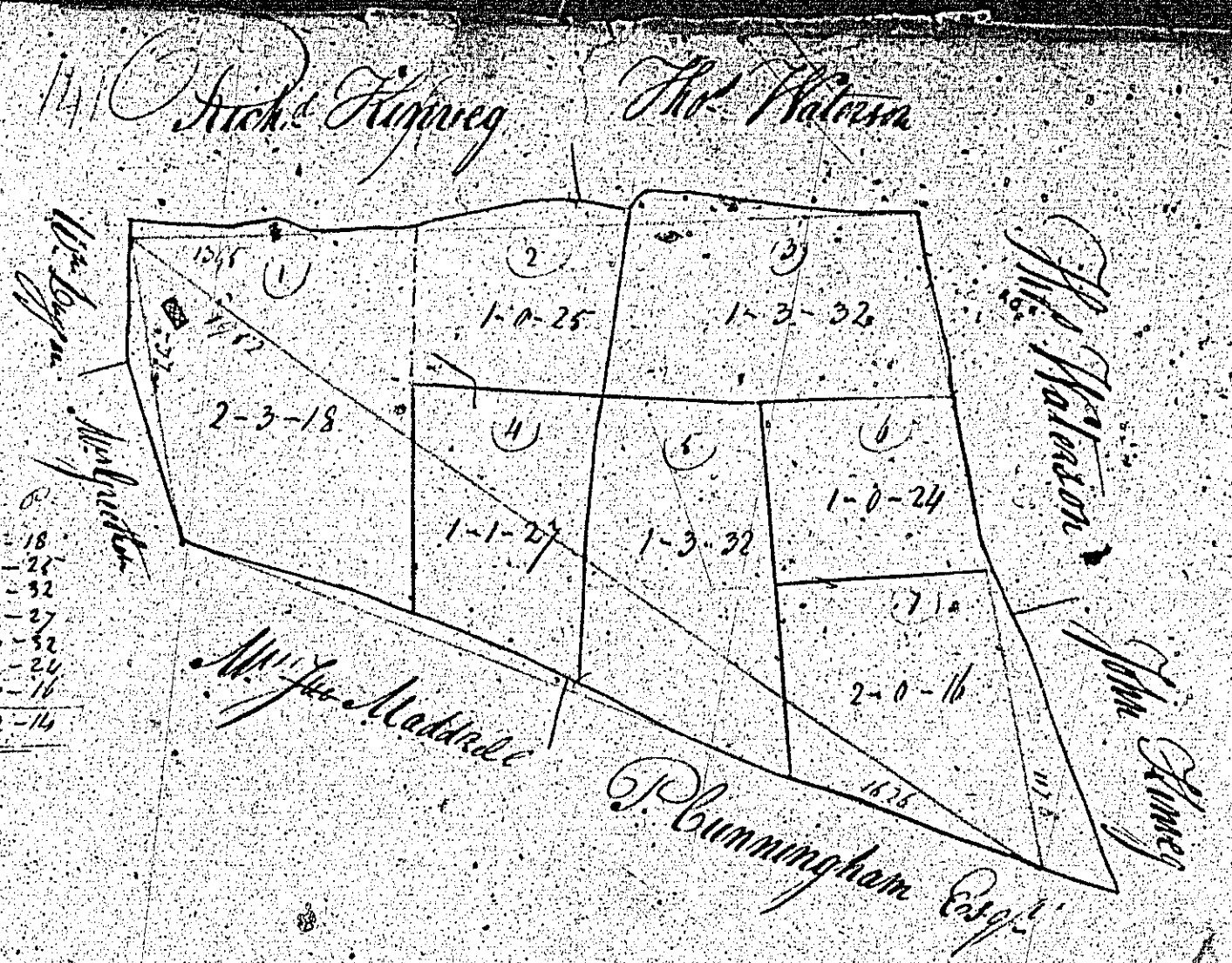

Plan  
 of part of the  
 Estate of Ballacubbin  
 in the  
 Parish of Abury  
 the property of  
 Mr. R. H. Fagant  
 May 16<sup>th</sup> 1830

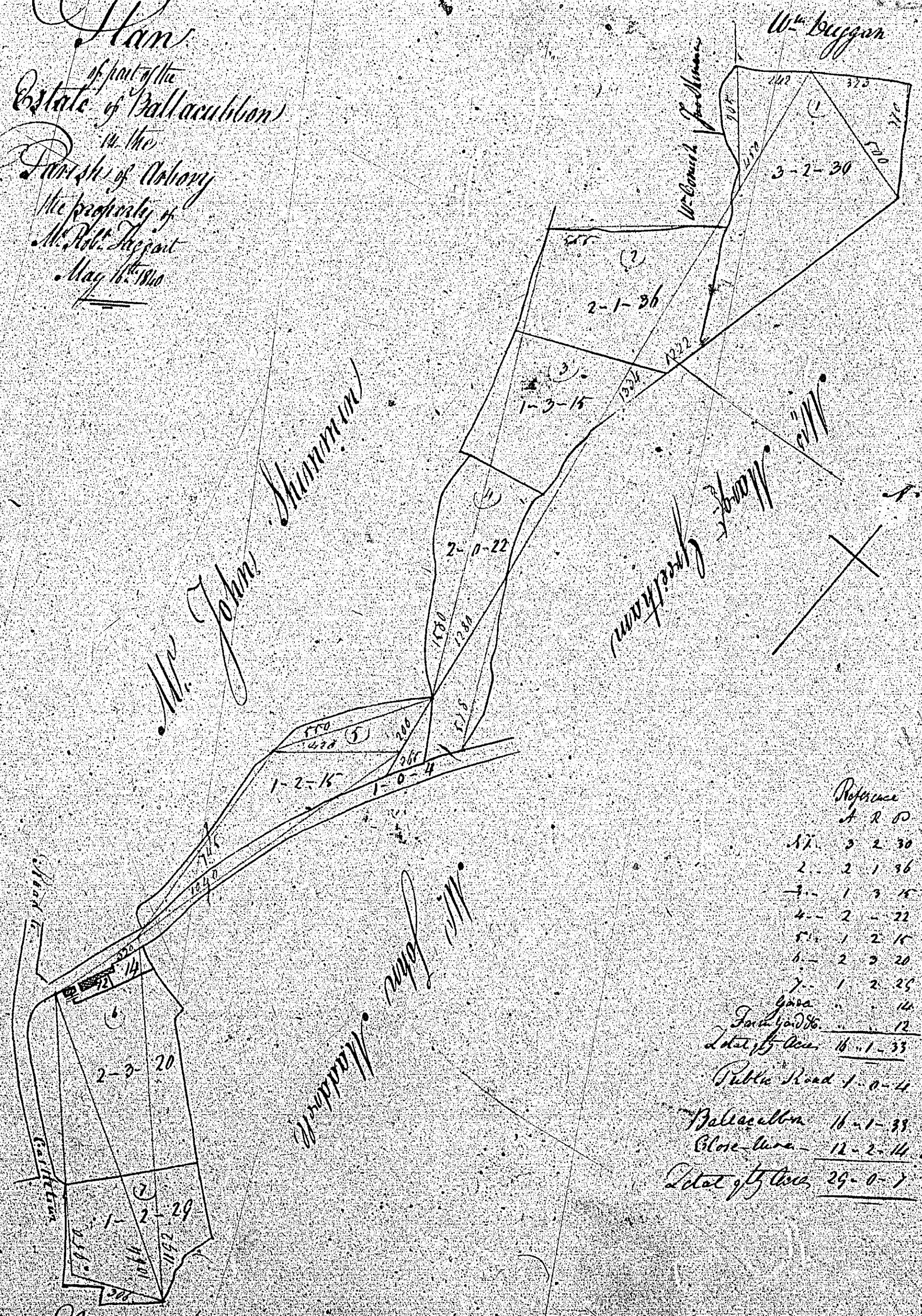

References

|                        |        |
|------------------------|--------|
| 1                      | 2-3-18 |
| 2                      | 1-0-25 |
| 3                      | 1-3-33 |
| 4                      | 1-1-27 |
| 5                      | 1-0-24 |
| 6                      | 1-5-22 |
| 7                      | 1-0-22 |
| 8                      | 2-0-16 |
| Total 15 Acres 12-2-14 |        |

Scale of Chains



Joseph Wake Surveyor

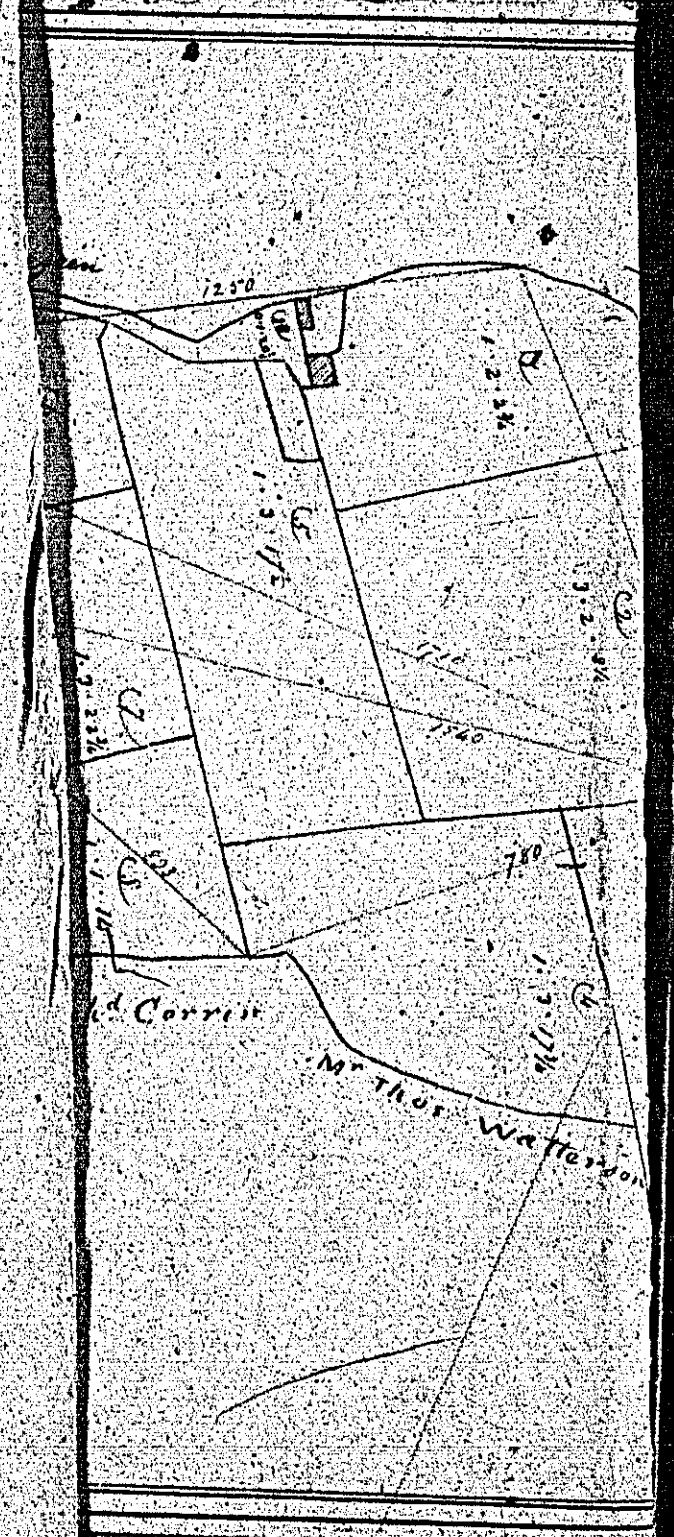
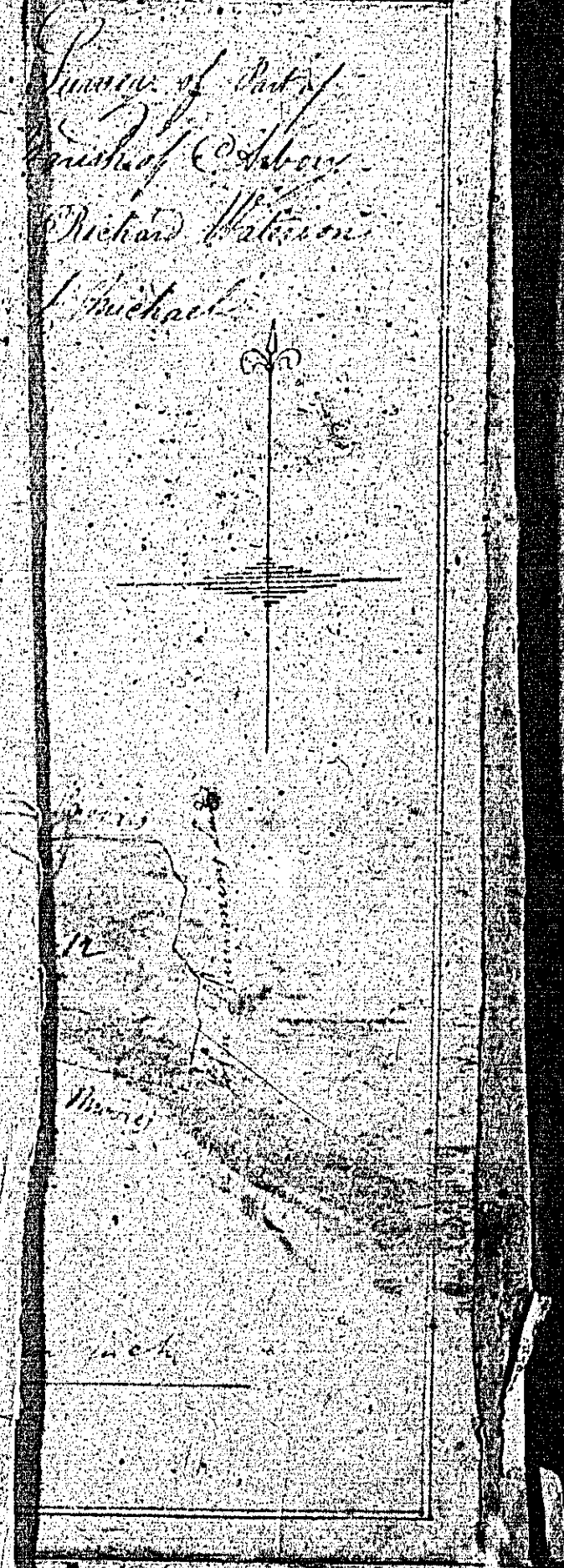

ISLE OF MAN GOVERNMENT: GENERAL REGISTRY

TITHE PLANS: PARISH OF ARBORY

- 143 Original coloured (decorative), marked, faint 1.30
- 144 Original coloured (decorative), marked, faint
- 145 Original monotone
- 146 Original coloured (decorative)
- 147 Original coloured (decorative), faint

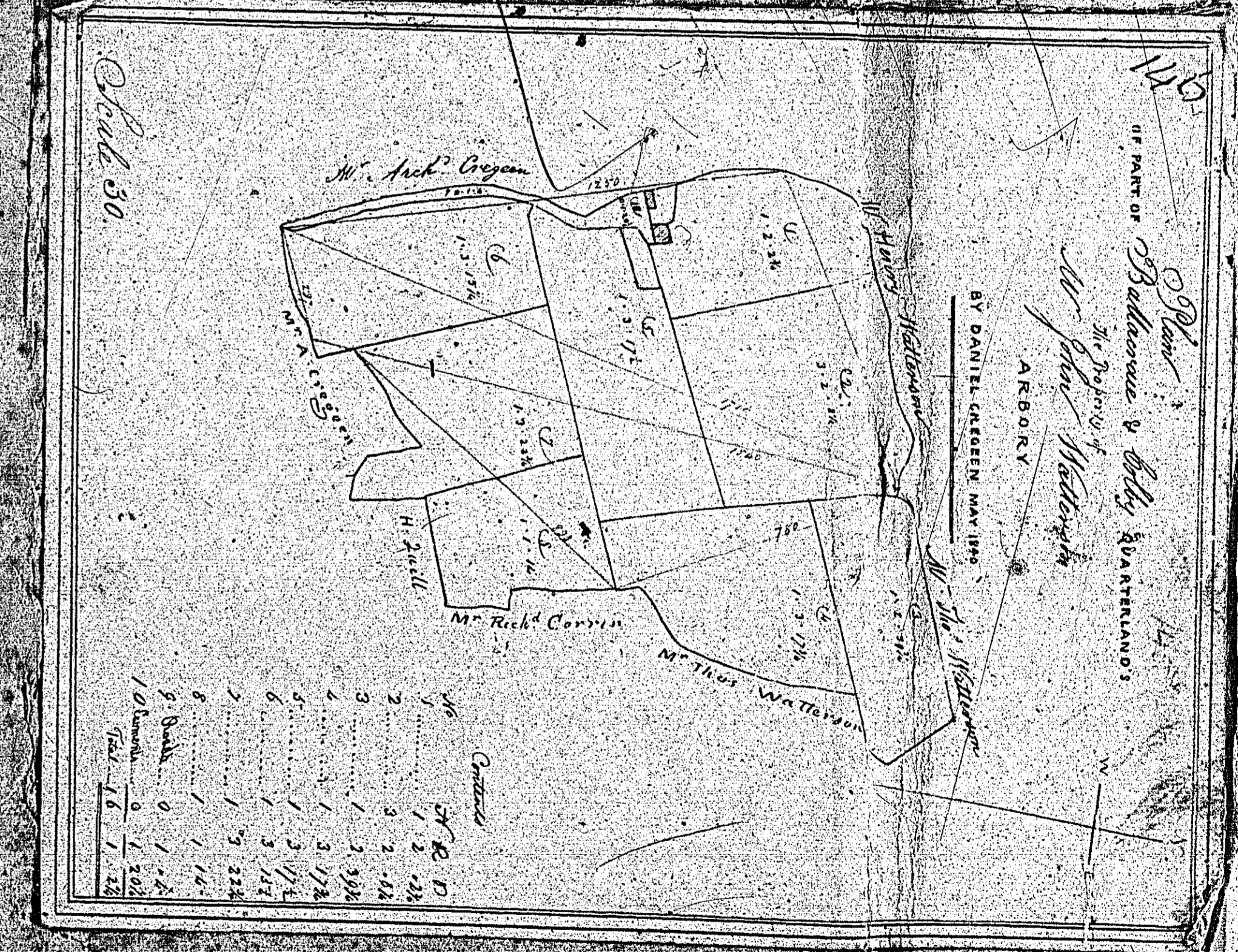
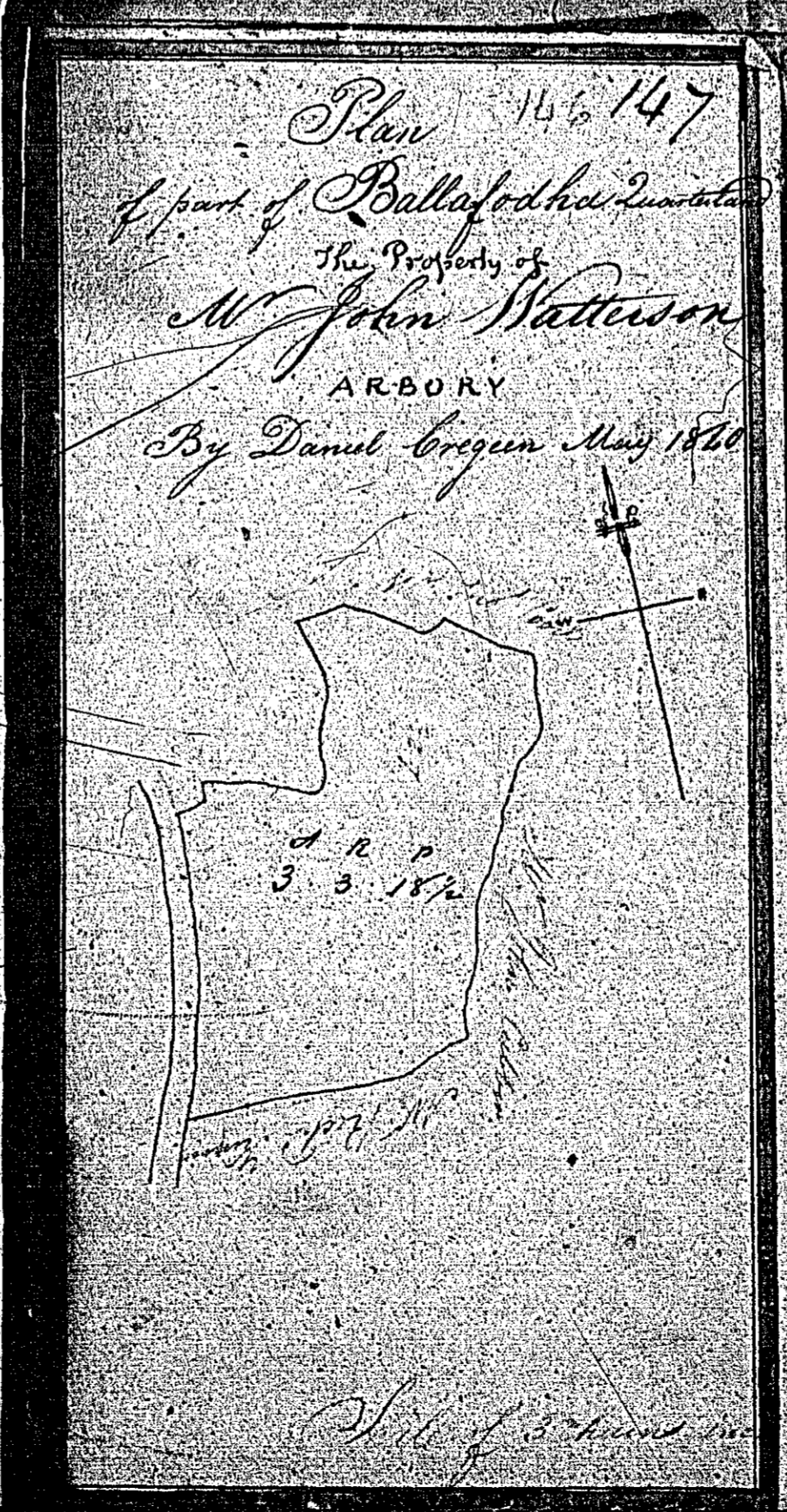
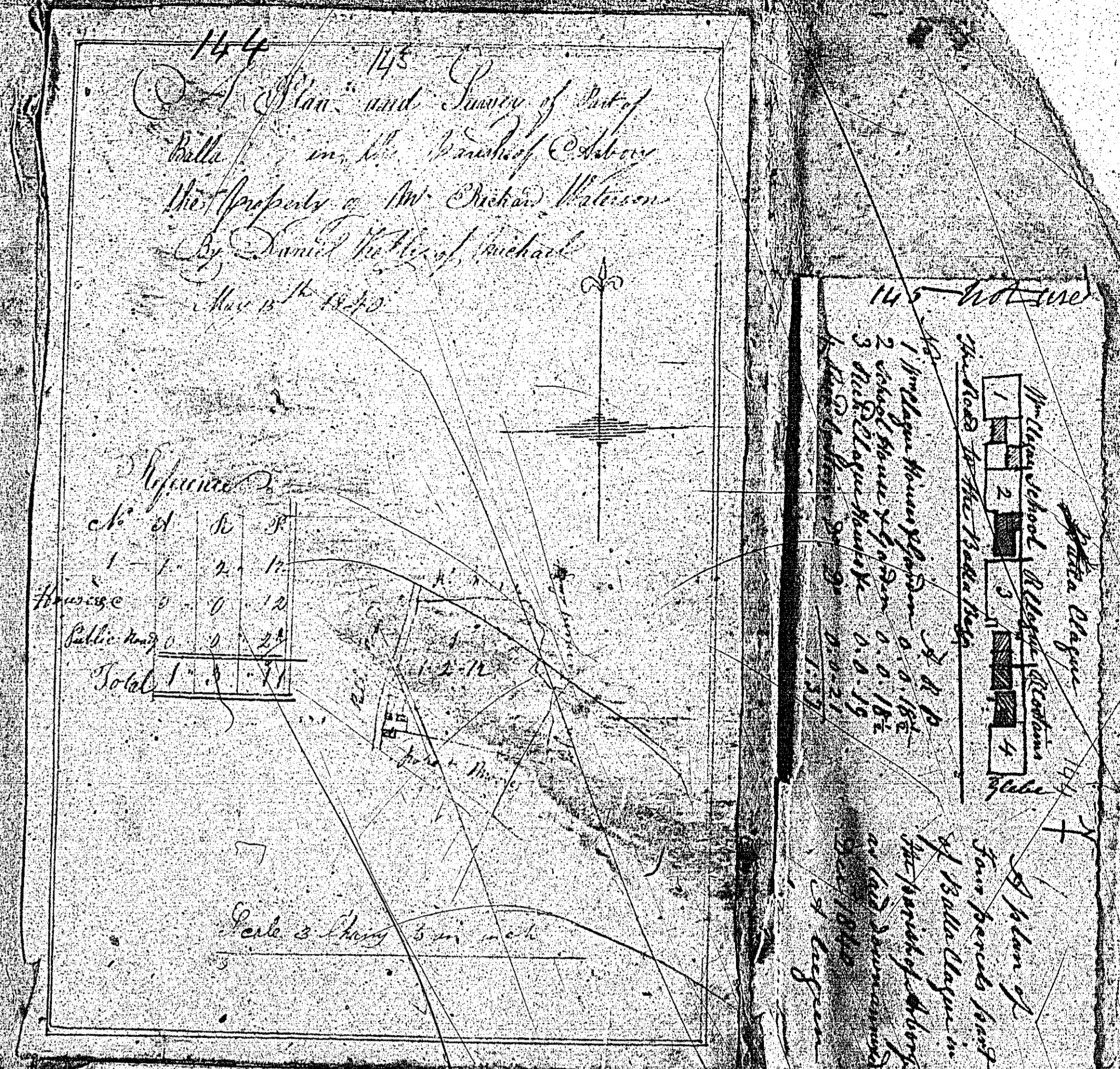

ISLE OF MAN GOVERNMENT: GENERAL REGISTRY

TITHE PLANS: PARISH OF ARBORY

- 148 Original coloured (decorative), marked, faint 1.30  
 149 Original monotone, marked

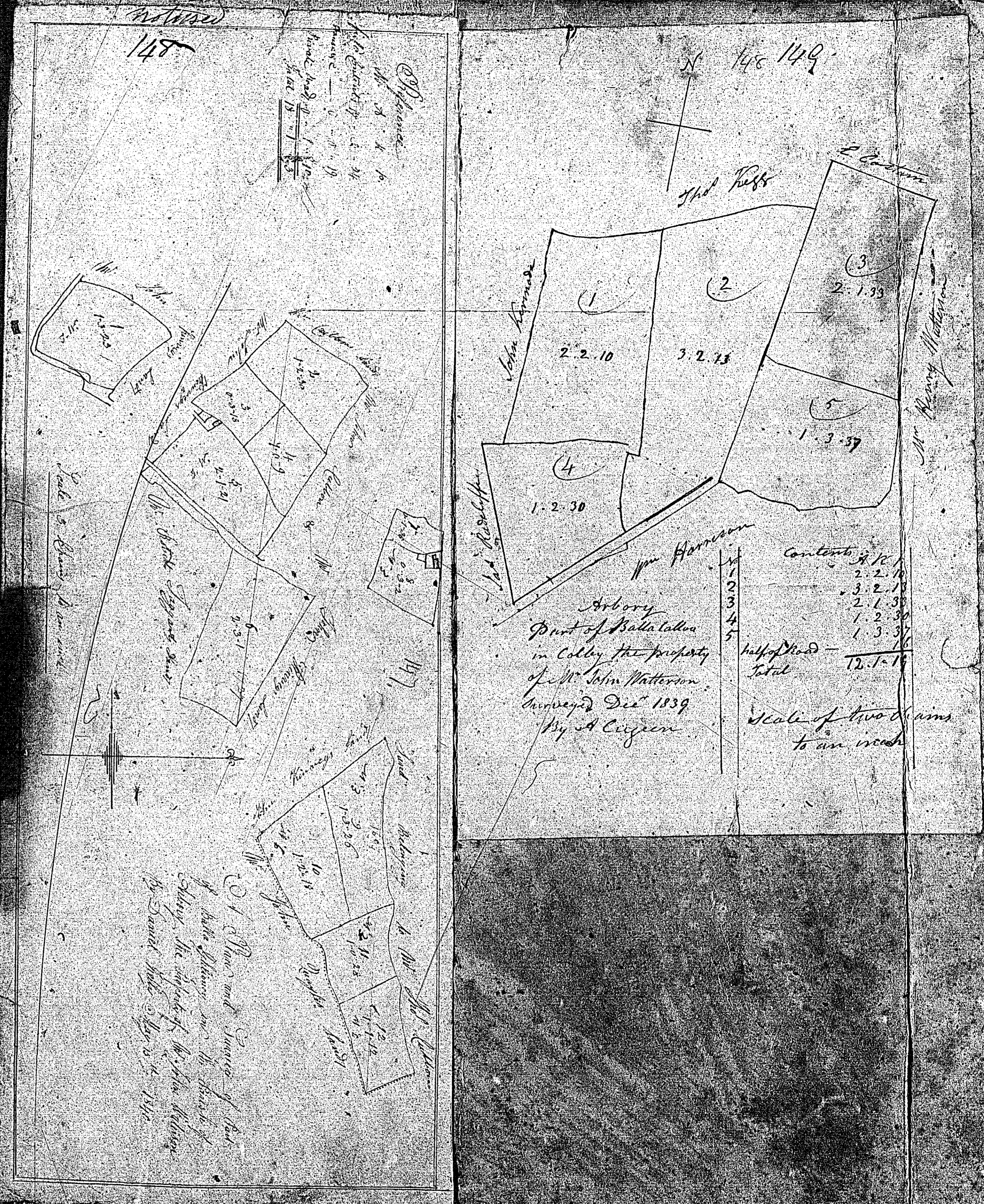

ISLE OF MAN GOVERNMENT: GENERAL REGISTRY

TITHE PLANS: PARISH OF ARBORY

- 150 Original monotone, marked, faint 1.30
- 151 Original monotone

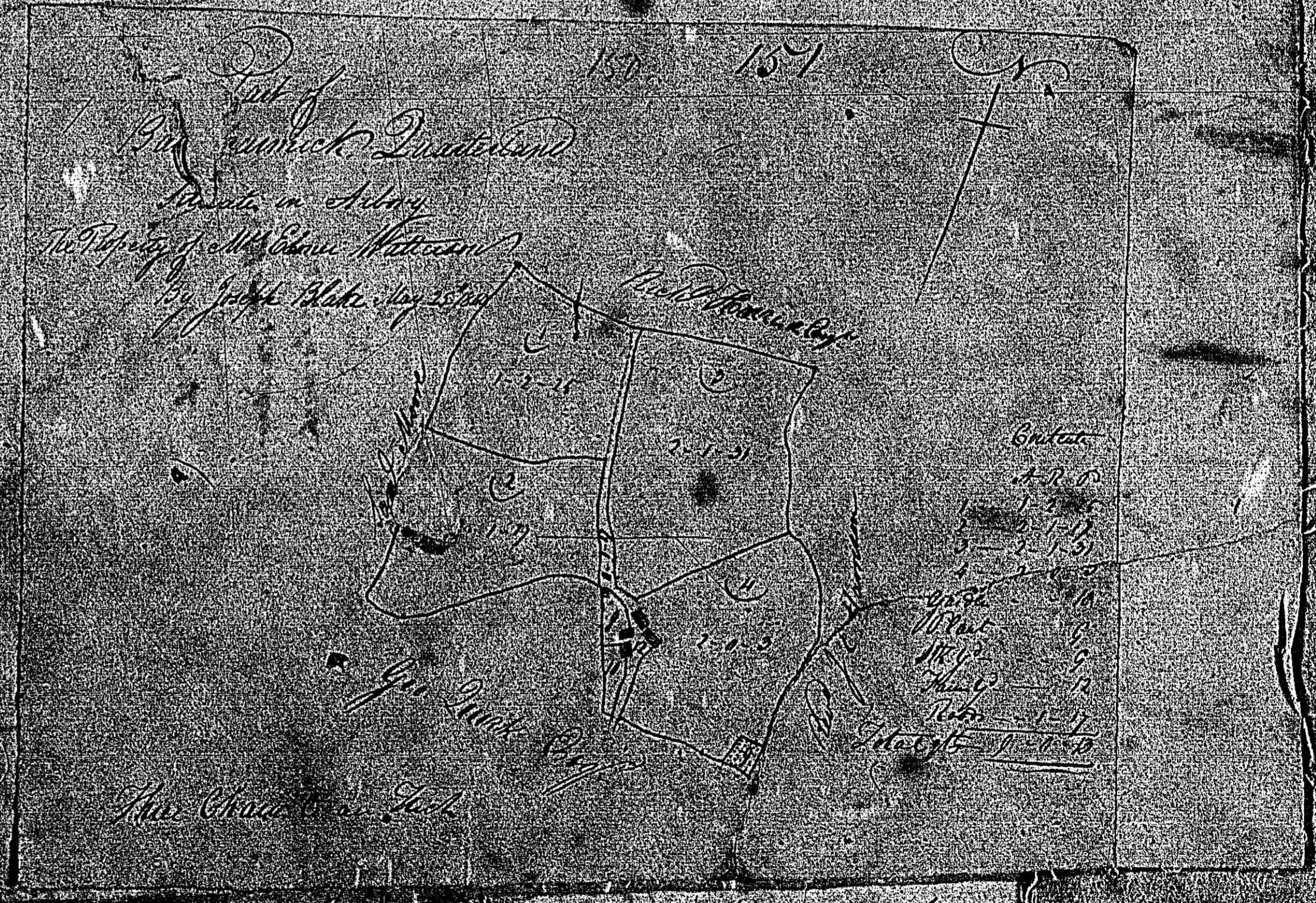
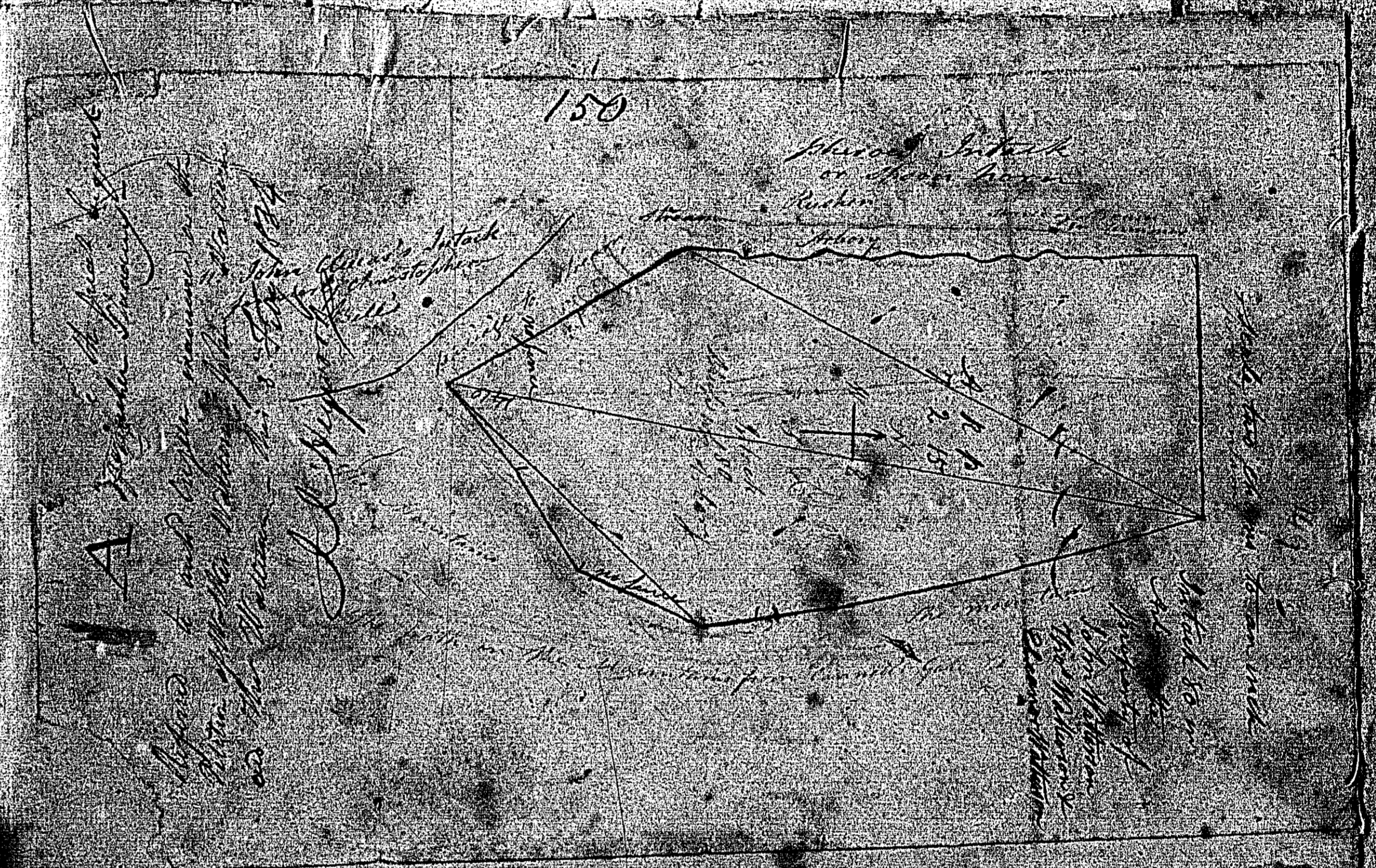

Property of Mr  
situate in Arbory

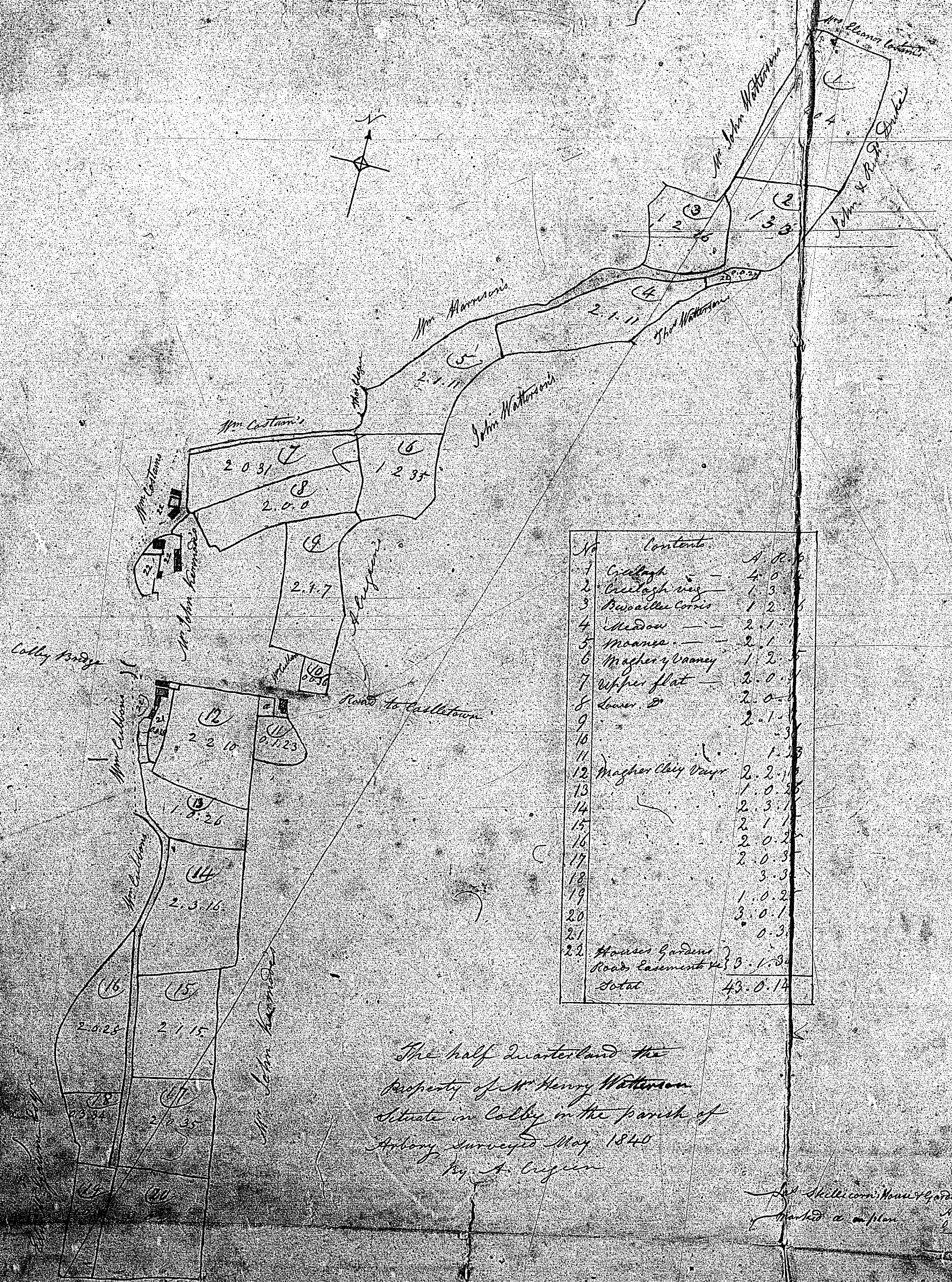

| No | Content              | A. R. P.       |
|----|----------------------|----------------|
| 1  | Grass                | 4.0.0          |
| 2  | Grass                | 1.3.0          |
| 3  | Grass                | 1.2.0          |
| 4  | Meadow               | 2.1.1          |
| 5  | Moore                | 2.1.1          |
| 6  | Moore & Vane         | 1.2.5          |
| 7  | Upper flat           | 2.0.0          |
| 8  | Lower flat           | 2.0.0          |
| 9  |                      | 2.1.1          |
| 10 |                      | 1.3.0          |
| 11 |                      | 1.2.3          |
| 12 | Magher clay Vane     | 2.2.1          |
| 13 |                      | 1.0.2          |
| 14 |                      | 2.3.1          |
| 15 |                      | 2.1.1          |
| 16 |                      | 2.0.2          |
| 17 |                      | 2.0.3          |
| 18 |                      | 3.3.0          |
| 19 |                      | 1.0.2          |
| 20 |                      | 3.0.1          |
| 21 |                      | 0.3.0          |
| 22 | Houses & Gardens     | 1.1.2          |
|    | Roads, Easements &c. | 1.1.2          |
|    | <b>Total</b>         | <b>43.0.14</b> |

The half quarter land the  
 Property of Mr. Henry Watson  
 Situate in Cully in the parish of  
 Ardara surveyed May 1840  
 by A. Green

Mr. William Watson's  
 half a plot  
 4.0.0

ISLE OF MAN GOVERNMENT: GENERAL REGISTRY

TITHE PLANS: PARISH OF ARBORY

1.30

153 Original monotone, marked

154 Original monotone, marked



**END OF VOLUME**