

Andreas the first

225. *Robt Hillip* *Mr. Corbett*

Robert Christian

225

Plan (and Survey
of an Inlatch and part
of the Quarterland of
Ballaogh in the Pa-
rish of Andreas the
Property of
Mr. Rich. Radcliffe

Contents.	
1.	1. 0. 34
2.	1. 0. 35
3. <i>Area garden</i>	0. 1. 2
4.	0. 2. 11
5.	0. 2. 35
	<u>4. 1. 8 1/2</u>
6 <i>Water place</i>	0. 0. 3
7 <i>High road</i>	0. 1. 10 1/2
Total	4. 3. 23

Scale of 5 chains to an Inch
Surveyed by
John Jones
1748

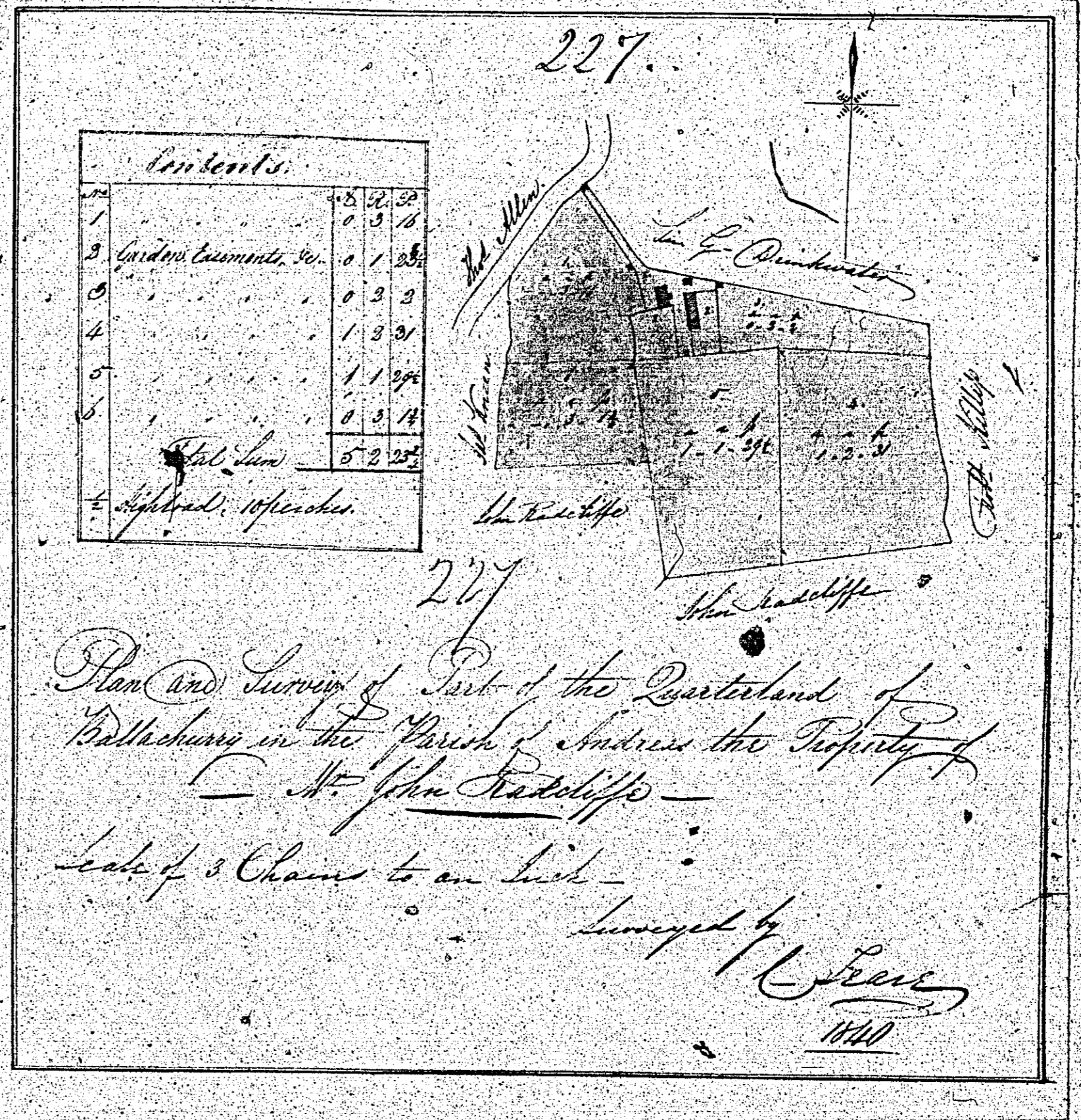

Indice B. 17

Charles Radcliffe
B. Survey

228.

Map and Survey
of part of the Quarterland of
Balla-Cherry
in the Parish of Andreas
the property of Mr. John Radcliffe

228

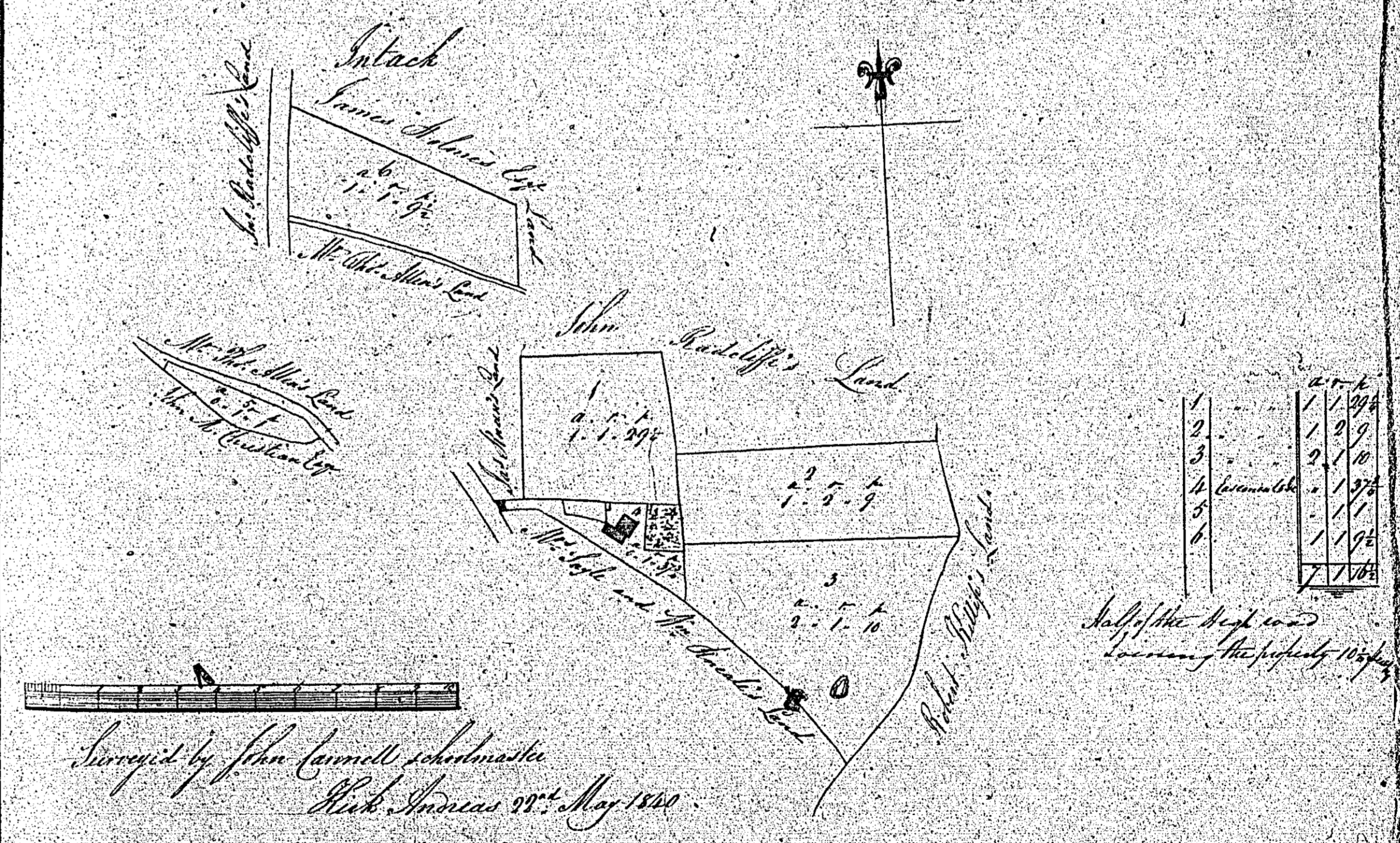

Andrews & ...

*Charles Radcliffe
B. Survey*

*Plan of a part of the Quarter lands
of
in the Parish of Andrews
the property
of Mr Tho^o Radcliffe*

229

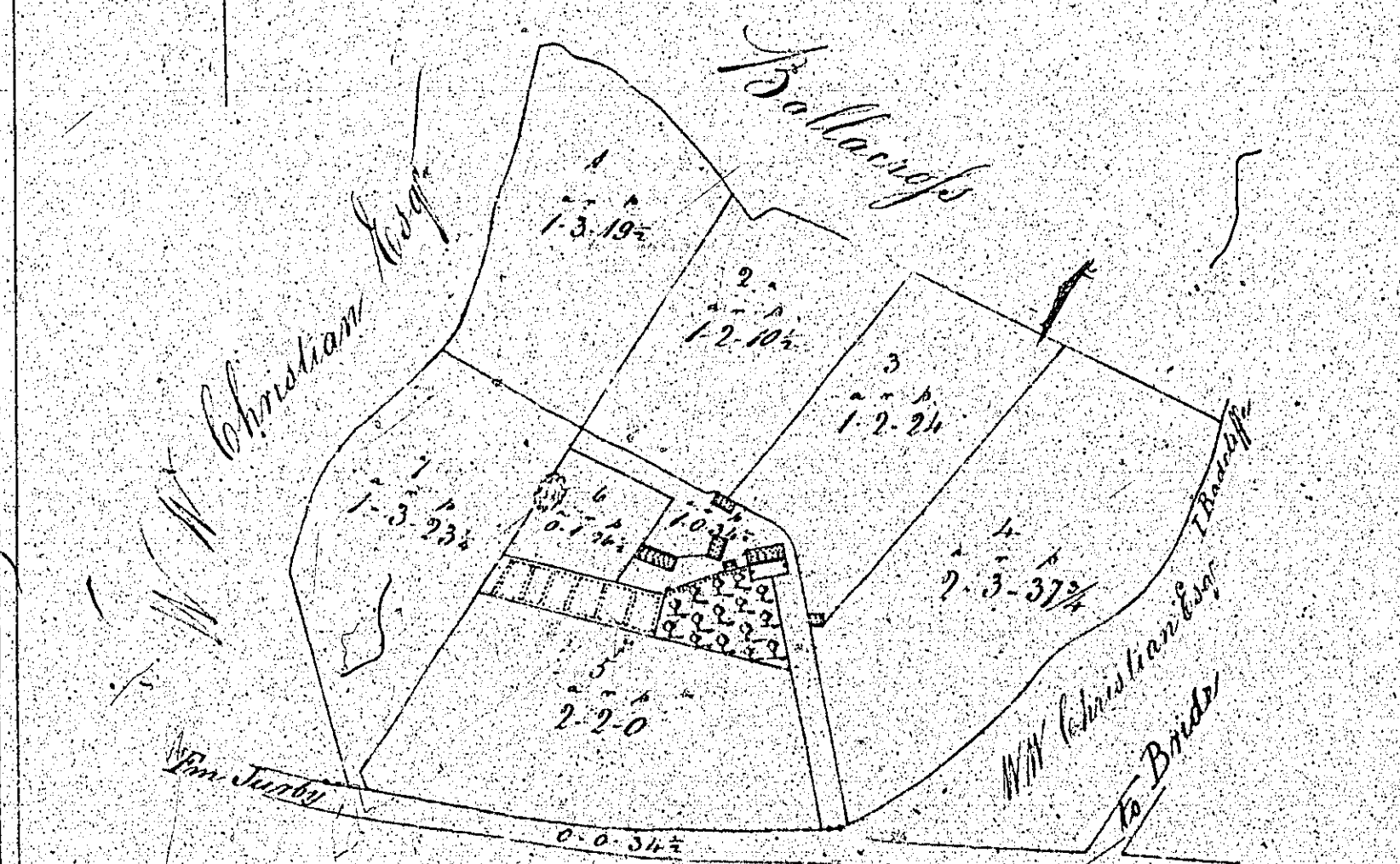
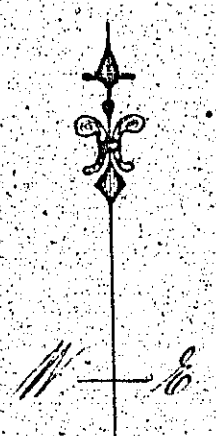

References

	Chains	Links	Perches
1	5	10	10
2	1	2	2
3	1	2	2
4	2	3	3
5	2	2	2
6	1	3	3
7	1	3	3
8	12	3	24
9	1	0	2
10	0	0	0
11	11	1	22
12	0	1	2
Total	36	2	72

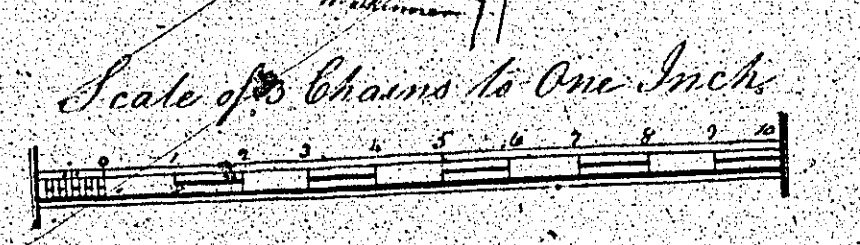

Total Chain 36 2 72

There is no plan 230

in this volume