

Not used

Not used

196.4.197

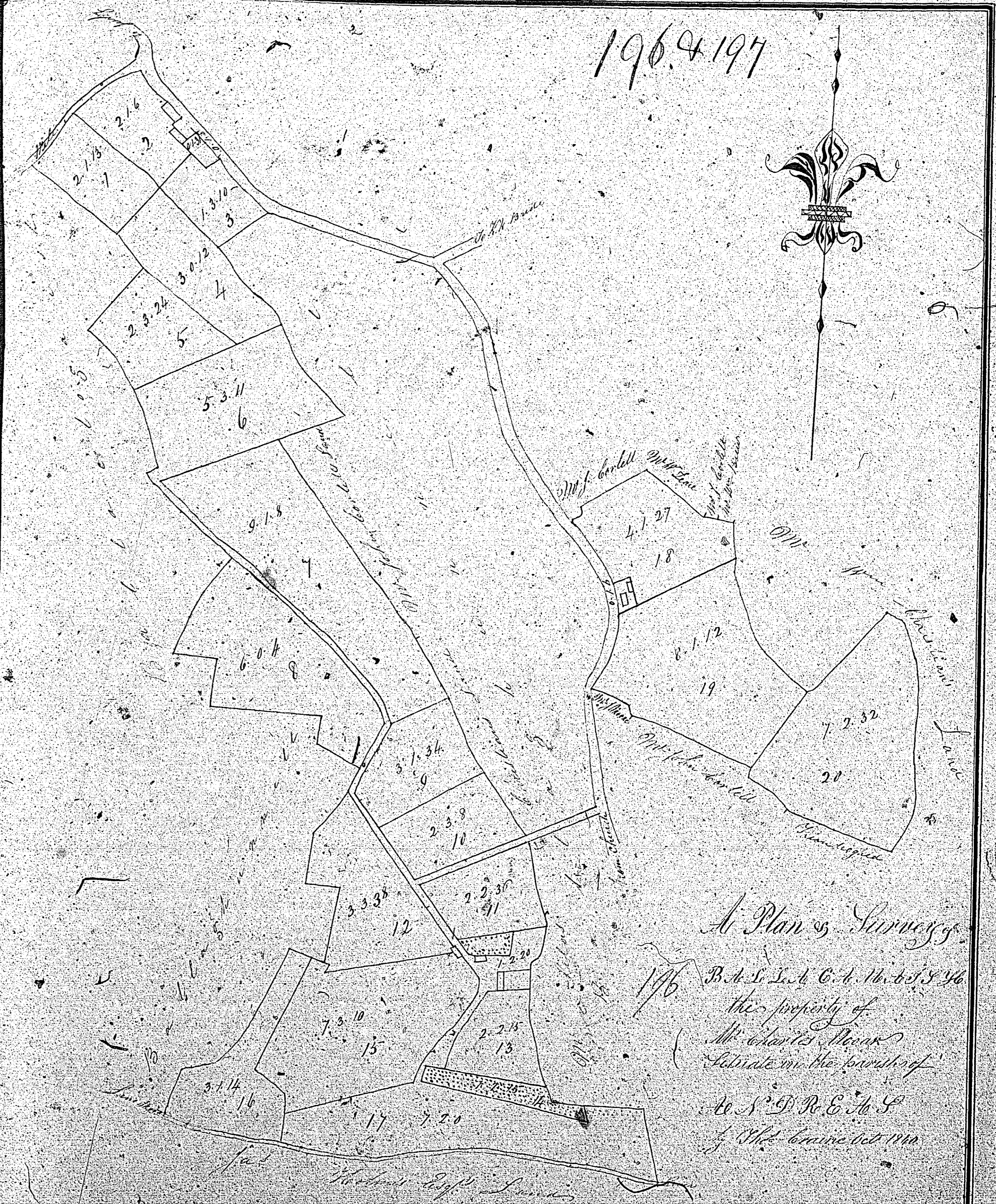

A Plan of Survey

196 B. A. S. L. C. 16. 6. 5. 5. 46
 the property of
 Mr. Charles Stewart
 Situate in the parish of
 W. S. D. R. E. S. S.
 of the County of ...

Scale of 4 chains to an inch

1846

J. Powell
Surveyor 1839

D I G

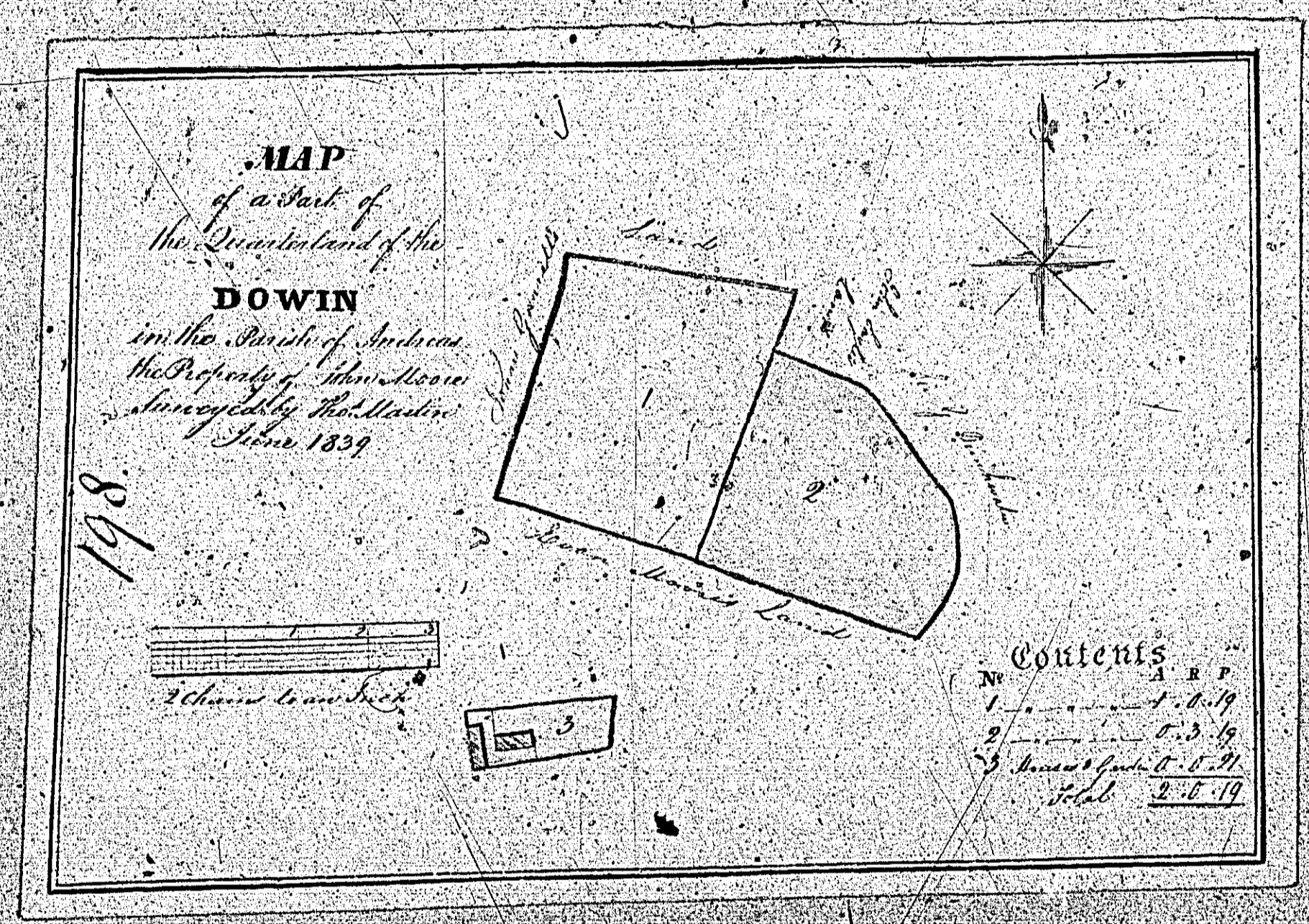

ISLE OF MAN GOVERNMENT: GENERAL REGISTRY
TITHE PLANS: PARISH OF ANDREAS
Original coloured (decorative) 1:30

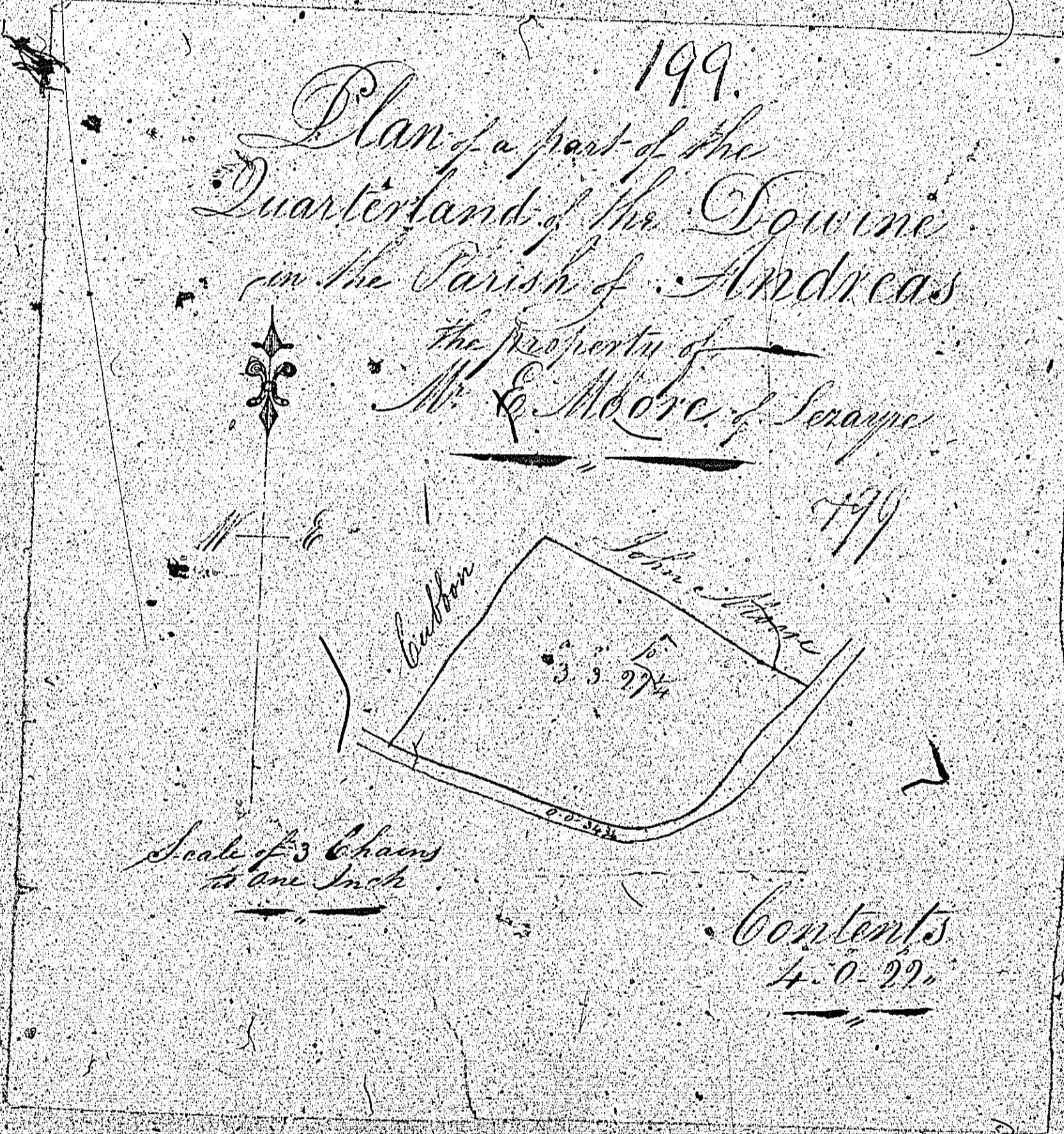

V
 I G

Esqr

J. Powell
 Surveyor 1760

A
Plan & Survey
of the Estate of
KIONDROGHAD
In the parish of
ANDREAS
the property of
JOHN M^c HUTCHIN ESQ^r

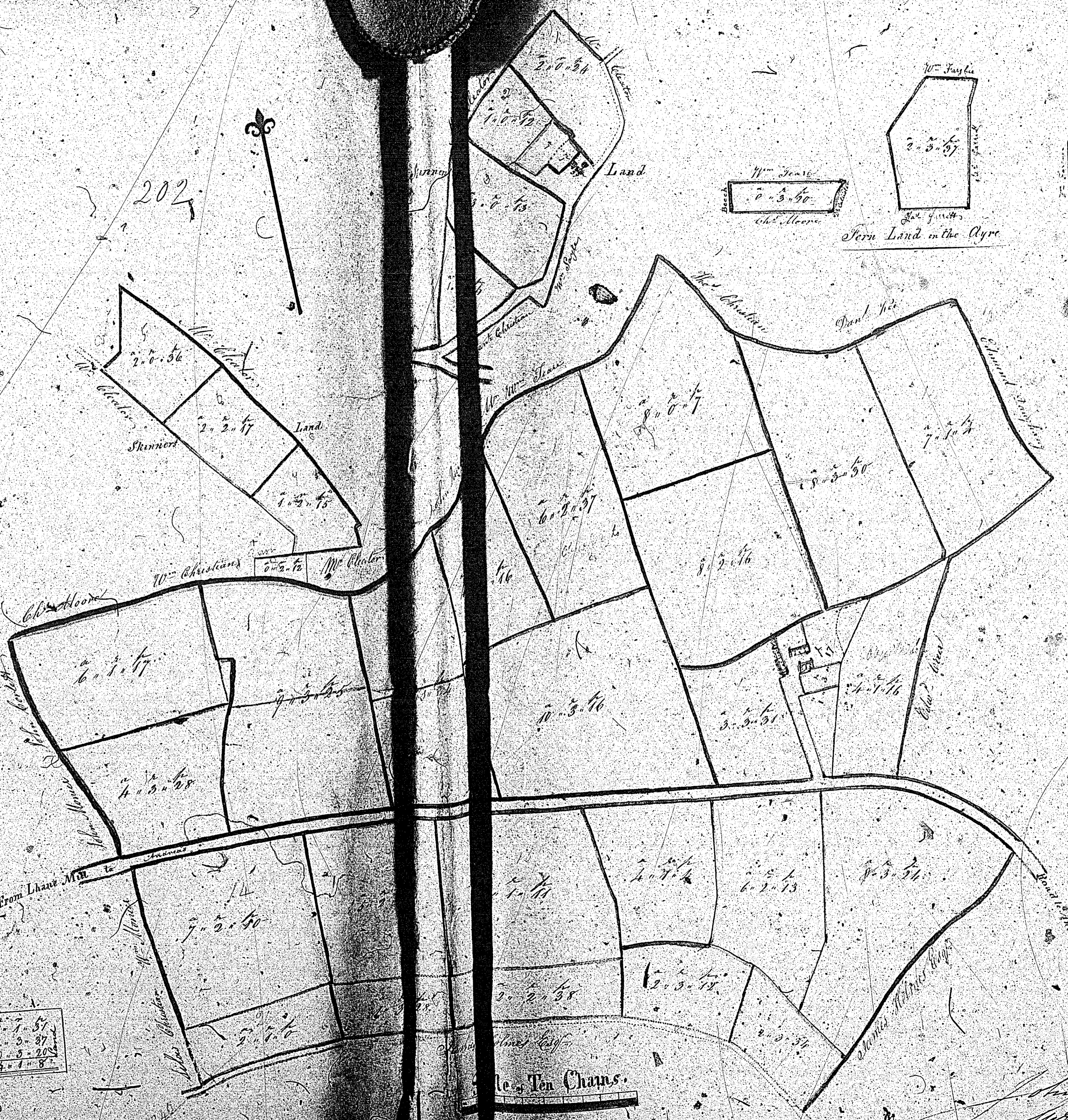

Field	Acres	Roods	Perches
1	1	17	
2	4	3	28
3	9	3	25
4	8	3	24
5	4	0	16
6	6	2	37
7	8	0	17
8	8	2	16
9	8	3	30
10	7	1	4
11	4	1	16
12	3	3	31
13	10	3	16
14	7	2	10
15	5	2	11
16	7	1	41
17	4	1	4
18	6	2	13
19	8	3	24
20	2	1	0
21	1	8	28
22	2	2	38
23	2	3	12
24	2	2	34
Contents/45			
2.13			
Gardens			
1.3			
17			
Drains			
0.2			
2			
Hedge Land			
2.4			
11			
Tern Land			
15.3			
13			
Kiondroghad			
16.2			
12			
Skinnors Land			
17.4			
26			
Total			
171.4			
26			

Contents	Acres	Roods	Perches
1	7	2	24
2	1	0	12
3	3	0	13
4	1	3	6
5	2	0	36
6	2	17	
7	1	2	15
8	0	2	12
9	15	0	13
Survey			
1.7			
39			
16.2			
12			

John Bony
 Surveyor