

MAP
and Survey of
Part of the Quarterland
of
BALLAVASTAN
in the Parish of Andrews
the property of the Court of Proprietors

Mr. Stephen Edge

Mr. Daniel Rice

Mr. Charles 2

John Compton

Whitely

Edward Beers

Mr. John P. Rice

| | |
|----|-----|
| 1 | 100 |
| 2 | 100 |
| 3 | 100 |
| 4 | 100 |
| 5 | 100 |
| 6 | 100 |
| 7 | 100 |
| 8 | 100 |
| 9 | 100 |
| 10 | 100 |
| 11 | 100 |
| 12 | 100 |
| 13 | 100 |
| 14 | 100 |
| 15 | 100 |
| 16 | 100 |
| 17 | 100 |
| 18 | 100 |
| 19 | 100 |
| 20 | 100 |
| 21 | 100 |
| 22 | 100 |
| 23 | 100 |
| 24 | 100 |
| 25 | 100 |
| 26 | 100 |
| 27 | 100 |
| 28 | 100 |
| 29 | 100 |
| 30 | 100 |
| 31 | 100 |
| 32 | 100 |
| 33 | 100 |
| 34 | 100 |
| 35 | 100 |
| 36 | 100 |
| 37 | 100 |
| 38 | 100 |
| 39 | 100 |
| 40 | 100 |
| 41 | 100 |
| 42 | 100 |
| 43 | 100 |
| 44 | 100 |
| 45 | 100 |
| 46 | 100 |
| 47 | 100 |
| 48 | 100 |
| 49 | 100 |
| 50 | 100 |



Surveyed by the Court
of Proprietors

Plan & Survey
of the
D O W N E
in the Parish of
Andreas
the Property of
Sir Geo. Drinkwater Bont.

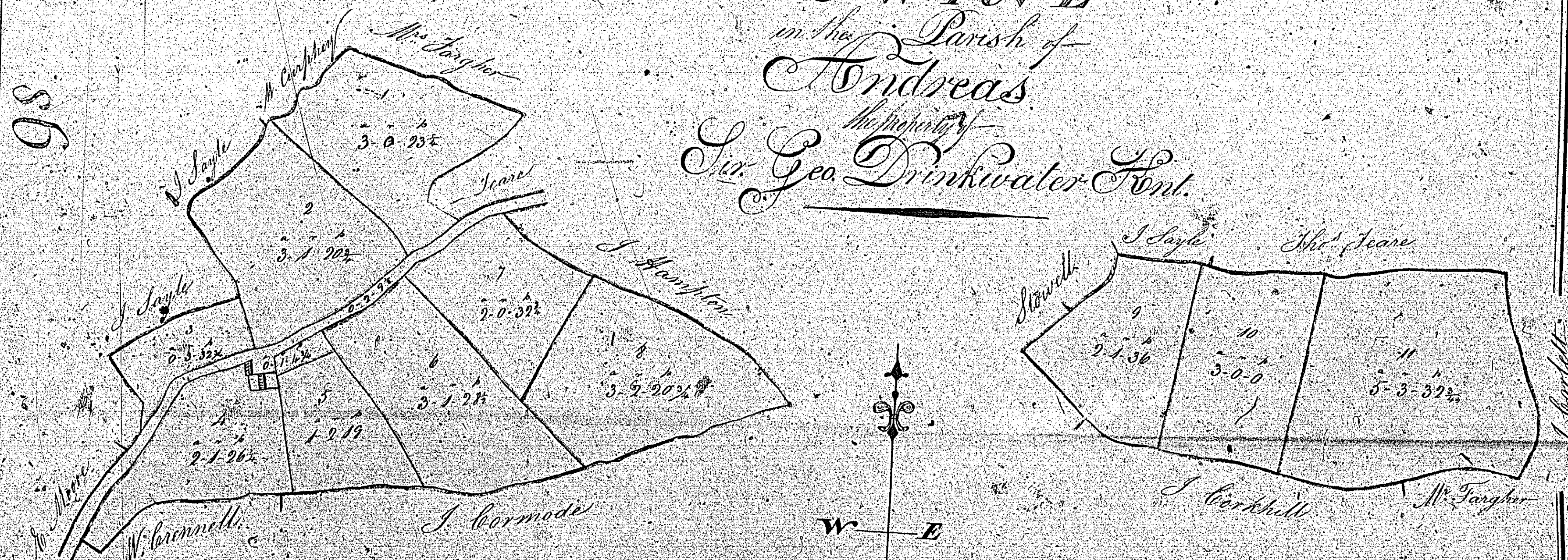

Scale of 5 Chains to One Inch

References

| No. | a. | r. | d. |
|-----------------------|-----------|----------|---------------|
| 1 | 3 | 0 | 23 1/2 |
| 2 | 3 | 1 | 20 1/2 |
| 3 | 0 | 3 | 32 1/2 |
| 4 | 2 | 1 | 26 1/2 |
| 5 | 1 | 2 | 19 |
| 6 | 3 | 1 | 28 1/2 |
| 7 | 2 | 0 | 32 1/2 |
| 8 | 3 | 2 | 20 1/2 |
| 9 | 2 | 1 | 36 |
| 10 | 3 | 0 | 0 |
| 11 | 5 | 3 | 32 1/2 |
| Fields | 32 | 0 | 32 1/2 |
| Commons &c | 0 | 3 | 11 1/2 |
| Total | 33 | 0 | 44 |

J. Corbett
Surveyor 1860

ISLE OF MAN GOVERNMENT: GENERAL REGISTRY
TITHE PLANS: PARISH OF ANDREAS
Original coloured (decorative) 1:30

ISLE OF MAN GOVERNMENT: GENERAL REGISTRY

TITHE PLANS: PARISH OF ANDREAS

Original coloured

1:30

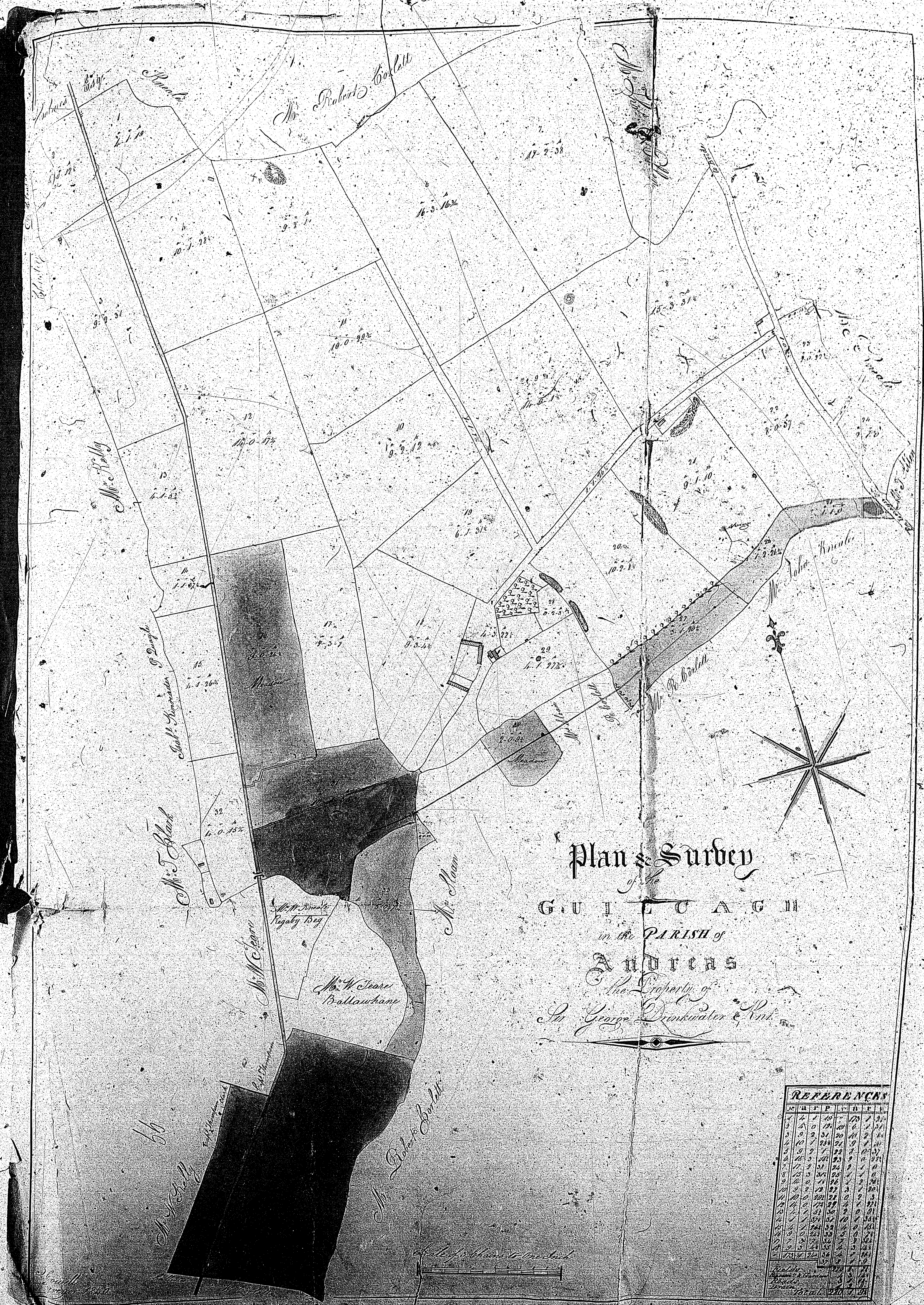

Plan & Survey
of the
GUILCAGH
in the PARISH of
ANDREAS
the Property of
Mr. George Drumboiler & Co.

| REFERENCES | | | | | | | | | | |
|------------|-----|-----|-----|-----|-----|-----|-----|-----|------|------|
| 1 | 2 | 3 | 4 | 5 | 6 | 7 | 8 | 9 | 10 | 11 |
| 1 | 2 | 3 | 4 | 5 | 6 | 7 | 8 | 9 | 10 | 11 |
| 12 | 13 | 14 | 15 | 16 | 17 | 18 | 19 | 20 | 21 | 22 |
| 23 | 24 | 25 | 26 | 27 | 28 | 29 | 30 | 31 | 32 | 33 |
| 34 | 35 | 36 | 37 | 38 | 39 | 40 | 41 | 42 | 43 | 44 |
| 45 | 46 | 47 | 48 | 49 | 50 | 51 | 52 | 53 | 54 | 55 |
| 56 | 57 | 58 | 59 | 60 | 61 | 62 | 63 | 64 | 65 | 66 |
| 67 | 68 | 69 | 70 | 71 | 72 | 73 | 74 | 75 | 76 | 77 |
| 78 | 79 | 80 | 81 | 82 | 83 | 84 | 85 | 86 | 87 | 88 |
| 89 | 90 | 91 | 92 | 93 | 94 | 95 | 96 | 97 | 98 | 99 |
| 100 | 101 | 102 | 103 | 104 | 105 | 106 | 107 | 108 | 109 | 110 |
| 111 | 112 | 113 | 114 | 115 | 116 | 117 | 118 | 119 | 120 | 121 |
| 122 | 123 | 124 | 125 | 126 | 127 | 128 | 129 | 130 | 131 | 132 |
| 133 | 134 | 135 | 136 | 137 | 138 | 139 | 140 | 141 | 142 | 143 |
| 144 | 145 | 146 | 147 | 148 | 149 | 150 | 151 | 152 | 153 | 154 |
| 155 | 156 | 157 | 158 | 159 | 160 | 161 | 162 | 163 | 164 | 165 |
| 166 | 167 | 168 | 169 | 170 | 171 | 172 | 173 | 174 | 175 | 176 |
| 177 | 178 | 179 | 180 | 181 | 182 | 183 | 184 | 185 | 186 | 187 |
| 188 | 189 | 190 | 191 | 192 | 193 | 194 | 195 | 196 | 197 | 198 |
| 199 | 200 | 201 | 202 | 203 | 204 | 205 | 206 | 207 | 208 | 209 |
| 210 | 211 | 212 | 213 | 214 | 215 | 216 | 217 | 218 | 219 | 220 |
| 221 | 222 | 223 | 224 | 225 | 226 | 227 | 228 | 229 | 230 | 231 |
| 232 | 233 | 234 | 235 | 236 | 237 | 238 | 239 | 240 | 241 | 242 |
| 243 | 244 | 245 | 246 | 247 | 248 | 249 | 250 | 251 | 252 | 253 |
| 254 | 255 | 256 | 257 | 258 | 259 | 260 | 261 | 262 | 263 | 264 |
| 265 | 266 | 267 | 268 | 269 | 270 | 271 | 272 | 273 | 274 | 275 |
| 276 | 277 | 278 | 279 | 280 | 281 | 282 | 283 | 284 | 285 | 286 |
| 287 | 288 | 289 | 290 | 291 | 292 | 293 | 294 | 295 | 296 | 297 |
| 298 | 299 | 300 | 301 | 302 | 303 | 304 | 305 | 306 | 307 | 308 |
| 309 | 310 | 311 | 312 | 313 | 314 | 315 | 316 | 317 | 318 | 319 |
| 320 | 321 | 322 | 323 | 324 | 325 | 326 | 327 | 328 | 329 | 330 |
| 331 | 332 | 333 | 334 | 335 | 336 | 337 | 338 | 339 | 340 | 341 |
| 342 | 343 | 344 | 345 | 346 | 347 | 348 | 349 | 350 | 351 | 352 |
| 353 | 354 | 355 | 356 | 357 | 358 | 359 | 360 | 361 | 362 | 363 |
| 364 | 365 | 366 | 367 | 368 | 369 | 370 | 371 | 372 | 373 | 374 |
| 375 | 376 | 377 | 378 | 379 | 380 | 381 | 382 | 383 | 384 | 385 |
| 386 | 387 | 388 | 389 | 390 | 391 | 392 | 393 | 394 | 395 | 396 |
| 397 | 398 | 399 | 400 | 401 | 402 | 403 | 404 | 405 | 406 | 407 |
| 408 | 409 | 410 | 411 | 412 | 413 | 414 | 415 | 416 | 417 | 418 |
| 419 | 420 | 421 | 422 | 423 | 424 | 425 | 426 | 427 | 428 | 429 |
| 430 | 431 | 432 | 433 | 434 | 435 | 436 | 437 | 438 | 439 | 440 |
| 441 | 442 | 443 | 444 | 445 | 446 | 447 | 448 | 449 | 450 | 451 |
| 452 | 453 | 454 | 455 | 456 | 457 | 458 | 459 | 460 | 461 | 462 |
| 463 | 464 | 465 | 466 | 467 | 468 | 469 | 470 | 471 | 472 | 473 |
| 474 | 475 | 476 | 477 | 478 | 479 | 480 | 481 | 482 | 483 | 484 |
| 485 | 486 | 487 | 488 | 489 | 490 | 491 | 492 | 493 | 494 | 495 |
| 496 | 497 | 498 | 499 | 500 | 501 | 502 | 503 | 504 | 505 | 506 |
| 507 | 508 | 509 | 510 | 511 | 512 | 513 | 514 | 515 | 516 | 517 |
| 518 | 519 | 520 | 521 | 522 | 523 | 524 | 525 | 526 | 527 | 528 |
| 529 | 530 | 531 | 532 | 533 | 534 | 535 | 536 | 537 | 538 | 539 |
| 540 | 541 | 542 | 543 | 544 | 545 | 546 | 547 | 548 | 549 | 550 |
| 551 | 552 | 553 | 554 | 555 | 556 | 557 | 558 | 559 | 560 | 561 |
| 562 | 563 | 564 | 565 | 566 | 567 | 568 | 569 | 570 | 571 | 572 |
| 573 | 574 | 575 | 576 | 577 | 578 | 579 | 580 | 581 | 582 | 583 |
| 584 | 585 | 586 | 587 | 588 | 589 | 590 | 591 | 592 | 593 | 594 |
| 595 | 596 | 597 | 598 | 599 | 600 | 601 | 602 | 603 | 604 | 605 |
| 606 | 607 | 608 | 609 | 610 | 611 | 612 | 613 | 614 | 615 | 616 |
| 617 | 618 | 619 | 620 | 621 | 622 | 623 | 624 | 625 | 626 | 627 |
| 628 | 629 | 630 | 631 | 632 | 633 | 634 | 635 | 636 | 637 | 638 |
| 639 | 640 | 641 | 642 | 643 | 644 | 645 | 646 | 647 | 648 | 649 |
| 650 | 651 | 652 | 653 | 654 | 655 | 656 | 657 | 658 | 659 | 660 |
| 661 | 662 | 663 | 664 | 665 | 666 | 667 | 668 | 669 | 670 | 671 |
| 672 | 673 | 674 | 675 | 676 | 677 | 678 | 679 | 680 | 681 | 682 |
| 683 | 684 | 685 | 686 | 687 | 688 | 689 | 690 | 691 | 692 | 693 |
| 694 | 695 | 696 | 697 | 698 | 699 | 700 | 701 | 702 | 703 | 704 |
| 705 | 706 | 707 | 708 | 709 | 710 | 711 | 712 | 713 | 714 | 715 |
| 716 | 717 | 718 | 719 | 720 | 721 | 722 | 723 | 724 | 725 | 726 |
| 727 | 728 | 729 | 730 | 731 | 732 | 733 | 734 | 735 | 736 | 737 |
| 738 | 739 | 740 | 741 | 742 | 743 | 744 | 745 | 746 | 747 | 748 |
| 749 | 750 | 751 | 752 | 753 | 754 | 755 | 756 | 757 | 758 | 759 |
| 760 | 761 | 762 | 763 | 764 | 765 | 766 | 767 | 768 | 769 | 770 |
| 771 | 772 | 773 | 774 | 775 | 776 | 777 | 778 | 779 | 780 | 781 |
| 782 | 783 | 784 | 785 | 786 | 787 | 788 | 789 | 790 | 791 | 792 |
| 793 | 794 | 795 | 796 | 797 | 798 | 799 | 800 | 801 | 802 | 803 |
| 804 | 805 | 806 | 807 | 808 | 809 | 810 | 811 | 812 | 813 | 814 |
| 815 | 816 | 817 | 818 | 819 | 820 | 821 | 822 | 823 | 824 | 825 |
| 826 | 827 | 828 | 829 | 830 | 831 | 832 | 833 | 834 | 835 | 836 |
| 837 | 838 | 839 | 840 | 841 | 842 | 843 | 844 | 845 | 846 | 847 |
| 848 | 849 | 850 | 851 | 852 | 853 | 854 | 855 | 856 | 857 | 858 |
| 859 | 860 | 861 | 862 | 863 | 864 | 865 | 866 | 867 | 868 | 869 |
| 870 | 871 | 872 | 873 | 874 | 875 | 876 | 877 | 878 | 879 | 880 |
| 881 | 882 | 883 | 884 | 885 | 886 | 887 | 888 | 889 | 890 | 891 |
| 892 | 893 | 894 | 895 | 896 | 897 | 898 | 899 | 900 | 901 | 902 |
| 903 | 904 | 905 | 906 | 907 | 908 | 909 | 910 | 911 | 912 | 913 |
| 914 | 915 | 916 | 917 | 918 | 919 | 920 | 921 | 922 | 923 | 924 |
| 925 | 926 | 927 | 928 | 929 | 930 | 931 | 932 | 933 | 934 | 935 |
| 936 | 937 | 938 | 939 | 940 | 941 | 942 | 943 | 944 | 945 | 946 |
| 947 | 948 | 949 | 950 | 951 | 952 | 953 | 954 | 955 | 956 | 957 |
| 958 | 959 | 960 | 961 | 962 | 963 | 964 | 965 | 966 | 967 | 968 |
| 969 | 970 | 971 | 972 | 973 | 974 | 975 | 976 | 977 | 978 | 979 |
| 980 | 981 | 982 | 983 | 984 | 985 | 986 | 987 | 988 | 989 | 990 |
| 991 | 992 | 993 | 994 | 995 | 996 | 997 | 998 | 999 | 1000 | 1001 |

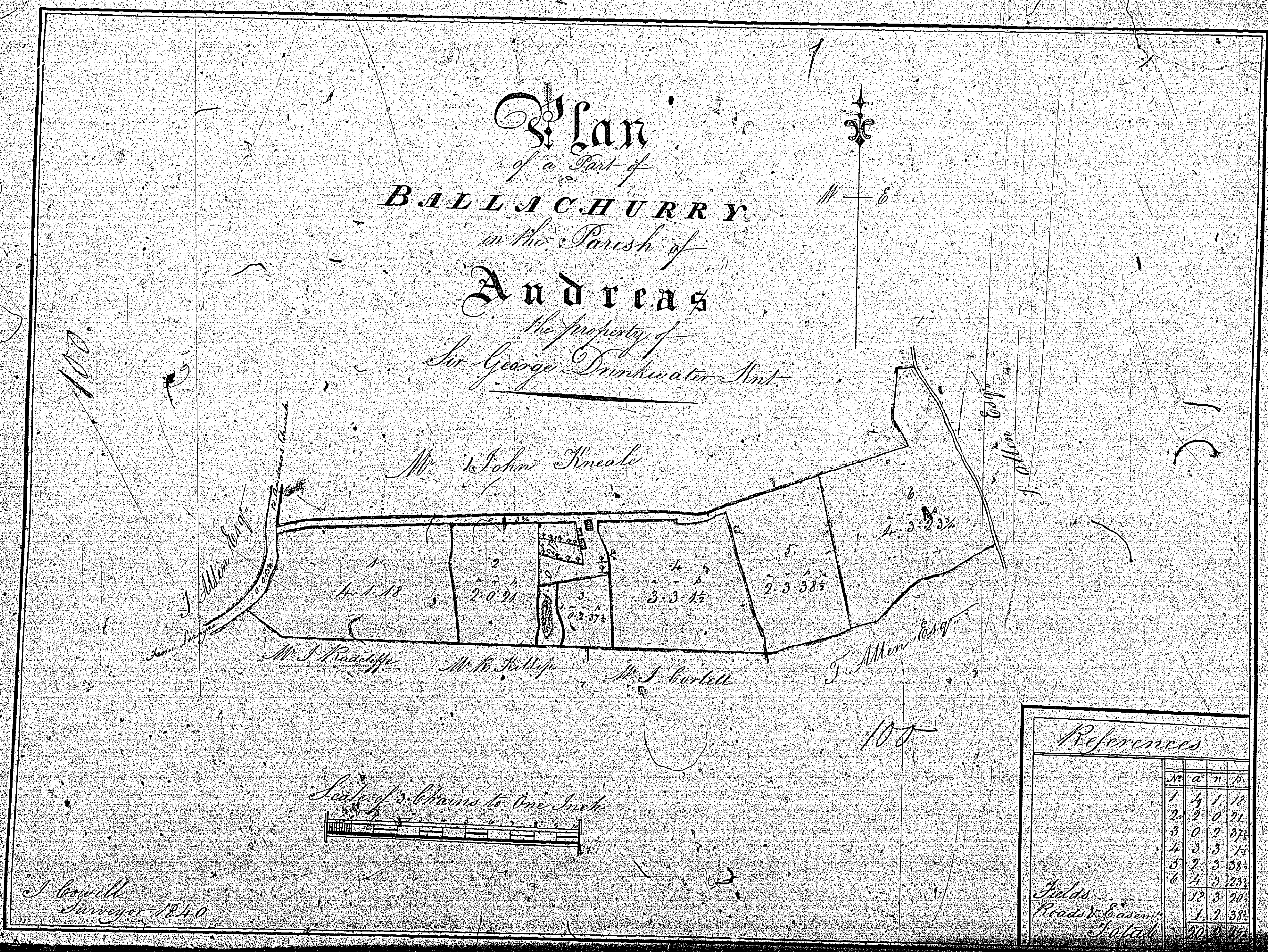

References

| No | a | r | p |
|------------------------------|----|---|------------------|
| 1 | 4 | 1 | 18 |
| 2 | 2 | 0 | 21 |
| 3 | 0 | 2 | 27 $\frac{1}{2}$ |
| 4 | 3 | 3 | 15 |
| 5 | 2 | 3 | 58 $\frac{1}{2}$ |
| 6 | 4 | 3 | 25 $\frac{1}{2}$ |
| <i>Fields</i> | | | |
| | 12 | 3 | 20 $\frac{1}{2}$ |
| <i>Roads & Easements</i> | | | |
| | 1 | 2 | 38 $\frac{1}{2}$ |
| <i>Total</i> | | | |
| | 20 | 0 | 15 $\frac{1}{2}$ |

ISLE OF MAN GOVERNMENT GENERAL REGISTRY
 TITHE PLANS: PARISH OF ANDREAS
 Original coloured 1:30

A PLAN
of the property of
William Langher
Andrews

107

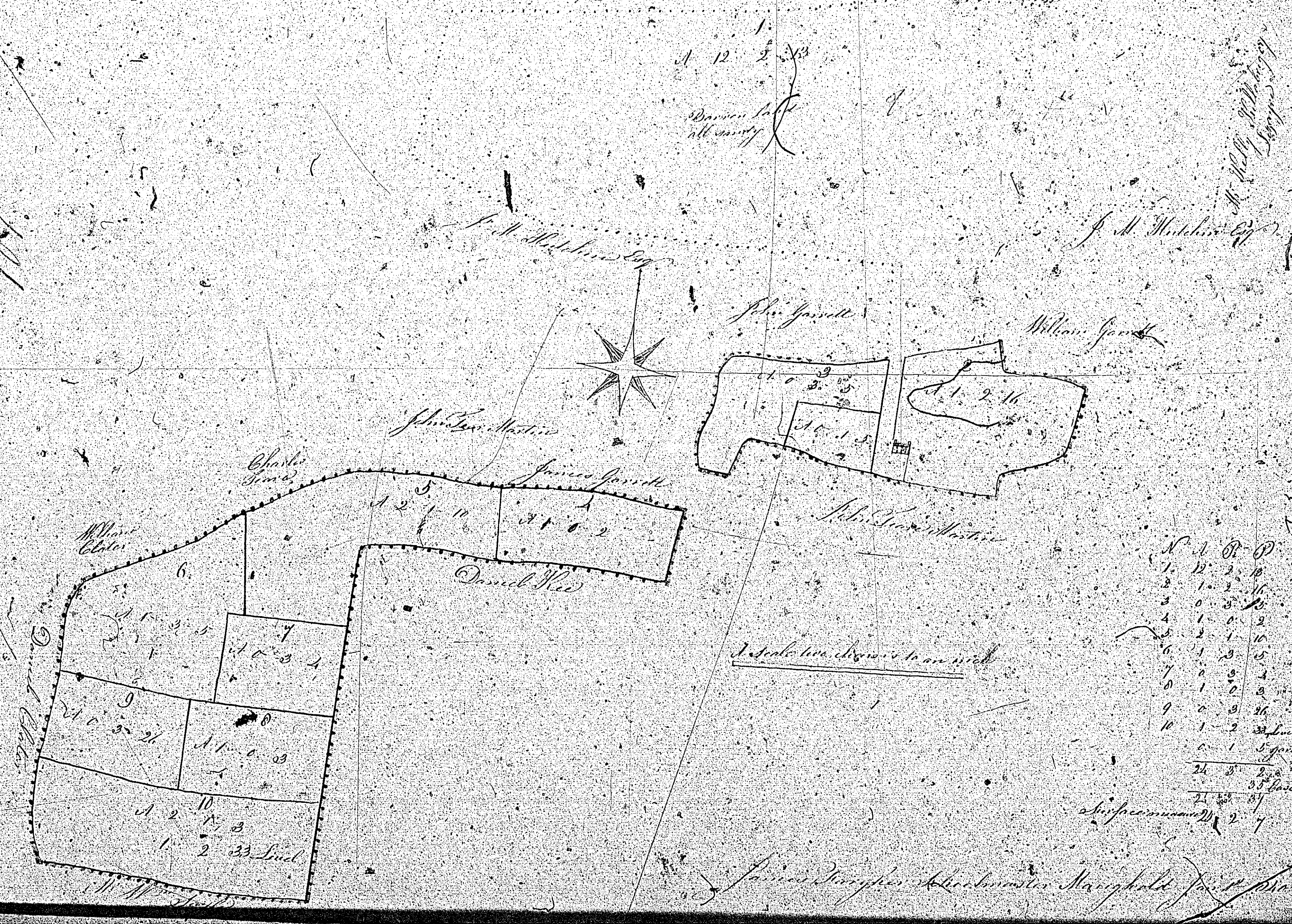

| N | A | P | D |
|----|----|---|----------|
| 1 | 12 | 2 | 10 |
| 2 | 1 | 2 | 16 |
| 3 | 0 | 3 | 23 |
| 4 | 1 | 0 | 2 |
| 5 | 2 | 1 | 10 |
| 6 | 1 | 3 | 15 |
| 7 | 0 | 3 | 4 |
| 8 | 1 | 0 | 3 |
| 9 | 0 | 3 | 16 |
| 10 | 1 | 2 | 33 |
| | | | 5 garden |
| | | | 20 |
| | | | 35 base |
| | | | 21 |
| | | | 87 |
| | | | 27 |

34 337
15 210
19 126

As to the above to an inch

James Douglas, Surveyor, St. John's, 1840

ISLE OF MAN GOVERNMENT: GENERAL REGISTRY
TITHE PLANS: PARISH OF ANDREAS
Original coloured (decorative) 1:30

102

Plan and Survey 102. of Partick Lands Parish of Andros

Belonging to Ellen Faragher
Andreas

102

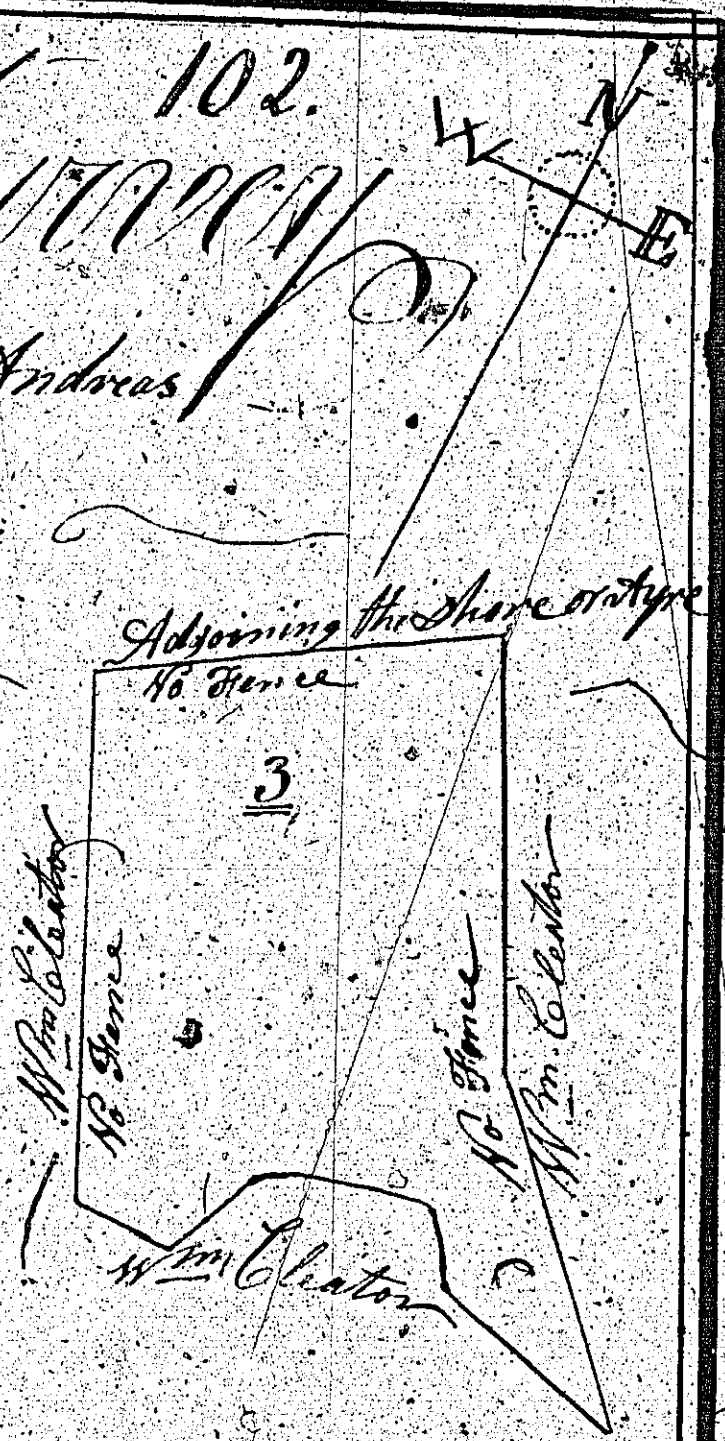

| No. | References | Acres |
|--------------------|--------------|-----------------|
| 1 | 1. 0. 29 1/2 | |
| 2 | 1. 0. 0. 11 | |
| 3 | 2. 0. 2. 18 | |
| Angles Garden Case | | 0. 0. 0. 55 1/2 |
| Pardon and Case | | 0. 0. 0. 12 |
| Total Acres | | 5. 0. 26 |

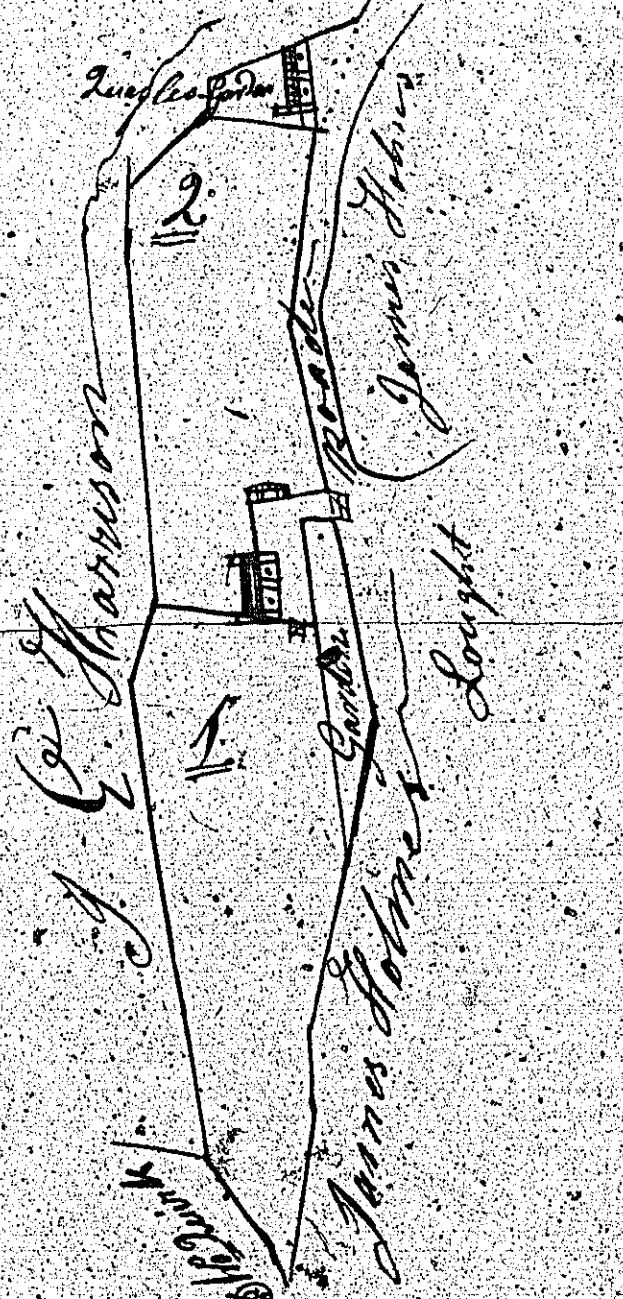

Thomas Coley
Surveyed by June 1839

Scale half Inch

102
102