

31.  
 A Plan and Survey of a part of  
 Boulders in the parish of Andover  
 the property of John Currier Esq  
 Daniel Currier taken Sept 11 1840  
 by Abel Hornish

Contents	
No. 1	2. 50
No. 2	3. 25
No. 3	2. 45

A scale of 100 Yards to an Inch

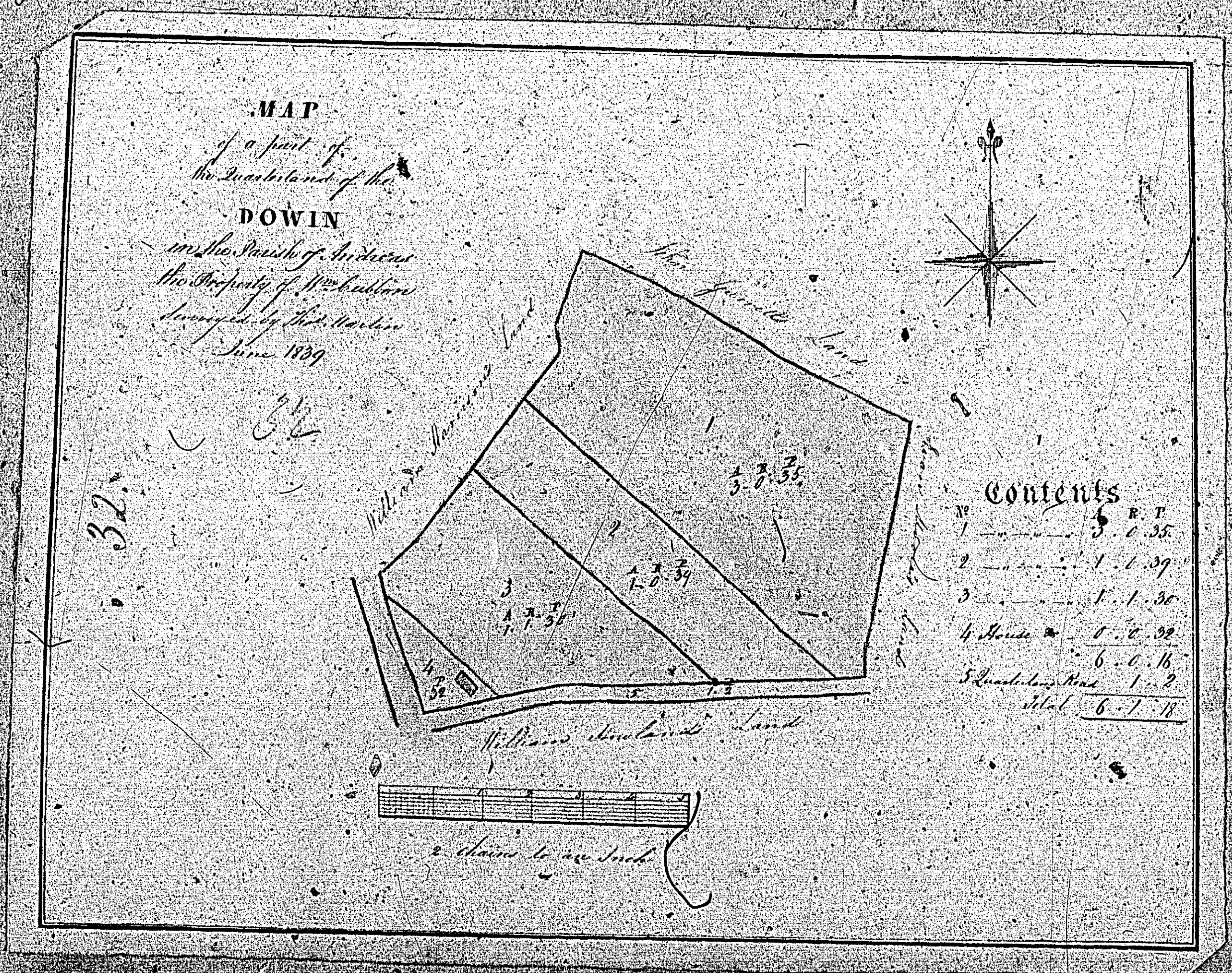



ISLE OF MAN GOVERNMENT: GENERAL REGISTRY  
**TITHE PLANS: PARISH OF ANDREAS**  
Original coloured (decorative) 1:30



Plan & Survey

BALLAGAWEN and  
BALLARANNEEN

in the Parish of  
Andreas

the Property of  
Mr S. Cowell

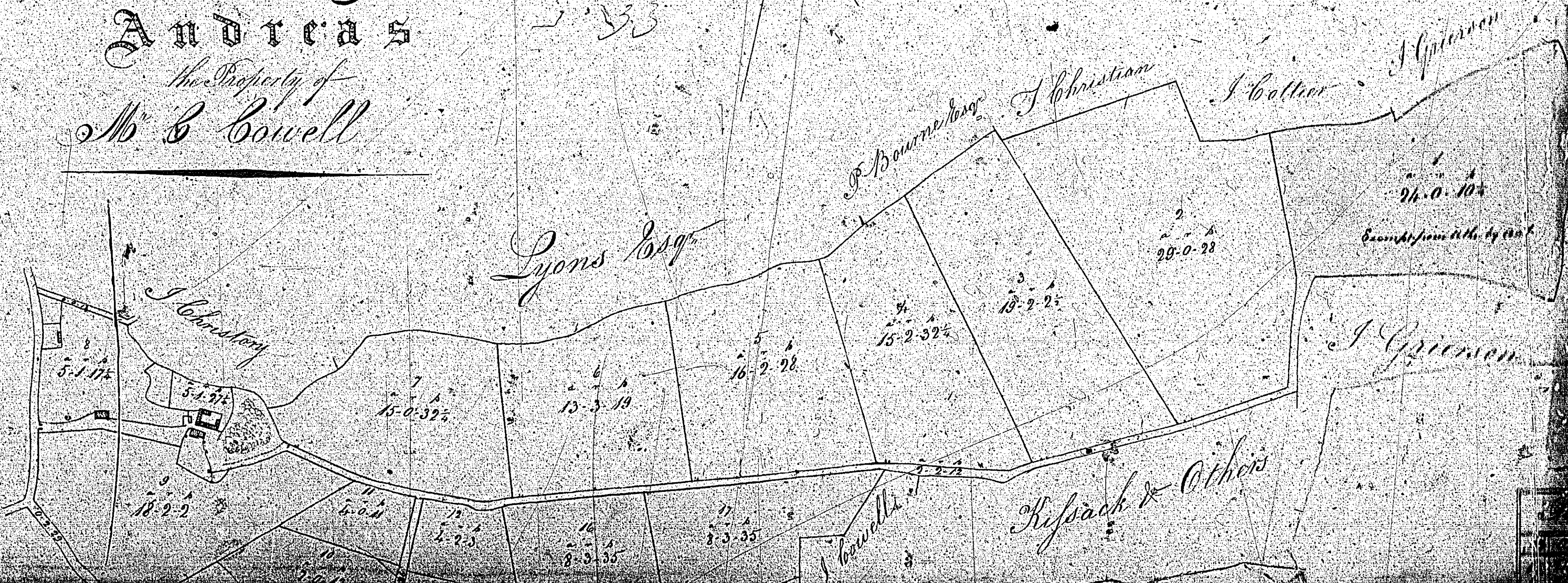
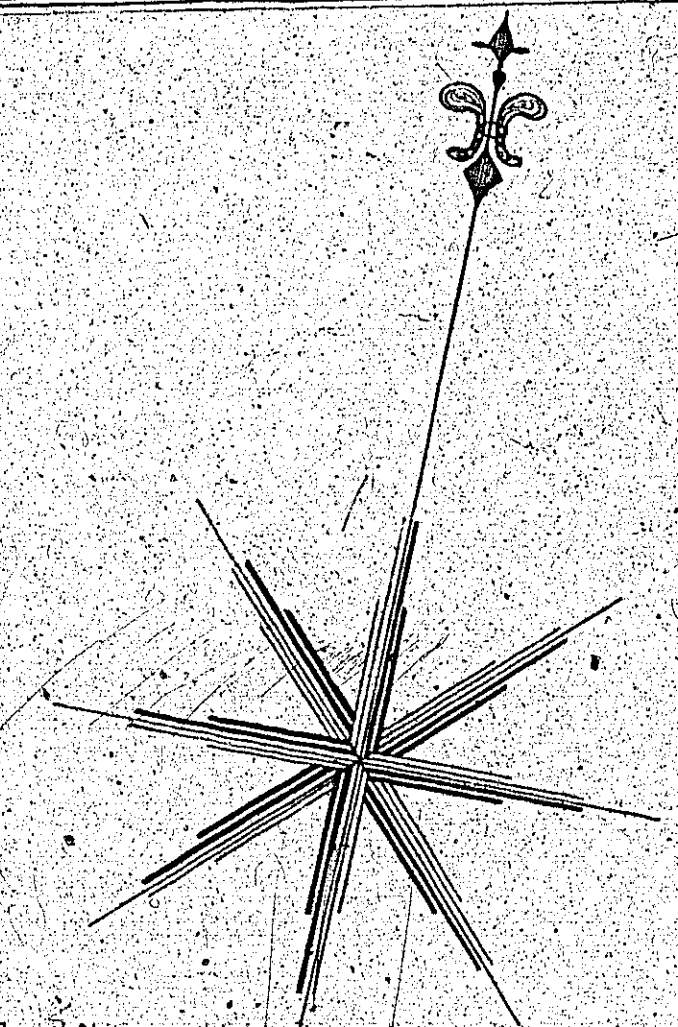

33

33

24.0.10  
Bound as from the No. 14 1808

22.0.28

18.2.22

15.2.32

16.2.28

13.3.19

15.0.32

18.2.2

5.1.17

5.5.34

8.3.35

8.3.35

8.3.35

8.3.35

8.3.35

8.3.35

8.3.35



MAP  
and Survey of  
**BALLAQUANE**  
in the Parish of Andreas  
the Bishopric of Sodor & Man

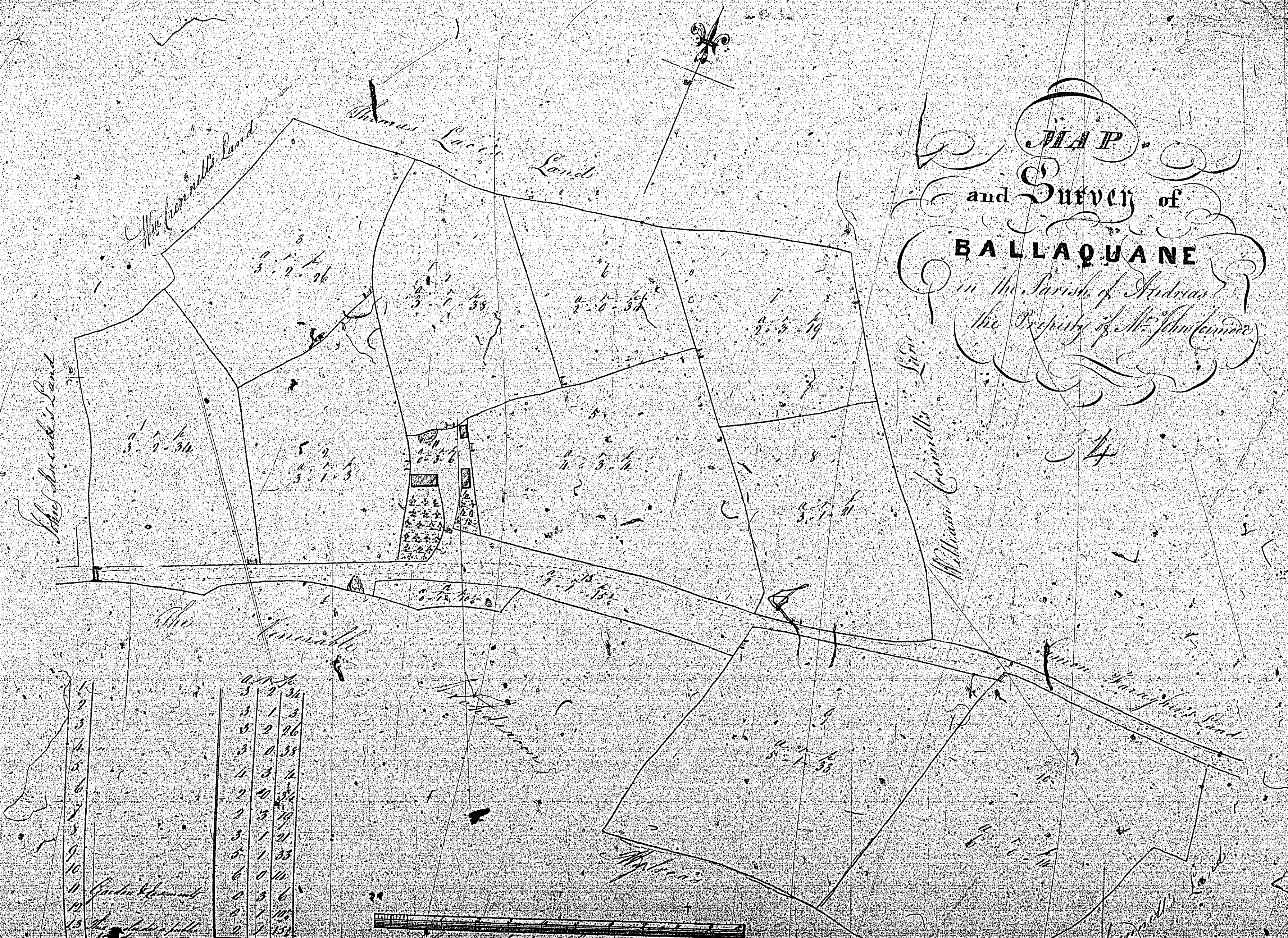

34

1	3	2	36
2	3	1	3
3	3	2	26
4	3	0	38
5	1	3	2
6	2	0	36
7	2	3	19
8	3	1	21
9	3	1	33
10	6	0	16
11	0	3	6
12	1	1	105
13	1	1	152
14	0	0	18

1	27
2	33
3	26
4	3
5	31
6	21
7	23
8	21
9	38
10	3
11	22
12	22
13	22
14	22

ISLE OF MAN GOVERNMENT: GENERAL REGISTRY

TITHE PLANS: PARISH OF ANDREAS

Original monotone

1:30



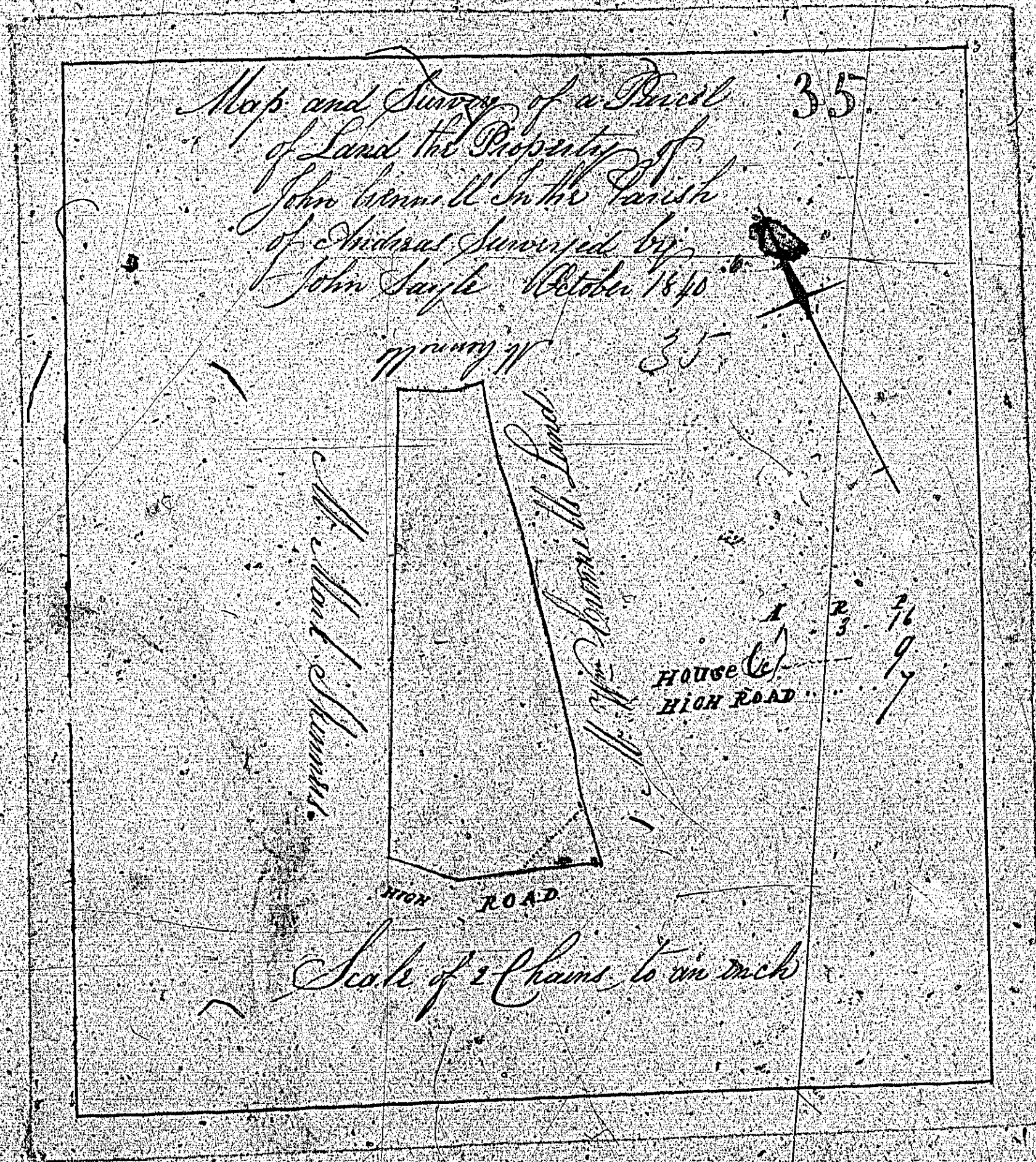

1	1
2	2
3	3
4	4
5	5
6	6
7	7
8	8
9	9
10	10
11	11
12	12
13	13
14	14
15	15
16	16
17	17
18	18
19	19
20	20
21	21
22	22
23	23
24	24
25	25
26	26
27	27
28	28
29	29
30	30
31	31
32	32
33	33
34	34
35	35