

ISLE OF MAN GOVERNMENT: GENERAL REGISTRY

ASYLUM PLANS: PARISH OF SANTON

Original monotone

1:23

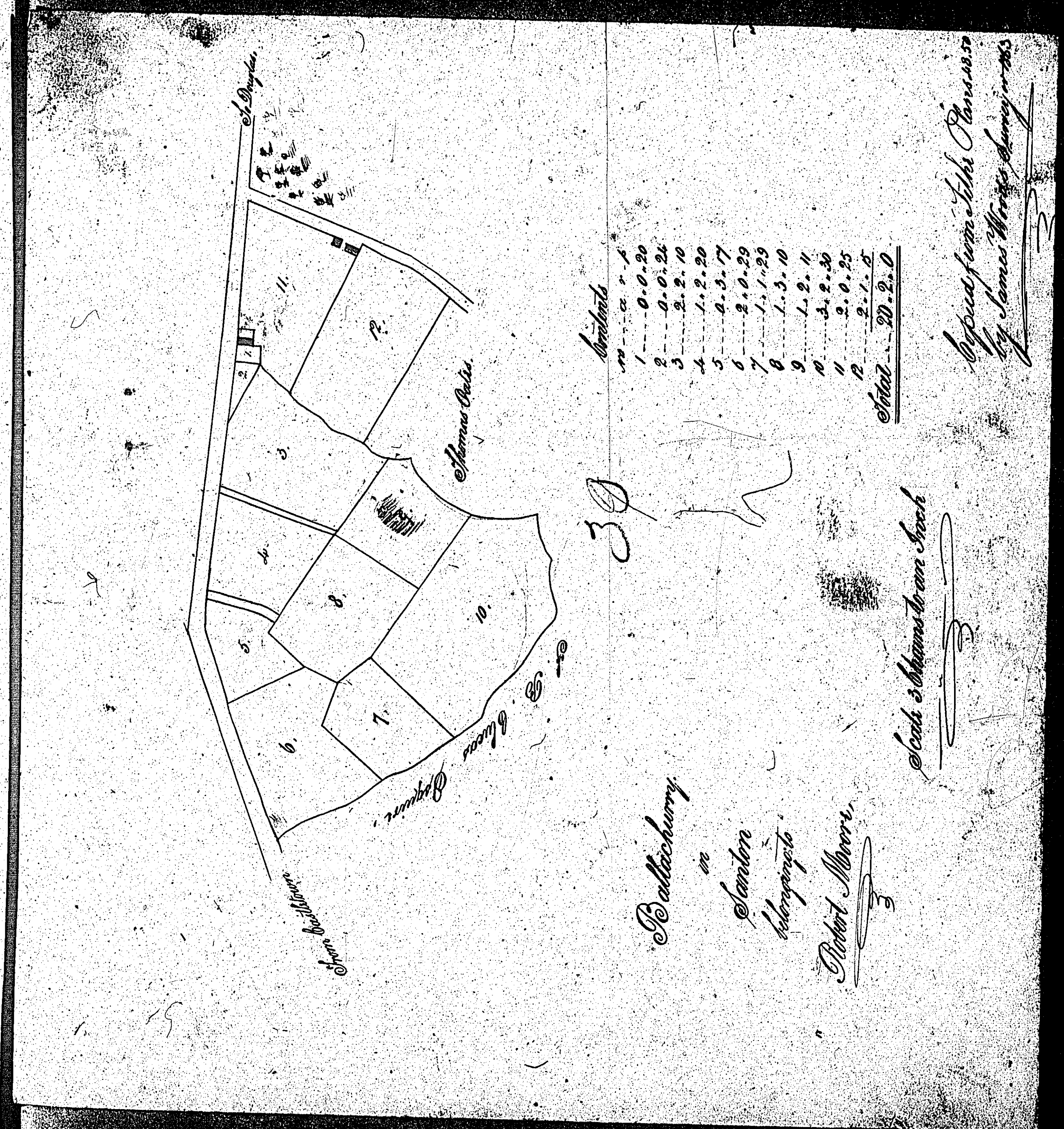

ISLE OF MAN GOVERNMENT: GENERAL REGISTRY

ASYLUM PLANS: PARISH OF SANTON

Originals monotone

1:23

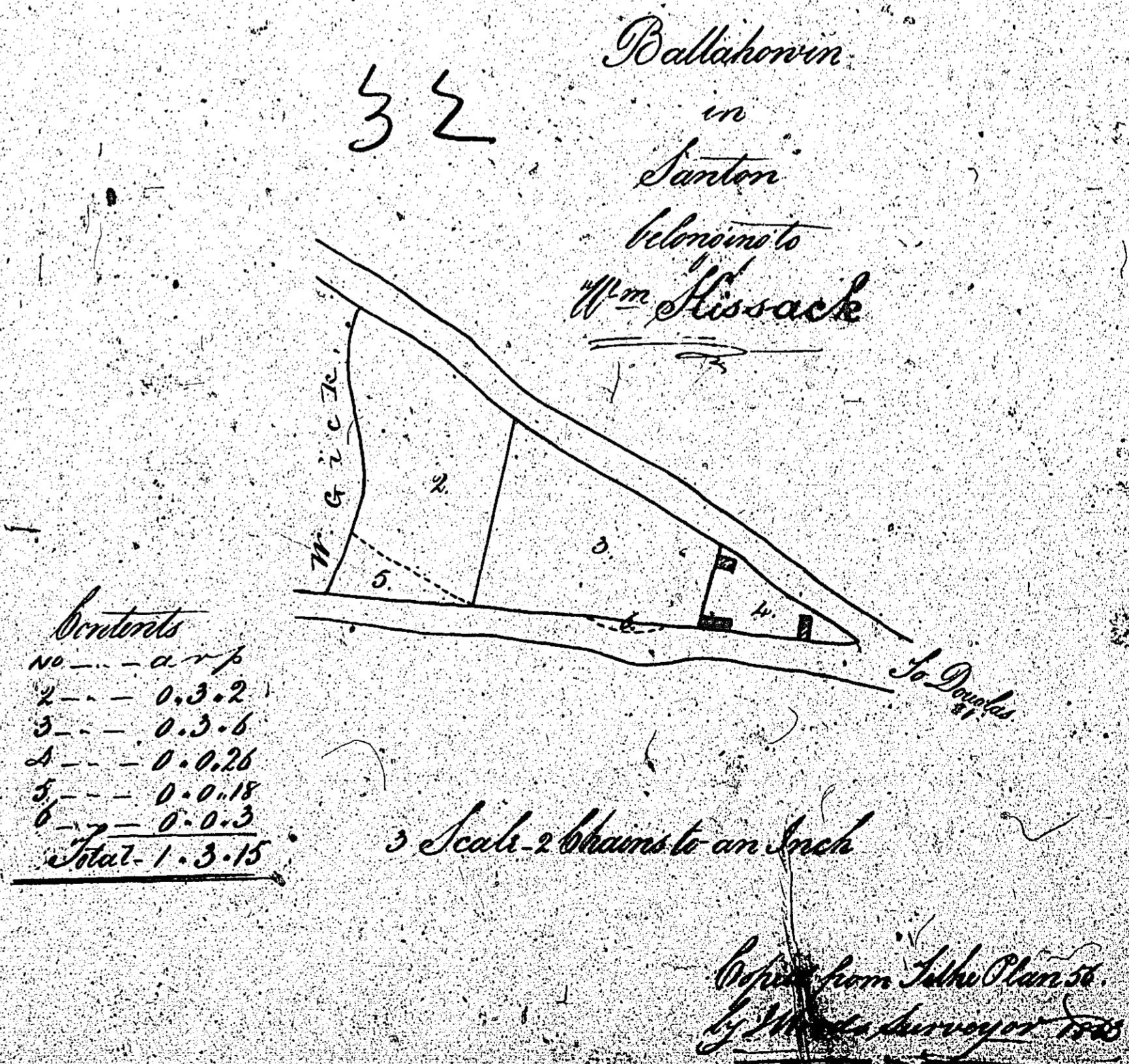
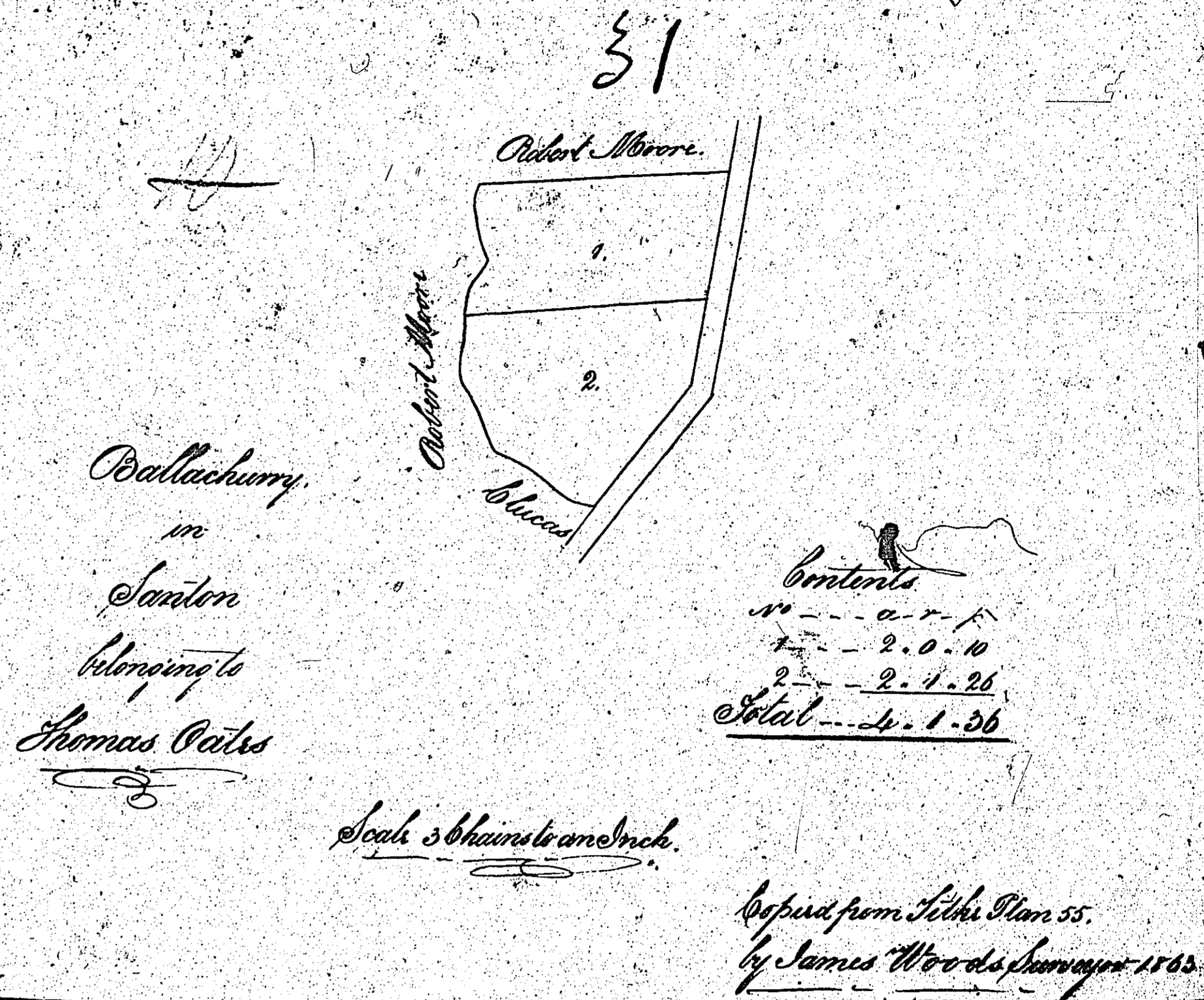

ISLE OF MAN GOVERNMENT: GENERAL REGISTRY  
 ASYLUM PLANS: PARISH OF SANTON

Original monotone

1:23

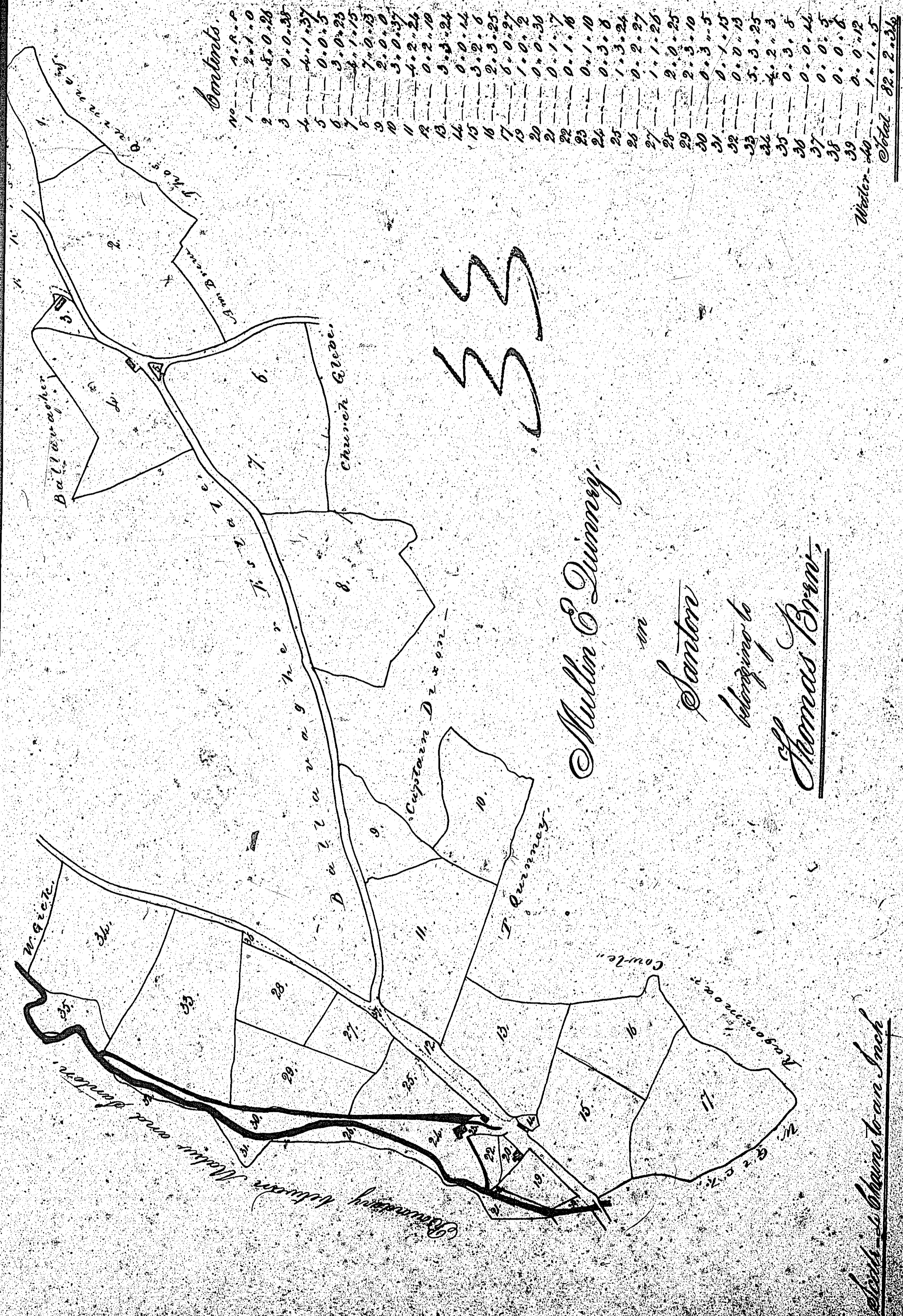

Scale - 1 Chain to an Inch

Copied from Title Plan 6  
 by James Woods Surveyor

ISLE OF MAN GOVERNMENT: GENERAL REGISTRY

ASYLUM PLANS: PARISH OF SANTON

Originals monotone

1:23

Parson Glebe  
Santon

34

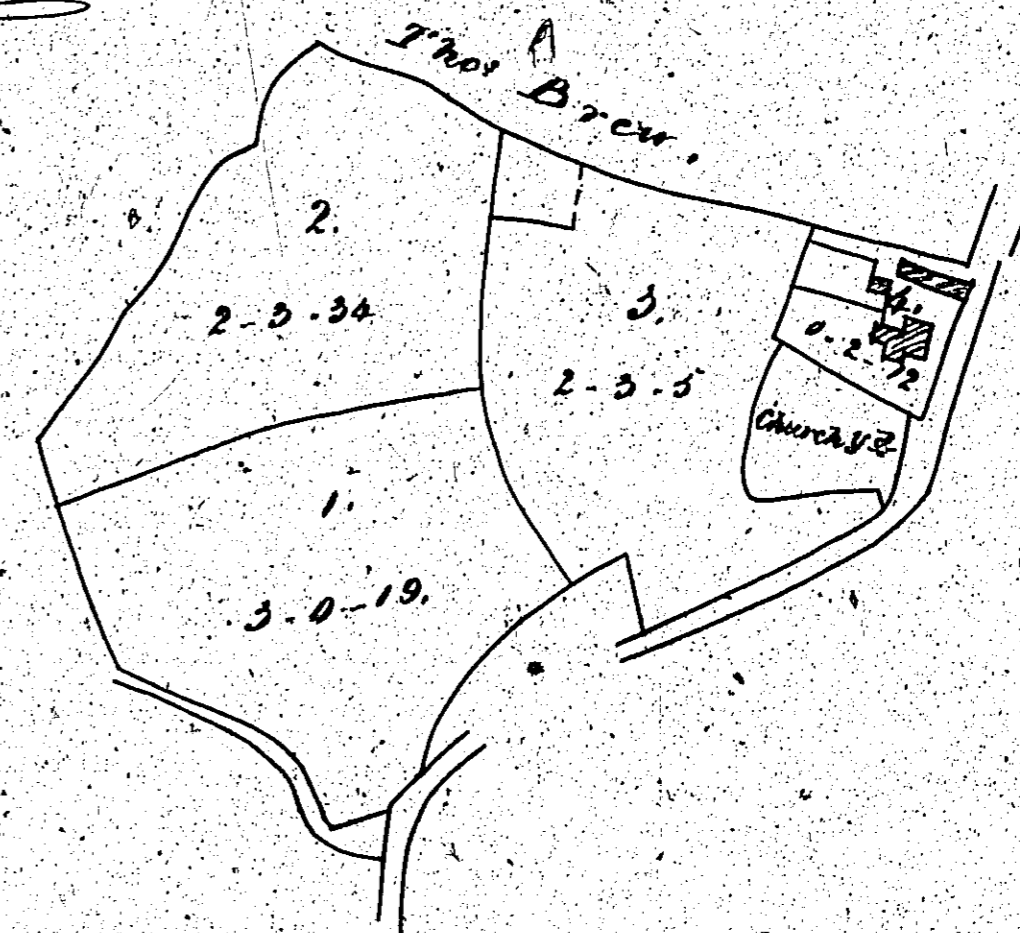

Contents <sup>and</sup> 9-1-30

Scale of 3 Chains

Kelly & Woods Surveyors

Clerks Glebe in Santon

35

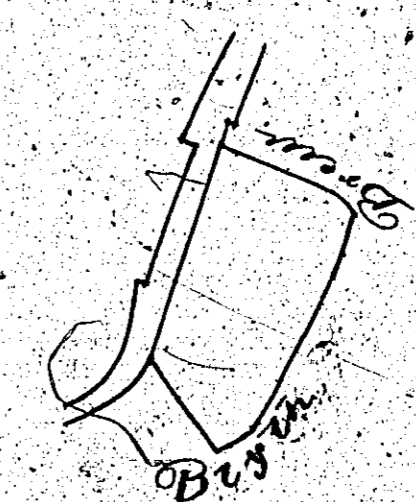

Scale of 3 Chains

Contents 0-5-12

Kelly & Woods Surveyors

ISLE OF MAN GOVERNMENT: GENERAL REGISTRY

ASYLUM PLANS: PARISH OF SANTON

Original monotone

1:23

Freehold  
Called  
Croit in Person

in  
Santon  
belonging to  
John Quinn

36

Verdants 0.2.4

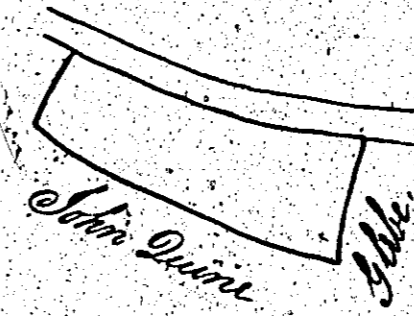

Scale 3 Chains to an Inch

Copied from the Plan 55.  
by James Woods Surveyor 1842

ISLE OF MAN GOVERNMENT: GENERAL REGISTRY

ASYLUM PLANS: PARISH OF SANTON

Original monotone

1:23

*Contents*

11	---	0. 0. 0.
1	---	3. 1. 14 1/2
2	---	1. 2. 16 1/2
3	---	2. 2. 20
4	---	0. 0. 36
5	---	1. 3. 27 1/2
6	---	0. 1. 30 1/2
7	---	1. 0. 28 1/2
8	---	0. 2. 23
9	---	0. 0. 28 1/2
10	---	1. 2. 26
11	---	0. 2. 25
<i>Total</i>	---	<i>16. 1. 36 1/2</i>

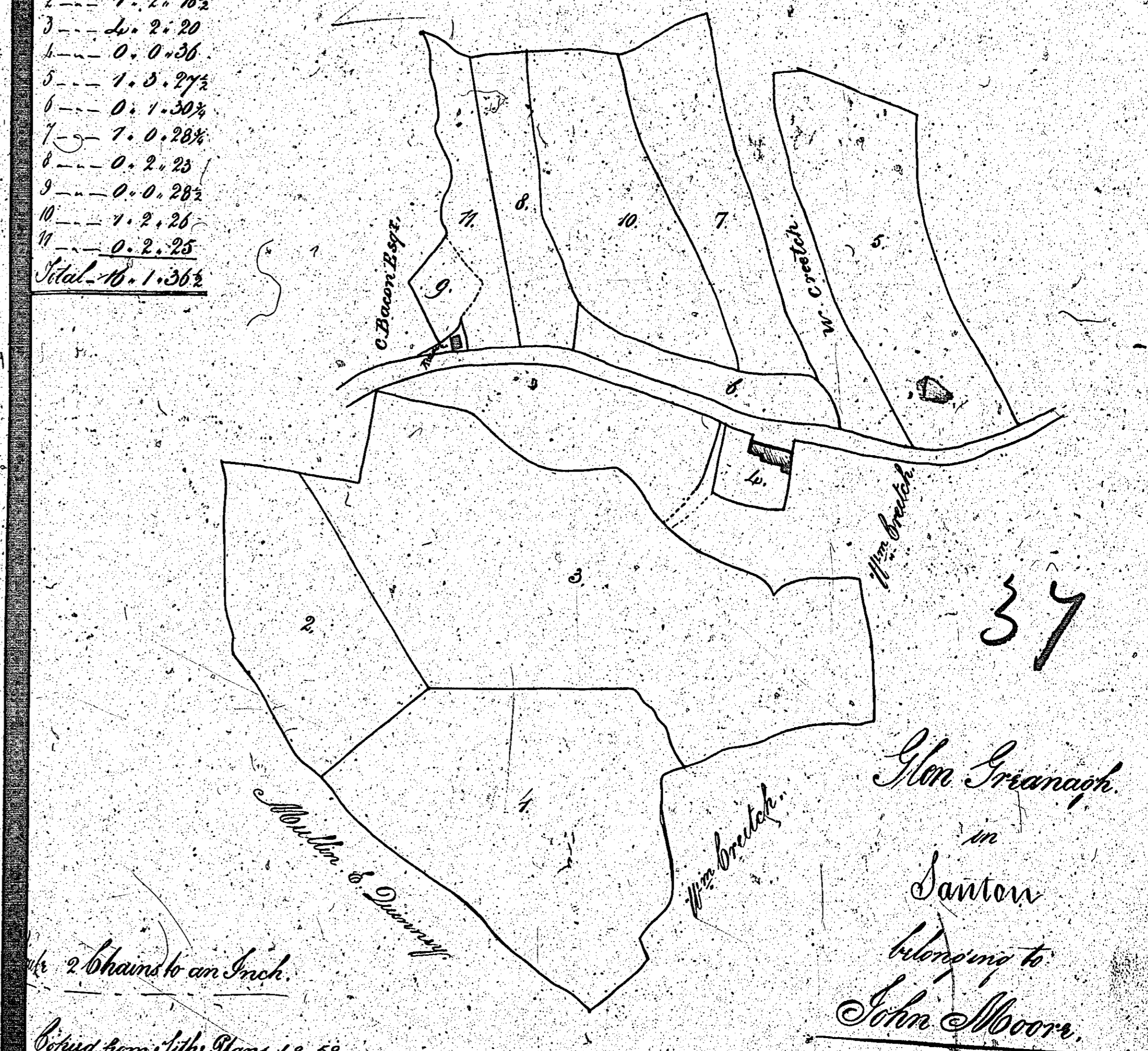

37

2 chains to an Inch.

Copied from Title Plans 1 & 58.  
by Jas Woods Surveyor 1865.

Glen Greanagh  
in  
Santon  
belonging to  
John Moore.