

ISLE OF MAN GOVERNMENT: GENERAL REGISTRY

ASYLUM PLANS: PARISH OF SANTON

Original monotone

1:23

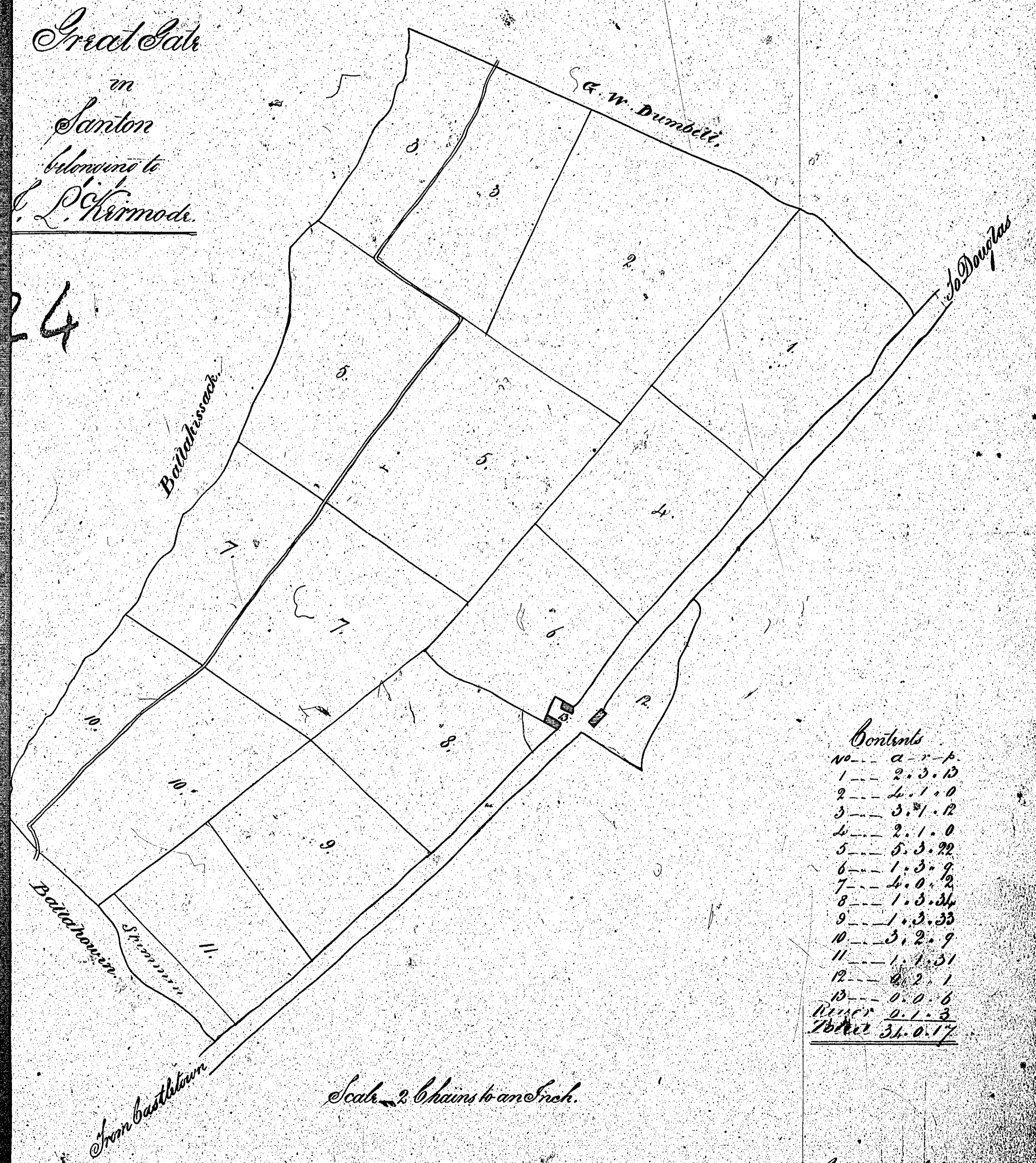



20

ISLE OF MAN GOVERNMENT: GENERAL REGISTRY  
ASYLUM PLANS: PARISH OF SANTON

Original coloured

1:23

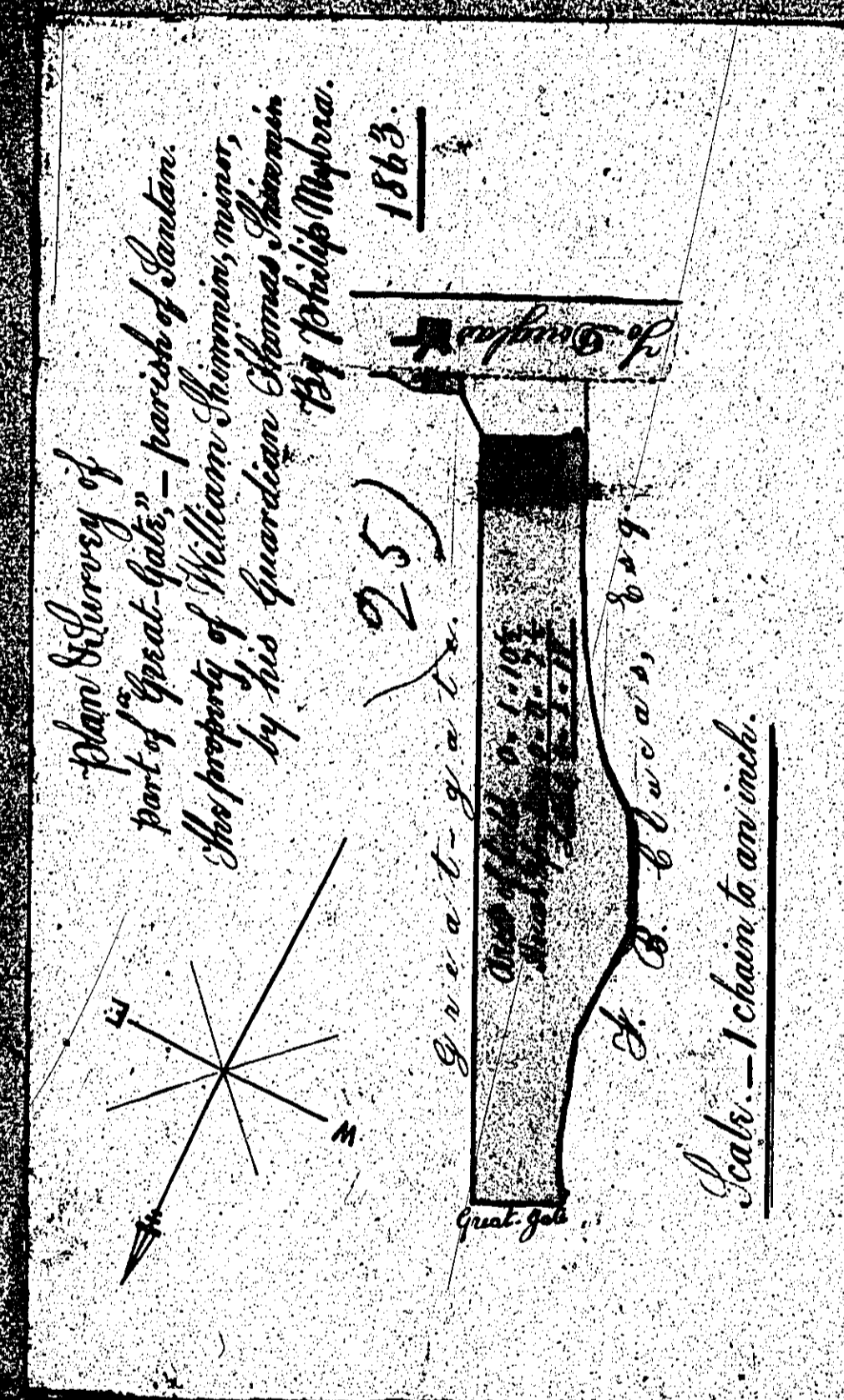







ISLE OF MAN GOVERNMENT: GENERAL REGISTRY

ASYLUM PLANS: PARISH OF SANTON

Original monotone

1:23

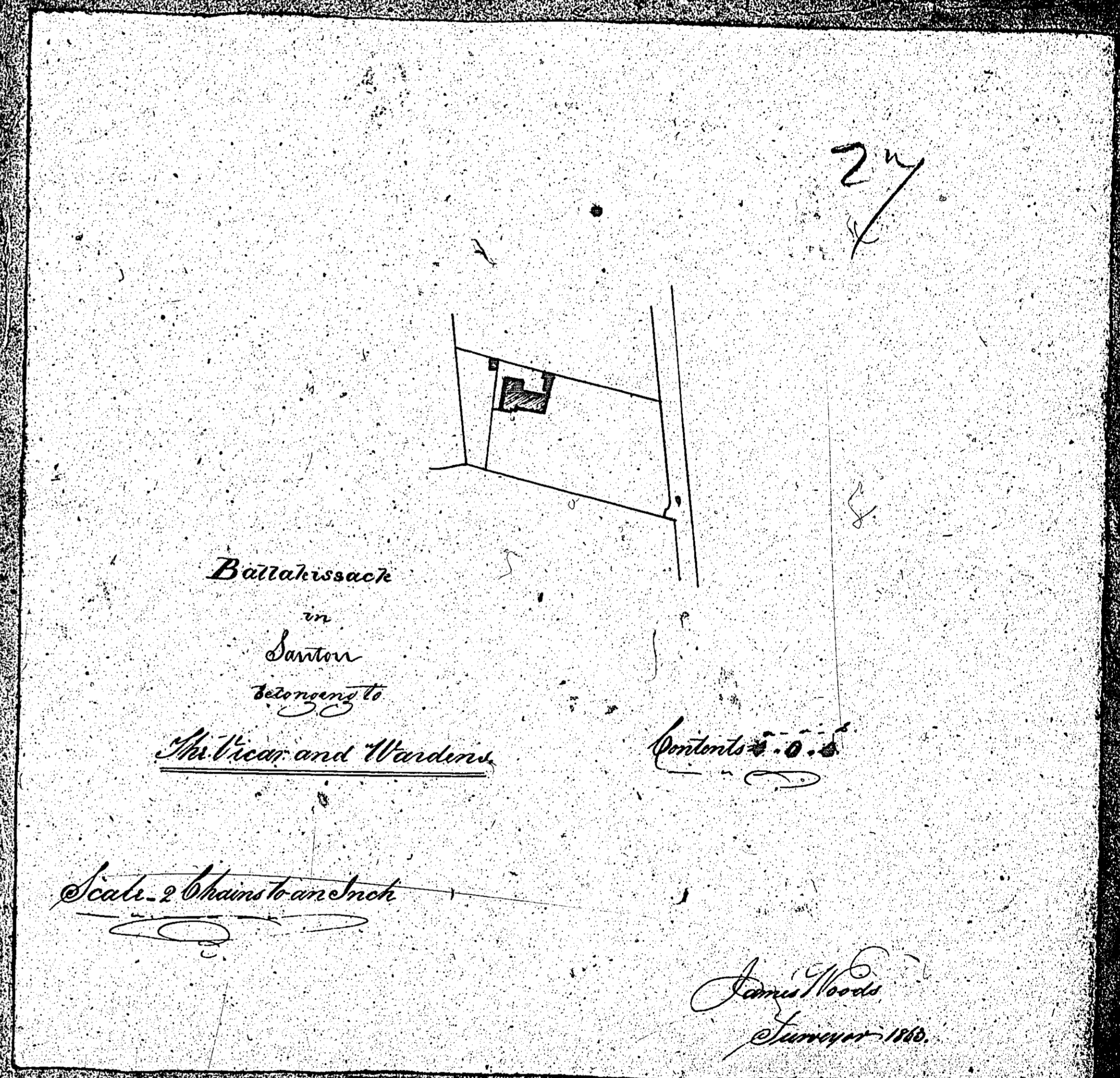



ISLE OF MAN GOVERNMENT: GENERAL REGISTRY

ASYLUM PLANS: PARISH OF SANTON

Original coloured

1:23

*Ballaun in Santon  
Belonging to F.B. Lucas Esq.*

*28*

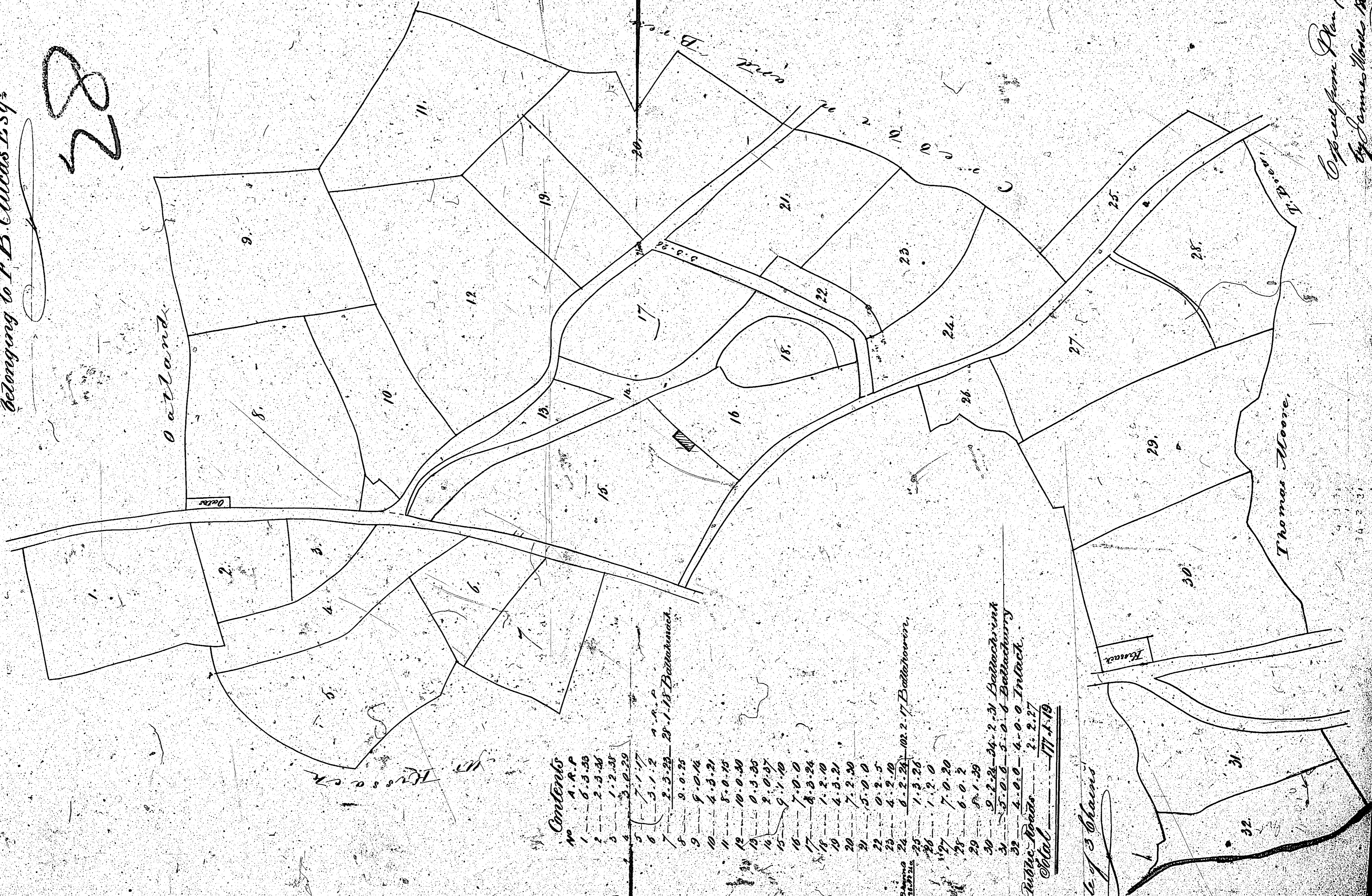

*Contents*

No	A.R.P.	A.R.P.
1	6.3.33	
2	2.3.35	
3	1.2.38	
4	3.0.29	
5	7.1.17	
6	3.1.2	
7	2.3.22	28.1.18 Ballinamuck
8	9.0.25	
9	9.0.16	
10	4.3.21	
11	5.0.15	
12	10.0.30	
13	0.3.30	
14	2.0.27	
15	9.1.10	
16	7.0.0	
17	4.3.24	
18	1.2.0	
19	4.3.21	
20	7.2.30	
21	5.0.0	
22	0.2.5	
23	4.2.10	
24	6.2.24	102.2.17 Ballinacree
25	1.3.26	
26	1.2.0	
27	7.0.20	
28	6.0.2	
29	8.1.39	
30	9.2.22	24.2.31 Ballinacree
31	5.0.6	5.0.6 Ballinacree
32	4.0.0	4.0.0 Intack
<i>Public Roads</i>		2.2.27
<i>Total</i>		177.1.13

*Scale of 3 Chains*

*Approved from Plan 71  
By James Moore 1853*



ISLE OF MAN GOVERNMENT: GENERAL REGISTRY

ASYLUM PLANS: PARISH OF SANTON

Original coloured

1:23

Plan and Survey  
of  
part of "Ballacurry",  
in the parish of Santon, Isle of Man.  
The property of Thomas Quinney.  
By Philip Mayhew.  
1862.

Samuel Jaggart

29

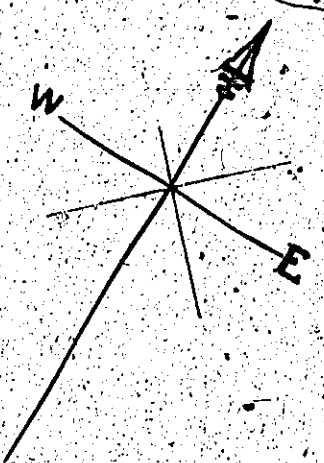

Contents.

No.	A.	R.	F.
1	1	0	14
2	1	0	16
Houses, Street & garden	0	0	12
Total of farm	2	1	2
one-half Highway	0	0	16
Grand Total	2	1	18

Captain Barry

Samuel Jaggart

Robert Moore

Scale. — 1 chain to an inch.