

ISLE OF MAN GOVERNMENT: GENERAL REGISTRY

ASYLUM PLANS: PARISH OF ONCHAN

Originals monotone

1:23

Callabroie
CALLED
Priory
In Onchan
belonging to
Rev. E. Forbes

227

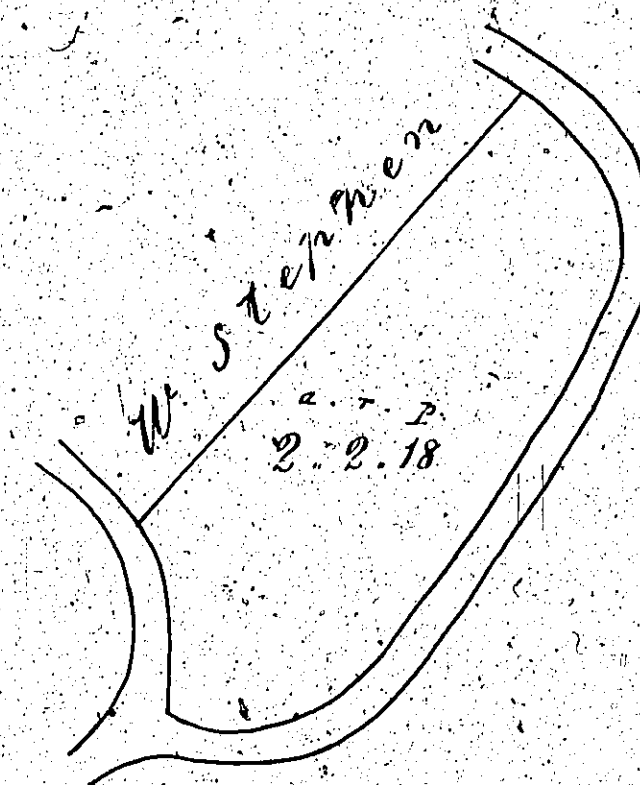

Contents 2.2.18

Scale

2 1/2 Chains to an Inch.

Copied from Sir H. Clerk's Plan N. 9.
By James Woods, 1862.

Callabroie.
CALLED
Eagle Hurst
in
Onchan
belonging to
William Stephen Esq.

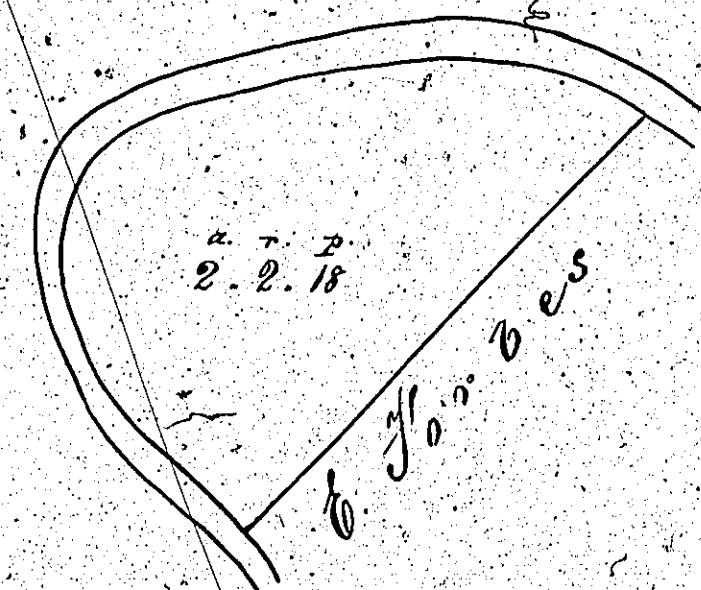

Contents 2.2.18

Scale

2 1/2 Chains to an Inch.

Copied from Sir H. Clerk's Plan N. 9.
By James Woods
Surveyor 1862.

ISLE OF MAN GOVERNMENT: GENERAL REGISTRY
 ASYLUM PLANS: PARISH OF ONCHAN

Original coloured

1:23

PLAN

OF PART OF

LAND OF BALLAKERMEN,
 PARISH OF ONCHAN,
 QUARTERS

situate in the

PROPERTY OF

James Bell Esq.

Decr 4th 1862

229

MOUNT VERNON.

N^o 66.

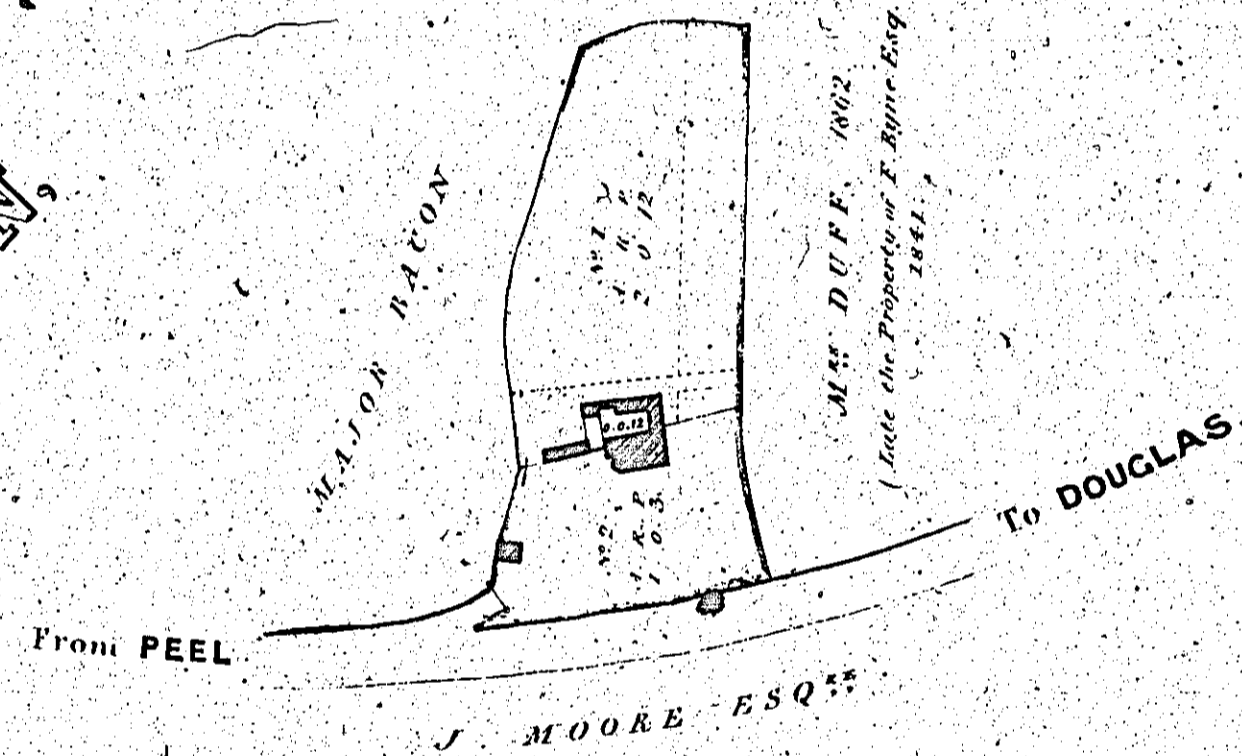

CONTENTS.

No 1	10	12
2 Garden	1	3
Yard &c.	1	10
Total Area	3	10 24

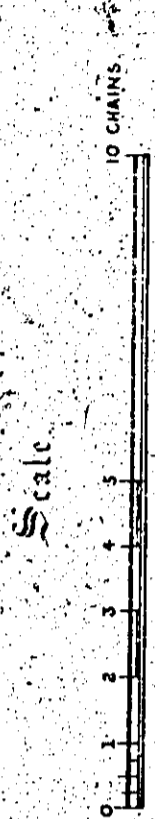

Joseph Blake - Surveyor.

Copyright by Henry G. Burt, C. E.

Woods 1862

ISLE OF MAN GOVERNMENT: GENERAL REGISTRY

ASYLUM PLANS: PARISH OF ONCHAN

Originals monotone

1:23

Meadows in Conchan
belonging to Jno. Moore Esq

230

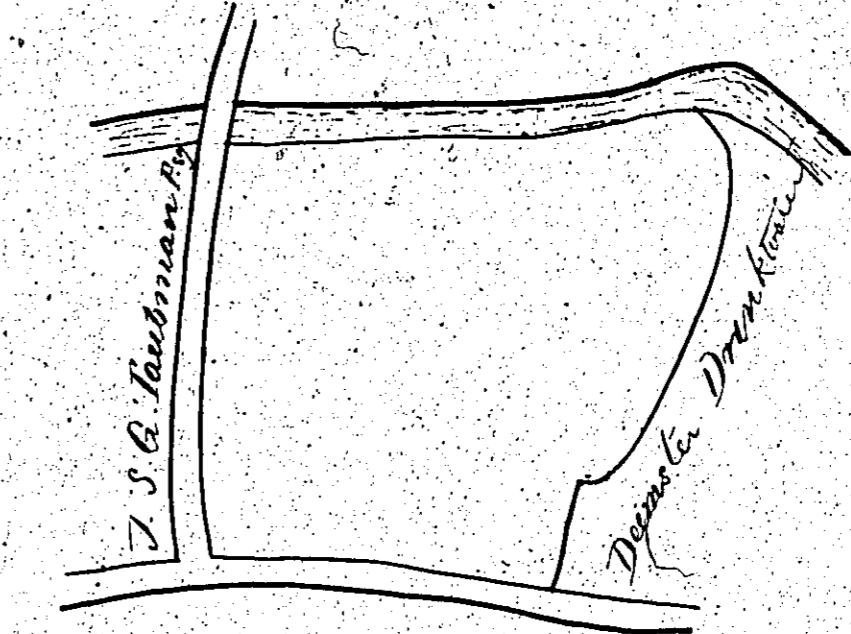

Scale 3 Chains

Content 7.2.24

Copied from plan 105 by
Woods 1864

Ballabroie in Conchan
belonging to J. Adamson Esq

231

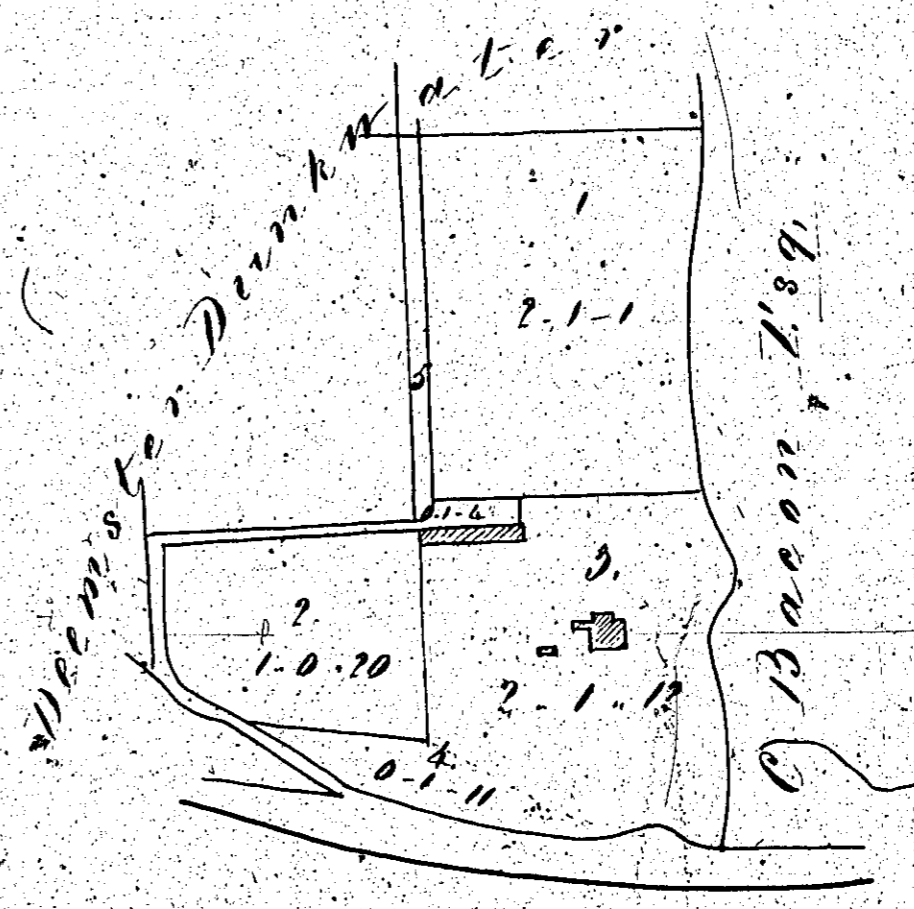

Scale 3 Chains

Content 6.1.8

Copied from plan 105 by
Woods 1864

ISLE OF MAN GOVERNMENT: GENERAL REGISTRY

ASYLUM PLANS: PARISH OF ONCHAN

Original monotone

1:23

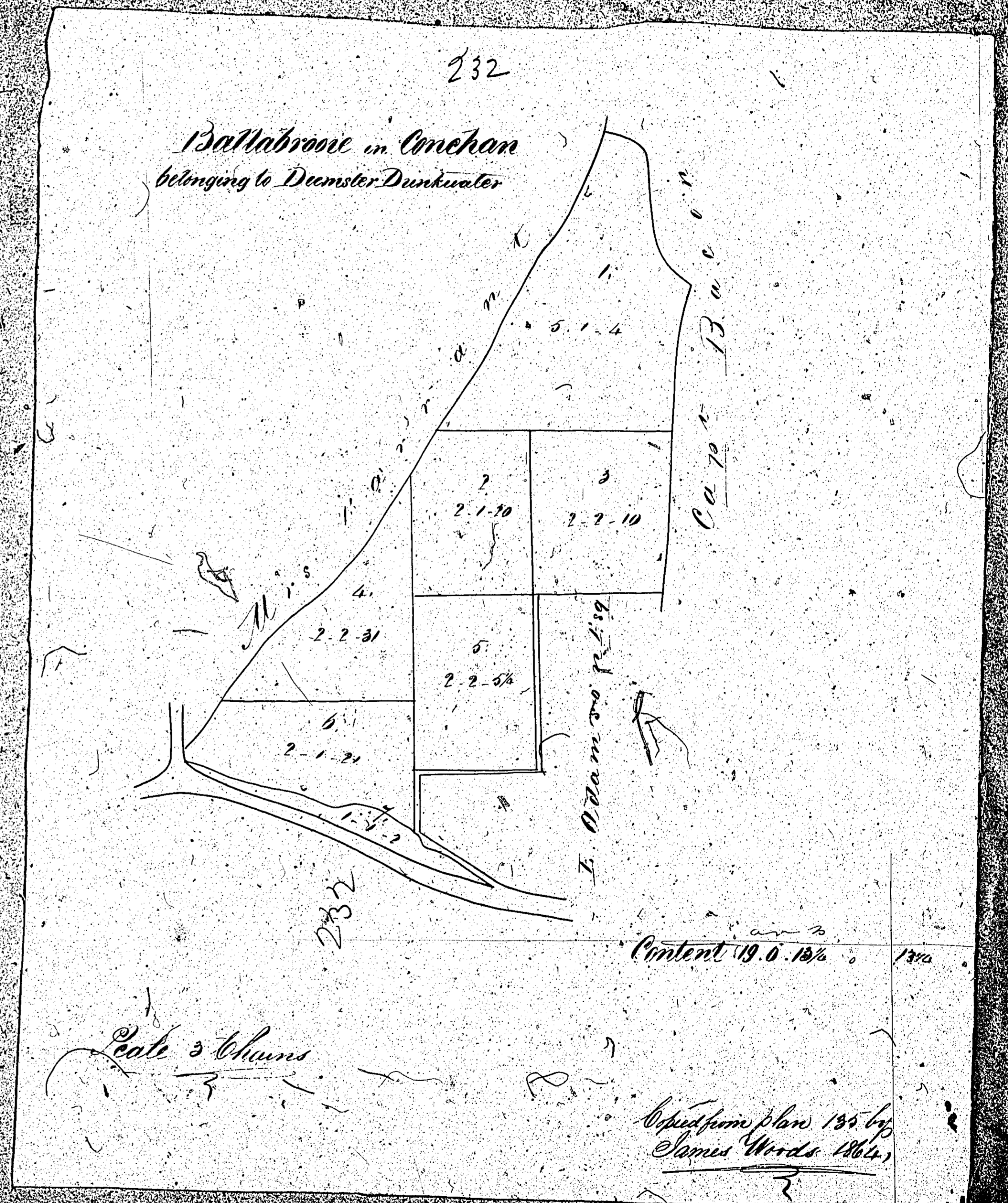

Plan 235 is bound
out of sequence
with plan 234

ISLE OF MAN GOVERNMENT: GENERAL REGISTRY
ASYLUM PLANS: PARISH OF ONCHAN

- 233 Original coloured
- 235 Original monotone

1:23

