

ISLE OF MAN GOVERNMENT: GENERAL REGISTRY

ASYLUM PLANS: PARISH OF ONCHAN

Original coloured

1:23

*Plan of Onchan*

*Plan*  
of  
*Castle Gill*  
in the parish of Onchan  
THE PROPERTY OF  
WILLIAM HALL ESQ.

128

Contents: A. R. P.  
2.0.25

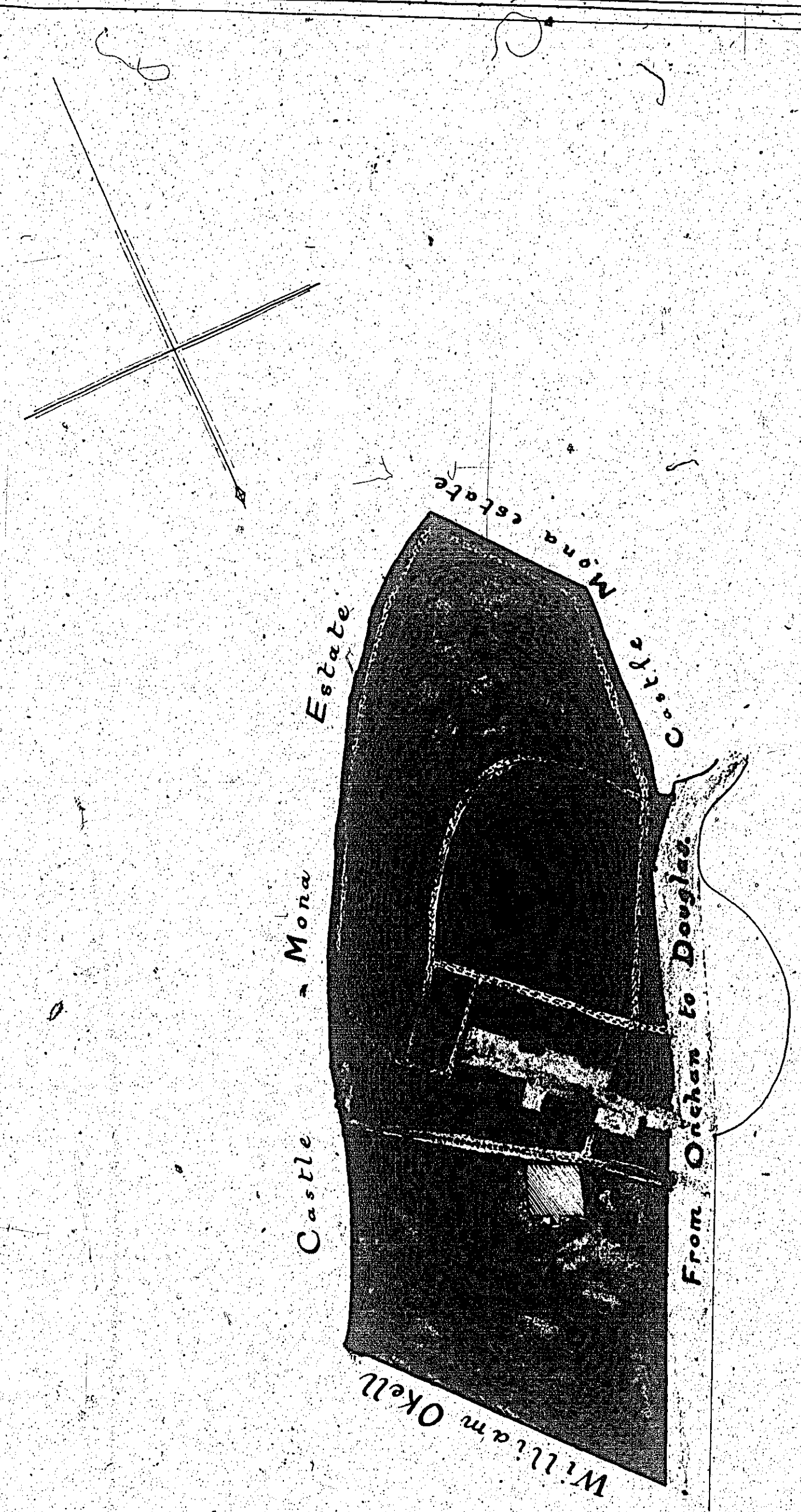

*C. M. Wood*  
*Douglas*  
*7 September 1863*

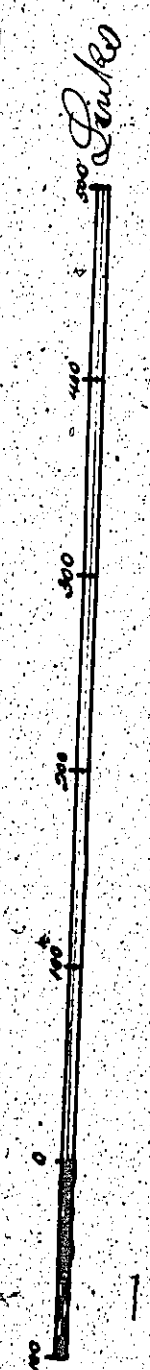

*Copied from plan 82 of*  
*Map 1864*



ISLE OF MAN GOVERNMENT: GENERAL REGISTRY

ASYLUM PLANS: PARISH OF ONCHAN

1:23

- 129 Original coloured (decorative)
- 130 Original monotone

Property in Onchan  
belonging to Sam<sup>l</sup> Harris Esq<sup>r</sup>

129

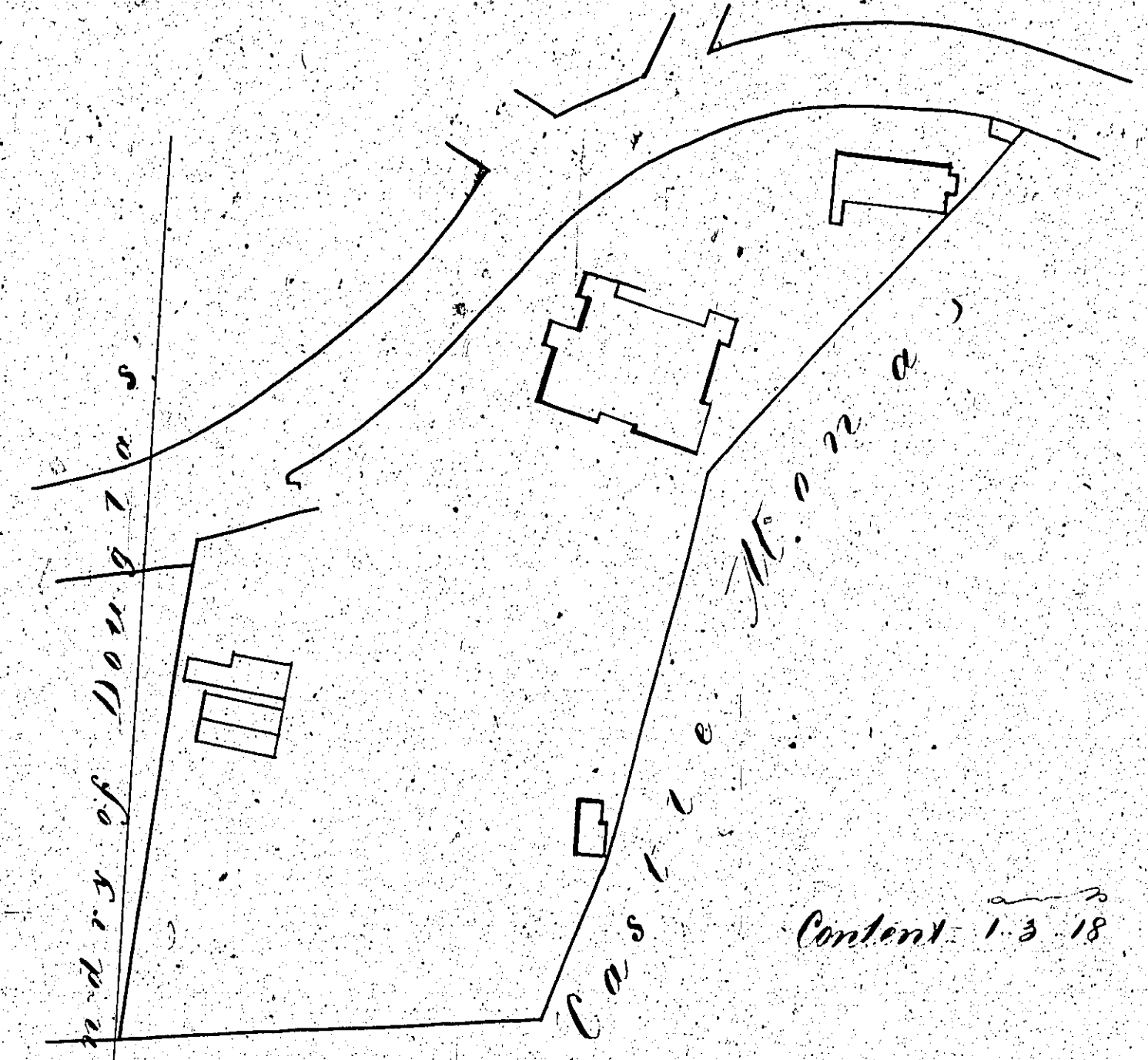

Scale 1 Chain

Copied by  
Samuel Woods 1864

Battaquarte in Onchan  
belonging to S. M. Dumbell Esq.

130

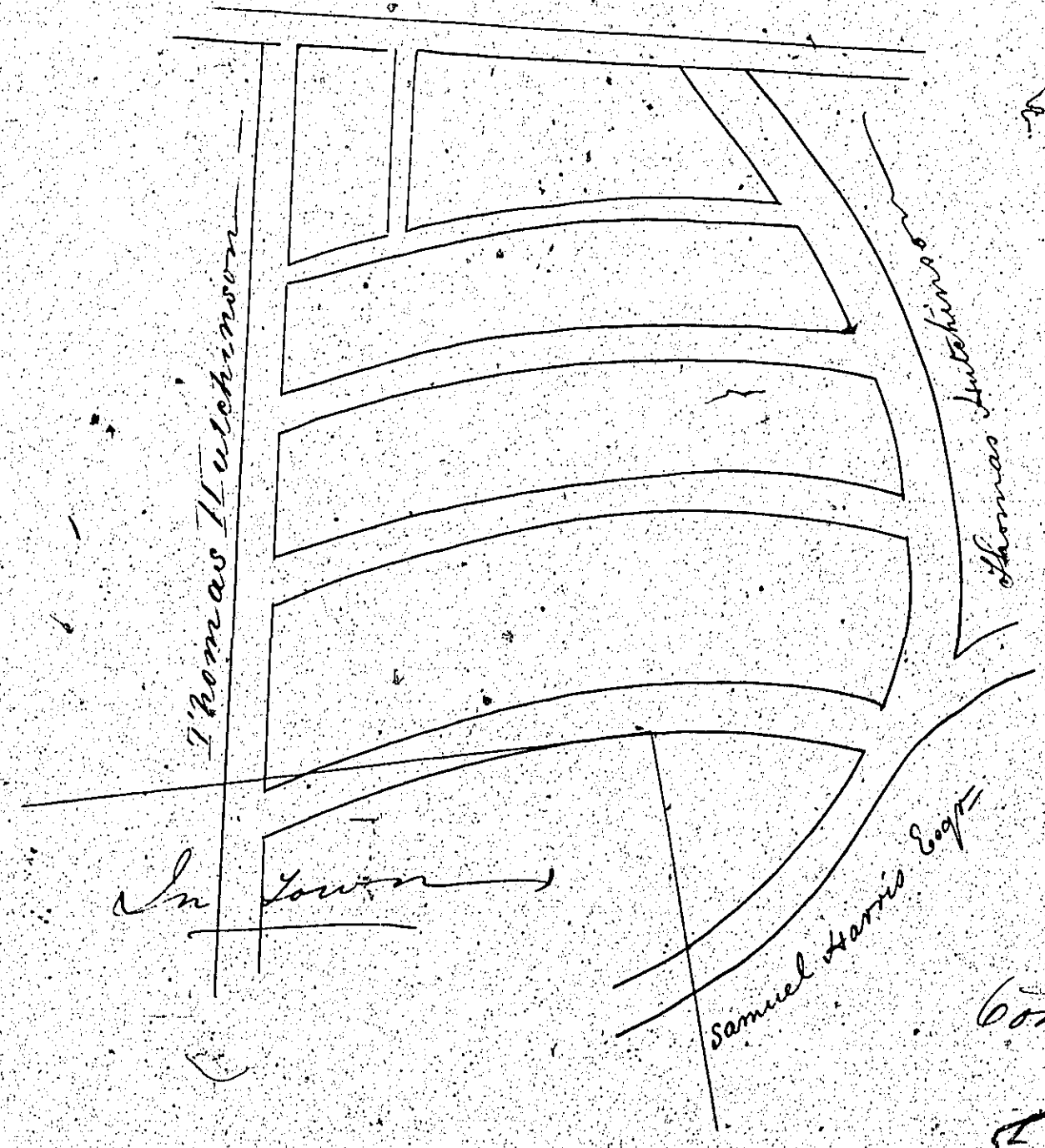

Scale 2 Chains

Content 6-3-20

Copied from plan 82 by  
Woods 1864



ISLE OF MAN GOVERNMENT: GENERAL REGISTRY

ASYLUM PLANS: PARISH OF ONCHAN

Original monotone

1:23

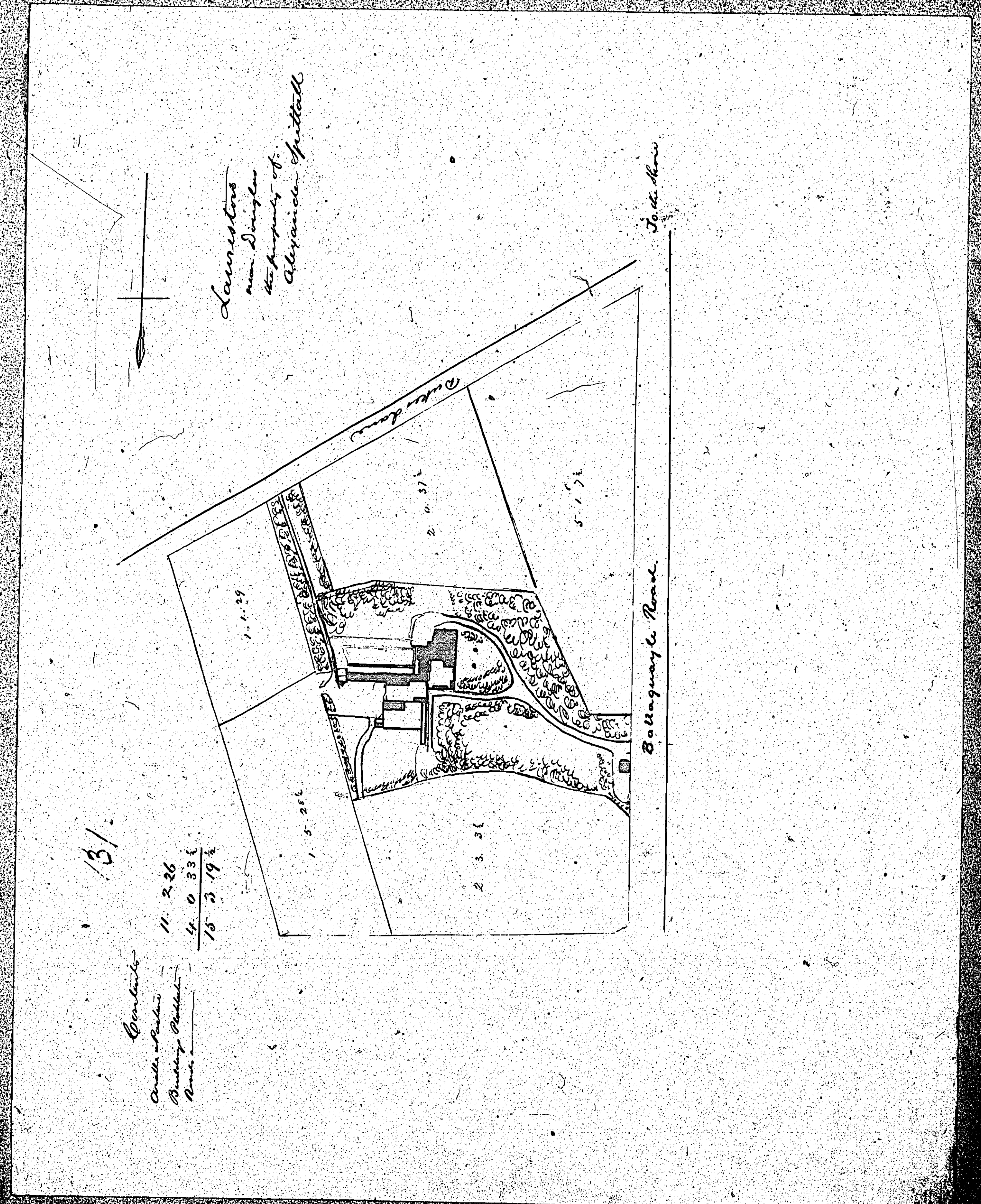



ISLE OF MAN GOVERNMENT: GENERAL REGISTRY

ASYLUM PLANS: PARISH OF ONCHAN

Original monotone

1:23

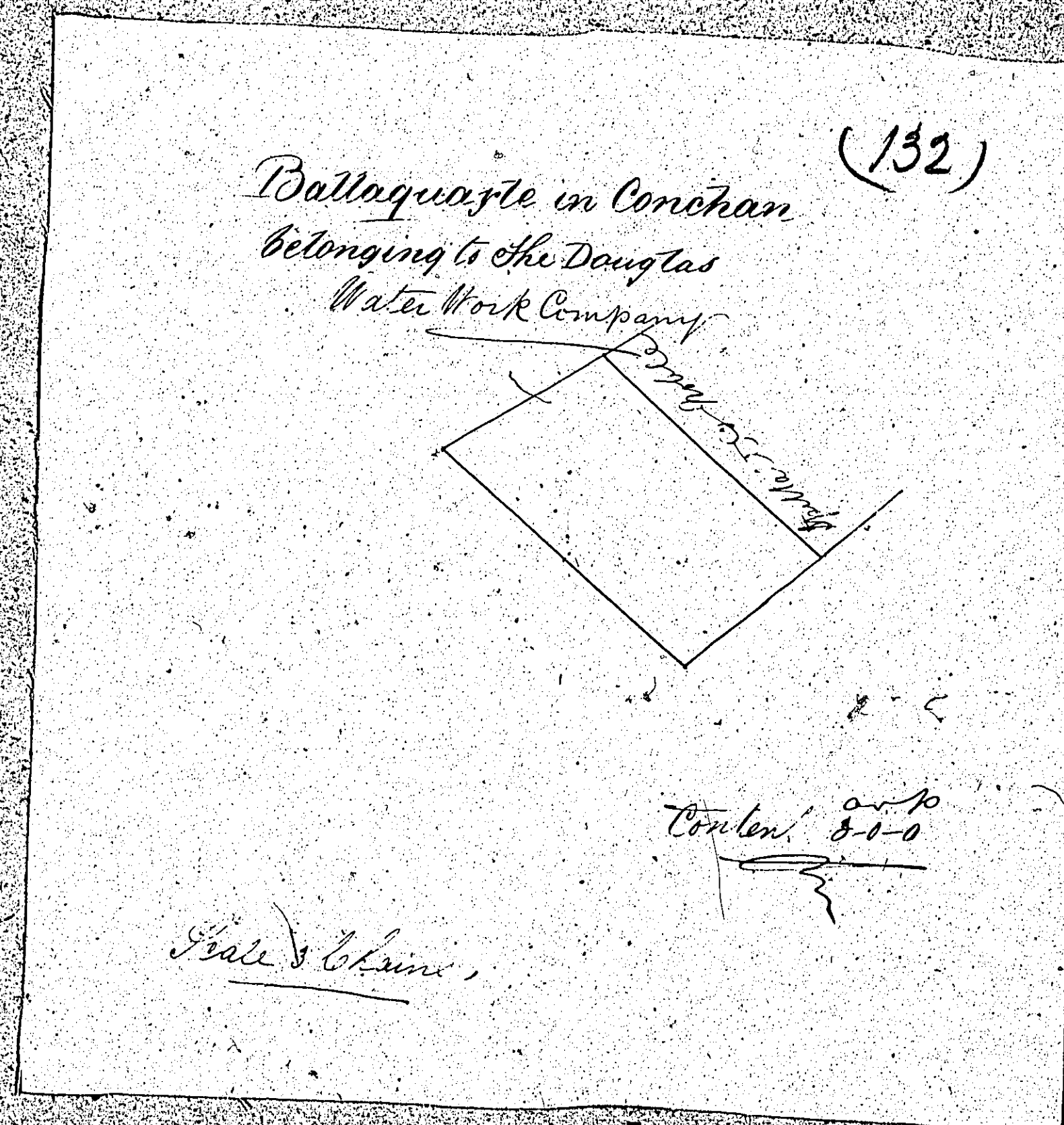



ISLE OF MAN GOVERNMENT: GENERAL REGISTRY

ASYLUM PLANS: PARISH OF ONCHAN

Original monotone

1:23

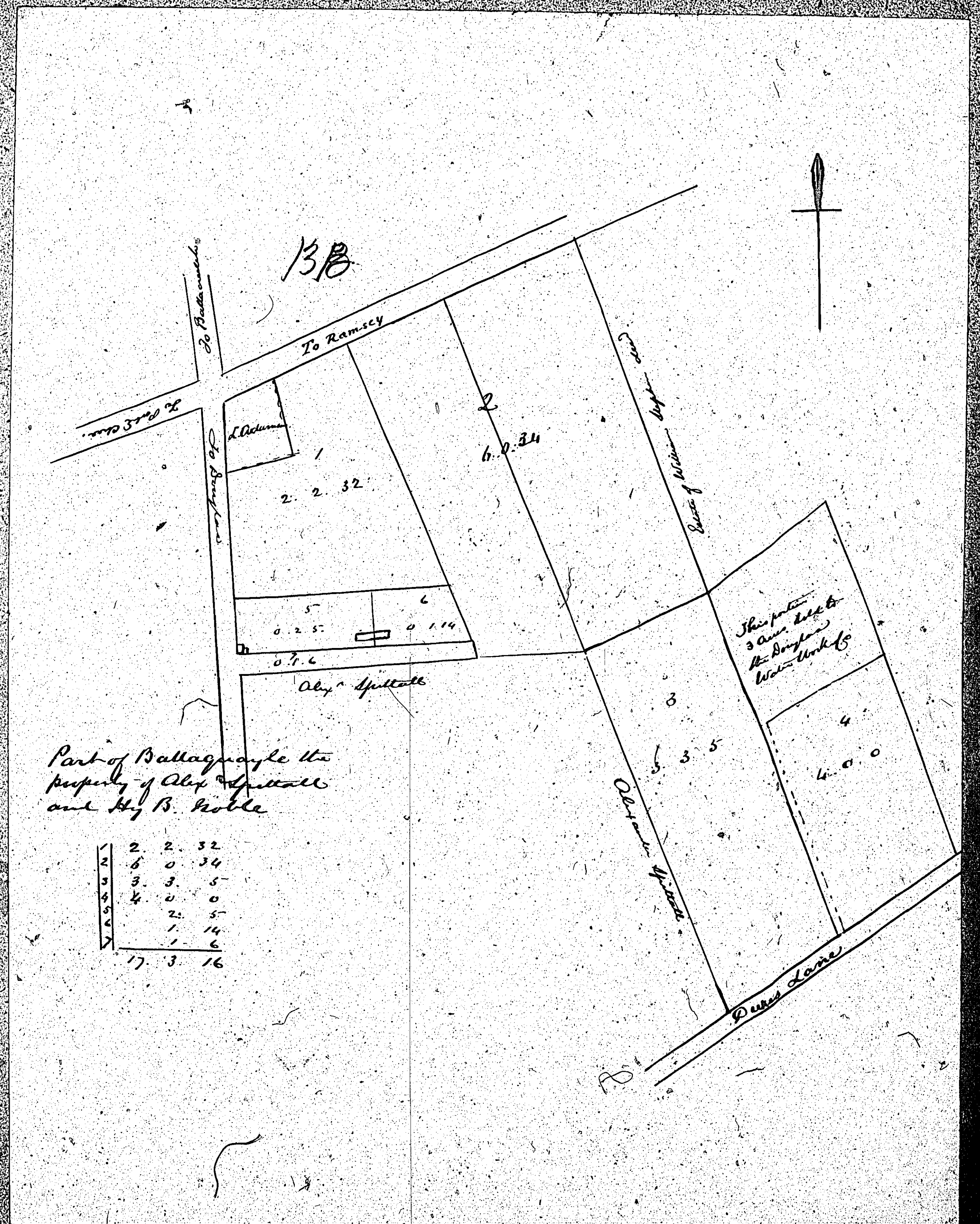



The following plan  
is not numbered

ISLE OF MAN GOVERNMENT: GENERAL REGISTRY

ASYLUM PLANS: PARISH OF ONCHAN

Original monotone

1:23

