

ISLE OF MAN GOVERNMENT: GENERAL REGISTRY

ASYLUM PLANS: PARISH OF ONCHAN

Originals monotone

1:23

190

Dalloquyte in Conchan
belonging to

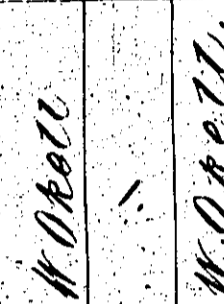
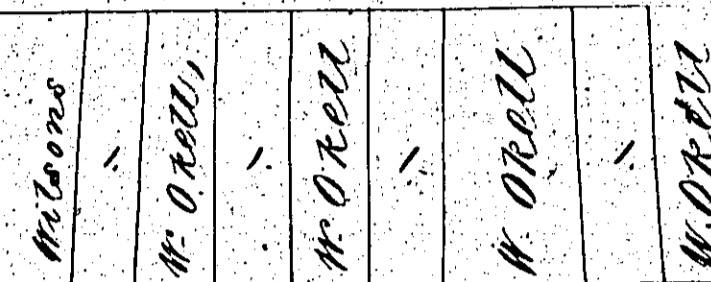
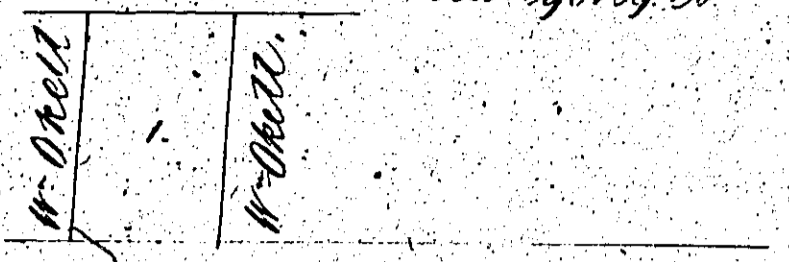

Content ¹⁰ 0-1-20

Scale line chain

*Copied from plan 82
by James Woods Esq.*

Glencrutchery in Conchan
belonging to *G. W. Dumbell Esq.*

(121)

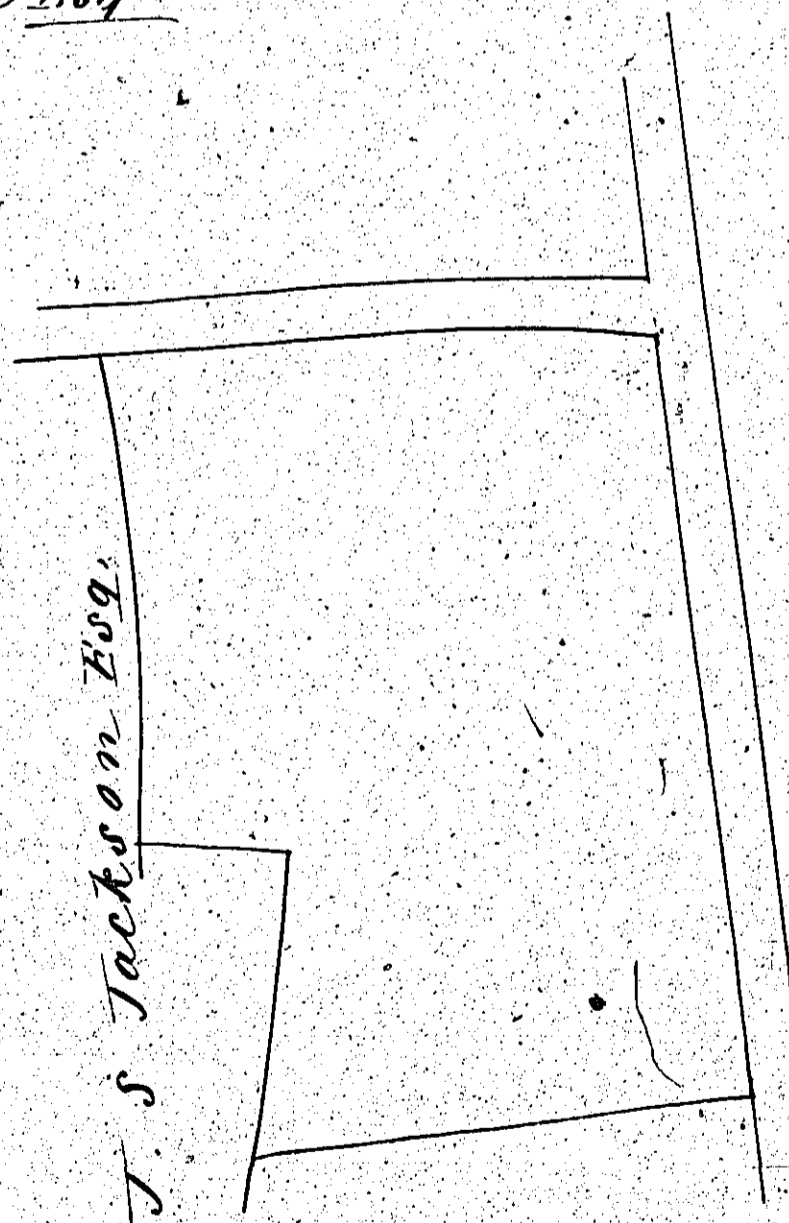

Scale & chains

Content ^{avp} 4-2-12

*Copied from plan 82 by
James Woods Esq.*

There is a second plan
numbered 121
on the following page

ISLE OF MAN GOVERNMENT: GENERAL REGISTRY
ASYLUM PLANS: PARISH OF ONCHAN

Originals monotone

1:23

2m-121
Pitencrutchery in Onchan
belonging to Richd. Tolson's Ors.

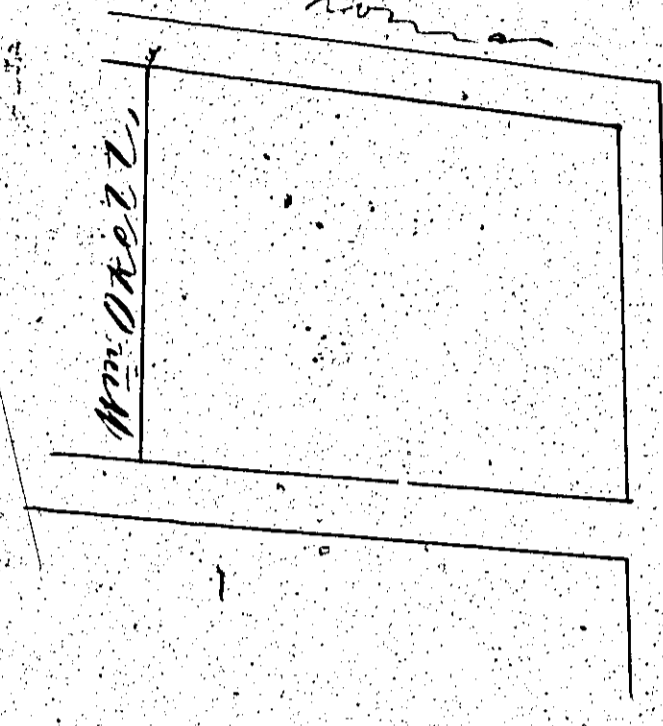

Content 1.3.36

Scale 2 chains

Copied from plan 82
by Wood 1864

122
Ballequarie in Onchan
belonging to Mr Lees

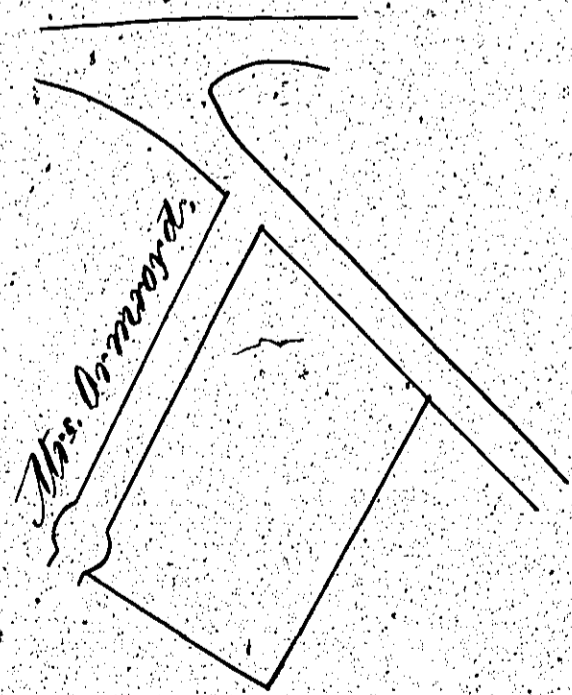

Contents 0.3.25

Scale 2 chains

Copied from plan 82
by Wood 1864

ISLE OF MAN GOVERNMENT: GENERAL REGISTRY
ASYLUM PLANS: PARISH OF ONCHAN

Original monotone

1:23

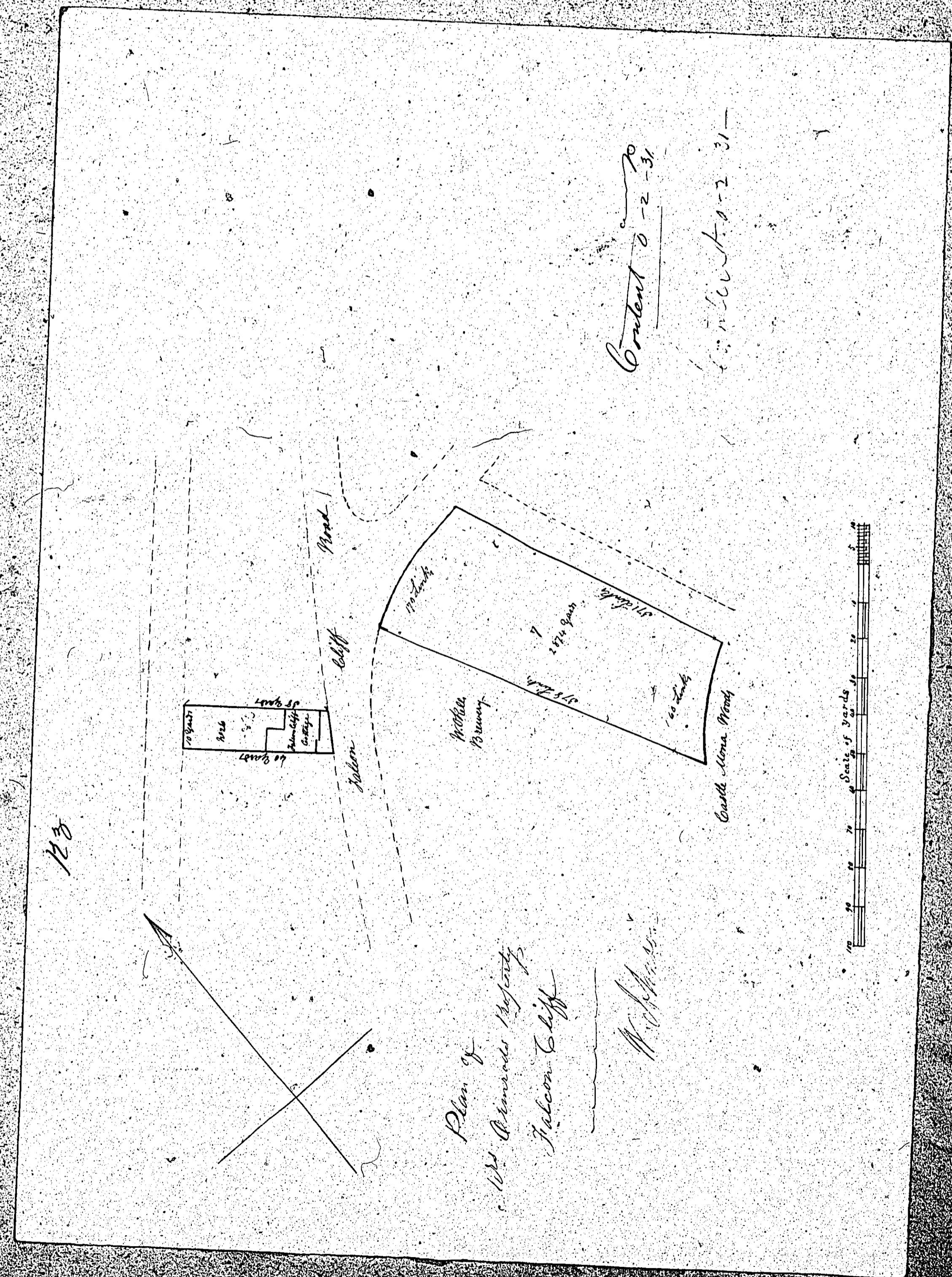

ISLE OF MAN GOVERNMENT: GENERAL REGISTRY
ASYLUM PLANS: PARISH OF ONCHAN

Original coloured

1:23

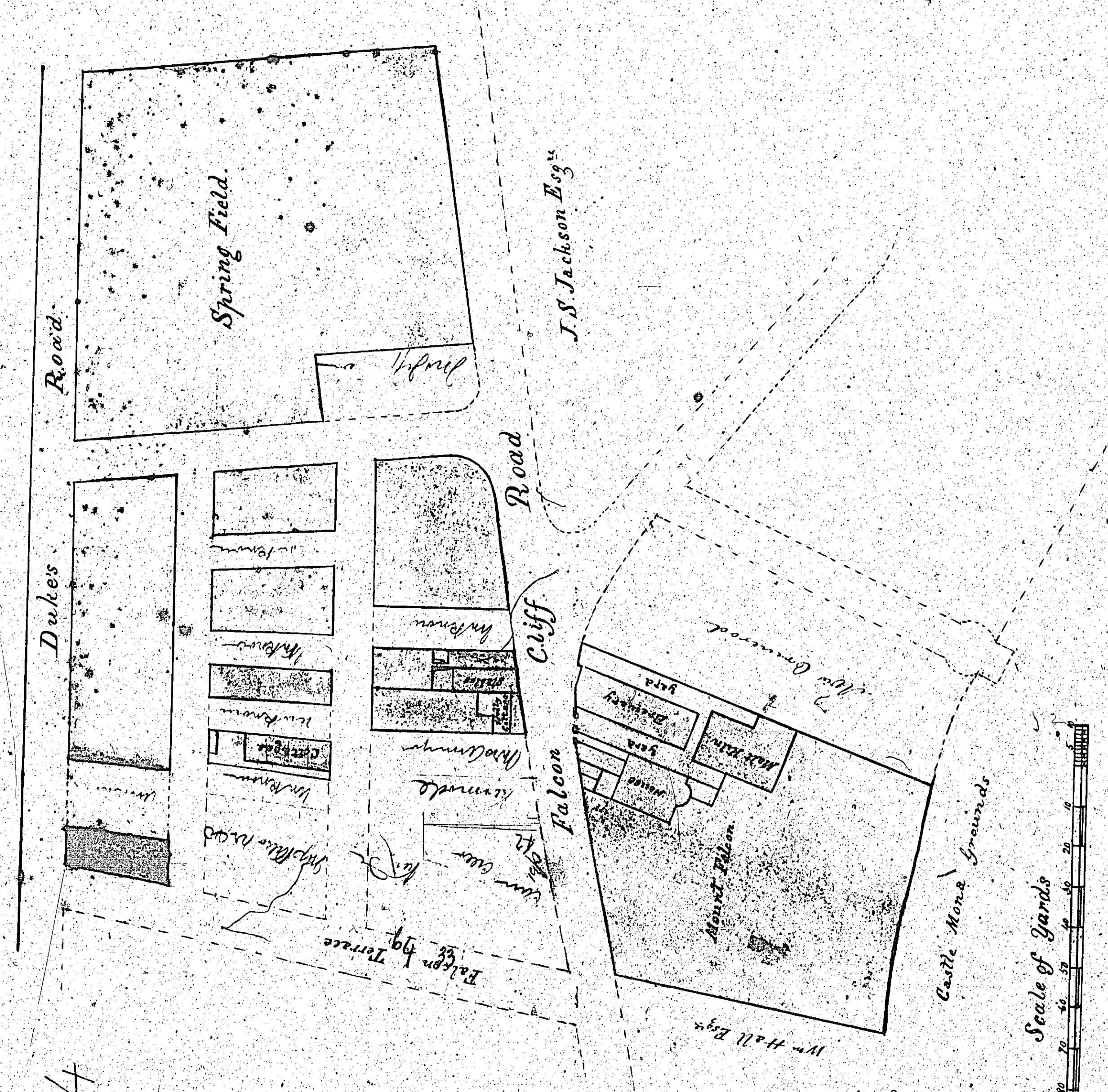

124

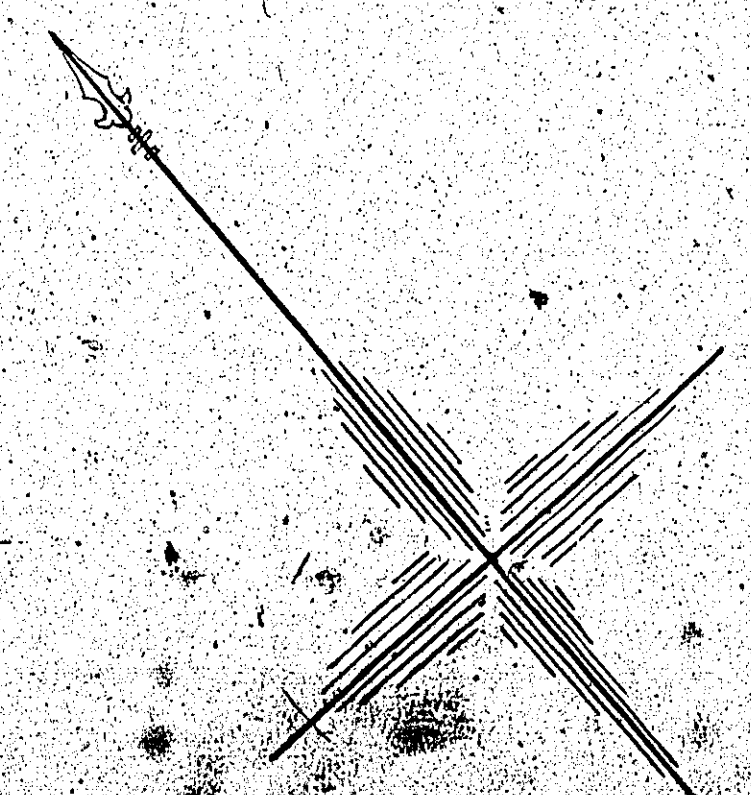

PLAN
OF
Property at Falcon Cliff
IN THE PARISH OF ONCHAN
Belonging to MR WILLIAM O'KELL.
AREA (United) FOUR STATUTE ACRES.
W. Johnson

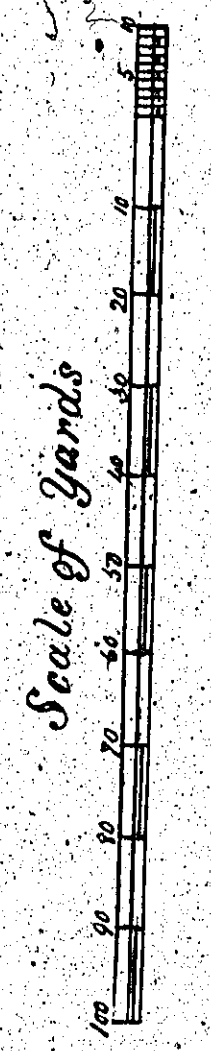

The following three
plans are also
numbered

124

ISLE OF MAN GOVERNMENT: GENERAL REGISTRY

ASYLUM PLANS: PARISH OF ONCHAN

Originals monotone

1:23

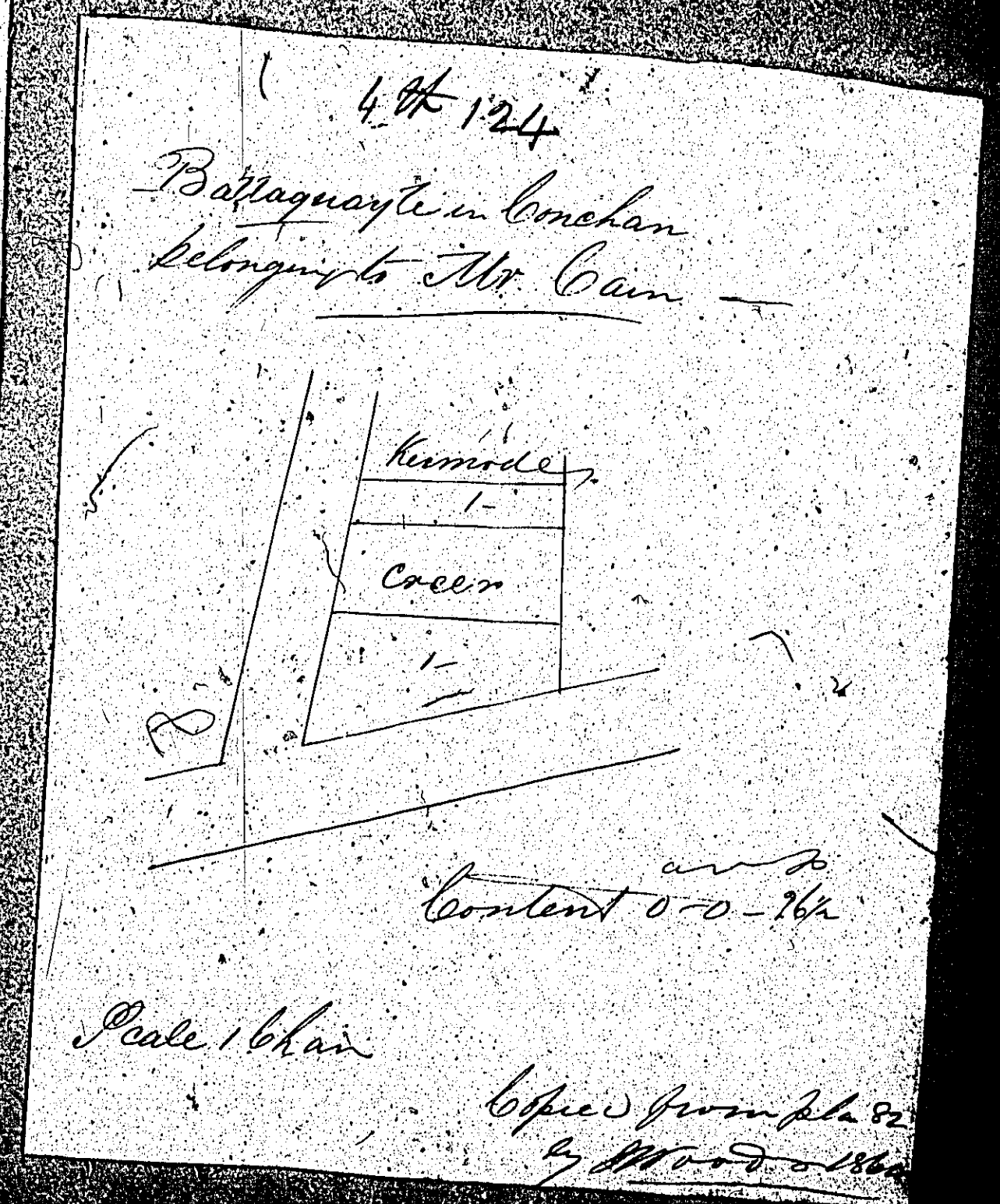
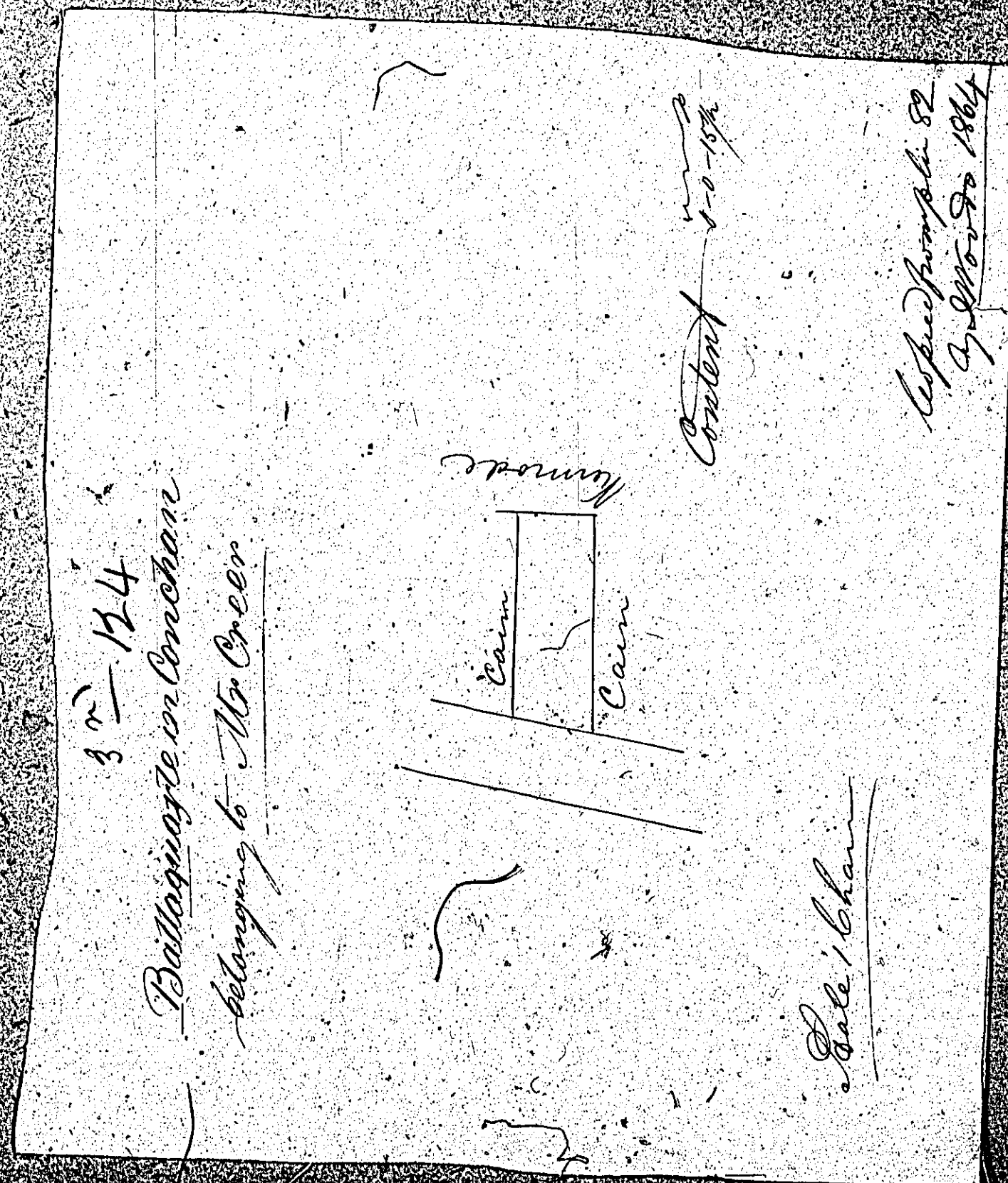
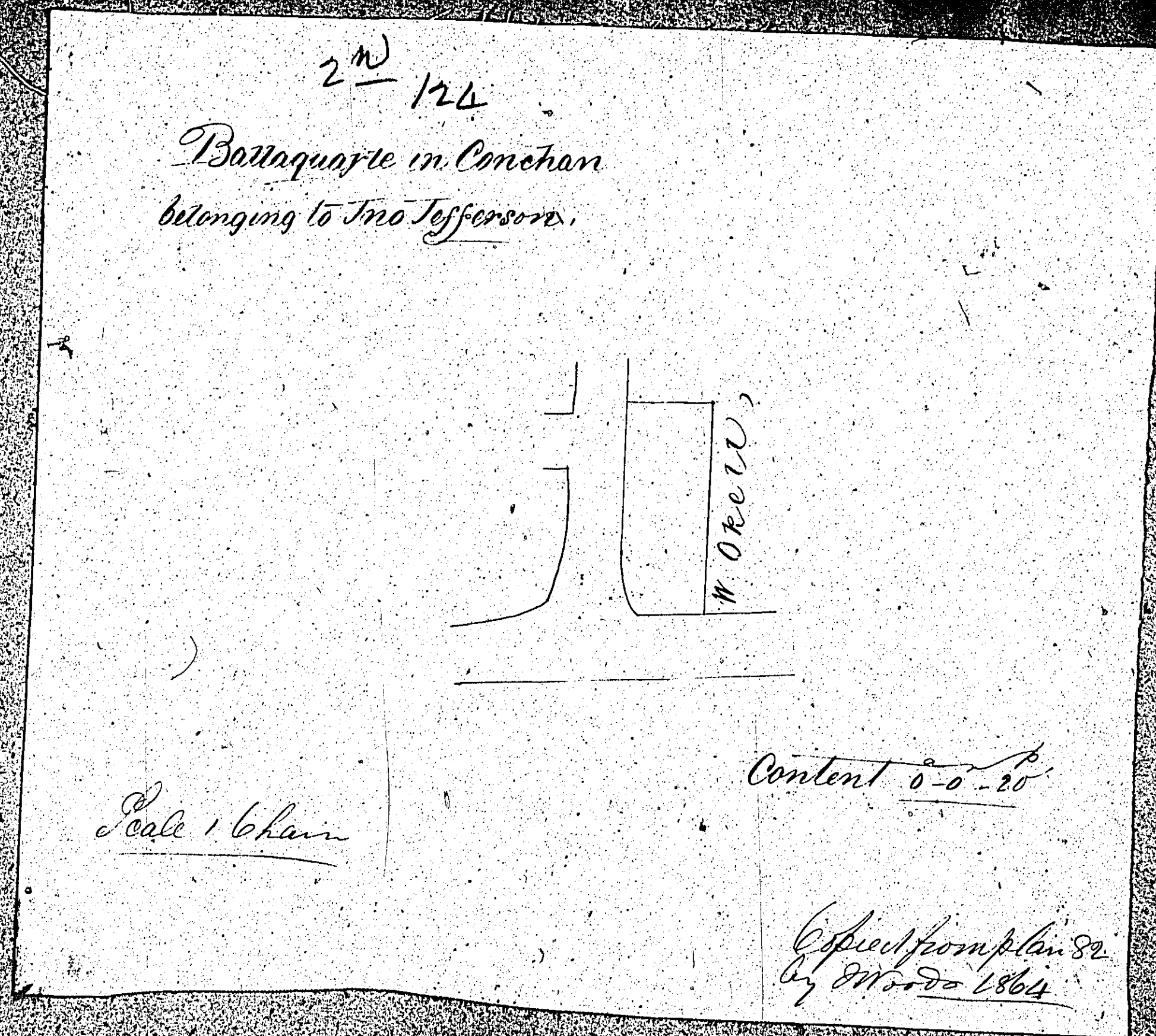

ISLE OF MAN GOVERNMENT: GENERAL REGISTRY

ASYLUM PLANS: PARISH OF ONCHAN

Originals monotone

1:23.

