

ISLE OF MAN GOVERNMENT: GENERAL REGISTRY

ASYLUM PLANS: PARISH OF ONCHAN

Original monotone

1:23

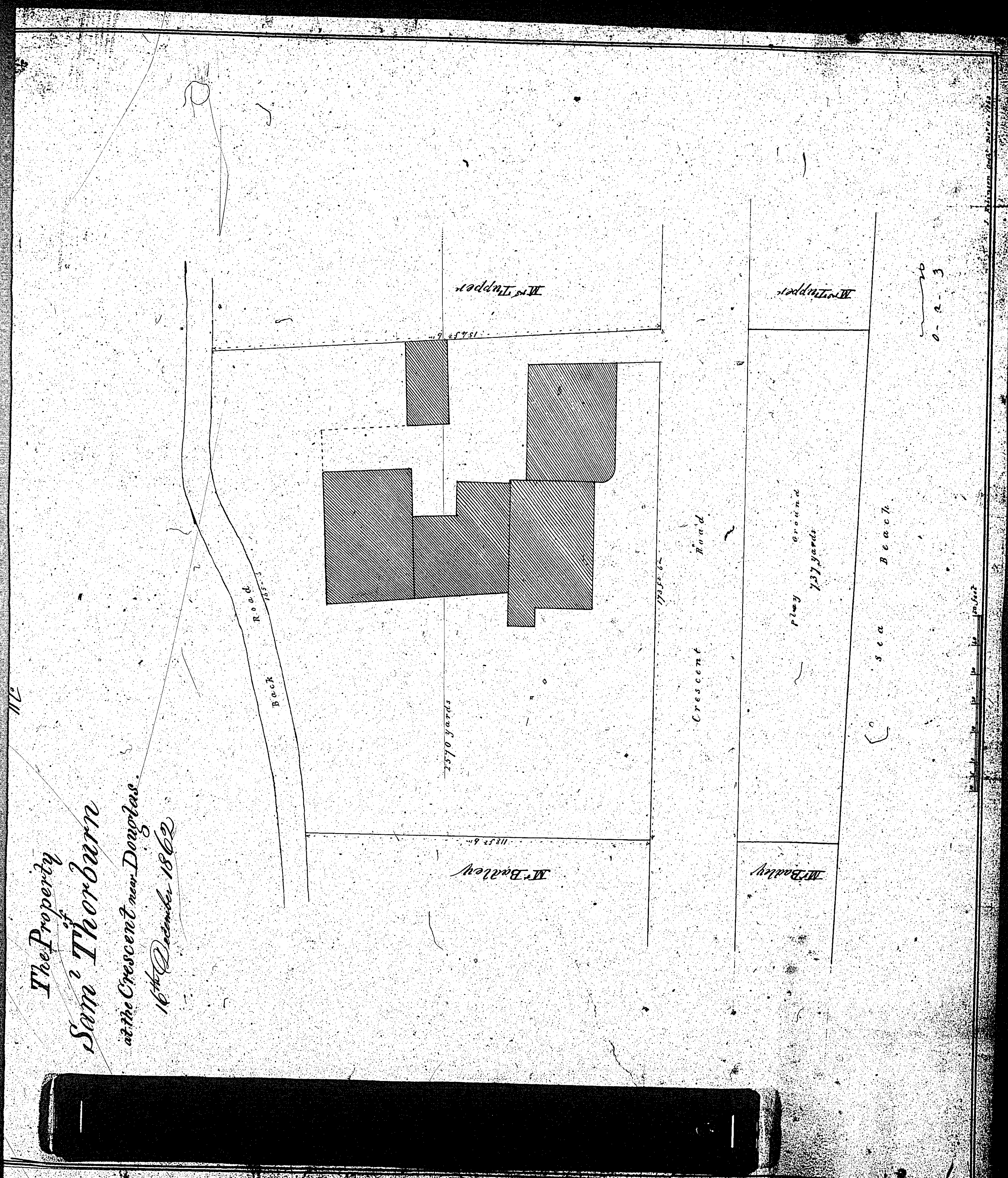

112
The Property
of
Saml Thorburn
at the Crescent near Douglas.
16th December 1862



Generators in Conchan
belonging to Mr. Biddleley

(113)

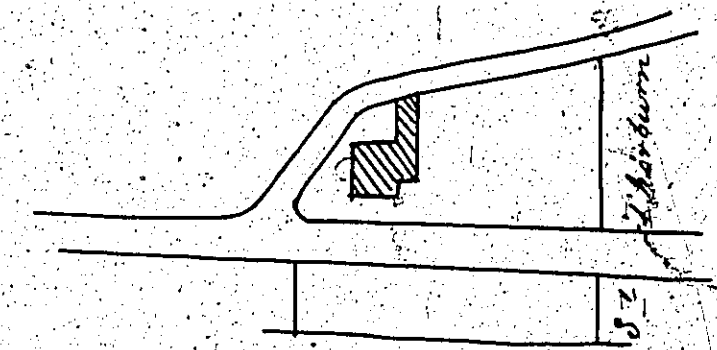

Scale 2 chains

Content 0-2-5

Words 1864

Dumbell

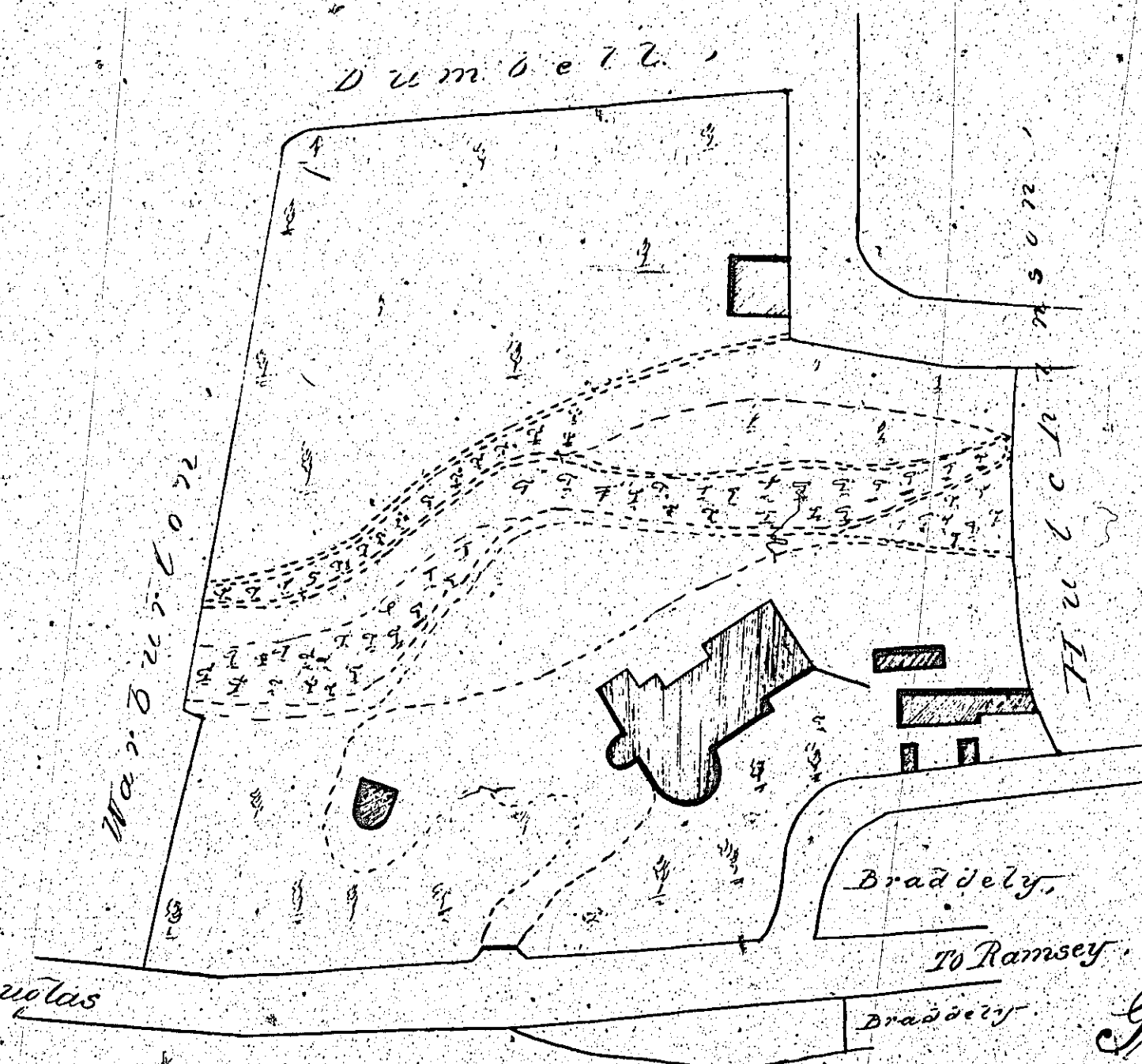

114

Contents 2.2.2

Scale 1 Chain to an Inch

Generators
in
Conchan
belonging to
Richd. Simpson Esq.

Deposited from J. Paris survey for
values of Land under the
Statute Act by J. Words 1864

ISLE OF MAN GOVERNMENT: GENERAL REGISTRY

ASYLUM PLANS: PARISH OF ONCHAN

1:23

115 Original monotone

116 Original coloured (decorative)

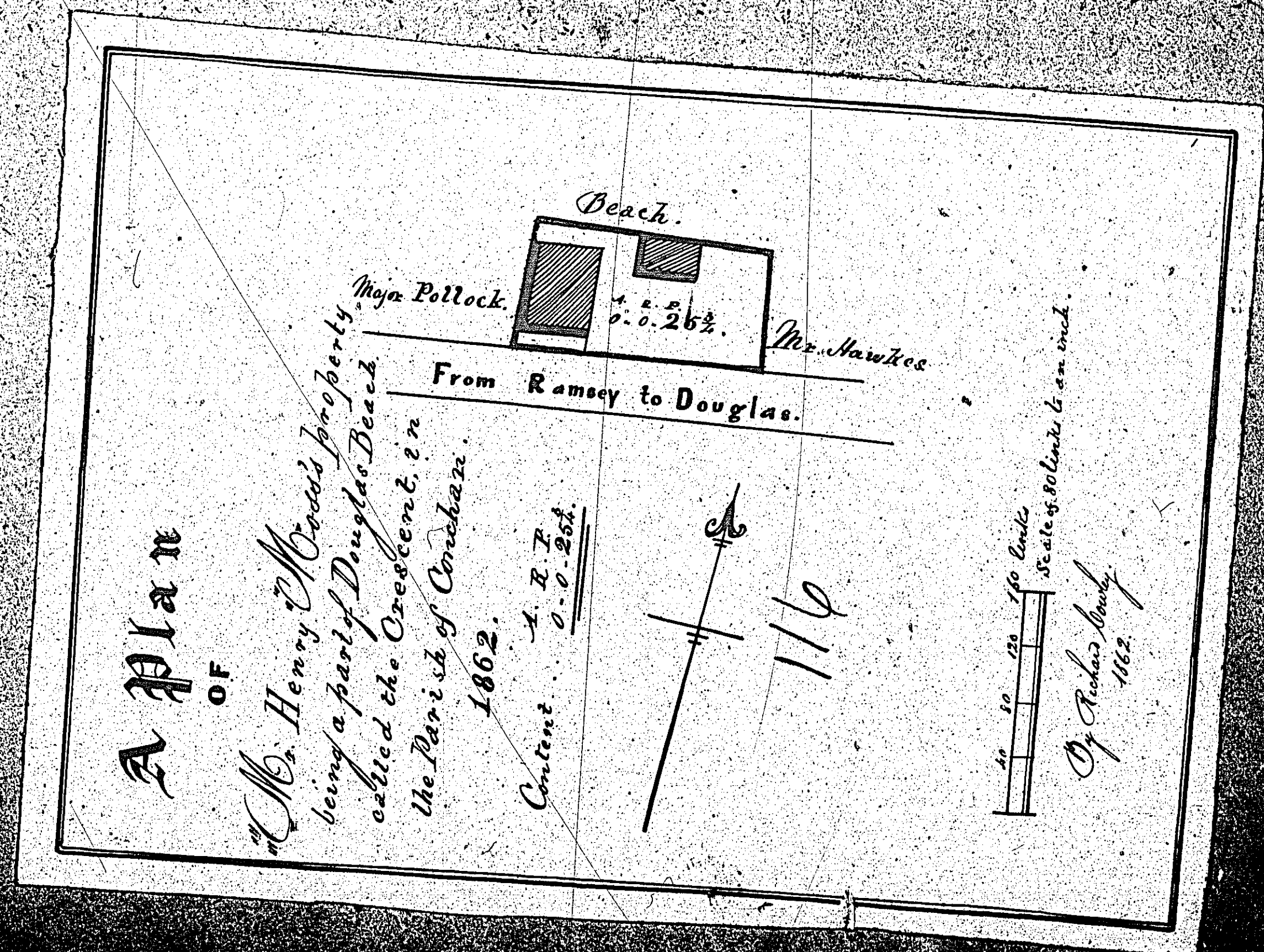
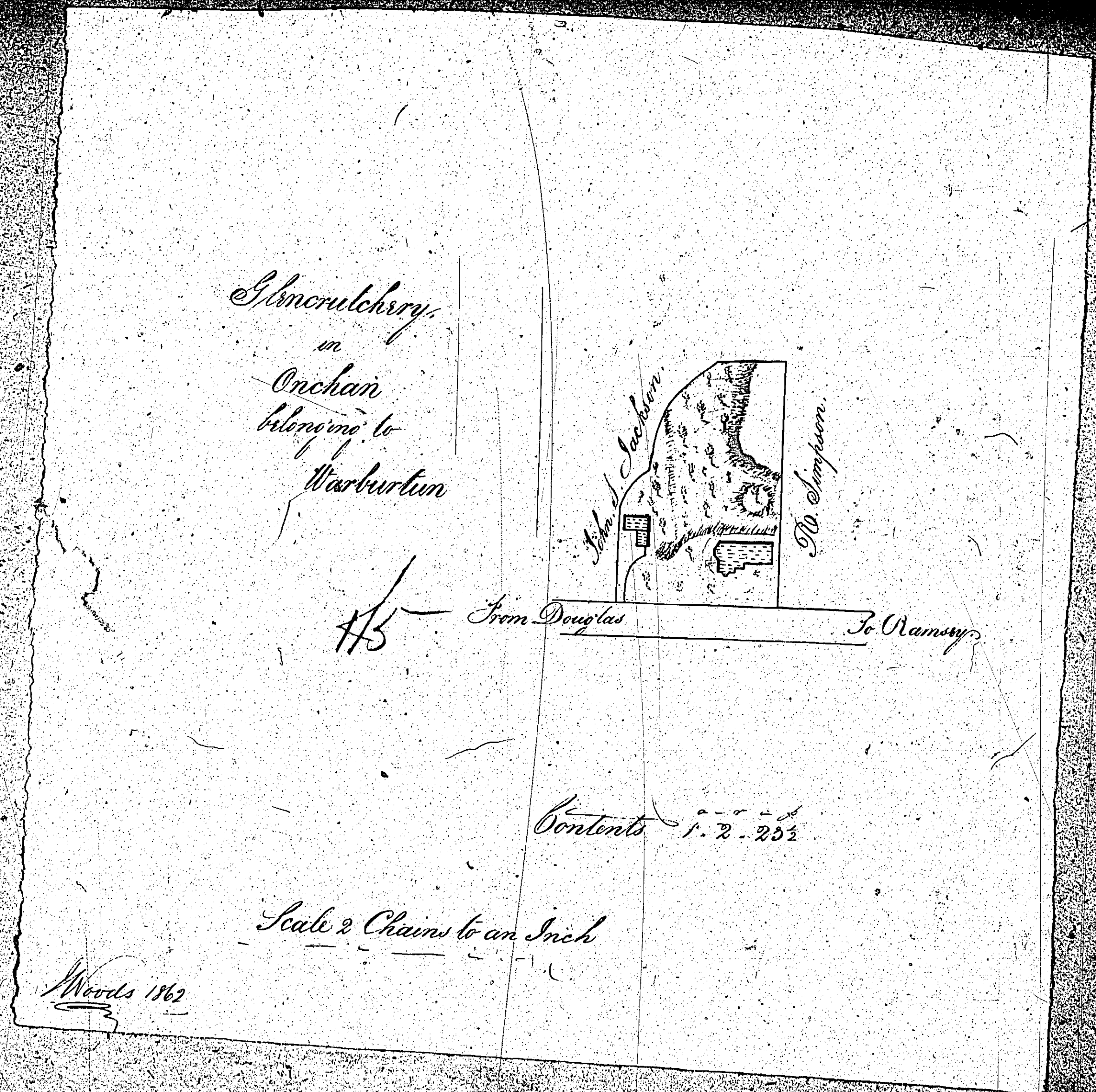

ISLE OF MAN GOVERNMENT: GENERAL REGISTRY

ASYLUM PLANS: PARISH OF ONCHAN

Original monotone

1:23

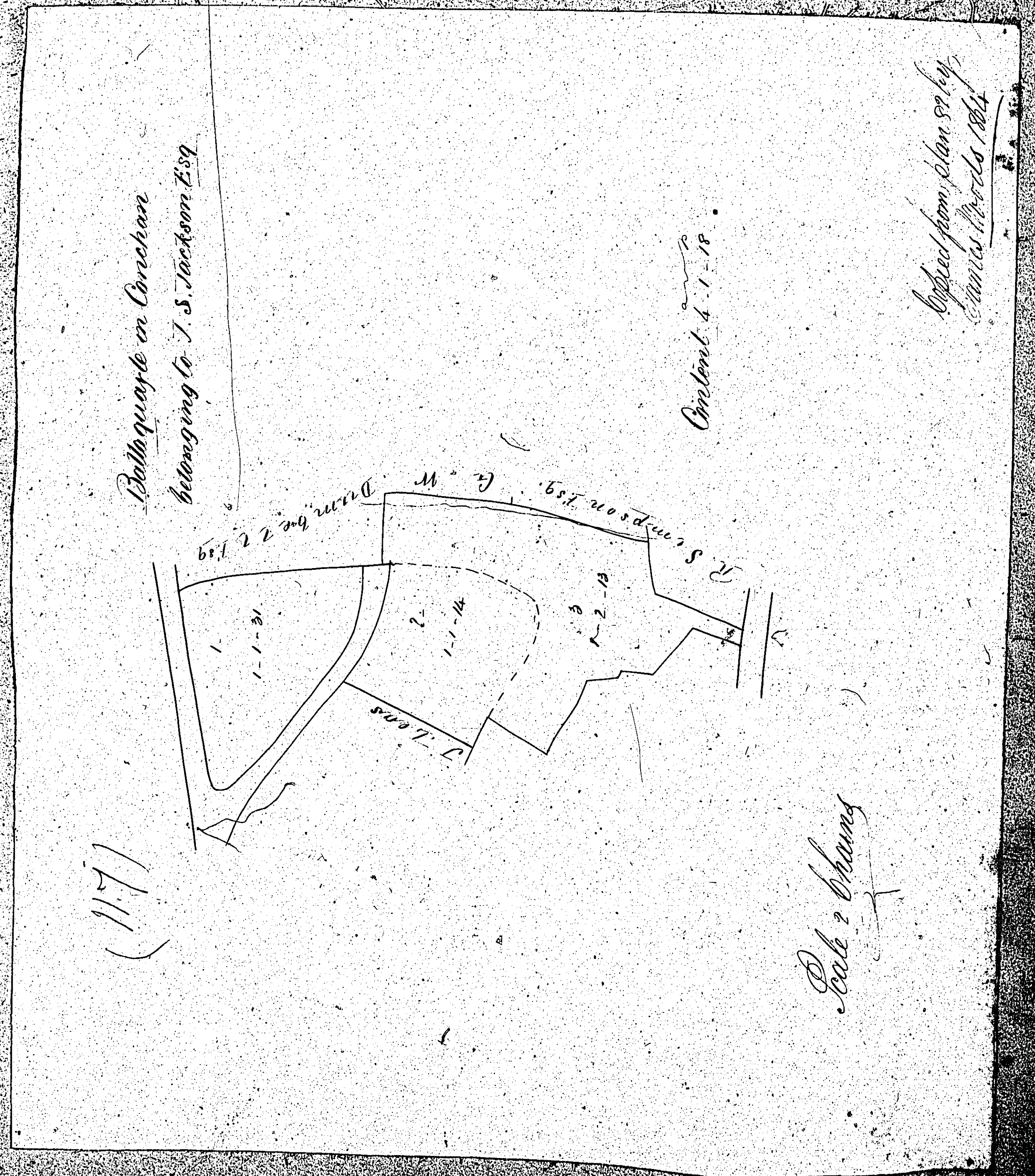

ISLE OF MAN GOVERNMENT: GENERAL REGISTRY

ASYLUM PLANS: PARISH OF ONCHAN

Original monotone

1:23

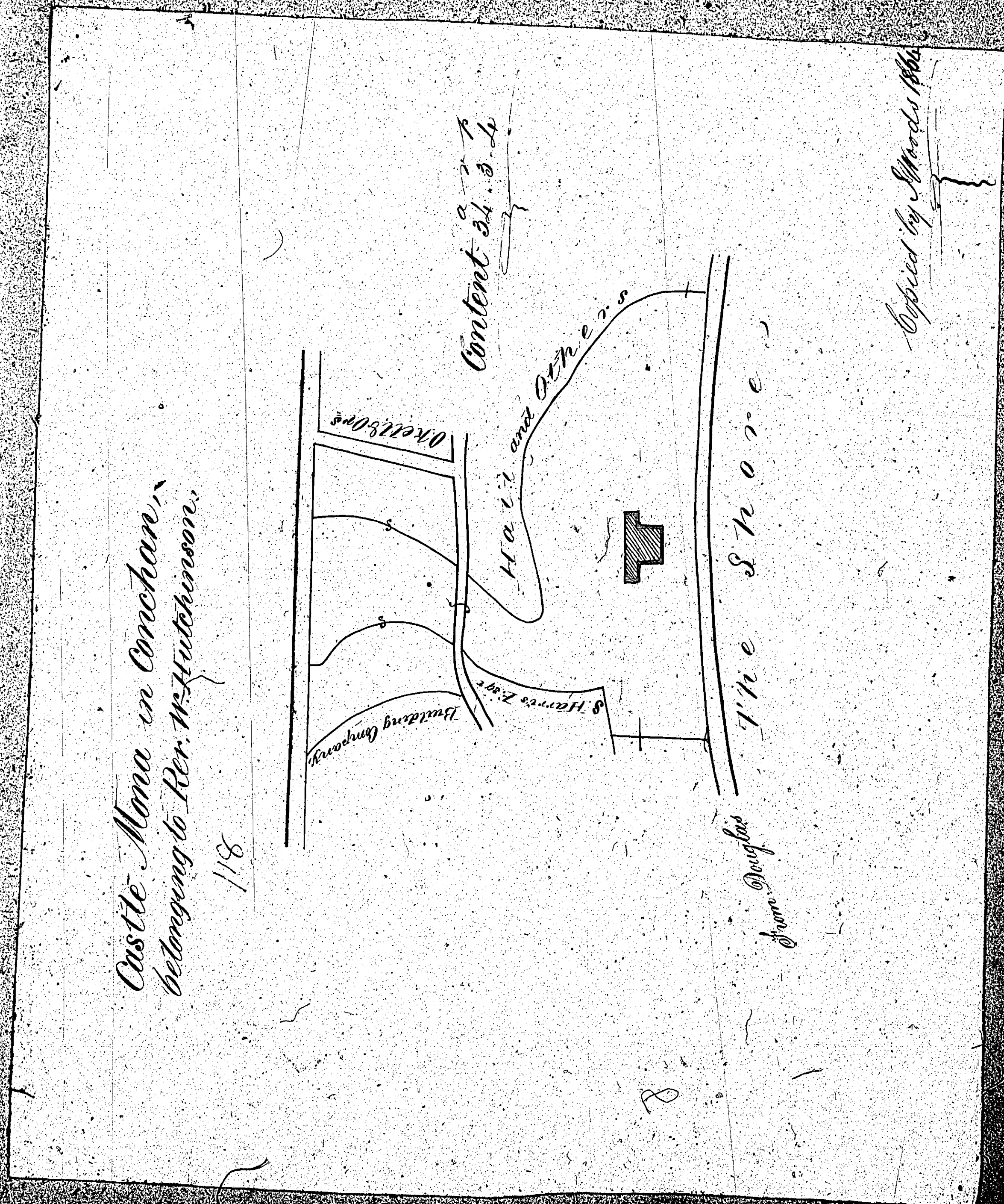

ISLE OF MAN GOVERNMENT: GENERAL REGISTRY
ASYLUM PLANS: PARISH OF ONCHAN

Original monotone

1:23

119
*Glencrutchery in Onchan,
belonging to Thos. Hutchinsonson.*

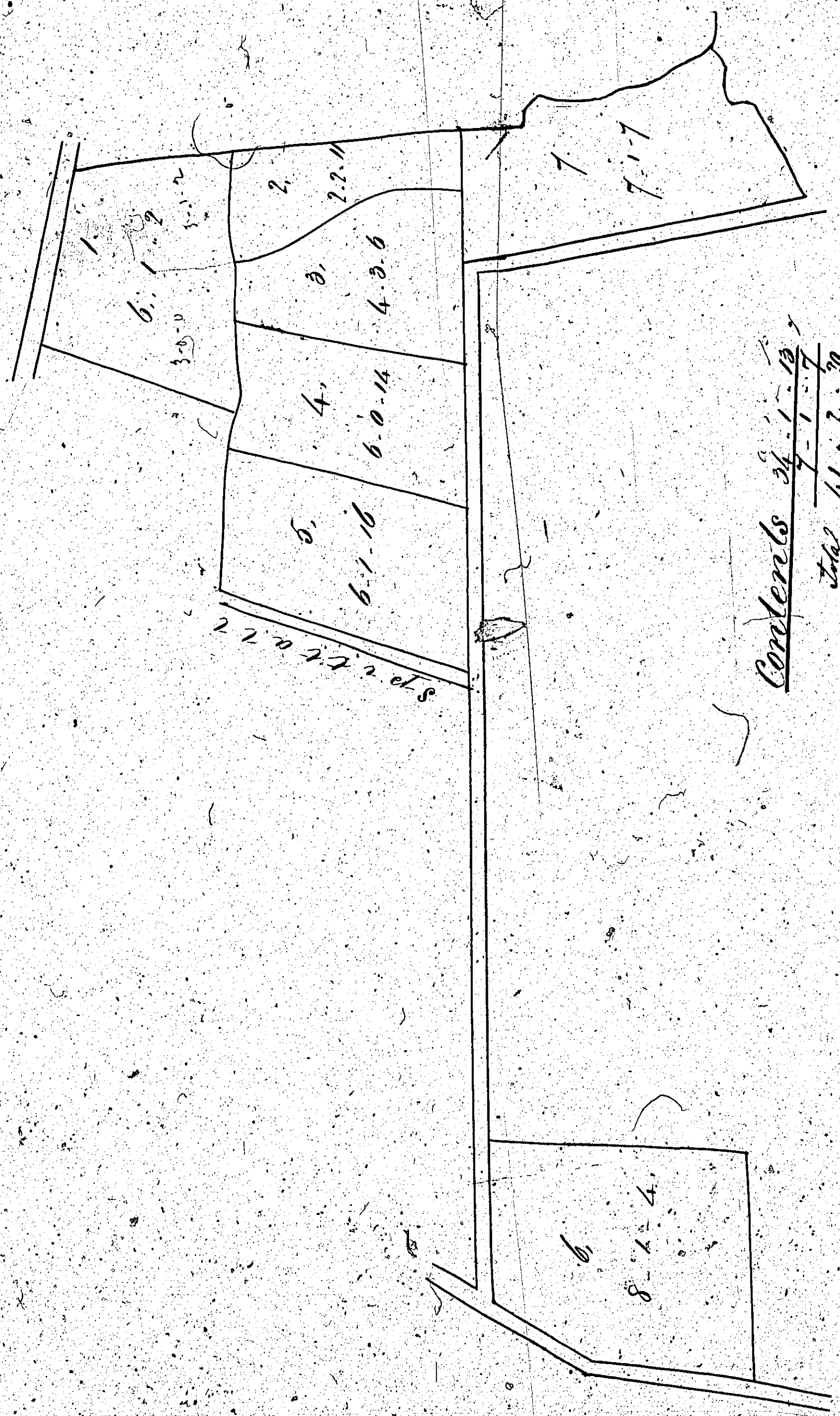

*Contents of 1-1-19
7-1-19
41-2-20*

Scale

*Copied by James Woods
1864*