

NOTES

The plans have been filmed in their bound state

This will have caused some image distortion particularly where large plans go into the binding gutter and/or have been folded

Many of the larger plans are damaged

Where plans are coloured this has been noted; 'monochrome' indicates a single ink colour which may be black, brown or blue

START OF VOLUME

ISLE OF MAN GOVERNMENT: GENERAL REGISTRY

ASYLUM PLANS: PARISH OF MAROWN

Original coloured

1:23

Marown

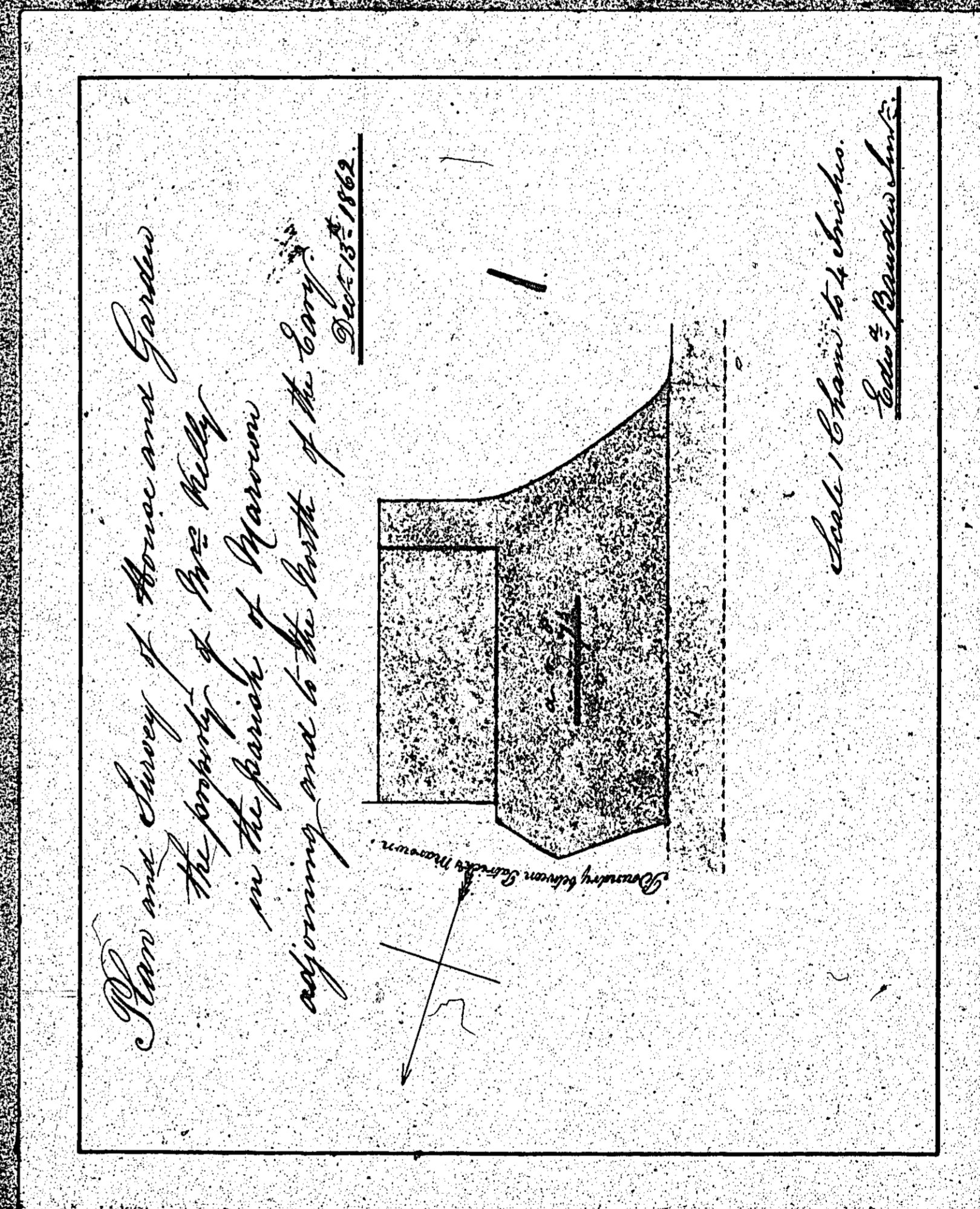

ISLE OF MAN GOVERNMENT: GENERAL REGISTRY

ASYLUM PLANS: PARISH OF MAROWN

Original coloured

1:23

P L A N

*of the Estate of
AUBRY-PLOD WELLS
In the Parish of Marown.
the Property of
Mrs John Rowland.*

*Total Area.
a. r. p.
20-3-10½*

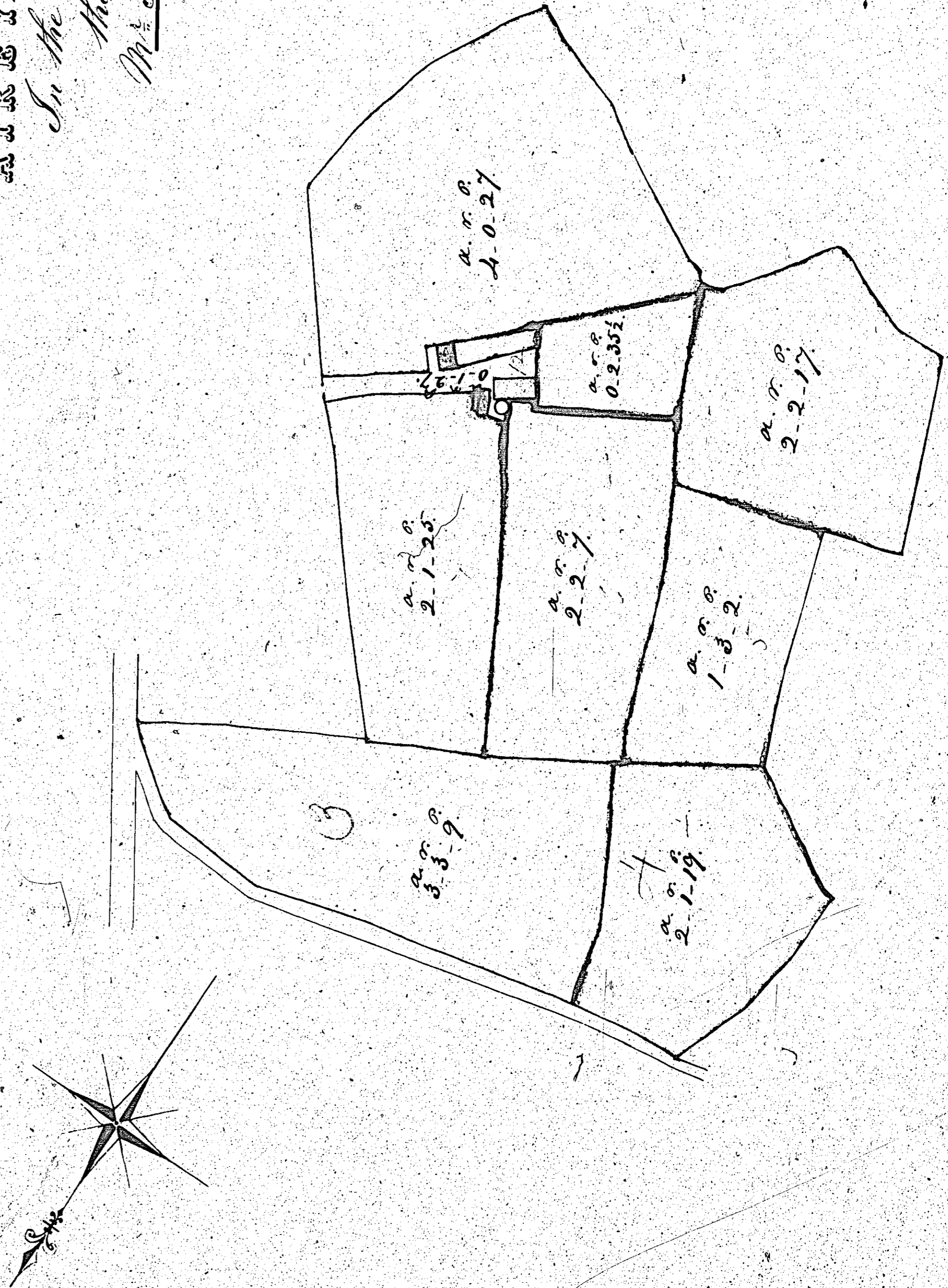

Scale 2 Chains to the Inch.

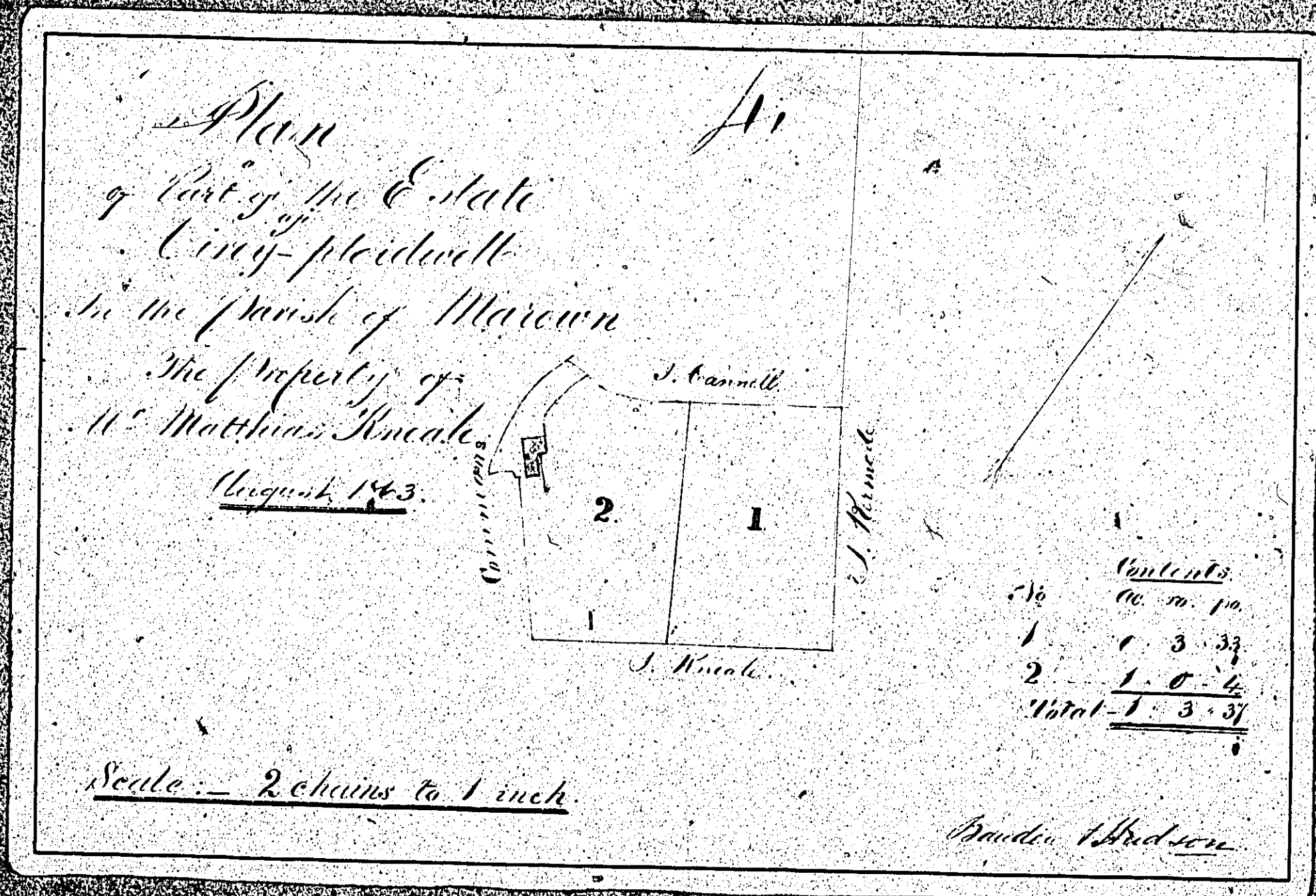
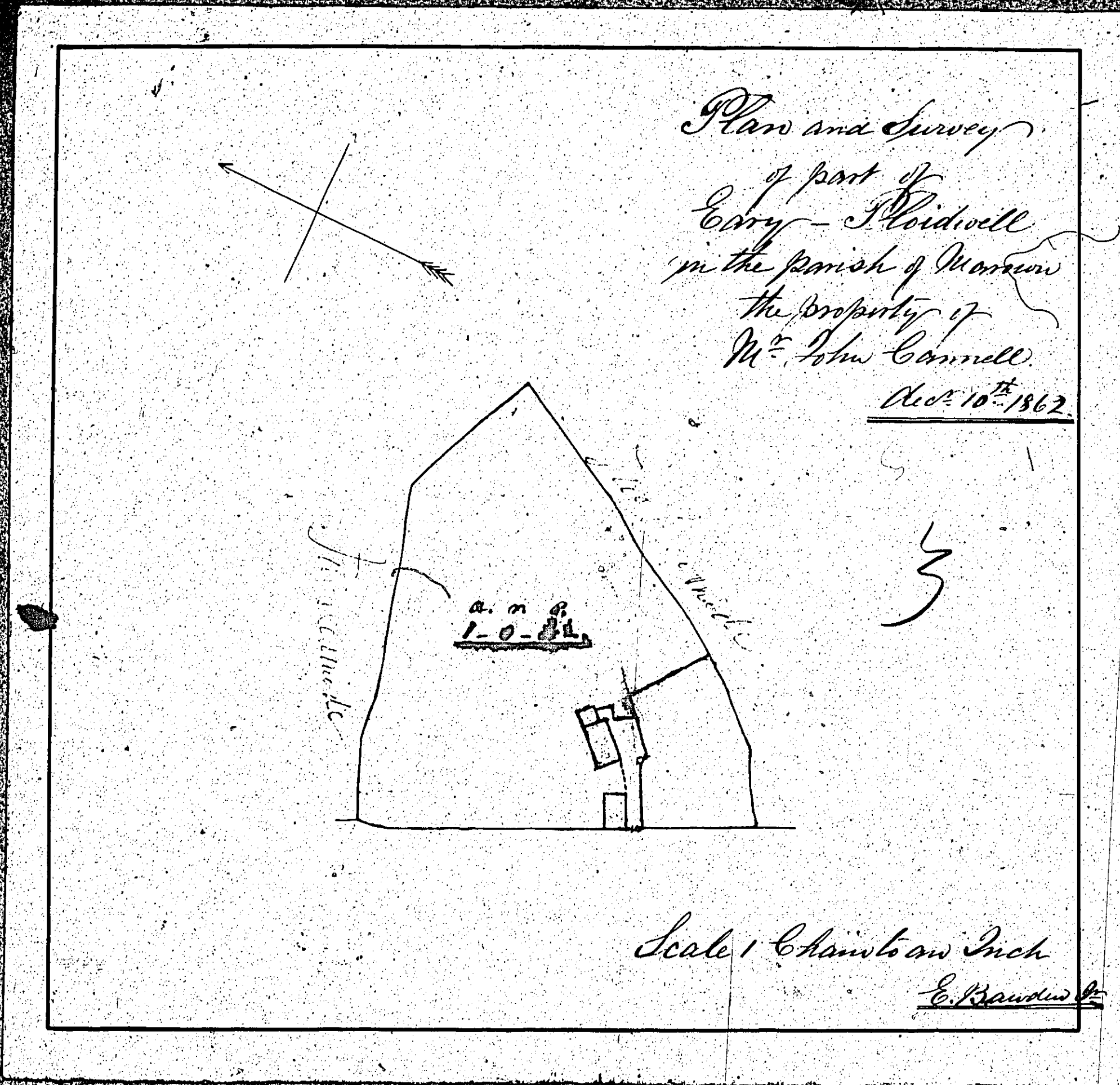

ISLE OF MAN GOVERNMENT: GENERAL REGISTRY

ASYLUM PLANS: PARISH OF MAROWN

Originals coloured

1:23

ISLE OF MAN GOVERNMENT: GENERAL REGISTRY
ASYLUM PLANS: PARISH OF MAROWN

Original coloured

1:23

