

ISLE OF MAN GOVERNMENT: GENERAL REGISTRY

ASYLUM PLANS: PARISH OF MALEW

Original coloured

1:23

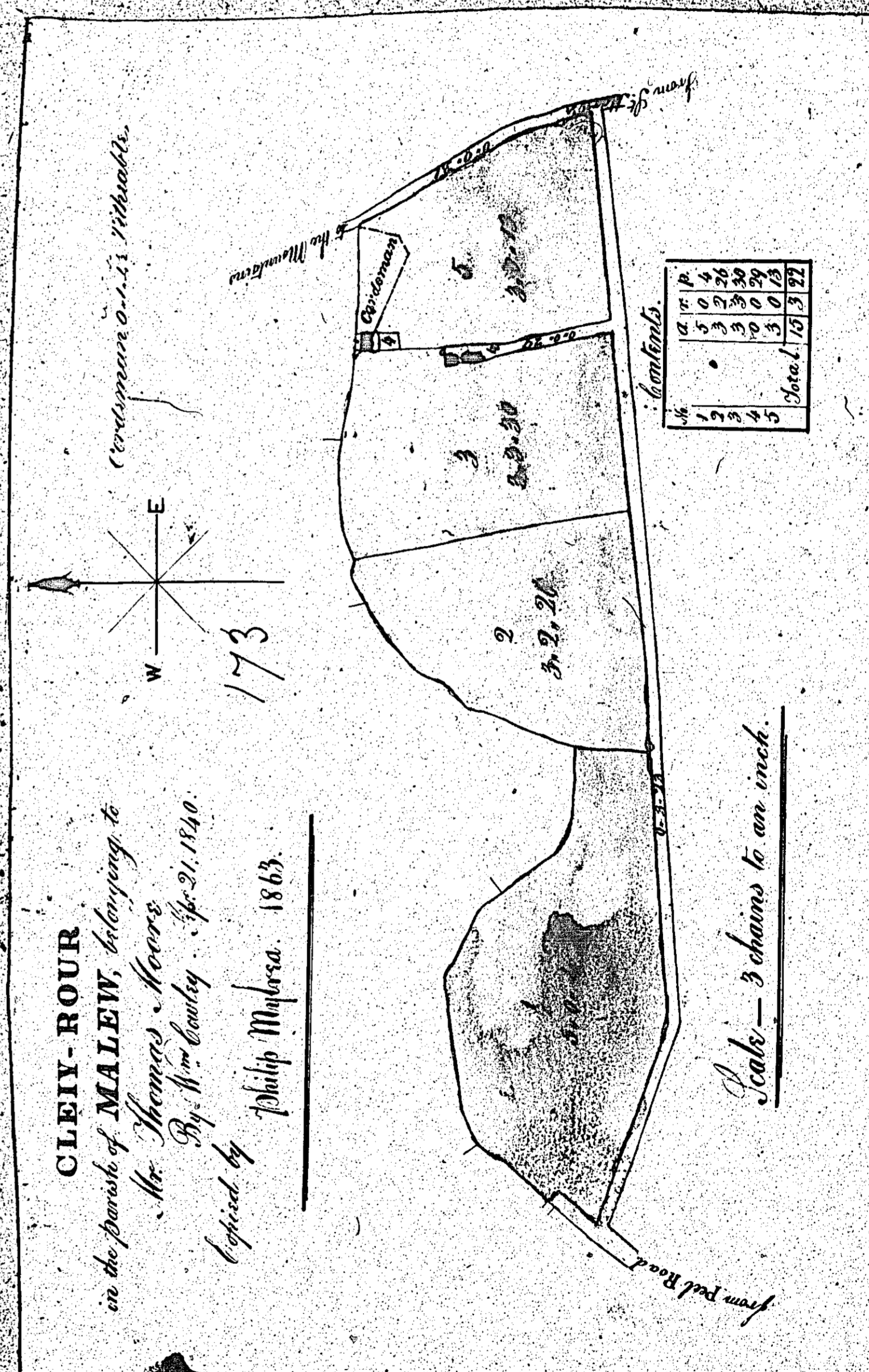

ISLE OF MAN GOVERNMENT: GENERAL REGISTRY

ASYLUM PLANS: PARISH OF MALEW

Original coloured

1:23

PLAN AND SURVEY
of Cordeman called,
OF THALLOVELL,
PARISH OF MALEW, ISLE OF MAN.
PROPERTY OF ANNE AND JOHN QUAGGIN.

BY THOMAS SHIMMIN.

1862.

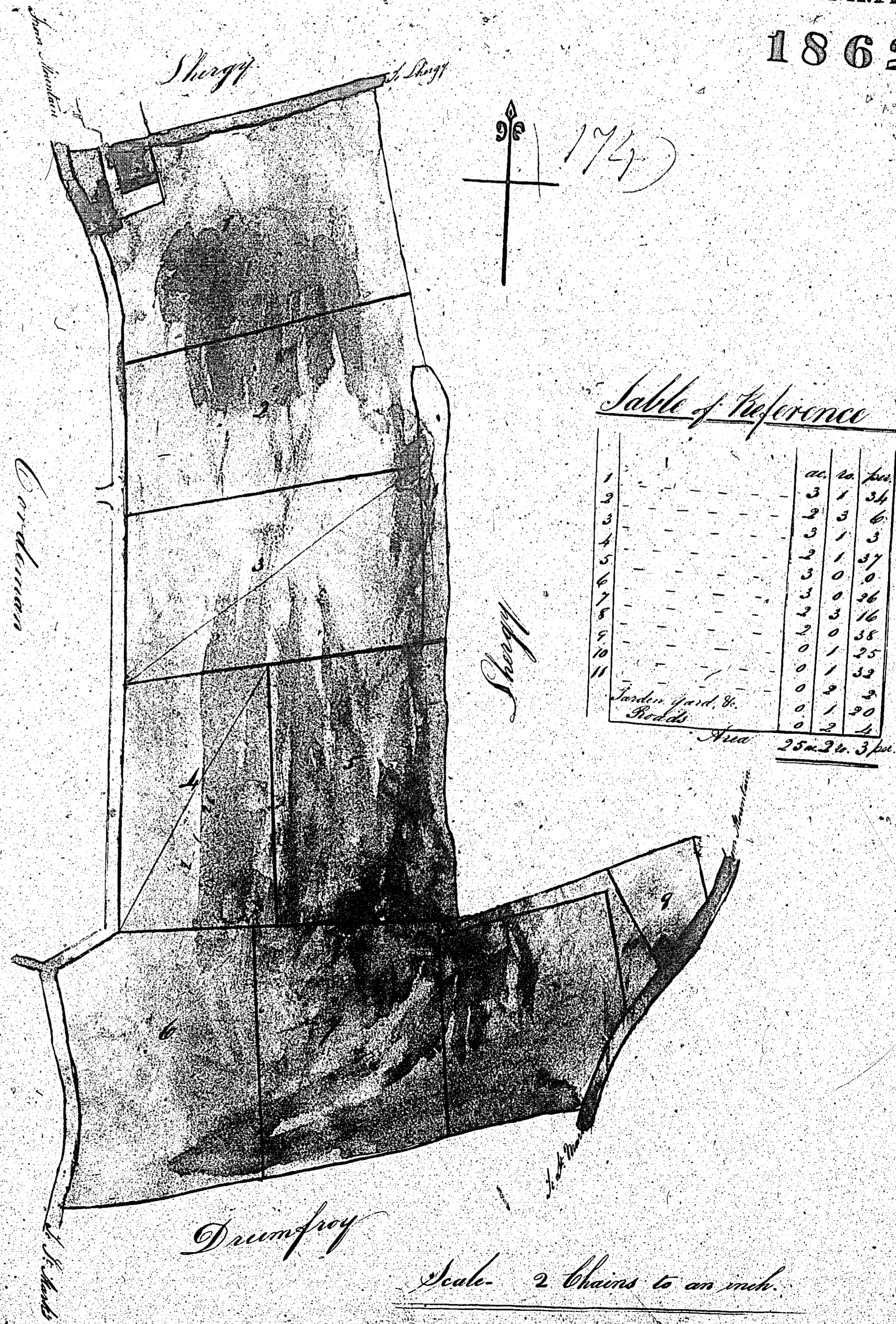

Table of Reference

	ac.	ro.	per.
1			
2	3	1	34
3	2	3	6
4	3	1	3
5	2	1	37
6	3	0	0
7	3	0	26
8	3	3	16
9	2	0	38
10	0	1	33
11	0	2	3
Jarden Gard. &c.	0	1	30
Stalls	0	2	4
Total Area			25m. 2r. 3p.

Scale. 2 Chains to an inch.

ISLE OF MAN GOVERNMENT: GENERAL REGISTRY

ASYLUM PLANS: PARISH OF MALEW

Original coloured

1:23

Plan and Survey

"Raggee;"

Parish of Malew, Isle of Man.

The property of James Jaggart.

By Philip Myhra. 1862.

(175)

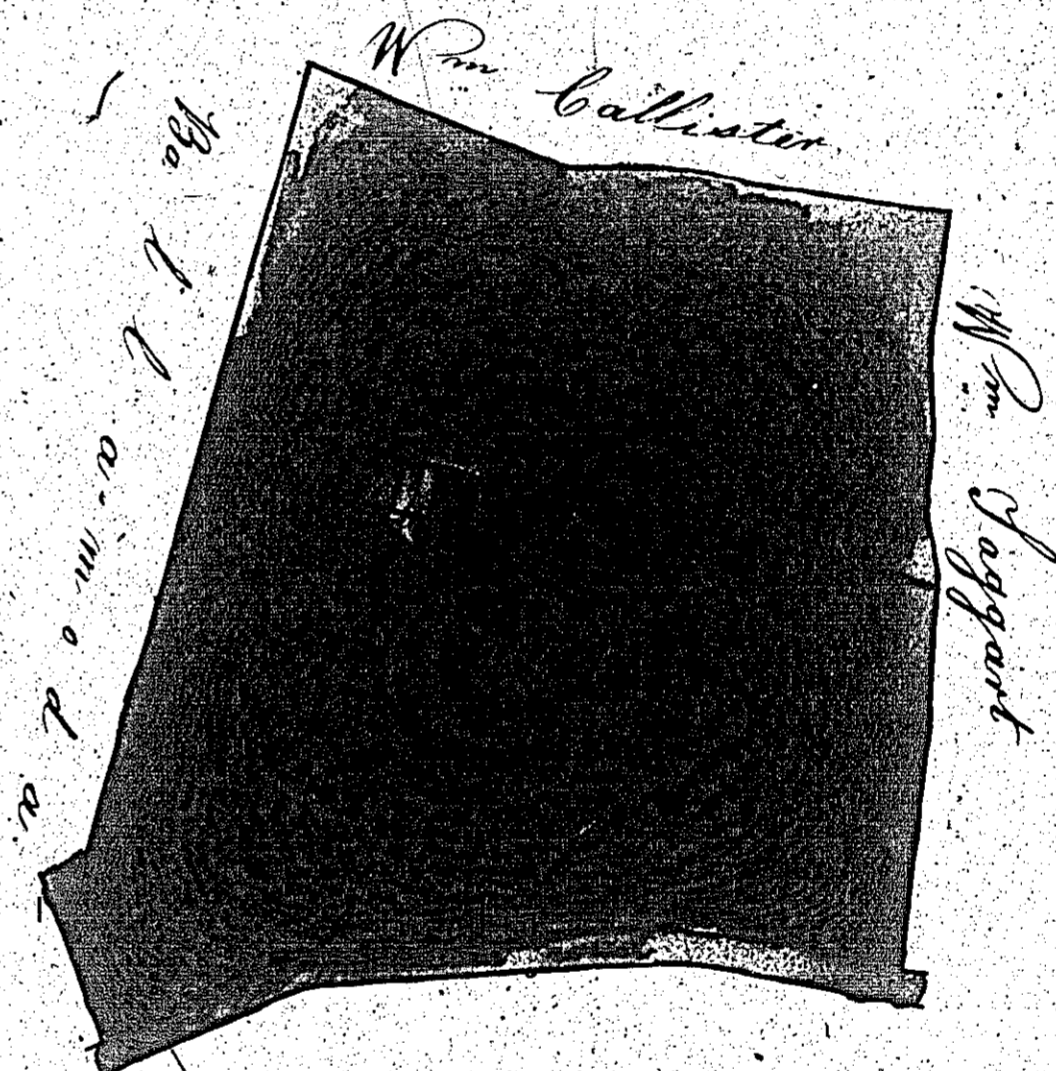

B. a. b. l. a. m. o. d. a.

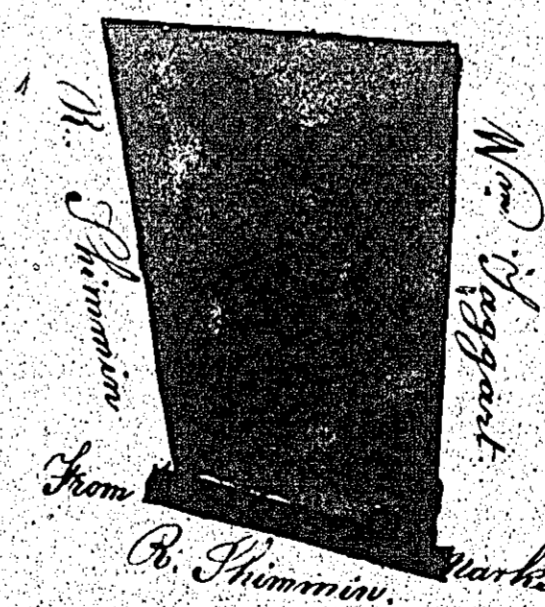

contents

No.	A.	R.	Per
1	1	2	16.
2	1	0	39
3	1	0	33
4	1	1	19
5	1	0	8
6	1	2	16
Gardens, &c.	0	0	16
Roads	0	1	5
Total	8	1	32.

Scale. — 2 chains to an inch.

ISLE OF MAN GOVERNMENT: GENERAL REGISTRY

ASYLUM PLANS: PARISH OF MALEW

Originals coloured

1:23

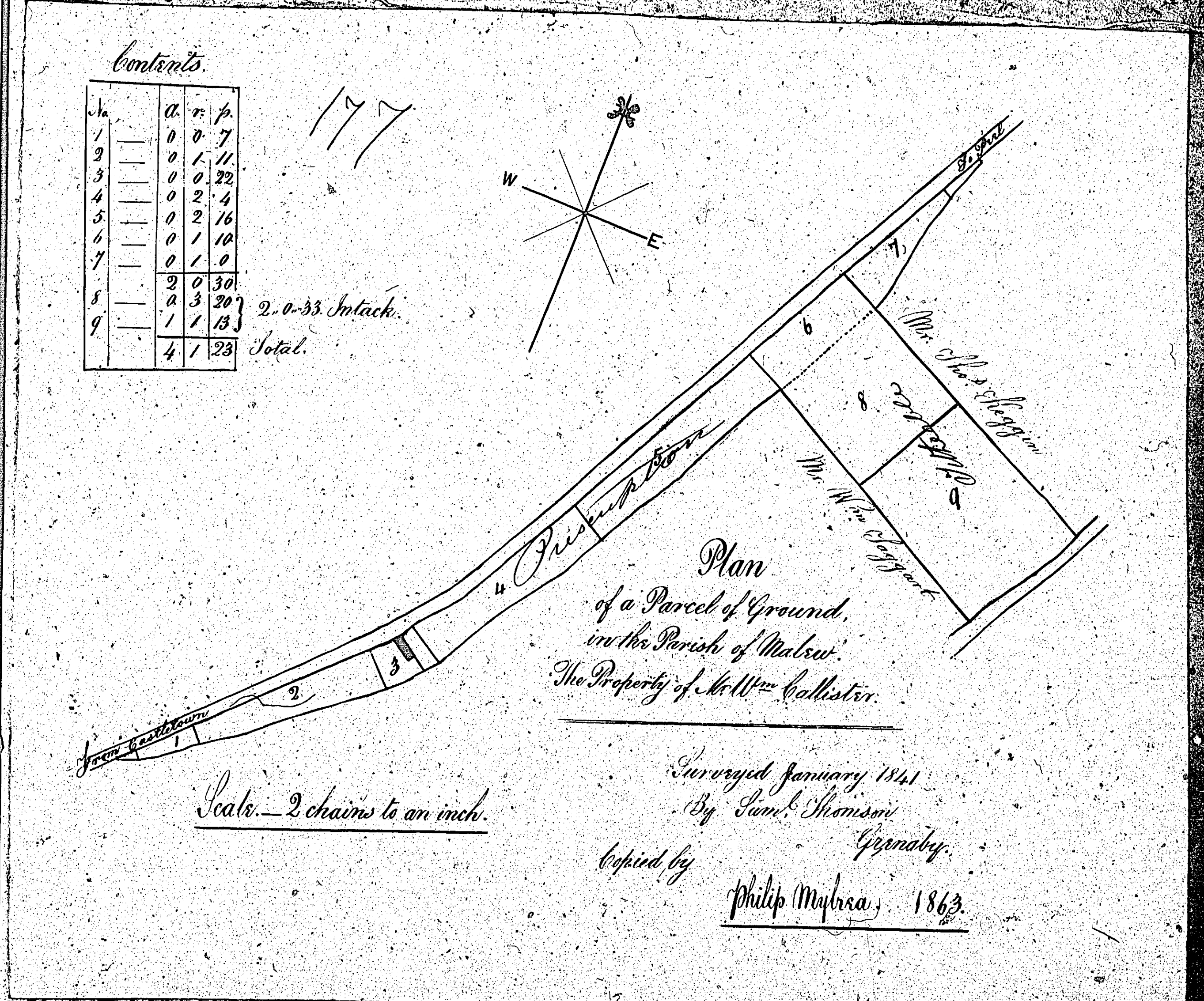
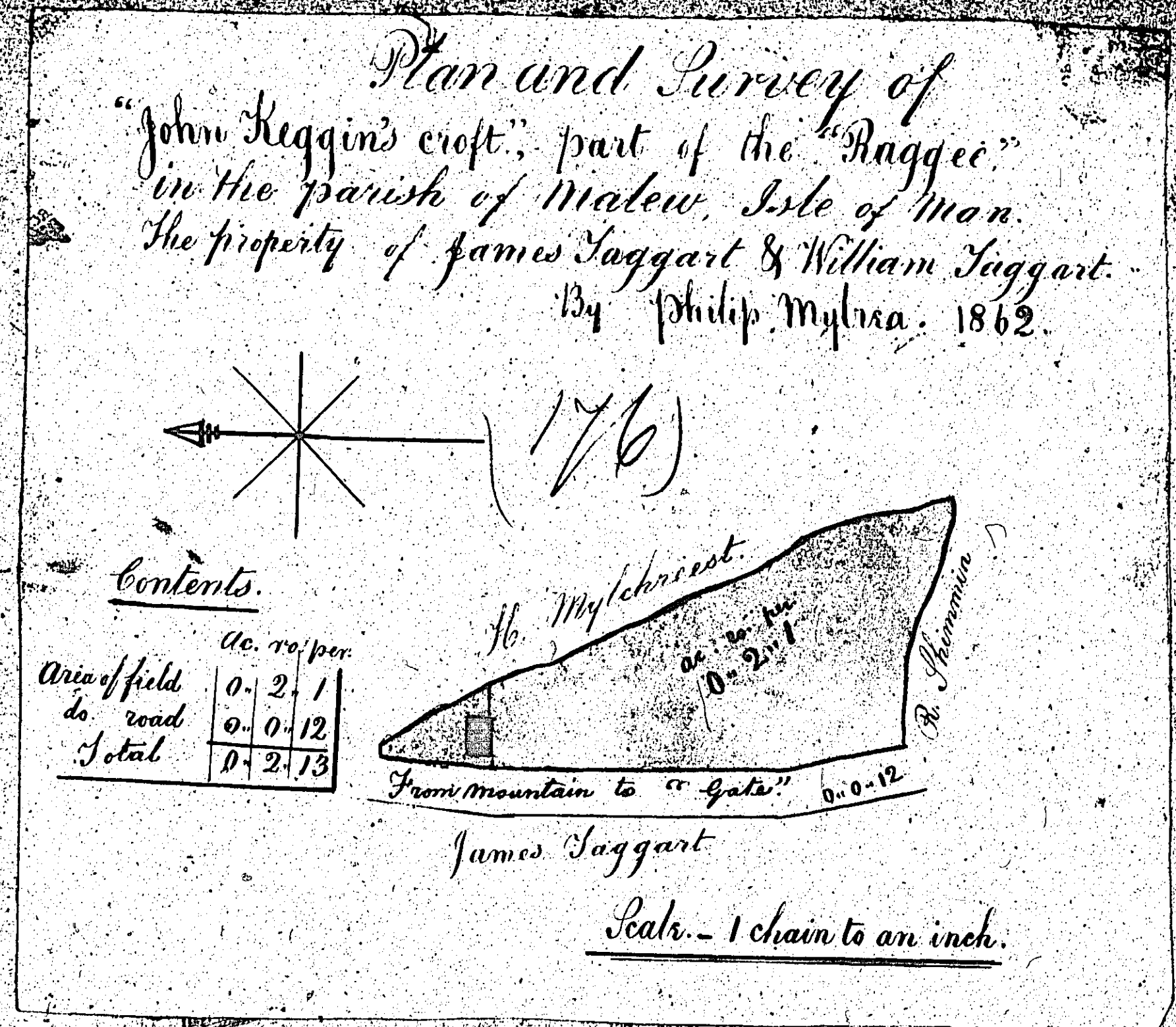

ISLE OF MAN GOVERNMENT: GENERAL REGISTRY

ASYLUM PLANS: PARISH OF MALEW

Original coloured, marked

1:23

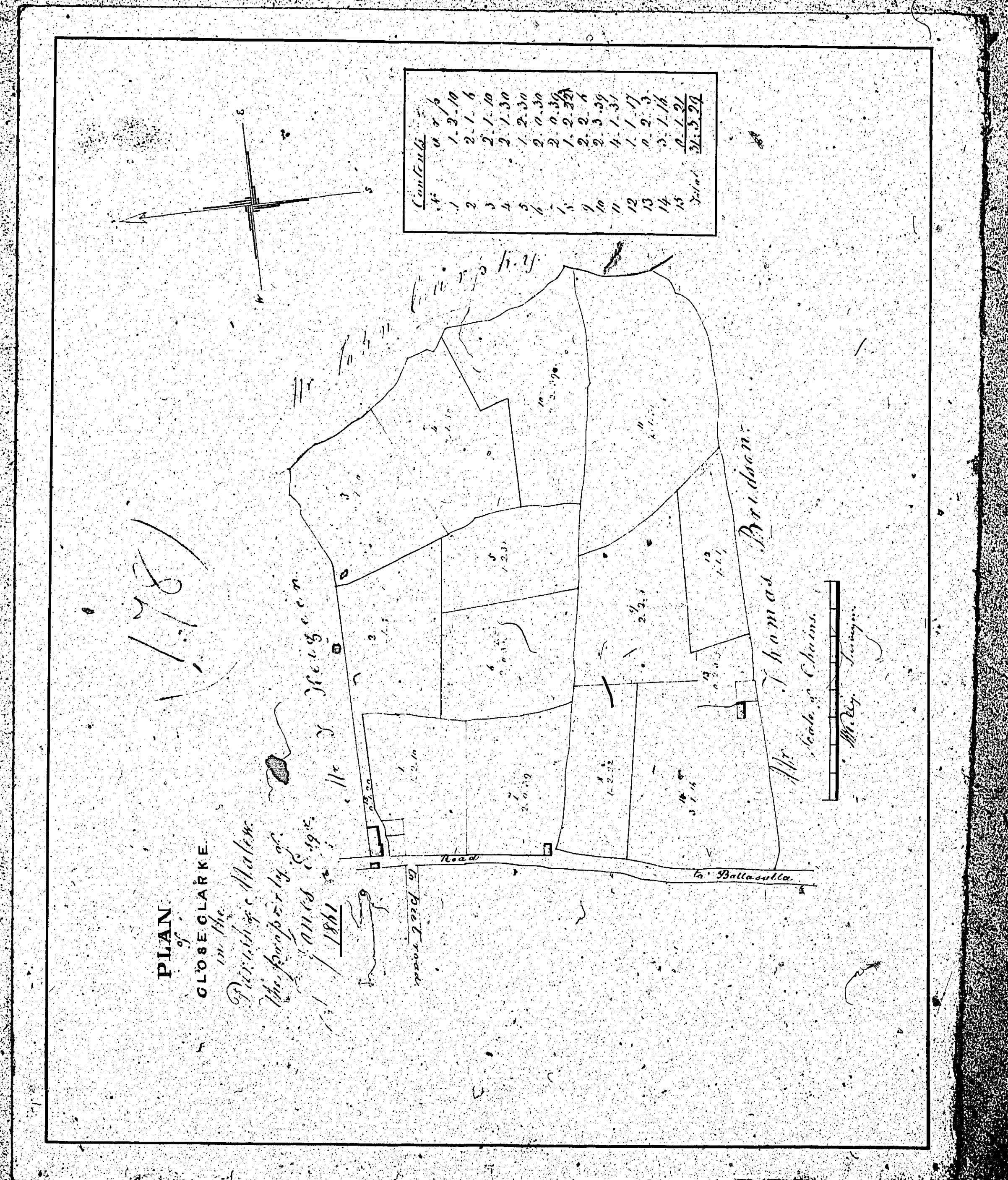

ISLE OF MAN GOVERNMENT: GENERAL REGISTRY

ASYLUM PLANS: PARISH OF MALEW

Original coloured, marked

1:23

