

ISLE OF MAN GOVERNMENT: GENERAL REGISTRY

ASYLUM PLANS: PARISH OF LONAN

Originals monotone

1:23

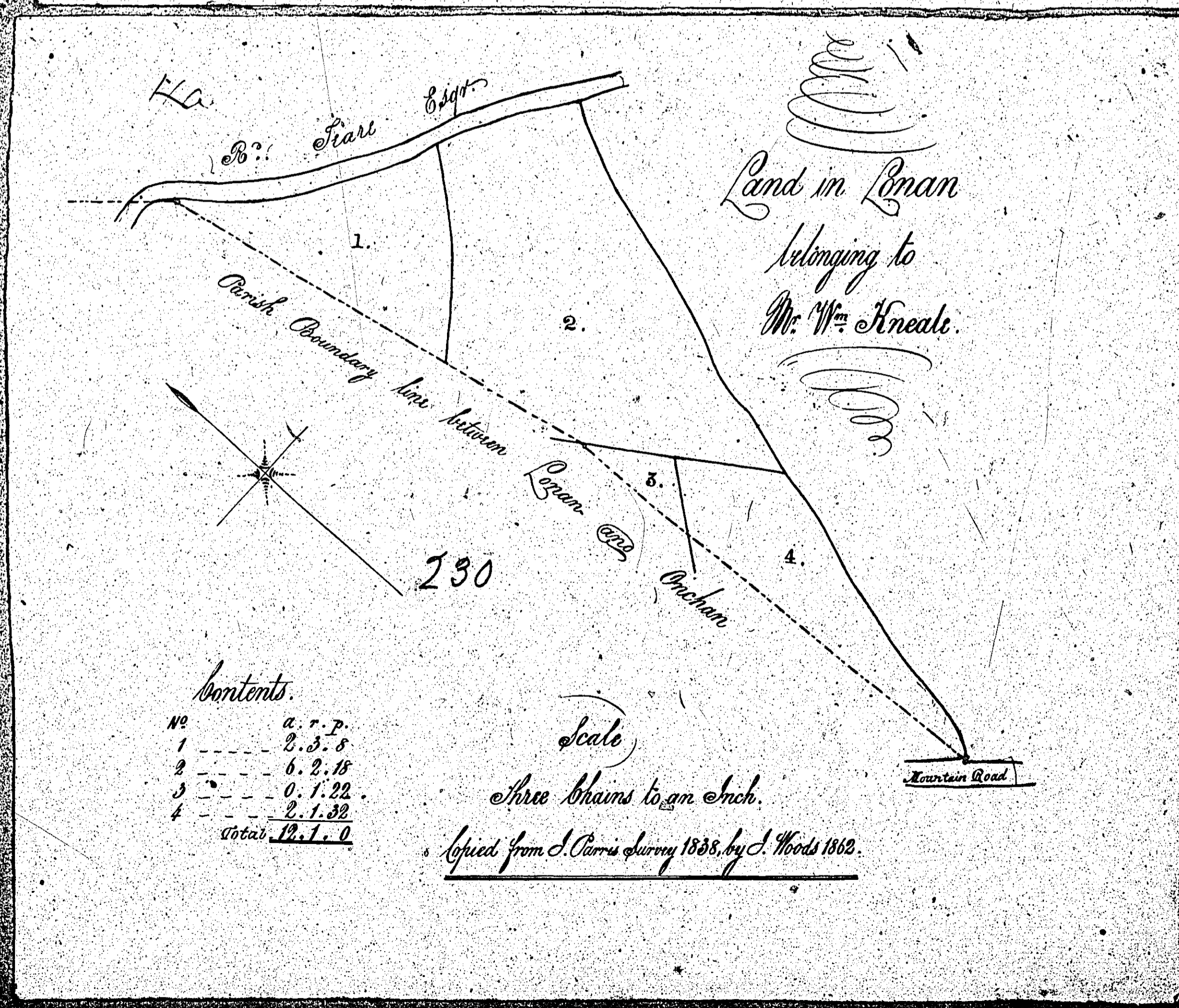
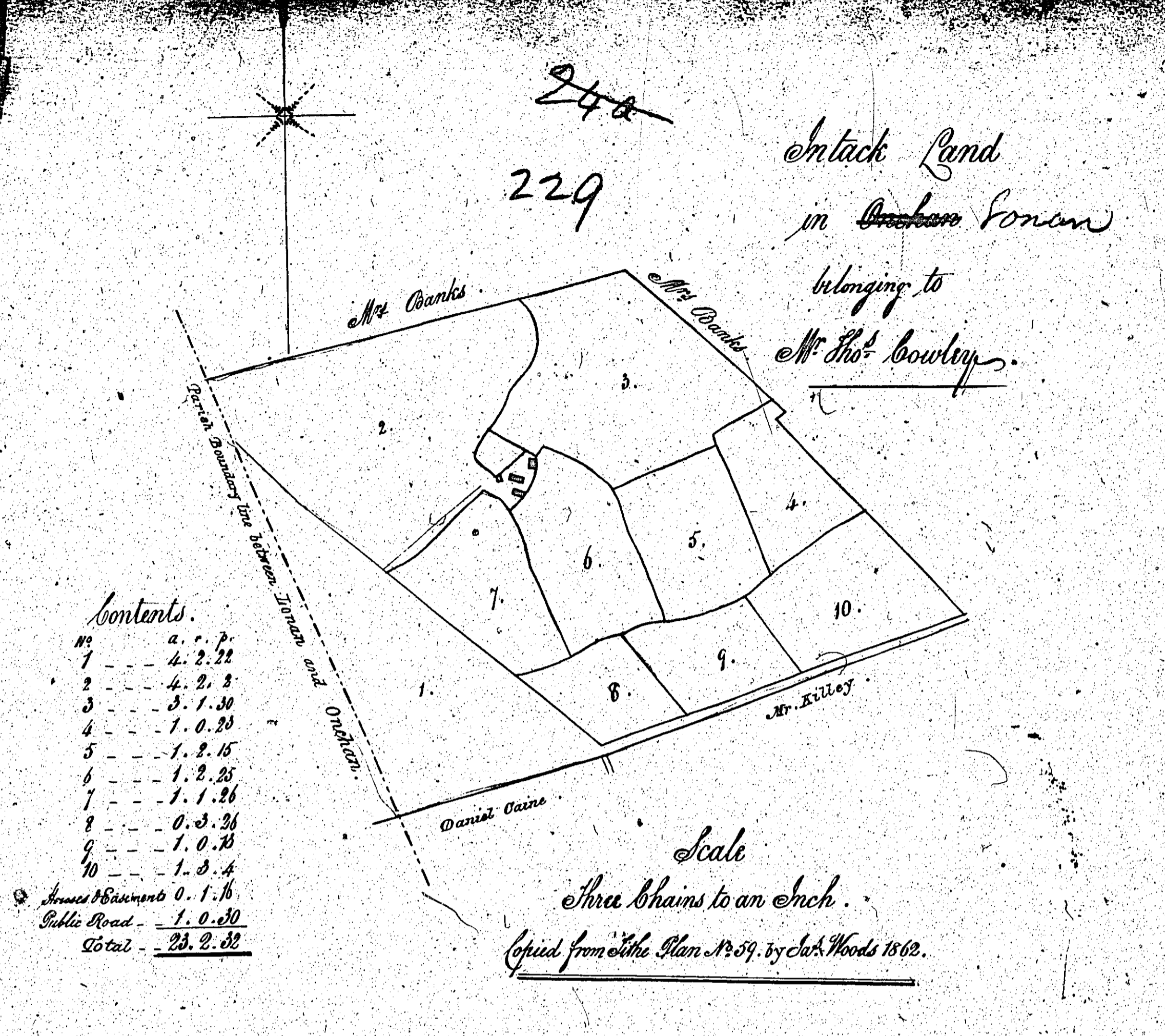

The following plan
is not numbered

but 231 is

pencilled on the back

ISLE OF MAN GOVERNMENT: GENERAL REGISTRY

ASYLUM PLANS: PARISH OF LONAN

Original coloured

1:23

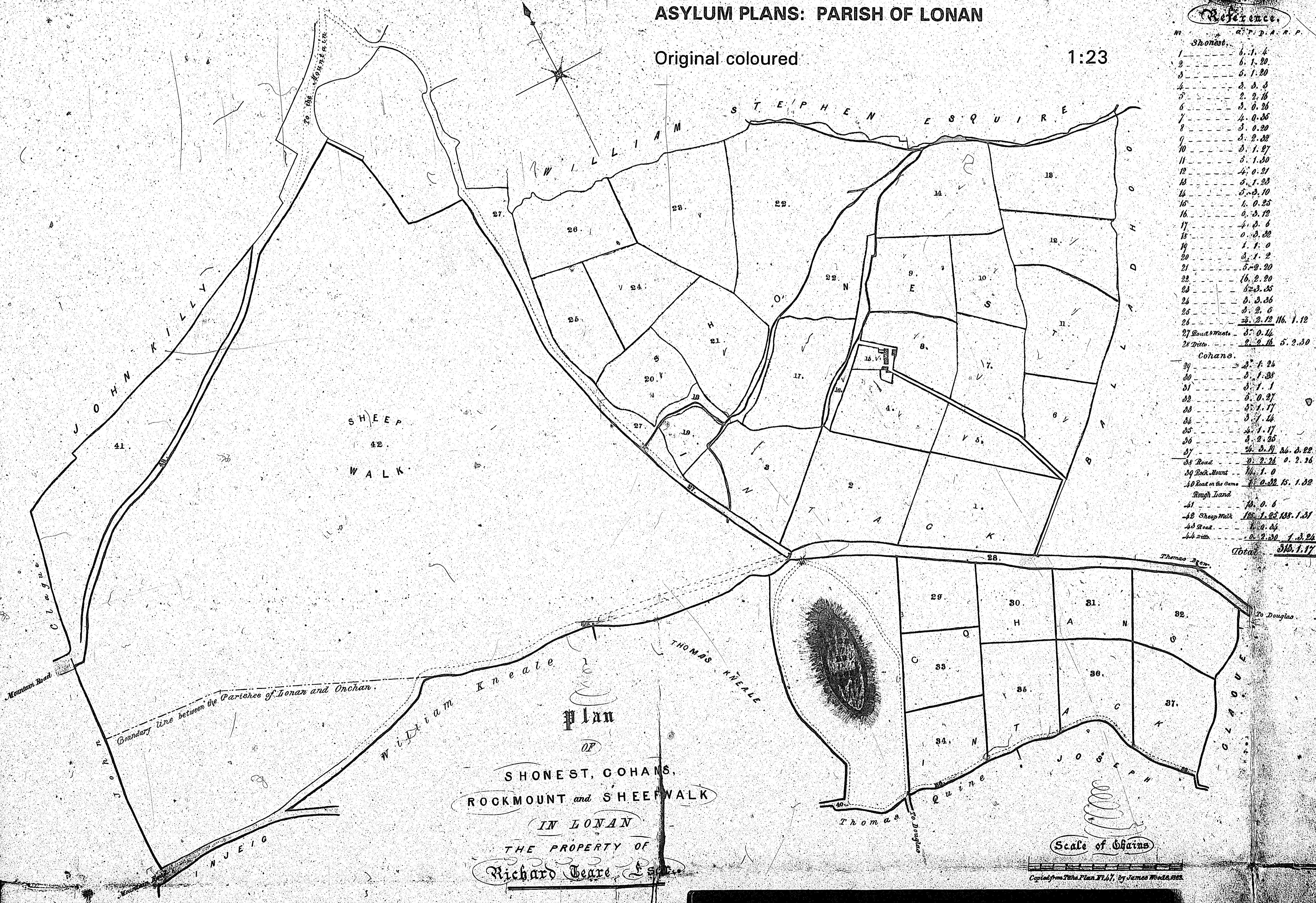

Reference

No.	Reference
1	6.1.4
2	6.1.20
3	5.1.20
4	2.3.3
5	2.2.16
6	3.0.26
7	4.0.35
8	3.0.20
9	3.2.33
10	3.1.27
11	5.1.30
12	4.0.21
13	5.1.23
14	3.3.10
15	1.0.25
16	0.3.12
17	4.3.6
18	0.3.32
19	1.1.0
20	3.1.2
21	5.2.20
22	16.2.20
23	5.3.35
24	0.3.36
25	3.2.6
26	2.2.12 116.1.12
27 Roadways	5.0.14
28 Ditto	2.3.16 5.2.30
Cohams.	
29	2.1.24
30	3.1.38
31	3.1.1
32	3.0.27
33	3.1.17
34	3.1.14
35	4.1.17
36	3.2.25
37	2.3.19 26.3.22
38 Road	0.2.26 0.2.26
39 Rock Mount	1.1.0
40 Road on the same	1.0.32 15.1.32
Rough Land	
41	1.0.6
42 Sheep Walk	1.2.138.1.31
43 Road	1.0.34
44 Ditto	0.2.30 1.3.24
Total	315.1.17

Scale of Chains

Copied from Title Plan T/117, by James Wood, 1882

ISLE OF MAN GOVERNMENT: GENERAL REGISTRY

ASYLUM PLANS: PARISH OF LONAN

Original monotone

1:23

Paltra-door
in Lonan
belonging to
Mr. John Leane

232

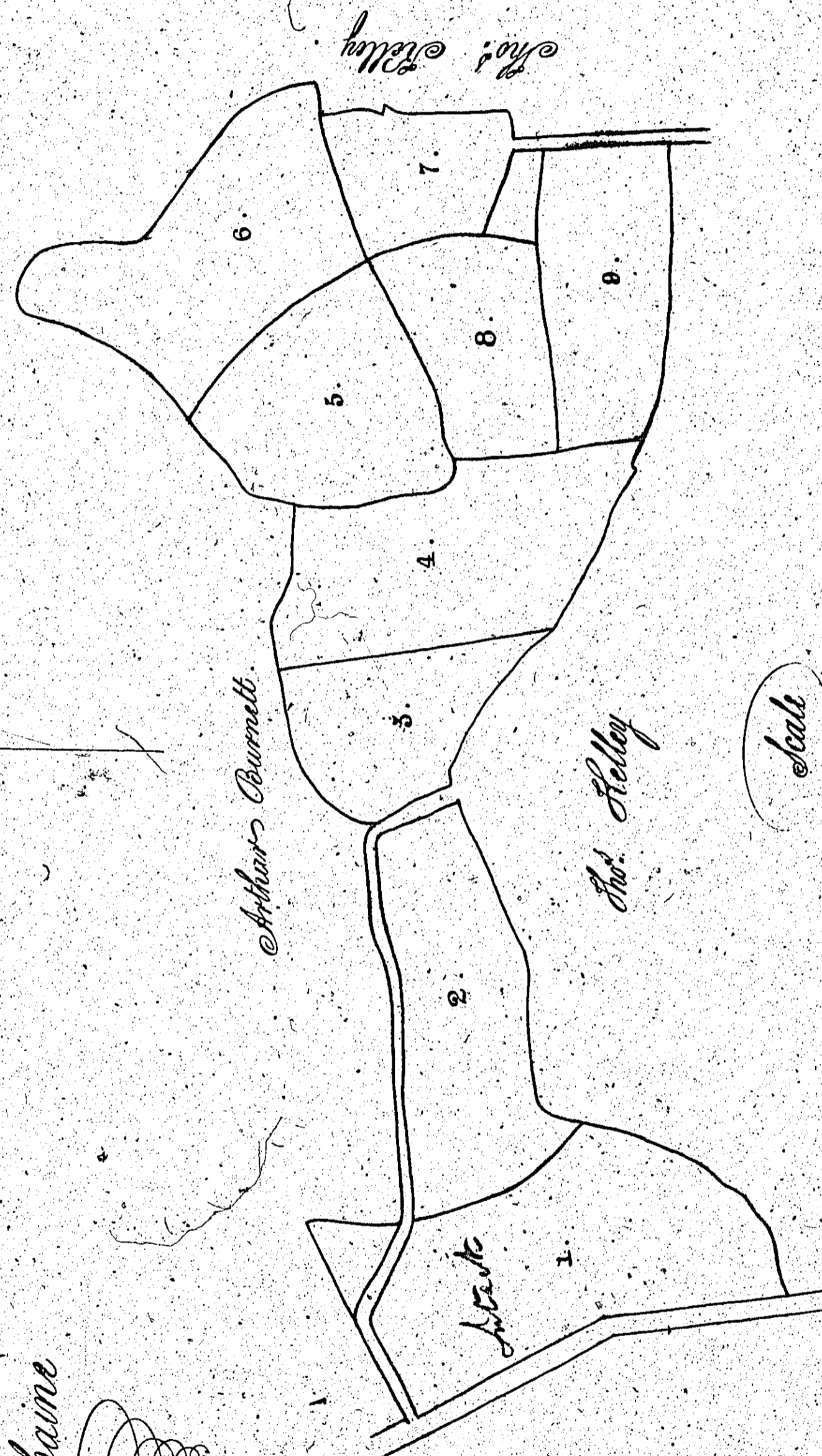
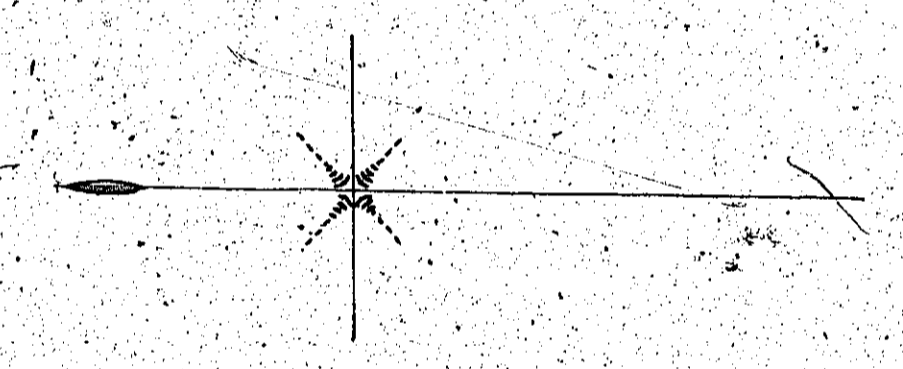

Scale
Three chains to an Inch.

Copied from Site Plan No. 6, by S. S. Woods 1868.

Contents

No.	a.	n.	p.
1	4	0	36
2	3	0	3
3	1	3	18
4	3	2	1
5	3	0	1
6	3	2	10
7	1	1	19
8	1	3	7
9	2	1	21
Areas Placements			0. 1. 18
Public Road			0. 2. 31
Total			25. 3. 0

ISLE OF MAN GOVERNMENT: GENERAL REGISTRY

ASYLUM PLANS: PARISH OF LONAN

Original monotone

1:23

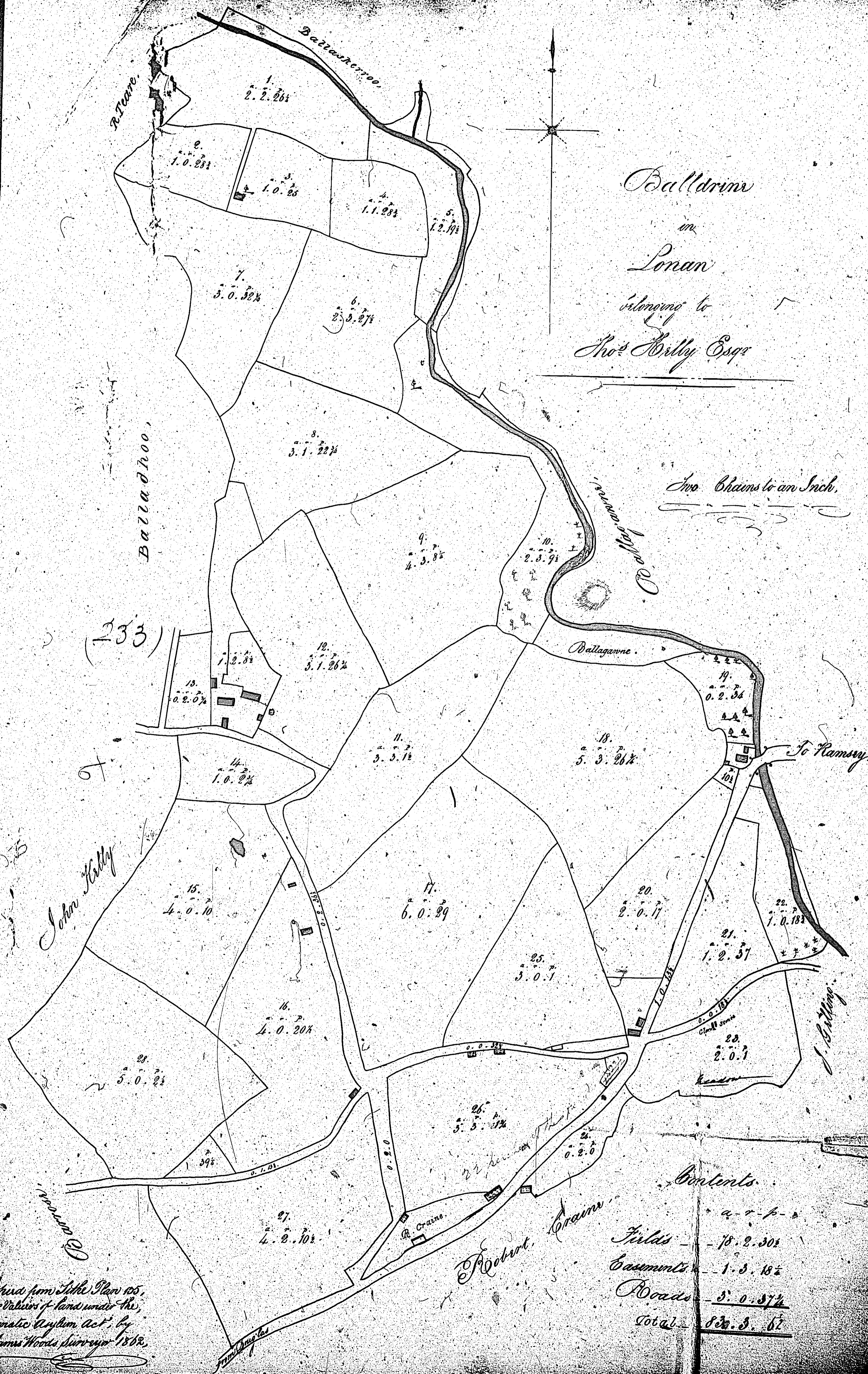

ISLE OF MAN GOVERNMENT: GENERAL REGISTRY

ASYLUM PLANS: PARISH OF LONAN

Originals coloured

1:23

