

ISLE OF MAN GOVERNMENT: GENERAL REGISTRY

ASYLUM PLANS: PARISH OF LONAN

Originals monotone

1:23

*Cottage*  
*in*  
*Lonan*  
*belonging to*  
*Miss Loney*

193

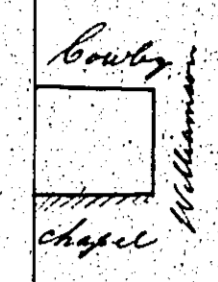

*Contents* <sup>*and*</sup> *0-0-54*

*Inch Scale*

*Woods*  
*Surveyor 1862*

*in Lonan*  
*belonging to Jas. Quayle*  
*1863.*

194



*Contents* <sup>*a. m. p.*</sup> *0.0.2*

*Scale Chains to an Inch*

*James Woods, Surveyor.*

ISLE OF MAN GOVERNMENT: GENERAL REGISTRY

ASYLUM PLANS: PARISH OF LONAN

Originals monotone

1:23 75.

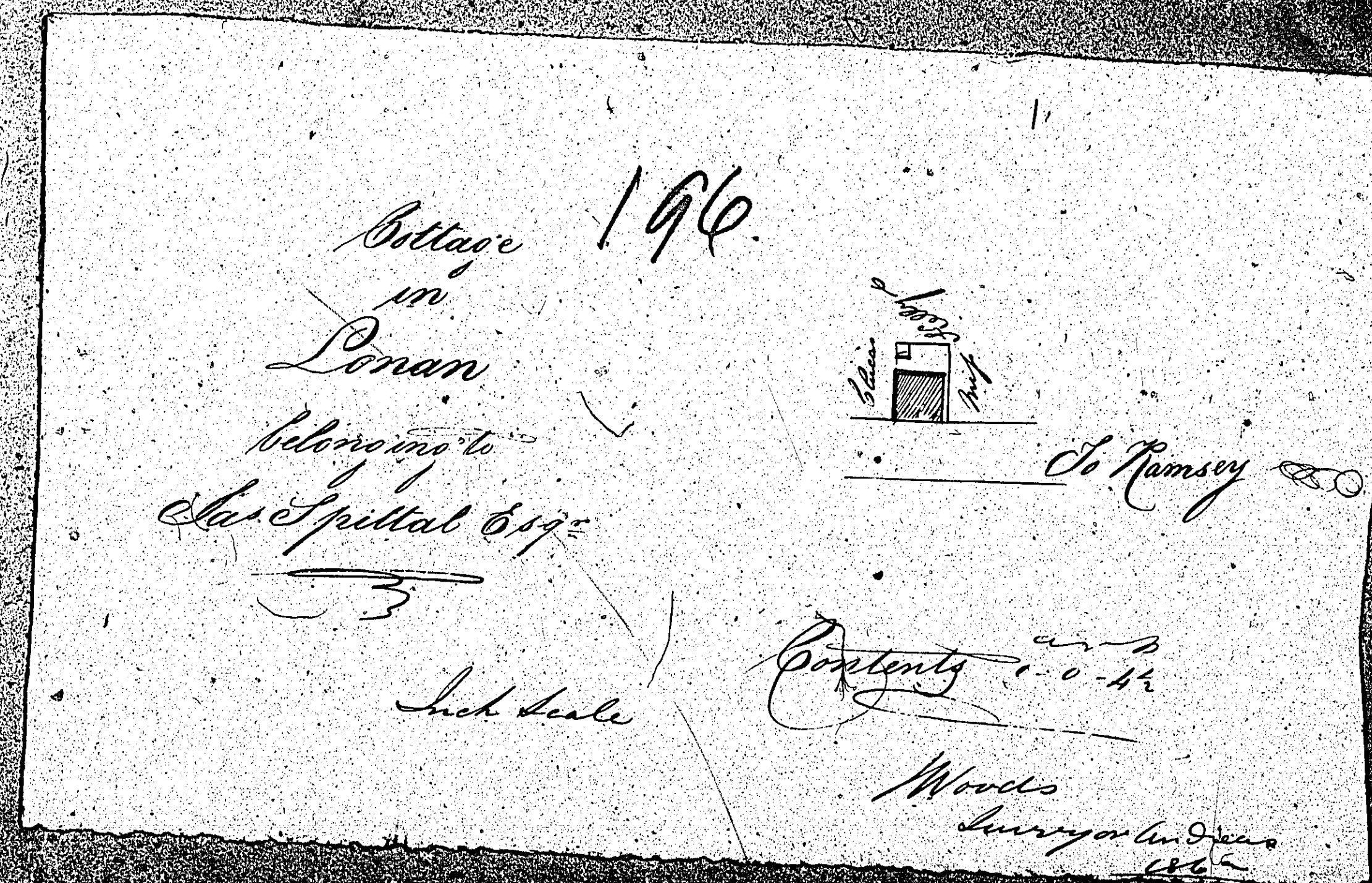
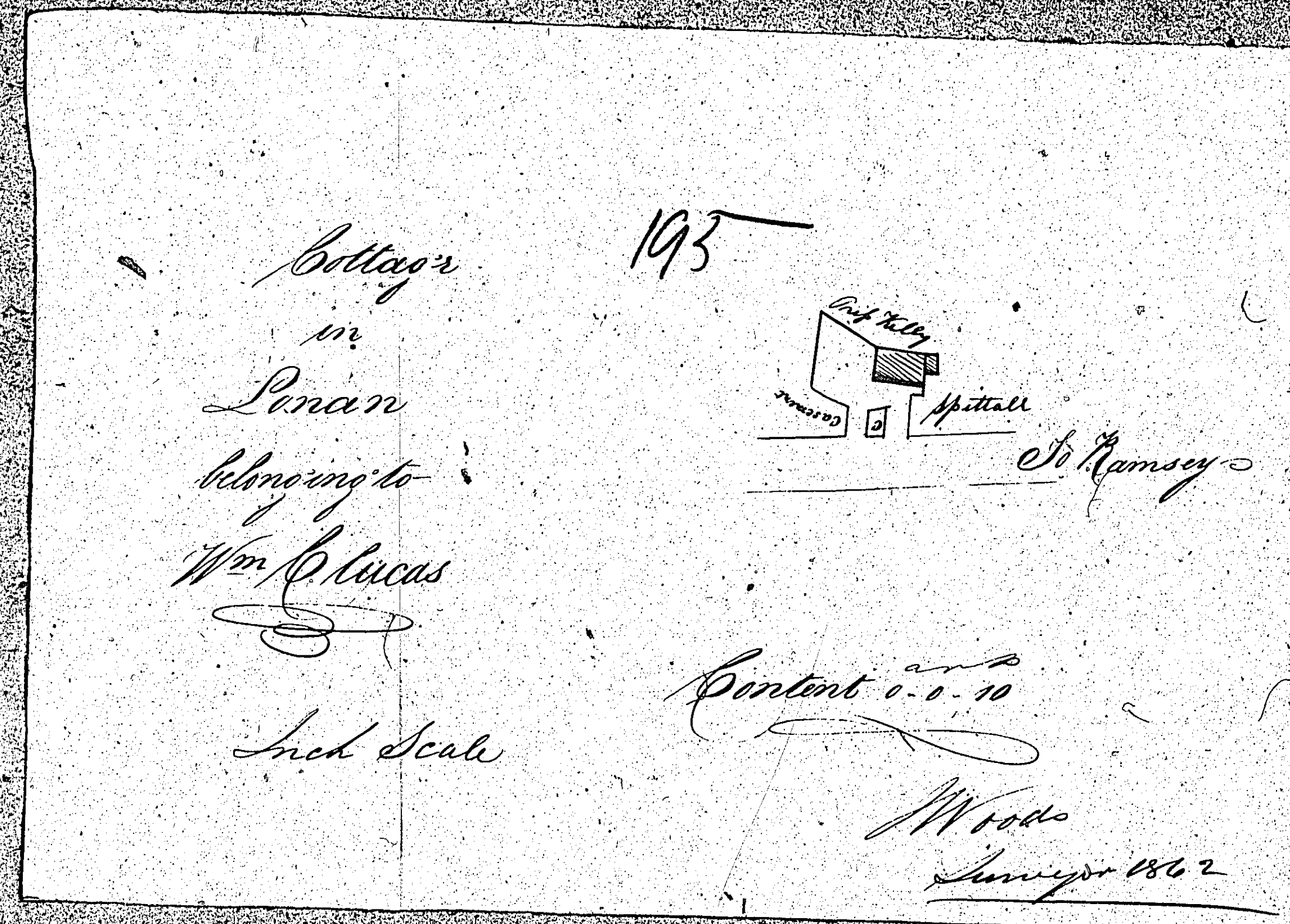

ISLE OF MAN GOVERNMENT: GENERAL REGISTRY

ASYLUM PLANS: PARISH OF LOÑAN

Original monotone

1:23

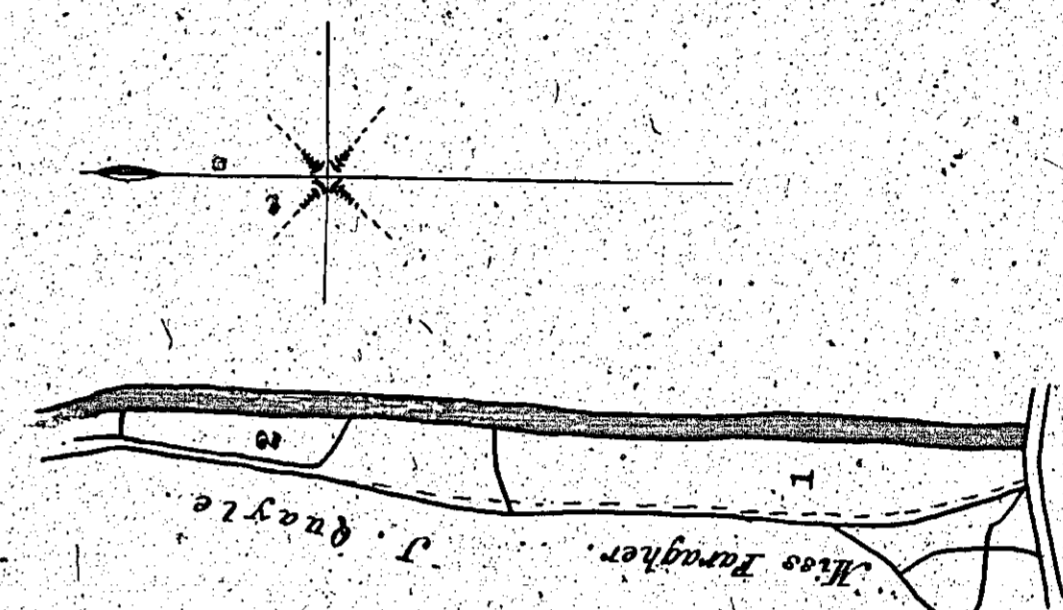

*Land in Loman,  
Belonging to  
Jas. B. Milbourne & Hogg.*

92.

197

Contents.  
A 0.7.2  
1 1.0.1  
2 0.0.14  
Total 1.8.15

Scale - 3 Chains to an Inch

Copied from Plans File 253, by J. C. Wood, 1892.

ISLE OF MAN GOVERNMENT: GENERAL REGISTRY

ASYLUM PLANS: PARISH OF LONAN

Original coloured

1:23

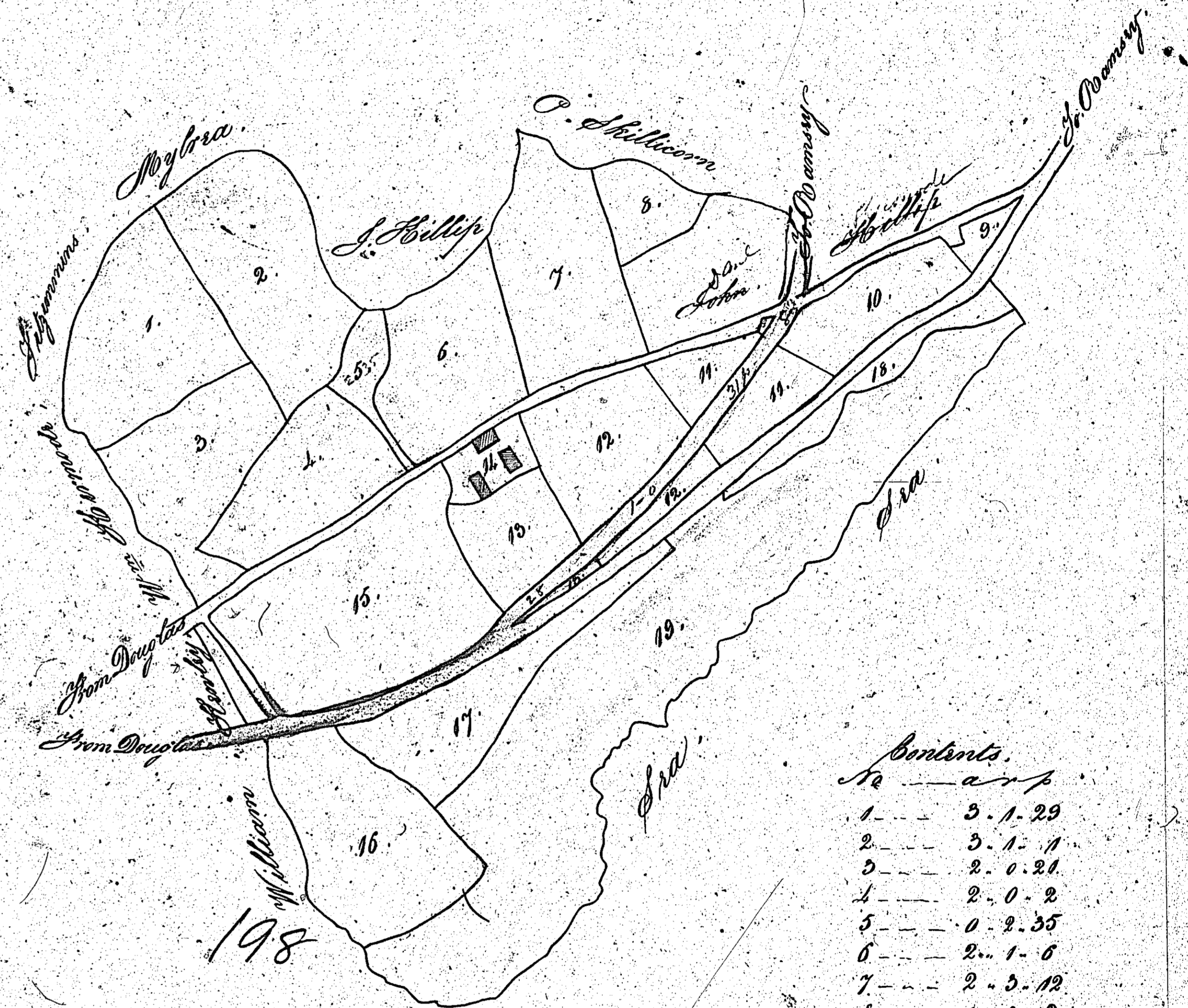

198

*Ballacalister*  
in  
*Lonan*  
belonging  
to  
*John Bowley*  
*Arms claims to an inch*

No	acp
1	3.1.29
2	3.1.1
3	2.0.21
4	2.0.2
5	0.2.35
6	2.1.6
7	2.3.12
8	0.3.2
9	0.1.31
10	1.1.15
11	1.1.8
12	1.3.28
13	1.0.7
14	0.1.20
15	1.2.13
16	3.0.12
17	2.0.26
18	0.3.1
19	9.3.39
<i>Roads 3.1.6</i>	
<i>Total 17.2.39</i>	

*Copy from plan 54*  
*by J. W. Wood*

ISLE OF MAN GOVERNMENT: GENERAL REGISTRY

ASYLUM PLANS: PARISH OF LONAN

Originals coloured (decorative)

1:23

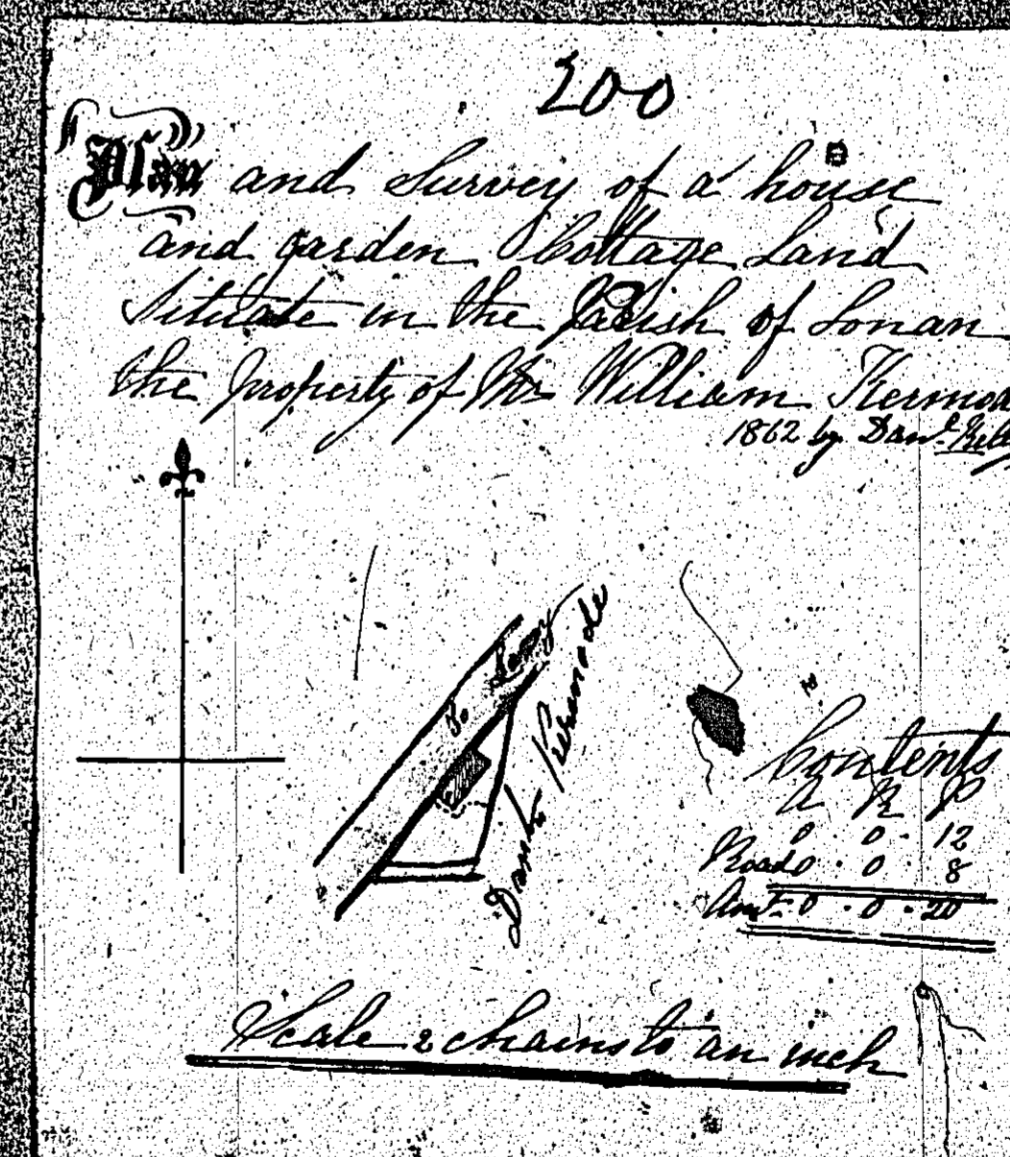
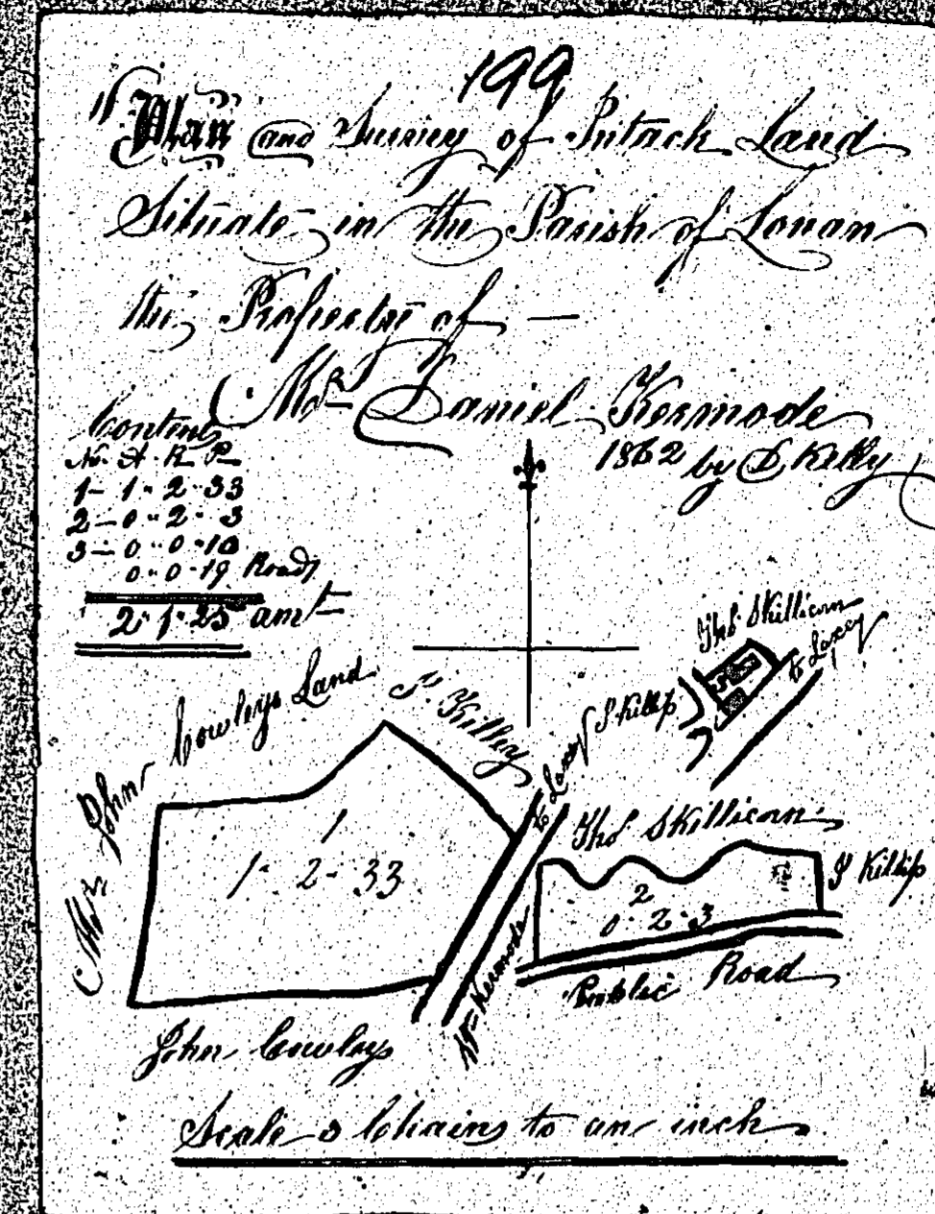

ISLE OF MAN GOVERNMENT: GENERAL REGISTRY

ASYLUM PLANS: PARISH OF LONAN

Original coloured

1:23

