

ISLE OF MAN GOVERNMENT: GENERAL REGISTRY

ASYLUM PLANS: PARISH OF LONAN

Original monotone

1:23

*Intack Land*  
*in*  
*Lonan*  
*The Property of*  
*Mr. James Callister.*

*Contents.*

<i>No</i>	<i>a. r. p.</i>
<i>1</i>	<i>3. 3. 33</i>
<i>2</i>	<i>1. 1. 26</i>
<i>3</i>	<i>1. 3. 5</i>
<i>4</i>	<i>1. 2. 17</i>
<i>5</i>	<i>2. 1. 8</i>
<i>6</i>	<i>3. 1. 34</i>
<i>7</i>	<i>1. 2. 10</i>
<i>8</i>	<i>1. 1. 6</i>
<i>9</i>	<i>10. 2. 3</i>
<i>House &amp; Basements</i>	<i>0. 0. 16</i>
<i>Total</i>	<i>28. 0. 3</i>

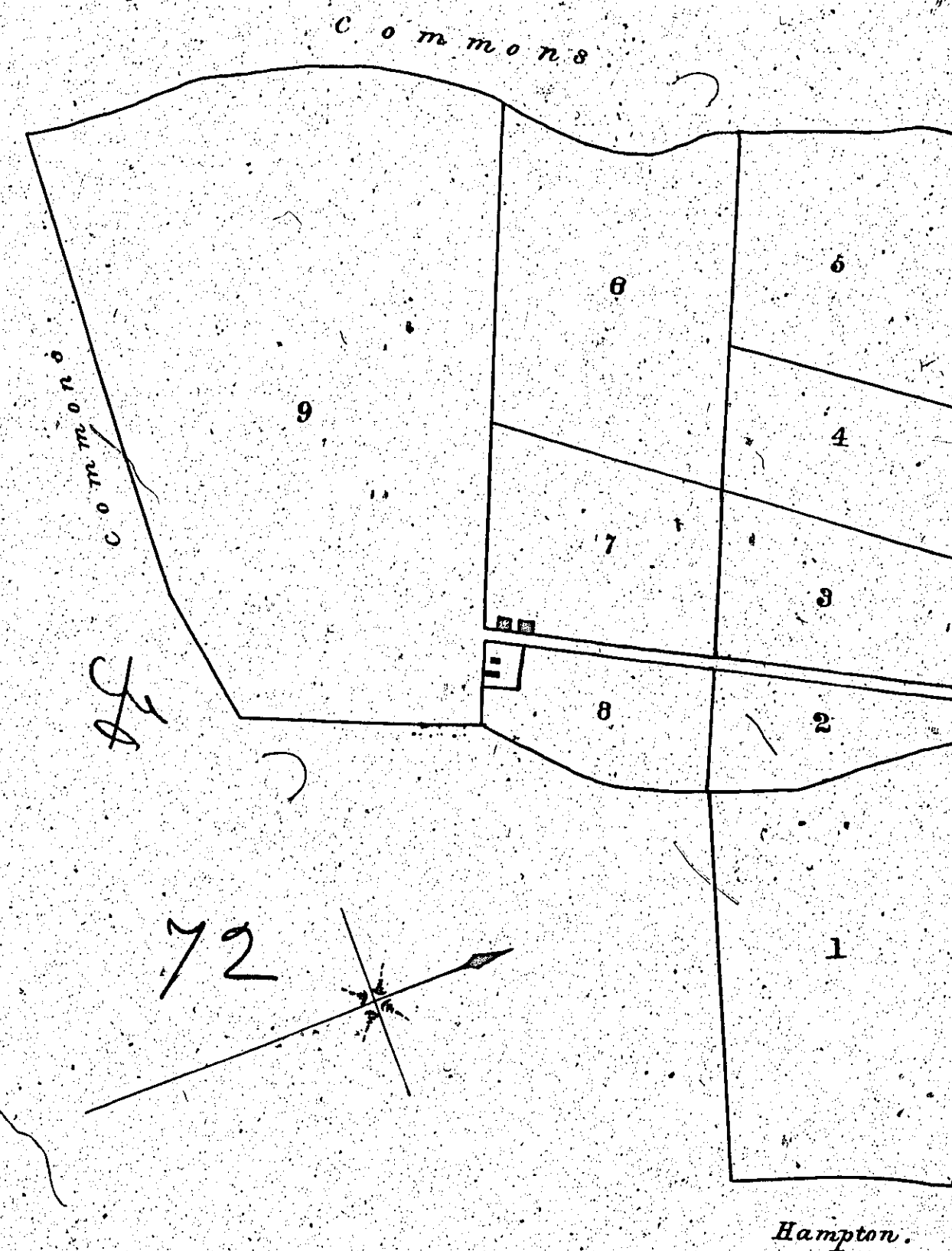

*Scale - 3 Chains to an Inch.*

*Copied from Title Plan No. 21 & 22, by Jas Woods, 1862.*

ISLE OF MAN GOVERNMENT: GENERAL REGISTRY

ASYLUM PLANS: PARISH OF LONAN

Original coloured

1:23

PART  
OF  
*Ballaglass*  
in  
LONAN  
THE PROPERTY OF  
*Mr Thomas Convin.*

Reference.

No	A. S. P.
1	1. 2. 7
2	1. 3. 36
3	2. 0. 25
4	3. 1. 33
5	3. 0. 36
6 Intack	18. 3. 37
	31. 1. 14
Proportion of Public Roads	0. 0. 00
<b>Total</b>	<b>31. 2. 4</b>

Scale 3 Chains to an Inch.  
Copied from Tithe Plan No 27, by J. Woods, 1862.

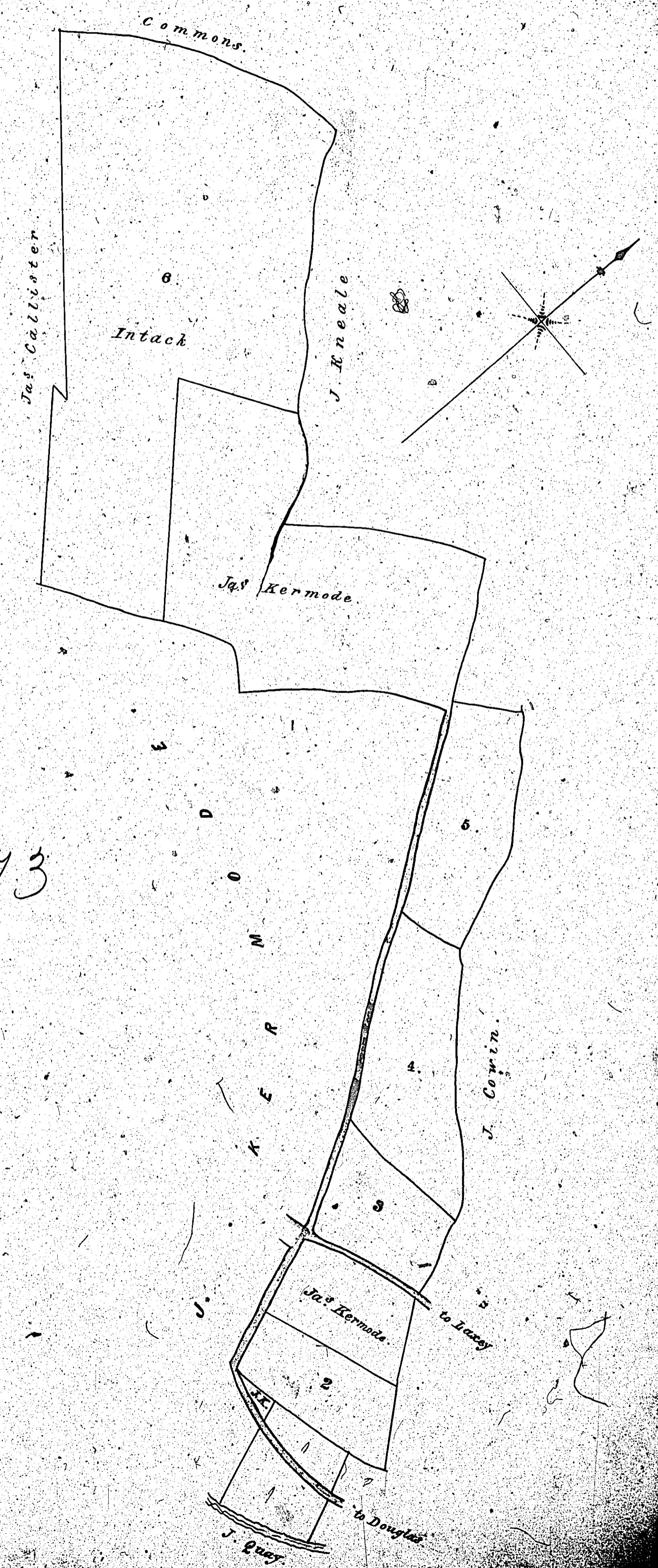

73

ISLE OF MAN GOVERNMENT: GENERAL REGISTRY

ASYLUM PLANS: PARISH OF LONAN

Original coloured

1:23

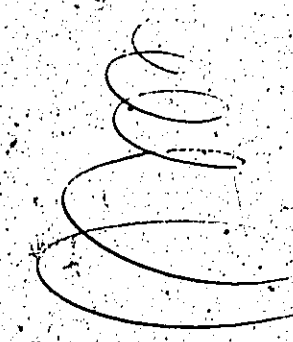
  
 PART  
 of  
*Ballaglass*  
 in  
*Lonan*  
 THE PROPERTY OF  
*Mr. J. Hermode.*

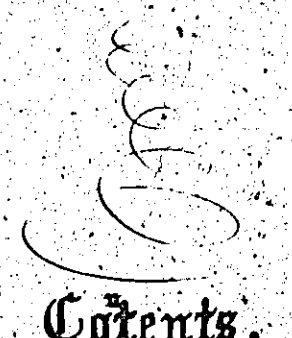
74

Contents.

No	a. r. p.
1	1. 0. 9
2	1. 3. 22
3	1. 3. 19
4	1. 2. 10
5	1. 1. 36
6	3. 3. 36 Houses, Gardens, & Basements included.
7	1. 1. 24
8	2. 1. 14
9	2. 0. 0
10	3. 3. 15
11	1. 2. 16
12 <i>Intack</i>	<del>4. 1. 2</del>
	27. 1. 3
Proportion of Public Roads	0. 1. 0
<b>Total</b>	<b>27. 2. 3</b>

Houses & Basements - 1. 3. 76

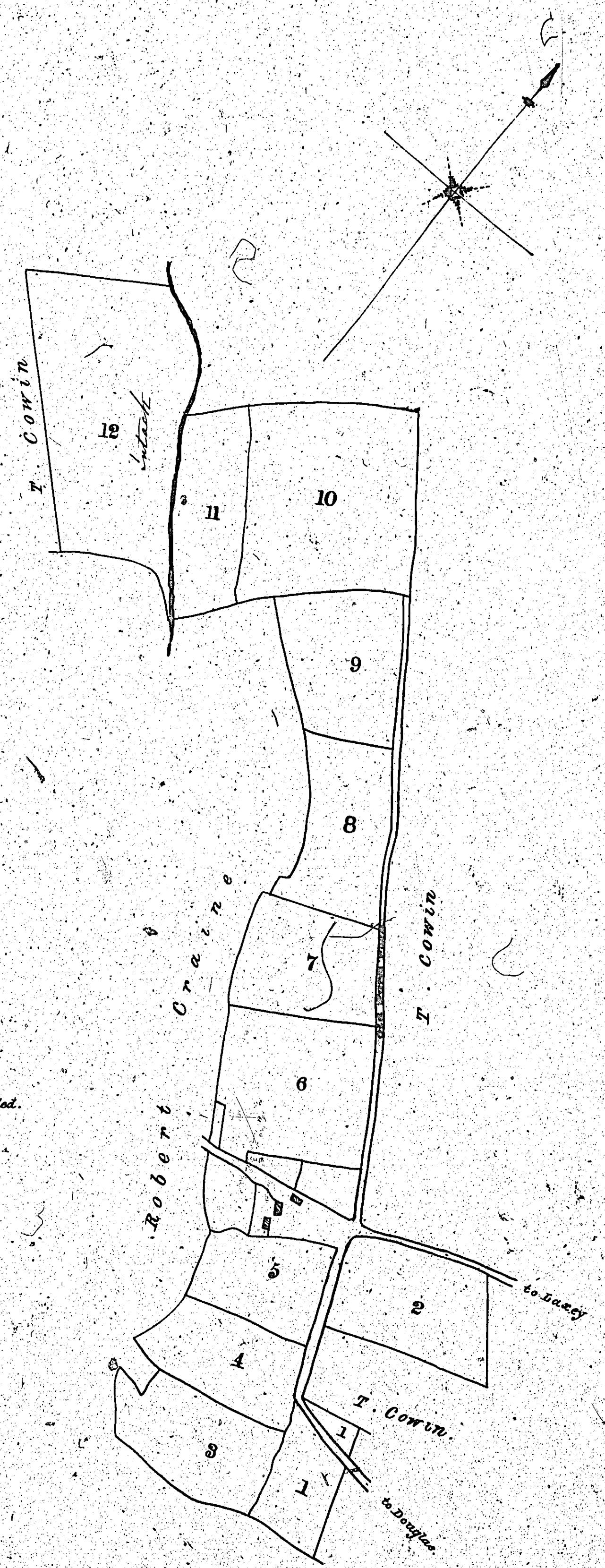

Scale - 5 Chains to an Inch.  
 Copied from *Itha Plan N° 27*, by J. Woods, 1862.

ISLE OF MAN GOVERNMENT: GENERAL REGISTRY  
 ASYLUM PLANS: PARISH OF LONAN

Original coloured

1:23

Part of <sup>26</sup>  
 Ballaglass  
 in  
 Lonan  
 The Property of  
 Mr. P. Kaneen.

Contents.

No.	a. r. p.
1	1. 0. 50 1/2
2	2. 3. 7
3	1. 0. 3
4	3. 2. 33
Total	8. 2. 33 1/2

Scale - 3 Chains to an Inch.

Copied from Title Plan N<sup>o</sup> 28, by Jas<sup>s</sup> Woods, 1862.

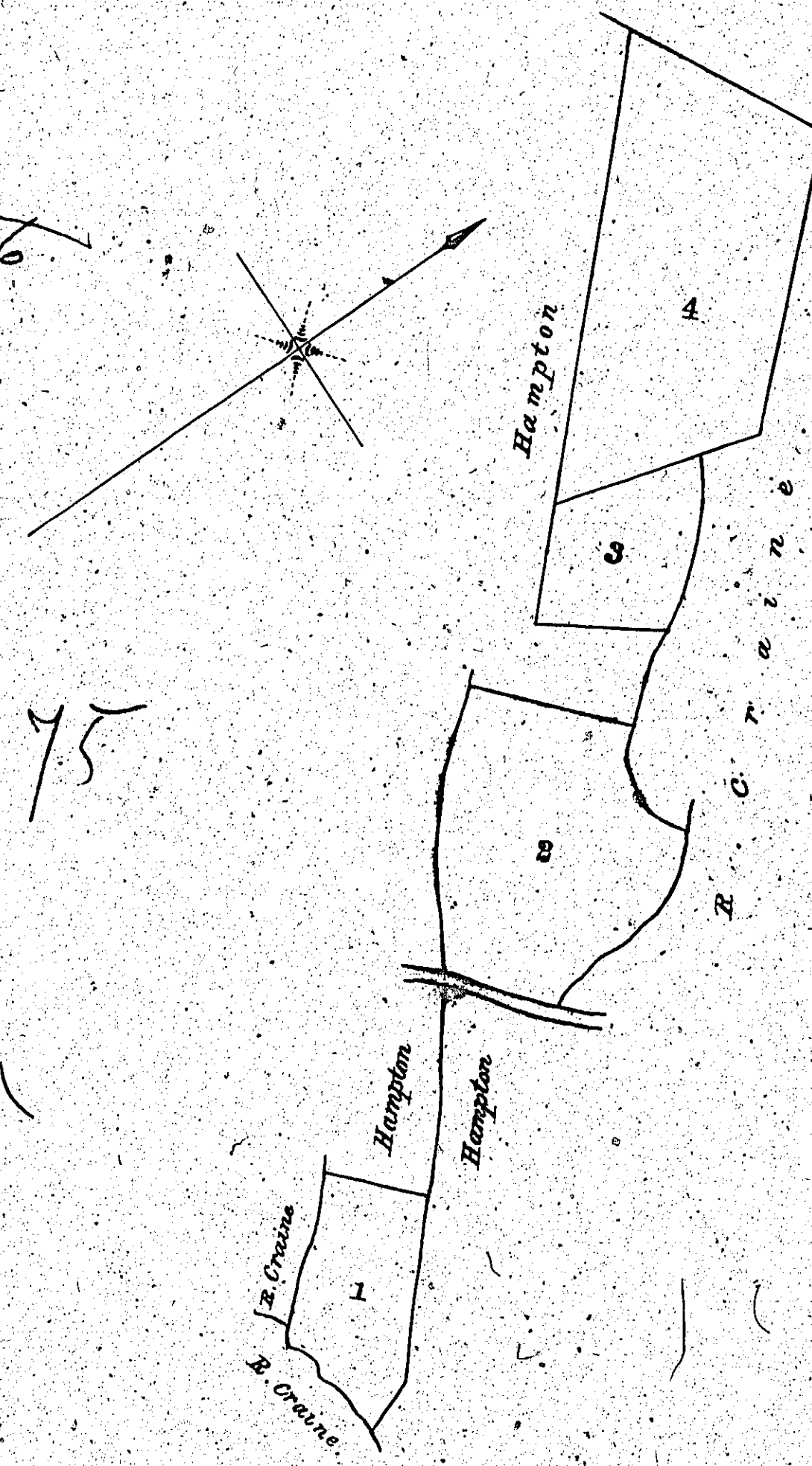

ISLE OF MAN GOVERNMENT: GENERAL REGISTRY

ASYLUM PLANS: PARISH OF LONAN

Original coloured

1:23

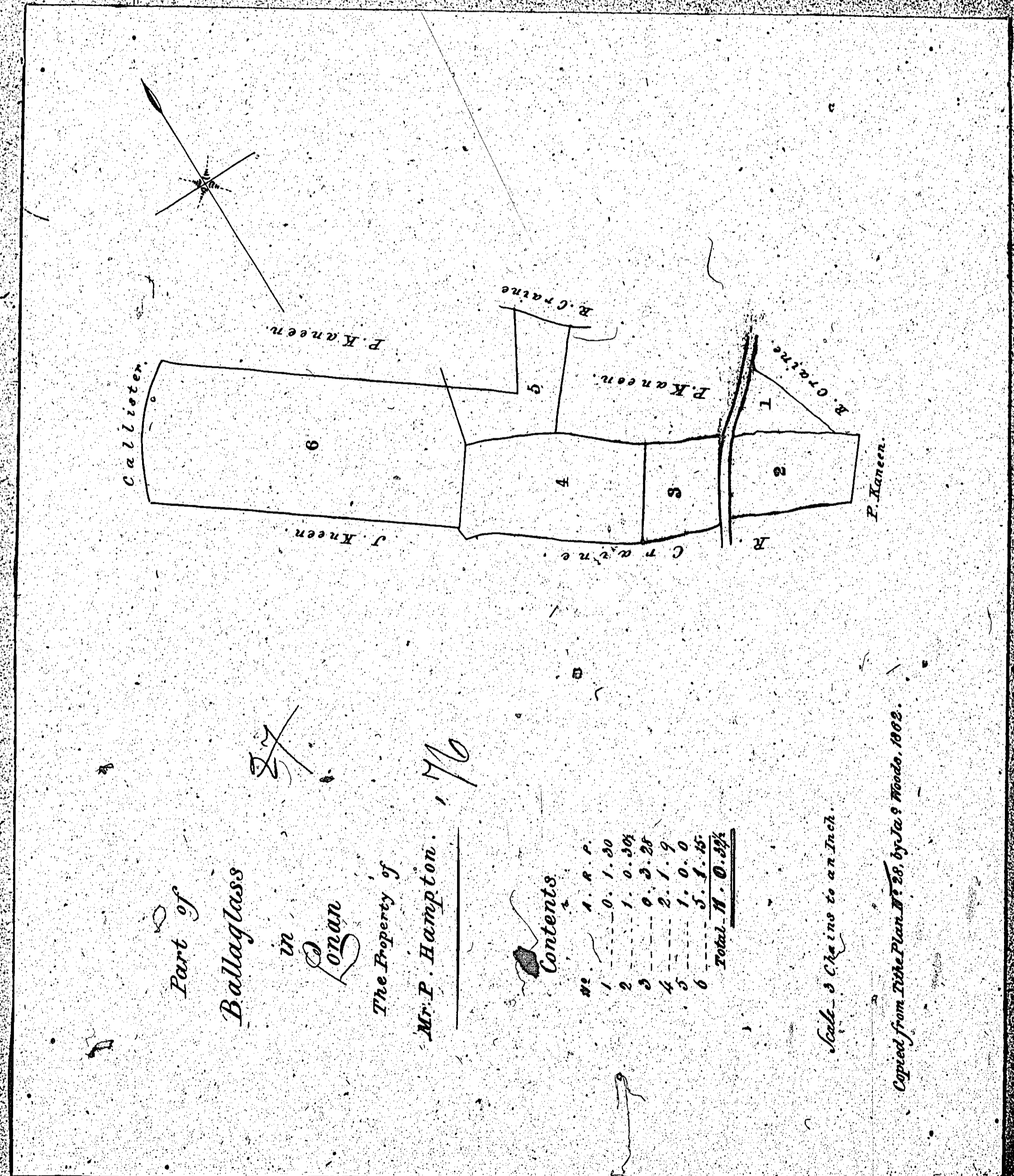

ISLE OF MAN GOVERNMENT: GENERAL REGISTRY  
 ASYLUM PLANS: PARISH OF LONAN

Original coloured

1:23

