

ISLE OF MAN GOVERNMENT: GENERAL REGISTRY

ASYLUM PLANS: PARISH OF LEZAYRE

Original monotone

1:23



ISLE OF MAN GOVERNMENT: GENERAL REGISTRY

ASYLUM PLANS: PARISH OF LEZAYRE

Original monotone

1:23

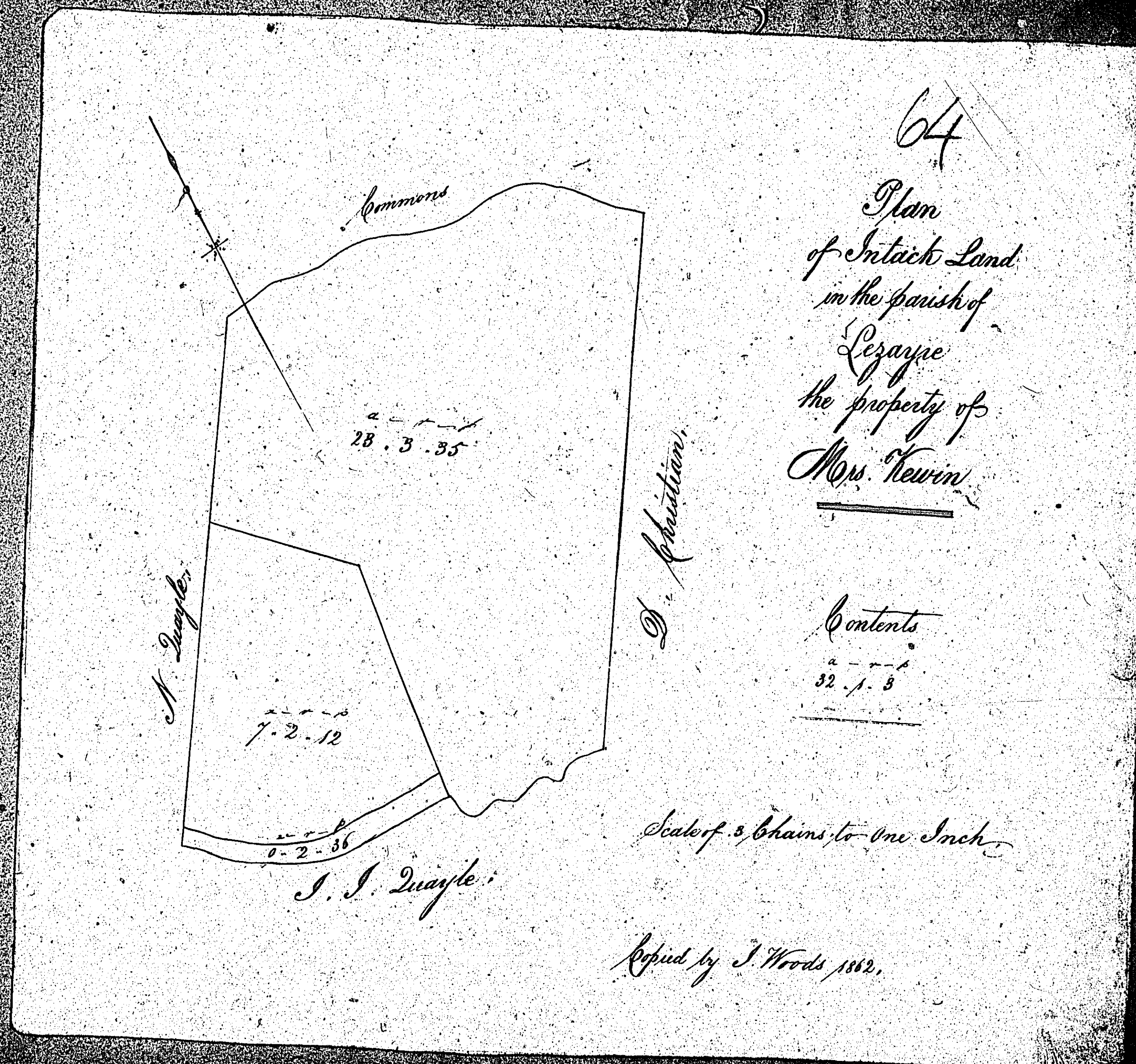

ISLE OF MAN GOVERNMENT: GENERAL REGISTRY

ASYLUM PLANS: PARISH OF LEZAYRE

Original coloured

1:23

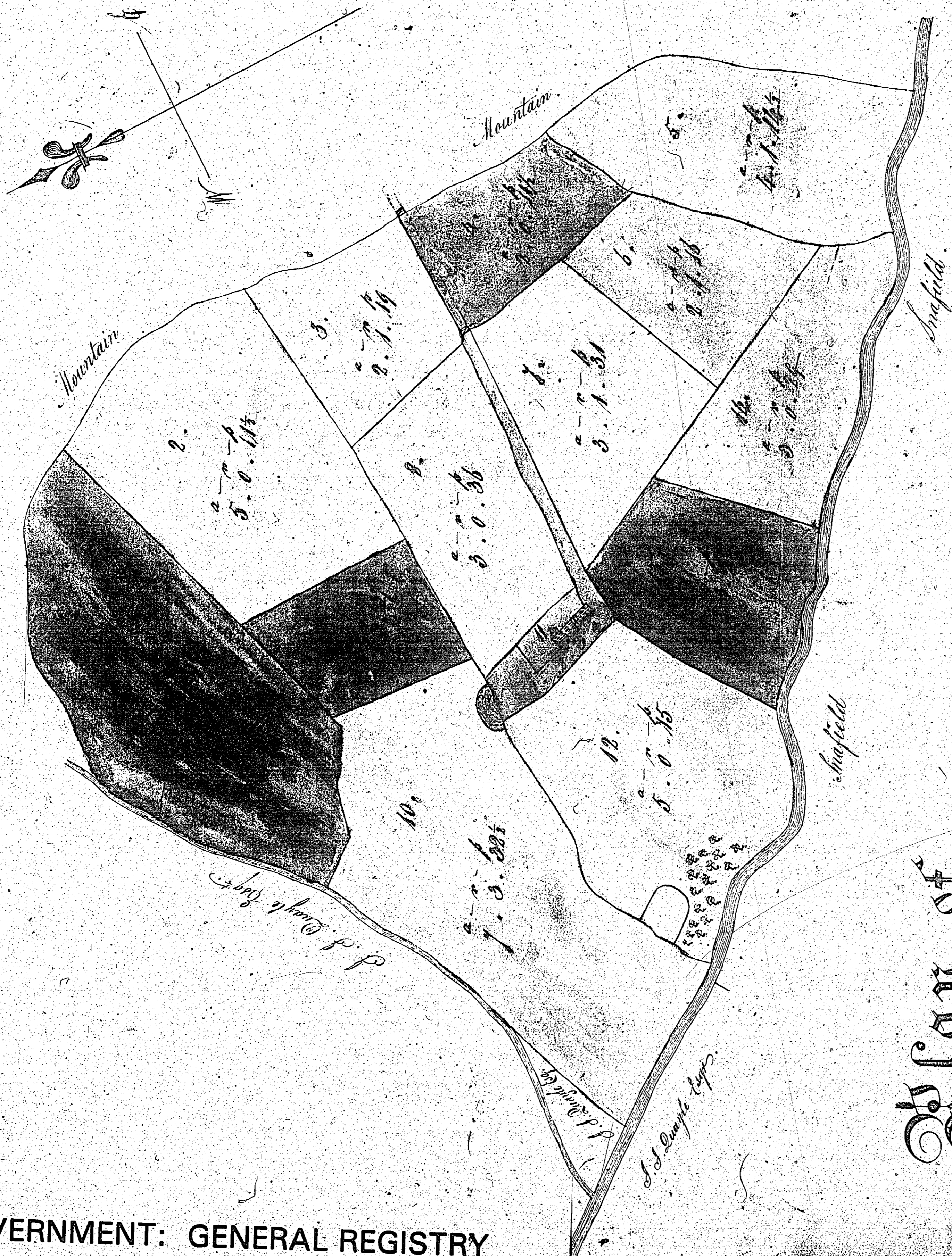

65

Contents.	
No.	Acres
1	1 1/2
2	1 1/2
3	1 1/2
4	1 1/2
5	1 1/2
6	1 1/2
7	1 1/2
8	1 1/2
9	1 1/2
10	1 1/2
11	1 1/2
12	1 1/2
13	1 1/2
14	1 1/2
Total	14 1/2
St. Quaye's Cross	1 1/2
St. Quaye's Cross	1 1/2

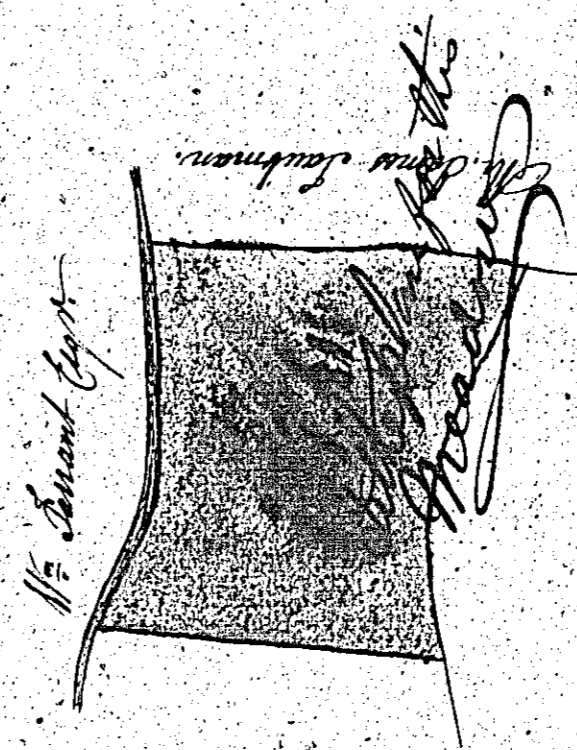

65

PLAN OF BLOCKERY

Being a Plan, in the Parish of

LEZAYRE

the Property of
Mr. William Quaye

Scale of 2 Chains to one Inch.

W. Quaye
Surveyor

ISLE OF MAN GOVERNMENT: GENERAL REGISTRY
 ASYLUM PLANS: PARISH OF LEZAYRE

Original coloured

1:23

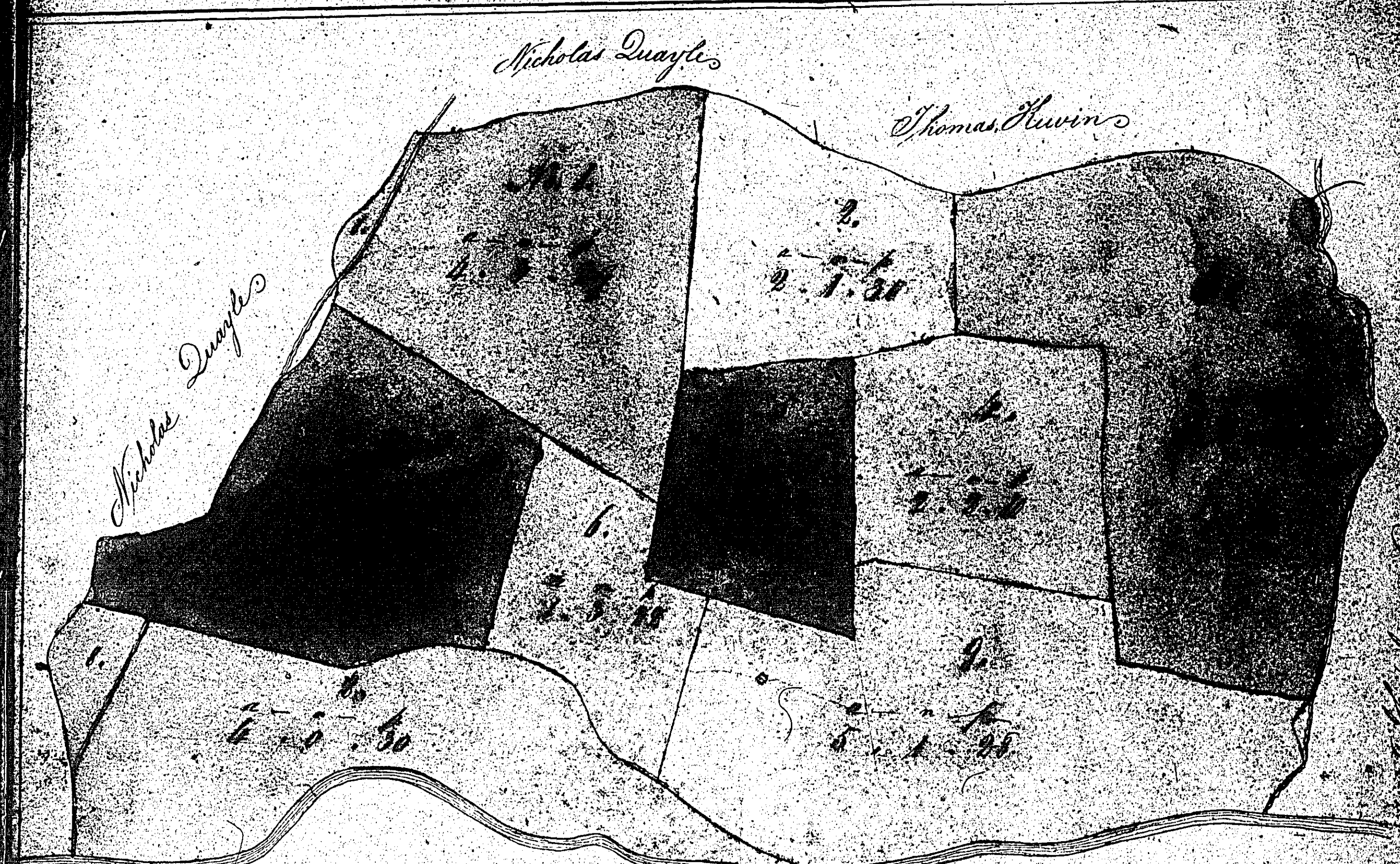

Plan
 of part of the Quarterland of
 S. LIEU MEANAGH, called
BWOILLEY GLASS
 in the Parish of
LEZAYRE
 the Property of
 Mr. John Quayle.

(66)

Contents.

N	a	r	p
1	4	3	24
2	2	1	54
3	4	8	30
4	2	2	10
5	2	0	6
6	1	3	32
7	4	1	30
8	4	0	34
9	5	1	28
<i>Total</i>			<i>36 3 14</i>

Scale of 2 Chains to One Inch

Wm. Meade Surveyor 1861.

The following plan
is not numbered
but 67 is
pencilled on the back