

ISLE OF MAN GOVERNMENT: GENERAL REGISTRY

ASYLUM PLANS: PARISH OF BRIDE

Original monotone

1:23

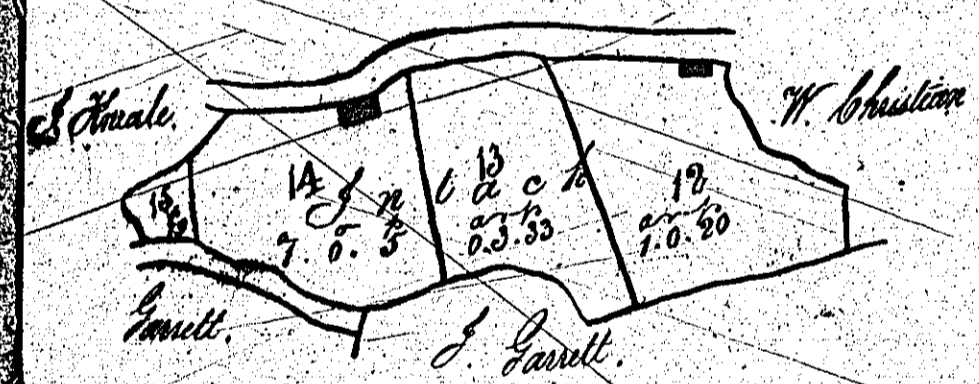
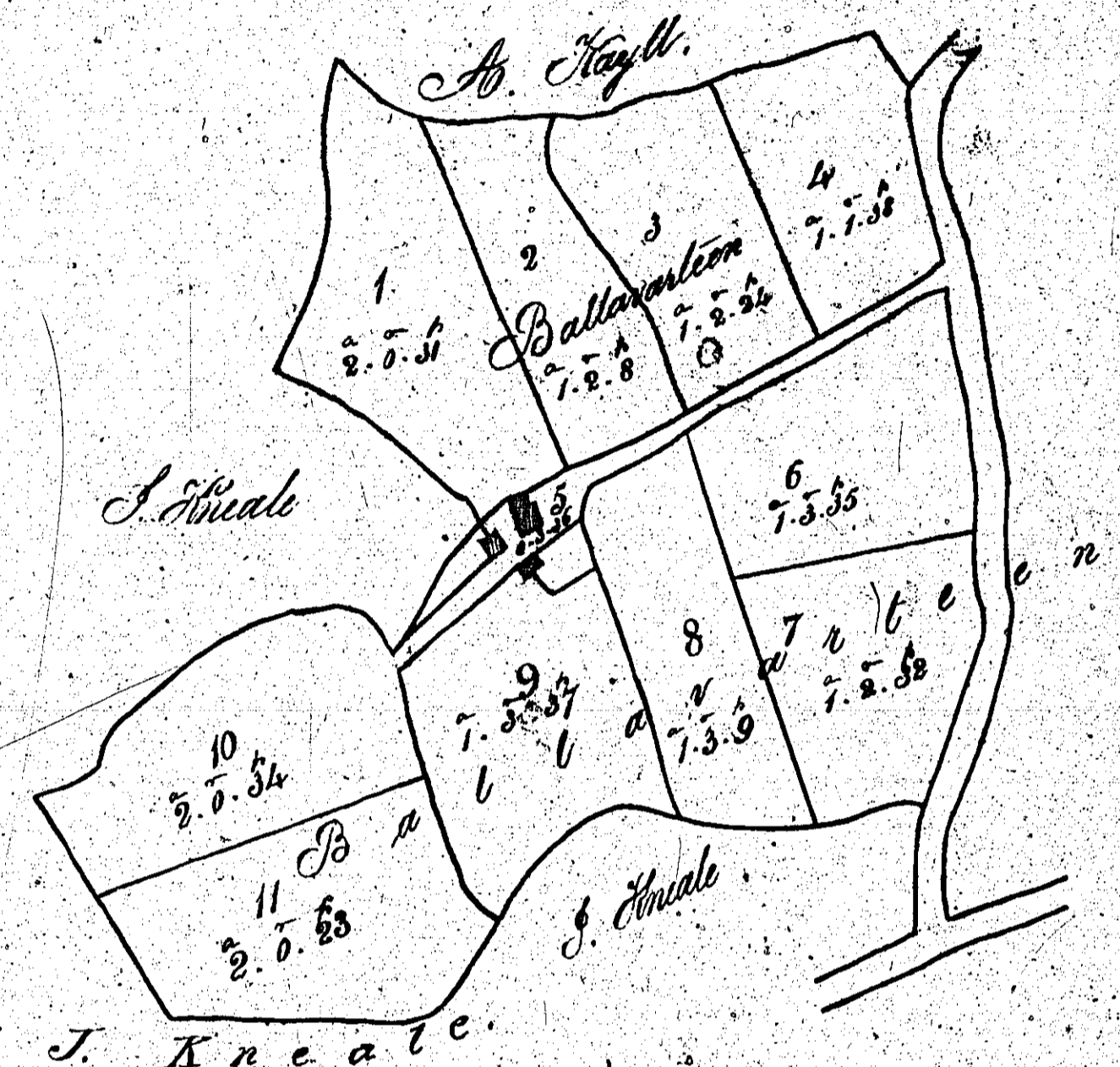

Arable	19.1.37
Orchard	3.0.17
Roads	2.5
Total	25.0.17

Scale - 3 chains to an Inch

Noted from Bride plan  
17047 by R. H. G. 1861

Part of Ballawarteen  
and an Orchard  
in  
Bride  
Surveyed by  
J. Shaw







There are two plans  
 numbered 34  
 on the following page

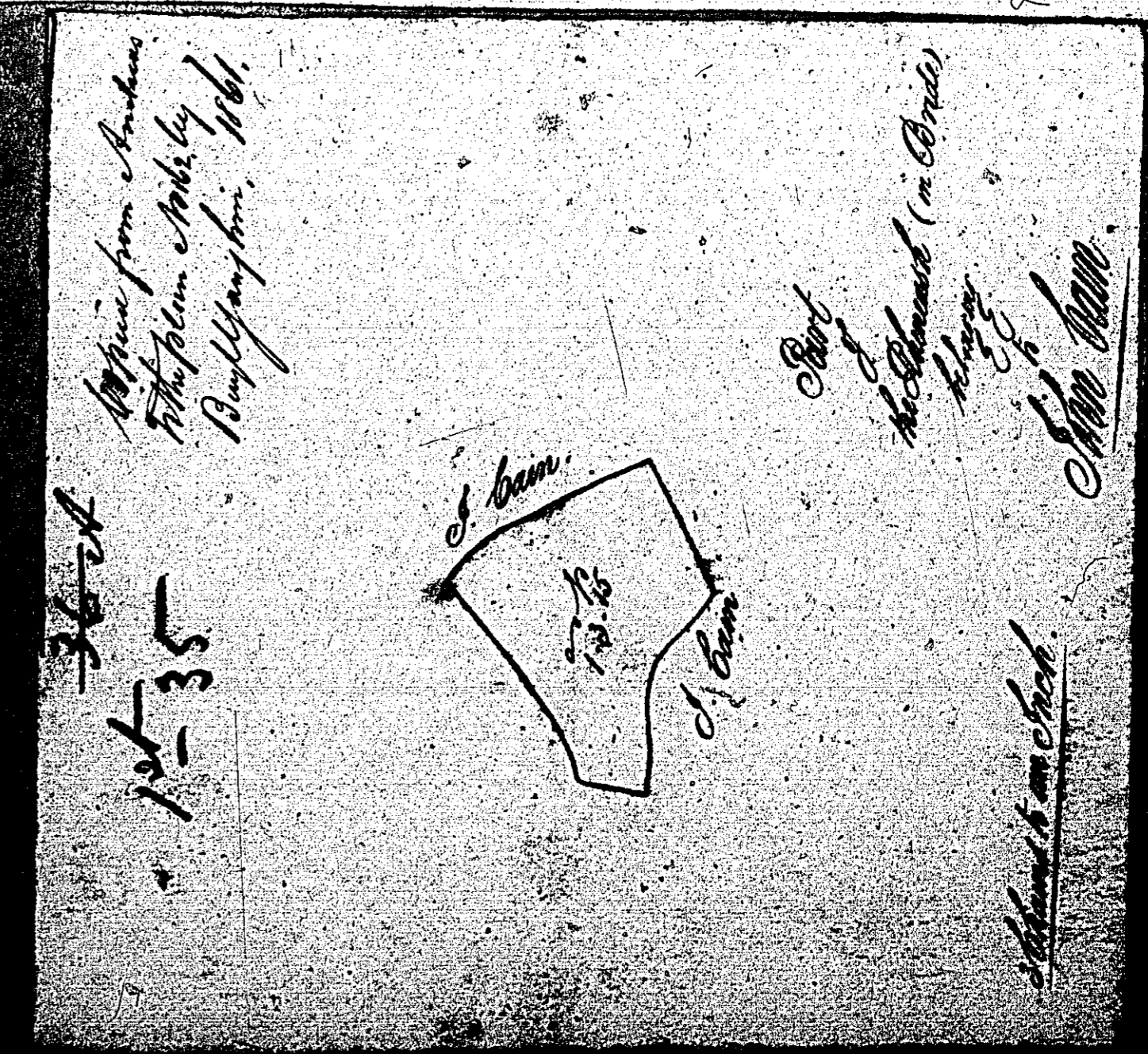
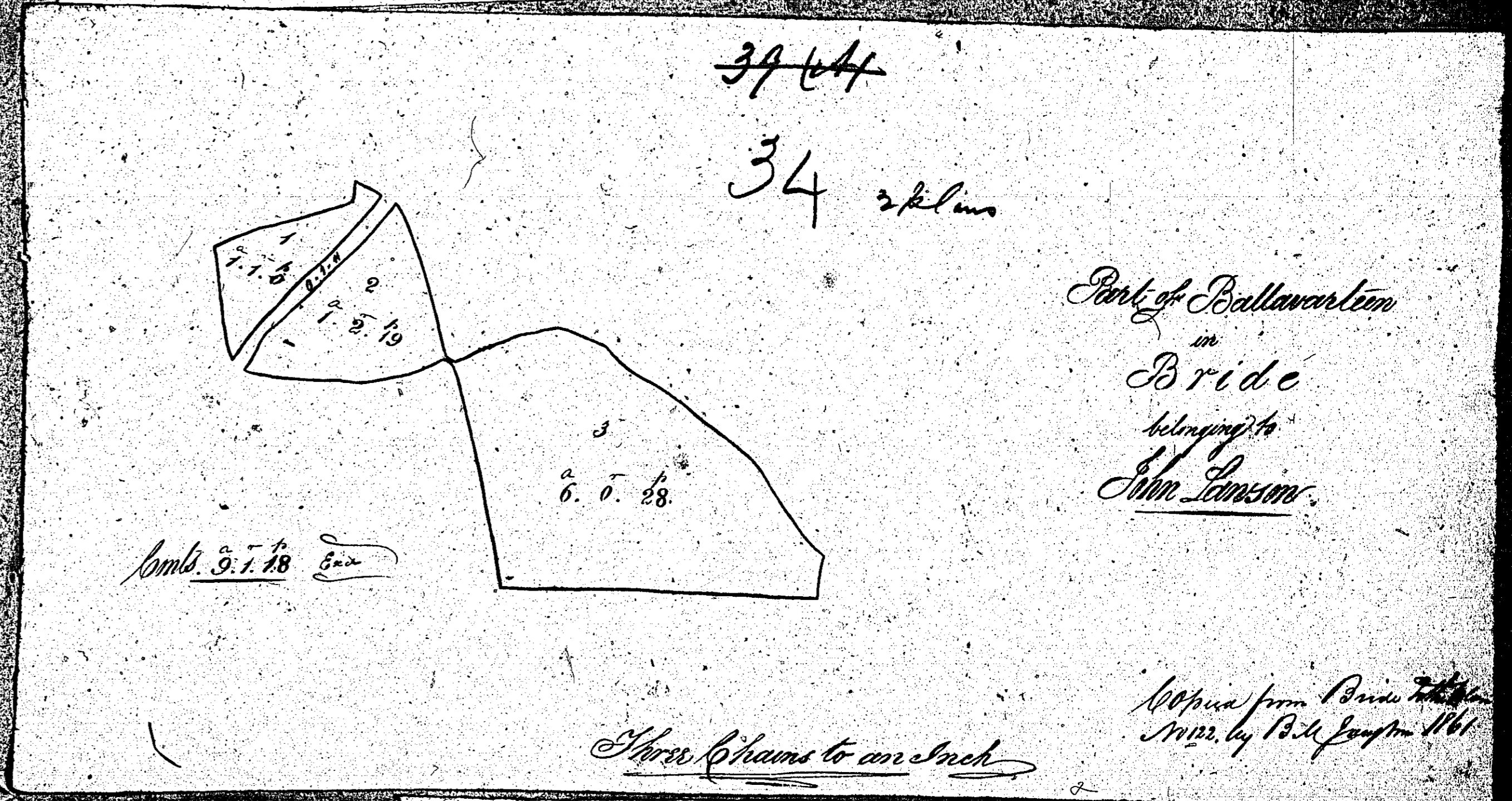
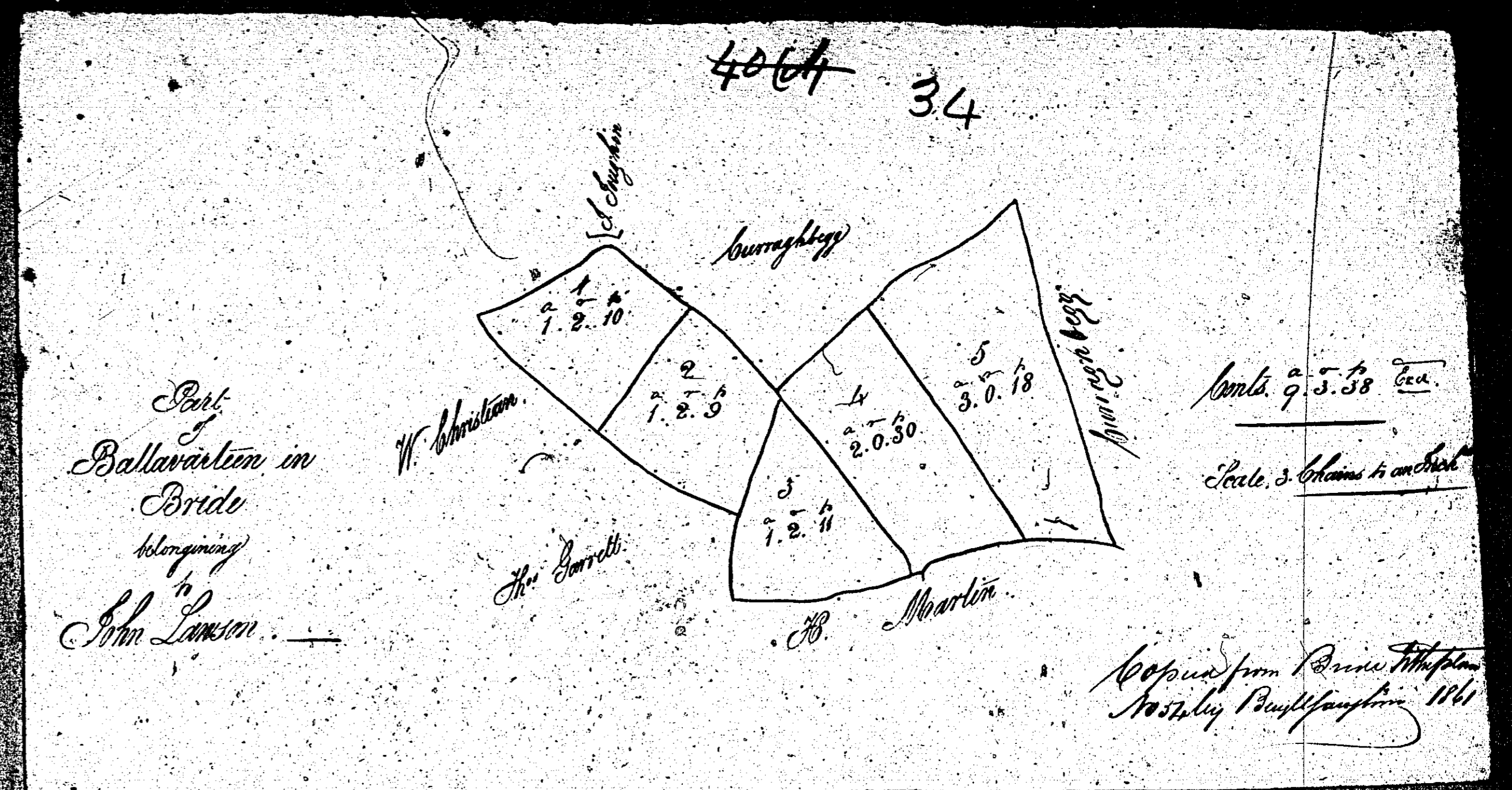

ISLE OF MAN GOVERNMENT: GENERAL REGISTRY

ASYLUM PLANS: PARISH OF BRIDE

Originals monotone

1:23



The following two  
plans are also  
numbered

35

ISLE OF MAN GOVERNMENT: GENERAL REGISTRY

ASYLUM PLANS: PARISH OF BRIDE

Originals monotone

1:23

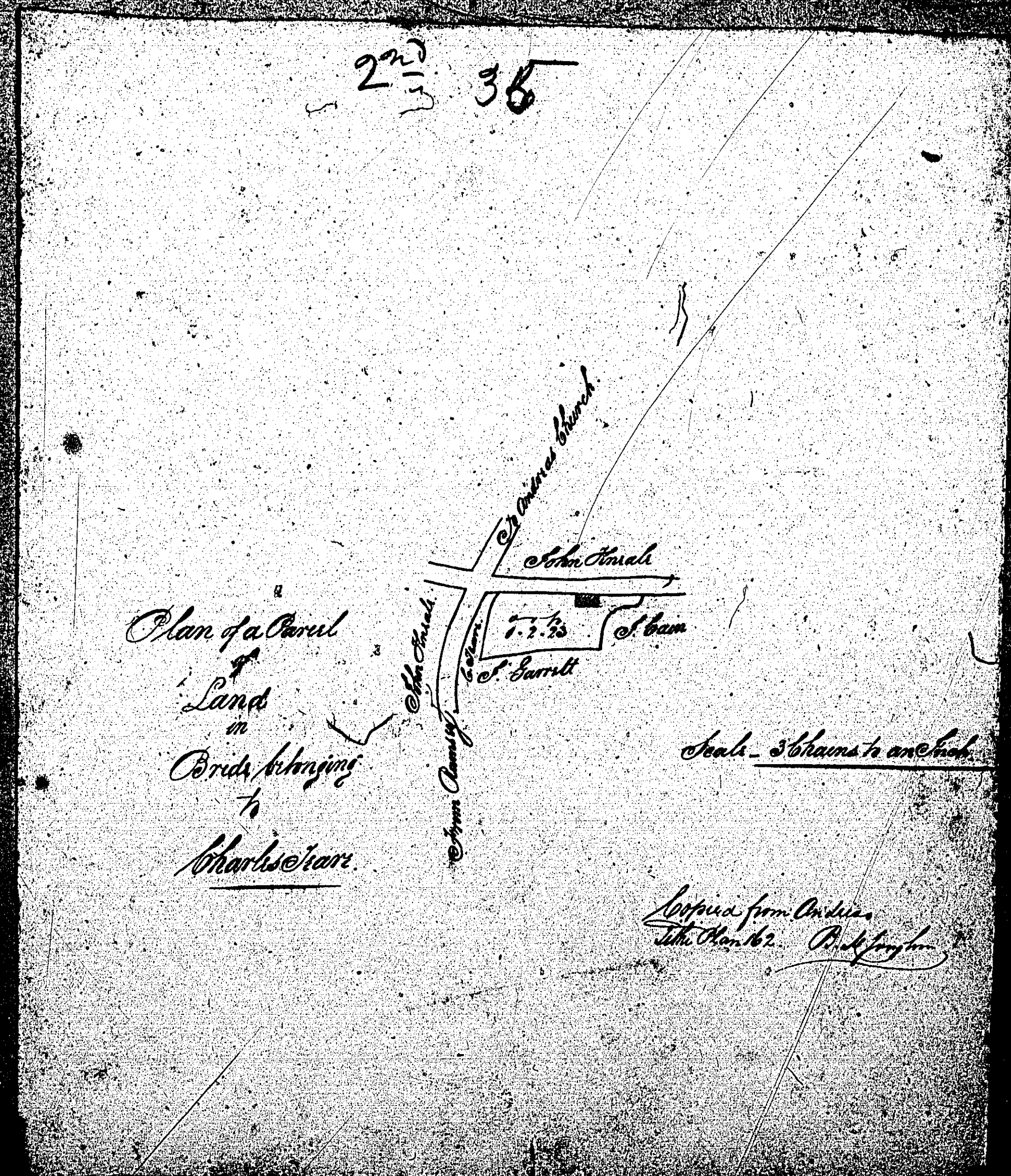
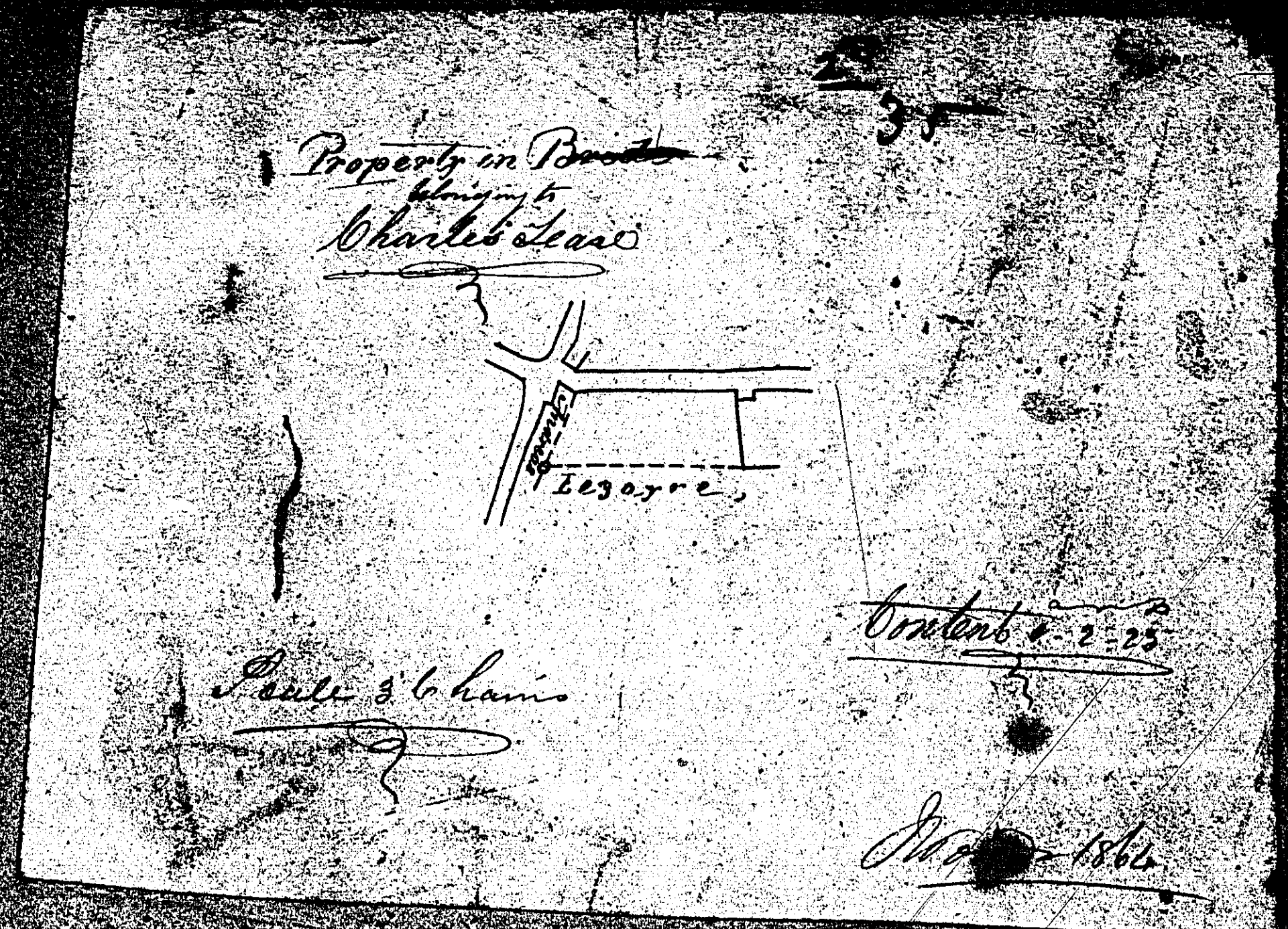







There is no plan

numbered

37

ISLE OF MAN GOVERNMENT: GENERAL REGISTRY

ASYLUM PLANS: PARISH OF BRIDE

Originals monotone

1:23

