

ISLE OF MAN GOVERNMENT: GENERAL REGISTRY.

ASYLUM PLANS: PARISH OF BALLAUGH

Original coloured

1:23

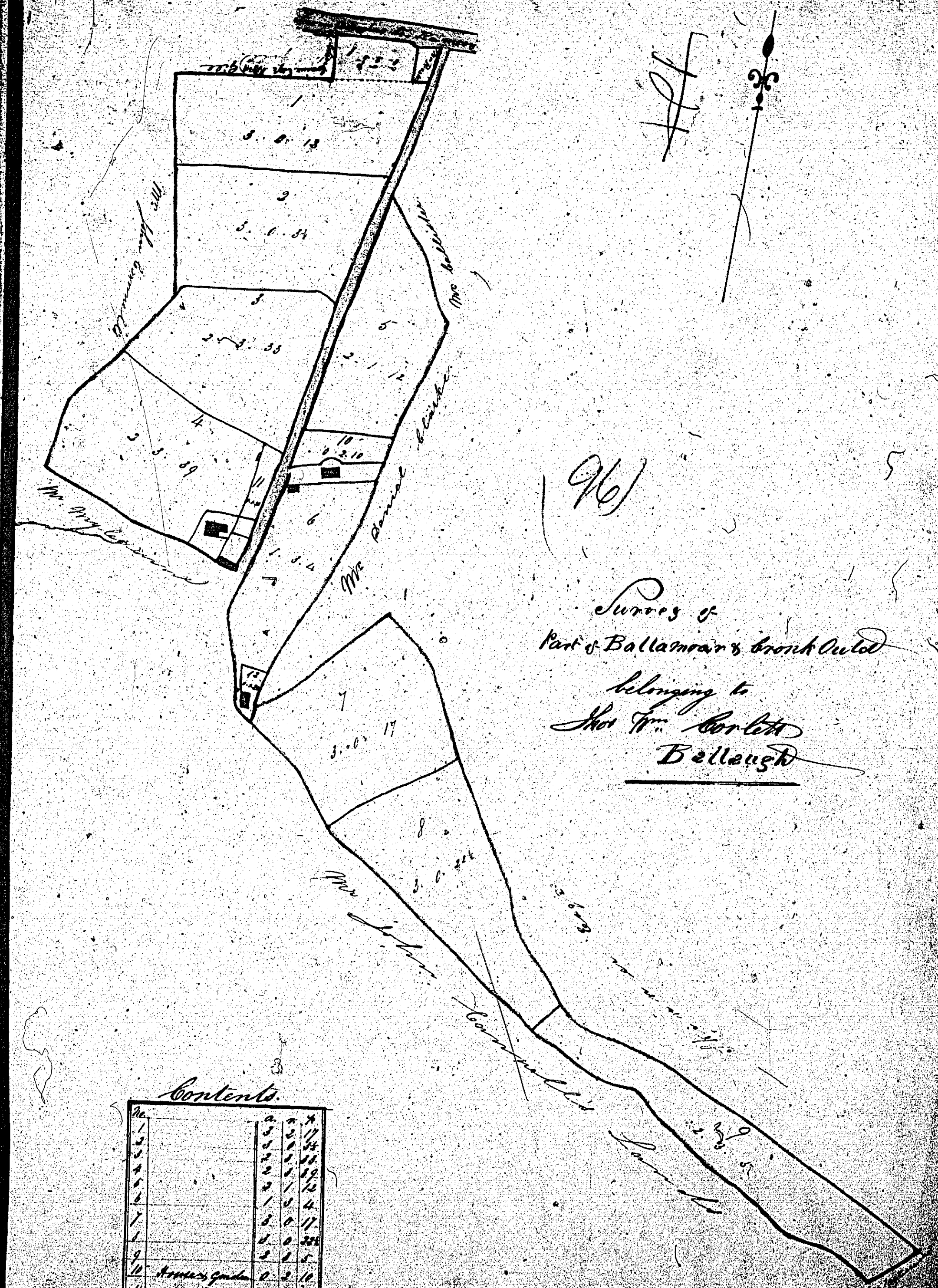

ISLE OF MAN GOVERNMENT: GENERAL REGISTRY

ASYLUM PLANS: PARISH OF BALLAUGH

Original coloured (decorative)

1:23

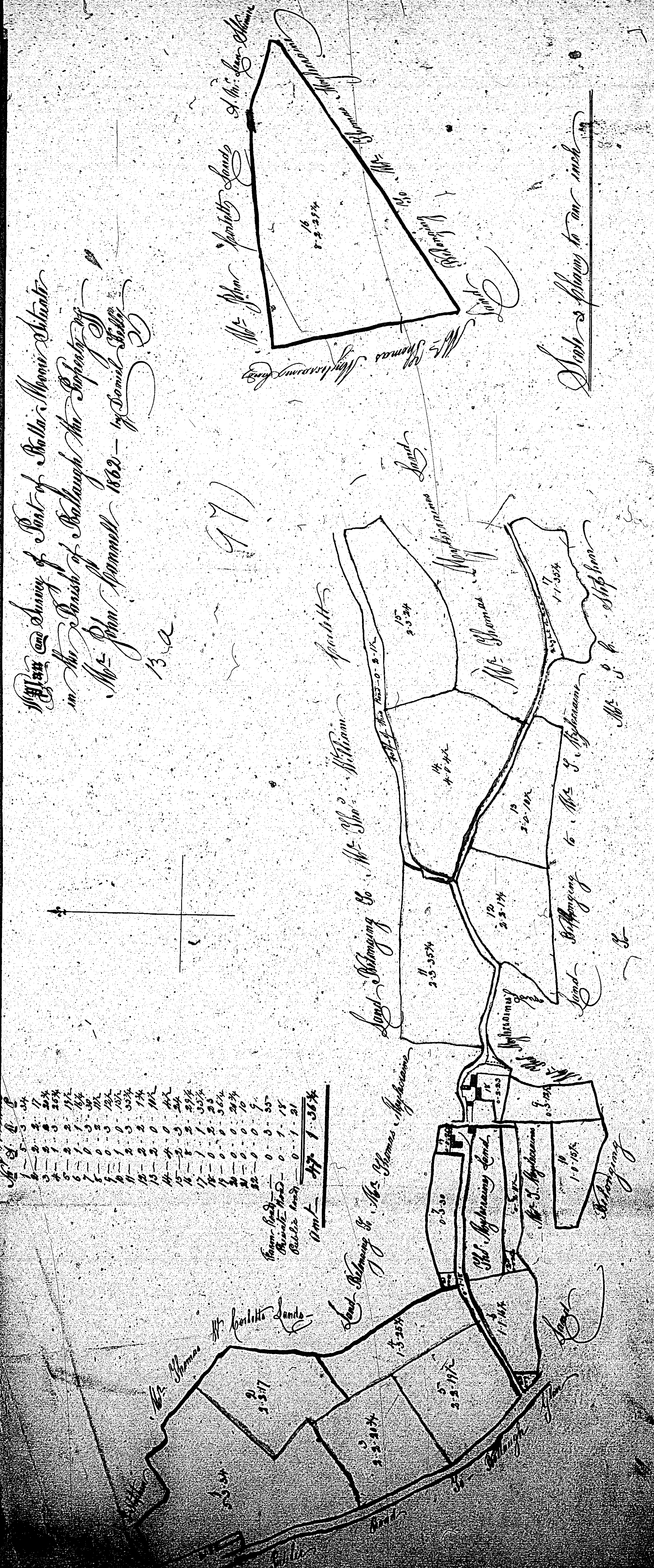

Ballaugh Plan

ISLE OF MAN GOVERNMENT: GENERAL REGISTRY
ASYLUM PLANS: PARISH OF BALLAUGH

Original coloured (decorative)

1:23

*Plan and Survey of Part of the Estate of
John Brown Esq. Situated in the Parish of
Ballaugh the Property of
Mrs. Thomas Stephens
1822 by Daniel Sully*

Contents

<i>No. 1. A. & B.</i>
<i>1. 0. 5. 38 1/2</i>
<i>2. 1. 0. 6 1/2</i>
<i>3. 5. 7. 4. 1. 14 1/2</i>
<i>5. 0. 5. 34 1/2</i>
<i>6. 2. 0. 30 1/2</i>
<i>7. 5. 10. 2. 2. 12</i>
<i>9. 5. 10. 5. 0. 11 1/2</i>
<i>11. 12. 15. 6. 5. 31</i>
<i>14. 8. 1. 38 1/2</i>
<i>15. 0. 1. 36</i>
<i>16. 0. 0. 20</i>
<i>17. 51. 0. 33 1/2</i>

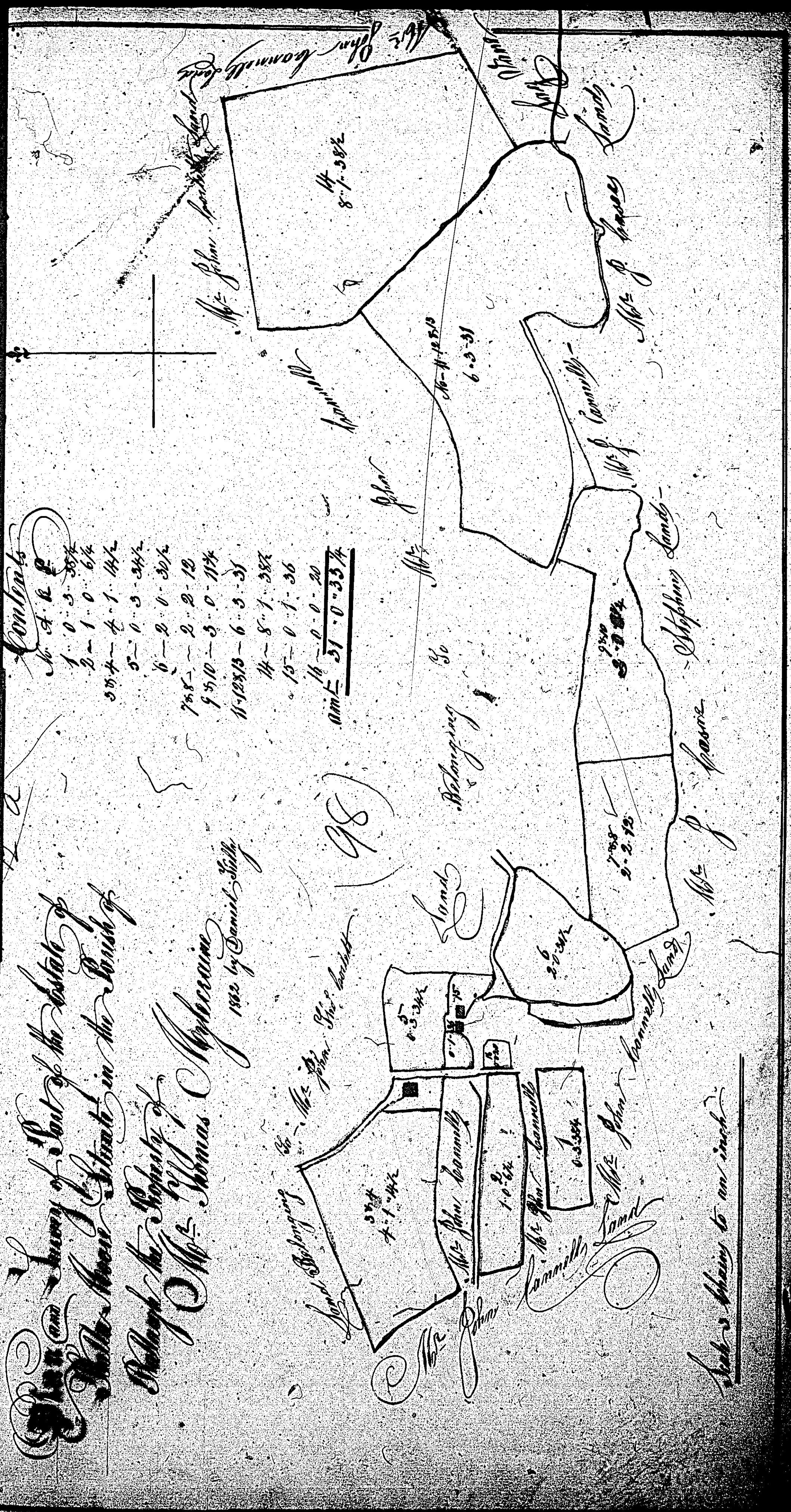

Scale 1 inch to 100 feet

ISLE OF MAN GOVERNMENT: GENERAL REGISTRY

ASYLUM PLANS: PARISH OF BALLAUGH

- 99 Original coloured
- 100 Original monotone

1:23

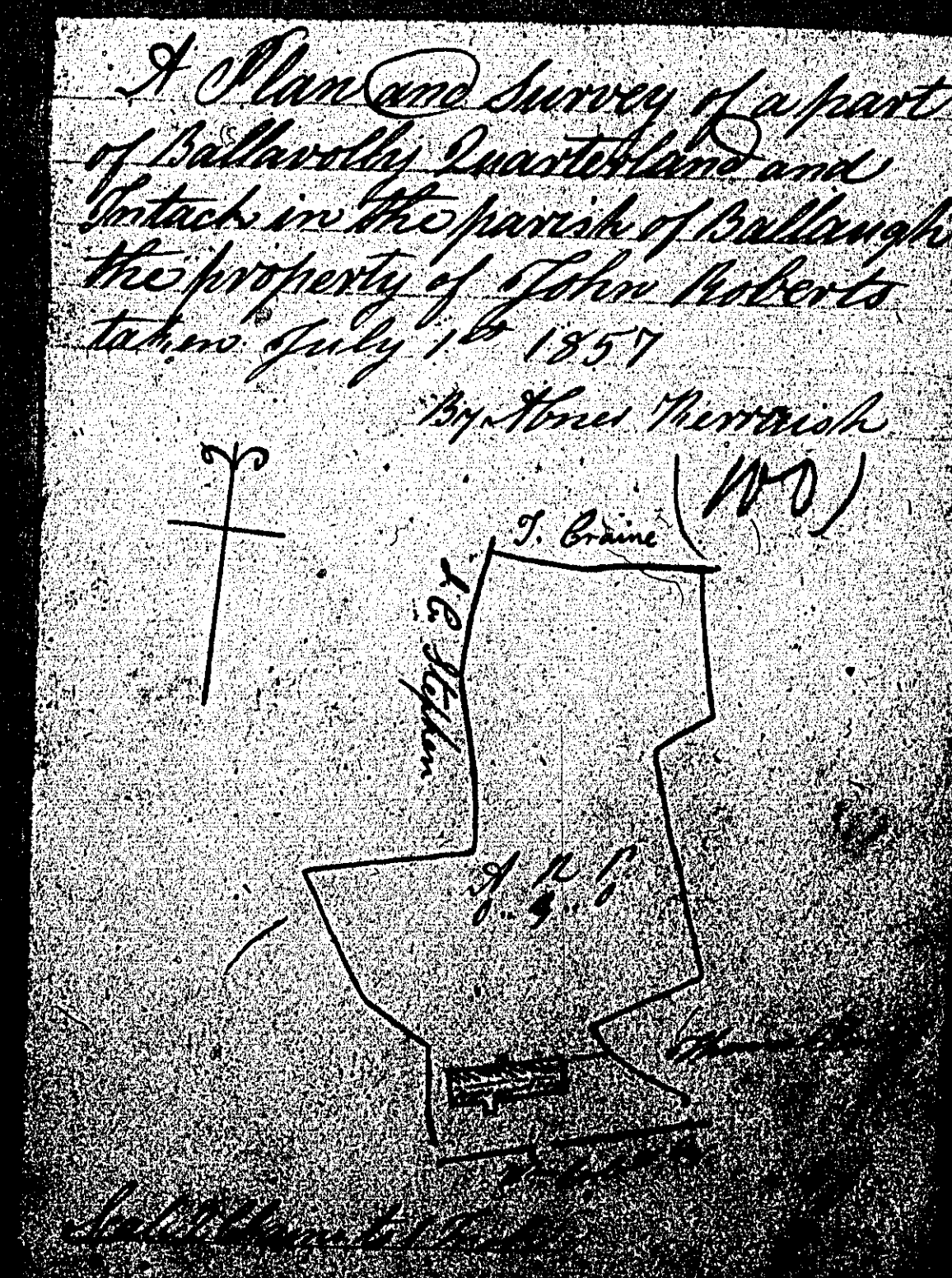
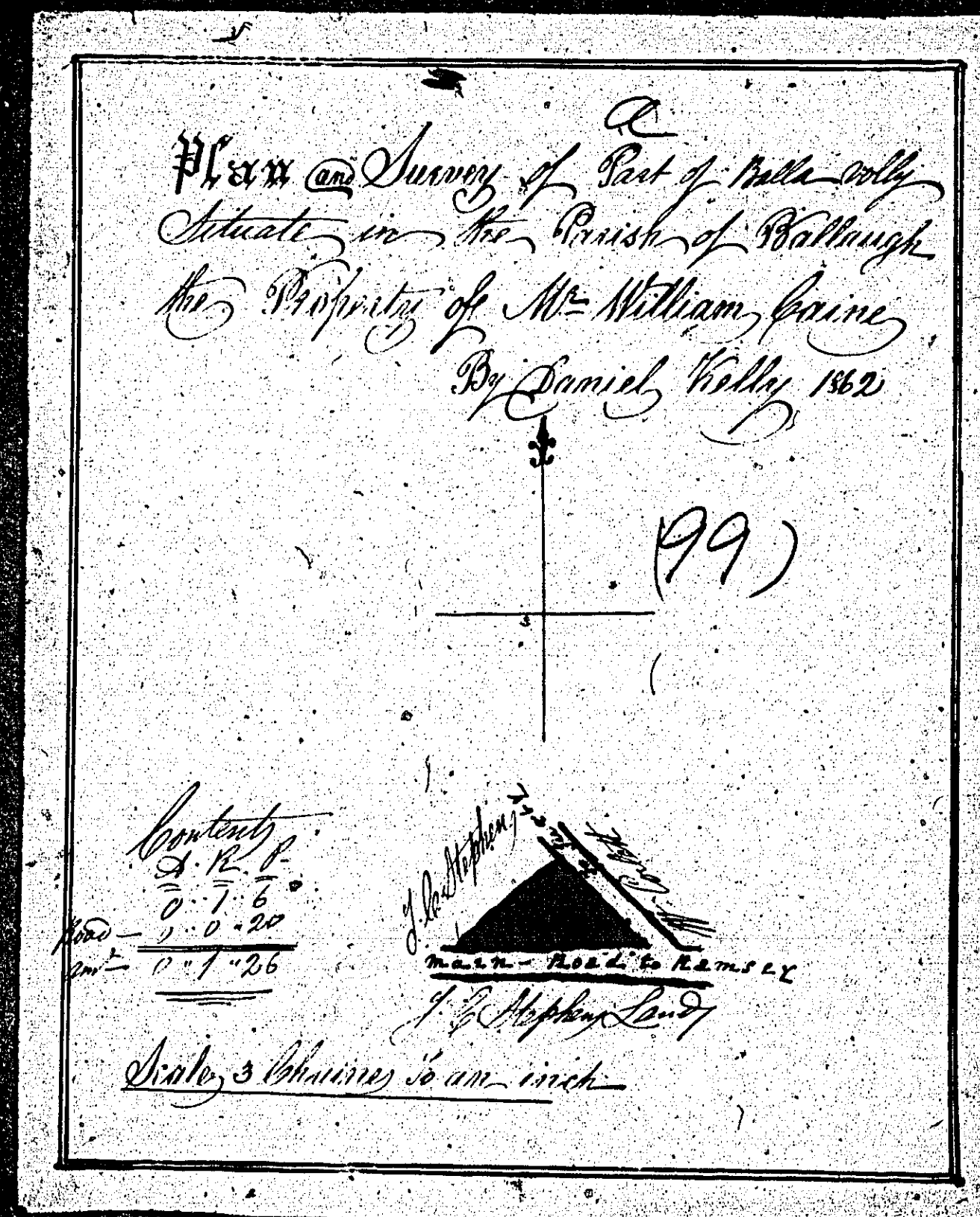

ISLE OF MAN GOVERNMENT: GENERAL REGISTRY

ASYLUM PLANS: PARISH OF BALLAUGH

1:23

101 Original coloured (decorative)

102 Original coloured

