

ISLE OF MAN GOVERNMENT: GENERAL REGISTRY

ASYLUM PLANS: PARISH OF BALLAUGH

Original monotone

1:23

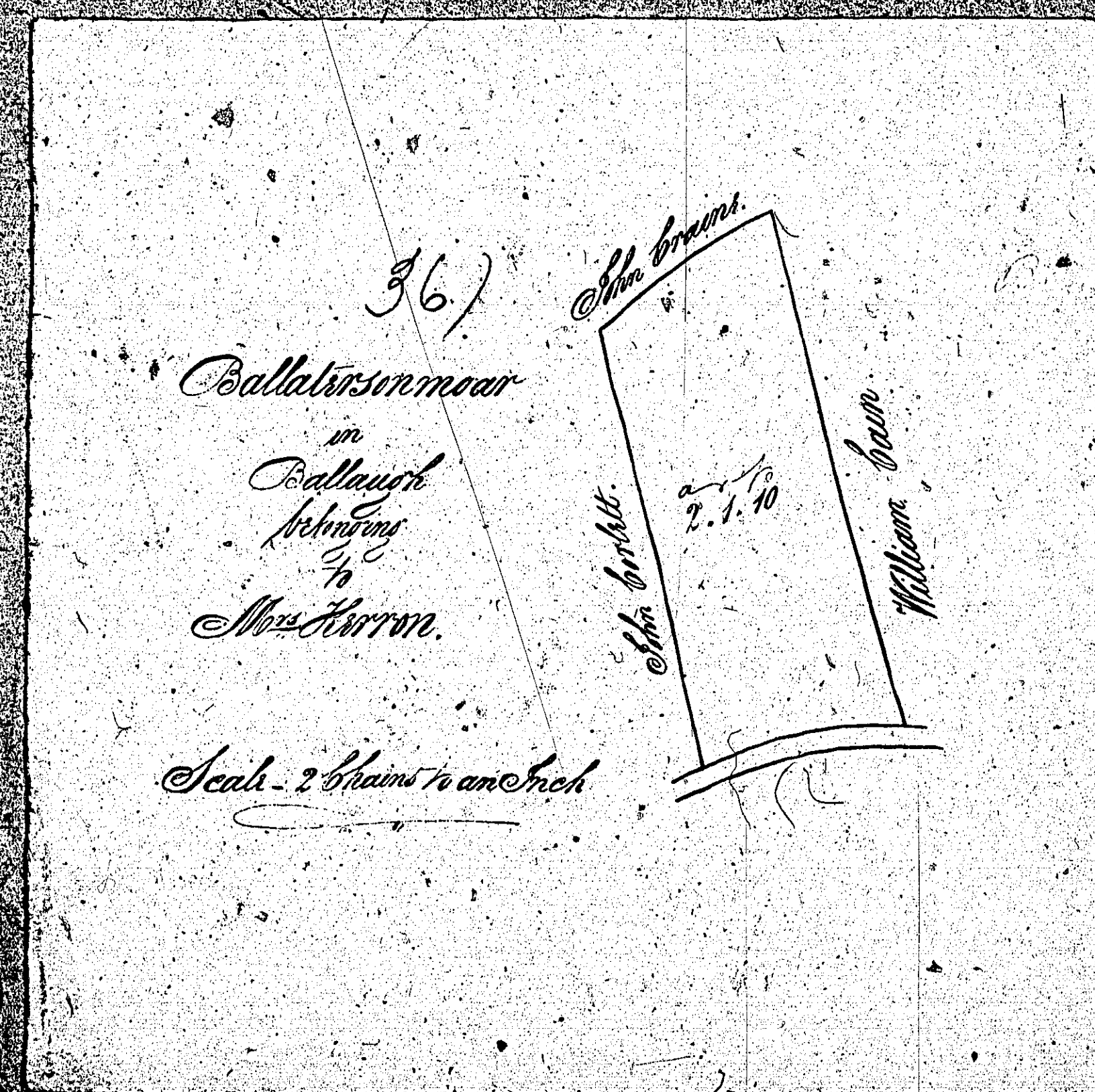

No plan numbered 37

but pencilled note

saying plan 37

is included in

Tithe Plan 99

~~37~~

ISLE OF MAN GOVERNMENT: GENERAL REGISTRY

ASYLUM PLANS: PARISH OF BALLAUGH

Original coloured

1:23

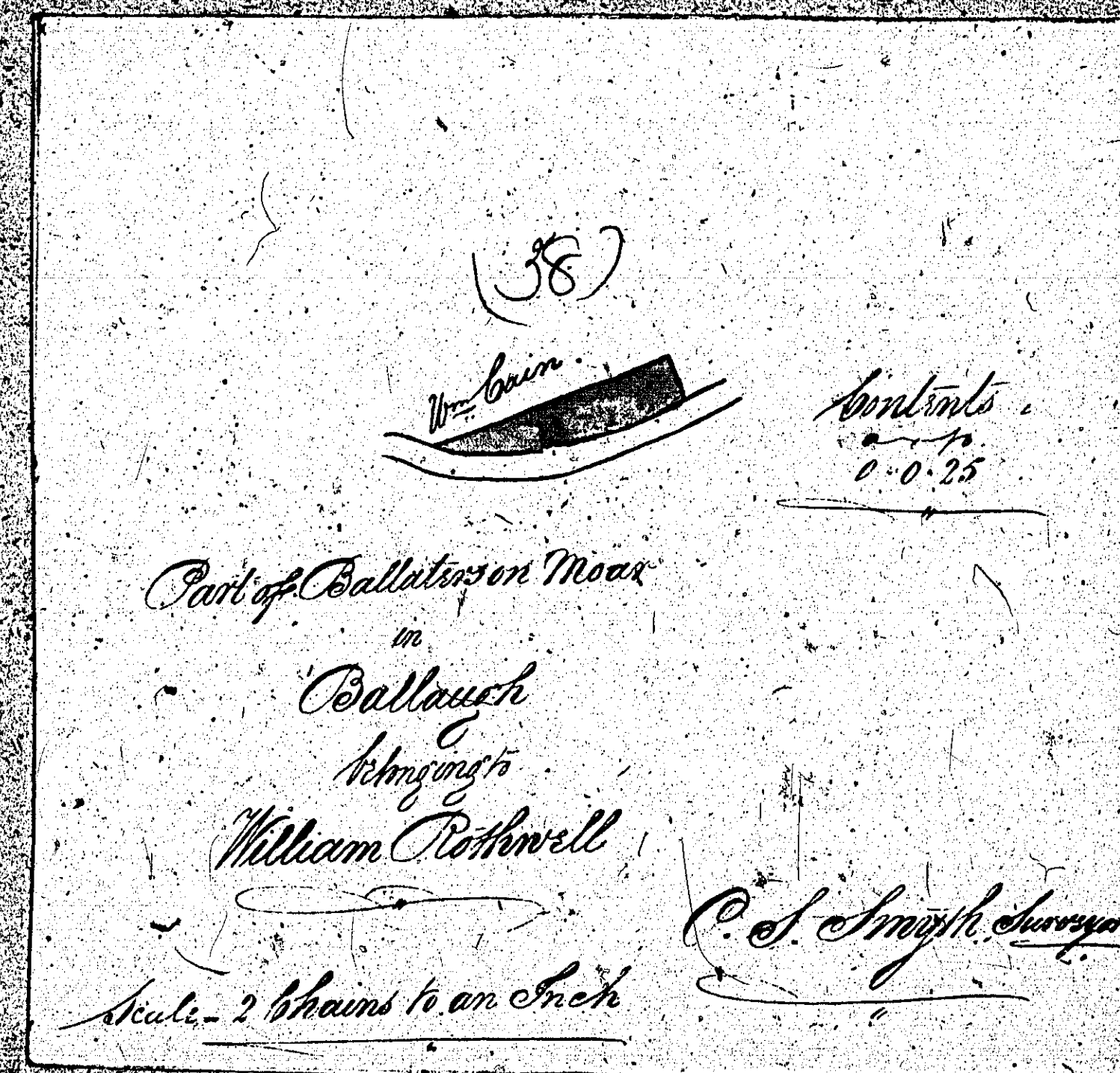

Contents

1	1	2	27 1/4
2	1	2	3 1/4
3	1	1	21
4	1	0	14 1/2
5	2	0	25 1/2
6	3	1	7 1/4
7	4	1	35
8	2	2	1 1/4
9	7	0	21
10	4	2	19
11	5	2	31 1/4
12	6	2	1 1/2
13	4	1	32 1/4
14	1	1	11 1/2
15	3	2	11
16	3	2	35 1/2
17	3	3	1
18	7	0	17 1/4
19	1	1	3 1/4
20	10	3	16
21	15	2	10
Public Road	1	3	17
Quinn	0	0	12
Private Road	0	0	33
Whole amt	93	0	0
			94. 3. 10

Plan and Survey Part of Balla Tasson
and other Black Lands situate in the
Parish of Ballaugh Isle of Man

The Property of
Mr Thomas Myllesraane By Daniel Kelly
(1862)

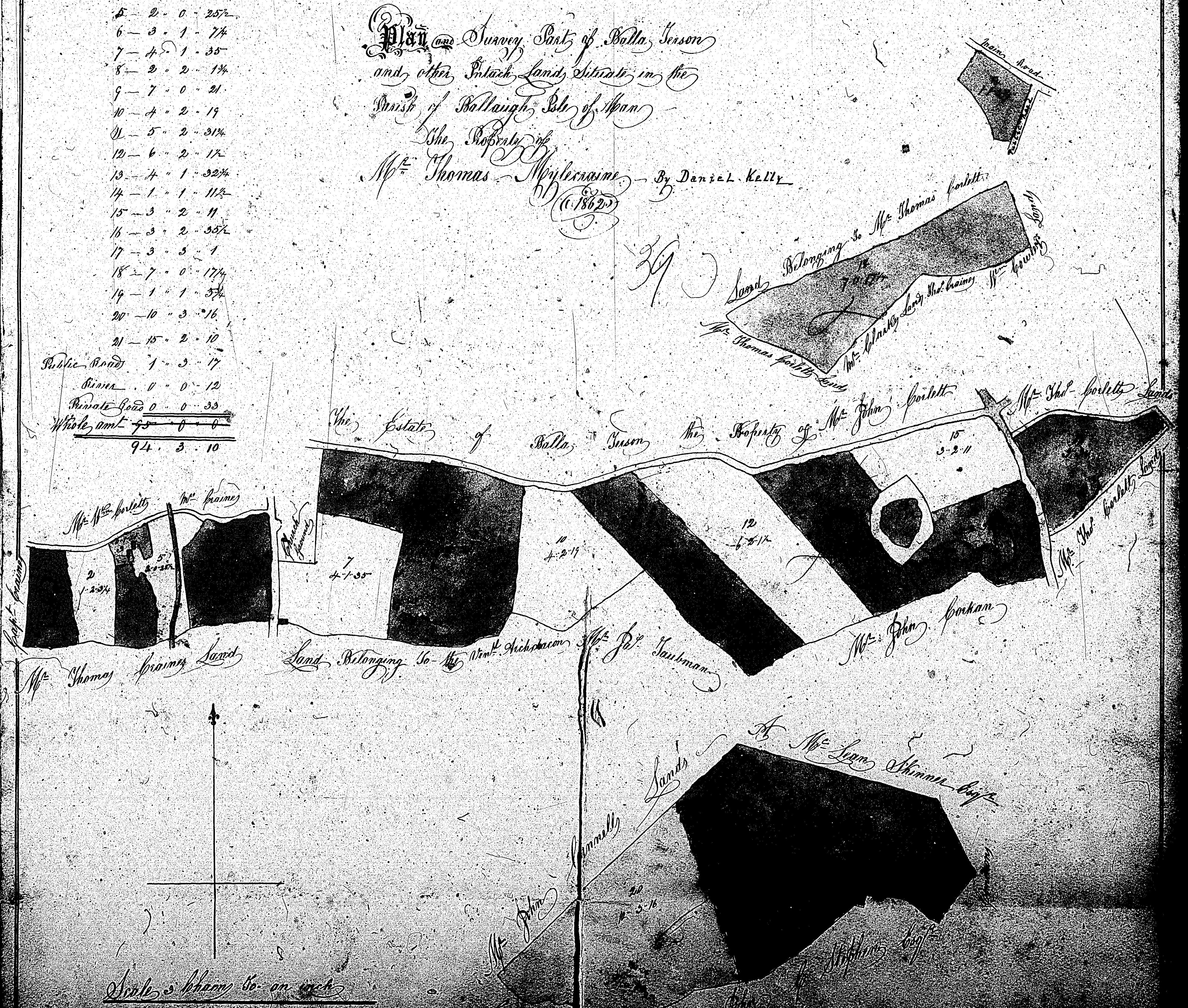

ISLE OF MAN GOVERNMENT: GENERAL REGISTRY

ASYLUM PLANS: PARISH OF BALLAUGH

Originals coloured

1:23

BE

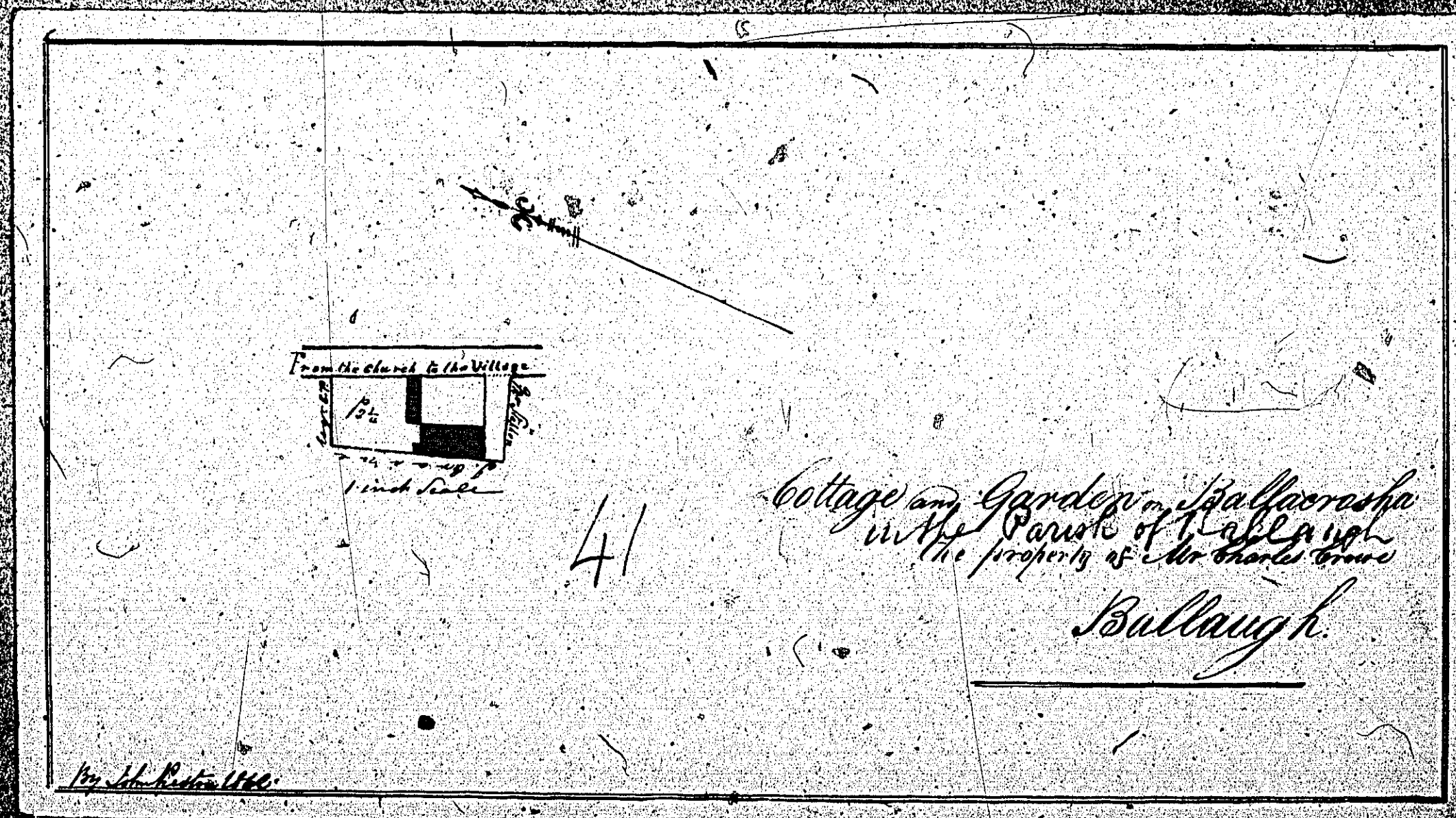
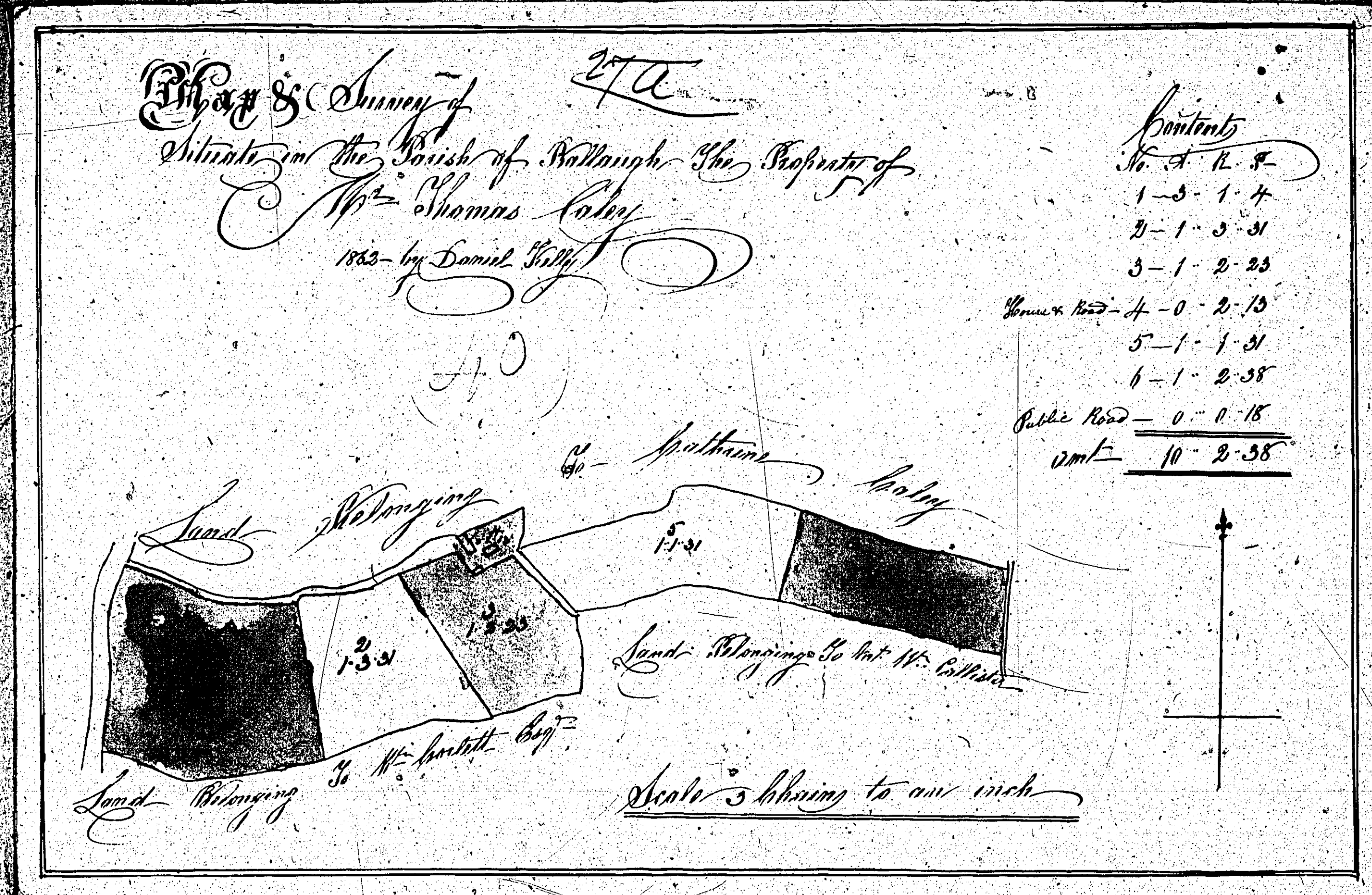

ISLE OF MAN GOVERNMENT: GENERAL REGISTRY

ASYLUM PLANS: PARISH OF BALLAUGH

Originals coloured

1:23

